



**COMPUTER FREEHOLD REGISTER
UNDER LAND TRANSFER ACT 1952**



**Guaranteed Search Copy issued under Section 172A
of the Land Transfer Act 1952**

R.W. Muir
Registrar-General
of Land

Identifier 386573
Land Registration District Canterbury
Date Issued 18 October 2007

Prior References
CB25A/548

Estate	Fee Simple
Area	4096 square metres more or less
Legal Description	Section 1019-1022 Town of Christchurch
Purpose	Public Passenger Interchange Facility

Proprietors
Christchurch City Council

Interests

A392649.1 CERTIFICATE PURSUANT TO SECTION 37 BUILDING ACT 1991 - 26.2.1999 AT 1.40 PM
Subject to a right to convey electric power (in gross) over part marked A on DP 81312 in favour of Orion New Zealand Limited created by Transfer A426097.1 - 22.9.1999 at 11:23 am

Identifier

386573

CT 386573

H2007/0263



LICHFIELD STREET

40.84

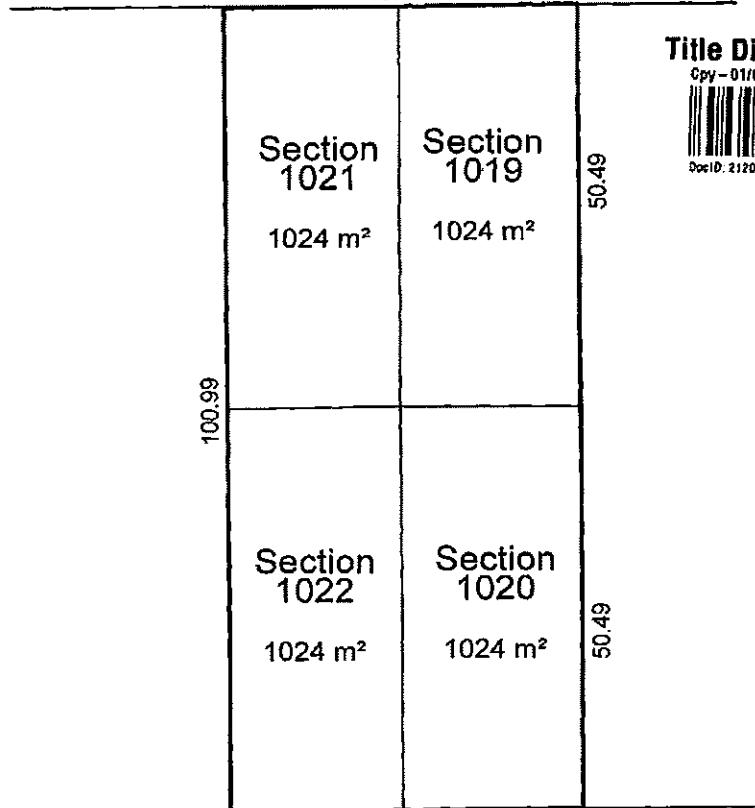

Title Diagram CT 386573

Copy - 01/03, Pgs - 001, 30/10/07, 12:47



DocID: 212031509

40.84

TUAM STREET

TOWN OF CHRISTCHURCH

TOTAL CT AREA: 4096 m²