

**COMPUTER FREEHOLD REGISTER
UNDER LAND TRANSFER ACT 1952**



R. W. Muir
Registrar-General
of Land

Historical Record

Identifier CB25A/548
Land Registration District Canterbury
Date Issued 29 June 1983

Cancelled

Prior References
CB22A/775

Estate Fee Simple
Area 5108 square metres more or less
Legal Description Section 1019-1022 and Section 1028 Town of Christchurch

Original Proprietors
Christ's College Canterbury

Interests

11317 Lease of Town Section 1028 to Hellaby Properties Limited Term (now) to 8.5.2011 - 12.5.1944 at 11.32 am and varied 9.4.1984 at 11.30 am and 18.7.1990 at 11.23 am

A366374.1 Variation of Lease 11317 - 28.8.1998 at 2.27 pm

A392649.1 CERTIFICATE PURSUANT TO SECTION 37 BUILDING ACT 1991 (ALSO AFFECTS SECTION 1019-1022 HEREIN) - 26.2.1999 AT 1.40 PM

A426097.1 Transfer creating the following easements in gross - 22.9.1999 at 11.23 am

Type	Servient Tenement	Easement Area	Grantee	Statutory Restriction
Convey electric power	Section 1019 Town of Christchurch - herein	A DP 81312	Orion New Zealand Limited	

6282603.1 CT 197958 issued for the leasehold estate in Lease 11317 - 20.1.2005 at 9:00 am

7582909.1 Transfer of Sections 1019,1020, 1021 and 1022 Town of Christchurch to Christchurch City Council - 18.10.2007 at 9:00 am

7582909.2 CTs issued - 18.10.2007 at 9:00 am

Legal Description	Title
Section 1019-1022 Town of Christchurch	386573
Section 1028 Town of Christchurch	386574

CANCELLED
CANCELLED



LICHFIELD STREET

40.84

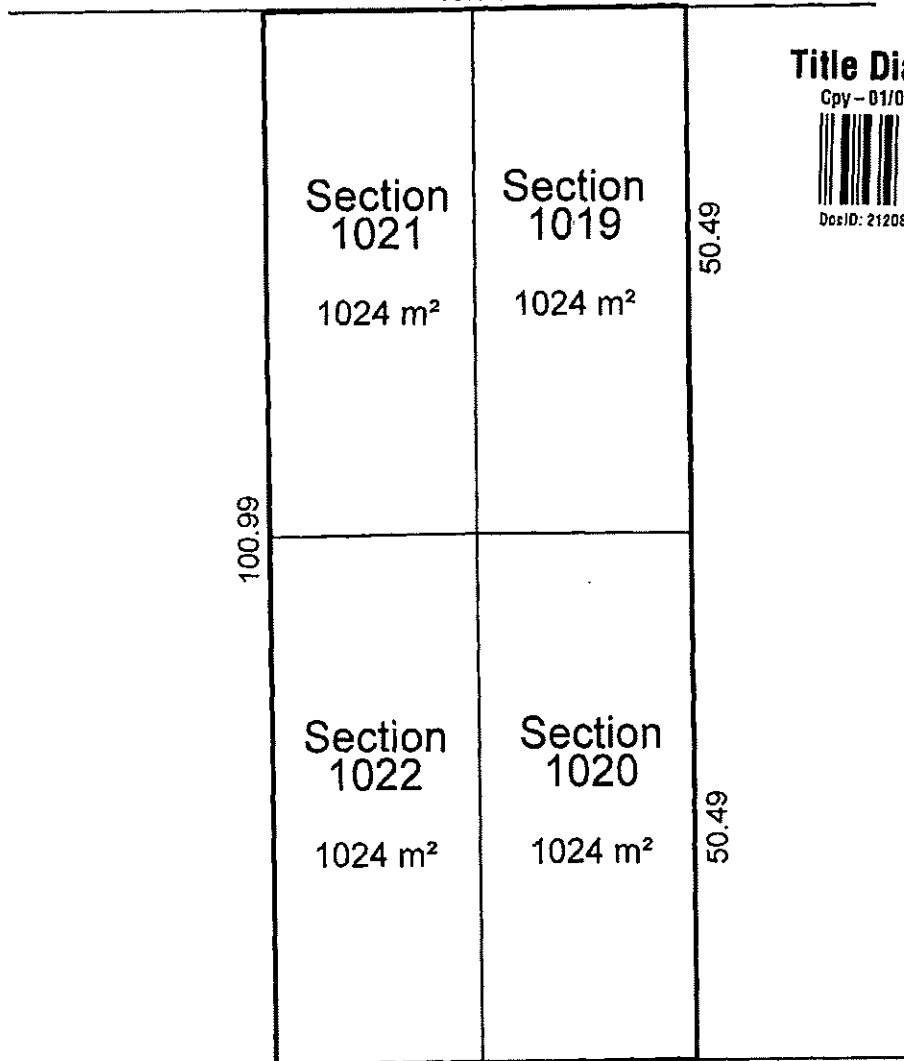

Title Diagram CT 386573

Cpy - 01/01, Pgs - 001, 30/10/07, 12:47



DocID: 212081509

40.84

TUAM STREET

TOWN OF CHRISTCHURCH

TOTAL CT AREA: 4096 m²