

Record of Survey - SO 566470

Survey Number SO 566470
Surveyor Reference 8226 - Holland
Surveyor Rhys James Kelly
Survey Firm RPC Ltd Registered Surveyors (Mt Maunganui)
Surveyor Declaration I Rhys James Kelly, being a licensed cadastral surveyor, certify that--
 (a) this dataset provided by me and its related survey are accurate, correct and in accordance with the Cadastral Survey Act 2002 and Cadastral Survey Rules 2021; and
 (b) the survey was undertaken by me or under my personal direction.
 Declared on 16 Sep 2021 04:01 PM

Survey Details

| | | | |
|----------------------------|---|-----------------------|---------|
| Dataset Description | Boundary Reinstatement of Lot 3 DPS 59072 | | |
| Purpose | Simple Boundary Reinstatement | | |
| Status | Registered | Type | Survey |
| Land District | South Auckland | Survey Class | Class A |
| Meridional Circuit | Bay of Plenty 2000 | Vertical Datum | None |

Survey Dates

| | | | |
|-----------------------|---------------------|-----------------------------|------------|
| Surveyed Date | 16/08/2021 | Certified Date | 16/09/2021 |
| Submitted Date | 16/09/2021 16:01:36 | Survey Approval Date | 22/09/2021 |
| Deposit Date | | | |

Referenced Surveys

| Survey Number | Land District | Bearing Correction |
|---------------|----------------|--------------------|
| DPS 59072 | South Auckland | -0°01'10" |
| DP 504770 | South Auckland | 0°00'00" |
| SO 537527 | South Auckland | 0°00'00" |

Territorial Authorities

Tauranga City

Mark and Vector

Survey Number SO 566470

Meridional Circuit Bay of Plenty 2000

| From | To | Code | Bearing | Adpt Surv | Bearing Correction | Distance | Adpt Surv | Class |
|-------------------|-------------------|------|--------------|-----------|--------------------|----------|-----------|---------|
| RM 109 SO 59650 | RSN 1 DP 330183 | ob0 | 121°52'10" M | | | 146.37 M | | |
| RSN 1 DP 330183 | AP 1 DP 504770 | ob6 | 301°48'00" M | | | 215.73 M | | |
| AP 1 DP 504770 | RM 109 SO 59650 | ob1 | 121°40'00" A | DP 504770 | 0°00'00" | 69.36 A | DP 504770 | |
| RSN 1 DP 330183 | RN 1 SO 566470 | ob7 | 16°23'30" M | | | 73.44 M | | |
| RN 1 SO 566470 | RN 2 SO 566470 | ob2 | 196°40'30" M | | | 70.35 M | | |
| RN 2 SO 566470 | RM 109 SO 59650 | ob9 | 300°43'40" M | | | 145.24 M | | |
| RN 1 SO 566470 | IB V ML 22106 | ob3 | 29°12'00" M | | | 107.63 M | | |
| IB V ML 22106 | IB IV ML 22106 | ob11 | 301°37'50" A | SO 537527 | 0°00'00" | 174.04 A | SO 537527 | |
| IB IV ML 22106 | AP 3 DP 504770 | ob12 | 216°12'00" A | DP 504770 | 0°00'00" | 121.76 A | DP 504770 | |
| AP 3 DP 504770 | AP 1 DP 504770 | ob13 | 219°50'30" A | DP 504770 | 0°00'00" | 56.98 A | DP 504770 | |
| RN 2 SO 566470 | AP I DPS 87210 | ob10 | 124°47'30" M | | | 56.29 M | | |
| AP I DPS 87210 | RM 109 SO 59650 | ob14 | 301°52'10" M | | | 201.43 M | | |
| RSN 1 DP 330183 | RSN 2 DP 330183 | ob8 | 121°52'10" A | SO 537527 | 0°00'00" | 3.61 A | SO 537527 | |
| PEG (2) DPS 59072 | AD 1A SO 566470 | ob15 | 114°48'50" R | DPS 59072 | -0°01'10" | 0.06 R | | Class A |
| AD 1A SO 566470 | AD 1B SO 566470 | ob19 | 114°48'50" R | DPS 59072 | -0°01'10" | 13.10 R | | Class A |
| AD 1B SO 566470 | PEG (1) DPS 59072 | ob18 | 114°48'50" R | DPS 59072 | -0°01'10" | 6.83 R | | Class A |
| PEG (1) DPS 59072 | RN 1 SO 566470 | ob17 | 32°44'00" M | | | 4.70 M | | |
| RN 1 SO 566470 | AD 1A SO 566470 | ob4 | 282°04'00" M | | | 21.10 M | | |
| RN 1 SO 566470 | AD 1B SO 566470 | ob5 | 262°54'00" M | | | 8.81 M | | |
| PEG (2) DPS 59072 | IB XI DPS 59072 | ob16 | 154°14'50" A | DPS 59072 | -0°01'10" | 17.19 A | DPS 59072 | |
| IB XI DPS 59072 | IB XII DPS 59072 | ob20 | 28°01'50" A | DPS 59072 | -0°01'10" | 59.84 A | DPS 59072 | |
| IB XII DPS 59072 | IB V ML 22106 | ob22 | 35°46'50" A | DPS 59072 | -0°01'10" | 64.35 A | DPS 59072 | |
| IB XI DPS 59072 | PEG (1) DPS 59072 | ob21 | 56°23'50" A | DPS 59072 | -0°01'10" | 12.82 A | DPS 59072 | |

| Mark Name | Mark Condition | Description |
|-----------------|----------------|------------------|
| AD 1A SO 566470 | | AD top of fence |
| AD 1B SO 566470 | | AD top of fence |
| RM 109 SO 59650 | | Flush in channel |



Mark and Vector

Survey Number SO 566470

Meridional Circuit Bay of Plenty 2000

| Mark Name | Mark Condition | Description |
|----------------|----------------|-------------------|
| RN 1 SO 566470 | | Flush in driveway |

***** End of Report *****



SO 566470

OCCUPATION DIAGRAM

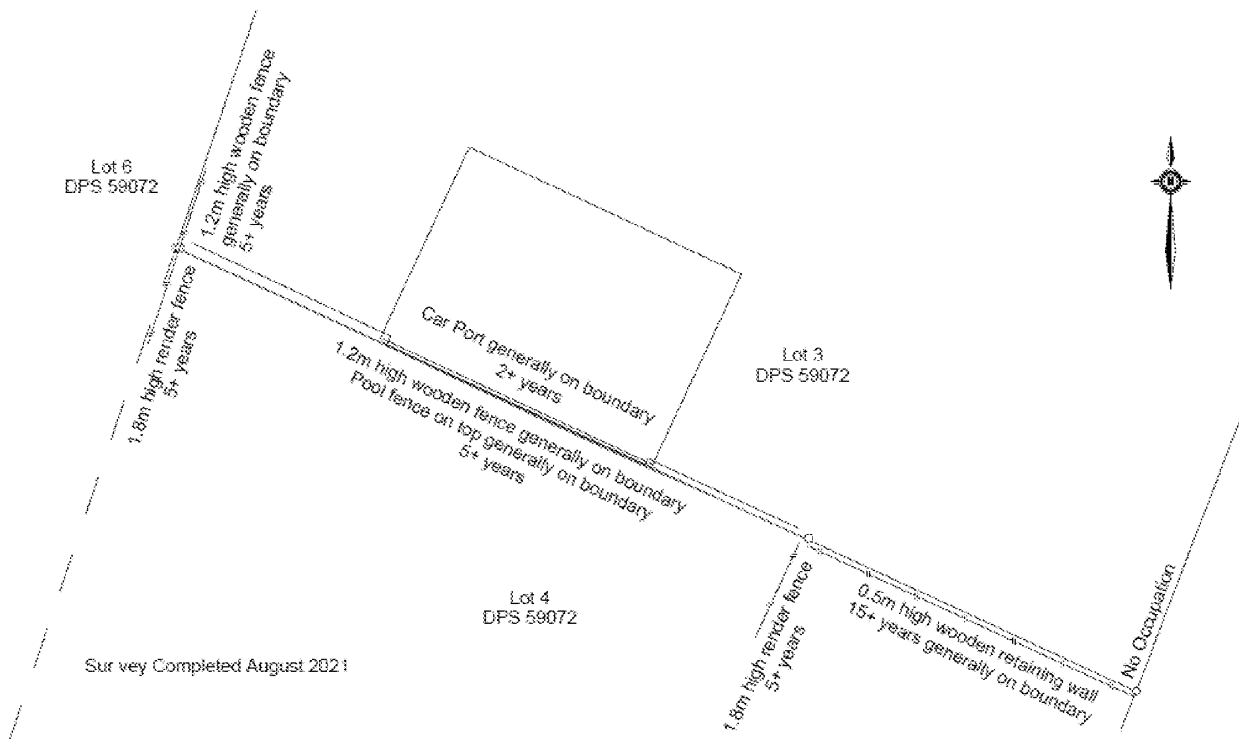



Diag. A

IB V ML 22106

Otra Close

AP 1 DP 504770

Diag. AA
See S1

Lot 6 DPS 59072

Lot 3
DPS 59072

Lot 4
DPS 59072

RM 109 SO 59650
(Flush in channel)

Papamoa Beach Road

RN 1

AD 1A (AD top of fence)

Lot 3 DPS 59072

AD 1B
(AD top of fence)

Lot 4 DPS 59072

(1) DPS 59072

To IB V ML 22106

RN 1
(Flush in driveway)

To RN 2
To RSN 1 DP 330183

Diag. AA

Lot 5 DPS 5005

Lot 1 DPS 84201

RN 2

RSN 1 DP 330183

AP 1 DPS 87210

S 1/1

Boundary Reinstatement of Lot 3 DPS 59072

Land District: South Auckland

Digitally Generated Plan

Generated on: 22/09/2021 09:47:am | Page 5 of 5

Surveyor: Rhys James Kelly
Firm: RPC Ltd Registered Surveyors (M/M)
Date of Survey: 16/08/2021

Record of Survey
SO 566470
Approved on: 22/09/2021