



# Record of Survey - DP 558700

---

**Survey Number** DP 558700  
**Surveyor Reference** 500983 - 1050 Colombo Street  
**Surveyor** Liam James Jagvik  
**Survey Firm** Eliot Sinclair & Partners Ltd  
**Surveyor Declaration** I Liam James Jagvik, being a licensed cadastral surveyor, certify that--  
(a) this dataset provided by me and its related survey are accurate, correct and in accordance with the Cadastral Survey Act 2002 and Cadastral Survey Rules 2021; and  
(b) the survey was undertaken by me or under my personal direction.  
Declared on 13 Oct 2022 01:16 PM

---

## Survey Details

**Dataset Description** Lots 1 and 2 being a Subdivision of Part Lot 9 DP 2952  
**Purpose** LT Subdivision  
**Status** Deposited **Type** Survey  
**Land District** Canterbury **Survey Class** Class A  
**Meridional Circuit** Mount Pleasant 2000 **Vertical Datum** None

---

## Survey Dates

**Surveyed Date** 05/09/2022 **Certified Date** 13/10/2022  
**Submitted Date** 13/10/2022 13:16:31 **Survey Approval Date** 13/10/2022  
**Deposit Date** 19/09/2022

---

## Referenced Surveys

| Survey Number | Land District | Bearing Correction |
|---------------|---------------|--------------------|
| DP 561525     | Canterbury    | 0°00'00"           |
| DP 35318      | Canterbury    | 0°00'00"           |
| DP 2952       | Canterbury    | 0°00'00"           |
| DP 36569      | Canterbury    | 0°00'00"           |
| DP 46666      | Canterbury    | 0°00'00"           |
| SO 461634     | Canterbury    | 0°00'00"           |
| DP 569182     | Canterbury    | 0°00'00"           |

---

## Territorial Authorities

Christchurch City

---

## Comprised In

RT CB15A/1414

---

## Created Parcels

| Parcels                                      | Parcel Intent    | Area      | RT Reference |
|--|------------------|-----------|--------------|
| Lot 1 Deposited Plan 558700                  | Fee Simple Title | 0.0222 Ha | 981815       |
| Lot 2 Deposited Plan 558700                  | Fee Simple Title | 0.0283 Ha | 981816       |
| Area A Deposited Plan 558700                 | Easement         |           |              |
| Height-Limited Area AA Deposited Plan 558700 | Easement         |           |              |
| Area AB Deposited Plan 558700                | Easement         |           |              |



# Record of Survey - DP 558700

---

## Created Parcels

| Parcels                                      | Parcel Intent   | Area            | RT Reference |
|--|-----------------|-----------------|--------------|
| Area B Deposited Plan 558700                 | Easement        |                 |              |
| Height-Limited Area BA Deposited Plan 558700 | Easement        |                 |              |
| Area BB Deposited Plan 558700                | Easement        |                 |              |
| Area C Deposited Plan 558700                 | Easement        |                 |              |
| Area D Deposited Plan 558700                 | Easement        |                 |              |
| Area E Deposited Plan 558700                 | Covenant - Land |                 |              |
| <b>Total Area</b>                            |                 | <hr/> 0.0505 Ha |              |

# Mark and Vector

Survey Number DP 558700

Meridional Circuit Mount Pleasant 2000

| From                 | To                   | Code | Bearing      | Adpt Surv | Bearing Correction | Distance | Adpt Surv | Class |
|----------------------|----------------------|------|--------------|-----------|--------------------|----------|-----------|-------|
| IS II SO 452776      | IS III DP 36569      | ob0  | 183°23'20" M |           |                    | 82.00 M  |           |       |
| IS III DP 36569      | IS 11 SO 461634      | ob1  | 179°50'00" M |           |                    | 153.50 M |           |       |
| IS 11 SO 461634      | IT III DP 81379      | ob4  | 347°42'15" M |           |                    | 79.34 M  |           |       |
| IT III DP 81379      | MA 1 DP<br>558700    | ob5  | 4°36'30" M   |           |                    | 49.55 M  |           |       |
| MA 1 DP<br>558700    | IS II SO 452776      | ob7  | 9°04'30" M   |           |                    | 109.83 M |           |       |
| IS III DP 36569      | MA 2 DP<br>558700    | ob2  | 182°51'00" M |           |                    | 29.46 M  |           |       |
| MA 2 DP<br>558700    | MA 3 DP<br>558700    | ob10 | 181°12'00" M |           |                    | 9.86 M   |           |       |
| MA 3 DP<br>558700    | IT III DP 81379      | ob17 | 201°56'00" M |           |                    | 39.57 M  |           |       |
| MA 1 DP<br>558700    | MA 3 DP<br>558700    | ob8  | 139°34'00" M |           |                    | 16.66 M  |           |       |
| MA 2 DP<br>558700    | PEG (17) DP<br>46666 | ob11 | 22°13'00" M  |           |                    | 8.85 M   |           |       |
| MA 2 DP<br>558700    | PEG (18) DP<br>46666 | ob12 | 28°56'00" M  |           |                    | 6.94 M   |           |       |
| MA 2 DP<br>558700    | PEG (19) DP<br>46666 | ob13 | 34°57'00" M  |           |                    | 10.05 M  |           |       |
| MA 2 DP<br>558700    | IT I DP 46666        | ob14 | 43°48'00" M  |           |                    | 8.90 M   |           |       |
| MA 2 DP<br>558700    | IR V DP 569182       | ob15 | 31°48'00" M  |           |                    | 3.03 M   |           |       |
| IT I DP 46666        | IT I DP 35318        | ob23 | 216°45'20" A | DP 46666  | 0°00'00"           | 34.82 A  | DP 46666  |       |
| IT I DP 35318        | IT II DP 36569       | ob72 | 359°50'14" A | DP 36569  | 0°00'00"           | 23.05 A  | DP 36569  |       |
| IT II DP 36569       | IR V DP 569182       | ob75 | 86°28'00" A  | DP 36569  | 0°00'00"           | 16.38 A  | DP 36569  |       |
| MA 3 DP<br>558700    | PEG XV DP<br>36569   | ob18 | 19°16'00" M  |           |                    | 10.84 M  |           |       |
| PEG XV DP<br>36569   | IR V DP 569182       | ob76 | 321°33'00" A | DP 36569  | 0°00'00"           | 2.81 A   | DP 36569  |       |
| PEG XV DP<br>36569   | PEG (23) DP<br>46666 | ob77 | 359°50'00" A | DP 2952   | 0°00'00"           | 4.20 A   | DP 46666  |       |
| PEG (23) DP<br>46666 | IT I DP 46666        | ob28 | 56°52'00" A  | DP 46666  | 0°00'00"           | 3.36 A   | DP 46666  |       |
| IT I DP 46666        | PEG (19) DP<br>46666 | ob24 | 347°48'00" A | DP 46666  | 0°00'00"           | 1.84 A   | DP 46666  |       |
| IT I DP 46666        | PEG (17) DP<br>46666 | ob25 | 302°21'00" A | DP 46666  | 0°00'00"           | 3.35 A   | DP 46666  |       |
| IT I DP 46666        | PEG (18) DP<br>46666 | ob26 | 263°09'00" A | DP 46666  | 0°00'00"           | 2.84 A   | DP 46666  |       |
| IS III DP 36569      | IS VII DP 36569      | ob3  | 89°05'40" A  | DP 36569  | 0°00'00"           | 42.09 A  | DP 36569  |       |
| IS VII DP 36569      | IT IV DP 36569       | ob78 | 89°05'40" A  | DP 36569  | 0°00'00"           | 4.02 A   | DP 36569  |       |
| IT IV DP 36569       | IS VI DP 36569       | ob79 | 170°19'00" A | DP 36569  | 0°00'00"           | 24.87 A  | DP 36569  |       |
| IS VI DP 36569       | IR V DP 569182       | ob80 | 266°28'00" A | DP 36569  | 0°00'00"           | 50.22 A  | DP 36569  |       |

# Mark and Vector

Survey Number DP 558700

Meridional Circuit Mount Pleasant 2000

| From                 | To                   | Code | Bearing    | Adpt Surv   | Bearing Correction | Distance | Adpt Surv | Class   |
|----------------------|----------------------|------|------------|-------------|--------------------|----------|-----------|---------|
| MA 3 DP<br>558700    | PEG NR DP<br>569182  | ob19 | 79°12'30"  | M           |                    | 55.02 M  |           |         |
| PEG NR DP<br>569182  | PEG (24) DP<br>2952  | ob27 | 269°54'00" | A DP 569182 | 0°00'00"           | 0.19 A   | DP 569182 |         |
| PEG (24) DP<br>2952  | PEG XIV DP<br>36569  | ob29 | 269°54'00" | A DP 2952   | 0°00'00"           | 5.02 A   | DP 36569  | Class A |
| PEG XIV DP<br>36569  | IS VI DP 36569       | ob30 | 30°48'20"  | A DP 36569  | 0°00'00"           | 6.07 A   | DP 36569  |         |
| PEG XIV DP<br>36569  | UNMK 36 DP<br>558700 | ob31 | 269°54'00" | A DP 2952   | 0°00'00"           | 19.15 C  |           | Class A |
| UNMK 36 DP<br>558700 | PEG 35 DP<br>558700  | ob43 | 269°54'00" | A DP 2952   | 0°00'00"           | 0.10 C   |           | Class A |
| PEG 35 DP<br>558700  | UNMK 37 DP<br>558700 | ob42 | 269°54'00" | A DP 2952   | 0°00'00"           | 0.10 C   |           | Class A |
| UNMK 37 DP<br>558700 | PEG XV DP<br>36569   | ob44 | 269°54'00" | A DP 2952   | 0°00'00"           | 25.92 C  |           | Class A |
| MA 1 DP<br>558700    | PEG 35 DP<br>558700  | ob9  | 93°26'00"  | M           |                    | 40.45 M  |           |         |
| IT I DP 35318        | IT II DP 35318       | ob73 | 179°50'14" | A DP 35318  | 0°00'00"           | 7.67 A   | DP 35318  |         |
| IT II DP 35318       | PEG V DP 35318       | ob81 | 62°29'00"  | A DP 35318  | 0°00'00"           | 20.37 A  | DP 35318  |         |
| PEG V DP 35318       | PEG 27 DP<br>558700  | ob82 | 359°50'00" | A DP 2952   | 0°00'00"           | 10.06 C  |           |         |
| PEG 27 DP<br>558700  | AD 28 DP<br>558700   | ob32 | 359°50'00" | A DP 2952   | 0°00'00"           | 1.50 C   |           | Class A |
| AD 28 DP<br>558700   | UNMK 38 DP<br>558700 | ob34 | 359°50'00" | A DP 2952   | 0°00'00"           | 1.50 C   |           | Class A |
| UNMK 38 DP<br>558700 | UNMK 29 DP<br>558700 | ob45 | 359°50'00" | A DP 2952   | 0°00'00"           | 1.50 C   |           | Class A |
| UNMK 29 DP<br>558700 | PEG XV DP<br>36569   | ob36 | 359°50'00" | A DP 2952   | 0°00'00"           | 5.56 C   |           | Class A |
| MA 3 DP<br>558700    | PEG 27 DP<br>558700  | ob20 | 87°14'00"  | M           |                    | 3.59 M   |           |         |
| MA 3 DP<br>558700    | AD 28 DP<br>558700   | ob21 | 64°57'00"  | M           |                    | 3.95 M   |           |         |
| IT I DP 35318        | IS III DP 35318      | ob74 | 92°35'00"  | A DP 35318  | 0°00'00"           | 62.06 A  | DP 35318  |         |
| IS III DP 35318      | PEG VI DP<br>35318   | ob38 | 53°58'00"  | A DP 35318  | 0°00'00"           | 7.87 A   | DP 35318  |         |
| PEG VI DP<br>35318   | PEG 32 DP<br>558700  | ob39 | 359°50'00" | A DP 2952   | 0°00'00"           | 10.06 C  |           |         |
| PEG 32 DP<br>558700  | PEG (24) DP<br>2952  | ob40 | 359°50'00" | A DP 2952   | 0°00'00"           | 10.06 C  |           | Class A |
| MA 2 DP<br>558700    | PEG 32 DP<br>558700  | ob16 | 100°09'00" | M           |                    | 54.53 M  |           |         |
| PEG 27 DP<br>558700  | UNMK 46 DP<br>558700 | ob33 | 89°55'00"  | C           |                    | 31.98 C  |           | Class A |
| UNMK 46 DP<br>558700 | PEG 32 DP<br>558700  | ob56 | 89°55'00"  | C           |                    | 18.32 C  |           | Class A |

# Mark and Vector

Survey Number DP 558700

Meridional Circuit Mount Pleasant 2000

| From                 | To                   | Code | Bearing    | Adpt Surv | Bearing Correction | Distance | Adpt Surv | Class   |
|----------------------|----------------------|------|------------|-----------|--------------------|----------|-----------|---------|
| AD 28 DP<br>558700   | AD 33 DP<br>558700   | ob35 | 89°55'00"  | C         |                    | 26.00 C  |           | Class A |
| AD 33 DP<br>558700   | UNMK 42 DP<br>558700 | ob41 | 0°00'30"   | C         |                    | 1.37 C   |           | Class A |
| UNMK 42 DP<br>558700 | UNMK 39 DP<br>558700 | ob67 | 0°00'30"   | C         |                    | 0.13 C   |           | Class A |
| UNMK 39 DP<br>558700 | UNMK 43 DP<br>558700 | ob47 | 0°00'30"   | C         |                    | 0.90 C   |           | Class A |
| UNMK 43 DP<br>558700 | PEG 35 DP<br>558700  | ob51 | 0°00'30"   | C         |                    | 6.16 C   |           | Class A |
| MA 3 DP<br>558700    | AD 33 DP<br>558700   | ob22 | 86°42'00"  | M         |                    | 29.64 M  |           |         |
| UNMK 38 DP<br>558700 | UNMK 44 DP<br>558700 | ob46 | 89°55'00"  | C         |                    | 2.00 C   |           | Class A |
| UNMK 44 DP<br>558700 | UNMK 51 DP<br>558700 | ob53 | 89°55'00"  | C         |                    | 1.97 C   |           | Class A |
| UNMK 51 DP<br>558700 | UNMK 45 DP<br>558700 | ob63 | 89°55'00"  | C         |                    | 17.02 C  |           | Class A |
| UNMK 45 DP<br>558700 | UNMK 39 DP<br>558700 | ob54 | 89°55'00"  | C         |                    | 5.01 C   |           | Class A |
| UNMK 39 DP<br>558700 | UNMK 40 DP<br>558700 | ob48 | 89°55'00"  | C         |                    | 4.10 C   |           | Class A |
| UNMK 40 DP<br>558700 | UNMK 41 DP<br>558700 | ob49 | 89°55'00"  | C         |                    | 1.88 C   |           | Class A |
| UNMK 41 DP<br>558700 | UNMK 52 DP<br>558700 | ob50 | 179°55'00" | C         |                    | 0.13 C   |           | Class A |
| UNMK 52 DP<br>558700 | UNMK 46 DP<br>558700 | ob65 | 179°55'00" | C         |                    | 2.87 C   |           | Class A |
| UNMK 46 DP<br>558700 | UNMK 47 DP<br>558700 | ob55 | 44°55'00"  | C         |                    | 1.27 C   |           | Class A |
| UNMK 47 DP<br>558700 | UNMK 49 DP<br>558700 | ob57 | 89°55'00"  | C         |                    | 4.01 C   |           | Class A |
| UNMK 49 DP<br>558700 | UNMK 43 DP<br>558700 | ob59 | 89°55'00"  | C         |                    | 0.10 C   |           | Class A |
| UNMK 43 DP<br>558700 | UNMK 50 DP<br>558700 | ob52 | 89°55'00"  | C         |                    | 0.10 C   |           | Class A |
| UNMK 50 DP<br>558700 | UNMK 48 DP<br>558700 | ob61 | 89°55'00"  | C         |                    | 4.00 C   |           | Class A |
| UNMK 48 DP<br>558700 | UNMK 40 DP<br>558700 | ob58 | 179°55'00" | C         |                    | 0.90 C   |           | Class A |
| UNMK 29 DP<br>558700 | UNMK 44 DP<br>558700 | ob37 | 126°46'00" | C         |                    | 2.50 C   |           | Class A |
| UNMK 44 DP<br>558700 | UNMK 37 DP<br>558700 | ob60 | 0°00'30"   | C         |                    | 6.16 C   |           | Class A |
| UNMK 37 DP<br>558700 | UNMK 36 DP<br>558700 | ob62 | 0°00'30"   | C         |                    | 6.16 C   |           | Class A |
| UNMK 36 DP<br>558700 | UNMK 53 DP<br>558700 | ob64 | 179°55'00" | C         |                    | 0.13 C   |           | Class A |

# Mark and Vector

Survey Number DP 558700

Meridional Circuit Mount Pleasant 2000

| From              | To                | Code | Bearing     | Adpt Surv | Bearing Correction | Distance | Adpt Surv | Class   |
|-------------------|-------------------|------|-------------|-----------|--------------------|----------|-----------|---------|
| UNMK 53 DP 558700 | UNMK 42 DP 558700 | ob66 | 89°55'00" C |           |                    | 22.03 C  |           | Class A |
| UNMK 42 DP 558700 | UNMK 52 DP 558700 | ob68 | 89°55'00" C |           |                    | 5.98 C   |           | Class A |

| Mark Name       | Mark Condition | Description   |
|-----------------|----------------|---|
| AD 28 DP 558700 |                | Al. disk in driveway concrete   |
| AD 33 DP 558700 |                | Al. disk in driveway concrete   |
| IR V DP 569182  |                | IS V DP 36569 REN   |
| IT III DP 81379 |                | Tube flush in middle of sealed crossing                                 |
| MA 1 DP 558700  |                | Masonry anchor with washer flush in concrete bike lane separator island |
| MA 2 DP 558700  |                | Masonry anchor flush in top of kerb                                     |
| MA 3 DP 558700  |                | Masonry anchor flush in channel   |

\*\*\* End of Report \*\*\*

# Schedule / Memorandum

Land Registration District

**Canterbury**

Survey Number

**LT 558700**

Territorial Authority (the Council)

**Christchurch City**

## Memorandum of Easements

Last Edited: 15 Sep 2022 16:53:55

| <u>Purpose</u>  | <u>Shown</u> | <u>Burdened Land</u><br>(Servient Tenement) | <u>Benefited Land</u><br>(Dominant Tenement) |
|---|--------------|---|--|
| Right of Way  | A, AA, AB    | Lot 1                                       | Lot 2  |
|   | B, BA, BB    | Lot 2                                       | Lot 1  |
| Right to convey electricity,<br>water, telecommunications | A, AA, AB    | Lot 1                                       | Lot 2  |
|   | B, BA, BB    | Lot 2                                       | Lot 1  |
| Right to drain sewage, water                              | A, AA, AB    | Lot 1                                       | Lot 2  |
|   | B, BA, BB    | Lot 2                                       | Lot 1  |
| Party wall  | C            | Lot 1                                       | Lot 2  |
|   | D            | Lot 2                                       | Lot 1  |

## Notes

Last Edited: 06 Sep 2022 10:24:04

Area 'E' is subject to a Consent Notice for Visibility Splay

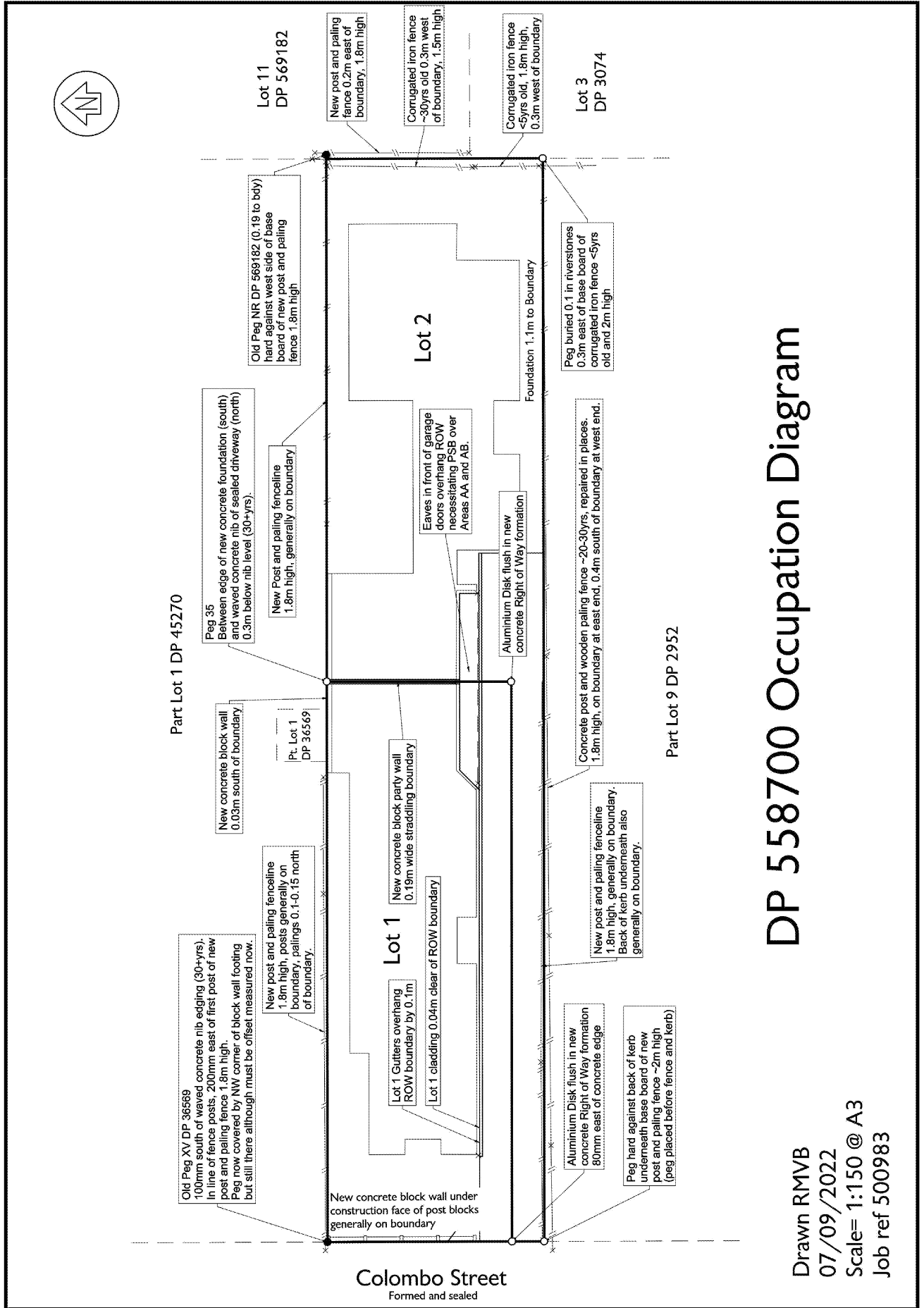

# DP 558700 Occupation Diagram

Drawn RMVB  
 07/09/2022  
 Scale= 1:150 @ A3  
 Job ref 500983







