

Record of Survey - DP 570666

Survey Number	DP 570666
Surveyor Reference	3494 Parker
Surveyor	Steven James Green
Survey Firm	Apex Surveying Ltd (Auckland)
Surveyor Declaration	I Steven James Green, being a licensed cadastral surveyor, certify that-- (a) this dataset provided by me and its related survey are accurate, correct and in accordance with the Cadastral Survey Act 2002 and Cadastral Survey Rules 2021; and (b) the survey was undertaken by me or under my personal direction. Declared on 09 Dec 2021 01:29 PM

Survey Details

Dataset Description	Area 2, Area 3 and Area D on Lot 78 DP 70166		
Purpose	Flat plan/Cross-lease		
Status	Deposited	Type	Survey
Land District	North Auckland	Survey Class	Class A
Meridional Circuit	Mount Eden OCD	Vertical Datum	None

Survey Dates

Surveyed Date	01/11/2021	Certified Date	09/12/2021
Submitted Date	09/12/2021 13:29:13	Survey Approval Date	24/02/2022
Deposit Date	14/09/2022		

Referenced Surveys

Survey Number	Land District	Bearing Correction
DP 70166	North Auckland	0°00'00"
DP 72988	North Auckland	0°00'00"

Territorial Authorities

Auckland Council

Comprised In

RT NA28D/702
RT NA28D/703

Created Parcels

Parcels	Parcel Intent	Area	RT Reference
Area 2 Deposited Plan 570666	Cross Lease Building		1031526
Area 3 Deposited Plan 570666	Cross Lease Building		1031526
Area D Deposited Plan 570666	Covenant - Flat/Crosslease		
Total Area		0.0000 Ha	

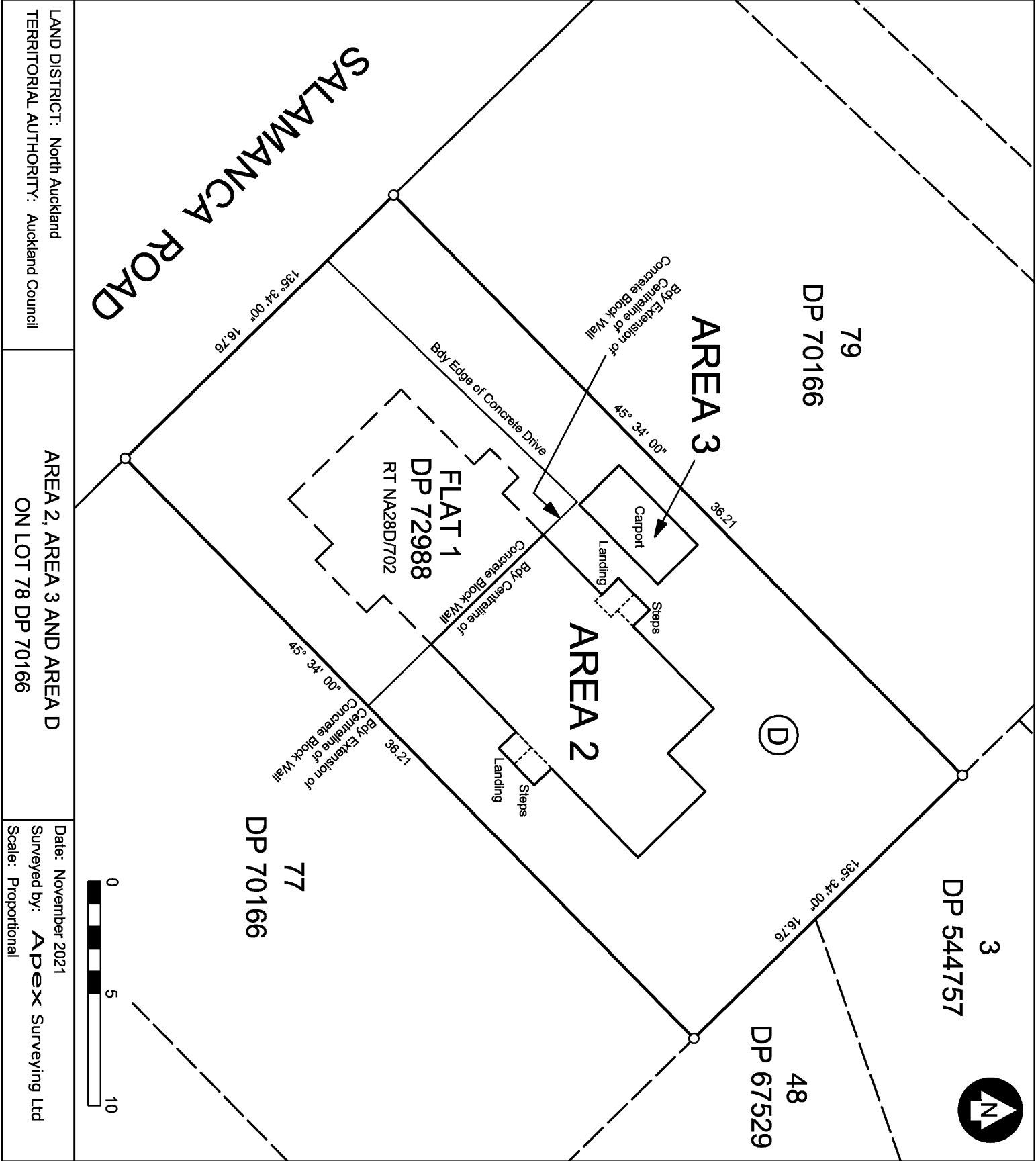

NOTES:

- 1) Area marked Area **D** is subject to covenants.
- 2) Boundaries of areas to be leased are to outside faces of walls and structures unless otherwise shown.
- 3) Unless otherwise shown covenant boundaries are not visibly defined.
- 4) Covenant boundaries follow outside faces of walls and structures at ground level unless otherwise shown.

Survey Class : Class A	
Total Area : 607m ²	
Comprised in : RT NA28D/702 (Flat 1 DP 72988) RT NA28D/703 (Flat 2 DP 72988)	
SUPPORTING DOCUMENT PLAN GRAPHIC SHEET 1 OF 1	
Surveyor : Steven James Green	
Our Ref: 3494	DP 570666