



Record of Survey - LT 538206

Survey Number LT 538206
Surveyor Reference 6479 Barrack Rd S2
Surveyor Rogan Hampson
Survey Firm Hampson & Associates Ltd
Surveyor Declaration I Rogan Hampson, being a licensed cadastral surveyor, certify that--
 (a) this dataset provided by me and its related survey are accurate, correct and in accordance with the Cadastral Survey Act 2002 and Cadastral Survey Rules 2021; and
 (b) the survey was undertaken by me or under my personal direction.
 Declared on 23 Dec 2021 10:51 AM

Survey Details

Dataset Description Plan of Redevelopment & Second Stage on Lot 8 DP 480614
Purpose Stage Unit Plan
Status Approved as to Survey **Type** Survey
Land District North Auckland **Survey Class** Class A
Meridional Circuit Mount Eden 2000 **Vertical Datum** None

Survey Dates

Surveyed Date 15/12/2021 **Certified Date** 23/12/2021
Submitted Date 23/12/2021 10:51:47 **Survey Approval Date** 16/03/2022
Deposit Date

Referenced Surveys

Survey Number	Land District	Bearing Correction
DP 480614	North Auckland	0°00'00"

Territorial Authorities

Auckland Council

Comprised In

RT 671991

Created Parcels

Parcels	Parcel Intent	Area	RT Reference
Principal Unit 128P Deposited Plan 538206	Principal Unit		1032688
Total Area		0.0000 Ha	

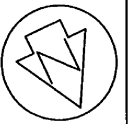

NOTES:
 UNLES SHOWN OTHERWISE:
 1. PRINCIPAL UNIT BOUNDARIES (PUS) ARE TO THE CENTRE LINE OF WALLS, GLAZING, HANDRAILS OR STRUCTURES.
 2. THE UPPER AND LOWER LIMITS OF PU'S ARE TO THE CENTRE OF THE CONCRETE FLOOR SLABS. THE UPPER LIMITS OF LEVEL 5 PU'S ARE TO THE UNDERSIDE OF THE SUSPENDED CEILINGS.
 3. UPPER AND LOWER PRINCIPAL UNIT BOUNDARIES ON EXTERIOR PARKING UNITS (SUFFIXED P) ARE TO THE UPPER FINISHED SURFACE OF THE SEALED PARKING AREAS AND 2.20m ABOVE THE UPPER FINISHED SURFACE OF THE SEALED PARKING AREAS
 4. AREAS V & A ARE COMMON PROPERTY
 EC=EDGE OF CONCRETE
 EXT=EXTENSION



SITE PLAN

LAND DISTRICT NORTH AUCKLAND
 DATASET TYPE SURVEYED
 DATUM GEODETIC 2000

PLAN OF UNIT REDEVELOPMENT
 & SECOND STAGE ON LOT 8 DP 480614

TERRITORIAL AUTHORITY Auckland Council
 Surveved by HAMPSON & ASSOCIATES LTD
 Scale 1:500
 Date December 2021

Compsied in
 File 6479
 Received
 Instructions
 SHEET 1/9
 DP 538206

3
DP 315665

2
DP 336425

15
DP 32230

14
DP 32230

11
DP 32230

10
DP 32230

Pt 7
DP 32230



COMMON PROPERTY

COMMON PROPERTY

FDU 1B

FDU 2C

STAIRS LIFTS



3
DP 480614

BASEMENT FLOOR PLAN

SHEET 2/9

LAND DISTRICT NORTH AUCKLAND
DATASET TYPE SURVEYED
DATUM GEODETIC 2000

PLAN OF UNIT REDEVELOPMENT
& SECOND STAGE ON LOT 8 DP 480614

TERRITORIAL AUTHORITY Auckland Council
Surveyed by HAMPSON & ASSOCIATES LTD
Scale 1:300 Date December 2021

Comptised in.....
File 6479
Received Instructions

DP 538206

DP 40175
1

DP 315665
3

DP 336425
2

DP 32230
15

DP 32230
14

DP 32230
11

DP 188206
1

DP 480614
3

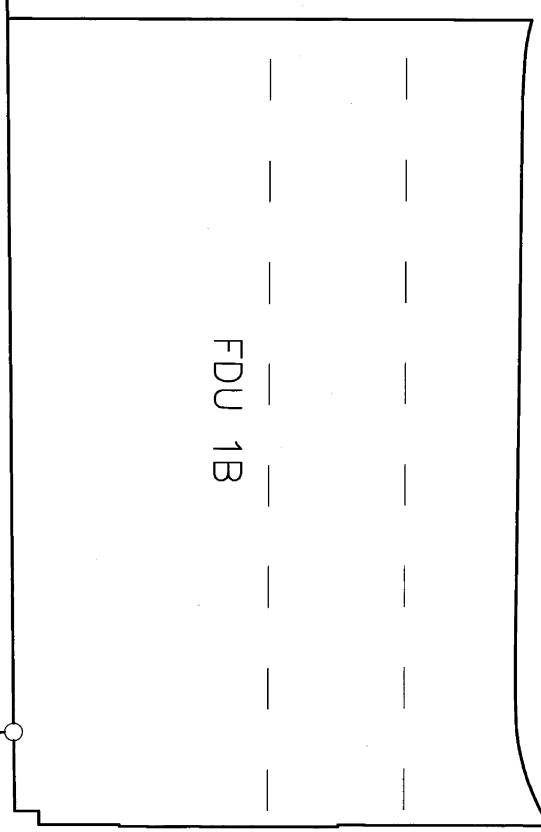
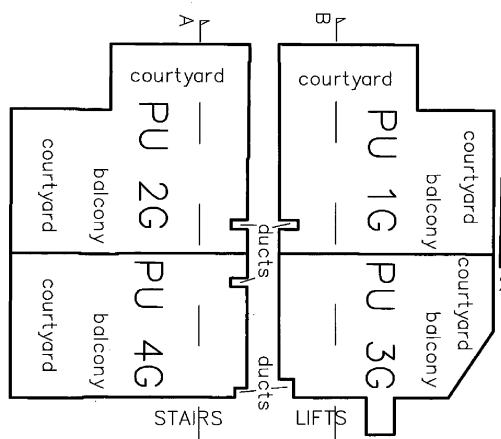
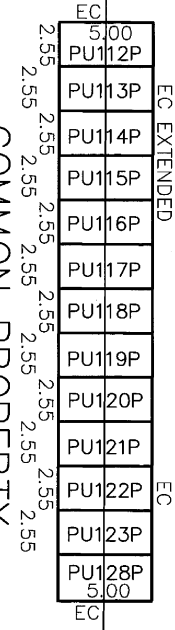
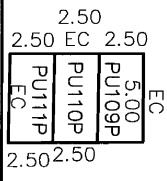

FDU 1B

FDU 2C
A
B

GROUND FLOOR PLAN

SHEET 3/9

LAND DISTRICT NORTH AUCKLAND
 DATASET TYPE SURVEYED
 DATUM GEODETIC 2000

PLAN OF UNIT REDEVELOPMENT
 & SECOND STAGE ON LOT 8 DP 480614

TERRITORIAL AUTHORITY Auckland Council
 Surveyed by HAMPSON & ASSOCIATES LTD
 Scale 1:300
 Date December 2021

Comprised in:
 File 6479
 Receiver Instructions
 DP 538206

DP 40175
1

DP 188206
1

DP 315665
3

DP 336425
2

DP 32230
15

DP 32230
14

DP 32230
11

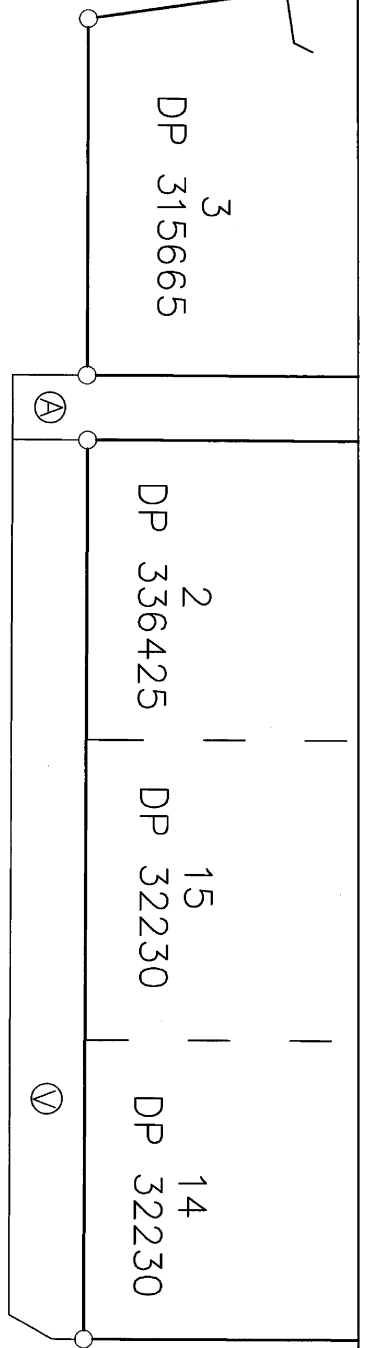

COMMON PROPERTY

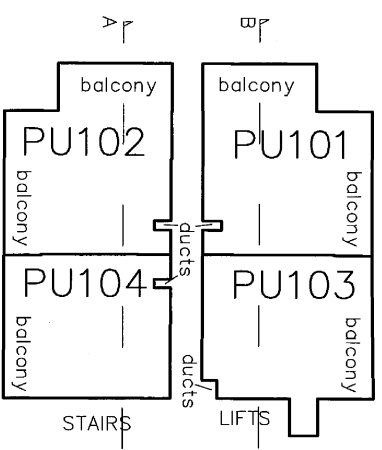

COMMON PROPERTY

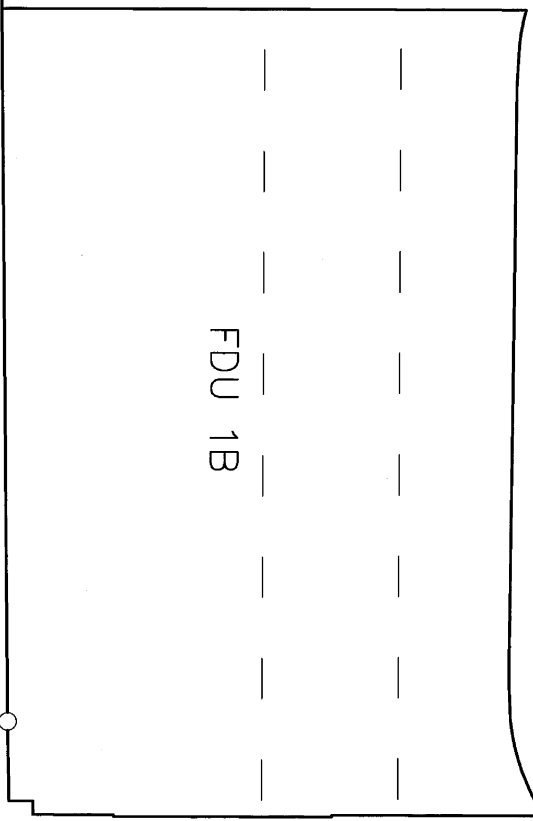

FDU 1B

FDU 2C

DP 480614
3

FIRST FLOOR PLAN

SHEET 4/9

LAND DISTRICT NORTH AUCKLAND
DATASET TYPE SURVEYED
DATUM GEODETIC 2000

PLAN OF UNIT REDEVELOPMENT
& SECOND STAGE ON LOT 8 DP 480614

TERRITORIAL AUTHORITY Auckland Council
Surveyed by HAMPSON & ASSOCIATES LTD
Scale 1:300 Date December 2021

Comprised in File 8479
Received Instructions

DP 538206

DP 40175
1

DP 315665
3

DP 336425
2

DP 32230
15

DP 32230
14

DP 32230
11

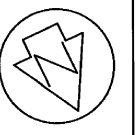

DP 188206
1

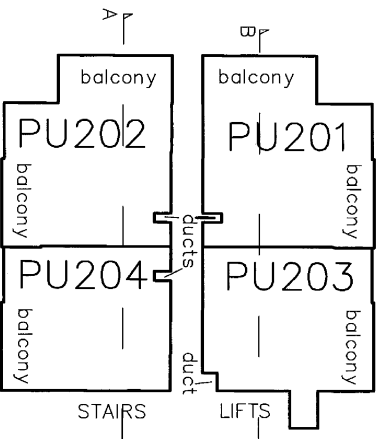

COMMON PROPERTY

FDU 1B

FDU 2C

DP 480614
3

SECOND FLOOR PLAN

SHEET 5/9

LAND DISTRICT: NORTH AUCKLAND
 DATASET TYPE: SURVEYED
 DATUM: GEODETIC 2000

PLAN OF UNIT REDEVELOPMENT
 & SECOND STAGE ON LOT 8 DP 480614

TERRITORIAL AUTHORITY: Auckland Council
 Surveyed by: HAMPSON & ASSOCIATES LTD
 Scale: 1:300
 Date: December 2021

Comprised in:
 File: 6479
 Received:
 Instructions:
 DP 538206

DP 40175
1

DP 315665
3

DP 336425
2

DP 32230
15

DP 32230
14

DP 32230
11



DP 188206
1

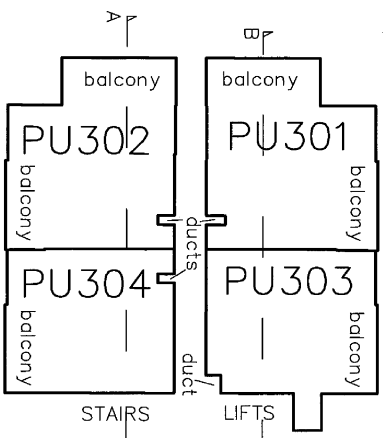

COMMON PROPERTY

FDU 1B

FDU 2C

DP 480614
3

THIRD FLOOR PLAN

SHEET 6/9

LAND DISTRICT NORTH AUCKLAND
 DATASET TYPE SURVEYED
 DATUM GEODETIC 2000

PLAN OF UNIT REDEVELOPMENT
 & SECOND STAGE ON LOT 8 DP 480614

TERRITORIAL AUTHORITY Auckland Council
 Surveyed by HAMPSON & ASSOCIATES LTD
 Scale 1:300
 Date December 2021

Comprised in
 File 6479
 Received Instructions
 DP 538206

DP 40175
1

DP 315665
3

DP 336425
2

DP 32230
15

DP 32230
14

DP 32230
11

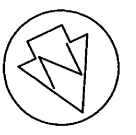

DP 188206
1

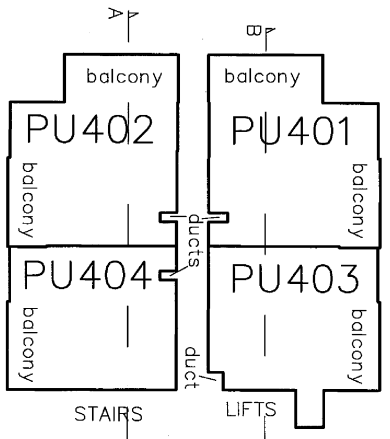

COMMON PROPERTY

FDU 1B

FDU 2C

DP 480614
3

FOURTH FLOOR PLAN

SHEET 7/9

LAND DISTRICT: NORTH AUCKLAND
 DATASET TYPE: SURVEYED
 DATUM: GEODETIC 2000

PLAN OF UNIT REDEVELOPMENT
 & SECOND STAGE ON LOT 8 DP 480614

TERRITORIAL AUTHORITY: Auckland Council
 Surveyed by: HAMPSON & ASSOCIATES LTD
 Scale: 1:300
 Date: December 2021

Complied in: 6479
 File: 6479
 Referred: Instructions

DP 538206

DP 40175
1

DP 315665
3

DP 336425
2

DP 32230
15

DP 32230
14

DP 32230
11

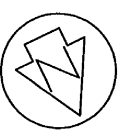

DP 188206
1

DP 480614
3

COMMON PROPERTY

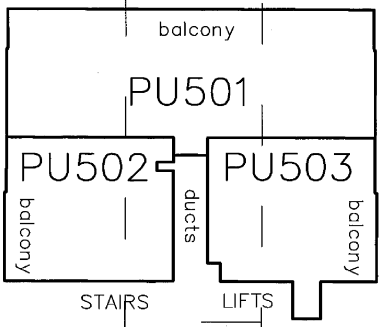

FDU 1B

FDU 2C

FIFTH FLOOR PLAN

SHEET 8/9

LAND DISTRICT NORTH AUCKLAND
 DATASET TYPE SURVEYED
 DATUM GEODETIC 2000

PLAN OF UNIT REDEVELOPMENT
 & SECOND STAGE ON LOT 8 DP 480614

TERRITORIAL AUTHORITY Auckland Council
 Surveyed by HAMPSON & ASSOCIATES LTD
 Scale 1:300 Date December 2021

Comprised in
 File 6479
 Received Instructions

DP 538206

COMMON
PROPERTY

FIFTH FLOOR
FOURTH FLOOR
THIRD FLOOR
SECOND FLOOR
FIRST FLOOR
GROUND FLOOR

COMMON
PROPERTY

PU501		PU503	
PU401		PU403	
PU301		PU303	
PU201		PU203	
PU101		PU103	
court -yard PU 1G		PU 3G	

LIFTS

COMMON
PROPERTY

SECTION B-B'

FDU 1B

FDU 2C

COMMON
PROPERTY

FIFTH FLOOR
FOURTH FLOOR
THIRD FLOOR
SECOND FLOOR
FIRST FLOOR
GROUND FLOOR

COMMON
PROPERTY

PU501		PU502	
PU402		PU404	
PU302		PU304	
PU202		PU204	
PU102		PU104	
court -yard PU 2G		PU 4G	

LIFTS

FDU 1B

FDU 2C

COMMON
PROPERTY

SECTION A-A'

SHEET 9/9

LAND DISTRICT NORTH AUCKLAND
DATASET TYPE SURVEYED
DATUM GEODETIC 2000

PLAN OF UNIT REDEVELOPMENT
& SECOND STAGE ON LOT 8 DP 480614

TERRITORIAL AUTHORITY Auckland Council
Surveyed by HAMPSON & ASSOCIATES LTD
Scale 1:200 Date December 2021

Comprised in
File Received 6479
Instructions

DP 538206

Schedule / Memorandum

Land Registration District

North Auckland

Plan Number

DP 538206

Territorial Authority (the Council)

Auckland

Schedule of Existing Easements in Gross

Purpose	Shown	Servient Tenement (Burdened Land)	Document
Right to convey Electricity	A & V	Lot 8 DP 480614	12065872.1
Right to convey Telecommunications	A	Lot 8 DP 480614	12065872.2

Land Covenant in Easement Instrument 10053825.9

Land Covenant in Easement Instrument 10157293.2