

Crown Pastoral Land Tenure Review

**Lease name : BEAUMONT STATION
- OTAGO**

Lease number : PO 362

Land Status Report

This report and attachments results from a pre-Tenure Review assessment of the pastoral lease for the purpose of confirming land available for Tenure Review and any issues, rights or obligations attaching to it. The information is gathered from files and other sources available to the LINZ contractor.

Part of the information relates to research on the status of the land, resulting in a Status Report that is signed off by a LINZ approving officer. The remainder of the information is not analysed for relevancy or possible action until required, and LINZ does not guarantee its accuracy or completeness as presented.

The report attached is released under the Official Information Act 1982.

December 09

LAND STATUS ADDENDUM REPORT**Prepared in Accordance with LINZS45000****Beaumont Station - Otago**

File Ref: S09026 Beaumont Station - Otago	Submission No:	Submission Date: 20 May 2009
-----------------------------------------------------	-----------------------	-------------------------------------

Office of Agent: Cromwell	Date sent to LINZ: 22 May 2009	LINZ Case No:
----------------------------------	---------------------------------------	----------------------

1. Details of Lease

Lease Name:	Beaumont Station - Otago
Lease No:	PO 362
Location:	Otago
Lessee:	Beaumont Station Lintied
Land District:	Otago
CIR Reference:	OT338/21 - Lease under s83 land Act 1948
Area:	21137.3516 hectares (subject to survey)
Tenure Review Status:	Not in tenure review.

2. Background Information

This report has been prepared on the instruction of Land Information New Zealand in terms of the Statement of Work dated 7 April 2009 and is undertaken for the purpose of updating the current Land Status Plan for Beaumont Station - Otago. This assessment has been undertaken in accordance with the requirements of LINZS45000: Standard to Determine Authority to Act and Record Crown Land.

Where changes to the Land Status Report have been identified, the relevant changes and supporting documentation are attached to this report. In this instance the Land Status Plan has also been updated to reflect the changes made.

Any changes identified from our review of the Land Status Report shall form an addendum to the report dated 17 June 2002. A new Land Status Report has not been prepared.

Where no changes to the Land Status Report have been identified, the Land Status Plan has simply been updated to comply with the *Drawing Specification for Pastoral Land Status Plans* in this instance the plan has been based on the Land Status Report dated 17 June 2002.

3. Land Status Report

Property:	BEAUMONT STATION - OTAGO
Lease Reference:	P 362
Land District:	Otago
Legal Description:	Part Run 656, Run 658, Run 814, Run 815 and Run 816 and Sections 33 and 35 SO 22593.
CIR Reference:	OT338/21
Area:	21137.3516 ha (subject to survey)
Status:	Crown Land subject to the Land Act 1948
Variations/Changes to Land Status	to Nil

4. Discussion

The land status report for Beaumont Station - Otago, as prepared on 17 June 2002, (attached as Appendix 3) by Opus International Consultants, was used as a basis for the preparation of this amended status plan. Verification of the data used in this initial report has been undertaken and an investigation of transactions registered against Computer Interest Register OT338/21 since the completion of the initial report has also been completed.

Since the last Land Status Report, Exploration Permit No. 5011169.1 to Central Otago Goldfields Mining Limited expired on the 10 October 2005. This has been updated on the Computer Interest Register OT338/21.

5. Reference Material

Computer Freehold Registers used in the determination of the status of Beaumont Station - Otago are attached in Appendix 2.

6. Recommendation

That the land depicted on the attached plan in Appendix 1 be accepted as having status as Crown Land subject to the Land Act 1948.

That the land depicted on the attached plan in Appendix 1 be accepted as being subject to Lease P 0362 as contained in Computer Interest Register OT338/21.

7. Appendices

1. Land Status Plan
2. Computer Interest and Freehold Registers
3. 2002 Status Report

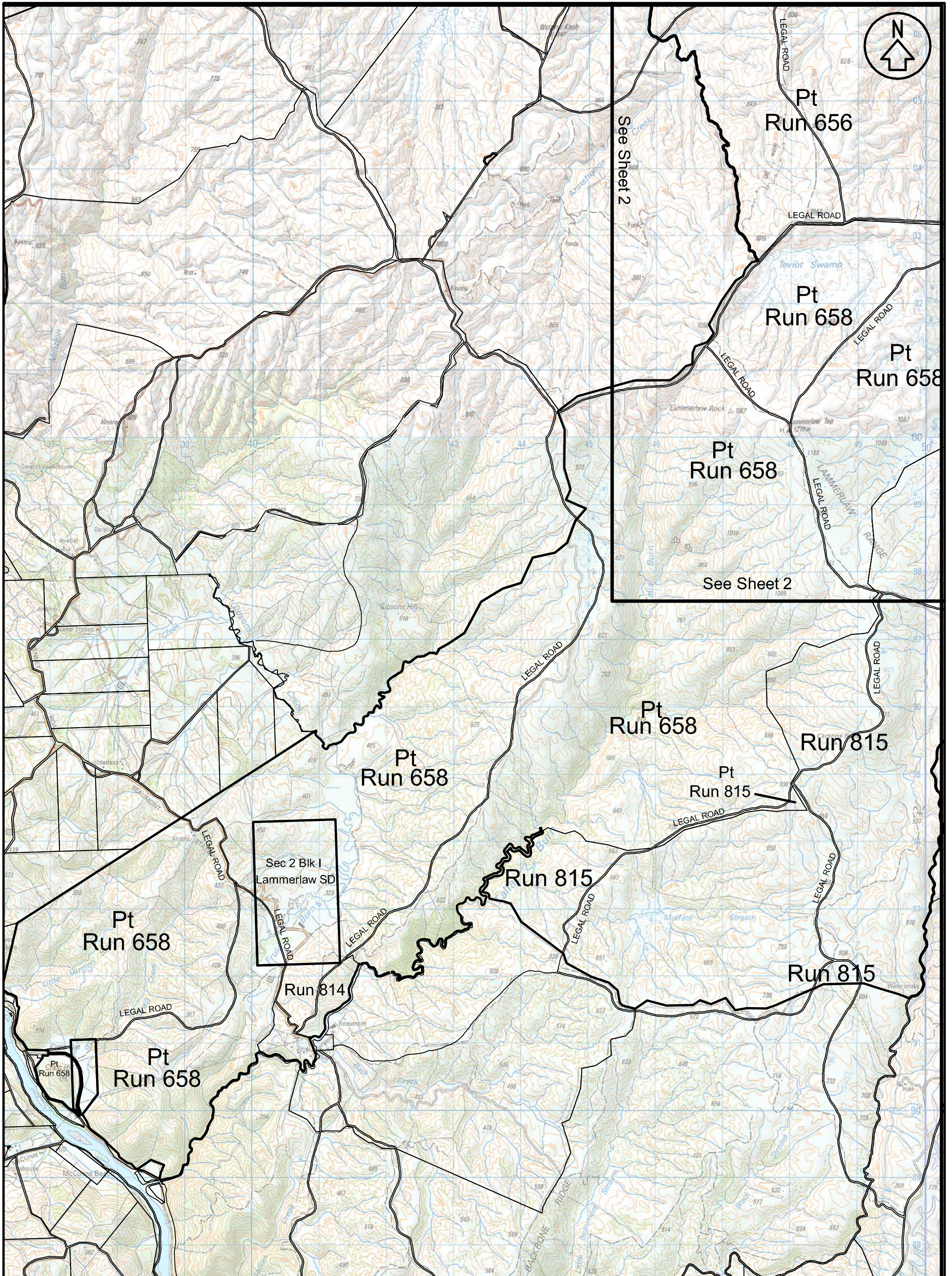

btw south
 . surveyors
 . planners
 . engineers
 . land & g/s services

Unit 7, Cromtrade, 2 McNully Road
 P.O. Box 302, CROMWELL 9342
 Ph (03) 445 0782 Fax (03) 445 0194 Ph 0800 023 3148
 Web www.btw.co.nz

GENERAL NOTES
 1. Coordinates in terms of:
 New Zealand Map Grid, Geodetic Datum 1949.
 2. Sources: LINZ Topographic NZMS 260
 LINZ Cadastral Data 2009

DRAWING No: S09026_2_1_A

NO	1	2	3	4	5
DATE	20/05/2009				
PREPARED BY	MP				
APPR					

REVISIONS
 Excludes all legal roads and Marginal strips if any.

LINZ Lease file Ref:
 Run Name: Beaumont Station - Otago
 Lease Registration Reference: PO 362
 Land District: Otago

SHEET 1 OF 2

TITLE
BEAUMONT STATION

0 km 1 2
 SCALE 1:50000

ORIGINAL SIZE
A3

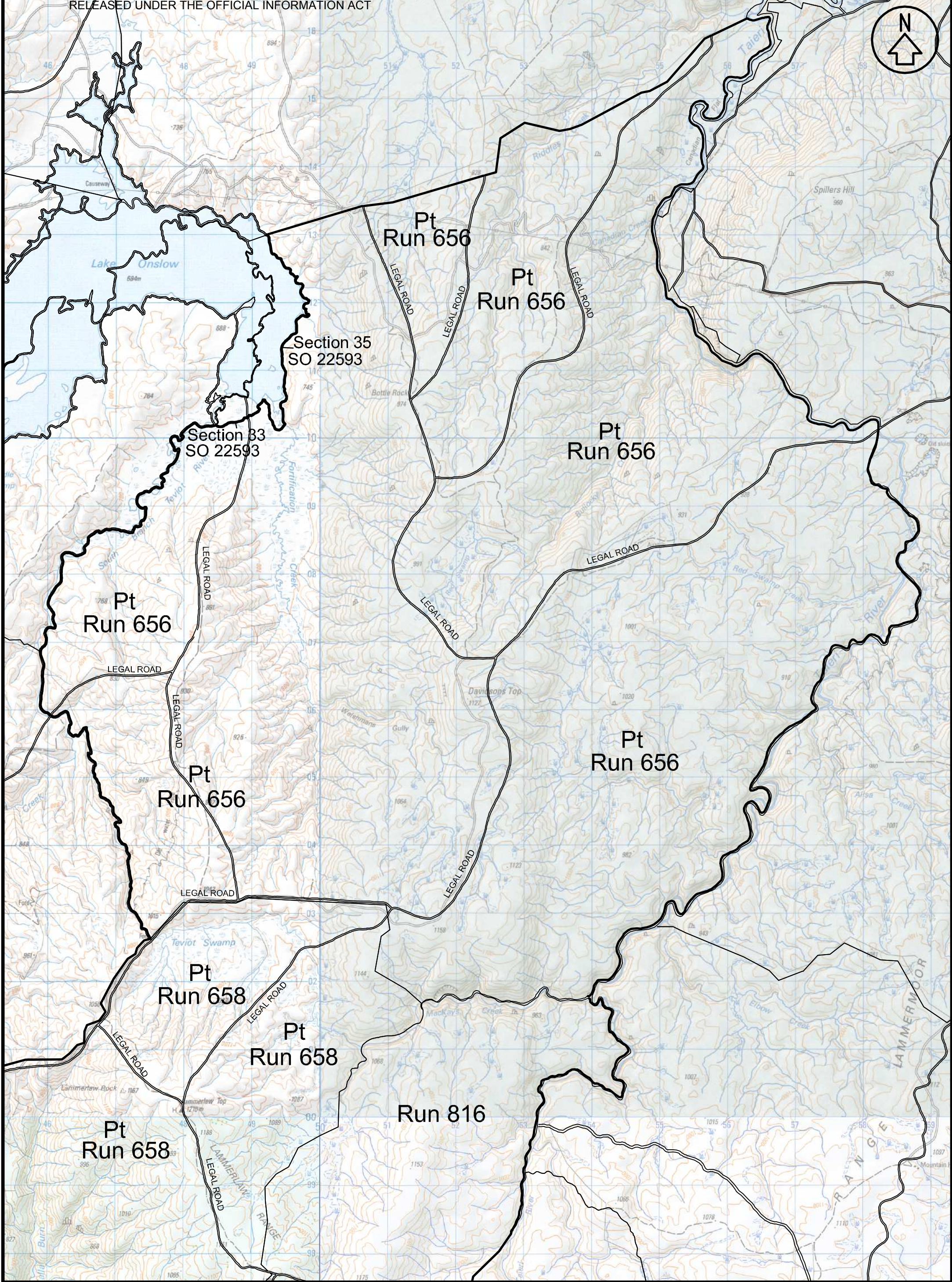

btw south
 . surveyors
 . planners
 . engineers
 . land & g+s services

Unit 7, Cromtrade, 2 McNully Road
 P.O. Box 302, CROMWELL 9342
 Ph (03) 445 0782 Fax (03) 445 0194
 Web www.btwsouth.co.nz

GENERAL NOTES
 1. Coordinates in terms of:
 New Zealand Map Grid, Geodetic Datum 1949.
 2. Sources: LINZ Topographic NZMS 260
 LINZ Cadastral Data 2009

NO	1	2	3	4	5
DATE	20/06/2009				
PREPARED BY	MP				
APPR					

REVISIONS
 Excludes all legal roads and Marginal strips if any.

LINZ Lease file Ref:
 Run Name: Beaumont Station - Otago
 Lease Registration Reference: PO 362
 Land District: Otago

SHEET 2 OF 2

TITLE
BEAUMONT STATION

1 0 km 1 2
 SCALE 1:50000

ORIGINAL SIZE
A3



**COMPUTER INTEREST REGISTER
UNDER LAND TRANSFER ACT 1952**



Search Copy

Identifier OT338/21
Land Registration District Otago
Date Registered 05 December 1952 02:10 pm

Part-Cancelled

Prior References
 OT337/150

Type	Lease under s83 Land Act 1948		
Area	27901.8610 hectares more or less	Term	Thirty-three years commencing on the first day of July 1951 and extending for a further thirty-three years commencing 1 July 1984

Legal Description Run 656 and Run 657 and Run 658 and Run 814 and Run 815 and Run 816 and Section 32-35 Survey Office Plan 22593 and Section 3 Block I Lammerlaw Survey District and Section 15 Block VII Beaumont Survey District

Proprietors
 Beaumont Station Limited

Interests

- 390698 Surrender of within Lease as to Section 15 Block VII Beaumont Survey District and Section 3 Block I Lammerlaw Survey District - CT OT5A/804 issued - 13.9.1972 at 2:23 pm
- 617822.3 New Appellation - Part Run 657 (2300 hectares) is now known as Run 815 - 9.7.1984 at 9:15 am
- 617822.4 New Appellation - Part Run 657 (1500 hectares) is now known as Run 816 - 9.7.1984 at 9:15 am
- 617822.2 New Appellation - Part Run 657 (130 hectares) is now known as Run 814 - 9.7.1984 at 9:15 am
- 716317 New Appellation - Parts Run 656 are now known as Sections 32-35 SO 22593 - 18.11.1988 at 9:17 am
- 788865.3 Surrender of the within Lease as to Sections 32 and 34 SO 22593 - 25.9.1991 at 9:25 am
- 826713 Memorandum renewing the term of the within Lease for a further term of 33 years commencing 1.7.1984 - 29.3.1993 at 10:13 am
- 870608 Transfer creating the following easements - 28.11.1994 at 9:38 am

Type	Servient Tenement	Easement Area	Dominant Tenement	Statutory Restriction
Convey water	Run 815 - herein	A-B DP 22125	Part Section 51 Block VIII Waipori Survey District - CT OT2C/1162	N/A

- 902992.2 Mortgage to Bank of New Zealand - 7.3.1996 at 10:12 am
- 5022833.1 Variation of the within Lease - 8.2.2001 at 9:00 am

52757 acs

UNIVALENT METRIC

EA IS 21,350,000 ha

RR. 788865/3- 131-0000 ha (SECS 32 & 34)

21,219,000 ha

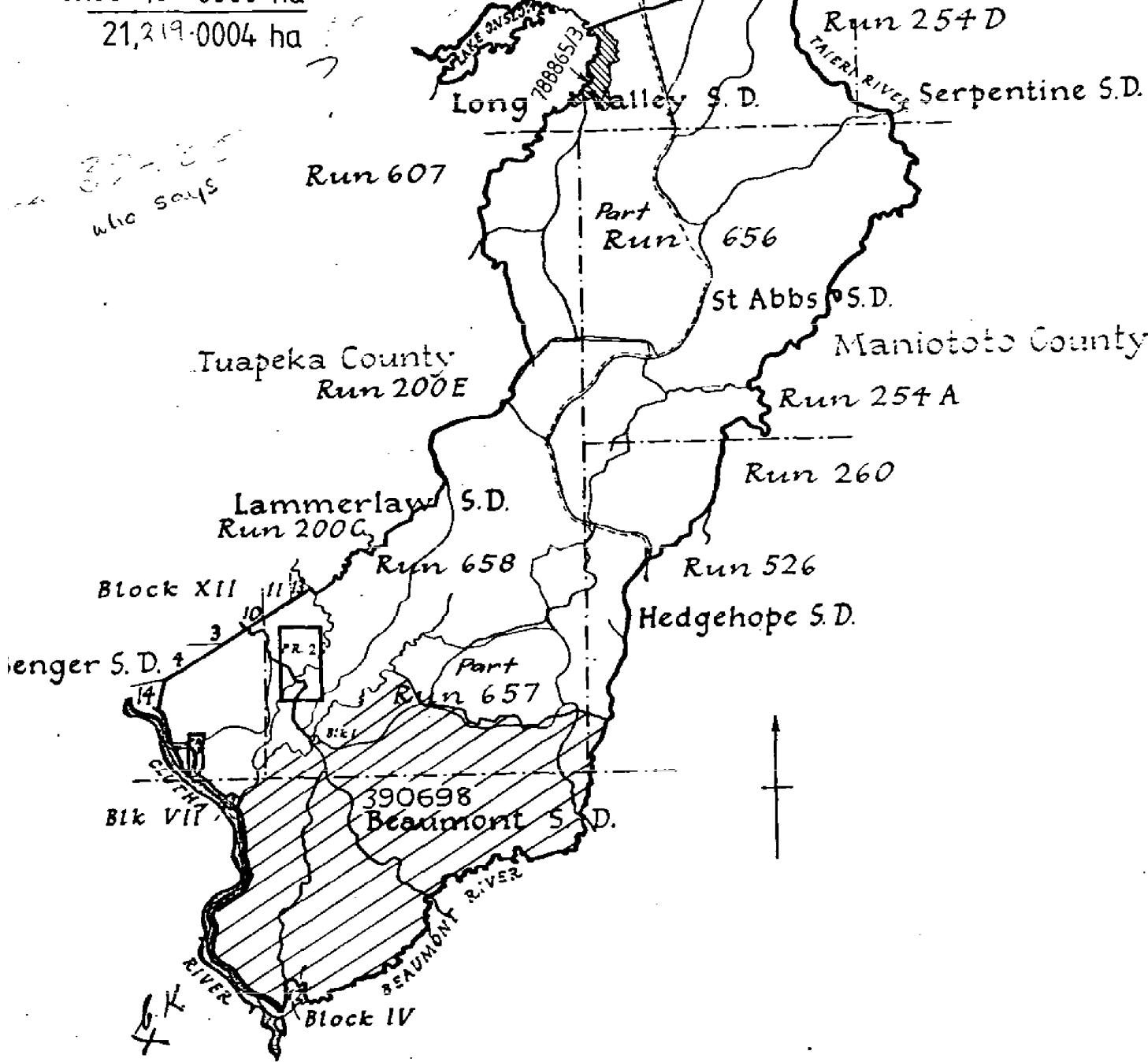

who says

Tuapeka County

Maniototo County

Wenger S.D.

Blk VII

390698
Beaumont S.D.

Block IV

X-K

52757 acs

UNIVALENT METRIC

EA IS 21,350,000 ha

RR. 788865/3- 131-0000 ha (SECS 32 & 34)

21,219,000 ha

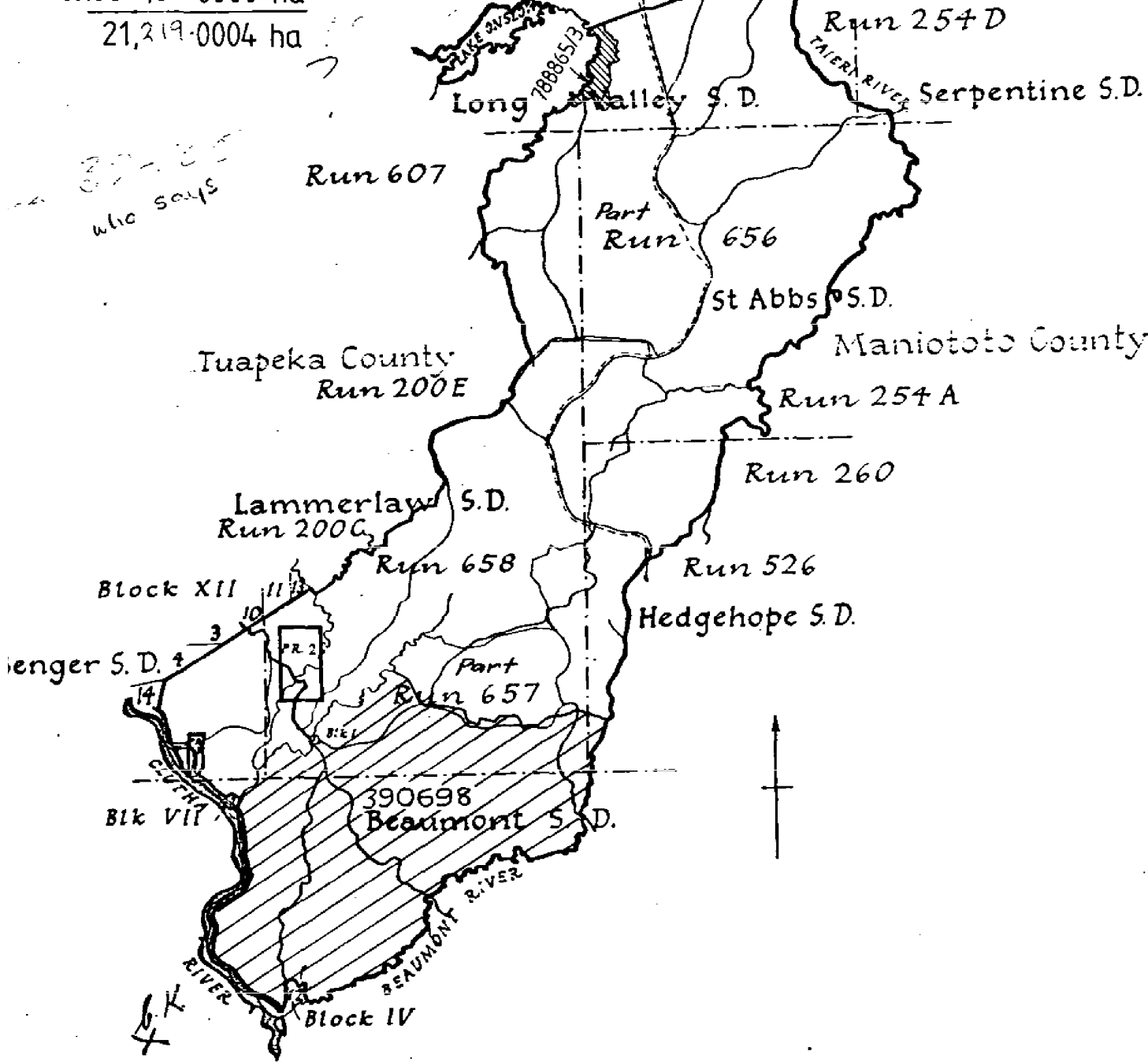

who says

Blk VII

4-K

LAND STATUS ADDENDUM REPORT

CERTIFICATION

Beaumont Station - Otago

File Ref: S09026 Beaumont Station - Otago	Submission No:	Submission Date: 20 May 2009
-----------------------------------------------------	-----------------------	-------------------------------------

Office of Agent: Cromwell	Date sent to LINZ: 22 May 2009	LINZ Case No:
----------------------------------	---------------------------------------	----------------------

CERTIFICATION

This report to the Commissioner of Crown Lands, or his delegate, recommends the acceptance of the Land Status Addendum Report for Beaumont Station Otago Land District as being Crown Land subject to the Land Act 1948.

1. The Land Status Addendum Report enclosed has been prepared by BTW South Limited.
2. Changes have been identified as part of the review carried out by BTW South Ltd. These changes are recorded in the Land Status Addendum Report.
3. The updated Land Status Plan attached to the Addendum Report has been prepared based on the changes identified and recorded in the Addendum Report.
4. I, Kate Louise Scott of BTW South Limited, certify that the status report addendum enclosed for certification as prepared by BTW South has been reviewed, and is in order for signature.
5. In giving this certification I, Kate Louise Scott of BTW South Limited, undertake that the status report addendum has been completed in compliance with all relevant policy instructions and Standards and Guidelines.



.....
Kate Scott
BTW South Ltd