

## **Crown Pastoral Land Tenure Review**

**Lease name : BEAUMONT STATION  
- SOUTHLAND**

**Lease number : PS 091**

## **Due Diligence Report (including Status Report) - Part 3**

This report and attachments results from a pre-Tenure Review assessment of the pastoral lease for the purpose of confirming land available for Tenure Review and any issues, rights or obligations attaching to it. The information is gathered from files and other sources available to the LINZ contractor.

Part of the information relates to research on the status of the land, resulting in a Status Report that is signed off by a LINZ approving officer. The remainder of the information is not analysed for relevancy or possible action until required, and LINZ does not guarantee its accuracy or completeness as presented.

The report attached is released under the Official Information Act 1982.

**April 09**

Fig. C.

GRAZING CHART - DEBENTON STATION  
1978

Block name	Area (ha)	M	J	J	A	S	O	N	D	J	F	M	A	
Home paddocks	1923													
Venison	20													
3rd Morleys	95													
1st Morleys	234													
2nd Morleys	1,105													
Windswept } Wairaki } Letham }	1,250													
Barretts	704													
Mistake	1,491													

KEY:

- ===== Ewes.
- Hoggets.
- ..... Cows.
- ..... Young cattle.

- T = Topping.
- L = Lambing.
- S = Shearing.

.06 Management and Landuse

.06.1 Landuse

Stock Wintered 1978

	<u>Number</u>		<u>Conversion factor</u>		<u>Stock Units</u>
Ewes	8,600	x	1.0	=	8,600
Hoggets	2,300	x	0.6	=	1,380
Other Sheep	200	x	0.9	=	180
Cows	570	x	6.0	=	3,420
Yearlings	346	x	4.0	=	1,384
Calves	270	x	3.5	=	945
Others	22	x	5.0	=	110
					<u>16,019</u>

Subdivision 1978 (See map in pocket at rear).

	<u>ha</u>
Freehold - 42 paddocks	1923
Venison Block (Cultivated)	20
3rd Morleys (Cultivated)	95
1st Morleys	234
2nd Morleys	1105 Partly faced
Windswept	692
Wairaki	444 } Not fenced
Letham	114 }
Barretts	704 Partly fenced only
Mistake (Bog)	378
Mistake (Tussock)	1113 } Not fenced
<b>TOTAL</b>	<u>6822</u>

Approximately two thirds of the freehold land has been cultivated and is utilized for intensive grazing, while another sixth has been improved by aerial oversowing and topdressing. Some of the remainder is in pine forest (90ha). The leasehold run is used in conjunction with the freehold as an extensive grazing venture.

.06.2 Management

The utilization of the blocks and freehold paddocks area is illustrated on the accompanying grazing chart. (Fig C) It emphasizes the fact that little grazing control is possible at present on the leasehold blocks. At present there is a change taking place from the past Romney cross breed of sheep to Perendale which allow for easier care and lower labour requirements.

Approximately 80ha of turnips and swedes for winter feed are produced annually, these crops are grown as part of the pasture renewal programme. In addition some new development out of tussock on the southern run country has taken place recently as follows:-

*[Handwritten signatures and initials]*  
 M.V.D.  
 \$

<u>Block</u>	<u>Years under cultivation</u>
Morley No. 3 (95ha)	1974 - 1976
Venison Block (20ha)	1976 - 1978

Some 10-11,000 bales of hay are made annually for winter feed.

Stock performance is improving as the following figures help to show:-

Lambing Percent

<u>Year</u>	<u>%</u>
Pre - 1973 average	65% (Approx.)
1974	72%
1975	76%
1976	78%
1977	{ 82% (Overall)
	{ 91% (Perendales)

Calving Percent

1977	80%
------	-----

2. CONSERVATION AND WORKS

.01 Problems

.01.1 Problems for the runholder

- (a) Loss of potential grazing due to wind and sheet erosion in the Elbow Creek area.
- (b) Inadequate fencing for stock control in the northern run country.
- (c) Limited finance available for development.
- (d) Scrub and tutu growth restricts the full grazing use of the larger tussock blocks.

.01.2 Problems from a soil and water conservation point of view

- (a) Loss of a national resource in the continued erosion of soil in the Elbow Creek area.
- (b) The need to prevent the possible deterioration of present swamp and tussock vegetation which has water conservation and flood amelioration value in the Aparima headwaters.
- (c) The need to prevent soil loss which may accompany land development on areas susceptible to wind and sheet erosion. i.e. to encourage the wise management of the land in accordance with its capability.

*[Handwritten signatures and initials]*  
M.V.D.

.02 Proposed Programme

The planned first 5 year programme will deal with the two major problems facing both the run-holder and the soil conservator.

Problems .01.1(a) and .01.2 (b) Elbow Creek Eroded Area  
Job Numbers : 1, 2, 3, 5, 5 and 6

It is proposed to fence off the majority of the class VIIe5 unit in this area to allow recuperative spelling for an initial period of five years (fence D-C-F). As finance becomes available this area of 336ha will then be oversown and topdressed. Fencing here would be subsidised at a rate of 2:1 as a protection fence. Provision will be made to compensate for loss of grazing by subsidised topdressing and oversowing on 177ha on the southern freehold part of the property. (Subsidy 1:1). Provision for offsite grazing is calculated on the following basis:-

<u>Offsite Calculation</u>			
<u>Present carrying capacity of area to be spelled</u>			
1. <u>Area at present grazed</u>			
Windswept Block		692	
Wairaki Block		444	
Barnetts Block		704	
Leatham Block		114	
			1,954ha
2. <u>Stock Carried</u>			
8,600 ewes (8,600 s.u.)	4 months	=	2,878 su/yr
570 cows (3,400 s.u.)	4 months	=	1,140 su/yr
			4,018 su/yr
3. <u>Carrying Capacity</u>			
(a) Area	=	$\frac{4018}{1954}$	= 2.06 su/ha/yr
(b) Area to be spelled	=	336ha	(Windswept 2 - Elbow Cr)
(c) 336ha @ 2.06 su/ha/yr	=	692	su/yr
<u>Provision for displaced stock</u>			
(a) Area to be A.O.S.T.D. at present carries approximately			2.1 su/ha

*[Handwritten signatures and initials]*

- (b) Assume A.O.S.T.D. will increase, carrying capacity by 3.9 su/ha/yr ( = 6 su/ha total )
- (c) Therefore will need 177 ha of A.O.S.T.D.

In addition the plan allows for subsidised erosion control oversowing and topdressing (2:1) of the smaller areas of class VIIe5 and associated VIe5 units totalling 100ha to the west of Elbow Creek along the Mt. Linton Boundary. This method of treatment on the wind and sheet eroded areas has been demonstrated to be effective on Mt. Linton where a similar problem area was oversown and topdressed without subsidy. Control of grazing on the area is of course essential, and a subsidised erosion control fence (1:1) will be constructed to fence this area off prior to oversowing. (Fence A-B-E). The area will also serve as a demonstration to encourage similar treatment of the spelled block.

Part of each of the two subsidised fences will be constructed in the first year of the plan (lengths A-B and C-D) so that a link fence between them can be constructed without subsidy (length B-C). This will enable early subdivision of the major unfenced run block into two manageable units.

Problems .01.1 (b) and .01.2 (b) Inadequate Stock Control in the Northern Run Country and Water Conservation in the Aparima Headwaters - Job No. 7

At present the bog portion of Mistake block is not well utilized and is really a problem area for management.

Also, as shown previously, this area is an important area for water conservation. Under the plan it is proposed to fence off and retire from grazing approximately 312ha of class VIIIw bog and associated class VIs, IVw, and IVe land situated at the northern end of the Mistake block between the Aparima river and Pleasant Creek. (Fence G-H). The fence so constructed will become the northern boundary of the property and therefore assist in stock control in that area. Besides the above reasons for retirement of the area the following factors also support its removal from pastoral use:-

- (1) The retired area will form a very important part of the berm areas to be created under the proposed Aparima Catchment Control Scheme (See Fig D)\*. Written support for the proposed retirement is already obtained from the comments on the environmental impact assessment prepared for the Aparima C.C.S. The following organizations have so far expressed strong support for the retirement of bogs and other water conservation areas in the Aparima Catchment.

- (a) New Zealand Forest Service
- (b) Nature Conservation Council
- (c) Southland Acclimatization Society

*[Handwritten signature]*  
*[Handwritten initials]*  
 \* See pocket at rear

PROPOSED 1st 5 YEAR PROGRAMME

YEAR	JOB NO.	WORK	ESTIMATE (PLUS 10% CONTINGENCIES)	PLUS 30% SERVICE CHARGE	SUBSIDY RATE	SUBSIDY	LOCAL SHARE	NET RETURN TO RUNHOLDER
1	1	Protection fence C - D	3km @ \$2,000 = \$ 6,000 + 10% = \$ 6,600	\$ 8,600	2:1	\$ 5,733	\$ 2,867	56%
	2a	Erosion Control fence A - B	0.8km @ \$2,000 = \$ 1,600 + 10% = \$ 1,760	\$ 2,290	1:1	\$ 1,145	\$ 1,145	35%
	2b	Subdivision fence B - C	0.9km @ \$2,000 = \$ 1,800 + 10% = \$ 2,000				\$ 2,000	Nil
				Yr 1= \$10,890		\$ 6,878	\$ 6,012	
2	3	A.O.S.T.D. (off- site on freehold land)	177ha @ \$76 = \$13,452 + 10% = \$14,797	Yr 2= \$19,236	1:1	\$ 9,618	\$ 9,618	35%
3	4	Protection fence C - F	3.5km @ \$2,000 = \$ 7,000 + 10% = \$ 7,700	\$10,000	2:1	\$ 6,667	\$ 3,333	56%
	5	Erosion control fence B - E	2km @ \$2,000 = \$ 4,000 + 10% = \$ 4,400	\$ 5,720	1:1	\$ 2,860	\$ 2,860	35%
				Yr 3= \$15,720		\$ 9,527	\$ 6,193	
4	6	A.O.S.T.D. (Erosion Control) on block ABE	100ha @ \$76 = \$ 7,600 + 10% = \$ 8,360	Yr 4= \$10,868	2:1	\$ 7,246	\$ 3,622	56%
5	7	Berm retirement fence G - H	6.5km @ \$2,000 = \$13,000 + 10% = \$14,300	Yr 5= \$18,600	Grant	\$18,600		100%
			TOTALS	\$59,917	\$75,314	\$51,869	\$25,445	

Local Share of subsidised works: \$23,445

- (2) Significant areas of wind and sheet erosion exist on the terraces where bogs are absent.
- (3) The floodplain of the Aparima is a danger to stock because of the frequency of high floods.
- (4) The river bank vegetation in this area should be preserved at a maximum to help prevent bank scour and addition of detritus to the downstream Aparima main channel.
- (5) The area to be retired is the main route by which access is gained to Eastern Takitimu mountains and State Forest, it is used by recreationalists at present and this can be expected to increase. A summer - use four-wheel drive track traverses the area as far up as the Waterloo-burn junction.
- (6) The bogs which form 44% of the area to be retired are good samples of Southland's unique bog resource and may in future yield significant scientific information especially with regard to palaeoclimates and ecology.
- (7) This area's recommended optimum long term use is retirement in the proposed Wallace County Scheme.

It is proposed to subsidise the fence G-H at a total grant because, although the fence could be treated as a normal berm fence at 2:1, it does involve the loss of a significant area of grazing. It is considered that this grazing loss is compensated for by the provision of a grant fence. This may be shown as follows:-

Offsite Calculation

(a) Estimate of grazing lost from area to be retired

<u>Land Class</u>	<u>Area (ha)</u>	<u>Estimated Carrying Capacity</u>	<u>No. Carried su/yr</u>
VIIIw	150	0.2	30
VIe10	19	1.0	19
VI s	25	0.5	13
IVe1	13	1.0	13
IV s	12	0.5	6
IVw	103	1.0	103
	<u>322</u>		<u>184</u>

(b) Estimate of Cost to replace 184 s.u.

Say A.O.S.T.D. will improve adjacent class VI land by 2.5 s.u./ha/yr. Therefore would require 77 ha of A.O.S.T.D. at \$76.00 per ha. = \$5,850

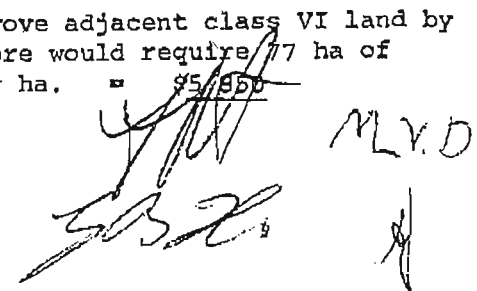
  
 M.V.D.



(c)	<u>Estimate of Cost to Runholder of Building the Fence at a subsidy of 2:1</u>		
	.6.5km fence @ \$2,000	=	\$13,000
	.Plus 10% Contingencies and 30% Service Charge	=	\$18,600
	.Subsidy at 2:1	=	\$12,400
	.Runholder's share	=	\$ 6,200
(d)	The runholder's share in the fence cost (\$6,200) is close to the cost of providing compensation for potential grazing loss. (\$5,850)		

Figure E Summarizes the five year programme under which the above works will be done while Fig. F summarizes the costs of the jobs by type of work.

Fig. F. - Summary of Works by Type

Type of Work	Total Cost (10% Contingencies and Service Charge)	Subsidy Rate	Subsidy	Local Share
6.5km Berm retirement fence G-H Job 7	\$18,600	Grant	\$18,600	-
6.5km Protection fence D-C-F Jobs 1 and 4	\$18,600	2:1	\$12,400	\$ 6,200
2.8km Erosion Control fence A-B-E Jobs 2a and 5	\$ 8,010	1:1	\$ 4,005	\$ 4,005
177ha Off-Site A.O.S.T.D. Job 3	\$19,236	1:1	\$ 9,618	\$ 9,618
100ha Erosion Control A.O.S.T.D. Job 6	\$10,868	2:1	\$ 7,246	\$ 3,622
1.9km Sub-division fence B-C Job 26	-	-	-	\$ 2,000
TOTALS:	\$75,314		\$51,869	\$25,445

.03 Proposed Management

The management of the run area proposed for the first five years is illustrated on the accompany grazing chart (Fig. G) it allows for the spelling of the Elbow Creek block. The more adequate sub-division will allow the blocks to be managed in such a way that vegetation conservation and utilization is maximized and blocks with

*[Handwritten signature]*  
M.V.D.

erosion problems will be spelled during critical periods. The smaller blocks at the southern end will be in a good position for improvement by aerial topdressing and oversowing and it is envisaged that a programme of such improvement will follow the 5 year plan.

.04 Specifications and unit costs

.04.1 Fences

Fences are to be of the following minimum standard, subsidy will be paid out on the cost of erecting such a fence on Beaumont Station. The fence may be of a better standard but extra costs will be borne by the runholder.

Per 20m (1 Chain)

- One Tenth Strainer
- 4 Wooden posts (11-14cm top dia.)
- 1 x No. 8g. plain wire
- 6 x 12 $\frac{1}{2}$ g. H.T. plain wire
- 20 Tie Wire or 12 cyclone droppers

Tiedowns, permanent strainer etc. Iron standards may be used in place of wooden posts on rocky ground.

Estimate of Costs

	<u>per km</u>	<u>Per 20m (1 chain)</u>
Materials	\$ 900	\$18.00
Transport & laying out	\$ 400	\$ 8.00
Labour	\$ 700	\$14.00
	<u>\$2,000</u>	<u>\$40.00</u>

.04.2 Aerial Topdressing and Oversowing

Seed

<u>Variety</u>	<u>Quantity/ha</u>	<u>Unit Cost/kg</u>	<u>Cost/ha</u>
White Clover (Prill coated)	4kg	\$2.10	\$ 8.40
Red or Alsike Clover	2kg	\$2.40	\$ 4.80
Cocksfoot	4kg	\$3.00	\$12.00
R. Ryegrass (Sunny only)	4kg	\$1.00	\$ 4.00
Dogs tail (sunny) or Timothy (dark)	0.5kg	\$2.40	\$ 1.20
	<u>14.5kg</u>		<u>\$30.00</u>

Superphosphate

<u>Type</u>	<u>Quantity/ha</u>	<u>Unit Cost/tonne</u>	<u>Cost/ha</u>
Half strength Molybdenized Superphosphate	500kg (5cwt)	\$45.00	\$22.50

*[Handwritten signatures and initials]*  
 M.V.D.

Fig G

# GRAZING CHAR ~ BEAUMONT STN

End of 1<sup>st</sup> 5 year plan.

Key:   
 ———— ewes   
 ———— hoggets   
 ..... cows   
 ..... Young calf

Block name	Area (ha)	M	J	J	A	S	O	N	D	J	F	M	A	
Home paddocks	1,923	9070 su (M), 1500 su (J), 9070 su (J), 1500 su (A), 3500 su (S), 1500 su (O), 620 su (N), 1000 su (D), 3500 su (J), 1500 su (F), 1500 su (M), 1500 su (A)												
Venison	20	1000 su (J)												
3rd Morleys	95	1300 su (J)												
1st Morleys	234	5000 su (J), 1500 su (D)												
2nd Morleys	1,105	1770 su (J), 1500 su (S), 620 su (O)												
Windswept 1	256	1000 su (J)												
Windswept 2	336	5 YEAR SPELLED.												
Windswept 3	100	1000 su (J), 1000 su (M)												
Muiraki } Letham }	558	2000 su (J), 1500 su (S), 2000 su (M), 1500 su (A)												
Barretts	704	3070 su (J), 2000 su (S), 3070 su (M), 2000 su (A)												
Mistake	1,169	3500 su (J)												
Mistake (bon)	322	RETIRED FROM GRAZING.												

M V D  
 14/10/02

Aerial Spreading

Material	<u>Cost/ha</u>
Seed	\$ 2.00
Super (Less subsidy)	\$16.00
	<u>\$18.00</u>
	<u>Cost/ha</u>
Freight	\$ 5.10
<b>TOTAL COST PER HA:</b>	<b>\$76.00</b>

.05 Economics

Satisfactory development finance is available through the Rural Bank.

.06 Legal Agreement and Conditions

.06.1 The legal agreement binds the runholder to the following Conditions:-

- (A) Maintenance of subsidised fences for the term of the lease or for a period of 50 years after freehold title is obtained.
- (B) Maintenance topdressing (200 kg/ha within 2½ years) on the areas to be A.O.S.T.D.
- (C) 5 year spelling on block F-C-D in the Elbow Creek area.
- (D) Retirement from grazing and removal from the lease of the berm area along the Aparima river, north of fence G-H.
- (E) Retention of the area to be A.O.S.T.D. as part of the offsite benefit, within the area of Beaumont Station for the 5 year spelling period.

.06.2 Status of land which is to be removed from the lease. This land will become a Soil Conservation reserve to be administered by the Catchment Authority for water and soil conservation purposes as allowed for in the S.C.R.C. act 1941 Section 16.

.07 Plan Preparation and Acknowledgements

1. G. Heward, G. Morgan, P. Chapman, W. Tuckey (S.O.B.);

- 16 -

W. Stevenson, L. Thompson (M.O.W. and D.) ;  
A. Mason and R. Elcock (L. & S. Dept.) ;  
L. Simpson (Manager, Beaumont Station) ;  
R. Sworn (Dalgety Limited) ;  
J. Bruce (D.S.I.R.) ;  
M. Scott (Department of Agriculture).

2. References

Mutch A.R. 1973 "Geology of Morley Subdivision"  
N.Z. Geological Survey Bulletin 78

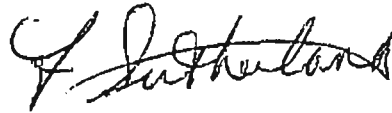

F. Sutherland  
SOIL CONSERVATOR

for:

N.A. McMillan  
CHIEF TECHNICAL OFFICER

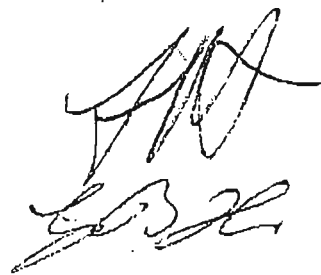

MKD  
Ⓢ

Beaumont Station.

SWCP 22 - Proposed  
soil & water conservation  
programme

Key:

- Run boundary.
- |-| existing fence
- |-| proposed fence
-  proposed AOS+TD

Scale: one inch to one mile

Note: leasehold area only  
is shown

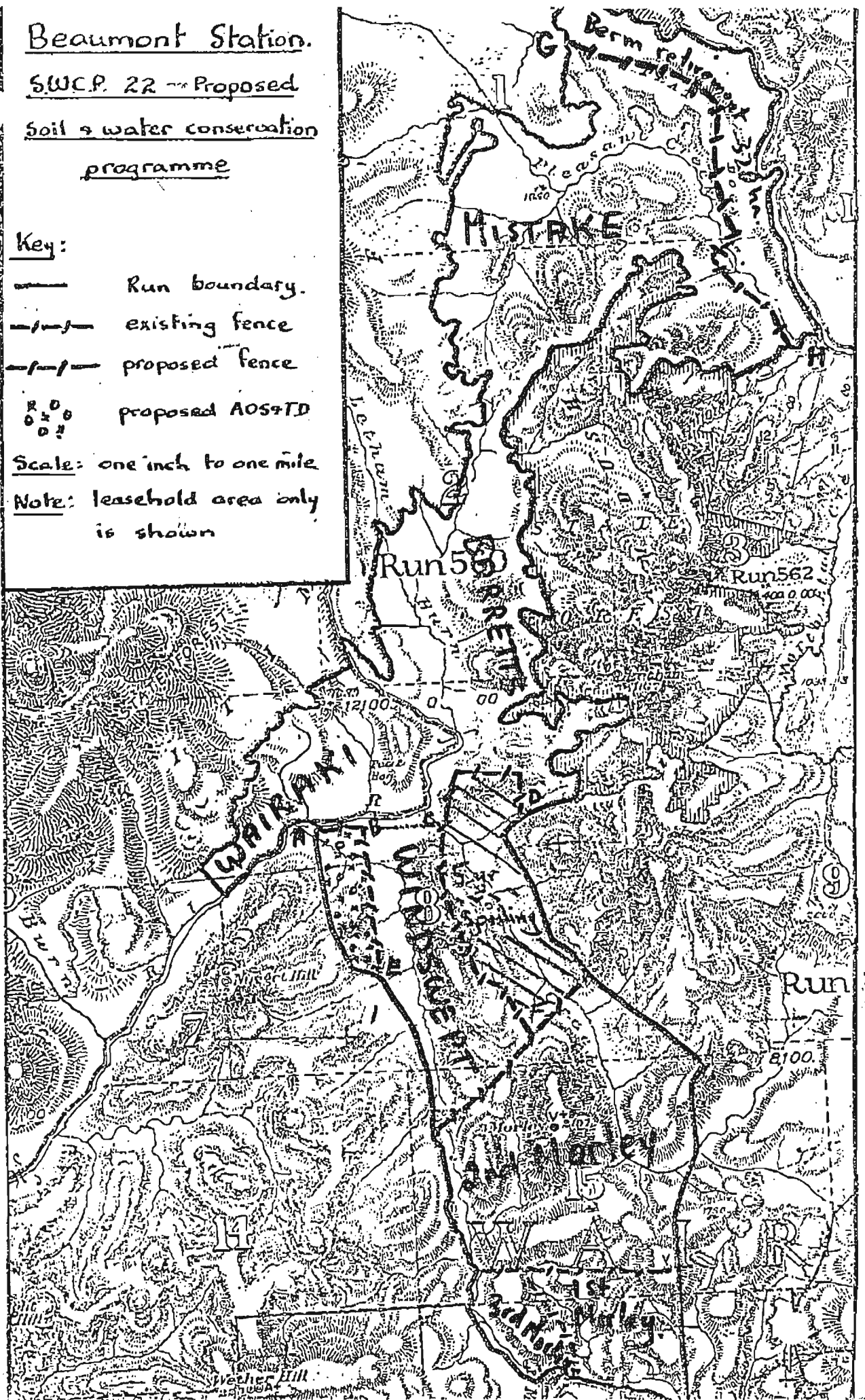

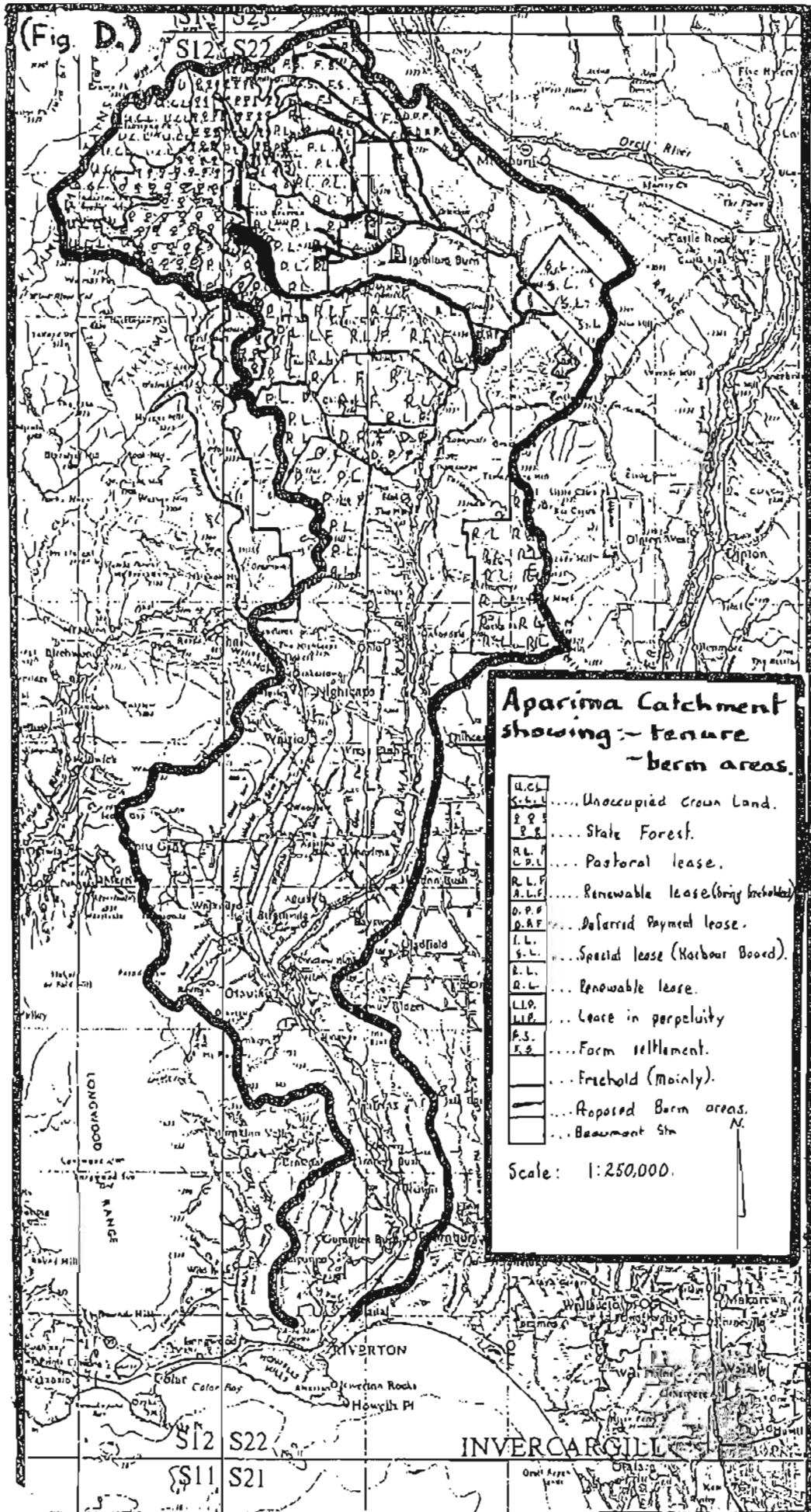



085061 / Discharged as to  
Cs 1 183/645 and 198/143 20.1.1982 at  
2.05 pm *Walter*  
AUC

051308 /  
109/951



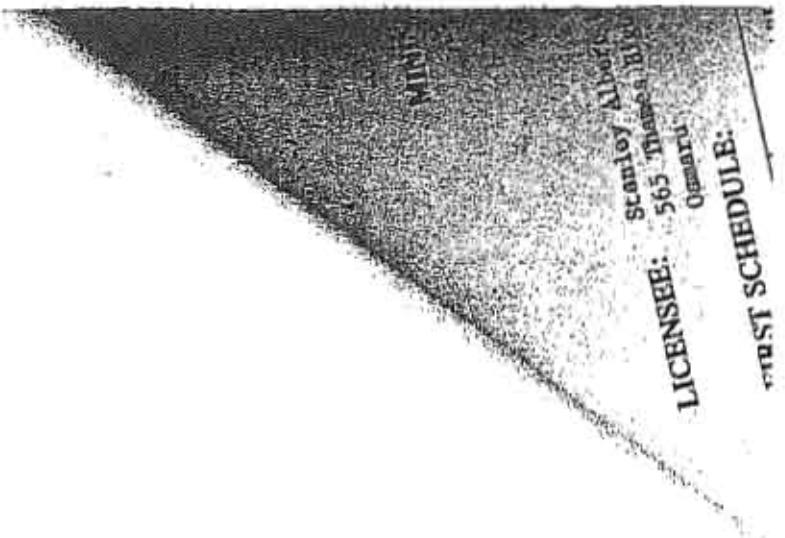

MINI  
Stanley Albert  
565 Thames Bldg  
Oamaru  
LICENSEE:  
TRUST SCHEDULE:

5.0 29.JUL91 183861  
PARTICULARS AND FIELD REGISTER  
LAND REGISTER SOUTH ISLAND  
ASSISTANT REGISTRAR

**COMMERCE**  
MINISTRY OF COMMERCE  
Te Manatū Tauhokohoko

Our Ref: 32 274

21 JUL 1991  
District Land Registrar  
Private Bag  
INVERCARGILL

MINING LICENCE 32 274  
HELD BY WAIKAIA MINING CO LTD

This is to advise that the above licence recorded in your office as 070829.1 has expired on 18 June 1991.

Would you please note your records accordingly.

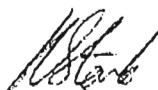
  
H Stark (Miss)  
for General Manager

179 JUL 1991



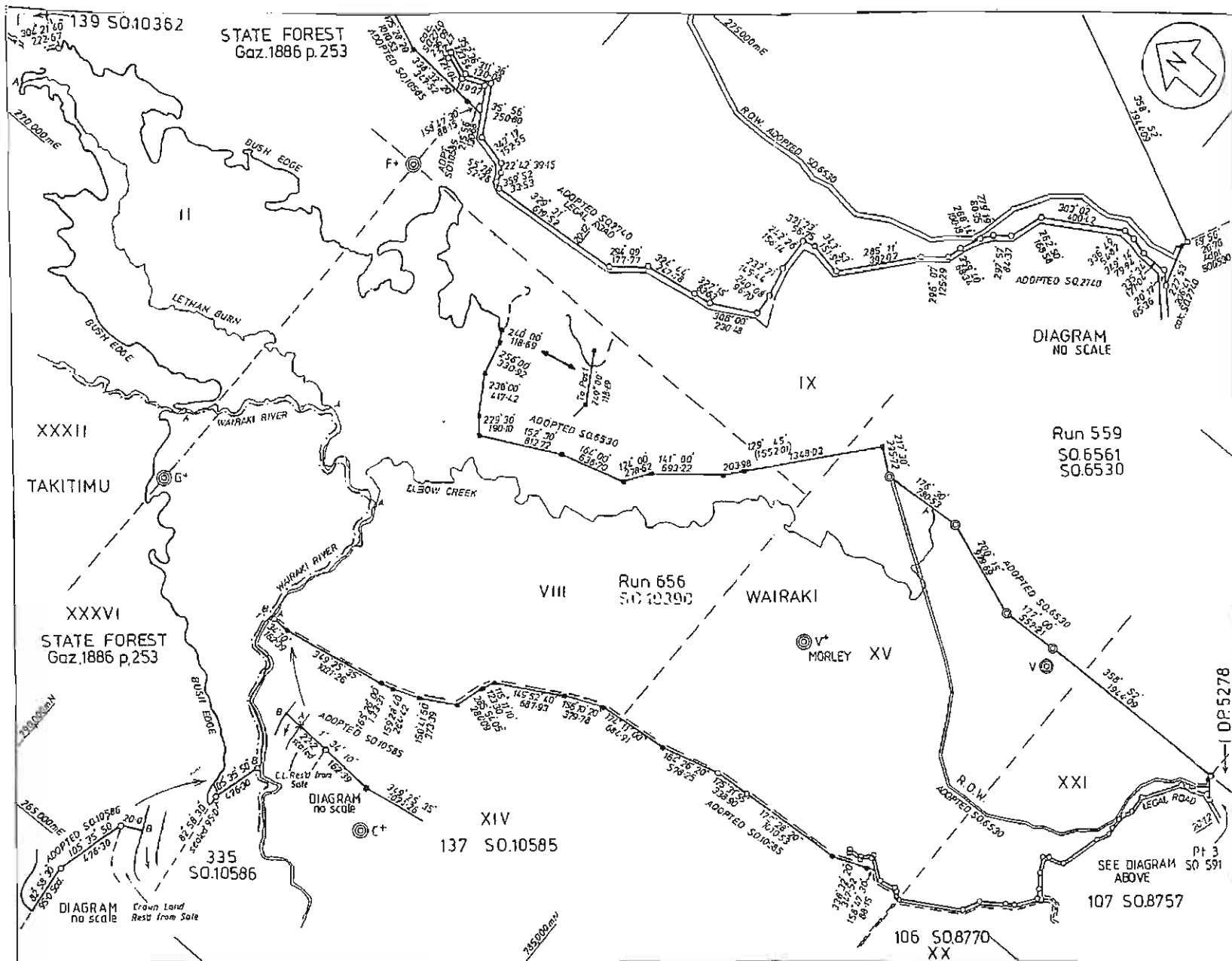

Approvals	
<p><b>NOTE</b> Both sides of the streams marked A-A and the north side of the Wairaki River, marked B-B, are subject to marginal strips pursuant to Section 24 of the Conservation Act 1982.</p> <p>Bush edge and stream positions have been fixed from map NZMS 270 D44D which was plotted from aerial photos S.M.8038 C8-9, D8-10 flown 15/2/1982.</p>	
<p>DATUM GEODETIC 1949 CIRCUIT BLUFF ORIGIN Obs. Spot 700,000mN 300,000mE</p>	
<p>Total Area... 3348.0000 ha</p>	
<p>Comprised in... R.B.7A/616</p>	
<p>I. Robert Nelson, Esq., Registered Surveyor and holder of an annual practicing certificate for who may act as a registered surveyor pursuant to section 25 of the Survey Act 1980 hereby certify that this plan has been made from surveys conducted by me or under my direction, that both plan and survey are correct and have been made in accordance with the Survey Regulations 1972 or any regulations made in substitution thereof. Dated at Invercargill this 15<sup>th</sup> day of January 1993. Signature... R.N. Beck</p>	
<p>Witnessed... p. Traverse Book... p. Reference Plans SO.2210, 2756, 4530, 6562, 8257, 8720, SO.10362, 10390, 10582, 10585, 10586... DP.5278 Examined... Correct</p>	
<p>Approved for Lease Purposes 21.08.93 A.J. Chief Surveyor</p>	
<p>Deposited this ... day of ... 19 ... District Land Registrar</p>	
<p>File 75/1060/01 Received 20/11/93 Instructions 960376</p>	
<p>SO 11908</p>	

LAND DISTRICT SOUTHLAND  
XXXII, XXXVI TAKITIMU  
Survey Blk. & Dist. II, VIII, XV, XXI WAIRAKI  
NZMS 261 Sheet D44. Record Map No. B5 526, 601, 603

Redefinition of Run 656

TERRITORIAL AUTHORITY Southland District  
COMPILED BY DEPT. OF SURVEY & LAND INFORMATION  
Scale 1:25,000 Date Nov. 1992

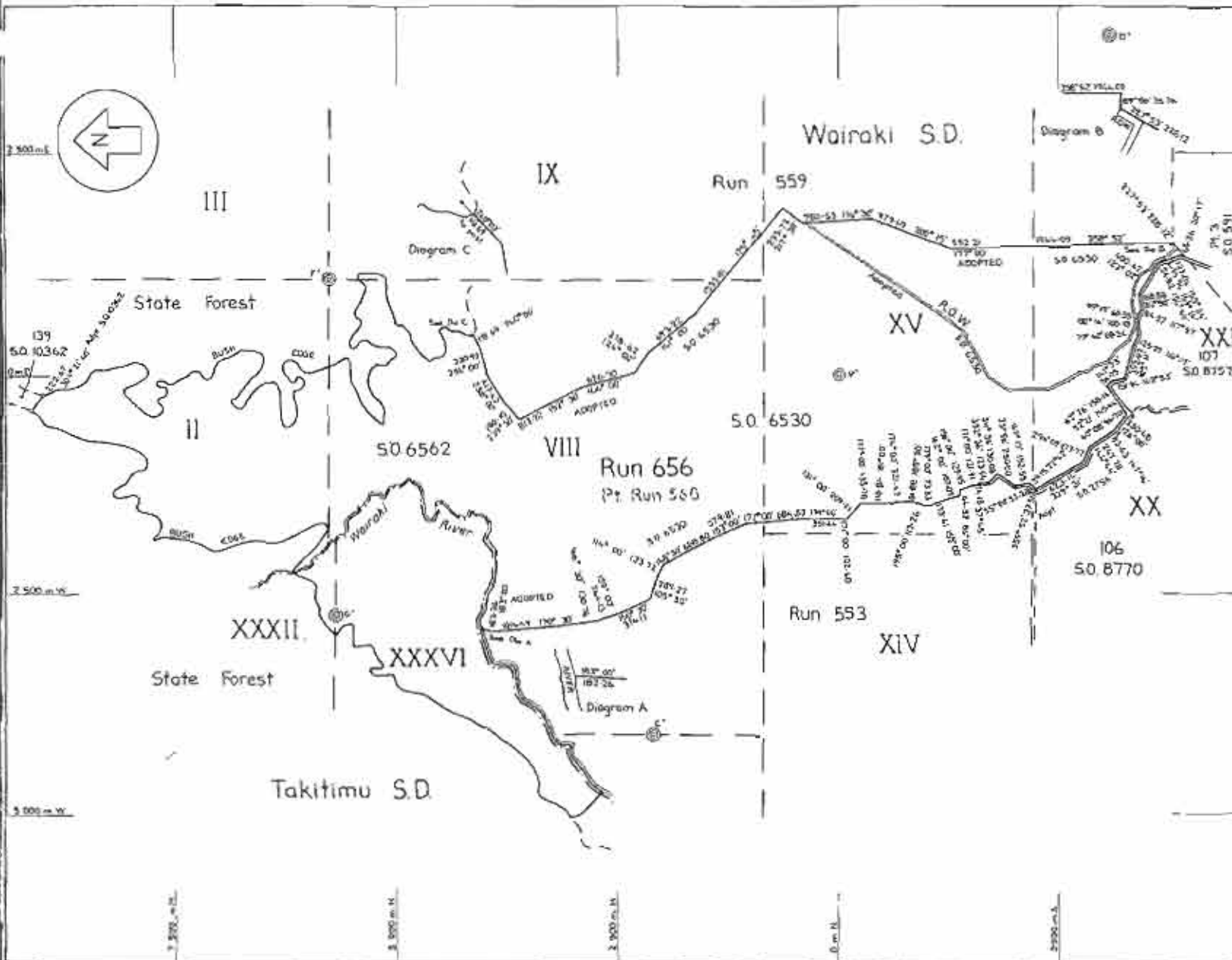

Diagrams are not drawn to scale.	
Bush edge boundary is adopted from Photogrammetric plot of NZMS 1 S 59	
Datum: Old Cadastral Origin: Trig V'	
Total Area 3300 ha Compiled in R.B. 206/6	
<p>Registered Surveyor and holder of an exempt practicing certificate hereby certify that this plan has been made from surveys executed by me or under my direction. That both plan and survey are correct and have been made in accordance with the regulations under the Surveyors Act 1968.</p> <p>Dated at _____ 1983</p> <p>of _____</p>	
Field Book	Diagrams Book
Reference Plans S.O.s 2756, 6530, 6562, 10362	
Examined <i>[Signature]</i>	Chief P.S. <i>[Signature]</i>
Approved for Pastoral Licences Purposes only	
17/83	Chief Surveyor
Deposited this _____ day of _____ 19 _____	
District Land Registrar	
File #79 Received 18-6-83 Introductions	S.O. 10390

LAND DISTRICT SOUTHLAND  
 XXXII & XXXVI TAKITIMU  
 SURVEY BLK. 8 DIST. II, VIII, IX, XV, XXI WAIRAKI  
 NZMS 261 SHEET No. D 44

RUN 656

LOCAL AUTHORITY WALLACE COUNTY  
 Surveyed by Compiled in Survey Office  
 Scale 1:30 000 Date June 1983



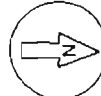
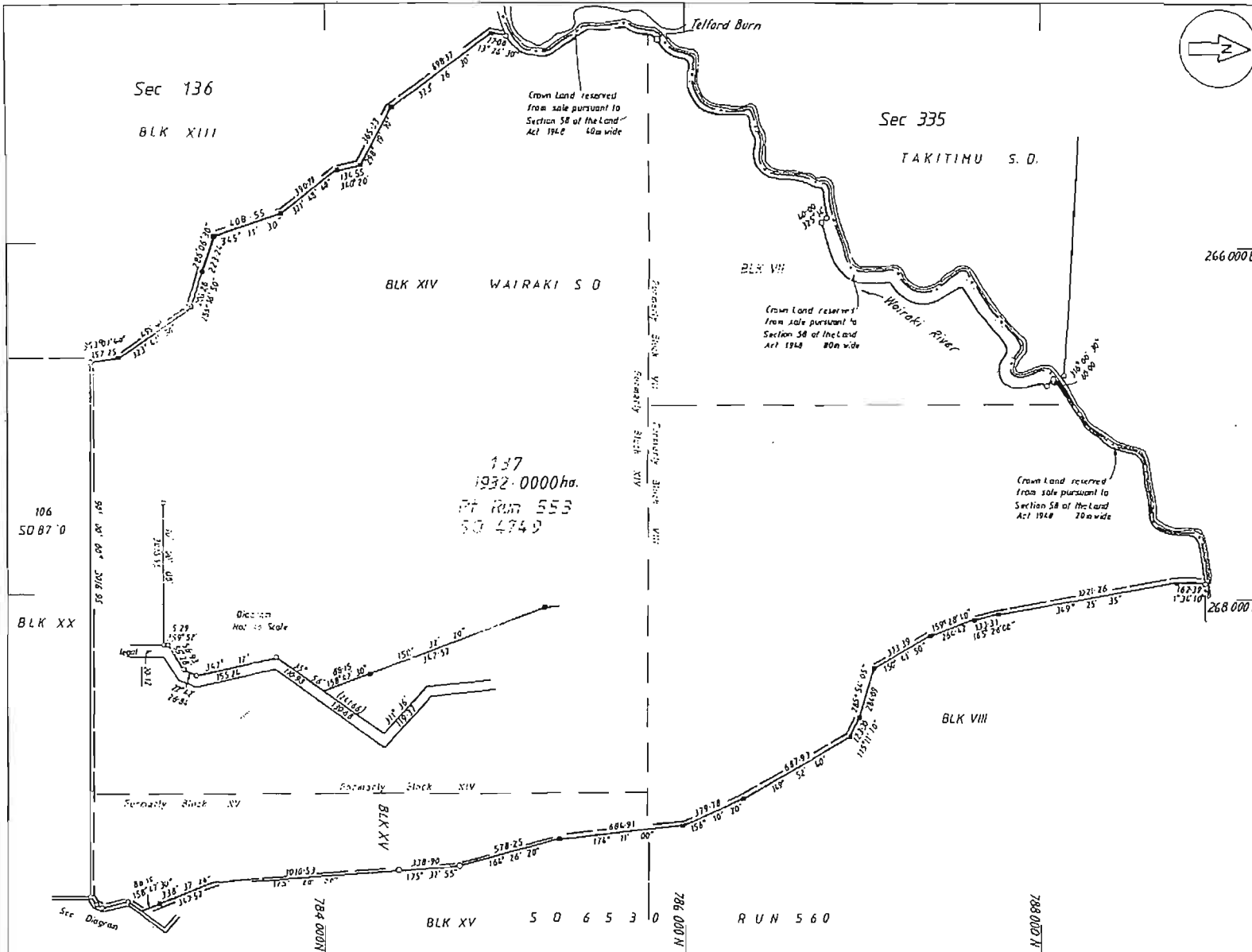

APPROVALS

Natural boundaries in this plan have been determined by photogrammetric plot  
Photo number 1110/B 3109/21 Dec 1960

NB unless indicated otherwise boundaries are adapted from SO 10582

Total Area 1932.0000 ha

Comprised in C.T. R.B. 193/130

I, ALBERT LESLIE NAYLOR of Invercargill Registered Surveyor and holder of an annual practicing certificate hereby certify that this plan has been made from surveys executed by me or under my direction; that both plan and survey are correct and have been made in accordance with the regulations under the Surveyors Act 1964.

Dated at INVERCARGILL this 23rd day of July 1985 Signature *A.L. Naylor*

Field Book No. p. Traverse Book 125 p. 82-83

Reference Plan

Examined *K. M. ...* Correct *R. ...*

Approved as to Survey *[Signature]* Chief Surveyor

12.7.85

Deposited this \_\_\_\_\_ day of \_\_\_\_\_ 19\_\_\_\_

District Land Registrar

1358/17

File DPF/668  
Receipt 2.B. 29. 4. 85  
Instruments

SO 10585

LAND DISTRICT Southland  
SURVEY BLK. & DIST XIV WAIRAKI S.D.  
NZMS 261 SHEET No D44

SECTION 137 FORMERLEY  
PART OF RUN 553

LOCAL AUTHORITY WALLACE COUNTY COUNCIL  
Surveyed by A. L. NAYLOR  
Scale 1:15000 Date April 1980





1163

1163

238E

238N

WAKEFIELD S. D.

223J

Run 590

Total Area  
7112 11 10  
4412 11 10  
7100 0 00

Run 589

Total Area  
10350 4 00  
Run Area 8610 0 00

221H

V

LEANING ROCKS S. D.

XIV

TIGER HILL

LAUDER S. D.

III

IV

PARTS OF RUNS 582 & 590  
Leaning Rock & Wakefield Districts

DIVISION OF SUBDIVISIONS OF  
MONTGOMERY COUNTY  
Surveyed by A. L. Hays, January, 1912

1163

1163

RELEASED UNDER THE OFFICIAL INFORMATION ACT



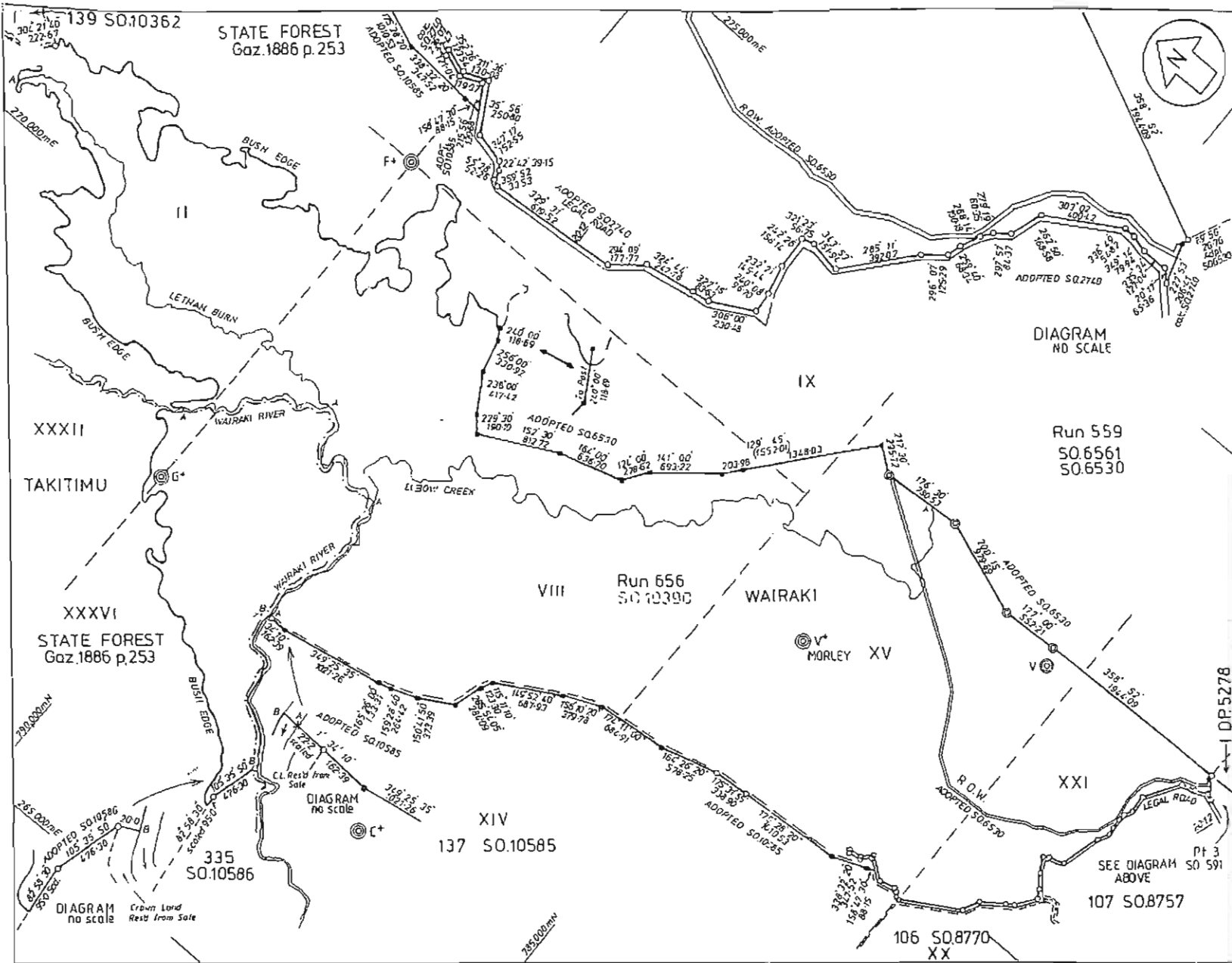

Approvals	
<p>NOTE Both sides of the streams marked A-A and the north side of the Wairaki River, marked B-B, are subject to marginal strips pursuant to Section 24 of the Conservation Act 1982.</p> <p>Bush edge and stream positions have been taken from map NZMS 270 0440 which was plotted from aerial photos S.M.8038 C8-9, D8-10 flown 15/2/1982.</p>	
<p>DATUM GEODETIC 1949 CIRCUIT BLUFF ORIGIN Obs. Spot 700,000mN 300,000mE</p>	
<p>Total Area ... 334.8:0000 ha</p>	
<p>Comprised in ... RB.7A/616</p>	
<p>I. Robert Nelson Beck ... Registered Surveyor and holder of an annual practicing certificate for who has acted as a registered surveyor pursuant to section 25 of the Survey Act 1938 hereby certify that this plan has been made from surveys executed by me or under my direction, that both plan and survey are correct and have been made in accordance with the Survey Regulations 1972 as any regulations made in substitution thereof. Dated at Invercargill this 15<sup>th</sup> day of January 1993. Signature ... R.N. Beck</p>	
<p>Field Book ... Traverse Book ... Reference Plans SO 2710, 2758, 6520, 6562, 8257, 8720, ... SO 10362, 10390, 10582, 10585, 10586, ... DP 5278 ... Examined ... Correct</p>	
<p>Approved for Lease Purposes 21/08/93 Acting Chief Surveyor</p>	
<p>Deposited this ... day of ... 19 ... District Land Registrar</p>	
<p>File 75/1066/01 Retrieved 20/1/93 by ... Instructions 580376</p>	

LAND DISTRICT ... SOUTHLAND  
Survey Blk. & Dist. I, VIII, IX, XV, XXI ... TAKITIMU ... WAIRAKI  
NZMS 261 Sheet D4.4. Record Map No. BS 526, 601, 603

Redefinition of Run 556

TERRITORIAL AUTHORITY Southland District  
COMPILED BY DEPT. OF SURVEY & LAND INFORMATION  
Scale 1:25,000 Date Nov. 1992

SO 11908

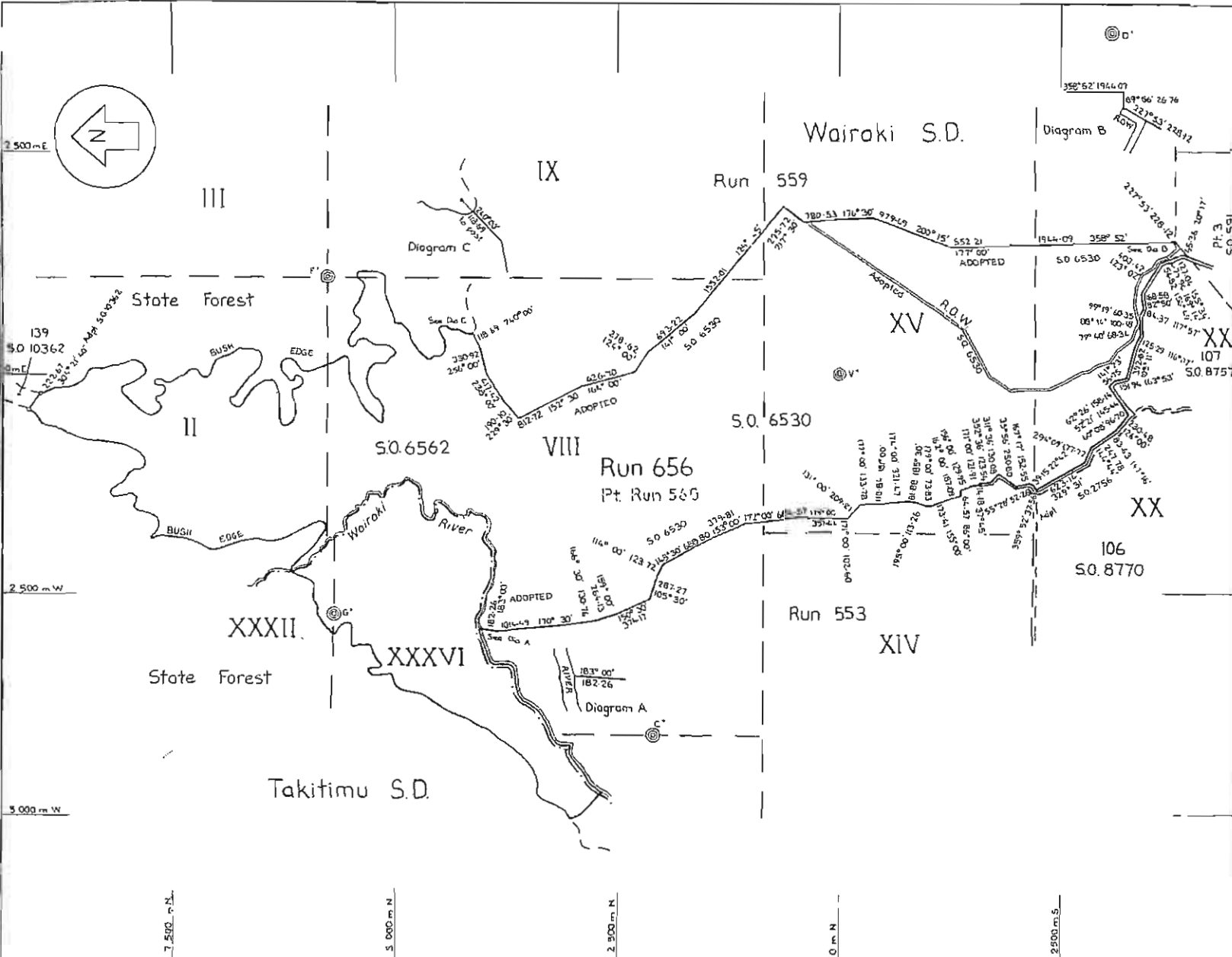

Diagrams are not drawn to scale

Bush edge boundary is adopted from Photogrammetric plot of NZMS 1 S159

Datum: Old Cadastral  
Origin: Trig V\*

Total Area 3300 ha  
Computed in R.B. 206/6

I, John P. Brown of Christchurch  
Registered Surveyor and holder of an annual practicing certificate  
hereby certify that this plan has been made from Surveys executed  
by me or under my direction that data plan and Survey are correct  
and have been made in accordance with the regulations under the  
Surveyors Act 1966

Gates at 19 this day  
of 19 Signature

Field Book          p          Traverse Book          p           
Reference Plans S.O.s 2756, 6530, 6562, 10362

Examined John P. Brown Chief Surveyor

Approved for Pastoral Licence Purposes only

1: 7 183  
Deposited this day of 19

District Land Registrar

File P191  
Received 13-6-83  
Instructions

LAND DISTRICT SOUTHLAND  
SURVEY BLK & DIST. XXXII + XXXVI TAKITIMU  
DIST. II, VIII, IX, XV, XXI WAIRAKI  
NZMS 261 SHEET NO. D 44

RUN 656

LOCAL AUTHORITY WALLACE COUNTY  
Surveyed by Compiled in Survey Office  
Scale 1:30 000 Date June 1983





6530

6530

TAKITIMU S. D.

STATE FOREST  
XXXVI

VII

VIII

IX

WAIRAKI S. D.

RUN 55J

RUN 55K

XIV

XV

XVI

All boundaries have been surveyed with a compass  
and bearings indicated by a dotted line  
where necessary with a true north  
to conform with the 1872 ACT 1872

PLAN OF RUN 540 & RUN 550

BLANKS VII, IX, XI AND XII WAIRAKI S. D. AND BLANKS XXXVI  
TAKITIMU S. D.  
SOUTHLAND LAND DISTRICT HULLADE COUNTY COUNCIL Sec 47  
SCALE: 30 CHAINS TO AN INCH SURVEYED BY G. H. GIBSON AND OTHERS

Total Area Run 540 127000/1  
550 4100/1

APPROVED  
G. H. GIBSON  
1872

6530

I hereby certify that the above is a true and correct copy of the plan of the land described in the Schedule of the Statute in that behalf made and that the same has been approved by me as Surveyor-General of the Colony of New Zealand.

APPROVED  
G. H. GIBSON  
1872

6530

RELEASED UNDER THE OFFICIAL INFORMATION ACT

1163

1163

238K

238N

WAKEFIELD S. D.

Run 590

Total Area	712	1	10
to 12	1	10	
700	0	00	

Run 589

Total Area	5610	0	00
------------	------	---	----

223J

XIV

221H

V

TIGER HILL

LEANING ROCK S. D.

LAUDER S. D.

PARTS OF RUNS 589 & 590  
Leaning Rock & Wakefield Districts

part of subdivision of  
MOUTRIE RUN

Surveyed by A. H. HAY January 1912

1163

DISTRICT OF COLUMBIA  
 DEPARTMENT OF THE INTERIOR  
 BUREAU OF LAND MANAGEMENT  
 WASHINGTON, D. C.

2022  
 This map is a reproduction of a map  
 prepared by the Bureau of Land Management  
 in 1912. It is not intended to be used  
 as a legal document.

1163

RELEASED UNDER THE OFFICIAL INFORMATION ACT