

Crown Pastoral Land Tenure Review

Lease name : BRAESIDE

Lease number : PO 181

Designations Plan

A Designations Plan forms part of the Tenure Review Substantive Proposal. The attached plan is a copy of the Designations Plan included in the Substantive Proposal for the above review. The Substantive Proposal has been accepted by the Leaseholder.

A summary of the Substantive Proposal is available as part of a notice of acceptance document lodged for registration against the Landonline computer register of the leasehold Certificate of Title being OT386/675. The Notice of Acceptance is a public document searchable at a LINZ processing centre or by licenced remote access to Landonline.

August

06

**Po 181
Braeside**

Land to be restored to full Crown ownership and control as a conservation area subject to continuation of an existing easement

Land to be restored to full Crown ownership and control for the purpose of a public access way

Land to be disposed of to GM & AJ McKnight subject to easements

Easement for public and conservation management access (a-b)

Irrigation Easement

New fence (A-B-C)



Ken Taylor TR 018/BRAESIDE 9 22 done on 22/06/05

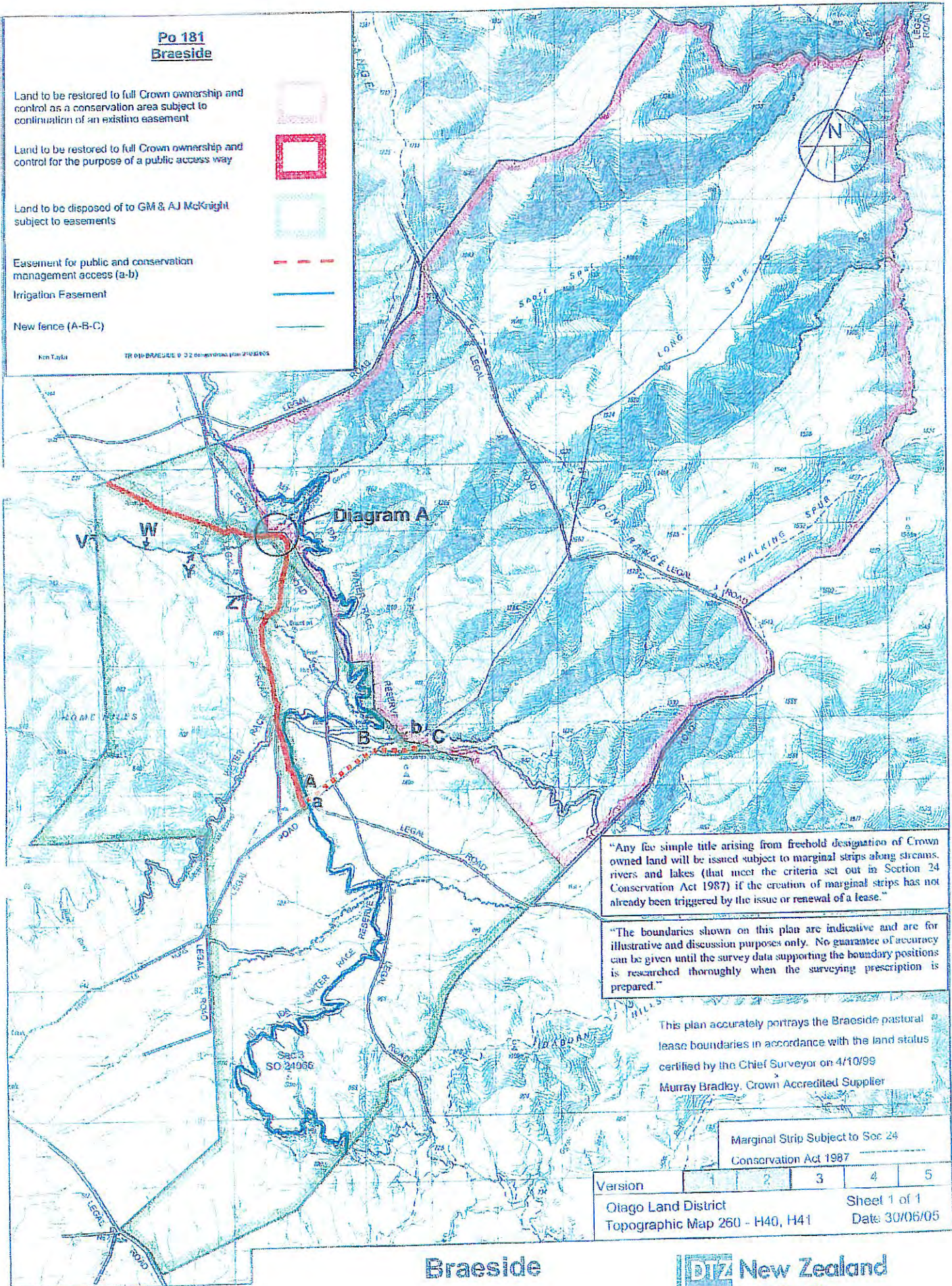

"Any fee simple title arising from freehold designation of Crown owned land will be issued subject to marginal strips along streams, rivers and lakes (that meet the criteria set out in Section 24 Conservation Act 1987) if the creation of marginal strips has not already been triggered by the issue or renewal of a lease."

"The boundaries shown on this plan are indicative and are for illustrative and discussion purposes only. No guarantee of accuracy can be given until the survey data supporting the boundary positions is researched thoroughly when the surveying prescription is prepared."

This plan accurately portrays the Braeside pastoral lease boundaries in accordance with the land status certified by the Chief Surveyor on 4/10/99
Murray Bradley, Crown Accredited Supplier

Marginal Strip Subject to Sec 24
Conservation Act 1987

Version	1	2	3	4	5
Otago Land District Topographic Map 260 - H40, H41	Sheet 1 of 1				Date 30/06/05

Braeside

Scale 1:50000

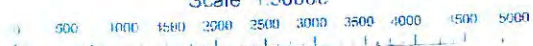

Po181 Braeside

Diagram A

- Existing Fence
- Proposed new unfenced Boundary 1-2-3-4-5
- Conservation Area
- Land Retained for Public Access
- Freehold

