

Crown Pastoral Land Tenure Review

Lease name : CAMDEN

Lease number : PM 028

Due Diligence Report (including Status Report) - Part 6

This report and attachments results from a pre-Tenure Review assessment of the pastoral lease for the purpose of confirming land available for Tenure Review and any issues, rights or obligations attaching to it. The information is gathered from files and other sources available to the LINZ contractor.

Part of the information relates to research on the status of the land, resulting in a Status Report that is signed off by a LINZ approving officer. The remainder of the information is not analysed for relevancy or possible action until required, and LINZ does not guarantee its accuracy or completeness as presented.

The report attached is released under the Official Information Act 1982.

April 09

10.12.1884 ...
 16.7.1884 ...
 18.11.1884 ...
 19.12.1884 ...
 20.1.1885 ...

The certificate that the Official Seal of the ...
 of the ...
 at ...
 1884 by order of the ...
 duty ...

4761

*Company of ...
 ...
 ...*

...
 ...
 ...
 ...
 ...
 ...
 ...
 ...

The ...
 ...

1871
1872
1873
1874
1875
1876
1877
1878
1879
1880
1881
1882
1883
1884
1885
1886
1887
1888
1889
1890
1891
1892
1893
1894
1895
1896
1897
1898
1899
1900

Paul Douslin
Solicitor Clerk
Blenheim

Memorandum

The undermentioned writings relating to the lands herein mentioned and described are deposited in the Office of the Registrar of Deeds at Blenheim in the Provincial District of Nelson in the Colony of New Zealand and such deposit is in full compliance with the provisions thereof.

Registered at No. 2470 31st October 1878
 Registered at No. 2480 20th March 1875

Letter of Administration of the Estate of Alexander Wilson deceased
 Order of the Supreme Court of New Zealand in the matter of Edwards and A. Wilson Executors of the last mentioned estate.

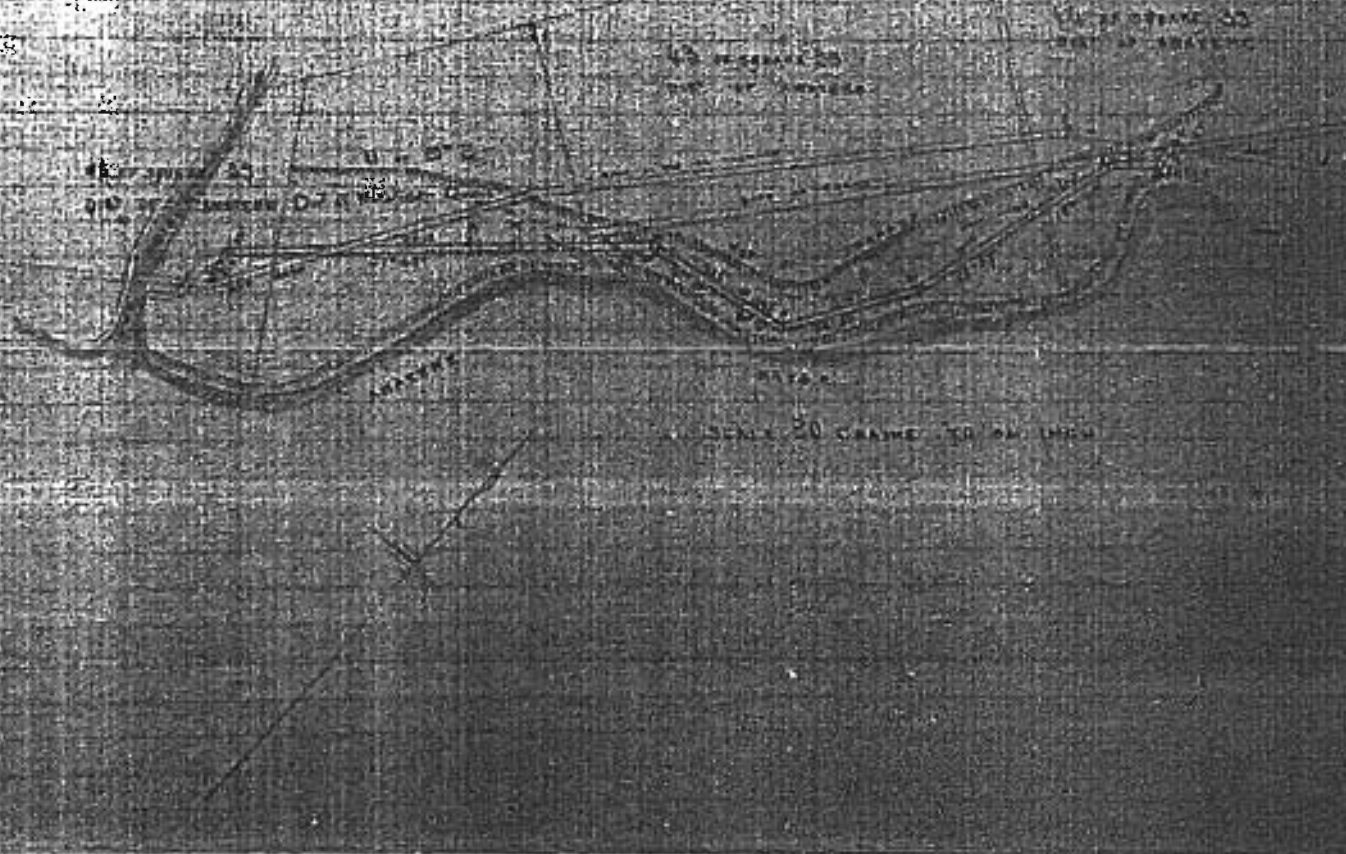

No.	REFERENCE	
	READING	DISTANCE
I	250 31	107.5
II	235 16	446.0
III	247 26	392.8
IV	242 16	195.2
V	252 03	197.3
VI	229 28	127.0
VII	247 05	110.4
VIII	263 59	145.3
IX	251 00	134.2
X	243 19	160.0
XI	100 14	094.8
XII	140 30	127.4
XIII	180 22	120.8
XIV	220 17	110.2
XV	230 00	100.0
XVI	240 20	110.0
XVII	250 40	120.0
XVIII	260 00	130.0
XIX	270 20	140.0
XX	280 40	150.0
XXI	290 00	160.0
XXII	300 20	170.0
XXIII	310 40	180.0
XXIV	320 00	190.0
XXV	330 20	200.0
XXVI	340 40	210.0
XXVII	350 00	220.0
XXVIII	360 20	230.0
XXIX	370 40	240.0
XXX	380 00	250.0
XXXI	390 20	260.0
XXXII	400 40	270.0
XXXIII	410 00	280.0
XXXIV	420 20	290.0
XXXV	430 40	300.0
XXXVI	440 00	310.0
XXXVII	450 20	320.0
XXXVIII	460 40	330.0
XXXIX	470 00	340.0
XXX	480 20	350.0
XXXI	490 40	360.0
XXXII	500 00	370.0
XXXIII	510 20	380.0
XXXIV	520 40	390.0
XXXV	530 00	400.0
XXXVI	540 20	410.0
XXXVII	550 40	420.0
XXXVIII	560 00	430.0
XXXIX	570 20	440.0
XXX	580 40	450.0
XXXI	590 00	460.0
XXXII	600 20	470.0
XXXIII	610 40	480.0
XXXIV	620 00	490.0
XXXV	630 20	500.0
XXXVI	640 40	510.0
XXXVII	650 00	520.0
XXXVIII	660 20	530.0
XXXIX	670 40	540.0
XXX	680 00	550.0
XXXI	690 20	560.0
XXXII	700 40	570.0
XXXIII	710 00	580.0
XXXIV	720 20	590.0
XXXV	730 40	600.0
XXXVI	740 00	610.0
XXXVII	750 20	620.0
XXXVIII	760 40	630.0
XXXIX	770 00	640.0
XXX	780 20	650.0
XXXI	790 40	660.0
XXXII	800 00	670.0
XXXIII	810 20	680.0
XXXIV	820 40	690.0
XXXV	830 00	700.0
XXXVI	840 20	710.0
XXXVII	850 40	720.0
XXXVIII	860 00	730.0
XXXIX	870 20	740.0
XXX	880 40	750.0
XXXI	890 00	760.0
XXXII	900 20	770.0
XXXIII	910 40	780.0
XXXIV	920 00	790.0
XXXV	930 20	800.0
XXXVI	940 40	810.0
XXXVII	950 00	820.0
XXXVIII	960 20	830.0
XXXIX	970 40	840.0
XXX	980 00	850.0
XXXI	990 20	860.0
XXXII	1000 40	870.0

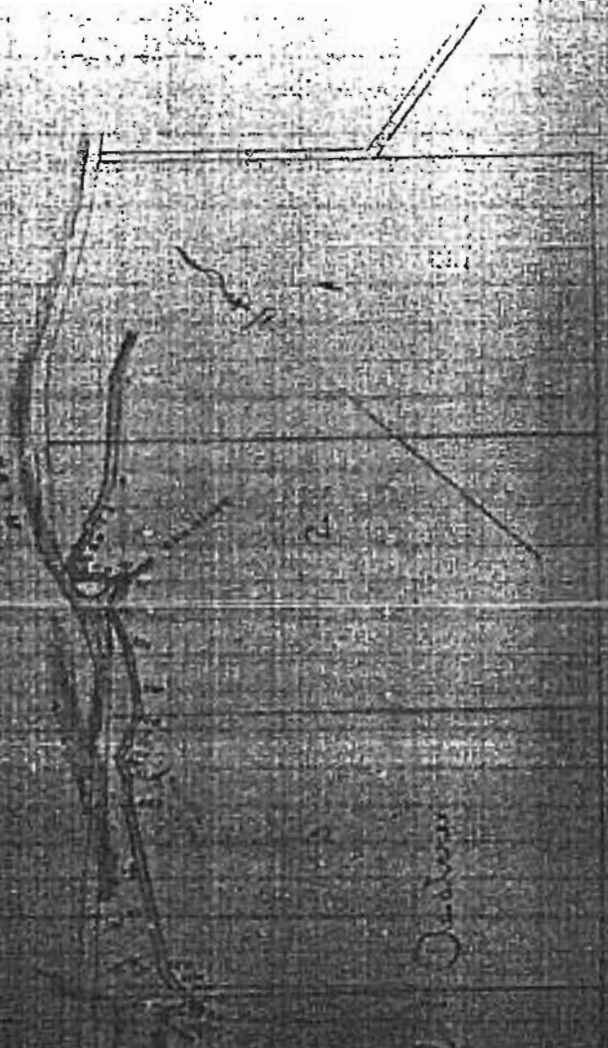

W. O. ...

2240	000	11	1240
2241	000	11	1240
2242	000	11	1240
2243	000	11	1240
2244	000	11	1240
2245	000	11	1240
2246	000	11	1240
2247	000	11	1240
2248	000	11	1240
2249	000	11	1240
2250	000	11	1240
2251	000	11	1240
2252	000	11	1240
2253	000	11	1240
2254	000	11	1240
2255	000	11	1240
2256	000	11	1240
2257	000	11	1240
2258	000	11	1240
2259	000	11	1240
2260	000	11	1240
2261	000	11	1240
2262	000	11	1240
2263	000	11	1240
2264	000	11	1240
2265	000	11	1240
2266	000	11	1240
2267	000	11	1240
2268	000	11	1240
2269	000	11	1240
2270	000	11	1240
2271	000	11	1240
2272	000	11	1240
2273	000	11	1240
2274	000	11	1240
2275	000	11	1240
2276	000	11	1240
2277	000	11	1240
2278	000	11	1240
2279	000	11	1240
2280	000	11	1240
2281	000	11	1240
2282	000	11	1240
2283	000	11	1240
2284	000	11	1240
2285	000	11	1240
2286	000	11	1240
2287	000	11	1240
2288	000	11	1240
2289	000	11	1240
2290	000	11	1240
2291	000	11	1240
2292	000	11	1240
2293	000	11	1240
2294	000	11	1240
2295	000	11	1240
2296	000	11	1240
2297	000	11	1240
2298	000	11	1240
2299	000	11	1240



22
25
25
25

4

5

6

22

100
90
80
70
60
50
40
30
20
10
0

100
90
80
70
60
50
40
30
20
10
0

100
90
80
70
60
50
40
30
20
10
0

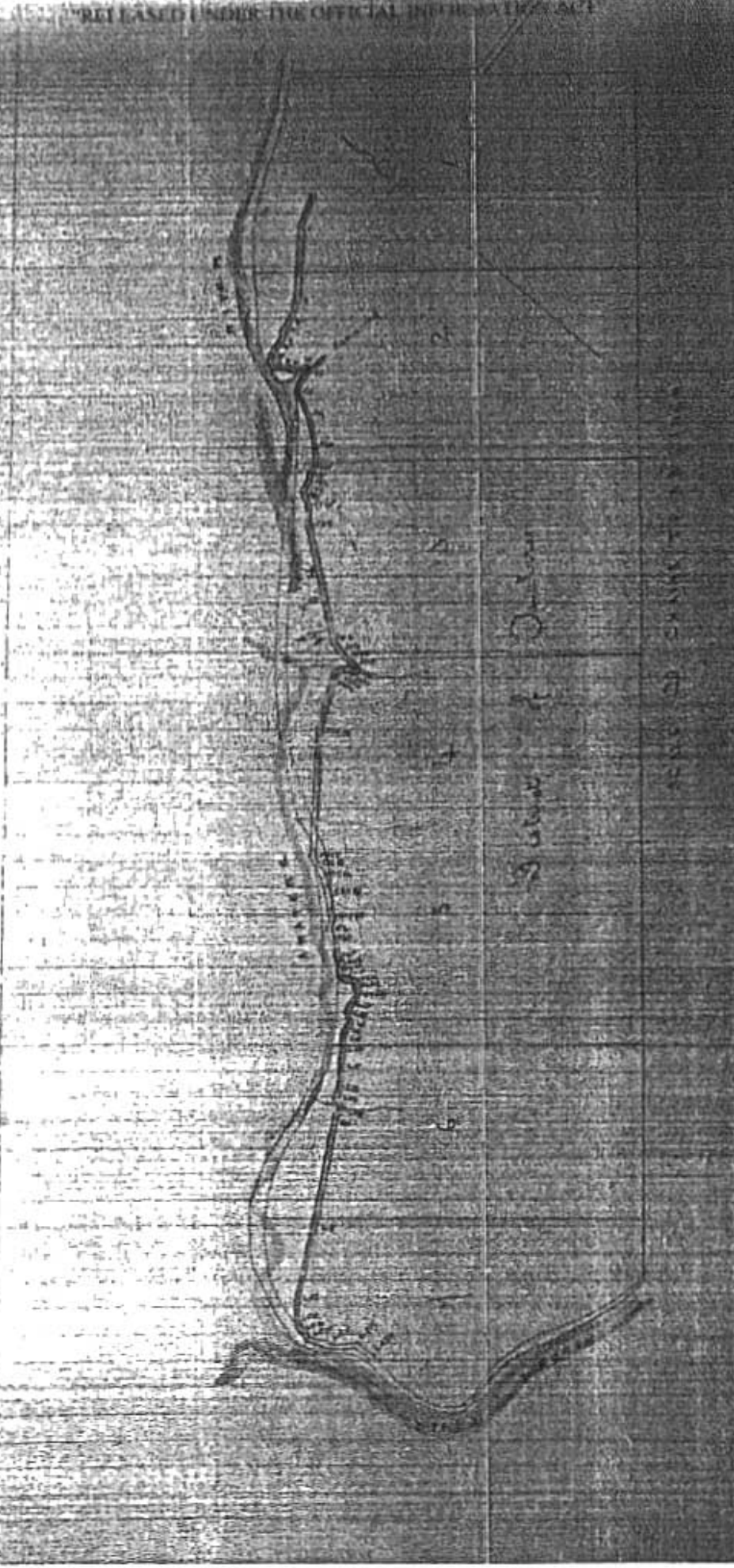

Section 1

Section 2

100
90
80
70
60
50
40
30
20
10
0

100
90
80
70
60
50
40
30
20
10
0

05 JAN 2001

CANCELLED

REGISTER

FOR EARLY S.G.R. Lease 194
Volume 22, Folio 23.

CANCELLED

NEW ZEALAND

(Lands Form B. 4.
Register Book.



Vol. 38 Fol. 130

No. 29

LEASE OF SMALL GRAZING-RUN.

Under the Land Act, 1924.

This Lease, dated the ---First--- day of ---March---, 1934, between His Majesty the King (who, with his heirs, and successors, is and are herein referred to as "the lessor"), of the one part, and ---IAB HUGH CALERON--- of the other part, who, with his executors, administrators, and assigns, is hereinafter referred to as "the lessee,"

of the latter part, who, with his executors, administrators, and assigns, is hereinafter referred to as "the lessee,"

of the latter part, who, with his executors, administrators, and assigns, is hereinafter referred to as "the lessee,"

of the latter part, who, with his executors, administrators, and assigns, is hereinafter referred to as "the lessee,"

of the latter part, who, with his executors, administrators, and assigns, is hereinafter referred to as "the lessee,"

of the latter part, who, with his executors, administrators, and assigns, is hereinafter referred to as "the lessee,"

of the latter part, who, with his executors, administrators, and assigns, is hereinafter referred to as "the lessee,"

of the latter part, who, with his executors, administrators, and assigns, is hereinafter referred to as "the lessee,"

of the latter part, who, with his executors, administrators, and assigns, is hereinafter referred to as "the lessee,"

of the latter part, who, with his executors, administrators, and assigns, is hereinafter referred to as "the lessee,"

of the latter part, who, with his executors, administrators, and assigns, is hereinafter referred to as "the lessee,"

of the latter part, who, with his executors, administrators, and assigns, is hereinafter referred to as "the lessee,"

of the latter part, who, with his executors, administrators, and assigns, is hereinafter referred to as "the lessee,"

of the latter part, who, with his executors, administrators, and assigns, is hereinafter referred to as "the lessee,"

of the latter part, who, with his executors, administrators, and assigns, is hereinafter referred to as "the lessee,"

of the latter part, who, with his executors, administrators, and assigns, is hereinafter referred to as "the lessee,"

of the latter part, who, with his executors, administrators, and assigns, is hereinafter referred to as "the lessee,"

of the latter part, who, with his executors, administrators, and assigns, is hereinafter referred to as "the lessee,"

of the latter part, who, with his executors, administrators, and assigns, is hereinafter referred to as "the lessee,"

of the latter part, who, with his executors, administrators, and assigns, is hereinafter referred to as "the lessee,"

of the latter part, who, with his executors, administrators, and assigns, is hereinafter referred to as "the lessee,"

of the latter part, who, with his executors, administrators, and assigns, is hereinafter referred to as "the lessee,"

of the latter part, who, with his executors, administrators, and assigns, is hereinafter referred to as "the lessee,"

of the latter part, who, with his executors, administrators, and assigns, is hereinafter referred to as "the lessee,"

of the latter part, who, with his executors, administrators, and assigns, is hereinafter referred to as "the lessee,"

of the latter part, who, with his executors, administrators, and assigns, is hereinafter referred to as "the lessee,"

of the latter part, who, with his executors, administrators, and assigns, is hereinafter referred to as "the lessee,"

of the latter part, who, with his executors, administrators, and assigns, is hereinafter referred to as "the lessee,"

of the latter part, who, with his executors, administrators, and assigns, is hereinafter referred to as "the lessee,"

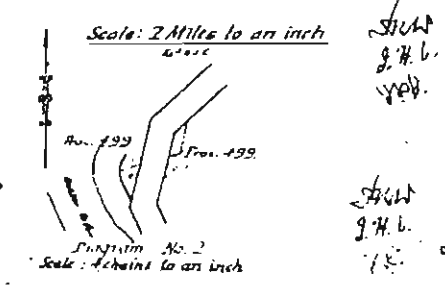
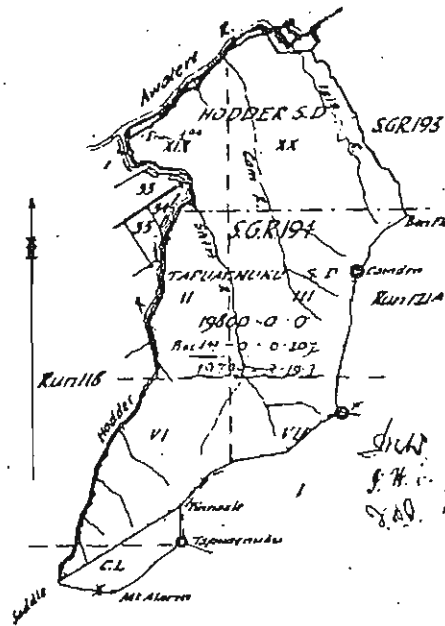

into the lessor, during the continuance of such term, the annual rent of £150 during the first five years, an annual rental of £200 during the next five years, and an annual rental of £250 during the balance of the term of the lease

by equal half-yearly payments in advance, on the first day of March and the first day of September in each year, clear of all rates, taxes, and deductions whatsoever. The first of such payments having been made to the Receiver of Land Revenue at Elphinstone on behalf of the lessor, the next to become due and be made on the first day of September next in the manner required by the said Act. And the lessee doth hereby, for himself, his heirs, executors, administrators, and assigns, covenant with the lessor that—(1) He, the lessee, shall and will pay the yearly rent of—

£250, hereinafter reserved, at the times and in manner aforesaid, and will, in relation to the premises hereby demised, perform, observe, and keep the several covenants and conditions herein contained or implied, and on the lessee's part to be performed, observed, and kept respectively; and will in all respects abide by and conform to the provisions of the said Act relative to small grazing-runs, and also abide by and conform to all other provisions of the said Act relating to or affecting the estate, interest, rights, or liabilities of the lessee in respect of the land and premises hereby demised.

(2) Thereas there is owing by the lessee to the lessor the sum of £750 in connection with the purchase of certain improvements now existing on the premises hereby demised, the lessee doth hereby, for himself, his heirs, executors, administrators, and assigns, covenant with the lessor that—(1) He, the lessee, shall and will pay the yearly rent of—

£250, hereinafter reserved, at the times and in manner aforesaid, and will, in relation to the premises hereby demised, perform, observe, and keep the several covenants and conditions herein contained or implied, and on the lessee's part to be performed, observed, and kept respectively; and will in all respects abide by and conform to the provisions of the said Act relative to small grazing-runs, and also abide by and conform to all other provisions of the said Act relating to or affecting the estate, interest, rights, or liabilities of the lessee in respect of the land and premises hereby demised.

(2) Thereas there is owing by the lessee to the lessor the sum of £750 in connection with the purchase of certain improvements now existing on the premises hereby demised, the lessee doth hereby, for himself, his heirs, executors, administrators, and assigns, covenant with the lessor that—(1) He, the lessee, shall and will pay the yearly rent of—

£250, hereinafter reserved, at the times and in manner aforesaid, and will, in relation to the premises hereby demised, perform, observe, and keep the several covenants and conditions herein contained or implied, and on the lessee's part to be performed, observed, and kept respectively; and will in all respects abide by and conform to the provisions of the said Act relative to small grazing-runs, and also abide by and conform to all other provisions of the said Act relating to or affecting the estate, interest, rights, or liabilities of the lessee in respect of the land and premises hereby demised.

(2) Thereas there is owing by the lessee to the lessor the sum of £750 in connection with the purchase of certain improvements now existing on the premises hereby demised, the lessee doth hereby, for himself, his heirs, executors, administrators, and assigns, covenant with the lessor that—(1) He, the lessee, shall and will pay the yearly rent of—

Signed by MURRAY GIBSON, Esq.
the Commissioner of Crown Lands for the Land District of Marlborough
on behalf of the lessor, in the presence of—
Witness - V. K. King
Occupation - ...
Address - ...

J. H. Caleron
Commissioner of Crown Lands.

Signed by the said IAB HUGH CALERON
in the presence of—
Witness - ...
Occupation - ...
Address - ...

J. H. Caleron
Lessee.

THIS REPRODUCTION (ON A REDUCED SCALE) CERTIFIED TO BE A TRUE COPY OF THE ORIGINAL REGISTER FOR THE PURPOSES OF SECTION 124 LAND TRANSFER ACT 1952.

(OVER)

Vertical text on the right margin, possibly a reference or note.

10 DEC 1986

SEC No.	REFERENCE TO			SEC No.	REFERENCE TO			SEC No.	REFERENCE TO		
	ACQUISITION	DISPOSAL			ACQUISITION	DISPOSAL			ACQUISITION	DISPOSAL	
		CERT	TITLE			CERT	TITLE			CERT	TITLE
11	Bk XXIV Hodder SD	CG	2/62	15	Bk XXIV Hodder SD	CG	2/62	19	Bk XIX Hodder SD	CG	2/62
	C. 17795	Now in SGR 194			C. 17795	Now in SGR 194			C. 17795	Now in SGR 194	
12	Bk XXIV Hodder SD	CG	2/62	16	Bk XXIV Hodder SD	CG	2/62	20	Bk XXIV Hodder SD	CG	2/62
	C. 17795	Now in SGR 194			C. 17795	Now in SGR 194			C. 17795	Now in SGR 194	
13	Bk XXIV Hodder SD	CG	2/62	17	Bk XXIV Hodder SD	CG	2/62	21	Bk XXIV Hodder SD	CG	2/62
	C. 17795	Now in SGR 194			C. 17795	Now in SGR 194			C. 17795	Now in SGR 194	
14	Bk XXIV Hodder SD	CG	2/62	18	Bk XXIV Hodder SD	CG	2/62	22	Bk XXIV Hodder SD	CG	2/62
	C. 17795	Now in SGR 194			C. 17795	Now in SGR 194			C. 17795	Now in SGR 194	

CAHLEN RON

AWATERE RD

SECS 11-22

10 DEC 1985

SEC No	REFERENCE TO			SEC No.	REFERENCE TO			SEC No.	REFERENCE TO		
	ACQUISITION	DISPOSAL			ACQUISITION	DISPOSAL			ACQUISITION	DISPOSAL	
		CERT	TITLE			CERT	TITLE			CERT	TITLE
1	Blk XIX Header SD	CG	2/60	4	Blk XIX Header SD	CG	2/60	7	Blk XIX Header SD	CG	2/60
Pt 1	C. 9487	Now Rd		Pt 4	C. 9487	Now Rd		Pt 7	C. 9487	Now Rd	
Pt 1	C. 17795	Now in SGR 194		Pt 4	C. 17795	Now in SGR 194		Pt 7	C. 17795	Now in SGR 194	
2	Blk XIX Header SD	CG	2/60	5	Blk XIX Header SD	CG	2/60	8	Blk XXIV Header SD	CG	2/62
Pt 2	C. 9487	Now Rd		Pt 5	C. 9487	Now Rd			C. 17795	Now in SGR 194	
Pt 2	C. 17795	Now in SGR 194		Pt 5	C. 17795	Now in SGR 194					
3	Blk XIX Header SD	CG	2/60	6	Blk XIX Header SD	CG	2/60	9	Blk XXIV Header SD	CG	2/62
Pt 3	C. 9487	Now Rd		Pt 6	C. 9487	Now Rd			C. 17795	Now in SGR 194	
Pt 3	C. 17795	Now in SGR 194		Pt 6	C. 17795	Now in SGR 194		10	Blk XXIV Header SD	CG	2/62
									C. 17795	Now in SGR 194	

CAMDEN RUN

AWATERE RD

SECS 1-10

10 DEC 1986

SEC No.	REFERENCE TO ACQUISITION			SEC No.	REFERENCE TO DISPOSAL			SEC No.	REFERENCE TO ACQUISITION			SEC No.	REFERENCE TO DISPOSAL		
	CERT	TITLE			CERT	TITLE			CERT	TITLE			CERT	TITLE	
33	CG	3/264		37	CG	3/264									
	C. 17795	Now in	SGR 193		C. 17795	Now in	SGR 193								
34	CG	3/264													
	C. 17795	Now in	SGR 193												
35	CG	3/264													
	C. 17795	Now in	SGR 193												
36	CG	3/264													
	C. 17795	Now in	SGR 193												

10 DEC 1986

SEC No.	REFERENCE TO ACQUISITION		REFERENCE TO DISPOSAL		SEC No.	REFERENCE TO ACQUISITION		REFERENCE TO DISPOSAL		SEC No.	REFERENCE TO ACQUISITION		REFERENCE TO DISPOSAL	
	CERT	TITLE	CERT	TITLE		CERT	TITLE	CERT	TITLE		CERT	TITLE	CERT	TITLE
20					25	Blk XV Hodder SD				29	Blk XX Hodder SD			
							CG	2/59				CG	2/59	
	to Not Used					C. 17795	Now in SGRs 193 & 194				C. 17795	Now in SGR 193		
21														
22	Blk XX Hodder SD				26	Blk XXV Hodder SD				30	Blk XL Hodder SD			
	CG	2/59					CG	2/59				CG	2/264	
	C. 17795	Now in SGRs 193 & 194			B 26	C. 17795	Now in SGR 193				C. 17795	Now in SGR 194		
23	Blk XI Hodder SD				27	Blk XXI Hodder SD				31	Blk XL Hodder SD			
	CG	2/59					CG	2/59				CG	2/264	
	C. 17795	Now in SGRs 193 & 194			A 27	C. 17795	Now in SGR 193				C. 17795	Now in SGR 193		
24	Blk XX Hodder SD				28	Blk XX Hodder SD				32	Blk XX Hodder SD			
	CG	2/59					CG	2/59				CG	2/264	
	C. 17795	Now in SGRs 193 & 194			B 28	C. 17795	Now in SGR 193				C. 17795	Now in SGR 193		

BRAES OF SUTHERLAND RUN / AWATERE RD SECS 1-32

10 DEC 1986

SEC	REFERENCE TO DISPOSAL			SEC	REFERENCE TO DISPOSAL			SEC	REFERENCE TO DISPOSAL		
	ACQUISITION	CERT	TITLE		No.	ACQUISITION	CERT		TITLE	No.	ACQUISITION
	to	Not Deed		46	Blk XIII Upcat SD	CG	2/87	51	Blk XIV Upcat SD	CG	2/87
41				47	Blk XIII Upcat SD	CG	2/87	52	Blk XIV Upcat SD	CG	2/89
42	Blk XIII Upcat SD	CG	2/87	48	Blk XIV Upcat SD	CG	2/87	53	Blk XIV Upcat SD	CG	2/89
43	Blk XIII Upcat SD	CG	2/87	49	Blk XIV Upcat SD	CG	2/87	54	Blk XIV Upcat SD	CG	2/89
44	Blk XIII Upcat SD	CG	2/87	50	Blk XIV Upcat SD	CG	2/87	55	Blk XIV Upcat SD	CG	2/87
45	Blk XIII Upcat SD	CG	2/87								

FAIRFIELD RUN

AWATERE RD

SECS 1-55

Other Information

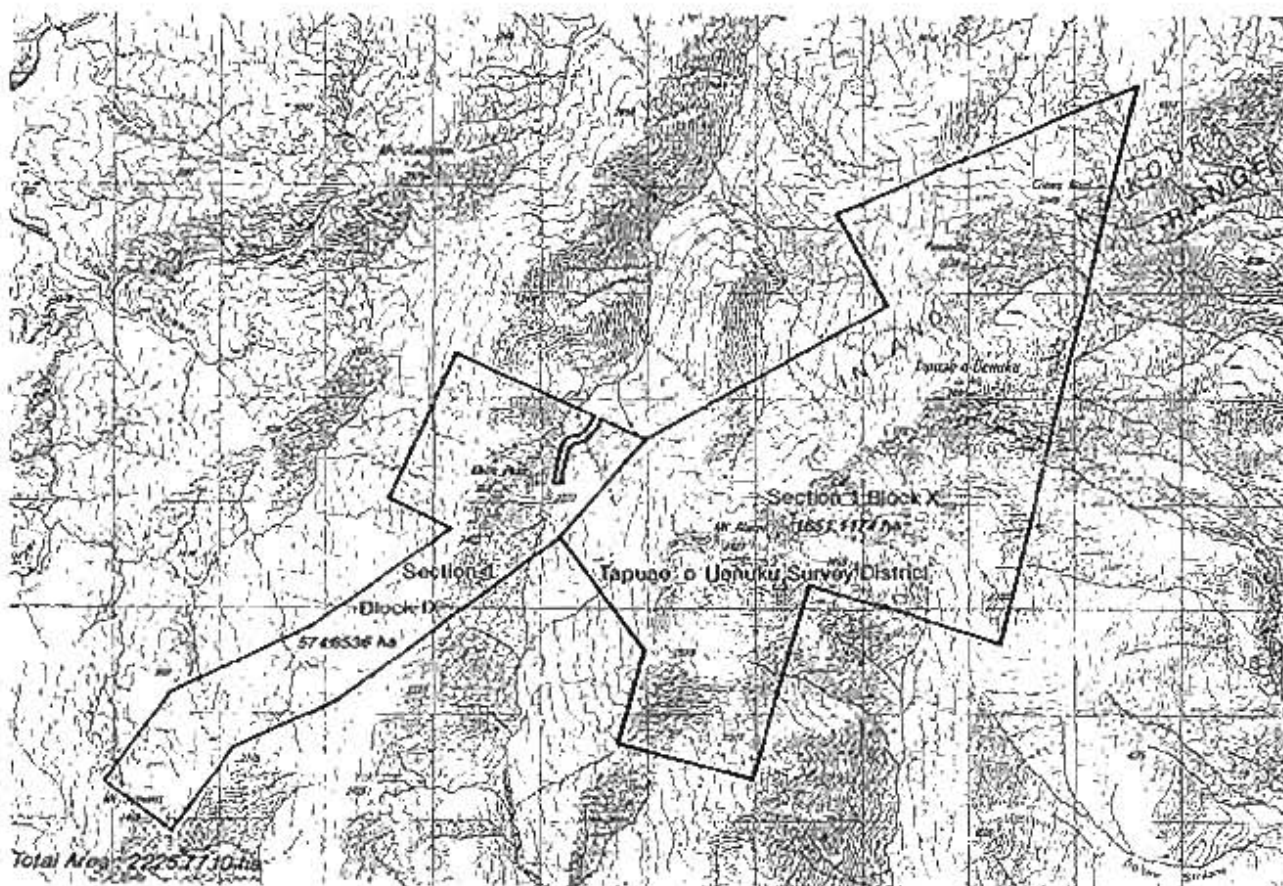

"RELEASED UNDER THE OFFICIAL INFORMATION ACT"

Scale of Original 1:50000 approx
 0 10 20 30 km

Marlborough Land District
 Territorial Authority: Kaikoura/Marlborough District

Terralink NZ Ltd
 Survey Services
 Christchurch



Tapuae o Uenuku

Areas referred to in the Deed of Settlement for the
 Ngāi Tahu Claim

Approved as to boundaries:
[Signature] 21/11/97
 for Te Kōwhiri o Ngāi Tahu
[Signature] 21/11/97
 on behalf of the Crown

MS 100
SO 7317

Proclamation

499

PARTICULARS ENTERED IN REGISTER-BOOKS

VOL *38/130, + 37/57*

THIS *9th* DAY OF *October* 1939

at *9-30 am*

Atwood

*Register Books
consulted*

DISTRICT LAND REGISTRAR

MARLBOROUGH.



*Vol. 37/57 noted 26/10/39
J. D. H.*

*Vol. 38/130 Altpo. 10558.
noted 2/11/1939 J. D. H.*

50 4208

[Extract from *New Zealand Gazette* No. 121, 28th September, 1939.]
Page 2572.

Land taken for the Purpose of a Road in Blocks XIX and XXIII, Hodder Survey District.

[L.S.] GALWAY, Governor-General.
A PROCLAMATION.

IN pursuance and exercise of the powers and authorities vested in me by the Public Works Act, 1928, and of every other power and authority in anywise enabling me in this behalf, I, George Vero Arundell, Viscount Galway, Governor-General of the Dominion of New Zealand, do hereby proclaim and declare that the land described in the Schedule hereto is hereby taken for the purposes of a road; and I do also declare that this Proclamation shall take effect on and after the second day of October, one thousand nine hundred and thirty-nine.

SCHEDULE.

Approximate Area of the Piece of Land taken.	Being Portion of	Situated in Block	Situated in Survey District of	Shown on Plan	Coloured on Plan
A. R. P. 0 0 11.7	Small Grazing Run 104	XIX	Hodder	P.W.D. 103201	Yellow.
0 0 0	Small Grazing Run 104	XIX	"	"	Purple.
0 2 30	Section 1, Upper Fairfield Downs District (S.O. B 814/70.)	XXIII	"	"	Red.

36/130

In the Marlborough Land District; as the same are more particularly delineated on the plan marked and coloured as above mentioned, and deposited in the office of the Minister of Public Works at Wellington.

Given under the hand of His Excellency the Governor-General of the Dominion of New Zealand, and issued under the Seal of that Dominion, this 26th day of September, 1939.

R. SEMPLE, Minister of Public Works.

GOD SAVE THE KING!

(P.W. 82/11/172/0.)

27363

Proclamation

PARTICULARS ENTERED IN REGISTER-BOOKS

VOL 37/173 + 38/130

THIS 26th DAY OF July 1957



Stamm
DISTRICT LAND REGISTRAR
MARLBOROUGH

28262 Proclamation revoking
the within Proclamation as
to an area of 1 acre 2 roods
32 perches thereby described
in the schedule hereto produced.
27/1/1958 at 9-30 am *Stamm*
ChR

Copy

SO 4291

Extract from *N.Z. Gazette*, 4 July 1957, No. 48, page 1247

Road Closed in Blocks XIX, XXIV, and XXV, Hodder Survey District, Awatere County

C. W. M. NORRIE, Governor-General
A PROCLAMATION

PURSUANT to section 29 of the Public Works Amendment Act 1948, I, Lieutenant-General Sir Charles Willoughby Moke Norrie, the Governor-General of New Zealand, hereby proclaim as closed the road described in the Schedule hereto.

SCHEDULE

ALL those pieces of road in the Marlborough Land District, situated in Blocks XIX, XXIV, and XXV, Hodder Survey District, Marlborough R.D., described as follows:

A.	R.	P.	Adjoining or passing through
21	0	0	
5	1	0	
1	2	32	Part Small Grazing Run 194.
2	1	24	
3	3	16	
2	2	24	
5	0	12	
12	0	0	
40	3	8	
0	1	12	
0	3	6	
0	0	16	
0	1	4	
0	2	20	Part Small Grazing Run 191.
0	0	2-4	
0	3	20	
0	2	0	
0	0	15-2	
0	2	17-4	
2	0	3	
0	0	35	
17	2	16	

38/130

17/173

1-0-32

As the same are more particularly delineated on the plan marked P.W.D. 153697 (S.D. 4291) deposited in the office of the Minister of Works at Wellington, and thereon coloured green.

Given under the hand of His Excellency the Governor-General, and issued under the Seal of New Zealand, this 1st day of July 1957.

[S.] W. S. GOOSMAN, Minister of Works.

GOD SAVE THE QUEEN!

(P.W. 42/823; D.O. 16/1122)

R. B. OWEN, Government Printer, Wellington, New Zealand.