



Crown Pastoral Land Tenure Review

Lease name : Clayton

Lease number : Pt 011

Designations plan

A designations plan forms part of the tenure review substantive proposal. The attached plan is a copy of the designations plan included in the substantive proposal for the above review. The substantive proposal has been accepted by the leaseholder.

A summary of the substantive proposal is available as part of a notice of acceptance document lodged for registration against the Landonline computer register of the leasehold certificate of title being CB529/13. The notice of acceptance is a public document searchable at a LINZ processing centre or by licenced remote access to Landonline.

July 03

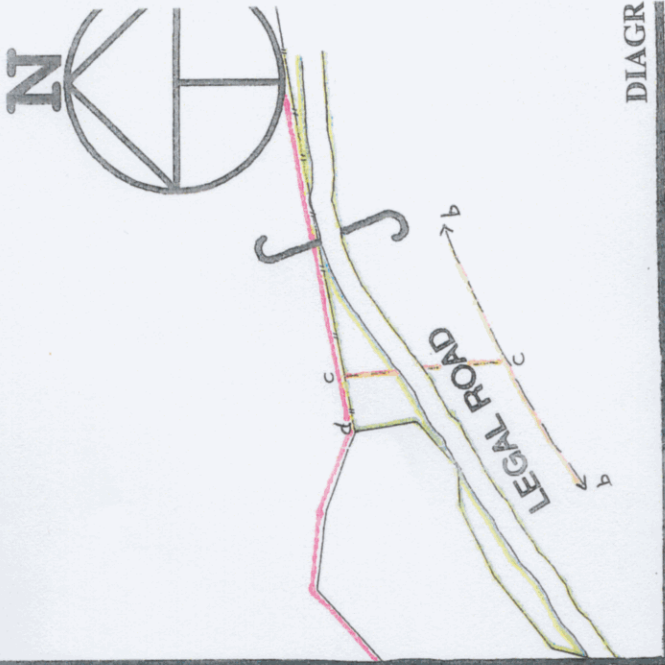

DIAGR

CLAYTON

Plan for
SUBSTANTIVE PROPOSAL
Drafting Instructions 7 May 2002

KEY TO DESIGNATIONS

- Land to be restored to full Crown Ownersh
Control
- Land to be disposed of on Freehold
- Access Easement
- Fencing

b-b c-c
d-d

See Diagram 1 for Easement c-c



Clayton Station

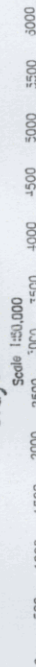

Version	1	2	3	4	5
Canterbury Land District					
NZMS 260					
Sheet 1 of 31					
Date 24/9/1999					

Marginal Strip Subject To Sec 24 (9)
Conservation Act 1987