

Crown Pastoral Land Tenure Review

Lease name : CLENT HILLS

Lease number : PC 076

Due Diligence Report (including Status Report) - Part 2

This report and attachments results from a pre-Tenure Review assessment of the pastoral lease for the purpose of confirming land available for Tenure Review and any issues, rights or obligations attaching to it. The information is gathered from files and other sources available to the LINZ contractor.

Part of the information relates to research on the status of the land, resulting in a Status Report that is signed off by a LINZ approving officer. The remainder of the information is not analysed for relevancy or possible action until required, and LINZ does not guarantee its accuracy or completeness as presented.

The report attached is released under the Official Information Act 1982.

December 05

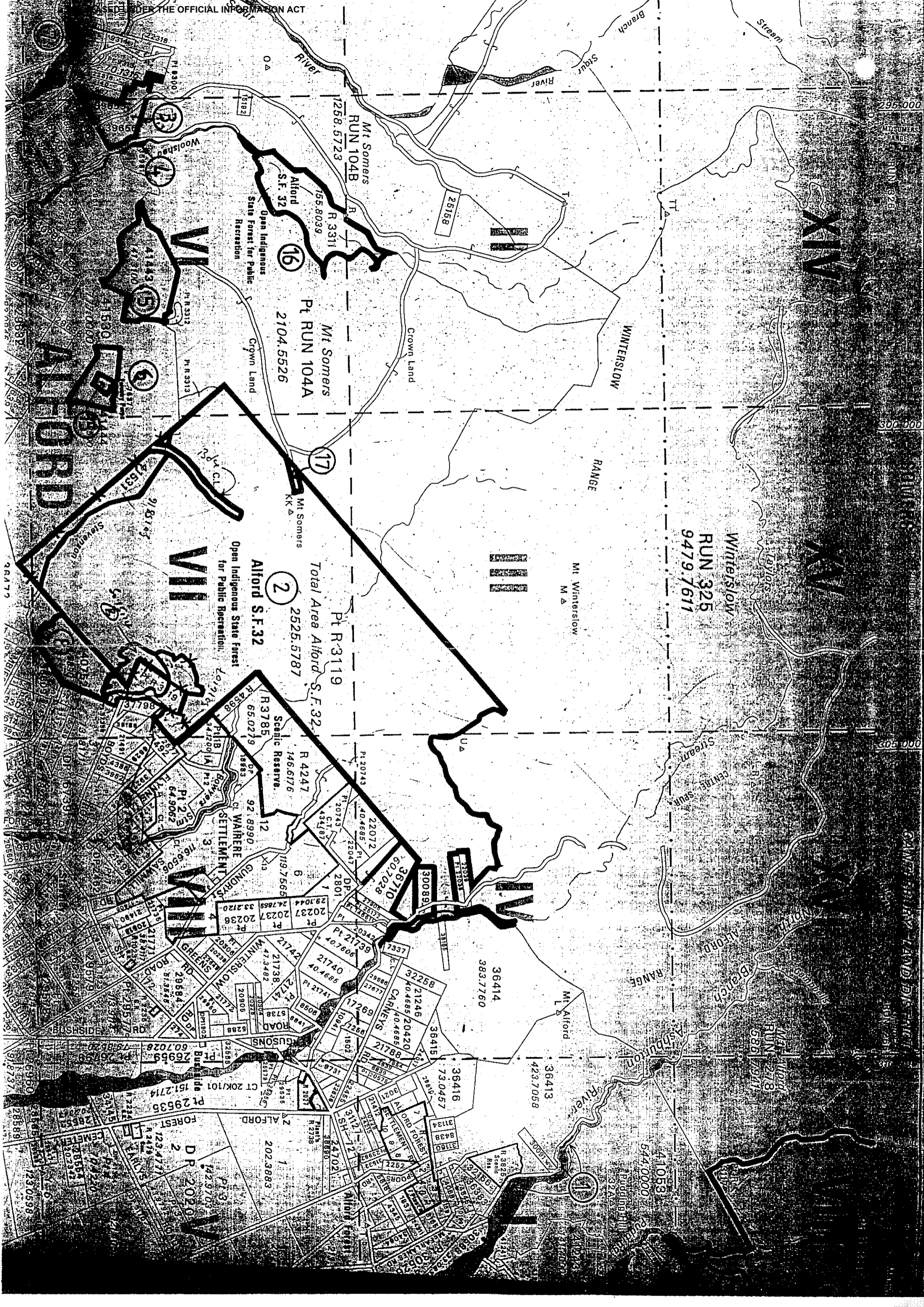

XIV

XVI

ALFORD

VI

VII

IV

16

17

2

1

Open Indigenous State Forest for Public Recreation

Open Indigenous State Forest for Public Recreation

Scenic Reserve

WINTERSLOW RANGE

RANGE

RANGE

Mt Somers RUN 104B
R 3311
155,8039

Mt Somers
Pt RUN 104A
2104.5526

Pt R 3119

Total Area Alford S.F. 32
2525.5787

R 3785
R 4247
R 4247

Winterslow RUN 325
9479.7611

Alford RUN 278
586.7941

Mt Winterslow
M Δ

Mt Alford
L Δ

2318
Pt R 3312
Pt R 3313
1580
41443 (5)
1587
41531
918143
2525.5787
4247
43497
2801
291044
20237
20236
20237
21742
21740
40.4685
Pt 21741
21741
21738
47.3482
20905
Pt 29535
Pt 20200
Pt 3119
Pt 3785
Pt 4247
Pt 3785
Pt 4247
Pt 20237
Pt 20236
Pt 21739
Pt 21740
Pt 21741
Pt 21742
Pt 21743
Pt 21744
Pt 21745
Pt 21746
Pt 21747
Pt 21748
Pt 21749
Pt 21750
Pt 21751
Pt 21752
Pt 21753
Pt 21754
Pt 21755
Pt 21756
Pt 21757
Pt 21758
Pt 21759
Pt 21760
Pt 21761
Pt 21762
Pt 21763
Pt 21764
Pt 21765
Pt 21766
Pt 21767
Pt 21768
Pt 21769
Pt 21770
Pt 21771
Pt 21772
Pt 21773
Pt 21774
Pt 21775
Pt 21776
Pt 21777
Pt 21778
Pt 21779
Pt 21780
Pt 21781
Pt 21782
Pt 21783
Pt 21784
Pt 21785
Pt 21786
Pt 21787
Pt 21788
Pt 21789
Pt 21790
Pt 21791
Pt 21792
Pt 21793
Pt 21794
Pt 21795
Pt 21796
Pt 21797
Pt 21798
Pt 21799
Pt 21800
Pt 21801
Pt 21802
Pt 21803
Pt 21804
Pt 21805
Pt 21806
Pt 21807
Pt 21808
Pt 21809
Pt 21810
Pt 21811
Pt 21812
Pt 21813
Pt 21814
Pt 21815
Pt 21816
Pt 21817
Pt 21818
Pt 21819
Pt 21820
Pt 21821
Pt 21822
Pt 21823
Pt 21824
Pt 21825
Pt 21826
Pt 21827
Pt 21828
Pt 21829
Pt 21830
Pt 21831
Pt 21832
Pt 21833
Pt 21834
Pt 21835
Pt 21836
Pt 21837
Pt 21838
Pt 21839
Pt 21840
Pt 21841
Pt 21842
Pt 21843
Pt 21844
Pt 21845
Pt 21846
Pt 21847
Pt 21848
Pt 21849
Pt 21850
Pt 21851
Pt 21852
Pt 21853
Pt 21854
Pt 21855
Pt 21856
Pt 21857
Pt 21858
Pt 21859
Pt 21860
Pt 21861
Pt 21862
Pt 21863
Pt 21864
Pt 21865
Pt 21866
Pt 21867
Pt 21868
Pt 21869
Pt 21870
Pt 21871
Pt 21872
Pt 21873
Pt 21874
Pt 21875
Pt 21876
Pt 21877
Pt 21878
Pt 21879
Pt 21880
Pt 21881
Pt 21882
Pt 21883
Pt 21884
Pt 21885
Pt 21886
Pt 21887
Pt 21888
Pt 21889
Pt 21890
Pt 21891
Pt 21892
Pt 21893
Pt 21894
Pt 21895
Pt 21896
Pt 21897
Pt 21898
Pt 21899
Pt 21900
Pt 21901
Pt 21902
Pt 21903
Pt 21904
Pt 21905
Pt 21906
Pt 21907
Pt 21908
Pt 21909
Pt 21910
Pt 21911
Pt 21912
Pt 21913
Pt 21914
Pt 21915
Pt 21916
Pt 21917
Pt 21918
Pt 21919
Pt 21920
Pt 21921
Pt 21922
Pt 21923
Pt 21924
Pt 21925
Pt 21926
Pt 21927
Pt 21928
Pt 21929
Pt 21930
Pt 21931
Pt 21932
Pt 21933
Pt 21934
Pt 21935
Pt 21936
Pt 21937
Pt 21938
Pt 21939
Pt 21940
Pt 21941
Pt 21942
Pt 21943
Pt 21944
Pt 21945
Pt 21946
Pt 21947
Pt 21948
Pt 21949
Pt 21950
Pt 21951
Pt 21952
Pt 21953
Pt 21954
Pt 21955
Pt 21956
Pt 21957
Pt 21958
Pt 21959
Pt 21960
Pt 21961
Pt 21962
Pt 21963
Pt 21964
Pt 21965
Pt 21966
Pt 21967
Pt 21968
Pt 21969
Pt 21970
Pt 21971
Pt 21972
Pt 21973
Pt 21974
Pt 21975
Pt 21976
Pt 21977
Pt 21978
Pt 21979
Pt 21980
Pt 21981
Pt 21982
Pt 21983
Pt 21984
Pt 21985
Pt 21986
Pt 21987
Pt 21988
Pt 21989
Pt 21990
Pt 21991
Pt 21992
Pt 21993
Pt 21994
Pt 21995
Pt 21996
Pt 21997
Pt 21998
Pt 21999
Pt 22000
Pt 22001
Pt 22002
Pt 22003
Pt 22004
Pt 22005
Pt 22006
Pt 22007
Pt 22008
Pt 22009
Pt 22010
Pt 22011
Pt 22012
Pt 22013
Pt 22014
Pt 22015
Pt 22016
Pt 22017
Pt 22018
Pt 22019
Pt 22020
Pt 22021
Pt 22022
Pt 22023
Pt 22024
Pt 22025
Pt 22026
Pt 22027
Pt 22028
Pt 22029
Pt 22030
Pt 22031
Pt 22032
Pt 22033
Pt 22034
Pt 22035
Pt 22036
Pt 22037
Pt 22038
Pt 22039
Pt 22040
Pt 22041
Pt 22042
Pt 22043
Pt 22044
Pt 22045
Pt 22046
Pt 22047
Pt 22048
Pt 22049
Pt 22050
Pt 22051
Pt 22052
Pt 22053
Pt 22054
Pt 22055
Pt 22056
Pt 22057
Pt 22058
Pt 22059
Pt 22060
Pt 22061
Pt 22062
Pt 22063
Pt 22064
Pt 22065
Pt 22066
Pt 22067
Pt 22068
Pt 22069
Pt 22070
Pt 22071
Pt 22072
Pt 22073
Pt 22074
Pt 22075
Pt 22076
Pt 22077
Pt 22078
Pt 22079
Pt 22080
Pt 22081
Pt 22082
Pt 22083
Pt 22084
Pt 22085
Pt 22086
Pt 22087
Pt 22088
Pt 22089
Pt 22090
Pt 22091
Pt 22092
Pt 22093
Pt 22094
Pt 22095
Pt 22096
Pt 22097
Pt 22098
Pt 22099
Pt 22100

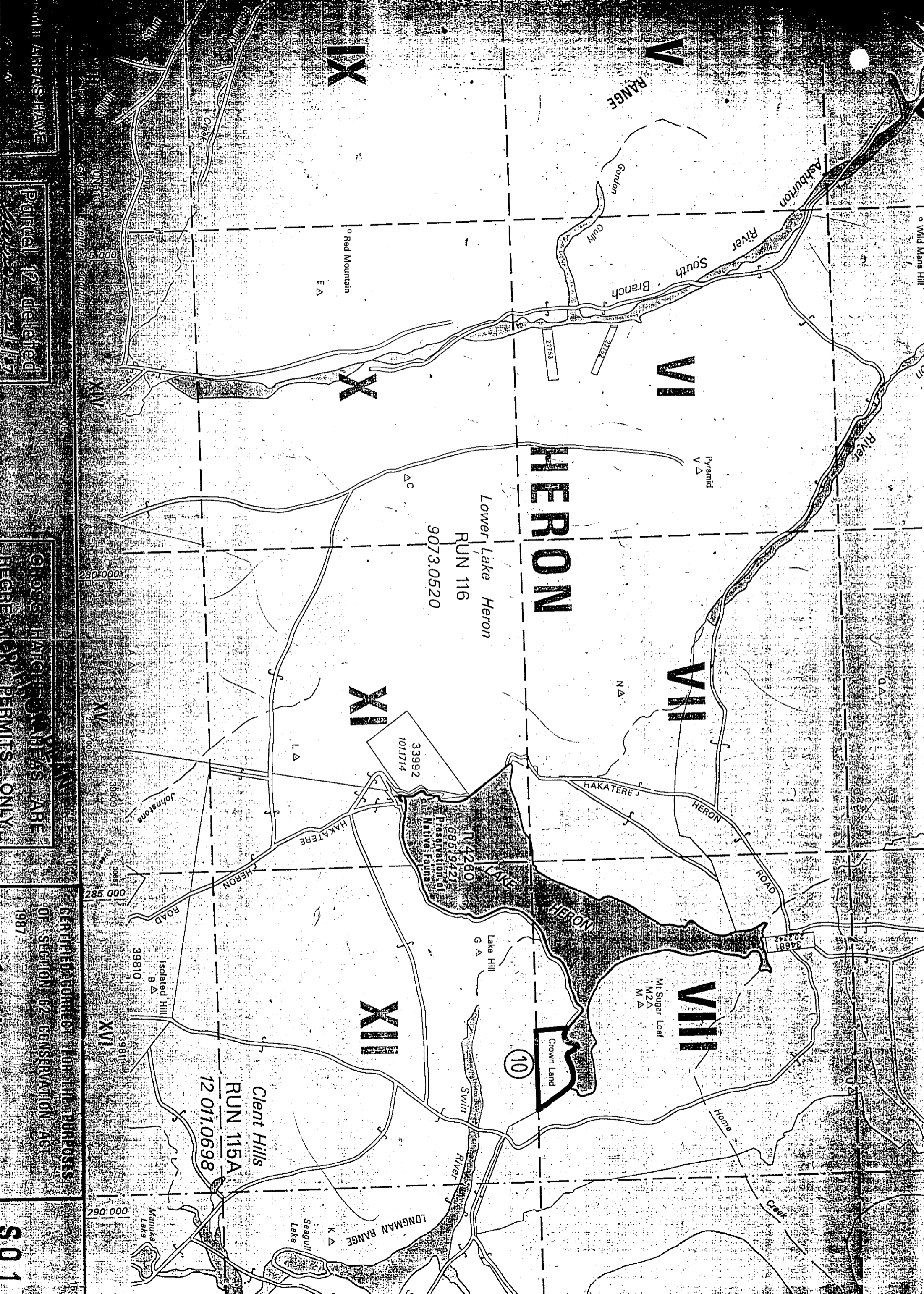

ALL AREAS HAVE

Parcel 12 deleted
2/1/17

CROSS HATCHED AREAS ARE
REGULATED PERMITS ONLY

CERTIFIED CORRECT FOR THE PURPOSES
OF SECTION 62 CONSERVATION ACT
1987

S 01

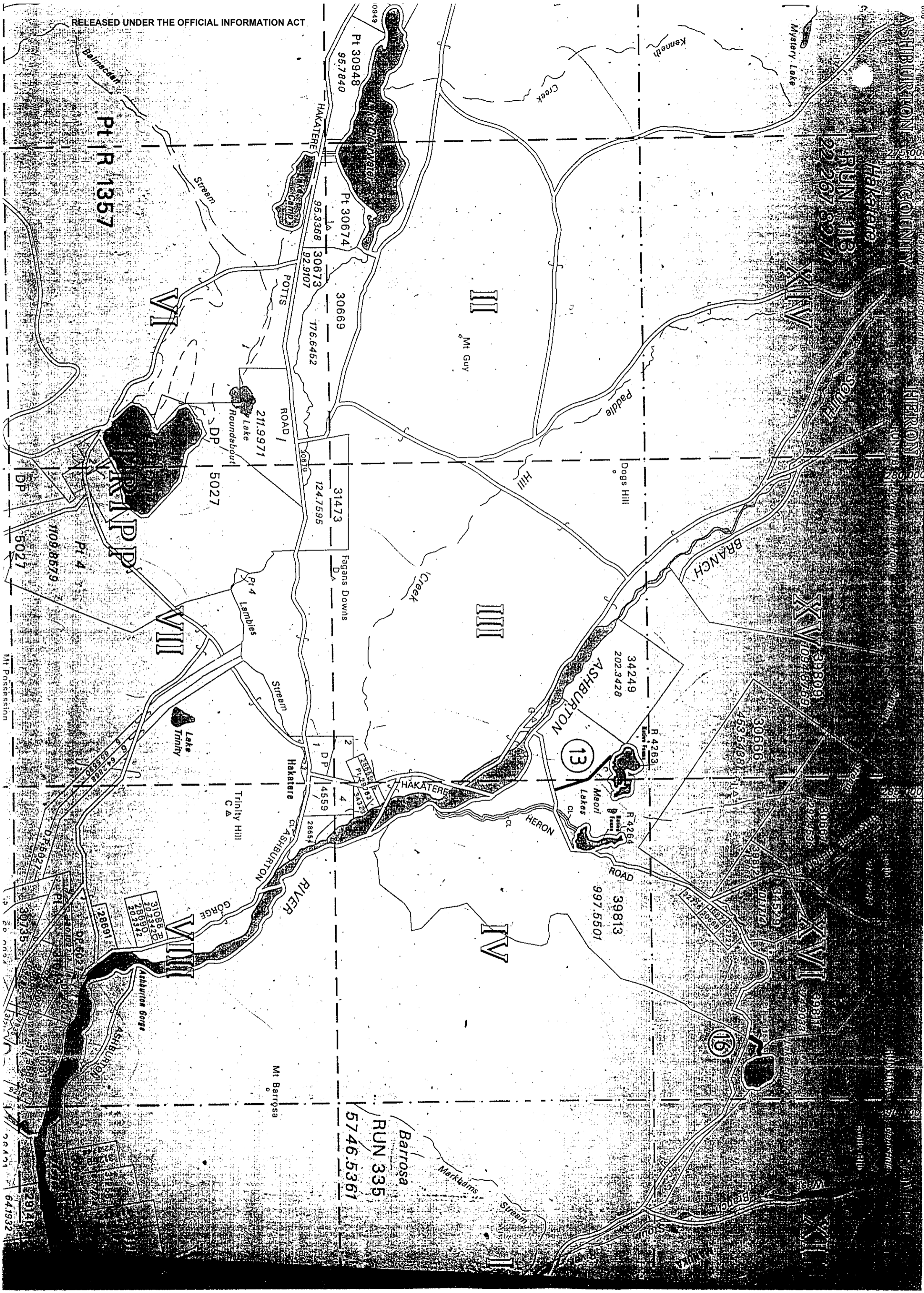

ASHBURTON COUNTY
HERON COUNTY
275,000
280,000

Battosa
RUN 335
5746.5361

29146
641932

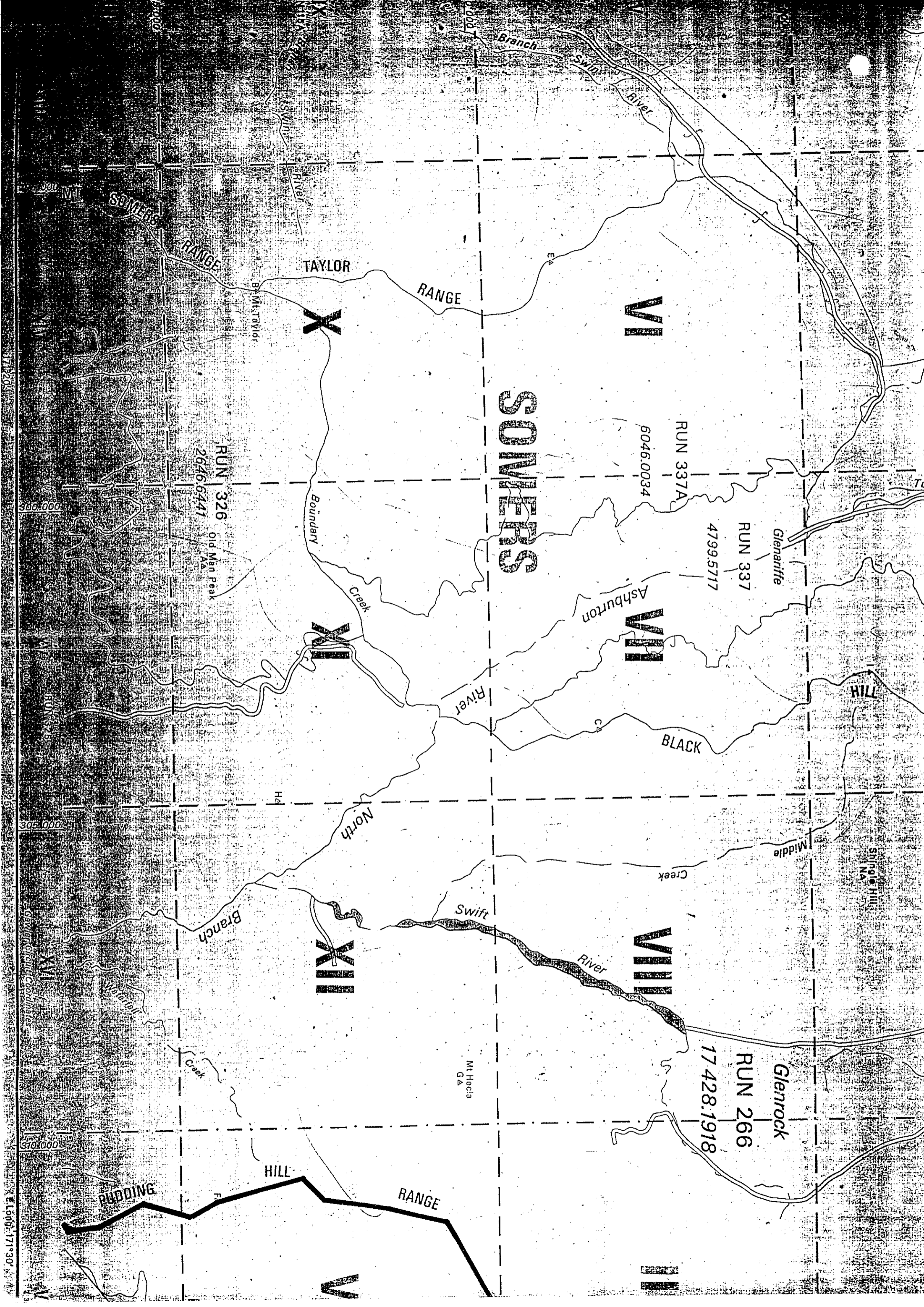

SOMERS

SOMERS RANGE

TAYLOR RANGE

VI

VII

VIII

XI

XIII

XIV

RUN 337A

RUN 337

RUN 266

RUN 326
Old Man Peak

17428.1918

6046.0034

Mt. Hecla
GA

HILL

Shingle Hill
GA

RIDDING

RANGE

NET

305.000

310.000

Geological Coordinates

171.200

171.300

171.400

171.500

DOC Consultation



Department of Conservation
Te Papa Atawhai

Our ref: PAR 019, PTR 034 PTR 076

19 September 2001

Don McGregor
McGregor Property Services
6 Cumberland Place
Kaiapoi

Dear Don

PASTORAL LEASE STATUS CHECK - CLENT HILLS AND ISLAND HILLS

I refer to your letter of 6 September 2001.

CLENT HILLS

I have checked the Department of Conservation's land records. The only areas of public conservation estate within the boundary are marginal strips. I have commented on these below. Conservation Estate does adjoin part of the property and is listed below.

The following public conservation lands adjoin the Clent Hills Pastoral Lease. These are listed clockwise from the northwestern corner of the property:

J35/6 & J35/7 = Lake Heron Nature Reserve, and associated Marginal Strips. Held under Reserves Act 1977 (Nature Reserve) and Conservation Act 1987 (Marginal Strips).

J35/8 = Lake Heron Stewardship Land (former Crown Land). Held pursuant to the Conservation Act 1987.

J35/13 = Swin River Marginal Strip. Held pursuant to the Conservation Act 1987. This marginal strip appears to have been created by the process of legislation when the lease was renewed. It does not show up on Terraview as far as I can see.

J35/14 = Mellish Stream Marginal Strip. Held pursuant to the Conservation Act 1987. This marginal strip appears to have been created by the process of legislation when the lease was renewed. It does not show up on Terraview as far as I can see.

K35/44 = Glenariffe/Winterslow Stewardship Land. Held pursuant to the Conservation Act 1987.

K36/182 = Mount Somers Retirement Land. This land is part of the yet to be completed surrender programme, and is presently Crown Land, but will come to the Department of Conservation in due course.

K36/163 Stour River Marginal Strip. This appears to be a Section 58 strip, now administered under the Conservation Act 1987.

J36/39 = Lake Emily Marginal Strip. This appears to be a Section 58 strip, now administered under the Conservation Act 1987.

J36/41, J35/12 = Manuka Lake, and Seagull Lake. These show up in our land system as being Marginal Strips, but I am not confident this is the case. According to Terraview, both Lakes have legal road surrounding them, which would negate the creation of marginal strips upon renewal. While they show up in our system, I have doubts that either waterway is subject to marginal strips.

In terms of our land information system, Clent Hills seems to be the first property I've come across where the "new" Section 24 Conservation Act 1987 marginal strips have shown up. If I am to hazard a guess, someone has inputted marginal strips as existing on the clearly identifiable waterways. In the case of Manuka and Seagull Lakes, I think such input might have been an error.

Canterbury Conservancy

Private Bag 4715, 133 Victoria Street, Christchurch, New Zealand
Telephone 03-379 9758, Fax 03-365 1388

The fact some marginal strips have been identified, does not necessarily mean that the other waterways are not subject to Marginal Strips. It is possible that there are more marginal strips that don't show up in our land information system.

It is possible that there might be concessions issued covering the Glenariffe/ Winterslow Stewardship Area, but as this is outside the area of the PL, I have not made any enquiries. It is unlikely any concessions will have been granted over Lake Heron but again as this is outside the area of the PL, I have not made any enquiries. In terms of the Marginal Strips, there will not be any concessions granted, save for those covering the vast majority of the public conservation estate in the conservancy. No concessions will have been granted for the Mount Somers retirement land.

ISLAND HILLS

Thankfully this is less complicated than Clent Hills. I have checked the Department of Conservation's land records. Conservation Estate does adjoin a part of this property and is listed below. No part of the estate is within the boundary but please note my comments below on marginal strips.

L32/501 = Lake Sumner Conservation Park. Held pursuant to the Conservation Act 1987.
M32/013 = Island Hills Stewardship Area. This is held under the Conservation Act 1987, and comprises land surrendered from the subject lease in 1990, and allocated to the Department.

With the Lake Sumner Conservation Park, there will almost certainly be concessions over this part of the public conservation estate. It is possible the Island Hills area will be subject to concessions. As both are outside the area of the PL, I have not made any enquiries.

MARGINAL STRIPS:

Clent Hills was renewed in 1991, and is subject to the new Conservation Act 1987 marginal strips, but at the same time, there are Section 58 strips in place on some waterways (i.e. Lake Emily). I cannot say for certain which waterways the new strips are associated with.

Island Hills was renewed in 1986, so there will be no Conservation Act marginal strips in place, and I cannot see a Section 58 memorial on the title, although the renewal certificate may make mention of reserving land from sale. As you know, the legality of Section 58 strips not identified on survey plans is in doubt.

It is practically impossible to identify with any certainty whether a marginal strip is in place if it is not shown on a survey plan. Some marginal strips are shown on the DOC estate maps, and others are not. If there is no marginal strip shown on our allocation records, I have not identified them. In the case of Clent Hills, there are some shown on our records, which I am not sure are marginal strips. This all adds to the uncertainty surrounding marginal strips, particularly in the SI High Country. Maps are attached as usual.

Yours faithfully



Robert Cant
Statutory Land Management Officer (Community Relations)
For Conservator, Canterbury
Email: Rcant@doc.govt.nz

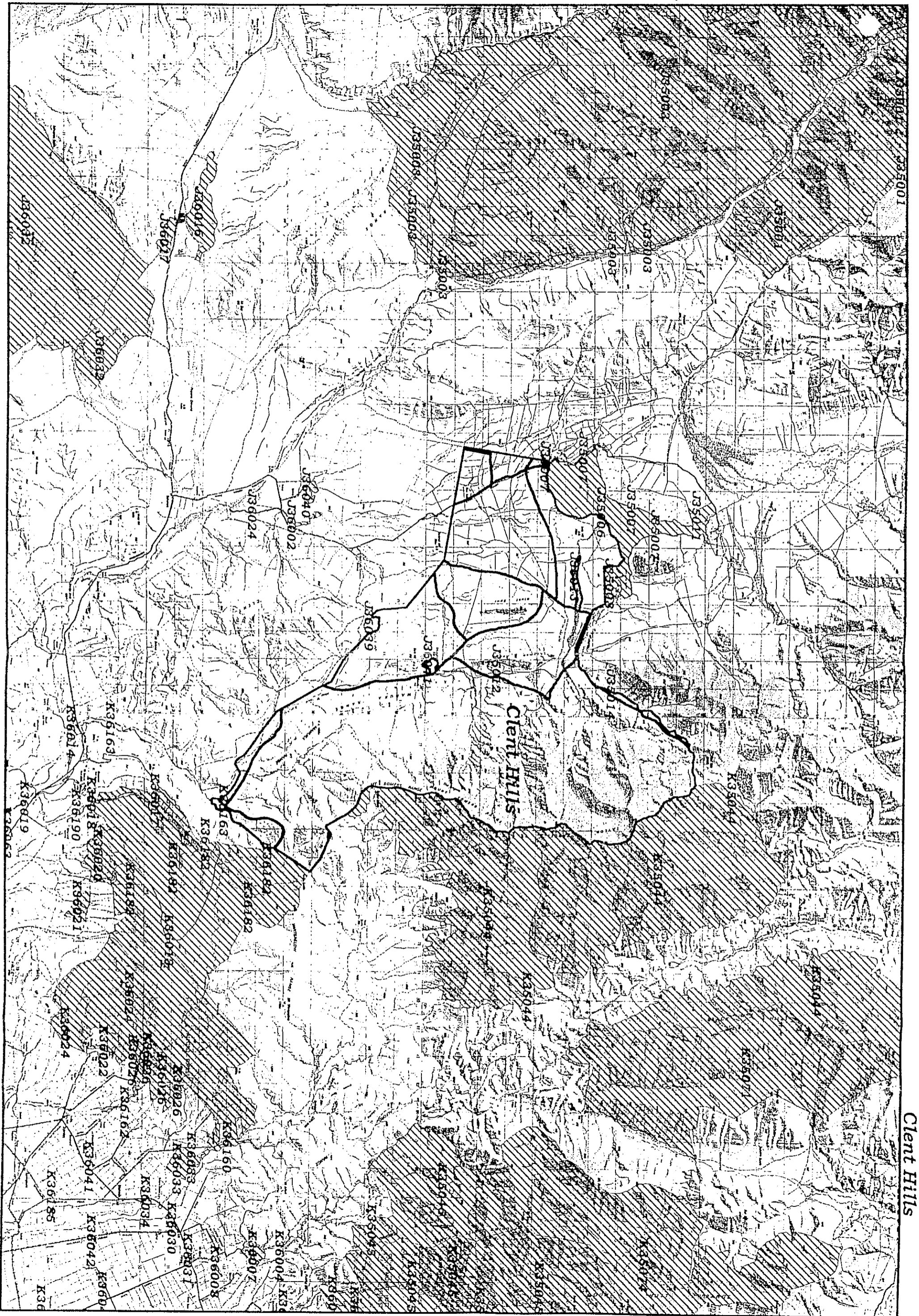

Clent Hills