

Crown Pastoral Land Tenure Review

Lease name : DOUBLE HILL

Lease number : PC 127

Designations Plan 3

A Designations Plan forms part of the Tenure Review Substantive Proposal. The attached plan is a copy of the Designations Plan included in the Substantive Proposal for the above review. The Substantive Proposal has been accepted by the Leaseholder.



A summary of the Substantive Proposal is available as part of a notice of acceptance document lodged for registration against the Landonline computer register of the leasehold Certificate of Title being CB17422. The Notice of Acceptance is a public document searchable at a LINZ processing centre or by licenced remote access to Landonline.

October

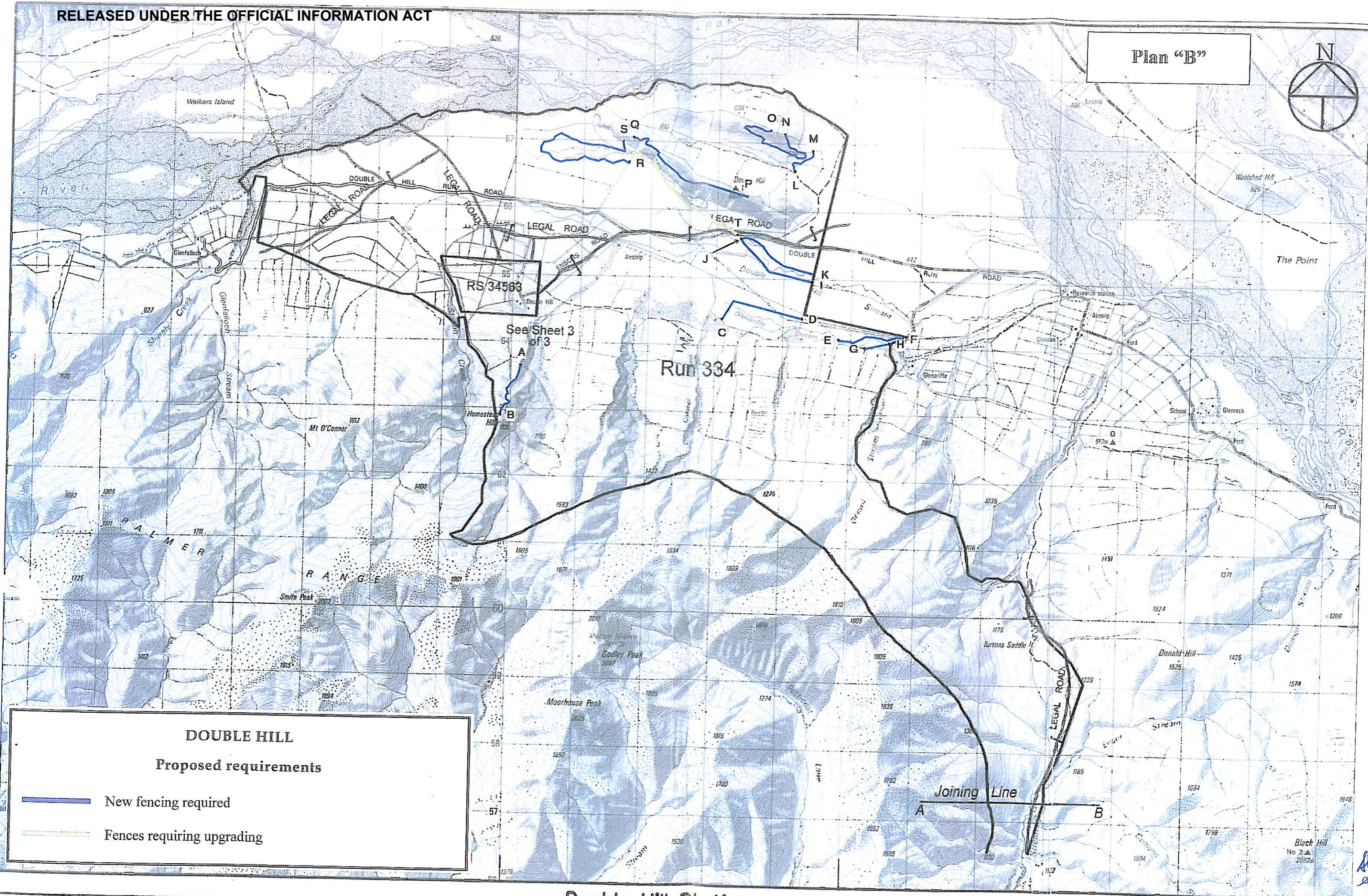
05



DOUBLE HILL
Proposed requirements

-  New fencing required
-  Fences requiring upgrading

Marginal Strip Subject to Sec 24(9)
Conservation Act 1987

Double Hill Station

Scale 1:50000

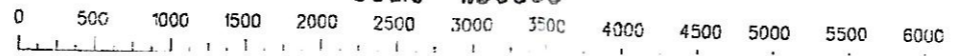

Version	1	2	3	4	5
Canterbury Land District					
Topographic Map 260 - J35, K35					
					Date 1/10/99

Handwritten initials and a signature in the bottom right corner.