

Crown Pastoral Land Tenure Review

Lease name : ESKHEAD

Lease number : PC 064

Due Diligence Report (including Status Report) - Part 6

This report and attachments results from a pre-Tenure Review assessment of the pastoral lease for the purpose of confirming land available for Tenure Review and any issues, rights or obligations attaching to it. The information is gathered from files and other sources available to the LINZ contractor.

Part of the information relates to research on the status of the land, resulting in a Status Report that is signed off by a LINZ approving officer. The remainder of the information is not analysed for relevancy or possible action until required, and LINZ does not guarantee its accuracy or completeness as presented.

The report attached is released under the Official Information Act 1982.

April 09

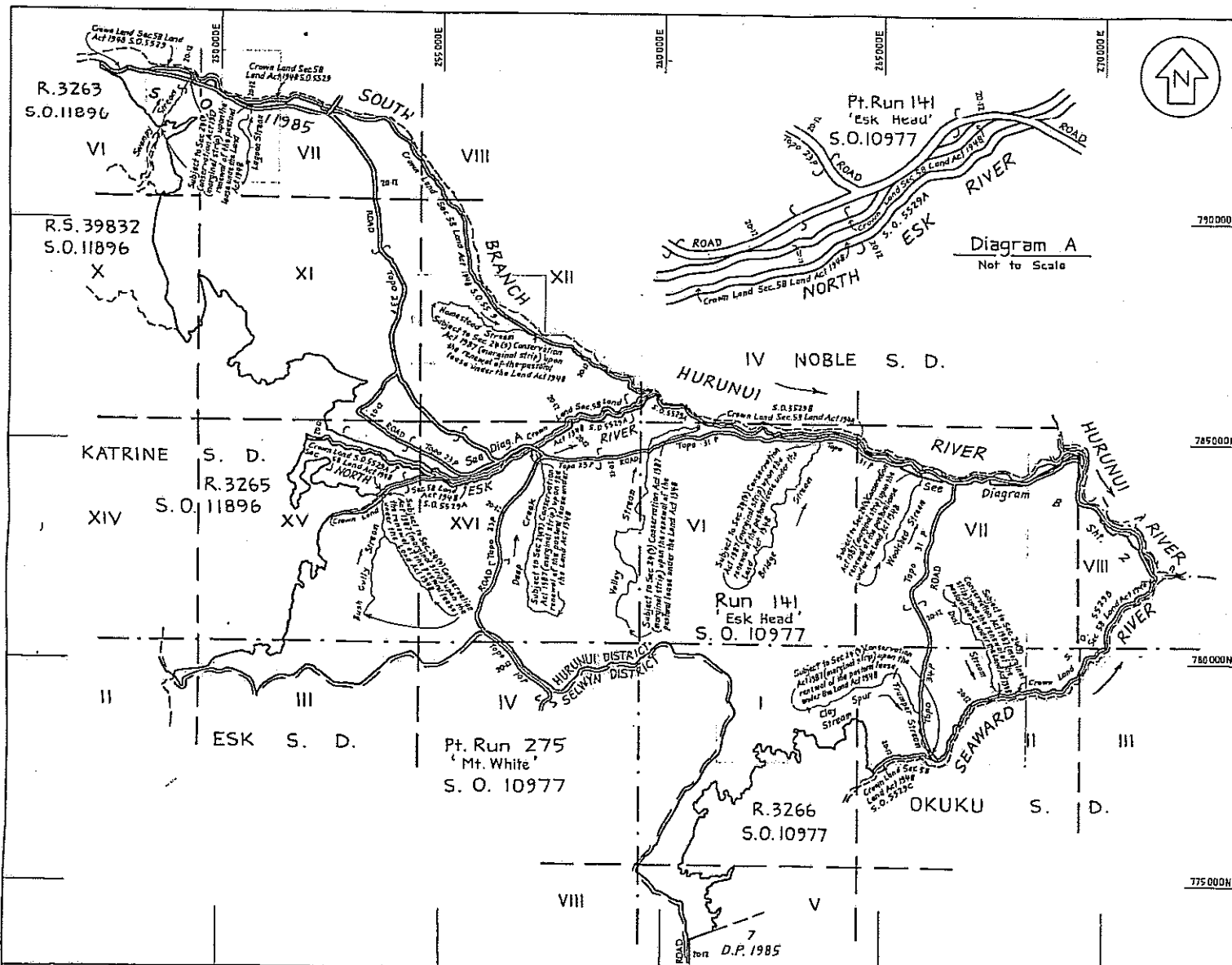

Approvals	
Total Area _____	
Comprised in <u>C.L. 529/43</u>	
I, <u>DEREK EDWARD BROWN</u> Registered Surveyor and holder of an annual practicing certificate for who may act as a registered surveyor pursuant to section 25 of the Survey Act 1986 hereby certify that this plan has been made from surveys executed by me or under my directions, that both plan and survey are correct and have been made in accordance with the Survey Regulations 1972 or any regulations made in substitution thereof. Dated at <u>Christchurch</u> on <u>5th</u> day of <u>June</u> 1992. Signature <u>D.E. Brown</u>	
Field Book _____	Traverse Book _____
Reference Plans <u>S.O. 11896, 11897, 11898, 11899, 11900, 11901, 11902, 11903, 11904, 11905, 11906, 11907, 11908, 11909, 11910, 11911, 11912, 11913, 11914, 11915, 11916, 11917, 11918, 11919, 11920, 11921, 11922, 11923, 11924, 11925, 11926, 11927, 11928, 11929, 11930, 11931, 11932, 11933, 11934, 11935, 11936, 11937, 11938, 11939, 11940, 11941, 11942, 11943, 11944, 11945, 11946, 11947, 11948, 11949, 11950, 11951, 11952, 11953, 11954, 11955, 11956, 11957, 11958, 11959, 11960, 11961, 11962, 11963, 11964, 11965, 11966, 11967, 11968, 11969, 11970, 11971, 11972, 11973, 11974, 11975, 11976, 11977, 11978, 11979, 11980, 11981, 11982, 11983, 11984, 11985, 11986, 11987, 11988, 11989, 11990, 11991, 11992, 11993, 11994, 11995, 11996, 11997, 11998, 11999, 12000</u>	
Examined <u>[Signature]</u>	Current _____
Approved for Record Purposes <u>23/7/92</u> <u>R. Moulton</u> Deputy Chief Surveyor	
Deposited this _____ day of _____ 19__	
District Land Registrar	
File <u>7100-02</u>	SO18875
Received <u>23.7.92</u>	
Instructor <u>B.G.934</u>	

LAND DISTRICT Canterbury
 Survey Blk. & Dist. As Shown
 L33 L33-50000 1/2, 2, 3
 NZMS 261 Sheet M33 Record Map No. M33-10000 1/2, 2, 3

Waterways in Pastoral Lease No 529/43
 along which Sec. 24 Conservation Act 1987 applies

TERRITORIAL AUTHORITY Hurunui District
 Compiled by Dept. of Survey & Land Information
 Scale 1: 60000 Date May 1992

RELEASED UNDER THE OFFICIAL INFORMATION ACT

S.O.10977

S.60

S.O.10977

S. O. 11985

S
O
1
1
0
8
4
L

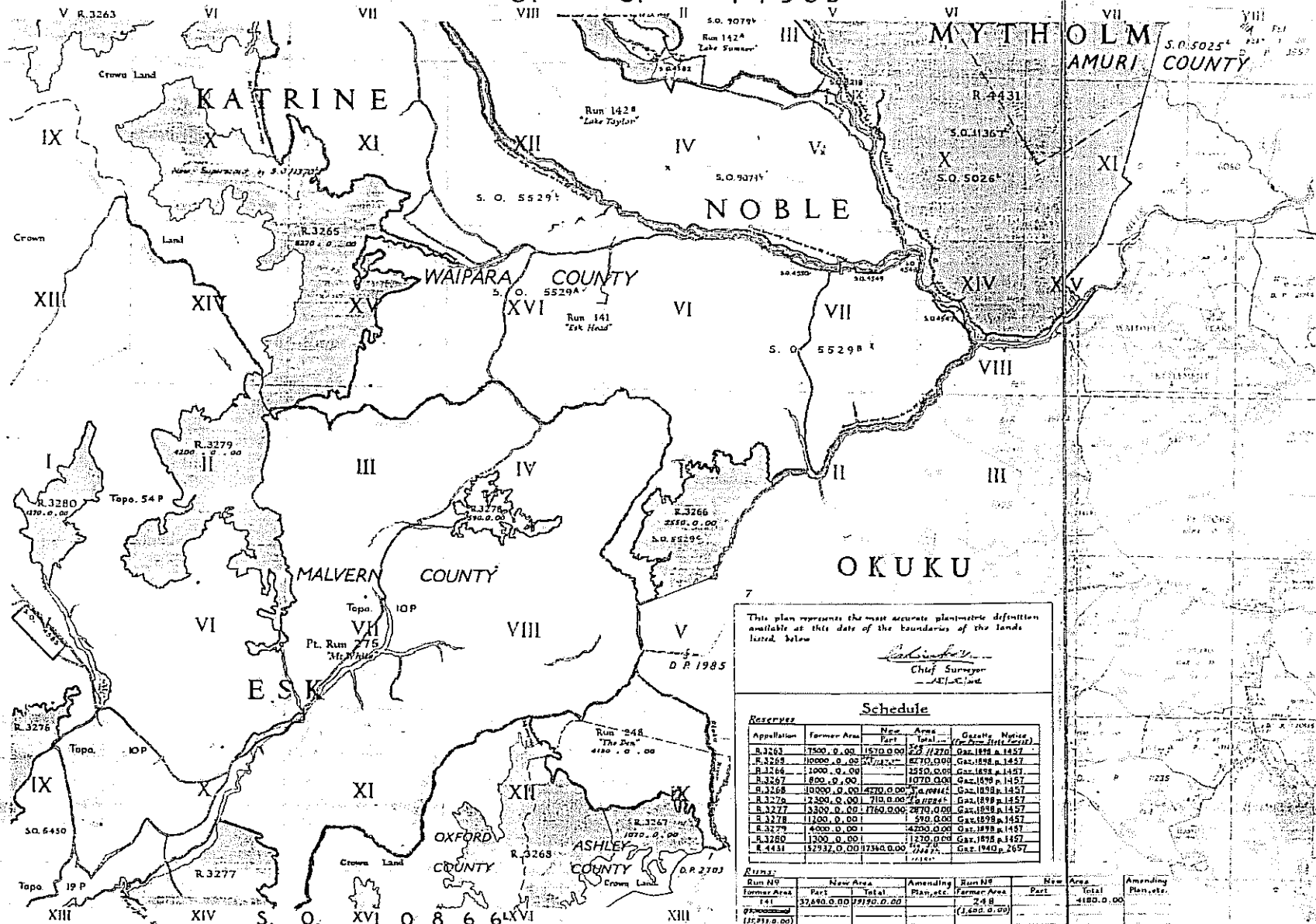

This plan represents the most accurate planimetric definition available at this date of the boundaries of the lands listed below

Calverley
Chief Surveyor
N.E.C. Ltd.

Schedule

Appellation	Former Area		New Area		Gazette Notice (or Date of Vesting)
	Part	Total	Part	Total	
R.3263	17500.0.00	16700.000	223	11270	Gaz. 1898 p. 1457
R.3265	10000.0.00	10700.000	6270	6270.000	Gaz. 1898 p. 1457
R.3266	1000.0.00	1070.000	1070	1070.000	Gaz. 1898 p. 1457
R.3267	800.0.00	1070.000	1070	1070.000	Gaz. 1898 p. 1457
R.3268	10000.0.00	10700.000	5,000	5,000.000	Gaz. 1898 p. 1457
R.3270	12300.0.00	11700.000	5,000	5,000.000	Gaz. 1898 p. 1457
R.3277	13300.0.00	11600.000	2170	2170.000	Gaz. 1898 p. 1457
R.3278	11300.0.00	11600.000	500	500.000	Gaz. 1898 p. 1457
R.3279	4000.0.00	4200.000	4200	4200.000	Gaz. 1898 p. 1457
R.3280	1300.0.00	1270.000	1270	1270.000	Gaz. 1898 p. 1457
R.4431	15292.0.00	15292.000	15292	15292.000	Gaz. 1940 p. 2657

Run No.	Part	New Area	Amending Plan, etc.	Run No.	Part	New Area	Amending Plan, etc.
141		37,650.0.00	12,910.0.00	248		4180.0.00	
142A		2,415.0.00	See S.O. 11985	275		62,210.0.00	See S.O. 11084
142B		13,720.0.00	18,040.0.00				

Note: All Runs are subject to Sec. 38, Land Act, 1948, along rivers and creeks over 10 ft. wide.

Scale: 60 chains to an inch, approx.

Roads shown coloured Burnt Sienna are Legal Roads.

S.O.10977

10977

S O 11985

S O 11985

en to file)

LAKE SUMNER

LAKE SUMNER
87 45 172 5111 50

This plan represents the most accurate planimetric definition available at this date of the boundaries of the lands listed below.

M. J. ...
Chief Surveyor
26. 3. 72

Schedule

Appellation	Former Area	New Part	Total	Gazette Notice
P.R. 4380	4688-0-00	1780-0-00	6468-0-00	S.O. 11977
P.R. 4381	34071-0-00	1810-0-00	35881-0-00	S.O. 11985
P.R. 4382	120-0-00	180-0-00	300-0-00	S.O. 11985
P.R. 4374	1079-0-00	1970-0-00	3049-0-00	S.O. 11985

Run/No	Former Area	New Part	Total	Amending Particulars
Run 141 (11091 a. 00)	1800-0-00	See S.O. 11977		
Run 142 (1043 a. 00)	8170-0-00	10595-0-00		
Run 142B (1024 a. 00)	9100-0-00	See S.O. 11977		
Run 255 (1038 a. 00)	3340-0-00			
Run 286 (1130 a. 00)	3320-0-00	See S.O. 11977		
Run 286 (1072 a. 00)	See S.O. 351	1043-0-00	See S.O. 11985	
Run 286 (1100 a. 00)	2920-0-00	See S.O. 11985		

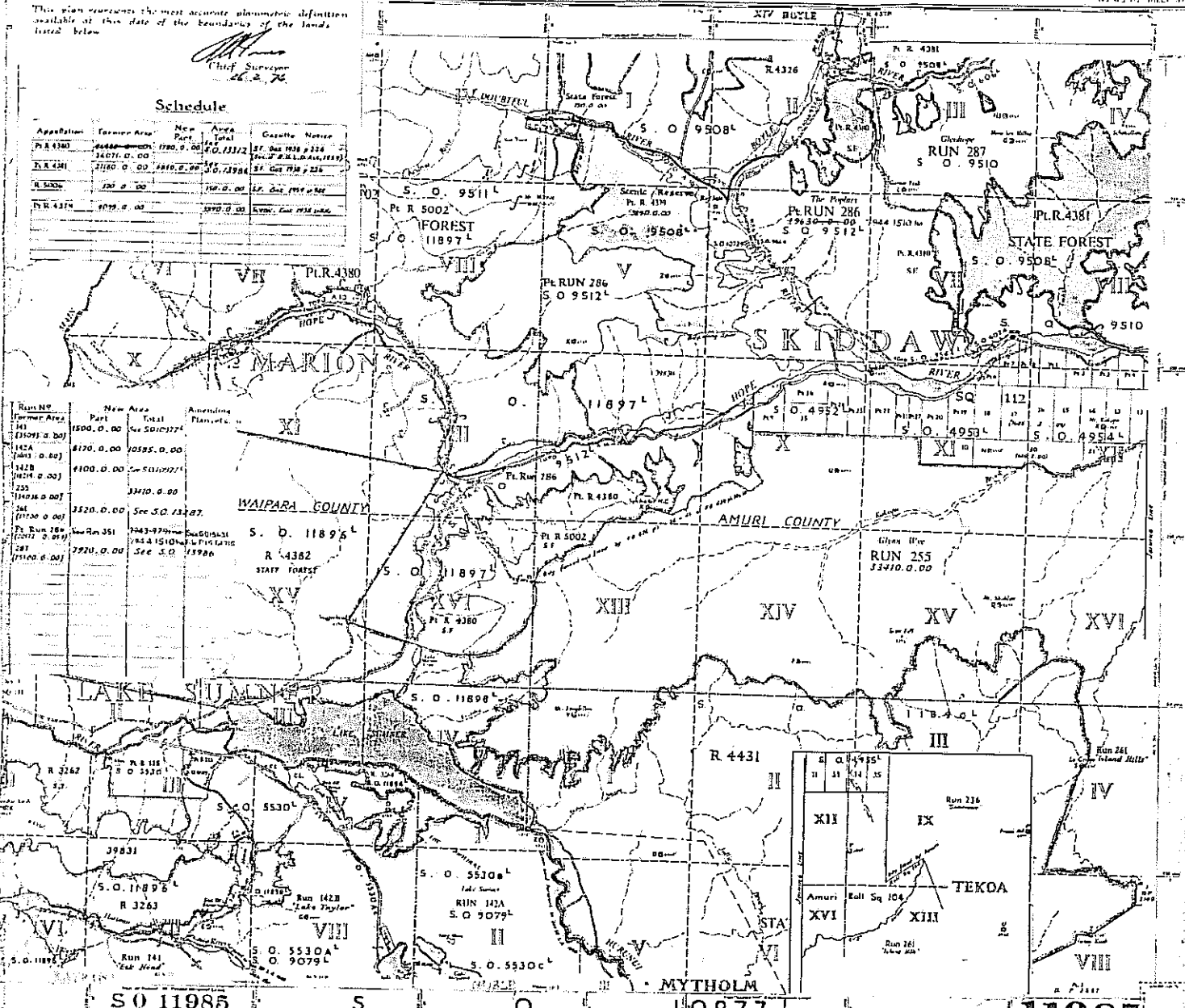

S O 11985

S

O

10977 L

11985

Scale - 1:63360 (1-Inch to 1-Mile) Scale - 60 chns to an inch (approx)

Curved & ...
 1. All ...
 2. ...
 3. ...
 4. ...
 5. ...
 6. ...
 7. ...
 8. ...
 9. ...
 10. ...

Notes:
 1. All ...
 2. ...
 3. ...
 4. ...
 5. ...
 6. ...
 7. ...
 8. ...
 9. ...
 10. ...

Scale:
 0 100 200 300 400 500 600 700 800 900 1000
 Feet
 0 100 200 300 400 500 600 700 800 900 1000
 Meters

INDEX TO COUNTY INTERESTS AND AMENDING DEEDS

S.O.	S.A.	S.T.	C.R. 11 PASHO
S.O.	S.A.	S.T.	C.R. 11 MCGON
S.O.	S.A.	S.T.	C.R. 11 MIDDLE
S.O.	S.A.	S.T.	C.R. 11 LAKE SUMNER
S.O.	S.A.	S.T.	C.R. 11 KATHIE
S.O.	S.A.	S.T.	C.R. 11 HOLE
S.O.	S.A.	S.T.	C.R. 11 WYNDHAM
S.O.	S.A.	S.T.	C.R. 11 WILSON

GAZETTE REFERENCE

S.O.	S.A.	S.T.	C.R. 11 PASHO
S.O.	S.A.	S.T.	C.R. 11 MCGON
S.O.	S.A.	S.T.	C.R. 11 MIDDLE
S.O.	S.A.	S.T.	C.R. 11 LAKE SUMNER
S.O.	S.A.	S.T.	C.R. 11 KATHIE
S.O.	S.A.	S.T.	C.R. 11 HOLE
S.O.	S.A.	S.T.	C.R. 11 WYNDHAM
S.O.	S.A.	S.T.	C.R. 11 WILSON

RELEASED UNDER THE OFFICIAL INFORMATION ACT



S.O.5529A

S.O.5529A

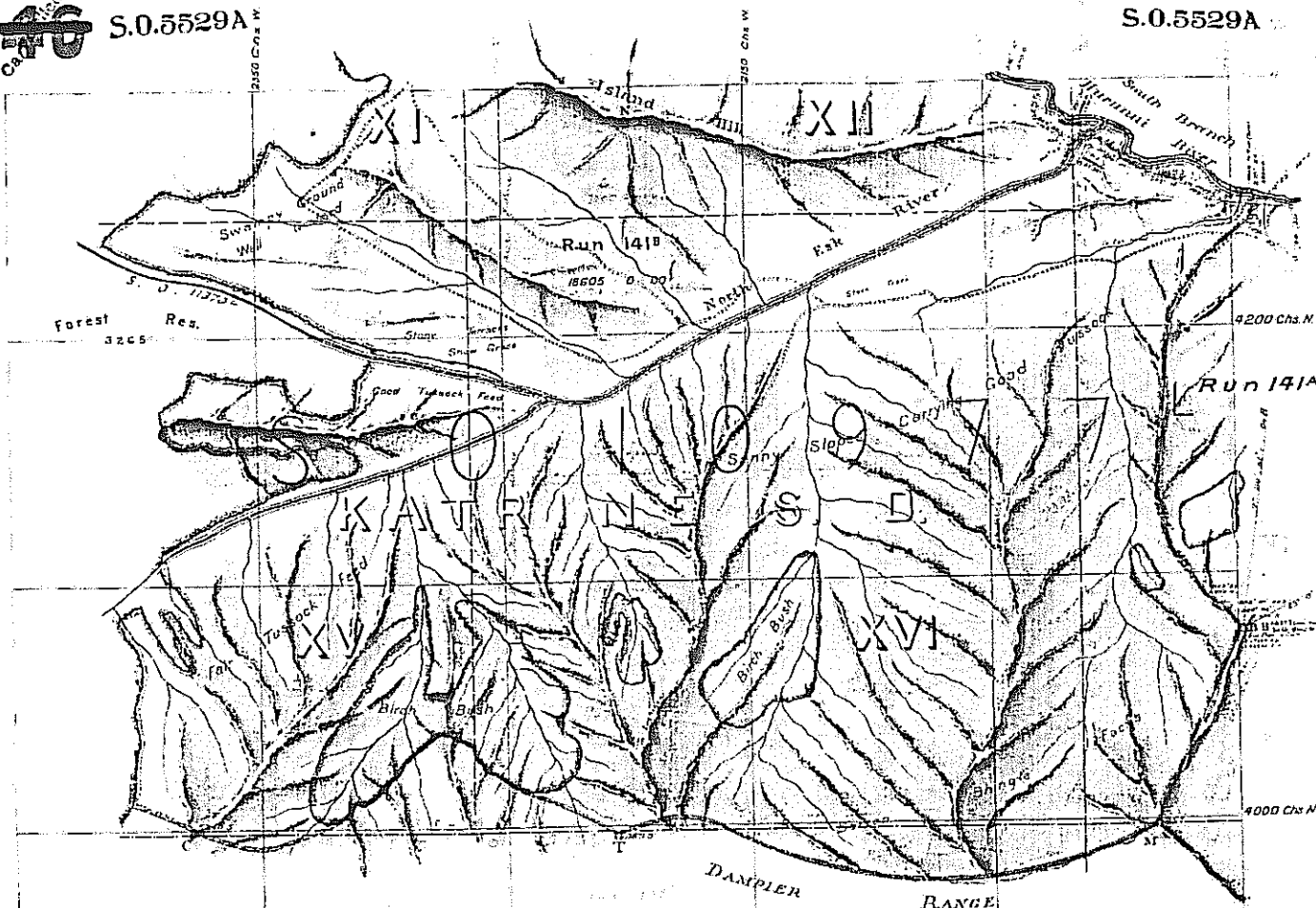

PLAN OF
RUN 141^B "ESK HEAD"
KATRINE NOBLE & ESK S. D.

Surveyed by F. H. Waters
Jan. 1918

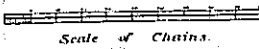

Approved
[Signature]
Chief Engineer
Dec 23 1918

N.B. For Home East Side of Run 141^B
See plan No. 1152

FILED 2015
REGISTERED
FILED
INDEXED
JAN 23 1918
S.O. 5529A

S.O.5529A

5529A

RELEASED UNDER THE OFFICIAL INFORMATION ACT

HAS
Camp

S.O.5529

S.O.5529

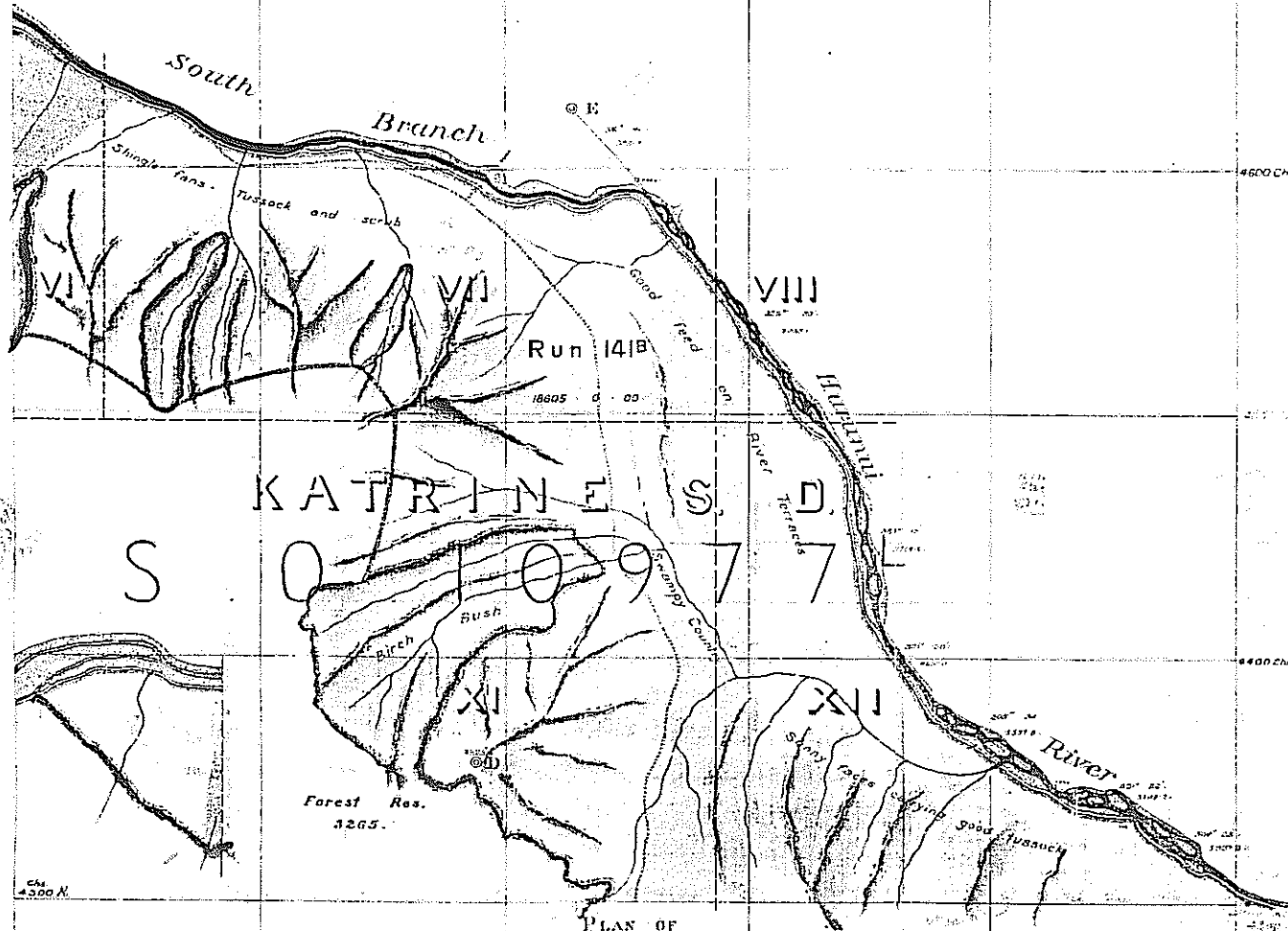

PLAN OF
RUN 141^B ESK HEAD
KATRINE S. D.

Surveyed by F. H. Waters
 Jan. 1918



Approved
[Signature]
 Chief Surveyor
 Date: 1. 2. 1918

N.B.
 The Homestead Sls. of Run 141^B
 See plan N° 1150

1918
 1919
 1920
 1921
 1922
 1923
 1924
 1925
 1926
 1927
 1928
 1929
 1930
 1931
 1932
 1933
 1934
 1935
 1936
 1937
 1938
 1939
 1940
 1941
 1942
 1943
 1944
 1945
 1946
 1947
 1948
 1949
 1950
 1951
 1952
 1953
 1954
 1955
 1956
 1957
 1958
 1959
 1960
 1961
 1962
 1963
 1964
 1965
 1966
 1967
 1968
 1969
 1970
 1971
 1972
 1973
 1974
 1975
 1976
 1977
 1978
 1979
 1980
 1981
 1982
 1983
 1984
 1985
 1986
 1987
 1988
 1989
 1990
 1991
 1992
 1993
 1994
 1995
 1996
 1997
 1998
 1999
 2000

S.O.5529

5529

1149

S.O. 5529C

S.O. 5529C

OKUKU S. D.

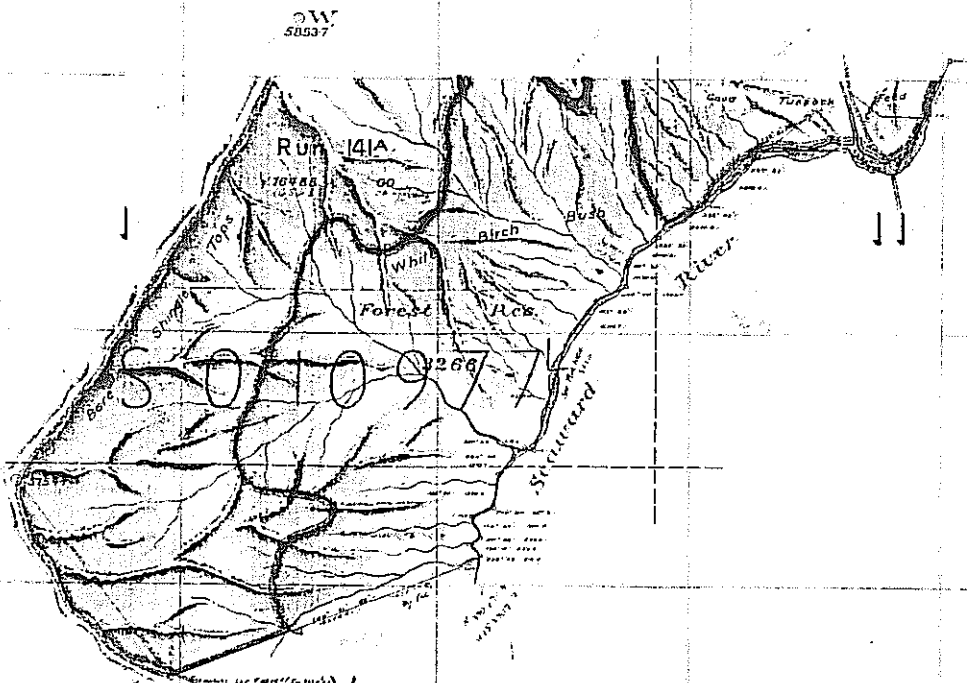

PLAN OF
RUN 141A "ESK HEAD"

OKUKU S. D.

Surveyed by F.H. Waters
 January 1918

Scale of Chains

Approved
[Signature]
 Chief Surveyor
 Date: 2. 2. 1918

RECORDED
 INDEXED
 FILED
 THE NEW BRUNSWICK ARCHIVES
 HERIOTVALE (1957) 22/25
 Released by: 1-2-2018

S.O. 5529C

5529 C

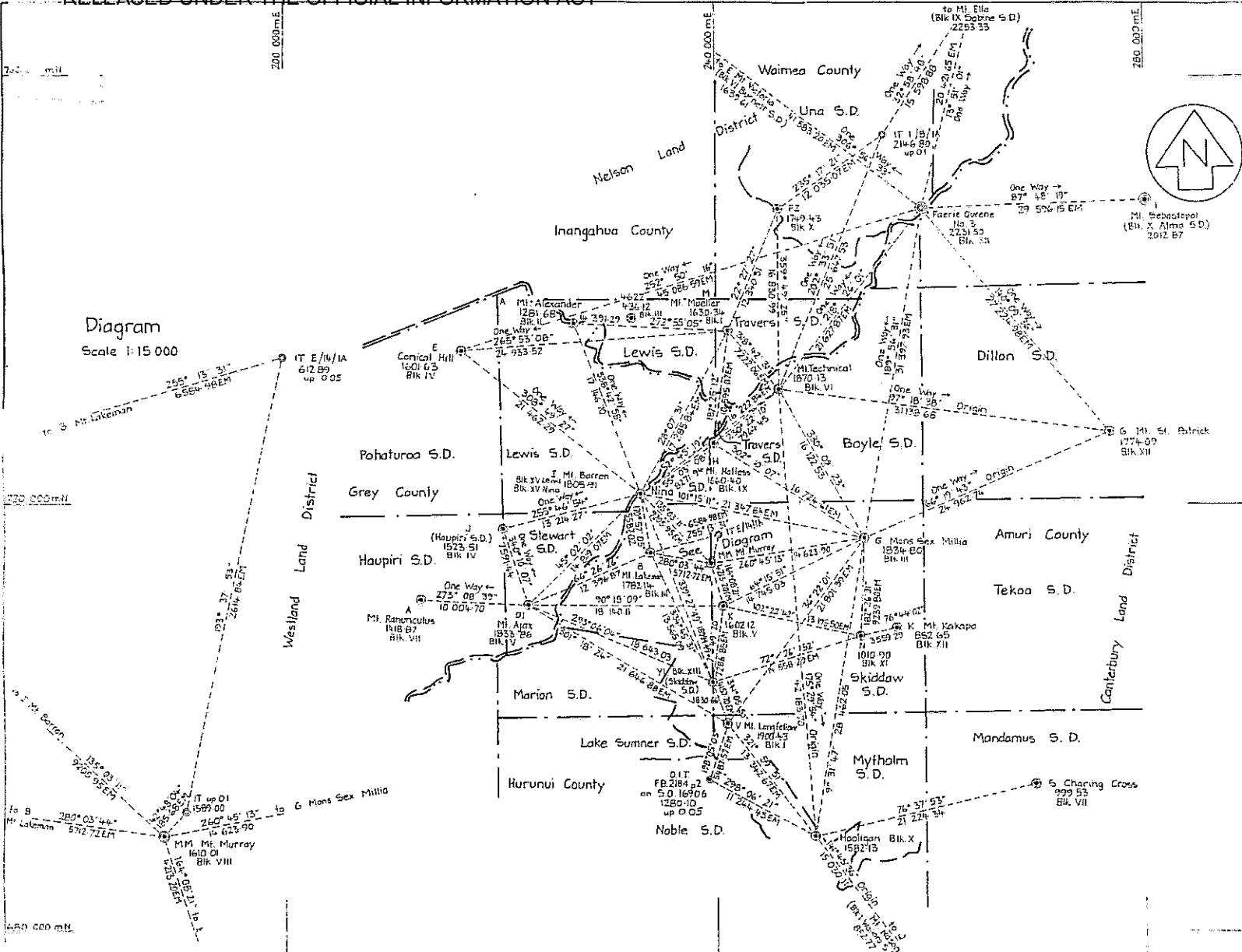

Diagram
Scale 1:15 000

Approvals
Notes: For location of Photo IN/EPs see Plan Sheets
Distances are Spheroidal
Unless otherwise shown distances are Calculated

Bearing Datum: Geodetic
Origin of Bearings: N 51 Cards
Coordinate Datum: Geodetic
Amuri Circuit Coordinates
Circuit Origin: Isolated Hill 700 000mN
300 000mE
Origins Points: Hooligan, G Mons Sex Millia,
& G Mt. St. Patrick

Table of Coordinates

Hooligan	688 708 67mN	249 246 44mE
G Mons Sex Millia	716 778 74	253 958 76
G Mt. St. Patrick	726 801 25	276 821 55
IT 1/8/1A	754 448 56	255 777 16
IT E/14/1A	717 106 39	240 266 81
IT	714 565 10	239 650 54
OIT FB 2184 p 2 on S.O.16906	694 006 16	239 327 58

Origin of Height : US 77, US 78, US 87,
NA 90 & 4-622
Height Datum : MSL, LyHaiton 1937.

Total Area _____
Comprised in _____

Derek Edward Brown
Registered Surveyor and holder of an annual practising certificate in accordance with section 25 of the Survey Act 1958 hereby certifies that this plan has been made from surveys conducted by me or under my direction, that both plan and survey are correct and have been made in accordance with the Survey Regulations 1977 or any regulations made in substitution thereof
Dated at Christchurch this 27th day of February 1985
of _____ 1985 Signature _____
Field Book _____

Approved as to Survey
27/2/85
Deposited this _____ day of _____ 1985

LAND DISTRICT Canterbury, Nelson & Westland
Survey Blk. & Dist. See plan face
NZMS 261 Sheet L31, L32, M30, M31, M32 & M33

Lewis Pass Photo Control
TERRITORIAL AUTHORITY Amuri, Hurunui, Grey,
Inangahua & Waimea Counties
Surveyed by D.E. Brown
Scale 1:250 000 Date February 1985

District Land Registrar
17/1/85

"RELEASED UNDER THE OFFICIAL INFORMATION ACT"

General Survey Department of New Zealand
Provincial District of Canterbury

1282
Small Plot

FIELD BOOK 272 pages 7071
1847. REGD. 1 Sheet
ACQUIRED July 1888
EXAMINED 1.11.58 Plot
REGISTERED

data from 7000000
from Surveyor

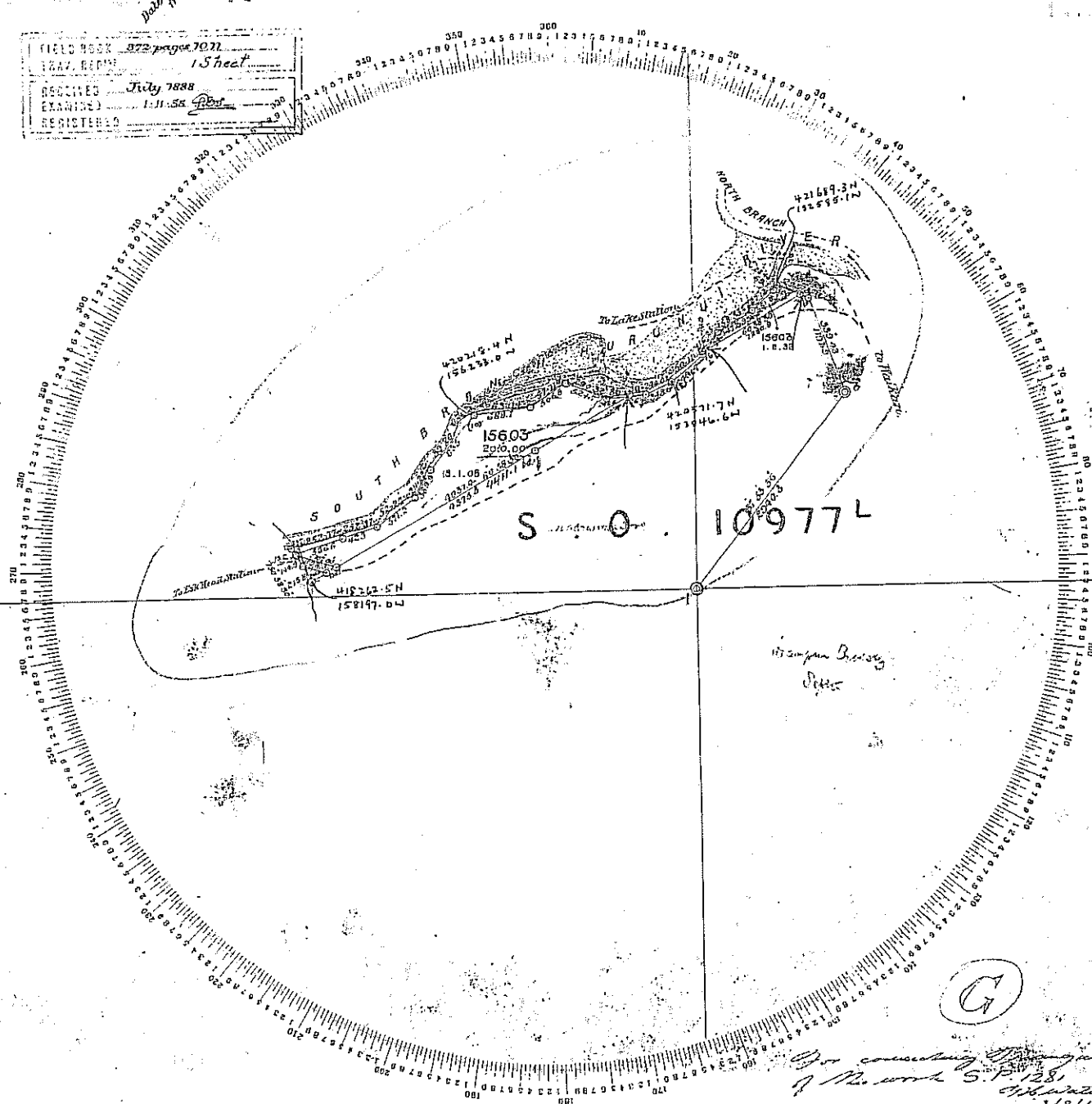

For consulting the regulations
of the work S.P. 128
3/3/18

Field Plan of application Section 15603

Survey Office No. Block 111 Noble District

Surveyed by Joseph J. Mitch

Date 20 April 1888

4548

Scale 10 Chains to an Inch

NOTE. Measured lines to be drawn in red, calculated or scaled lines in black, observed bearings in blue, the figures also being in red, black or blue respectively. Draw a red circle round each trig, a double red circle round each trig station. Remarks of Surveyor to be noted on back hereof.

System Time 11.14.18

General Survey Department of New Zealand
Provincial District of Canterbury

1283
Canterbury
(Small Plot)

Date when received
from Surveyor

FIELD BOOK	872 pages 77, 72
TRAV. REG.	15 sheet
RECEIVED	July 1888
EXAMINED	1.11.88
REGISTERED	

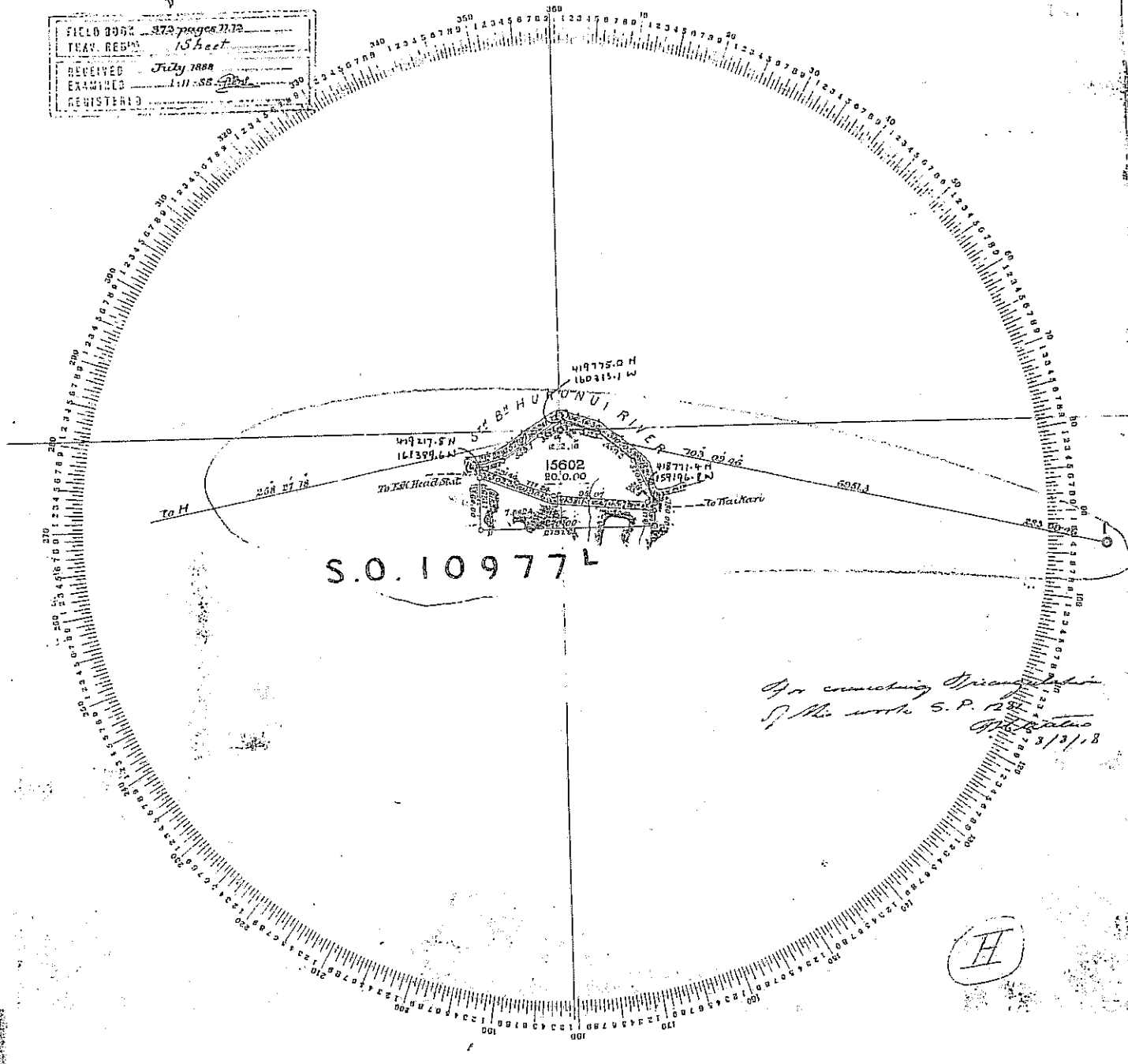

Field Plan of application, Section 15602

Survey Office No. Black 70 Noble District
 Surveyed by Joseph Melch Date 26 April 1888
 4549

Scale 70 Chains to an Inch

NOTE. Measured lines to be drawn in red. Calculated or scaled lines in black. Observed bearings in blue the figures also being in red black and blue respectively.
 Draw a red circle round each peg, a double red circle round each trig station. Remarks of Surveyor to be noted on back hereof.

Lytelton Times Oct 4 1888

General Survey Department of New Zealand
Provincial District of Canterbury

1281a
CANCEN
(CANCEN Plot)

372 pages 11 to 15, 18
1 Sheet

July 1888
26-11-88

Note with notebook
from Surveyor

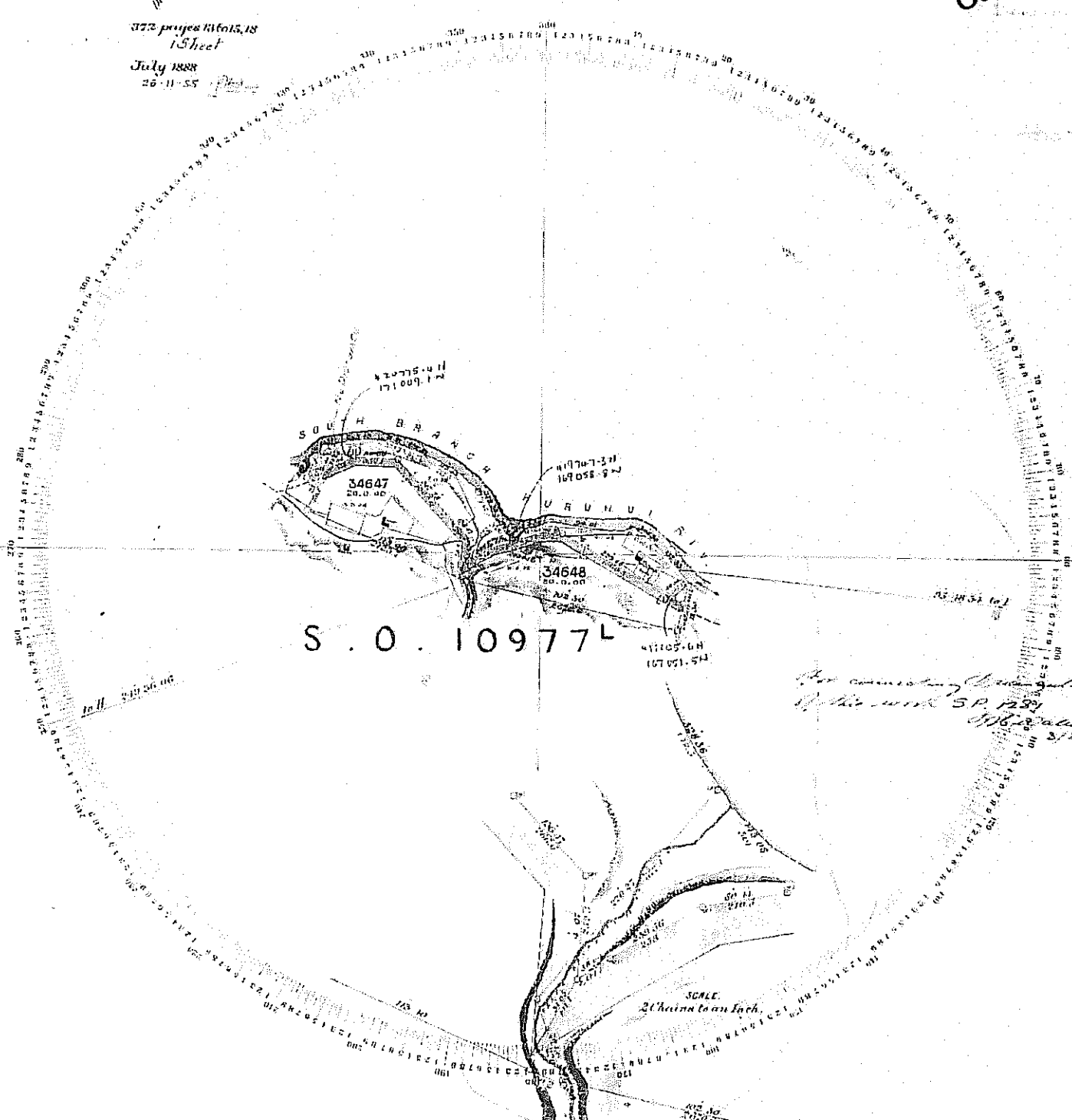

For connecting the boundary
of the work SP 1281
with the
SP 1281

Field Plan of application Sections 34647, 34648 (East Head Station) Survey Office No. 110077
Surveyed by *John S. H. H. H.* Block 7th 110077 District
Date 12th May 1888

Scale 10 Chains to an Inch

NOTE: Measured lines to be drawn in red, calculated or scaled lines in black. Observed bearings in blue the figures also being in red, black. Draw a red circle round each peg, a double red circle round each try station. Remarks of Surveyor to be noted on back of plan.

4550

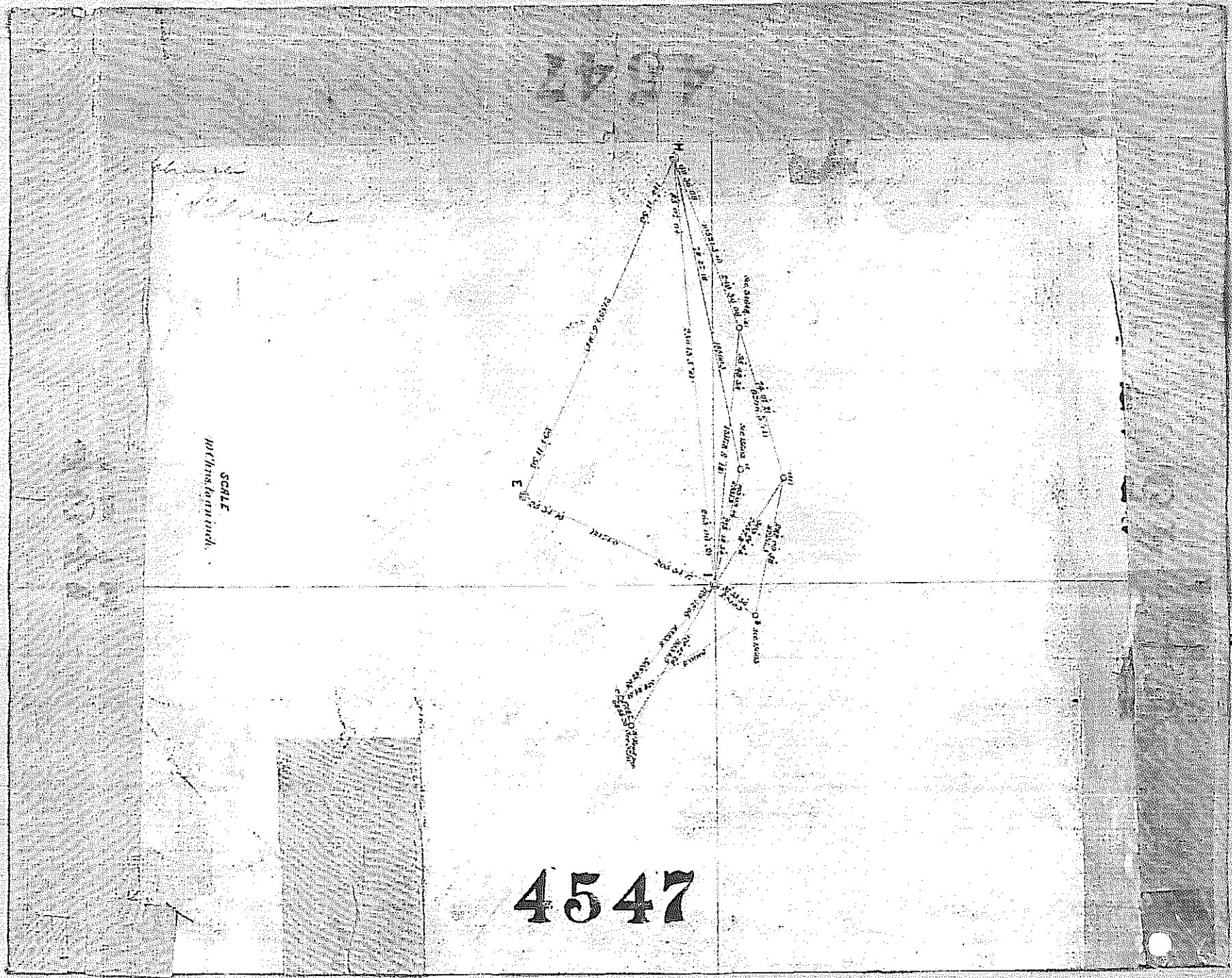

SCALE
10" = 1000 feet

4547

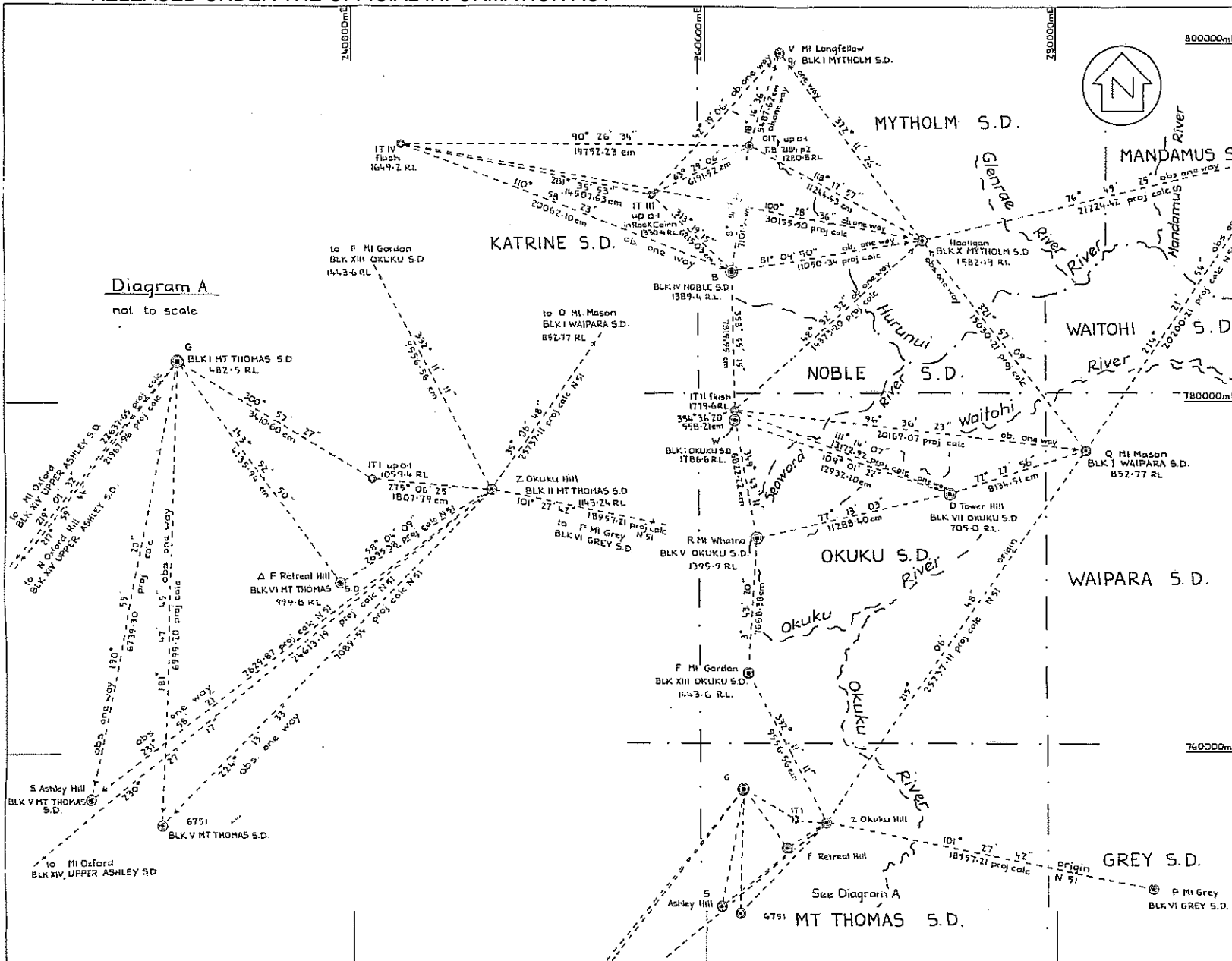

Diagram A
not to scale

Approvals
Height datum MSU Lyttelton 1937
Heights were derived from Reciprocal
Vertical Angles
Origin Heights : Z Okuku Hill 1143.24 m
Q Mt Mason 852.77 m
OIT, Fbk 2184 p 2 1280.8 m

Bearing Datum: Geodetic
Origin of Bearings: N 51 Cards
Coordinate Datum: Geodetic
Mt. Pleasant Circuit
Circuit Origin: Mt Pleasant
700000 mN 300000 mE

Origin Points:

Q Mt Mason + Z Okuku Hill from N 51 Cards

Table of Coordinates:

	mN	mE
I.T. IV	794481.68	242744.80
O.I.T	794329.04	262496.99
I.T. III	791964.91	256956.64
B	787300.82	261478.36
Hooligan	788998.25	272397.55
I.T. II	779482.13	261625.72
Q Mt Mason	777161.96	281620.89
W	778926.38	261678.20
R Mt Whatno	772213.55	262895.75
F Mt Gardon	764561.20	262397.93
G	758023.98	262131.54
Z Okuku Hill	756108.56	266877.07

Total Area

Comprised in

1. Brian John Butters
Registered Surveyor and holder of an annual practicing certificate for who may act as a registered surveyor pursuant to the proviso to section 33(2) of the Surveyors Act 1960 hereby certify that this plan has been made from surveys executed by me or under my directions that both plan and survey are correct and have been made in accordance with the Survey Regulations 1972

Dated at CHRISTCHURCH this 25th day of October 1986 Signature

Examined [Signature] Chief Surveyor

Approved as to Survey

2/2/87 [Signature] Chief Surveyor

Deposited this day of 19

District Land Registrar

LAND DISTRICT CANTERBURY
SURVEY BLK. & DIST. See Plan Face
NZMS 261 SHT L33, L34 RECORD MAP No M32-34

SURVEY CONTROL

TERRITORIAL AUTHORITY Hurunui County
Surveyed by BJ Butters
Scale 1:150000 Date Nov '85 - Feb '86

File 3/26/0
Retrieved 4/10/02
Instructions 3/10/02

5016906

RELEASED UNDER THE OFFICIAL INFORMATION ACT

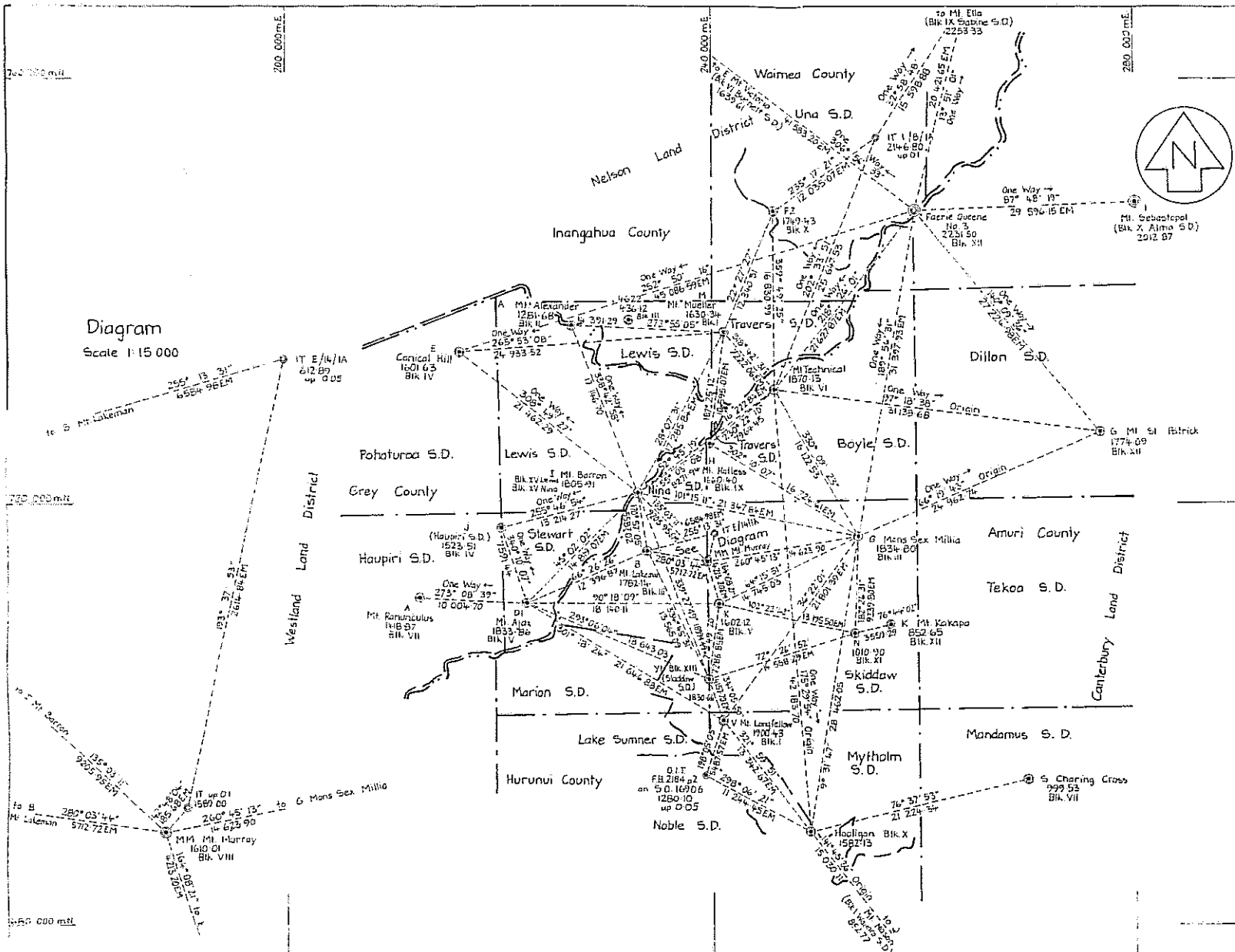

Approvals
 Notes: For location of Photo N.Y.C.P.s see Title Deeds
 Distances are Spheroidal
 Unless otherwise shown distances are calculated

Bearing Datum: Geodetic
 Origin of Bearings: N 51 Cards
 Coordinate Datum: Geodetic
 Amuri Circuit Coordinates
 Circuit Origin: Isolated Hill 700 000 mN
 300 000 mE

Origins Points: Hooligan, G Mans Sex Millia,
 & G Mt St Patrick

Table of Coordinates

Hooligan	688 708.67 mN	249 246.44 mE
G Mans Sex Millia	716 778.74	253 958.76
G Mt St Patrick	726 801.25	276 821.55
IT 1/14/1A	754 448.56	255 777.16
IT E/14/1A	717 106.39	240 266.81
IT	714 565.10	239 650.54
OIT FB 2184 p.2 on S.O. 16906	694 006.16	239 327.58



Diagram
 Scale 1:15 000

Origin of Height: UB 77, UB 78, UB 87,
 NA 90 & 4-622
 Height Datum: MSL, Lyttelton 1937.

Total Area _____

Comprised in _____

I, Derek Edward Brown
 Registered Surveyor and holder of an annual practicing certificate for who
 may act as a registered surveyor pursuant to section 25 of the Survey Act
 1958 hereby certify that this plan has been made from surveys executed
 by me or under my direction, that both plan and survey are correct and
 have been made in accordance with the Survey Regulations 1952 or any
 regulations made in substitution thereof.

Dated at _____ this _____ day of _____
 of _____ 1988 Signed _____

Field Book _____
 Field Books: 1044 p.43-46, 2180 p.1-2, 2190 p.1-9, 3111 p.1-7, 1752 p.1-33,
 2184 p.1-11, 1741 p.20-27, 1809 p.28-51, 134 p.27-57, 1873 p.16-35, 1797 p.1-36
 Reference Plans: S.O. 16906; M51 Cards.

Examined by _____
 Approved as to Survey _____
 27/1/88
 Deposited this _____ day of _____ 1988
 District Land Registrar

LAND DISTRICT Canterbury, Nelson & Westland
 Survey Bk. & Dist. See plan face
 NZMS 261 Sheet L31, L32, M30, M31, M32 & M33

Lewis Pass Photo Control

TERRITORIAL AUTHORITY Amuri, Hurunui, Grey,
 Inangahua & Waimea Counties
 Surveyed by D. E. Brown
 Scale 1:250 000 Date February 1985

17 1988

17 1988

RELEASED UNDER THE OFFICIAL INFORMATION ACT

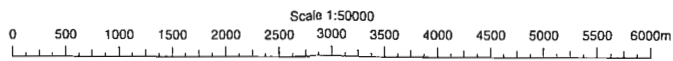
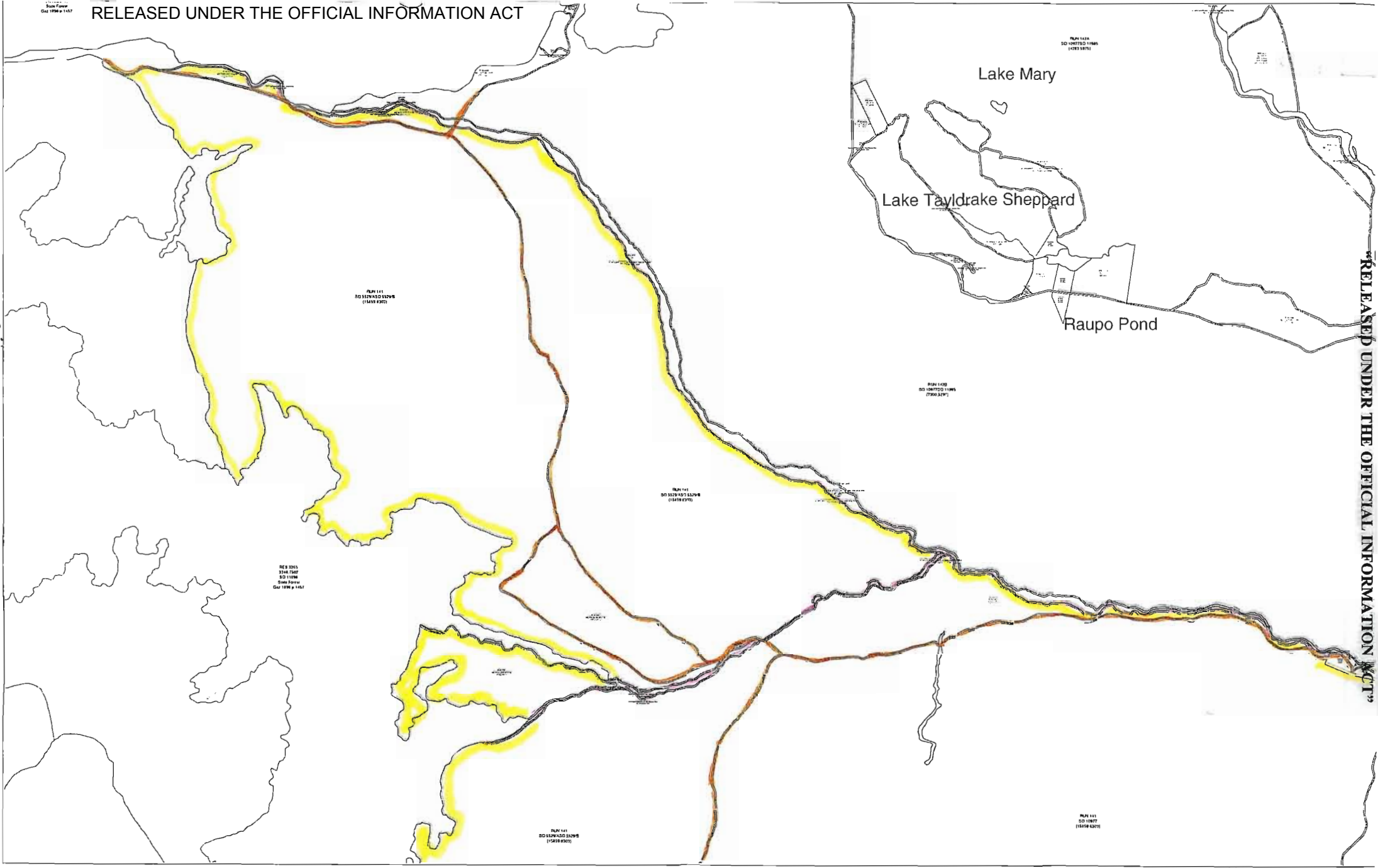

SO 5530/A



RELEASED UNDER THE OFFICIAL INFORMATION ACT

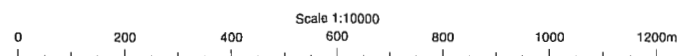

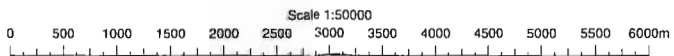
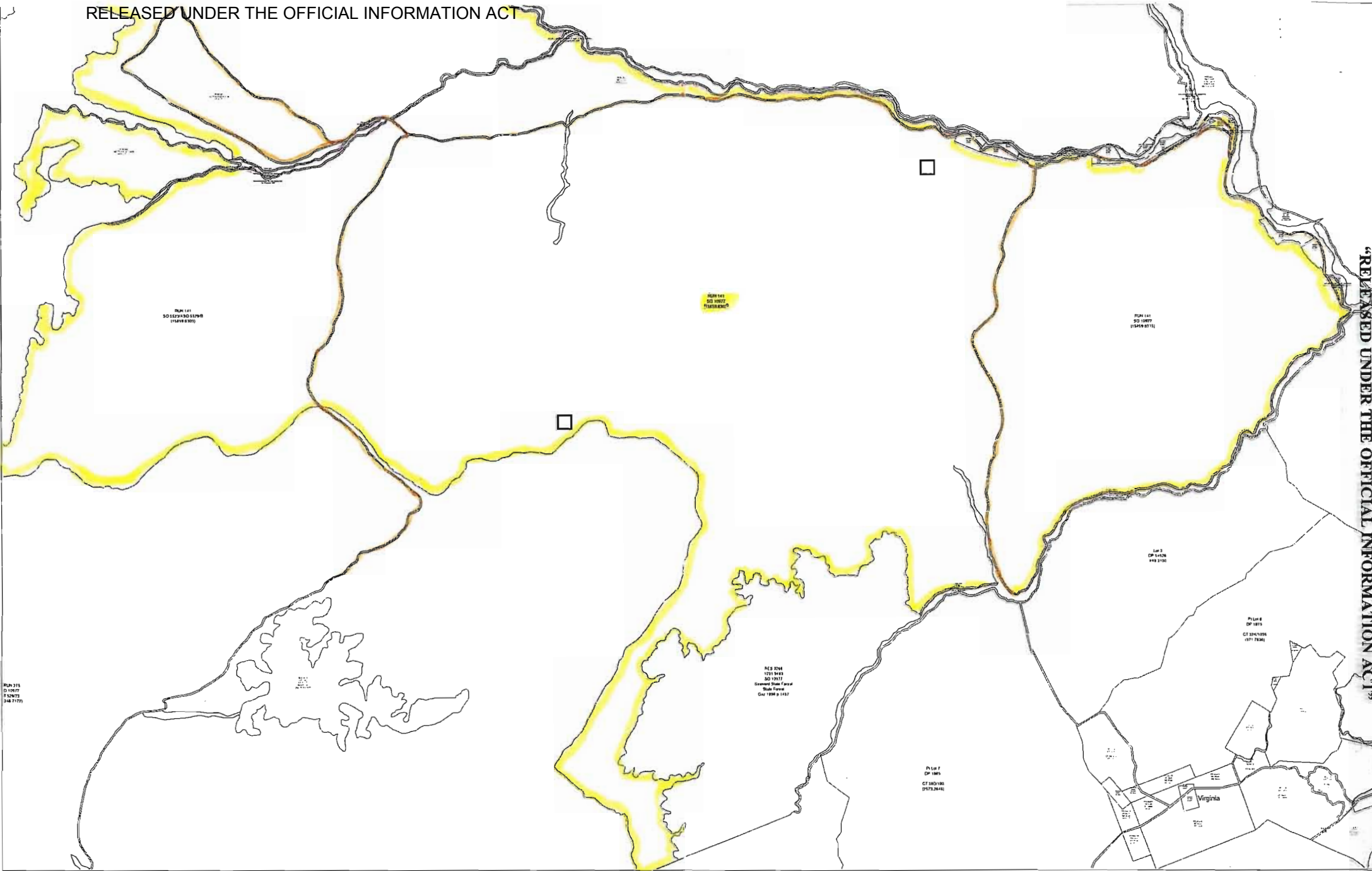

M33 L33

ESR

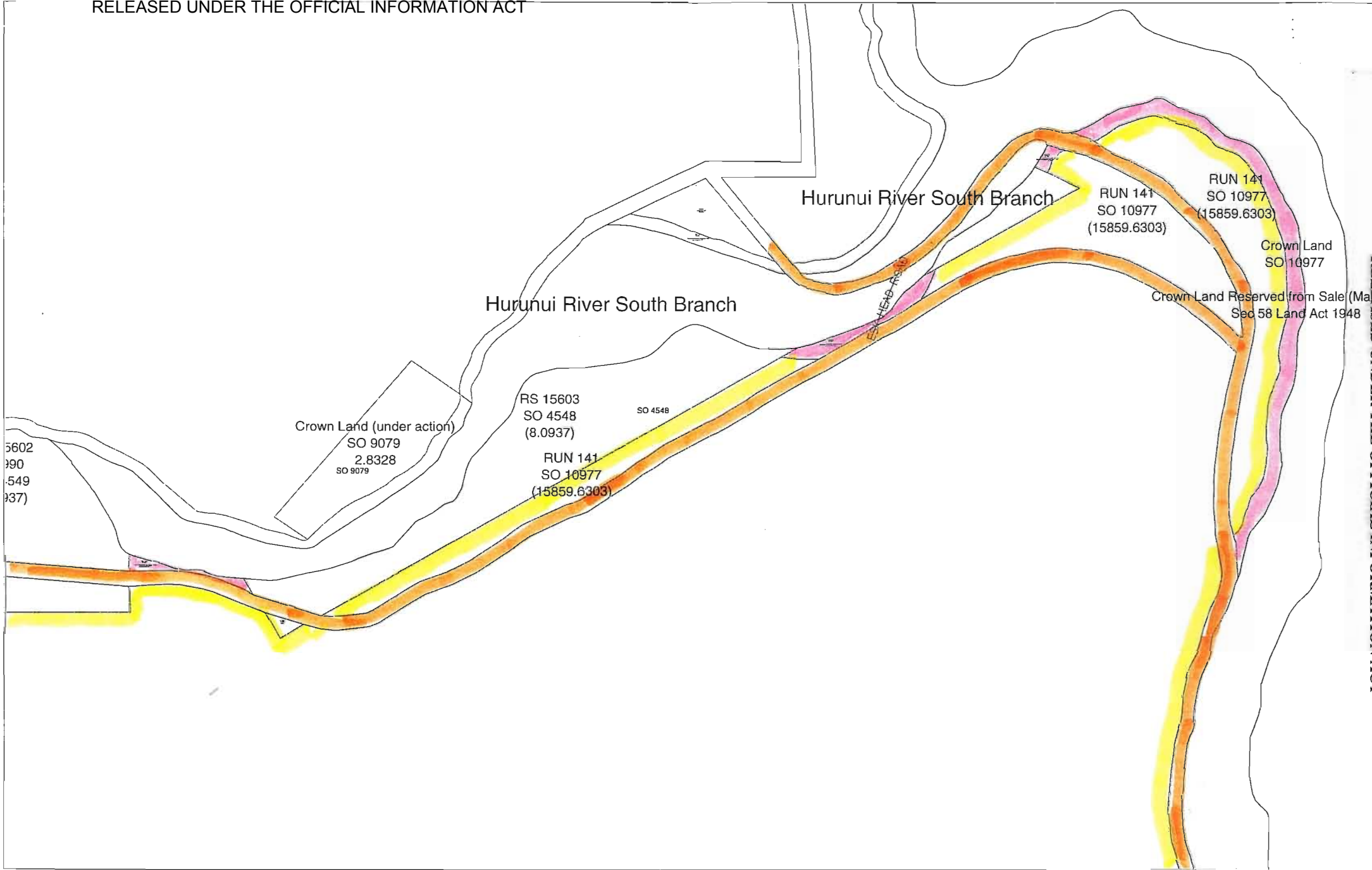

RELEASED UNDER THE OFFICIAL INFORMATION ACT

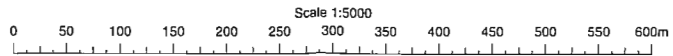

"RELEASED UNDER THE OFFICIAL INFORMATION ACT"

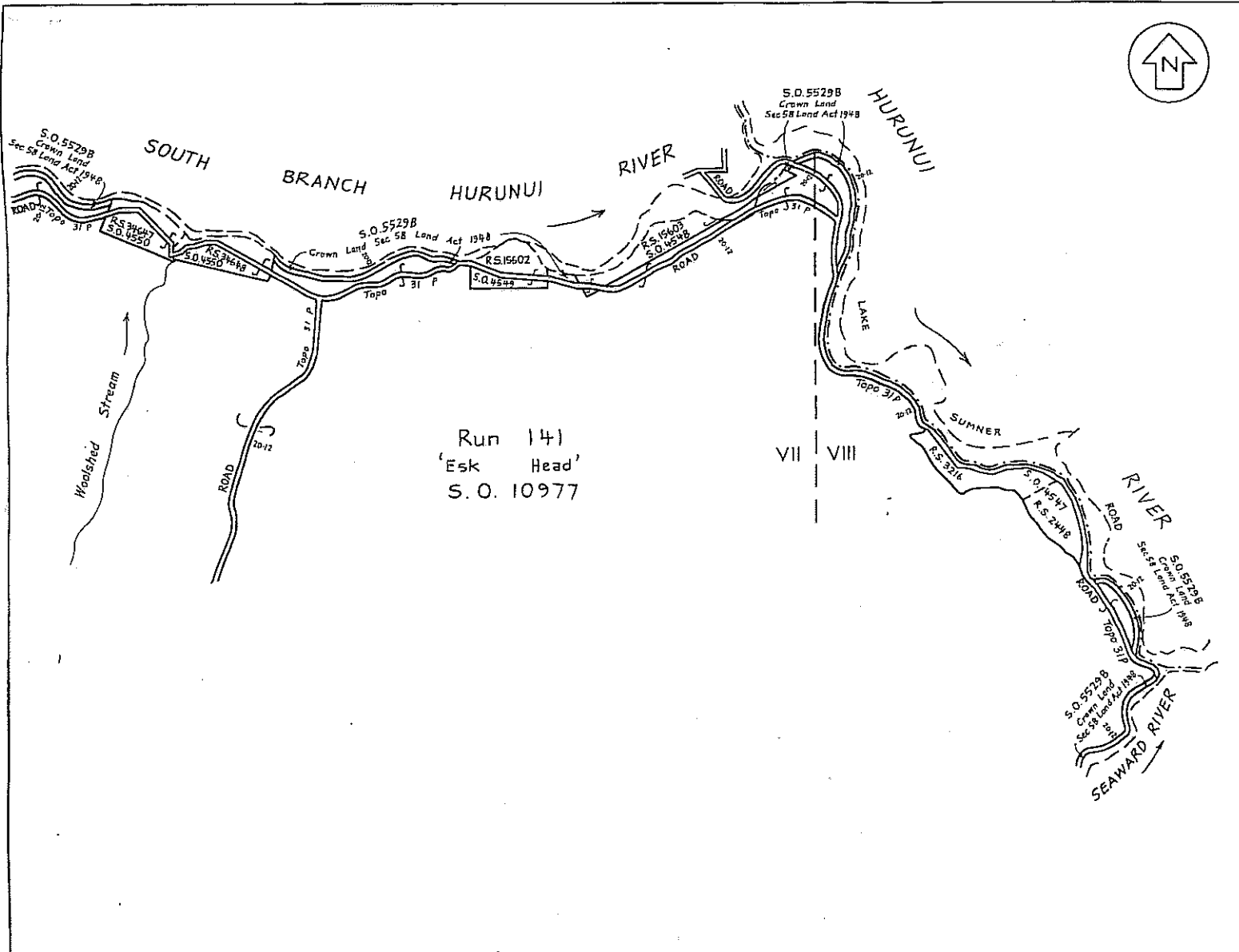

Approvals

Total Area _____
 Comprised in _____
 I, **DEREK EDWARD BROWN**, Registered Surveyor and holder of an annual practicing certificate for who may act as a registered surveyor pursuant to section 25 of the Survey Act 1956 hereby certify that this plan has been made from surveys executed by me or under my directions, that both plan and survey are correct and have been made in accordance with the Survey Regulations 1972 or any regulations made in substitution thereof.
 Dated at Christchurch this 5th day of June 1972 Signature *Derek Brown*
 Field Book _____ Traverse Book _____
 Reference Plans _____
 Examined *[Signature]* Correct _____

Approved for Record Purposes
 23/7/92 *R. Maullon* Deputy Chief Surveyor
 Deposited this _____ day of _____ 19____

LAND DISTRICT Canterbury
 Survey Blk. & Dist. VII & VIII Noble
 NZMS 261 Sheet M33 Record Map No. 10000/1,2,2-2

Diagram B.

TERRITORIAL AUTHORITY Hurunui District
 Compiled by Dept. of Survey & Land Information
 Scale Not to Scale Date May 1992

District Land Registrar
 File 7500-02
 Received 23.7.92
 Instructions 860424
SO 18875