

Crown Pastoral Land Tenure Review

Lease name : GLEN LYON

Lease number : PT 007

Due Diligence Report (including Status Report) - Part 4

This report and attachments results from a pre-Tenure Review assessment of the pastoral lease for the purpose of confirming land available for Tenure Review and any issues, rights or obligations attaching to it. The information is gathered from files and other sources available to the LINZ contractor.

Part of the information relates to research on the status of the land, resulting in a Status Report that is signed off by a LINZ approving officer. The remainder of the information is not analysed for relevancy or possible action until required, and LINZ does not guarantee its accuracy or completeness as presented.

The report attached is released under the Official Information Act 1982.

April 09

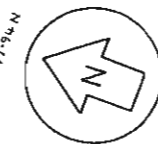
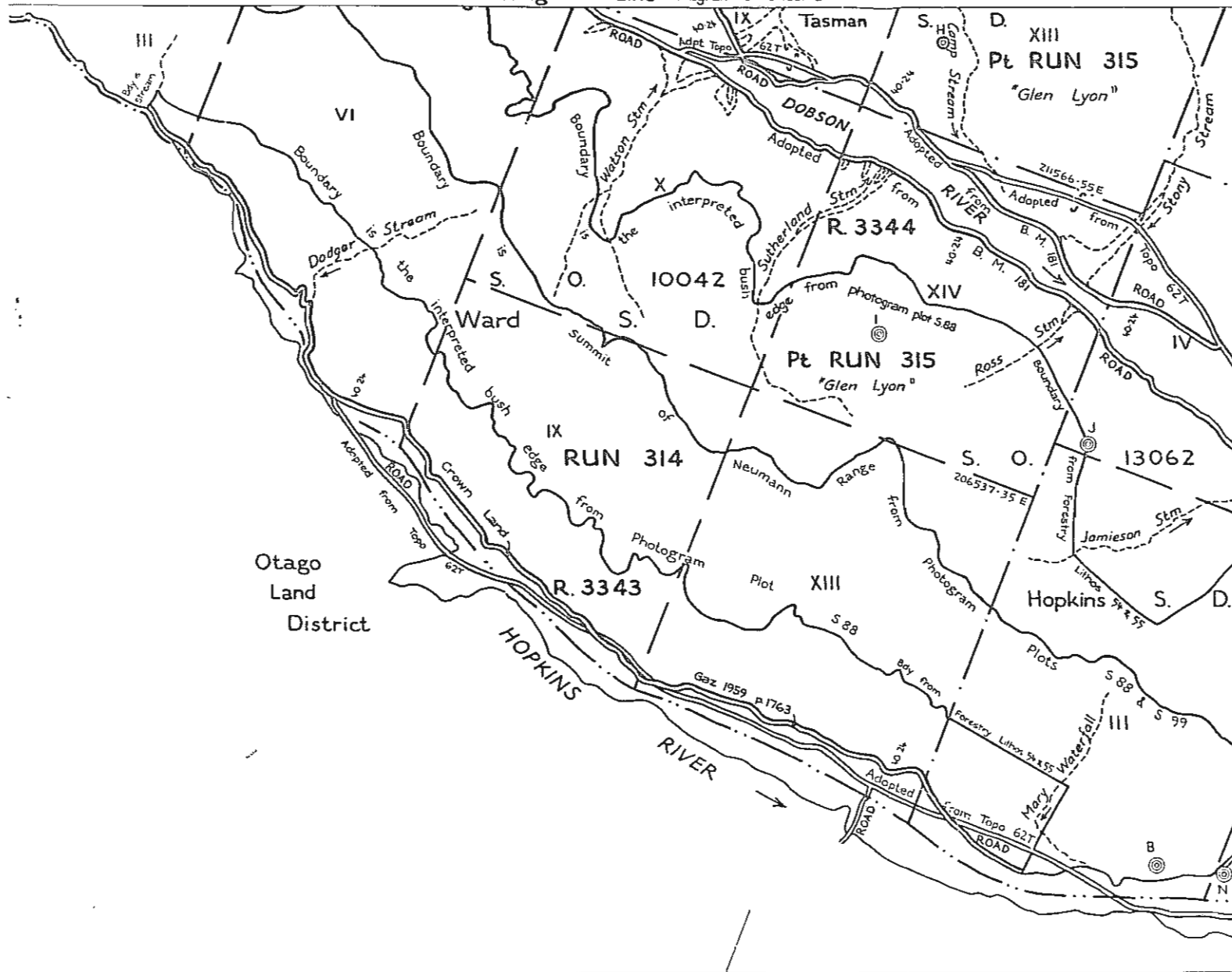

All roads are legal, 20-12 wide unless otherwise stated

Total Area _____
Comprised in _____

This plan represents the most accurate planimetric definition available at the date of the boundaries shown hereon

Dated 17/3/1974
Chief Surveyor

Field Book p _____ Traverse Book p _____
Reference Plans S.O.'s 10042 & 13062 B.M. 181
Topo 627 Photogram Plate 588 589 590 591
Examined by C.A.S. (see 1st page)

Approved as to Survey
See Above
Chief Surveyor

Deposited this _____ day of _____ 19____
District Land Registrar

CANTERBURY DISTRICT See face
Diagrams 38, 89, 99, 100

Diagram B

LOCAL AUTHORITY MACKENZIE COUNTY
Compiled in Survey Office
Scale 1 : 50 000 Date March 1974

50 133 26
Sheet 3 of 5 sheets

"RELEASED UNDER THE OFFICIAL INFORMATION ACT"

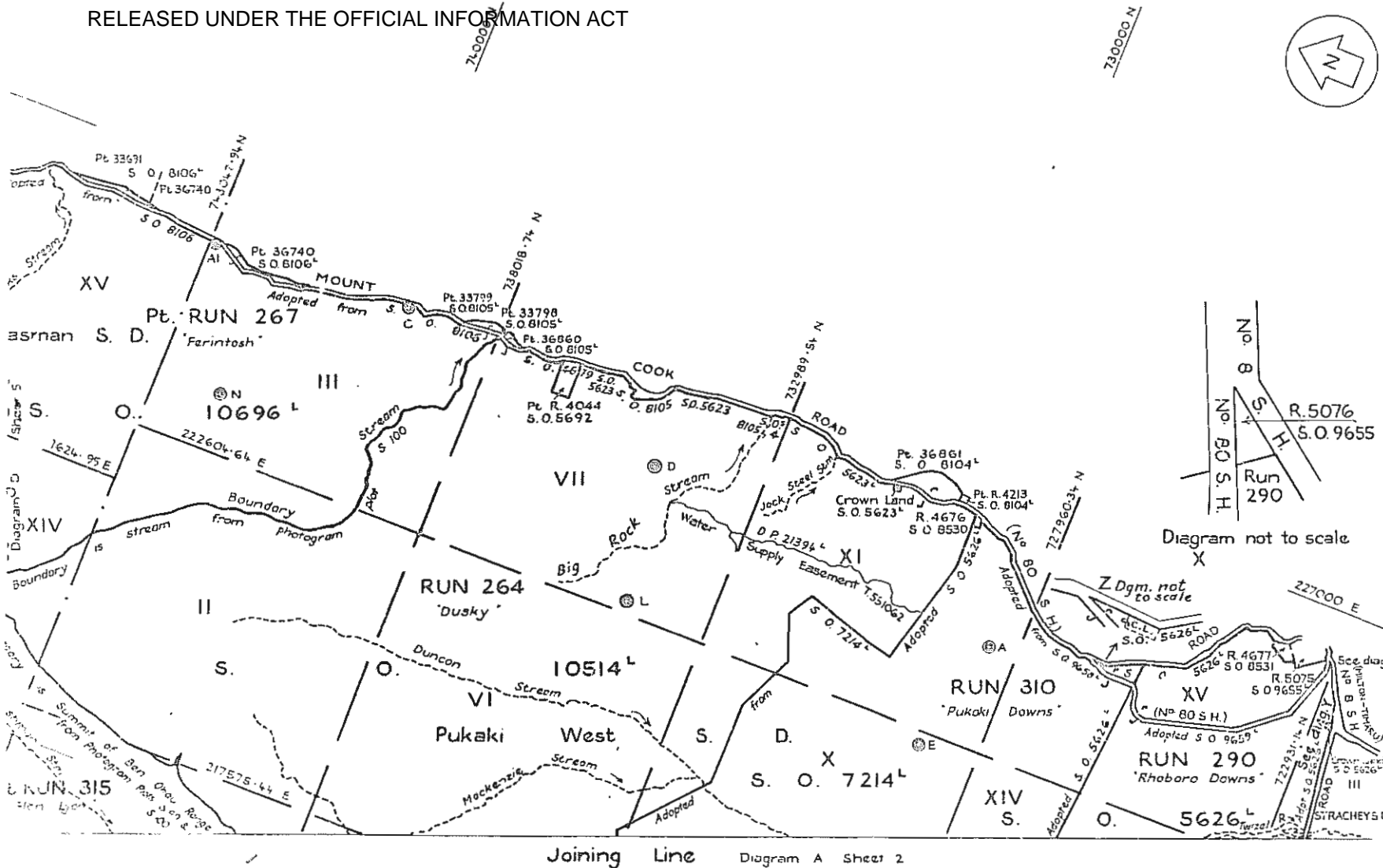

Approved as to the incorporation into Run 290 of the Crown Land shown in Diagram Y:

Commissioner of Crown Lands

Approved as to the incorporation into Run 310 of the Crown Land shown in Diagram Z:

Deputy Asst. Commissioner of Crown Lands.

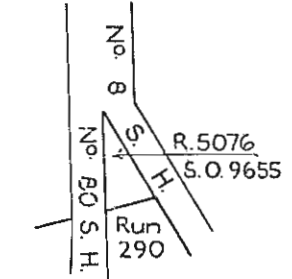

All roads are legal and 20.12 or over wide

Total Area Comprised in

This plan represents the most accurate planimetric definition available at this date of the boundaries shown hereon

Dated 17/7/1975 Chief Surveyor

Approved as to Survey

See Above Chief Surveyor

Joining Line Diagram A Sheet 2

Diagram Y not to scale

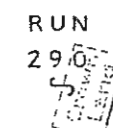
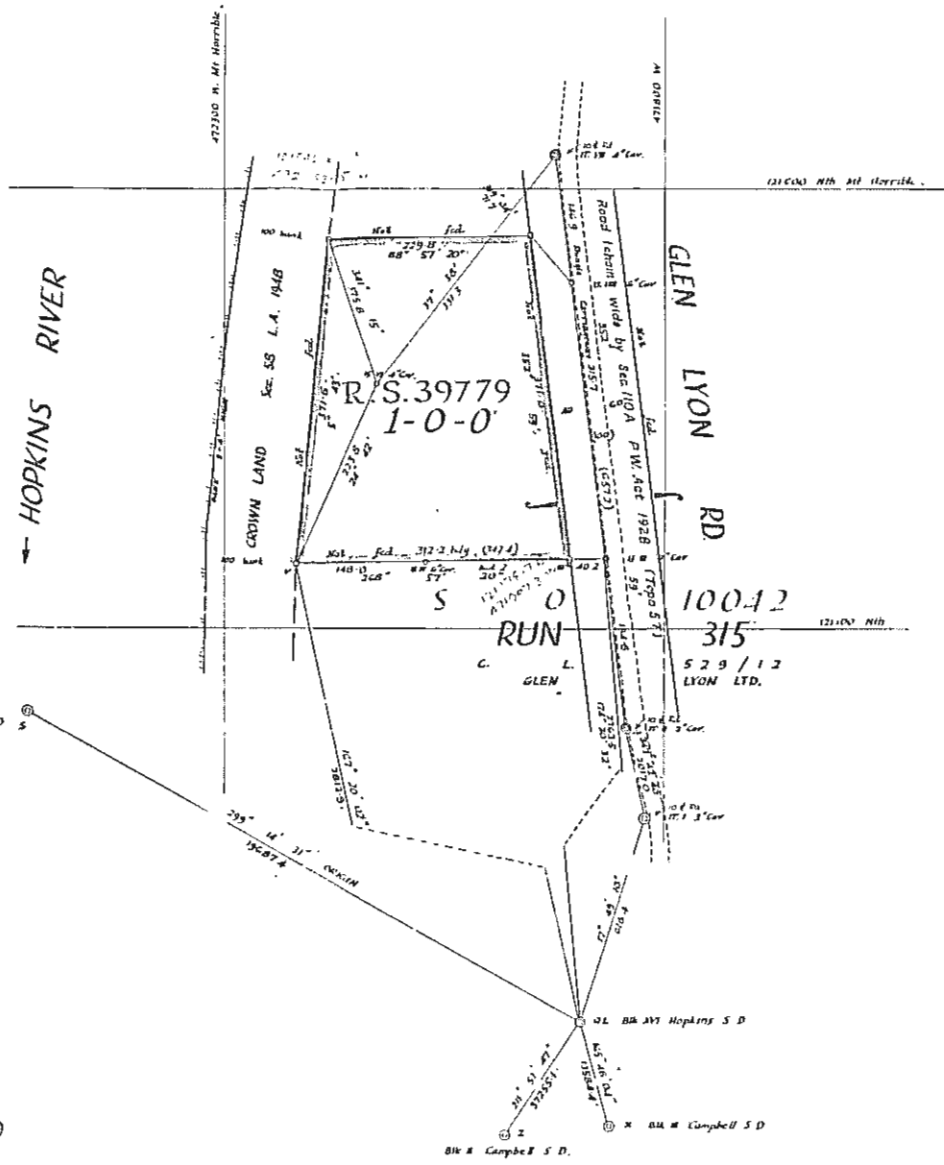
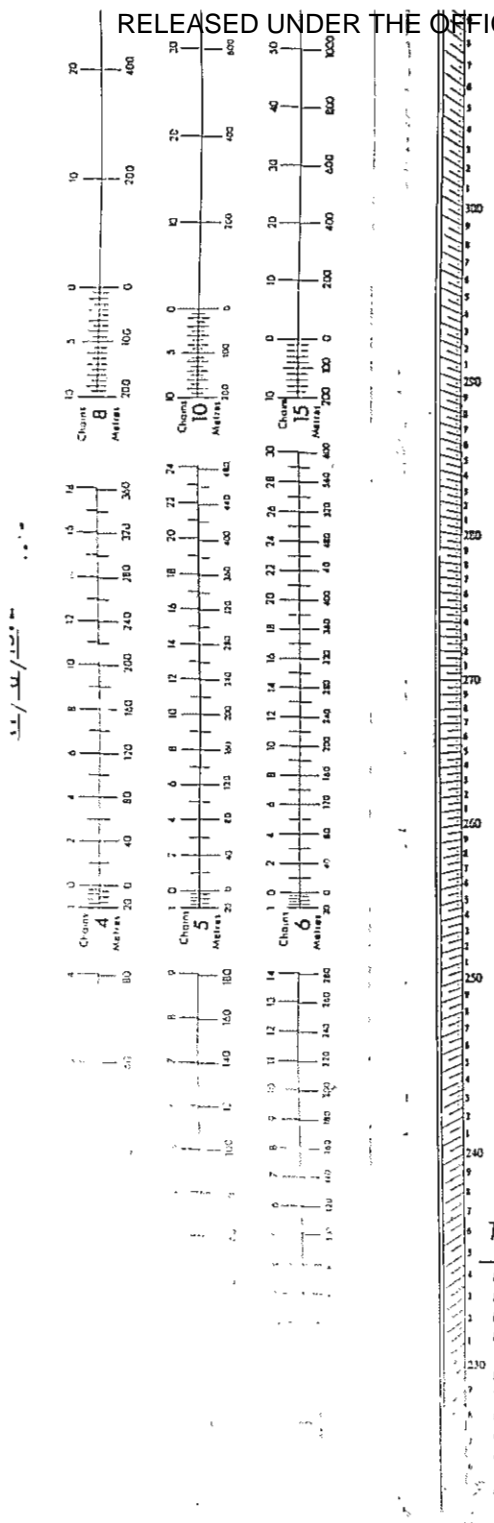

Diagram C

LOCAL AUTHORITY MACKENZIE COUNTY
Compiled in Survey Office
Scale 1:50000 Date April 1974



Bearings Co-ordinates
in terms of
Geodetic Datum 1949

For Local Body consent to
subdivision see file, folio 560
TOTAL AREA: 1-0-0

PLAN OF PT. RUN 315

| | |
|----------------------------|------------------------|
| Received, P.R.L. | 30.7.69 |
| File | P.Z. |
| Instructions | |
| Reference Plans | S.O. 10042, Tapa 5 J. |
| Tran. St. Tls. | |
| Field book | (1912) p. 134 |
| Traverse book | 72 p. 122 |
| Examined by | P. Greening, C.B. 239. |
| Recorded | |
| Plan in order for approval | |

Survey Block & District.....**BLK. XVI HOPKINS S.D.**
Land District.....**CANTERBURY**.....Local Body.....**MACKENZIE COUNTY**
Scale.....**ONE CHAIN TO AN INCH**.....Surveyed by.....**BRIDGES, MILWARD & FOLK**.....Date.....**MARCH 1960**

I, **EDMUND GEORGE FINLAY**, of **DUNEDIN**, Registered Surveyor and holder of an annual practicing certificate, hereby certify that this Plan has been taken from surveys executed by me; that both plan and survey are correct and have been made in accordance with the regulations under the Surveyors Act, 1928.
Dated at **DUNEDIN** this **31st** day of **MARCH** 19**60**.

Approved.....
Chief Surveyor.....
17288



Department of Conservation
Te Papa Atawhai

fax

Name Murray Brunet Peter King

Organisation Kuiri Frank

Address _____

Fax Number 3798-440 Date _____

From Rob Carr. No. of pages 2
(including cover sheet)

Statement of Confidentiality
 The information contained in this and any attached pages is intended to be for the use of the addressee named on this transmittal sheet. If you are not the addressee, note that any disclosure, photocopying, distribution or use of the contents of this faxed information is prohibited. If you have received this facsimile in error, please notify us by telephone (collect) on 03-379 9758 immediately so that we can arrange for the retrieval of the original document(s) at no cost to you.

Sorry for Lateness.

Rob Carr.



Department of Conservation
Te Papa Atawhai

Our ref: PAS 007, PAR 019

21 October 1999

The Manager
Knight Frank (NZ) Ltd
P O Box 142,
Christchurch,

Attention: Murray Bradley/Peter King

Dear Sir

STATUS INVESTIGATIONS - LAND TENURE REVIEW - GLEN LYON

I refer to your letter of 15 October 1999.

Glen Lyon Station

I have checked our allocation maps. The entire Glen Lyon Station is within the Canterbury Conservancy. I can find no conservation land within the boundaries of the Pastoral Lease, as shown on the maps supplied with your correspondence.

MARGINAL STRIPS/SECTION 58 STRIPS

As you are no doubt aware, there is considerable doubt as to where the Marginal Strip provisions of the Conservation Act 1987 apply within the High Country Pastoral Leased lands in Canterbury. In some cases the Marginal Strip provisions (Part IVA of the Conservation Act 1987) come into effect upon renewal. In other cases 'Section 58' strips (Land Act 1948) applied if a lease was renewed prior to the passing of the Conservation Act 1987. Some Marginal/Sec 58 strips are shown on survey plans, others are not.

It is virtually impossible to identify with any certainty whether a Marginal Strip is in place if they are not shown on a plan. Some Marginal Strips are shown on the DOC allocation maps, while others are not. If there are no Marginal Strips shown on the allocation maps, I have not identified them.

This scenario means that there will be some Marginal Strips technically under DOC control, but because they are not identified, the Department is not aware of them. Where there are no marginal strips shown on our allocation maps, the Department of Conservation will not have granted any concessions.

If you have any questions on this matter please do not hesitate to contact the writer.

Yours faithfully

Robert Cant
Community Relations Officer (Statutory Land Management)
For Conservator

Canterbury Conservancy

Private Bag 4715, 133 Victoria Street, Christchurch, New Zealand
Telephone 03-379 9758, Fax 03-365 1388

**Knight
Frank**



Your Ref : LIPS 12763

Our Ref : Contract 50178

21 October 1999

4th Floor, Knight Frank House
76 Cashel Street, Christchurch
Telephone: (03) 379 9787
Facsimile: (03) 379 8440

The Chief Surveyor
Land Information New Zealand
Private Bag 4721
CHRISTCHURCH

Attention : Mr R Moulton

Dear Sir

PASTORAL TENURE REVIEW- STATUS INVESTIGATION
CANTERBURY

Attached status investigation report and supporting papers for the following pastoral run;

- Glen Lyon

for your perusal and approval, under the requirements of CCPO Standards and Guidelines, volume 4 OSG Standard 1995/05.

The purpose of this investigation being, to confirm status and ownership for the purpose of the pastoral tenure review under the Crown Pastoral Leases Act 1998.

Please charge this to account; Knight Frank(NZ) Ltd Christchurch, customer No.11014.

Upon completion, please return the report and attachments to this office for my attention.

Yours faithfully
Knight Frank (NZ) Limited

Peter M King
Crown Accredited Agent

Encl.

Corporate Offices

Auckland
Wellington
Christchurch

13 Offices Nationwide

International

Australia
Belgium
Botswana
China
France
Germany

Hong Kong
India
Italy
Japan
Malawi
Monaco

Nigeria
Portugal
Singapore
South Africa
Spain
Sweden

Tanzania
The Netherlands
United Kingdom
United States
of America
Zimbabwe

Postal Address:
PO Box 142, Christchurch
New Zealand

Knight Frank (NZ) Limited
(An LPL Group Company)

INTERNATIONAL PROPERTY CONSULTANTS



File Ref : LINZ (LIPS) 12763

4th Floor, Knight Frank House
76 Cashel Street, Christchurch
Telephone: (03) 379 9787
Facsimile: (03) 379 8440

CERTIFICATE OF AUTHORISATION

PROPERTY ADDRESS: GLEN LYON - LAKE OHAU - CANTERBURY.

ASSURANCE

Knight Frank (NZ) Limited gives an assurance that the documents attached to this certificate are in order for signature.

The decision when made will comply with the following statutory requirements:

- The New Standards & Guidelines Manuals CCPO: Legalisation/Roading, OSG Standard 1995/05.
- Land Act 1948.
- Crown Pastoral Land Act 1998.

In giving this assurance **Knight Frank (NZ) Limited** undertakes that all relevant policy instructions, legal requirements, court judgements and any other matters have been taken into account and applied where appropriate.

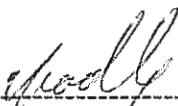

Murray Bradley
Crown Accredited Agent

Dated *20/12/98*

Corporate Offices

Auckland
Wellington
Christchurch

13 Offices Nationwide

International

Australia
Belgium
Botswana
China
France
Germany

Hong Kong
India
Italy
Japan
Malawi
Monaco

Nigeria
Portugal
Singapore
South Africa
Spain
Sweden

Tanzania
The Netherlands
United Kingdom
United States of America
Zimbabwe

Postal Address:
PO Box 142, Christchurch
New Zealand
Knight Frank (NZ) Limited MREINZ
(An LPL Group Company)
INTERNATIONAL PROPERTY CONSULTANTS

KNIGHT FRANK (NZ) LIMITED

Appendix A

This report has been prepared on the instruction of Land Information New Zealand in terms of the contract number 50178 dated September 1999 and is undertaken for the purposes of the Crown Pastoral Leases Act 1998.

| | | | | |
|---|----------|-----------|----------|--------------------------|
| LAND STATUS REPORT for GLEN LYON | | | | <i>[LIPS ref. 12763]</i> |
| Property | 1 | of | 1 | |

| | |
|----------------------------|--|
| Land District | Canterbury |
| Legal Description | Part Run 315, Glen Lyon situated in Blocks XVI & XVII Mueller Survey District, Blocks III, VI, IX, X, XIII and XIV, Ward Survey District, Blocks I, II, V, VI, IX, X, XIII and XIV, Tasman Survey District Blocks III, IV, VII, VIII, XII and XVI, Hopkins Survey District, Blocks I, II and V, Pukaki West Survey District, Blocks III and IV Campbell Survey District and Rural Section 39779 Block XVI Hopkins Survey District. |
| Area | 31800.0000 hectares |
| Status | Crown Land subject to the Land Act 1948. |
| Instrument of lease | Pastoral Lease 529/12 pursuant to Section 66 as registered under Section 83 Land Act 1948. |
| Encumbrances | Subject to part IVA of the Conservation Act 1987 upon disposition. |
| Mineral Ownership | Minerals remain with the Crown as the land has never been alienated since its acquisition for Settlement purposes from the former Maori owners under the Kemp purchase in 1848. |
| Statute | Land Act 1948 & Crown Pastoral Land Act 1998. |

| | |
|---------------------------------|-----------------|
| Data Correct as at | 20 October 1999 |
| [Certification Attached] | Yes |

| | |
|-------------------------------|---------------------------|
| Prepared by | Murray Bradley |
| Crown Accredited Agent | Knight Frank (NZ) Limited |

KNIGHT FRANK (NZ) LIMITED

Appendix B

This land status report has been prepared on the instruction of Land Information New Zealand in terms of the contract number 50178 dated September 1999 and is undertaken for the purposes of the Crown Pastoral Leases Act 1998.

| | | | | |
|---|----------|-----------|----------|-------------------------|
| LAND STATUS REPORT for GLEN LYON | | | | <i>[LIPS ref.12763]</i> |
| Property | 1 | of | 1 | |

| | |
|----------------------------|--|
| Land District | Canterbury |
| Legal Description | Part Run 315, Glen Lyon situated in Blocks XVI & XVII Mueller Survey District, Blocks III, VI, IX, X, XIII and XIV, Ward Survey District, Blocks I, II, V, VI, IX, X, XIII and XIV, Tasman Survey District Blocks III, IV, VII, VIII, XII and XVI, Hopkins Survey District, Blocks I, II and V, Pukaki West Survey District, Blocks III and IV Campbell Survey District and Rural Section 39779 Block XVI Hopkins Survey District. |
| Area | 31800.0000 hectares |
| Status | Crown Land subject to the Land Act 1948. |
| Instrument of lease | Pastoral Lease 529/12 pursuant to Section 66 as registered under Section 83 Land Act 1948. |
| Encumbrances | Subject to part IVA of the Conservation Act 1987 upon disposition. |
| Mineral Ownership | Minerals remain with the Crown as the land has never been alienated since its acquisition for Settlement purposes from the former Maori owners under the Kemp purchase in 1848. |
| Statute | Land Act 1948 & Crown Pastoral Land Act 1998. |

| | |
|---------------------------------|-----------------|
| Data Correct as at | 20 October 1999 |
| [Certification Attached] | Yes |

| | |
|-------------------------------|---------------------------|
| Prepared by | Murray Bradley |
| Crown Accredited Agent | Knight Frank (NZ) Limited |

Certification:

Pursuant to section 11(1)(l) of the Survey Act 1986 and acting under delegated authority of the Surveyor-General pursuant to section 11 (2) of that act, I hereby certify that the land described above is; Crown Land subject to the Land Act 1948.

.....
 R Moulton, Chief Surveyor
 Land Information New Zealand, Christchurch

Date...../...../1999

| | | | | |
|---|----------|-----------|----------|------------------|
| LAND STATUS REPORT for GLEN LYON | | | | [LIPS ref.12763] |
| Property | 1 | of | 1 | |

Research Data: Some Items may be not applicable

| | | | | |
|--|----------|-----------|----------|--|
| Property | 1 | of | 1 | |
| SDI Print Obtained | | | | Yes |
| NZMS 261 Ref | | | | H37 & H38 |
| Local Authority | | | | MacKenzie District |
| Crown Acquisition Map | | | | Kemp Purchase |
| SO Plan | | | | SO 5620, 13326 and SO 11288. |
| Relevant Gazette Notices | | | | 1973 Page 1515 - Part Run 315 Proclaimed Road (6-0-23 acres) |
| CT Ref / Lease Ref | | | | Pastoral Lease 529/12 |
| Legalisation Cards | | | | SO 11236 shows that an area of part Run 315 (6-0-23) was Proclaimed Road by Gaz. 1975 page 1515. |
| CLR | | | | N/A |
| Allocation Maps (if applicable) | | | | N/A |
| VNZ Ref - if known | | | | 25320 - 02200 |
| Crown Grant Maps | | | | N/A (See Sale Plan 191-1898). |
| If Subject land Marginal Strip: | | | | Note: Lease 529/12 and SO 13326 are subject to the provisions of Section 58 of the Land Act 1948. The Dobson and Hopkins Rivers are clearly depicted on SO 13326 without a one chain strip having been laid off. In view of LINZ letter dated 13 November 1997 regarding 'Lilybank' and Ministerial Co-ordinating Committee/State Owned Enterprises paper 271 dated 31 March 1987 (Dept of Justice) it would appear this memorial to have no substance unless a one chain strip was laid of by definition on a plan in the Chief Surveyors records. SO11288 which defines the boundaries of RS39779 also defines a 20 metre strip as Crown land subject to Section 58 of the Land Act 1948 adjoining the Hopkins River. |
| a) Type [Sec 24(9) or Sec 58] | | | | |
| b) Date Created | | | | |
| c) Plan Reference | | | | |

| | | |
|---|----------|-------------------|
| LAND STATUS REPORT for GLEN LYON | | [LIPS ref. 12763] |
| Property | 1 | of 1 |

Research – continued

| | | | |
|---|---|--|---|
| Property | 1 | of | 1 |
| If Crown land - Check Irrigation Maps. | | N/A | |
| Mining Maps | | No current Mining privileges identified within the run boundaries. | |
| If Road a) Is it created on a Block Plan - Section 43(1)(d) Transit NZ Act 1989 b) By Proc | | a) No part of the formed Glen Lyon Road has been defined by Survey except the ends of the deviation on SO11236 and the east and west boundaries of RS39779 on SO11288. All other unformed and formed legal roads are held by Crown Grant and or Section 110A Public Works Act 1981. b) SO11236 shows that an area of Part Run 315 (6-0-23) was Proclaimed Road by Gaz. 1975 page 1515. | |
| Other Relevant Information a) Concessions - Advice from DOC or Knight Frank. b) Subject to any provisions of the Ngai Tahu Claims Settlement Act 1998. c) Mineral Ownership d) Other Information | | (a) Glen Lyon Limited holds recreation permits for the following activities: (i) Hunting operations: Term 1 yr from 01/07/99; (ii) Fishing, 4WD Vehicle Tours and Horse Trekking: Term 9 yrs from 01/07/99. (b) Subject to Part 9 Ngai Tahu Claims Settlement Act 1998. (c) Minerals are owned by the Crown because the Land has never been alienated from the Crown since its acquisition for settlement purposes from the former Maori owners under the Kemp purchase 1848. Contained in:- PR158 (1898) (earliest Lease available after Canterbury Gazette 1864 Page 160 - 163 (Nos 300, 307, 315, 477, 479, 480 and 534 - 538) - Confirmation of runs under the Canterbury Land Regulations. (i) In April 1969 (folio 548) the LSBd approved the surrender of 1 acre from the lease and the issue of a special lease pursuant to Section 67 Land Act 1948 for a Holiday bach site. However, in February 1973 the lessee advised that he did not wish to proceed with this lease. | |

| | |
|--|--|
| | <p>(ii) The following issues have been identified on a report dated 30/03/87 (folio 727) that may require further investigation as part of the Tenure review process:-</p> <p>(A) Glen Lyon Station to surrender land hatched yellow on Plan (not on file) and grassed areas of presently gazetted state forest (hatched red) to be incorporated in the pastoral lease subject to:</p> <p>(i) The boundary between land to be surrendered and land to be incorporated other than well defined bush edges (further subject to advice as to the Chief Surveyor as to definition in this latter case) to be the 1000m contour.</p> <p>(ii) covenant to be included in the lease to the effect that the lessee and lessor acknowledge that the contour open boundary is unfencable; that some stock drift over this is inevitable; that the lessee will not intentionally drive or have driven stock grazing on block adjoining an open boundary over and above that boundary; that it is agreed that if stock drift becomes unacceptably high, block limit to reduce this may be enforced.</p> <p>(B) Inclusion of a further covenant (clause) in the lease granting the public the right to wander on foot at will on the leased land upstream of the black lines dotted across the Dobson River.</p> <p>(C) Preservation of existing hut sites will need to be allowed for. Discussion with the Chief Surveyor (determining the best and easiest defined method) will be undertaken to finalise these.</p> <p>(D) The pastoral leases to be amended removing the lessee's right under Section 100 Land Act to take native timber for certain uses and further giving acknowledgement to the importance of the native bush on the leases and the need to preserve these from undue stock damage.</p> <p>(iii) We note reference on file that Telecom applied for a telecommunications easement</p> |
|--|--|

| | |
|--|--|
| | <p>in June 1997 which has not yet been granted. It appears that LINZ Head office are giving consideration to granting telecommunications easements to Telecom over a number of other runs and are still formulating the easement documentation.</p> <p>(iv) We note that the lessee elected to have the lease renewed values to be determined by the Land Valuation Tribunal in 1975 which has not yet been actioned. The CCL outlined the process that would be followed in a letter addressed to the Chairman of the South Island High Country Committee of Federated Farmers dated 07th October 1998 but no further action has taken place since then.</p> |
|--|--|

529/12

Issued as a Renewal of (as in Exchange for) Lease Pastoral Licence No. 347 registered in Vol. 547 fol. 576

NEW ZEALAND

Entered in the Register-book, Vol. 547 fol. 576

CANTERBURY LAND DISTRICT

the 22nd day of November 1951

1951 at 0.24 o'clock



Pastoral Lease of Pastoral Land under the Land Act, 1948

P. No. 7.



This Deed, made the 1st day of March, one thousand nine hundred and fifty-one between HIS MAJESTY THE KING (who, with his heirs and successors, is hereinafter referred to as "the Lessor"), of the one part, and OLEN LYON LIMITED a duly incorporated company having its registered office at Dunedin (who, with his executors, administrators, and permitted assigns, is hereinafter referred to as "the Lessee"), of the other part, WITNESSETH that, in consideration of the rent hereinafter reserved, and of the covenants, conditions, and agreements herein contained or implied and on the part of the Lessor to be paid, observed, and performed, the Lessor doth hereby demise and lease unto the Lessee All those pieces or parcels of land containing by admeasurement 103,200 acres situated in the Land District of Canterbury, and being Run 93A (Olen Lyon) situated in Ward, Hopkins, Campbell, Mueller, Tasman and Pukaki West Survey Districts

Metric Area 34881.2921 ha. Area reduced to 31800.0000 ha. by survey S.O.13326

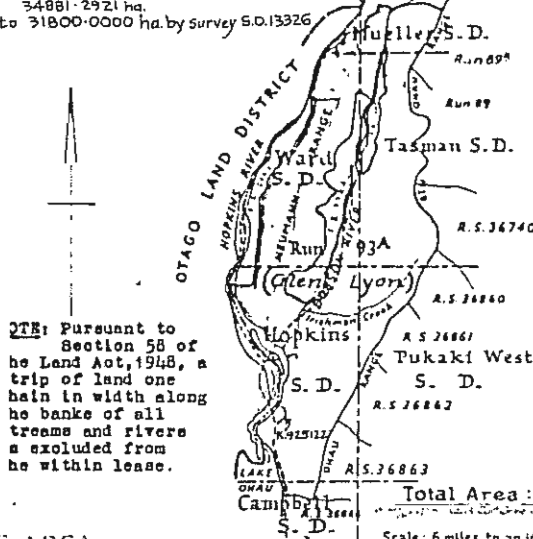

NOTE: Pursuant to Section 58 of the Land Act, 1948, a strip of land one chain in width along the banks of all streams and rivers is excluded from the within lease.

METRIC AREA

Total Area: 103,200 acs. (12,373.33 acs. by S.O. 13326) less 19,320 acs. = 83,880 acs. Scale: 6 miles to an inch. Date of issue: 12.1.51. Price: £ 430.0.0 per acre. Total value: £ 35,868.00. Date of lease: 1st day of July in each year in the same manner as rent.

- AND the Lessee doth hereby covenant with the Lessor as follows, that is to say:
1. THAT the Lessee will fully and punctually pay the rent hereinafter reserved at the times and in the manner hereinafter named in that behalf; and also will pay and discharge all rates, taxes, assessments, and outgoings whatsoever that now are or hereafter may be assessed, levied, or payable in respect of the said land or any part or parts thereof during the said term.
2. THAT the Lessee will within one year after the date of this lease take up his residence on the said land, and thereafter throughout the term of the lease will reside continuously on the said land.
3. THAT the Lessee will hold and use the said land bona fide for his own use and benefit and will not transfer, assign, sublet, mortgage, charge, or part with possession of the said land or any part thereof without the previous approval of the Land Settlement Board: Provided that such approval will not be necessary in the case of a mortgage to the Crown or to a Department of State.
4. THAT the Lessee will at all times farm the said land diligently and in a husbandlike manner according to the rules of good husbandry and will not in any way commit waste.
5. THAT the Lessee will throughout the term of his lease to the satisfaction of the Commissioner of Crown Lands for the Land District of Canterbury (hereinafter referred to as "the Commissioner") cut and trim all live fences and hedges, clear and keep clear the said land of all noxious weeds, and will comply strictly with the provisions of the Noxious Weeds Act, 1928.
6. THAT the Lessee will keep the said land free from wild animals, rabbits, and other vermin, and generally comply with the provisions of the Rabbit Nuisance Act, 1928.
7. THAT the Lessee will clean and clear from weeds and keep open all creeks, drains, ditches, and watercourses upon the said land, including any drains or ditches which may be constructed by the Commissioner after the commencement of the term of the lease; and will not at any time without the prior consent of the Commissioner alter the channel of any such creek or watercourse or stop or divert the water flowing therein.
8. THAT the Lessee will at all times during the said term repair and maintain and keep in good substantial repair, order, and condition all improvements belonging to the Crown (including those specified in the Schedule hereto which are being purchased by the Lessee) now or hereafter erected on the said land, and will not, without the prior written consent of the Commissioner, pull down or remove them or any part of them.
9. THAT the Lessee will insure all buildings belonging to the Crown (including those specified in the Schedule hereto which are being purchased by the Lessee) now or hereafter erected on the said land to their full insurable value in the name of the Commissioner in some insurance office approved by the Commissioner and will pay all premiums falling due under every such insurance policy and deposit with the Commissioner every such policy and, not later than the forenoon of the day on which any such premium becomes payable, the receipt for that premium.
10. THAT the Lessee will not throughout the term of the lease without the prior consent of the Commissioner, which consent may be given on such terms and conditions (including the payment of royalty) as the Commissioner thinks fit, fell, sell, or remove any timber, tree, or bush growing, standing, or lying on the said land, and that he will throughout the term of the lease prevent the destruction of any such timber, tree, or bush unless the Commissioner otherwise approves: Provided that the consent of the Commissioner as aforesaid shall not be necessary where any such timber or tree is required for any agricultural, pastoral, household, roadmaking, or building purpose on the said land nor where the timber or tree has been planted by the Lessee.
11. THAT the Lessee shall not, except for the purpose of complying with any of the provisions of the Noxious Weeds Act, 1928, burn any tussock, scrub, fern, or grass on the said land, nor permit any tussock, scrub, fern, or grass on the said land to be burned, unless in either case he shall have obtained the prior consent in writing of the Commissioner, which consent may be given subject to such terms and conditions as the Commissioner may deem necessary.
12. THAT officers and employees of the Department of Internal Affairs shall at all times have a right of ingress, egress, and regress over the land comprised in this lease for the purpose of determining whether such land or any adjoining land is infested with deer, wild goats, wild pigs, opossums, or other animals which the said Department is charged with the duty of exterminating or controlling, or for the purpose of destroying any such animals: Provided that such officers and employees in the performance of the said duties shall at all times avoid undue disturbance of the Lessee's stock.
13. THAT the Lessee shall exercise due care in stocking the said land and shall not overstock.

- AND it is hereby agreed and declared by and between the Lessor and the Lessee:
(a) THAT the Lessee shall have the exclusive right of pasturage over the said land, but shall have no right to the soil.
(b) THAT the Lessee shall have no right, title, or claim whatsoever to any minerals (within the meaning of the Land Act, 1918) on or under the surface of the soil of the said land, and all such minerals are reserved to His Majesty together with a free right of way over the said land in favour of the Commissioner or of any person authorized by him and of all persons lawfully engaged in the working, extraction, or removal of any mineral on or under the surface of the said land or any adjacent land of the Crown, subject to the payment to the Lessee of compensation for all damage done to improvements on the said land belonging to the Lessee in the working, extraction, or removal of any such minerals: Provided that there shall be no right of way over, or right to work, extract, or remove any mineral from, any part of the said land which is for the time being under crop or used or situated within 50 yards of a yard, garden, orchard, vineyard, nursery, or plantation, or within 100 yards of any building dwelling-house: Provided also that the Lessee may, with the prior consent in writing of the Commissioner, which consent may be given subject to such conditions as the Commissioner thinks fit, use any such minerals for any agricultural, pastoral, household, roadmaking, or building purposes on the said land, but not otherwise.
(c) THAT upon the expiration of effusion of time of the term hereby granted and thereafter at the expiration of each succeeding term to be granted to the Lessee the outgoing Lessee shall have a right to obtain, in accordance with the provisions of section 64 (3) of the Land Act, 1918, a new lease of the land hereby leased at a rent to be determined in the manner prescribed by Part VIII of the said Act for a term of thirty-three years computed from the expiration of the term hereby granted and subject to the same covenants and provisions as this lease, including this present provision for the renewal thereof and all provisions ancillary or in relation thereto.

529/12

- (d) THAT the Lessee shall have no right of acquiring the fee-simple of the said land.
- (e) THAT the Lessee may, with the prior consent in writing of the Commissioner given subject to such conditions as the Commissioner may deem necessary, -
 - (i) Cultivate any portion of the said land for the purpose of growing winter feed for the stock depastured thereon;
 - (ii) Crop such area of the said land as is sufficient for the use of himself and family and his employees;
 - (iii) Plough and sow in grass any portion of the said land;
 - (iv) Clear any portion of the said land by felling and burning bush or scrub and sow the land so cleared in grain;
 - (v) Surface sow in grass any portion of the said land;

See below

- (f) THAT the Lessee shall, in connection with the said land and shall, and for the purpose of this clause it is hereby mutually declared and agreed between the Land Settlement Board and the Lessee that the number of sheep to be kept on the said land during the term of this lease shall not, without the prior consent of the Commissioner, exceed a basis of a ewe of one acre and a half for lambing ewes.
- (g) THAT if the Lessee shall leave New Zealand or abandon the said land or if he cannot be found or if he shall neglect or fail or refuse to comply with the covenants and conditions herein expressed or implied to the satisfaction of the Land Settlement Board or the Commissioner, as the case may be, or make default for not less than two months in the payment of rent, water levy, or other payments due to the Lessee, then the Land Settlement Board may, subject to the provisions of section 116 of the Land Act, 1948, declare this lease to be forfeit, and that without discharging or releasing the Lessee from liability for rent due or accruing due or for any prior breach of any covenant or condition of the lease.
- (h) THAT these provisions are intended to take effect as a pastoral lease under the Land Act, 1948, and the provisions of the said Act and of the regulations made thereunder applicable to such leases shall be binding in all respects upon the parties hereto in the same manner as if such provisions had been fully set out herein.

SCHEDULE

IMPROVEMENTS BELONGING TO THE CROWN AND BEING PURCHASED BY THE LESSEE

- (1) THAT pursuant to Section 8 of the Coal Mines Amendment Act, 1950, this lease is subject to the reservation to the lessor of all coal existing on or under the surface of the land, and subject also to the reservation to the lessor of the power to grant coal mining rights over the land under Part I of the Coal Mines Act, 1925.

In witness whereof the Commissioner of Crown Lands for the Land District of Canterbury, on behalf of the Lessor, hath hereunto set his hand, and these presents have also been executed by the said Lessee.

Signed by the said Commissioner, on behalf of the Lessor, in the presence of -

Witness: W. H. G. Jones
 Occupation: Land Office Clerk
 Address: Christchurch

Signed by the above named as Lessee, in the presence of -

Witness: M. O. Kelly
 Occupation: Public Accountant
 Address: P.O. Box 206 Timaru

The Common Seal of Glen Lyon Limited was hereunto affixed this 17th day of August 1951.

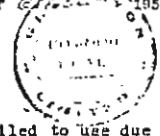

A. L. R.
Assistant Commissioner of Crown Lands.

[Signature]
Lessee.

- (f) THAT the lessee shall be deemed not to have failed to use due care in stocking, or to have overstocked so long as the number of sheep depastured on the said land does not exceed 7920 (being an increase of ten per cent on the carrying capacity on which is based the rent hereinbefore reserved) and the number of cattle does not exceed 900 but the Commissioner may by notice in writing permit the lessee to depasture thereon any greater number should he deem it advisable or expedient so to do. Any permission so granted shall be subject to revocation or amendment by the Commissioner at any time and particularly in the event of a transfer. Any variation consented to by the Commissioner shall not affect the rent payable hereunder.

441351 Certificate of Alteration varying terms of within lease entered 17 July 1951 at 2.21 p.m.

537118, surrendered to the within land etc. as a part of a larger area in plan entered Section 15150 acres

entered 27/10/1940 at 9.28 a.m.

* C.T. 524/213

Gazette Notice 925122 proclaiming Part Run 315 (6a. 23p.) as road which shall vest in The Chairman Councillors and Inhabitants of the County of MacKenzie - 24/8/1973 at 1.34 p.m.

A.L.R.

537118 Change of appellation whereby the description of the within land is changed to RUN 315 (6a. 23p.) produced this 17th day of August 1951 at 9.28 a.m. L.A. Registrar

No. 59263/1 Certificate of Alteration decreasing the area of the within lease to 31800 hectares by redefinition - 18.11.1975 at 9.27 a.m.

A.L.R.

537118 Change of appellation whereby the description of the within land is changed to RUN 315 (6a. 23p.) produced this 17th day of August 1951 at 9.28 a.m. L.A. Registrar

Mortgage 357816/1 to The Rural Banking and Finance Corporation - 1-12-1981 at 10.11a.m.

611509 Certificate of Alteration varying terms of within lease entered 24/10/1943 at 9.24 a.m.

537118 Change of appellation whereby the description of the within land is changed to RUN 315 (6a. 23p.) produced this 17th day of August 1951 at 9.28 a.m. L.A. Registrar

Mortgage 463131/1 to The Rural Banking and Finance Corporation - 1-12-1981 at 10.43 a.m.

DISC - 8

730455

for A.L.R.

REPRODUCTION (ON A REDUCED SCALE) CERTIFIED TO BE A TRUE COPY OF THE ORIGINAL REGISTER FOR THE PURPOSES OF SECTION 215A LAND TRANSFER ACT 1952.

A.L.R.

-OVER-

529/12

Variation of Mortgage 357816/1-
23.1.1985 at 10.45am.

E. Rose.
for A.L.R.

No. 838745/1 Variation of the within Lease
and extension of the term for 33 years
commencing on 1.7.1984 - 20.11.1989 at
11.47am

W. Maber.
for A.L.R.

Mortgage 843822/1 to Bank of New Zealand
- 14.12.1989 at 1.55pm

WITHDRAWN
[Signature]
for A.L.R.
X CAVEAT A80718/1 BY PACRIM FOREST PRODUCTS
(NZ) LIMITED - 10.11.1993
A.L.R. 2.15pm

[Signature]
for A.L.R.

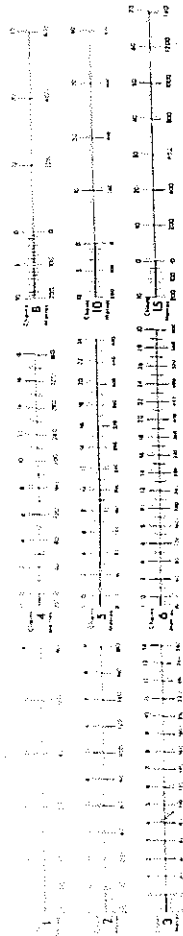

DATE OF PHOTOGRAPHY 14/9/1972

DATE OF PHOTOGRAPHY 14.9.1972

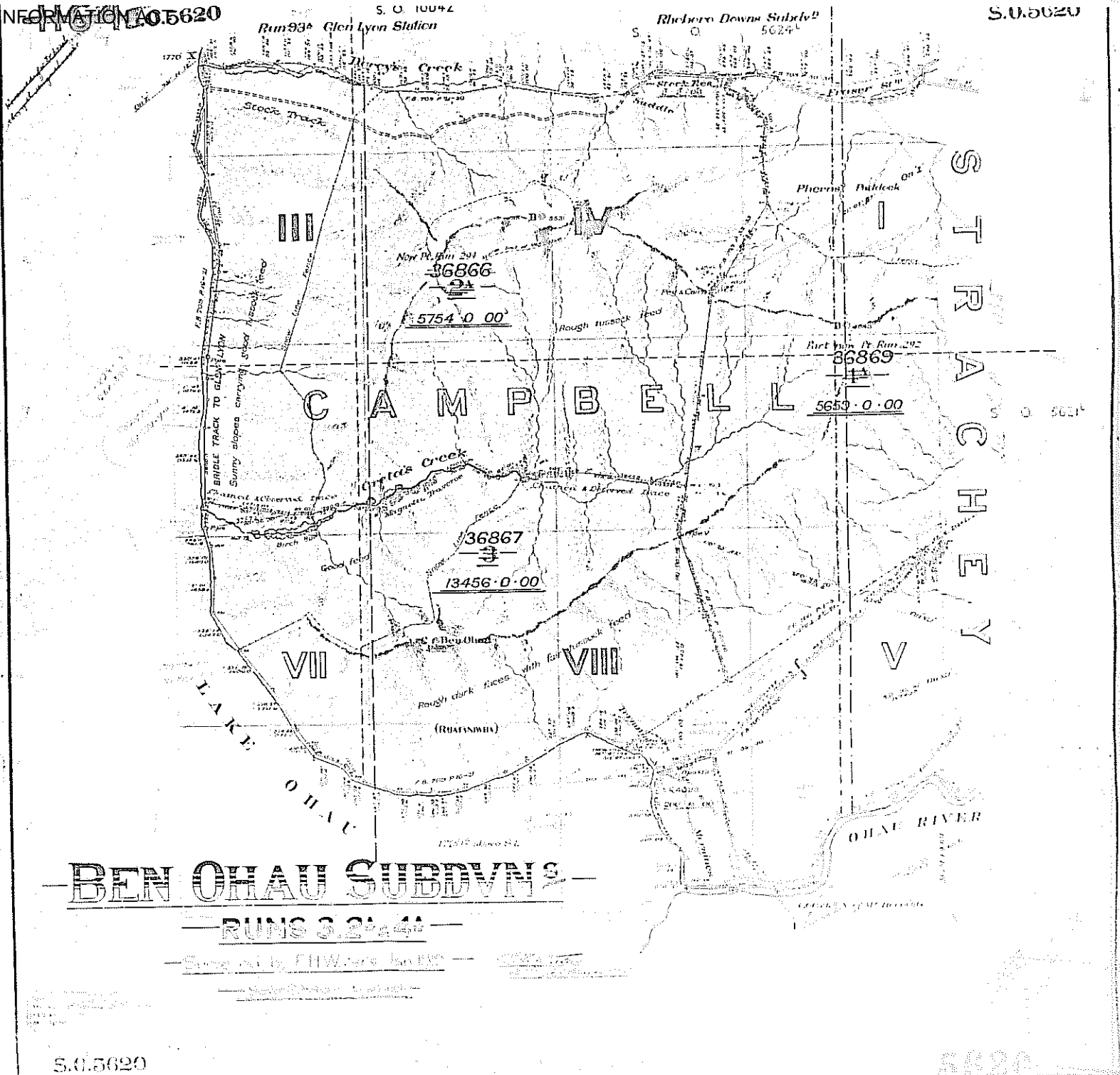

BEN OHAU SUBDIVN 2

RUNS 3 2 4 1

Surveyed by F.H.W. 1972

Run 93^A Glen Lyon Station

Rhoboro Dov

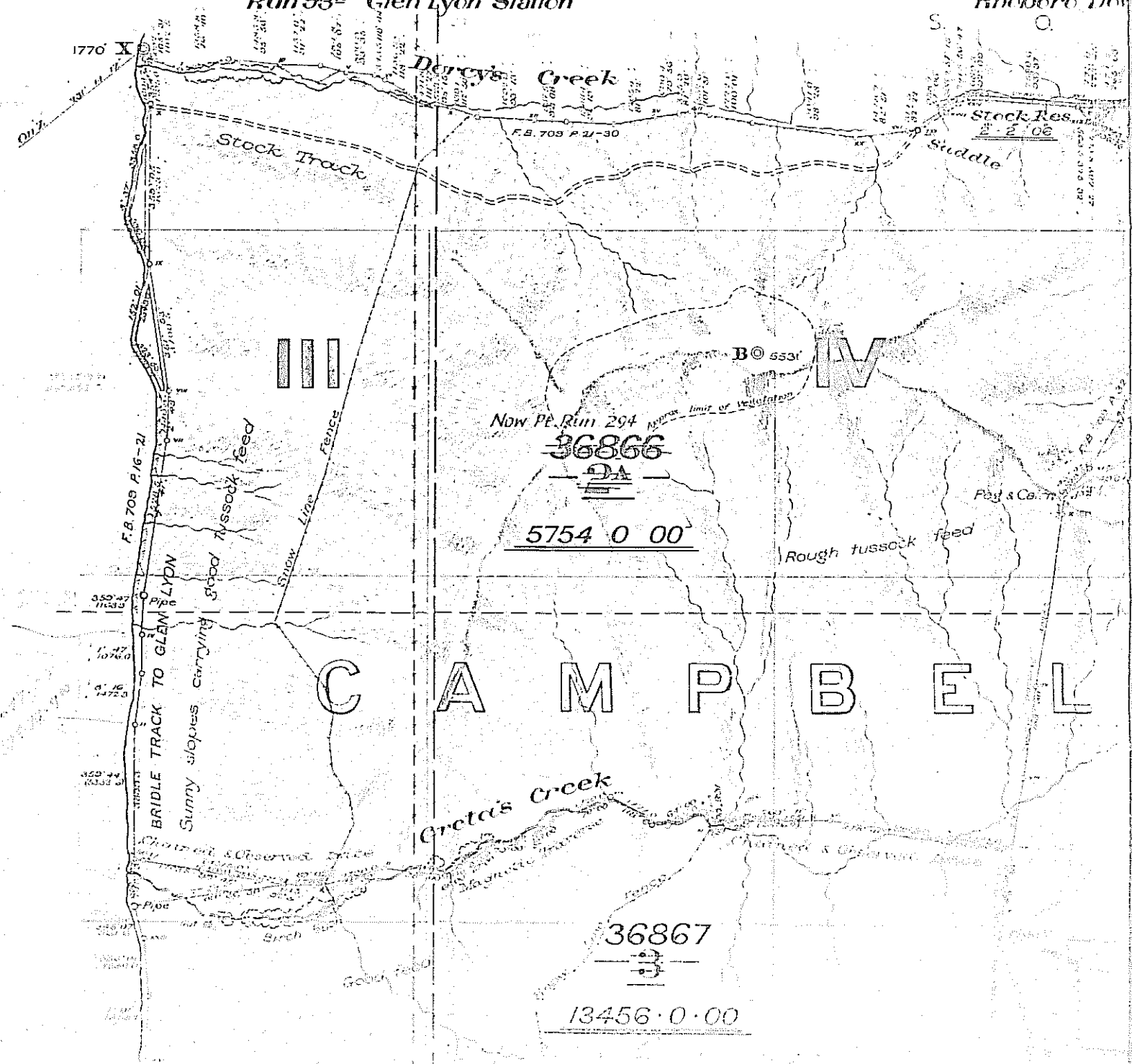
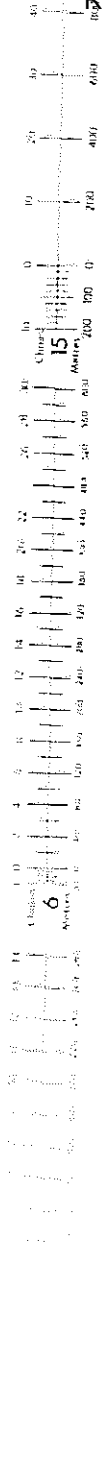

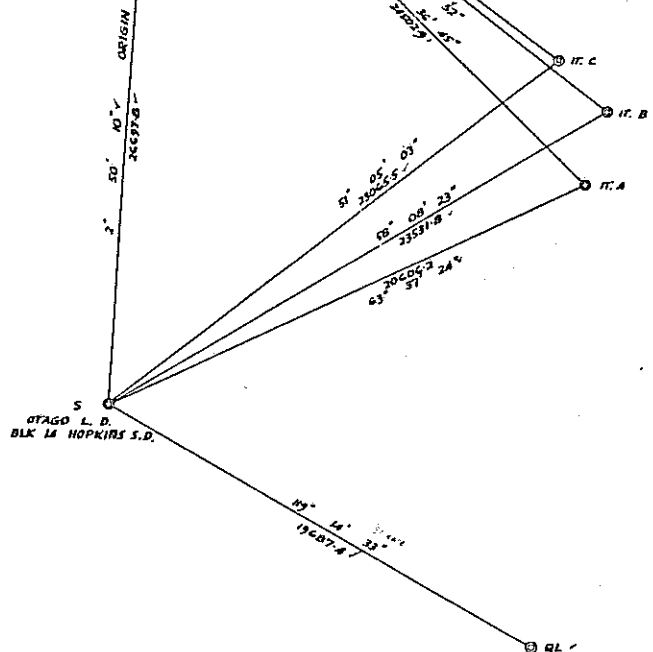

DIAGRAM SHOWING ORIGIN
Scale: 40 chs to an inch

Note: Glen Lyon Road accepted as defining position of road shown on Topo Plan 5T: Legal, 1 chn. wide, Sec. 110(a) Public Works Act 1928

| | |
|----------------------------|-------------------|
| Received at Registrar | 15.4.69 |
| File | S/31 |
| Instructions | |
| Reference Plans | TOPO 5T: AA JARA |
| Field book | 1229 p. 82-84 |
| Traverse book | 77 p. 108-110 |
| Examined by | S.J. C.S. 236 |
| Recorded | R. Stewart 1.9.69 |
| Plan in order for approval | |

I, Russell George Finlay of Timaru, Registered Surveyor and holder of an annual practising certificate, hereby certify that this plan has been made from surveys executed by me
Dated at Timaru this 10th day of April 1969

S.O.11236

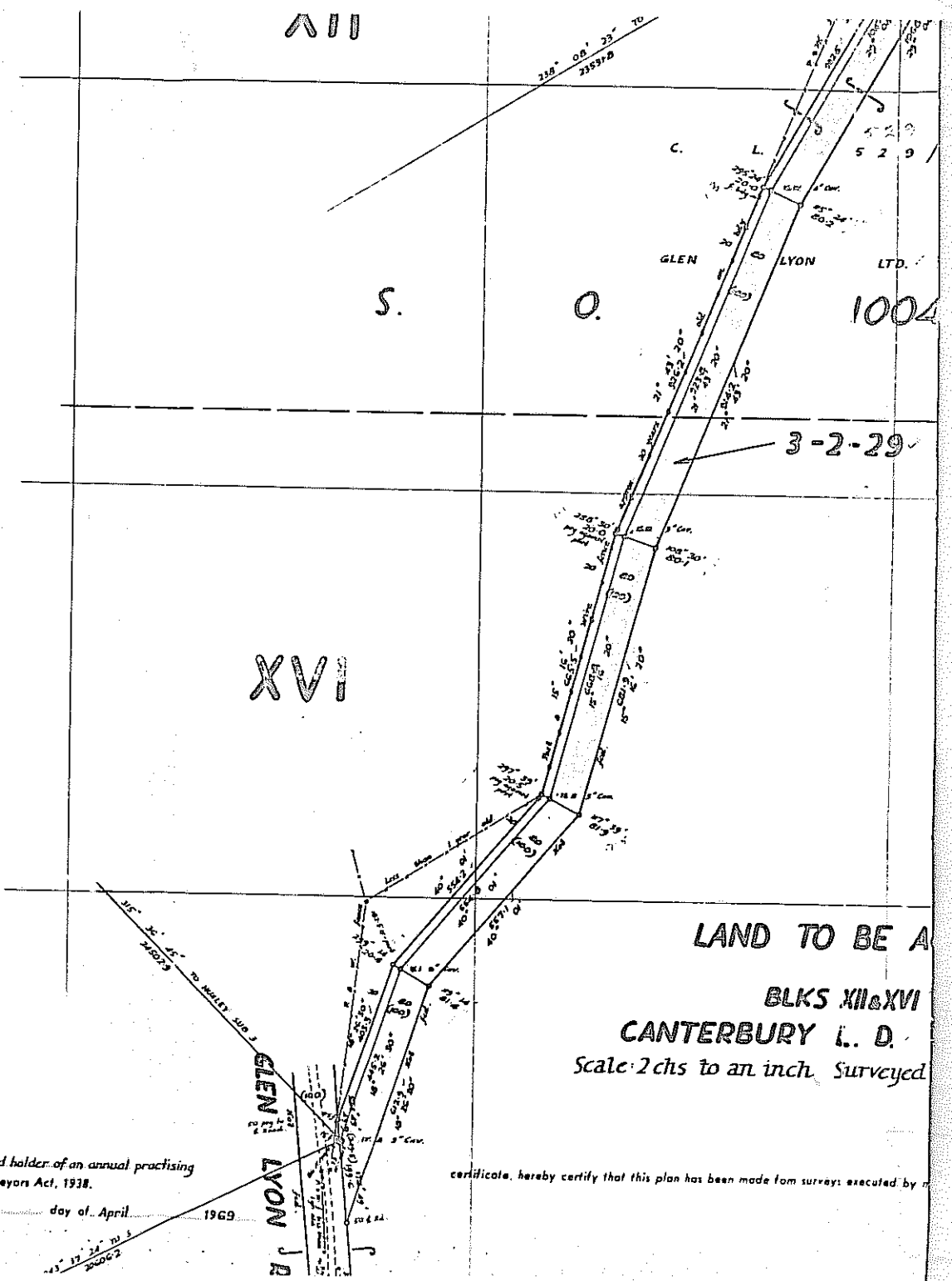

LAND TO BE A
BLKS XII & XVI
CANTERBURY L. D.
Scale: 2 chs to an inch. Surveyed

I, Russell George Finlay of Timaru, Registered Surveyor and holder of an annual practising certificate, hereby certify that this plan has been made from surveys executed by me

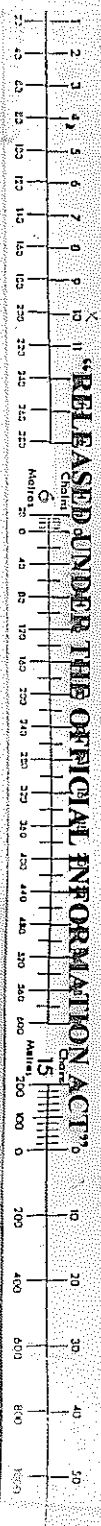
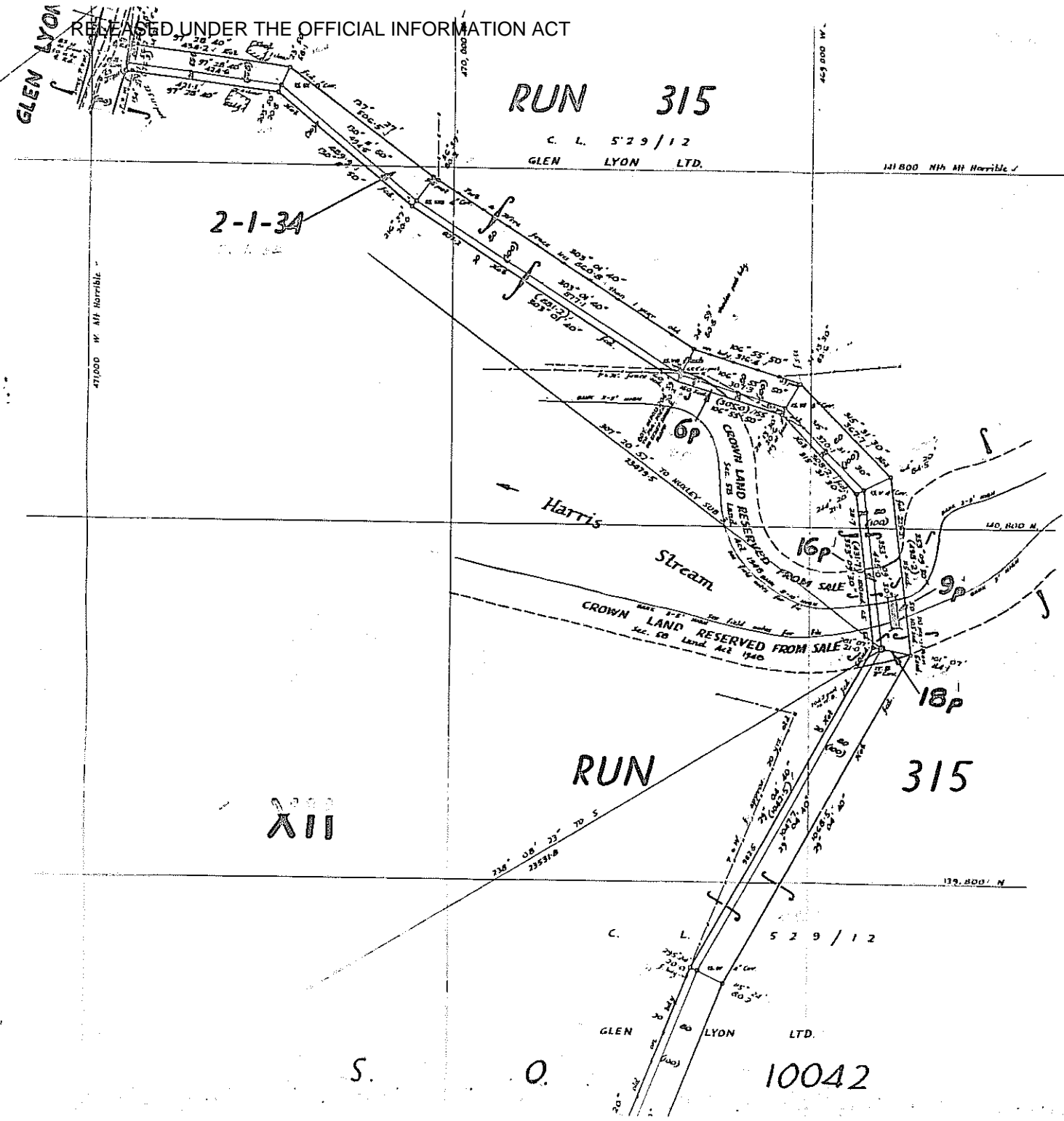

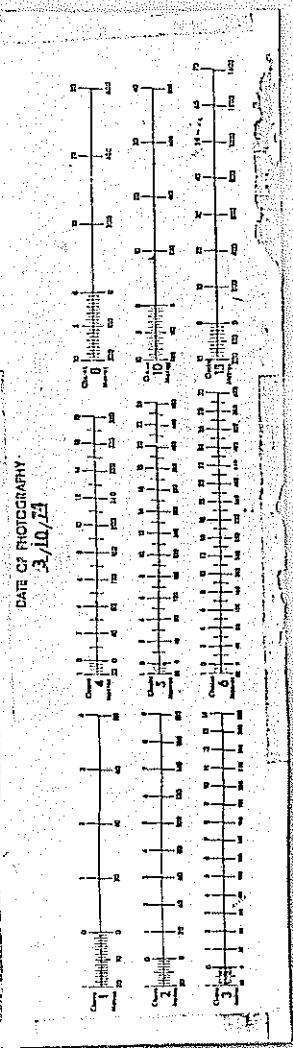

| FROM | COLOR | AREA | REMARKS |
|-------------|--------|--------|---------|
| BLK 10 | ORANGE | 6-1-23 | ROAD |
| HOPKINS L&L | RED | 0-1-07 | " |
| WYCKOFF L&L | BLUE | 0-2 | " |

TOTAL AREA 6-8-32

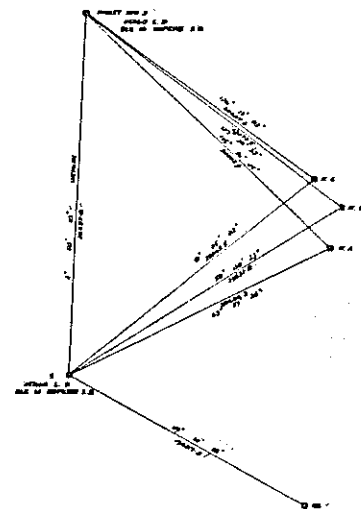

Note - Glen Lyon Road accepted as defining position of road shown on Twp Plan S.F. Legal, 1 chn wide, Sec. 110(a) Public Works Act 1928

Approved: F. Fournier, A.S.P.
 Phil...
 Reference Plan...
 Public...
 Examined by...
 Dated...
 This is to be approved...

S.O.11236

I, Bruce Innes, Esq., of Toronto, Registered Surveyor and holder of an annual practicing license made in accordance with the regulations under the Surveyors Act 1938
 Dated at Toronto this 27th day of April 1969

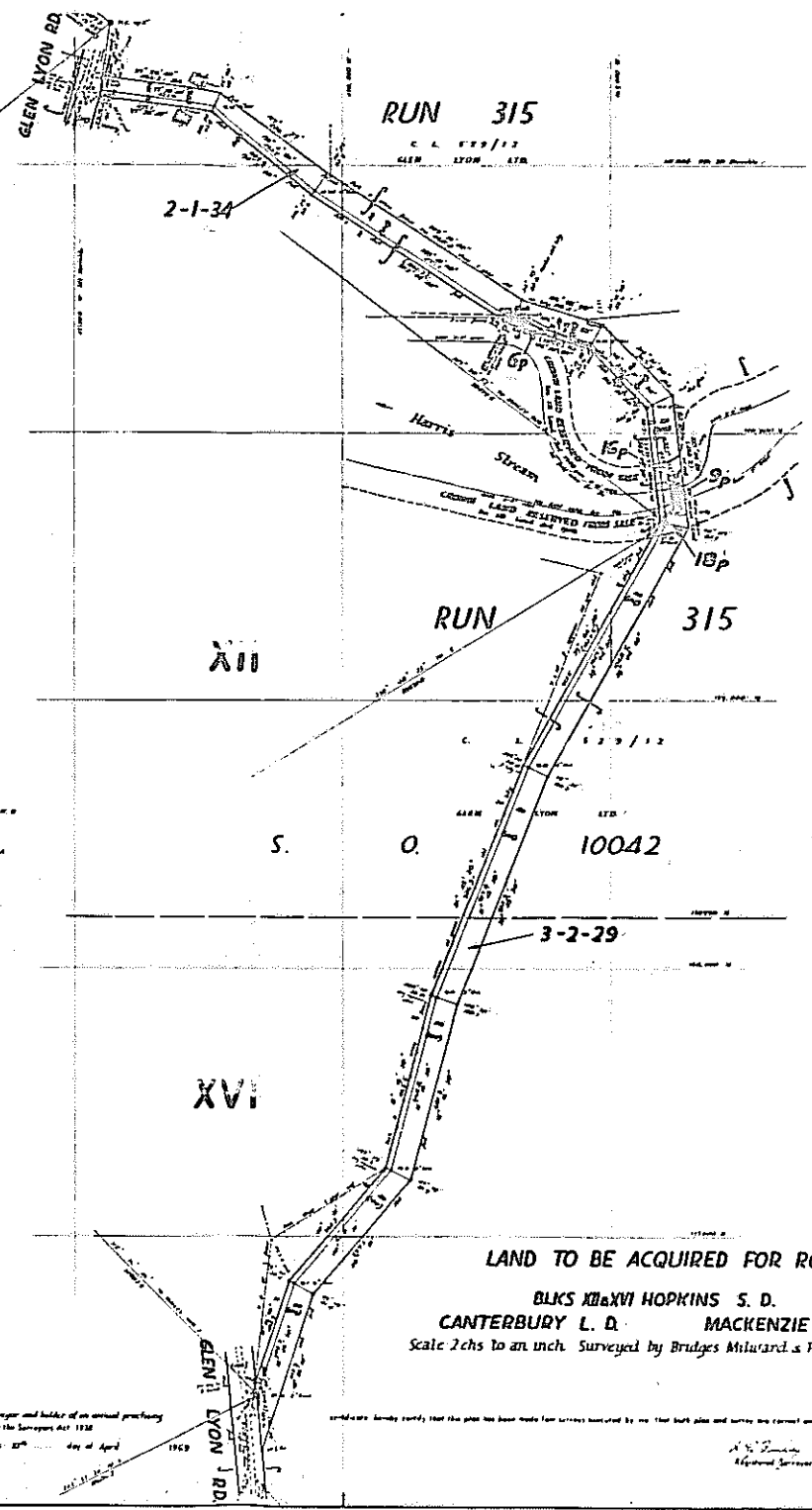

Bearing: Coordinates
 in 1948
 Geodesic Datum 1749

LAND TO BE ACQUIRED FOR ROAD
 BLKS XII & XVI HOPKINS S. D.
 CANTERBURY L. D. MACKENZIE COUNTY
 Scale 2 chs to an inch. Surveyed by Bridges Milward & Fougere

Approved: March 26/69
 Chief Surveyor
 11236

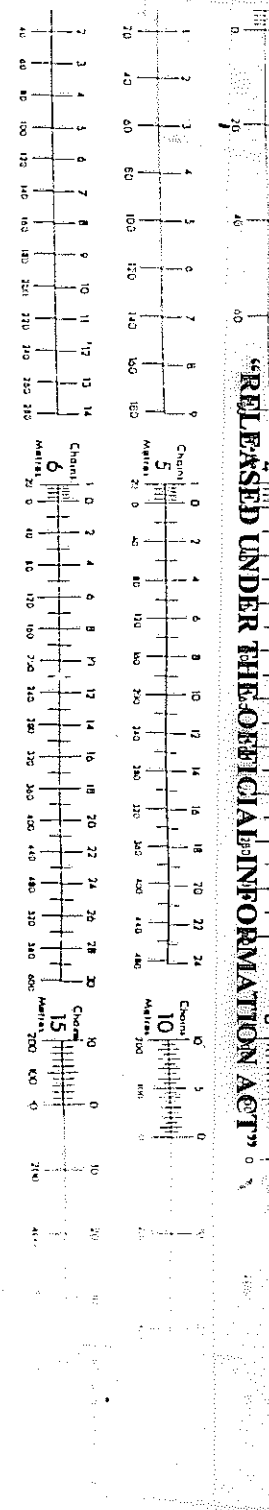
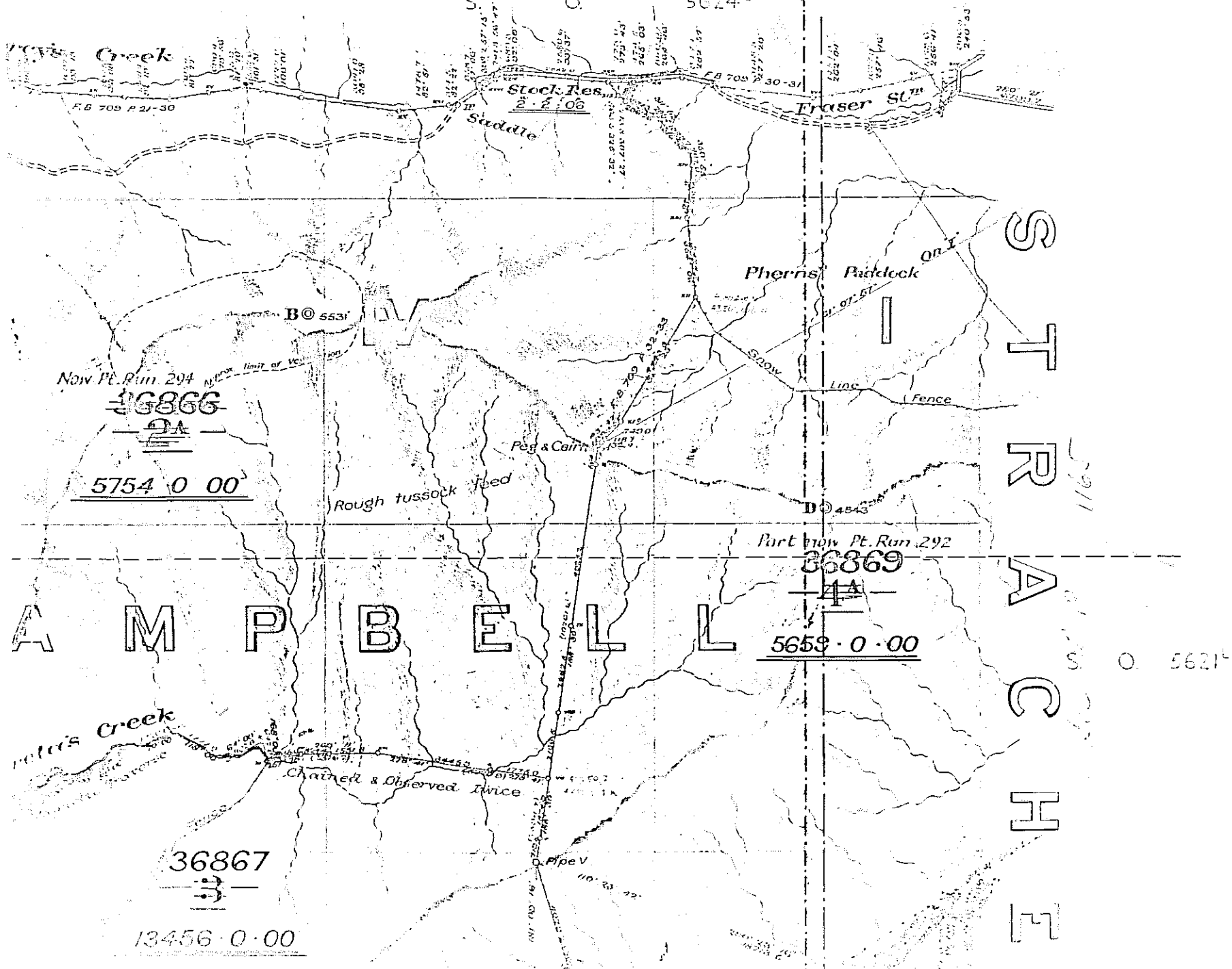

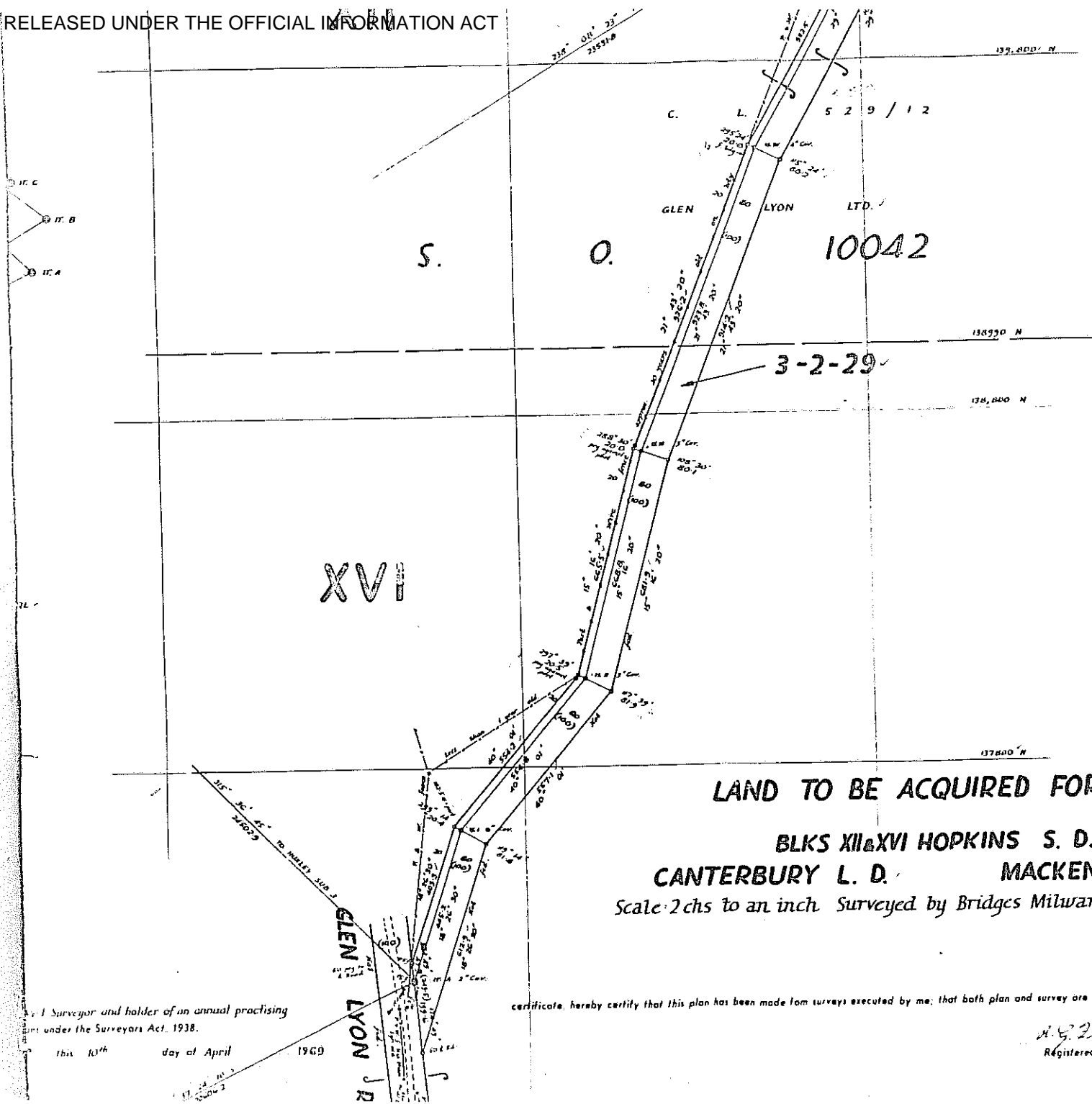

Bearings Co-ordinates
in terms of
Geodetic Datum 1949

LAND TO BE ACQUIRED FOR ROAD

**BLKS XII & XVI HOPKINS S. D.
CANTERBURY L. D. MACKENZIE COUNTY**
Scale 2 chs to an inch Surveyed by Bridges Milward & Fougere March 1969

Approved _____
 Chief Surveyor _____
 This space reserved for plan numbers
 11290

certificate, hereby certify that this plan has been made from surveys executed by me; that both plan and survey are correct and have

A. G. Lindsay
Registered Surveyor.

I, Surveyor and holder of an annual practising certificate under the Surveyors Act, 1938.
This 10th day of April 1969

XVI

10042

3-2-29

529/12

GLEN LYON LTD.

S. O.

GLEN LYON R

11290

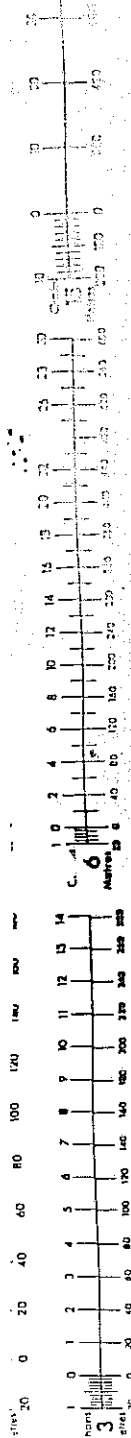

| FROM | COLOUR | AREA | PURPOSE |
|------------|--------|--------|---------|
| RUN 315 | ORANGE | 6-0-23 | ROAD |
| GRASS LAND | RED | 0-1-00 | - - |
| STREAM BED | BLUE | 9p. | - - |

TOTAL AREA 6-1-32

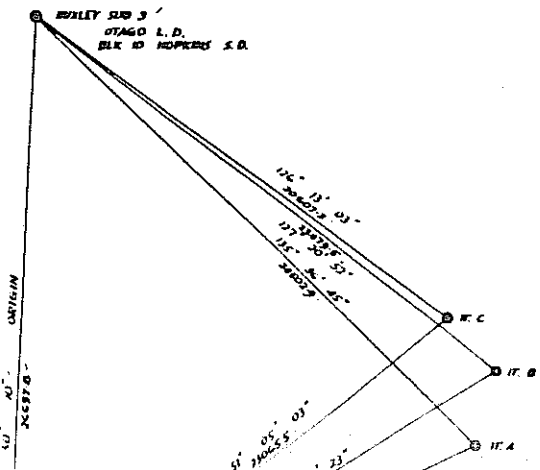

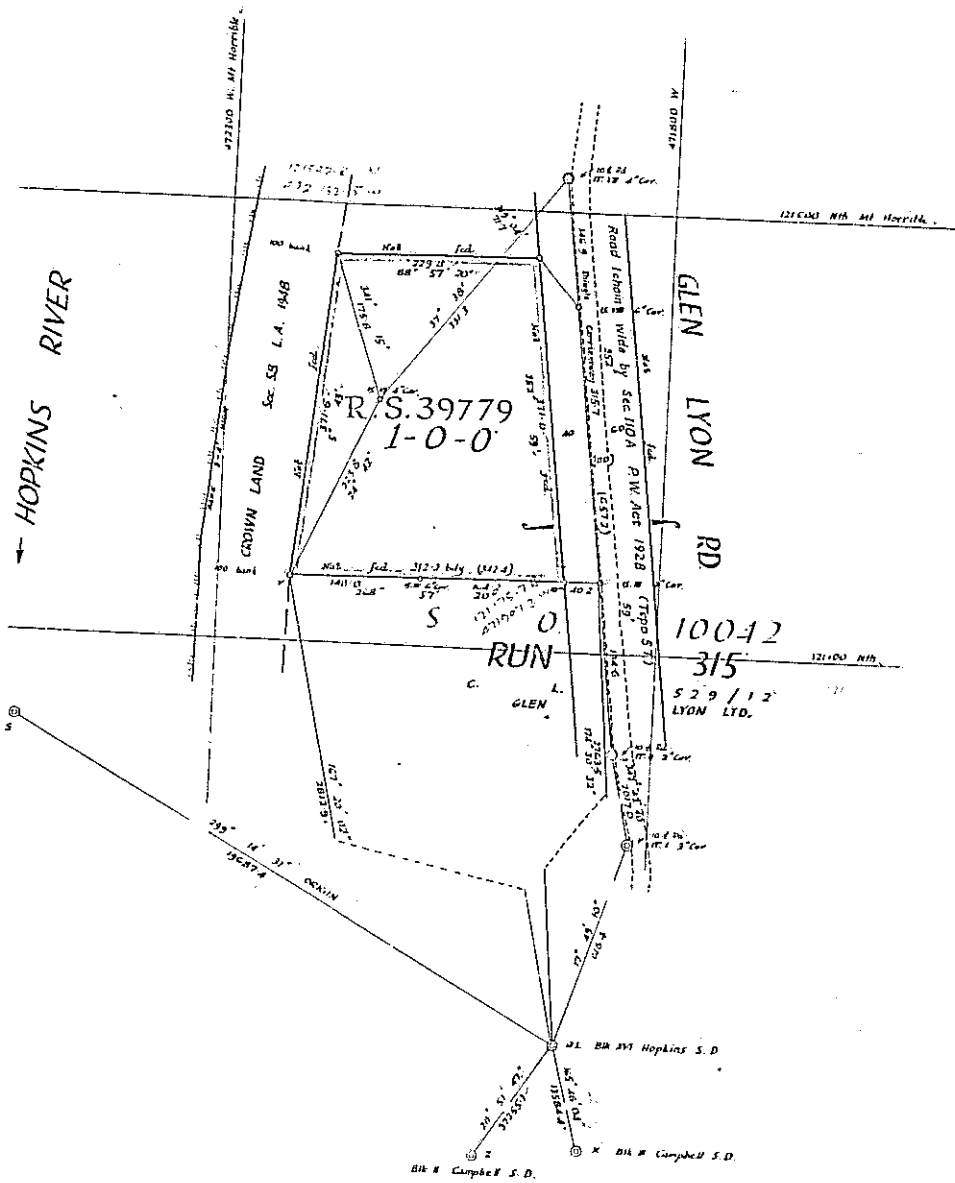
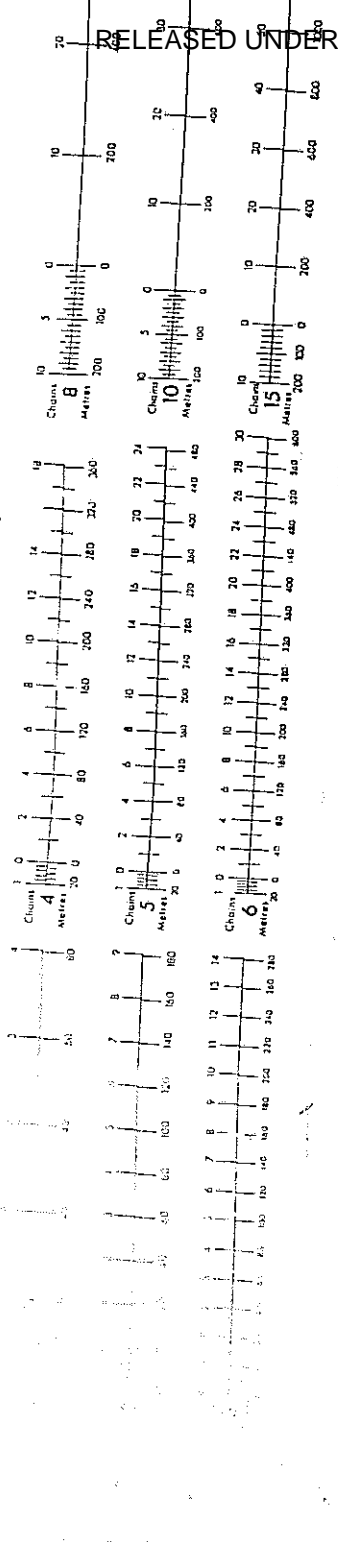

Bearings Co-ordinates
In terms of
Geodetic Datum 1949.

For Local Body consent to
subdivision see file, folio 560

TOTAL AREA 1-0-0

Received B.R.L. 20-7-69
File P.7
Instructions
Reference Plans S.O.J.O.M.2, Tappo S.T.
Field book 17312, p. 234
Traverse book 22, p. 130
Examined by R. Greening, C.A. 219
Recorded
Plan in order for approval
27/7/69

PLAN OF PT. RUN 315

Survey Block & District BLK XVI HOPKINS S.D.
Land District CANTERBURY Local Body MACKENZIE COUNTY
Scale ONE CHAIN TO AN INCH Surveyed by BRIDGES, MILWARD & FOUNSLER Date MARCH 1969
I, GEORGE FINLAY of 115/115 Registered Surveyor and holder of an annual practicing certificate, do hereby certify that this plan has been made from surveys executed by me; that both plan and survey are correct and have been made in accordance with the regulations under the Surveyors Act, 1928
Dated at TAKAPUA this 16 day of APRIL 1969

Approved.....
Chief Surveyor J. J.
17 208

S.O. 5620

S. O. 10042

S.O.5620

Run 93⁴ Glen Lyon Station

Rhebert Downs Subdv²
5624⁴

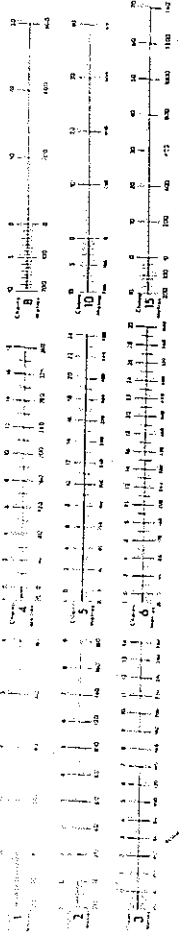

DATE OF PHOTOGRAPHY
14/9/1972

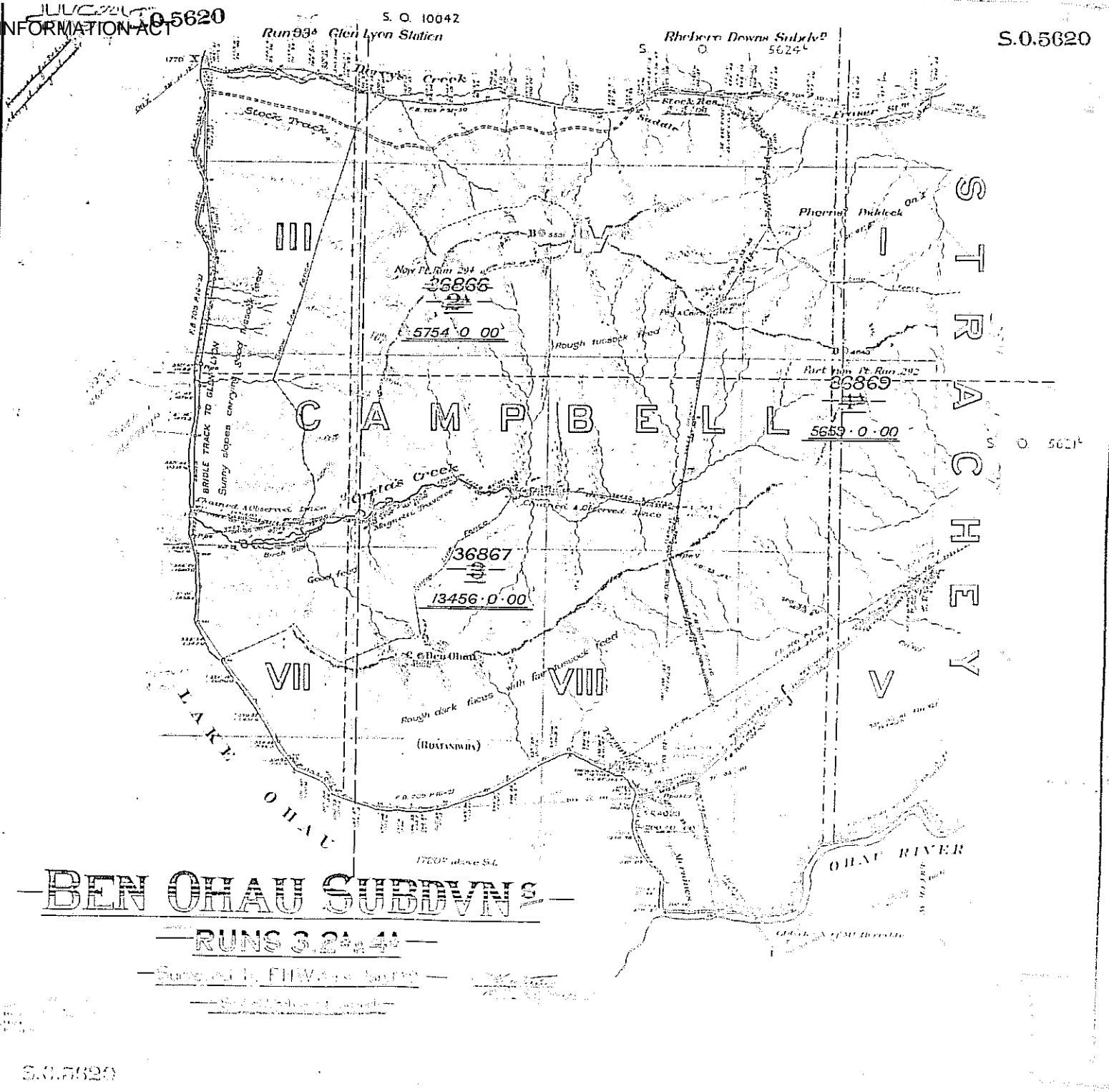

BEN OHAU SUBDIVN 3

RUNS 3, 2, 4

Surveyed by F.H.W. & S. on 1972

S.O. 5620

05620

Run 93^A Glen Lyon Station

Rhebaro Dov

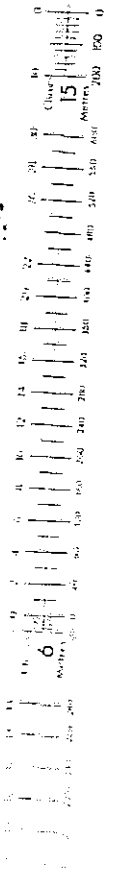
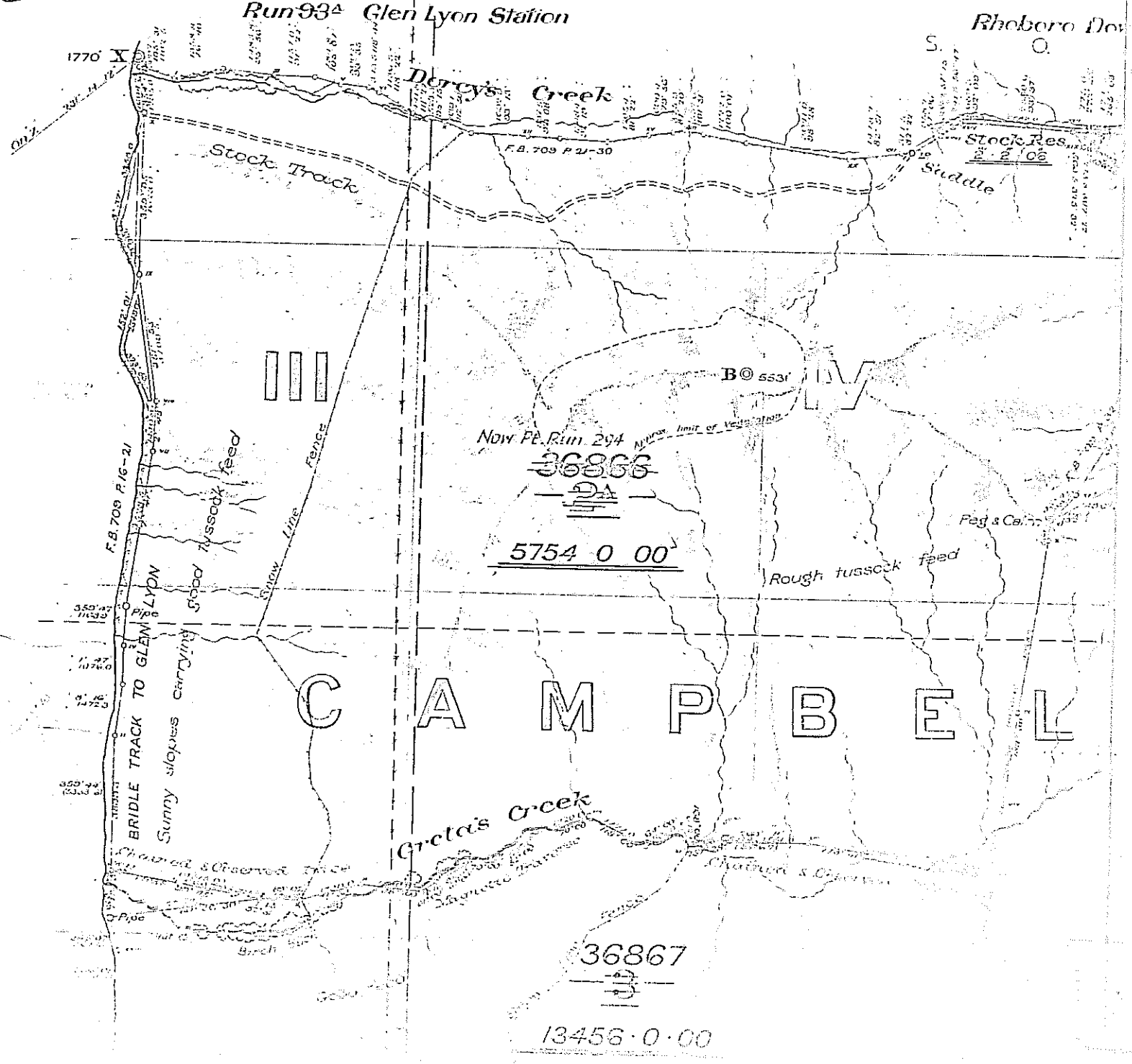

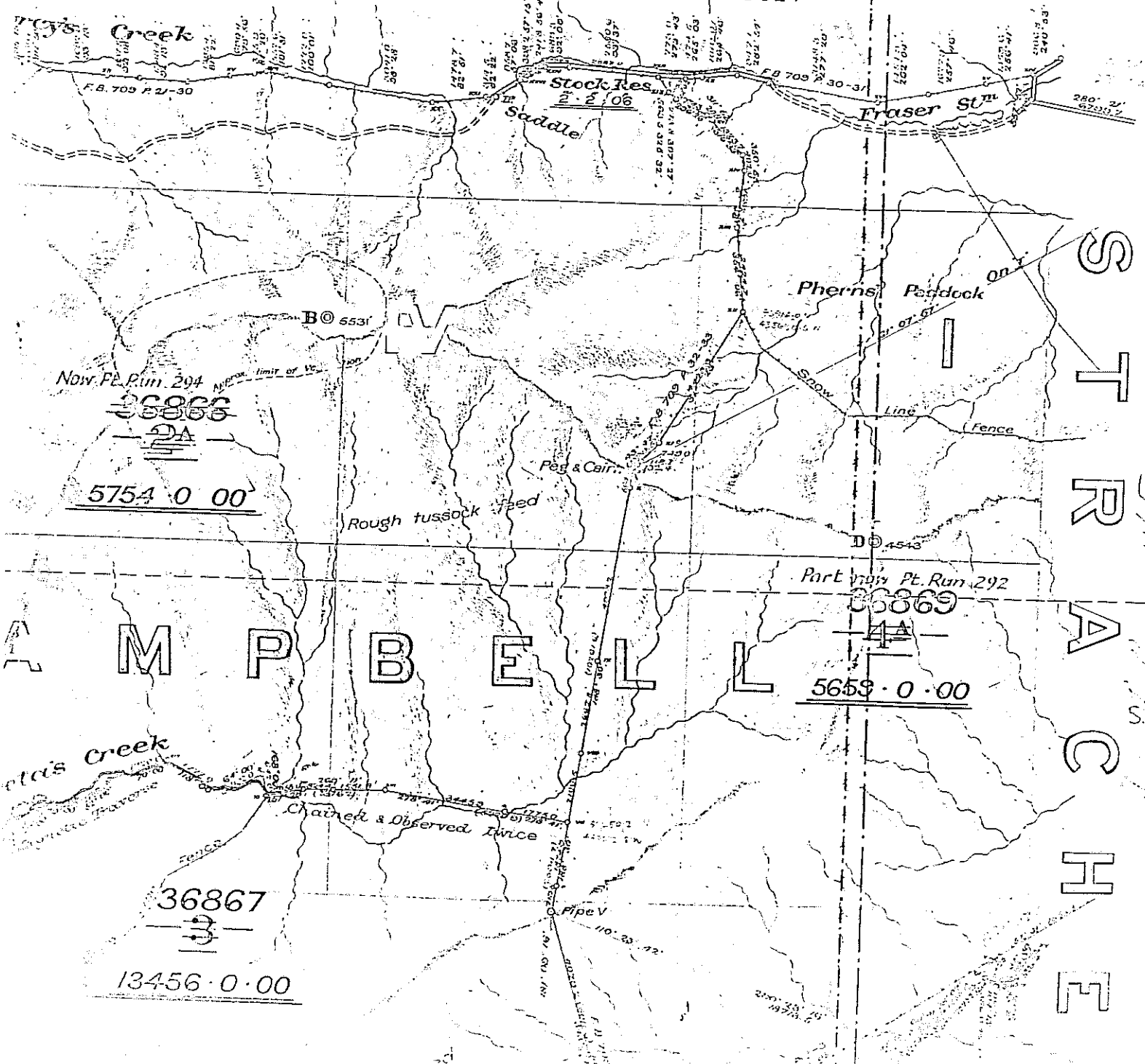

STRACHE

5911

O. 5621^L

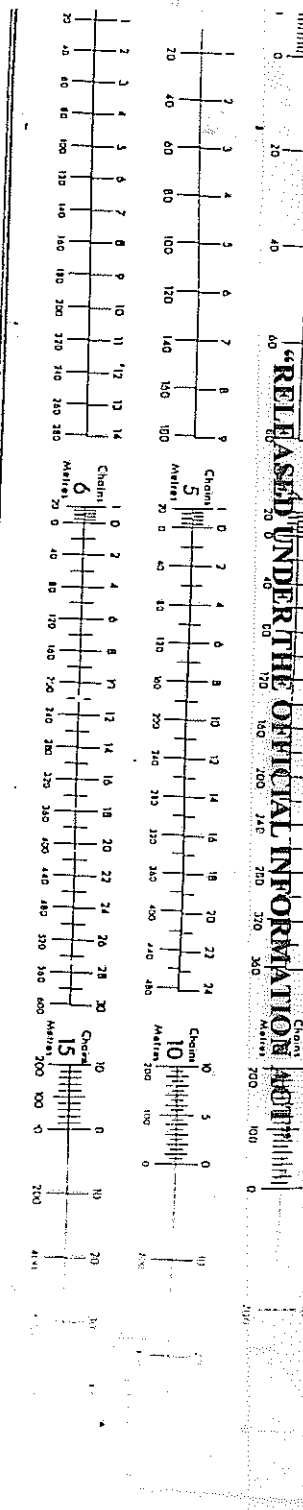

XVI

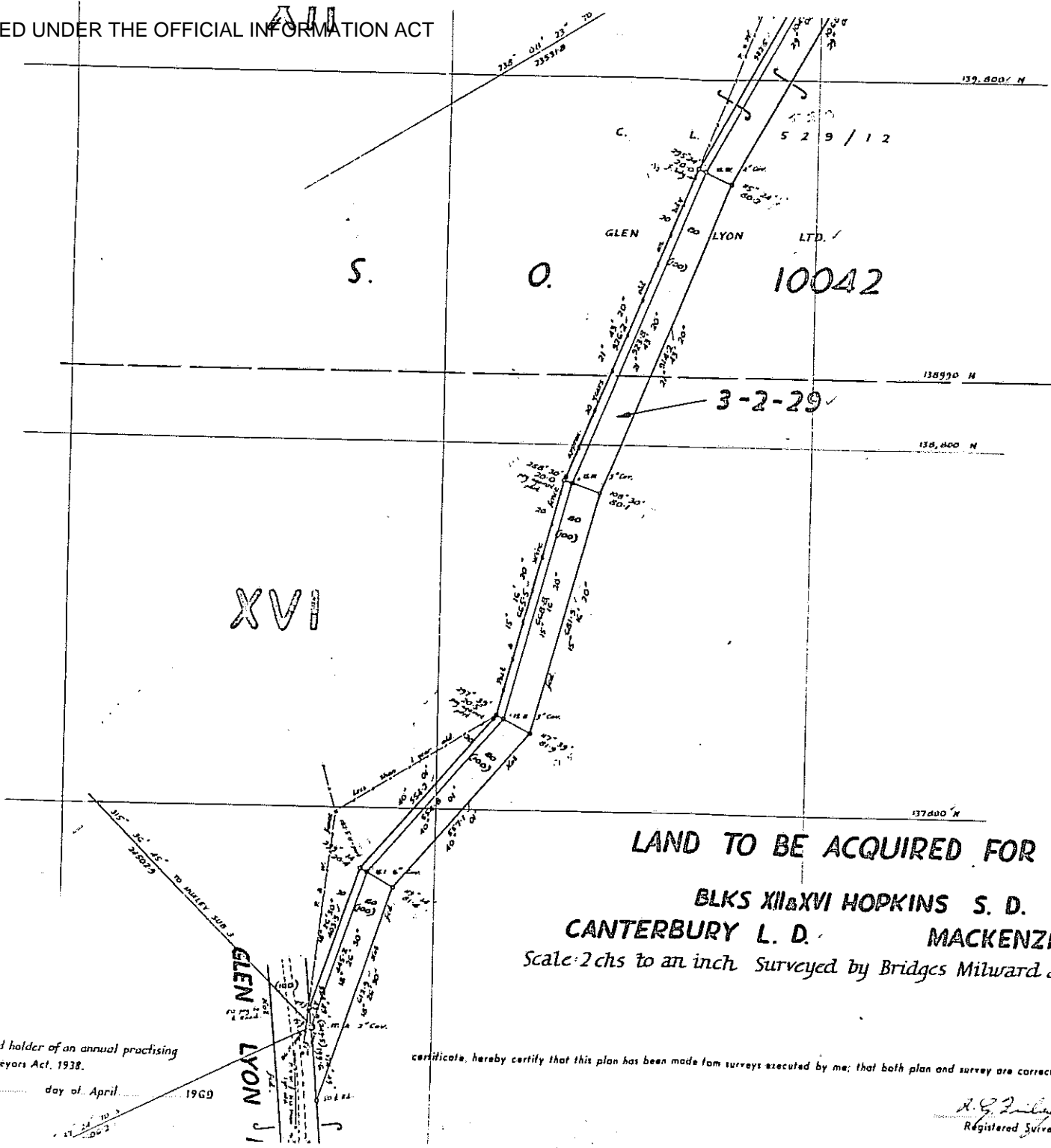

10042

3-2-29

XVI

LAND TO BE ACQUIRED FOR ROAD

BLKS XII & XVI HOPKINS S. D.
CANTERBURY L. D. MACKENZIE COUNTY

Scale: 2 chs to an inch. Surveyed by Bridges Milward & Fougere March 1969

Bearings Co-ordinates
in terms of
Geodetic Datum 1949

I, the Surveyor and holder of an annual practising
certificate under the Surveyors Act, 1938,
this 10th day of April 1969

I hereby certify that this plan has been made from surveys executed by me; that both plan and survey are correct and have

A. G. Zimley
Registered Surveyor.

| |
|---|
| Approved..... |
| <i>[Signature]</i> |
| Chief Surveyor |
| <small>This space reserved for plan numbers</small> |

11220

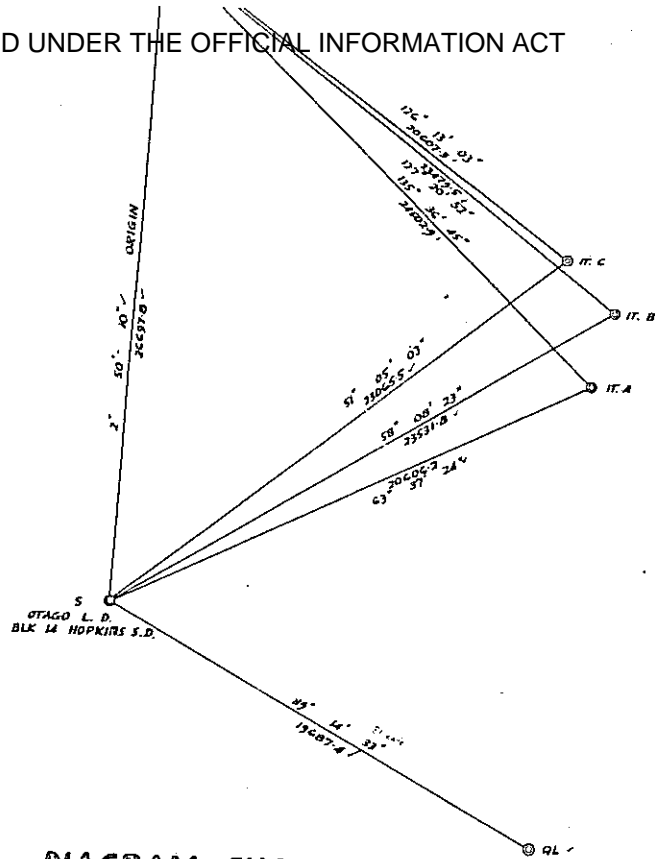

DIAGRAM SHOWING ORIGIN
Scale: 40 chs to an inch.

Note: Glen Lyon Road accepted as defining position of road shown on Topo Plan 5T: Legal, 1 chm. wide, Sec. 110(a) Public Works Act 1928

| | |
|----------------------------|----------------|
| Received N. Bayly | 24.69 |
| File | 9/31 |
| Instructions | |
| Reference Plans | Topo 5T: Legal |
| Field book | 1229 p. 82-86 |
| Traverse book | 27 p. 98-100 |
| Examined by | R. G. Finlay |
| Recorded | R. G. Finlay |
| Plan in order for approval | |

I, Russell George Finlay of Timaru, Registered Surveyor and holder of an annual practising certificate, hereby certify that this plan has been made from survey executed by me

Dated at Timaru this 10th day of April 1969

C O 11236

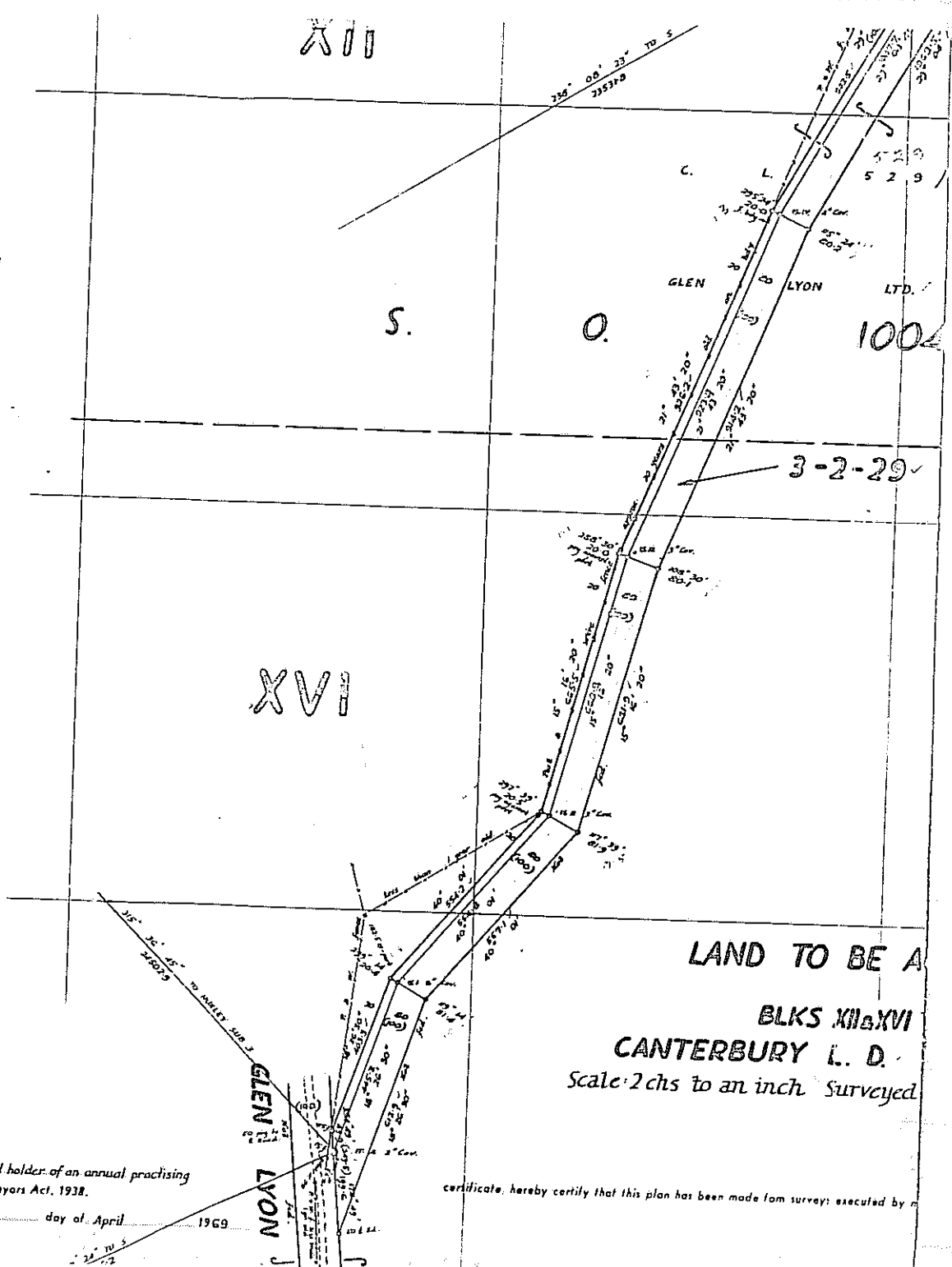

LAND TO BE A
BLKS XII&XVI
CANTERBURY L. D.
Scale: 2 chs to an inch Surveyed

RUN 315

C. L. 529/12
GLEN LYON LTD.

2-1-34

GLEN LYON

Harris Stream

CROWN LAND RESERVED FROM SALE
Sec. 8B Land Act 1940

RUN

315

XII

529/12

GLEN LYON LTD.

10042

S. O.

RELEASED UNDER THE OFFICIAL INFORMATION ACT

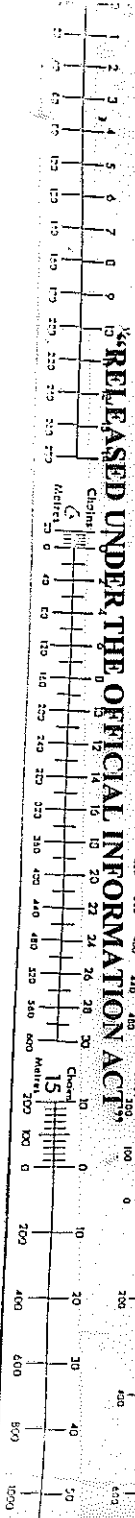

S.O. 11236

S.O. 11236

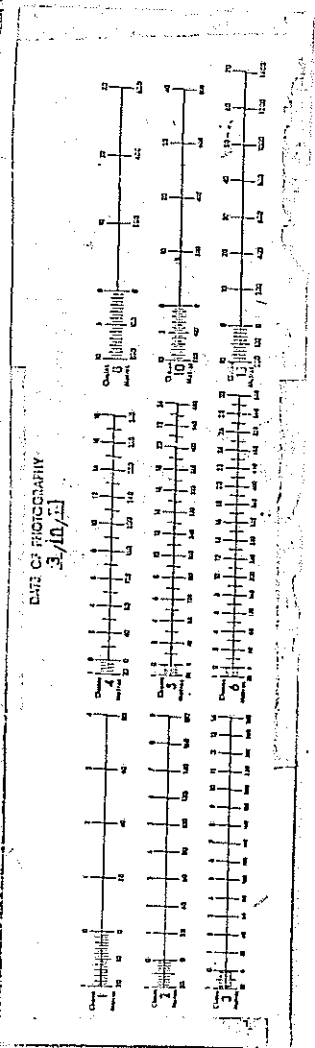

| FROM | COLOUR | AREA | FINISHED |
|--------|-----------|--------|----------|
| 2-1-34 | GREEN | 6-4-23 | 2-1-34 |
| 3-2-29 | RED | 0-1-21 | - |
| TOTAL | EST. AREA | 6-5-44 | - |

TOTAL AREA 6-5-44

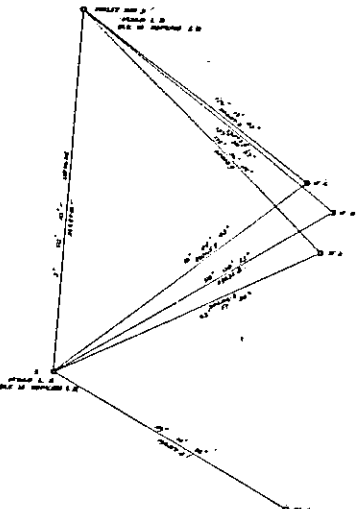

Note: Glen Lyon Road accepted as defining position of road shown on Topo Plan S.T. Legal, 1 chn wide, Sec 110(a) Public Works Act 1928

| | |
|-----------------|-----|
| Amount of Money | ... |
| ... | ... |
| ... | ... |
| ... | ... |
| ... | ... |
| ... | ... |
| ... | ... |
| ... | ... |
| ... | ... |
| ... | ... |

I, Bruce George Foley of Ontario, Registered Surveyor and holder of an annual practicing license made in conformity with the regulations under the Surveyors Act 1938

Dated at Toronto this 30th day of April 1969

S.O. 11236

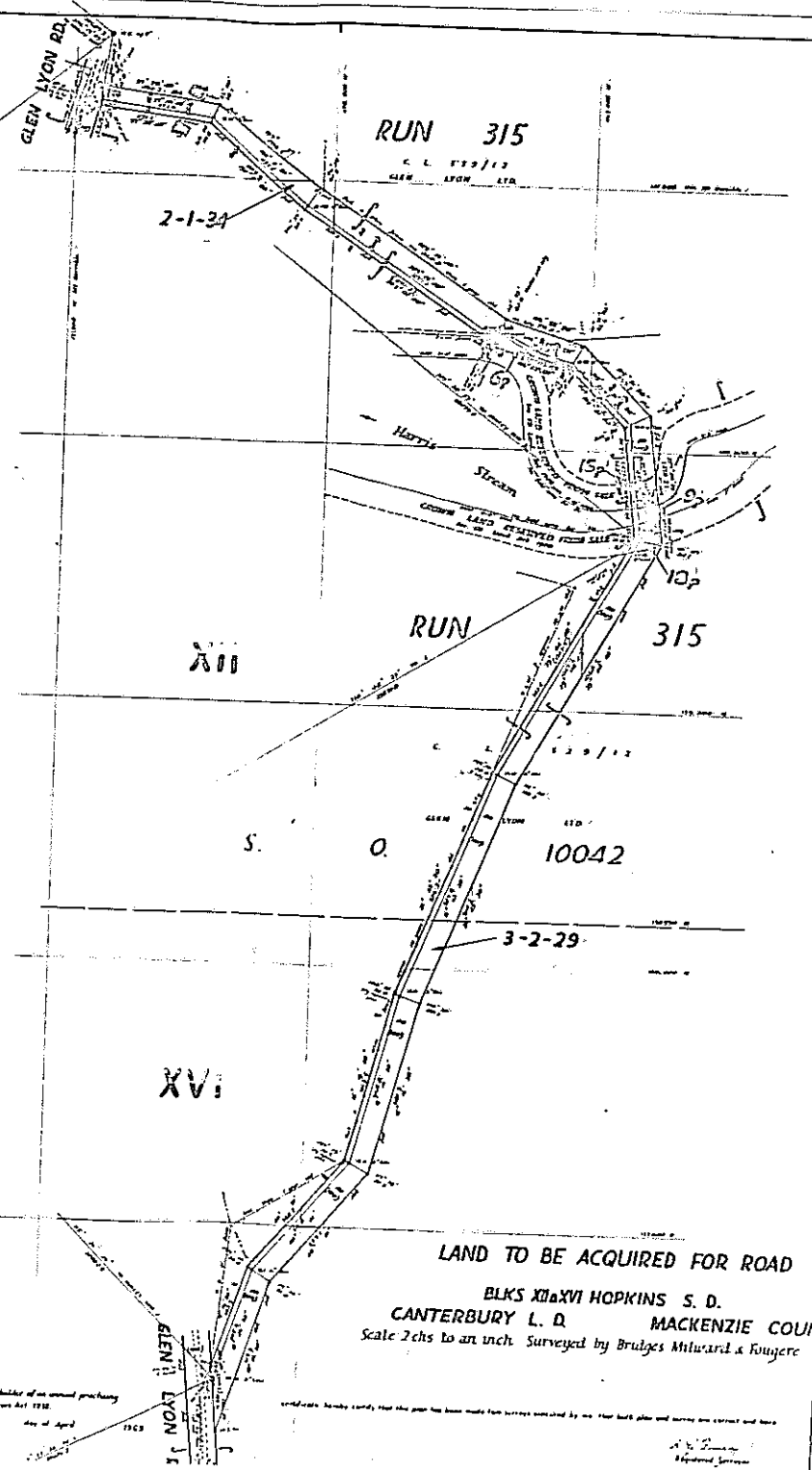

LAND TO BE ACQUIRED FOR ROAD
BLKS XII & XVI HOPKINS S. D.
CANTERBURY L. D. MACKENZIE COUNTY
Scale 2 chs to an inch. Surveyed by Bridges Whitward & Fougere March 1969

Bearing: Coordinates
in 1949
Geodetic Datum 1949

Approved: _____
Chief Surveyor

11000

CANTY PROU GAZETTE 1864

RUNS UNDER THE CANTERBURY LAND REGULATIONS,
CONTAINING 5000 ACRES AND UPWARDS.

(CLASS III.)

| No. | Areaage. | Licencee. | Date of Original License | Rent— 1st May, 1857. | Locality. |
|-----|----------|---|--------------------------|-------------------------|--|
| 1 | 7,400 | Parson, J. | Oct. 1851 | £ 8 0 | North bank of river Waimakariri |
| 1a | 12,300 | Dalgaty, H. R. | Sept. 1851 | 46 8 0 | Junction of the Okuku and Ashley |
| 2 | 7,000 | Chapman, R. | Oct. 1851 | 43 15 0 | Between Ryrs and Coast |
| 4c | 6,100 | New Zealand Trust and Loan Company | Sept. 1851 | 31 17 6 | Near C. 6, Christchurch and Lincoln districts |
| 6 | 20,650 | Walker, E. H. | Do | 120 1 8 | North bank Waimakariri |
| 7 | 5,500 | Rhodes, R. H. | Jan. 1851 | 34 7 6 | Porus, Port Lyttelton |
| 8 | 4,500 | Courage, F. | Sept. 1851 | 40 12 6 | Between Waipara and Kowai, Mimimole Downs |
| 11 | 11,300 | O'Connell, S. | Jan. 1852 | 70 0 0 | Between Kowai and Ashley, Mount Grey |
| 12 | 7,600 | Gobbie, M. | Do | 47 10 0 | Gobbie Flat, Port Lyttelton |
| 13 | | | March 1852 | | |
| 13 | | | May 1852 | | |
| 14 | 5,000 | Wright and Lucas | Oct. 1851 | 31 8 0 | West Head, Akaroa |
| 14 | 6,300 | Murphy, J. R. | Oct. 1851 | 19 7 6 | Joining No. 3 between Eyre and Coast |
| 15 | 5,000 | Oridland, H. J. | Sept. 1852 | 31 6 0 | North bank of north branch of river Ashburton |
| 16 | 8,000 | Karslake and Anson | May 1852 | 80 0 0 | Forks of River Selwyn |
| 17 | 11,850 | Hall, John | Nov. 1852 | 74 8 0 | North bank of River Rakia, between 25 and 28 M |
| 19 | 7,400 | Bealey, J. and S. | May 1852 | 46 8 0 | Between Wakapea and Hororata, Selwyn |
| 20 | 19,650 | Hall, John | Aug. 1851 | 124 2 3 | North bank of Rakia, Rakia terrace |
| 21 | 23,700 | Lee, G. W. H. | May 1856 | 145 2 6 | North-west of Mount Thomas, River Ashley |
| 22 | 5,800 | Ross, G. A. E. | Dec. 1851 | 36 17 6 | Forks of the River Selwyn |
| 23 | 15,100 | Douglas, T. | Aug. 1851 | 94 7 6 | Malvern Hills |
| 24 | 7,800 | Ward, J. H. | Jan. 1852 | 48 15 0 | Ditto |
| 25 | 25,000 | Thomson, Bros. | May 1855 | 156 8 0 | Rivers Makikihi and Hook |
| 26 | 9,400 | Brabazon and Newton | Sept. 1851 | 68 15 0 | South bank of River Waimakariri |
| 27 | | | Aug. 1853 | | |
| 29 | 7,200 | Ellis, T. | May 1852 | 45 0 0 | Rivers Ashley and Coast, west of No. 2 |
| 30 | 10,300 | Rhodes, G. | Jan. 1853 | 63 15 0 | At Kaikona |
| 30a | 7,000 | Rhodes and Haylock | Do | 43 15 0 | Banks Peninsula, Flax Bay |
| 31 | 24,950 | Trust and Agency Company of Australasia | July 1856 | 155 18 9 | South of Otiao |
| 22 | 8,750 | Trust and Agency Company of Australasia | June 1855 | 84 13 9 | Between River Waimakariri and Eyre |
| 33 | 10,250 | Phillips, H. | May 1852 | 64 2 3 | North bank of the Rakia |
| 34 | 6,600 | Rhodes and Wilkie | June 1852 | 41 5 0 | Between Rivers Eyre and Coast |
| 35 | 10,800 | Trust and Agency Company of Australasia | Do | 67 10 0 | River Eyre, adjoining No. 1 |
| 37 | 7,500 | Brabazon and Newton | Oct. 1851 | 46 17 6 | South bank of River Waimakariri |
| 37a | 7,100 | McLean, A. | Do | 44 7 6 | Ditto ditto |
| 38 | 9,680 | Hill and Broome | Sept. 1852 | 60 10 0 | Wakapea branch of River Selwyn |
| 39 | 14,000 | Owen, Rev. J. | Aug. 1851 | 45 12 6 | South bank of Waimakariri |
| 40 | 17,500 | Wilson, J. C. | Oct. 1851 | 111 5 0 | North bank of River Selwyn |
| 42 | | | May 1853 | | |
| 43 | | | Aug. 1853 | | |
| 41 | 30,850 | Dean's Trustees and James Young Deans | Oct. 1851 | 127 3 9 | Malvern Hills |
| 42 | 5,000 | Oridland, H. J. | Sept. 1853 | 31 5 0 | North bank of River Ashburton |
| 44 | 10,000 | Trust and Agency Company of Australasia | July 1856 | 63 10 0 | Forks of River Ashburton |
| 45 | 20,000 | Watson and Brown | Do | 125 0 0 | McKenzie Country |
| 46 | 9,300 | Westons, P. | May 1852 | 58 2 8 | South bank of River Selwyn |
| 47 | 5,000 | Ditto | Do | 81 5 0 | Ditto ditto |
| 48 | 5,000 | Bealey, J. and S. | Do | 31 5 0 | Hororata branch of River Selwyn |
| 49 | 17,700 | Rhodes, R. H. | Sept. 1852 | 110 12 6 | South bank of River Waimakariri |
| 50 | 7,300 | Ditto | Oct. 1852 | 45 13 6 | Ditto ditto |
| 51 | 10,000 | Lake, A., Representatives of | Sept. 1852 | 62 10 0 | North bank of River Selwyn |
| 52 | 8,000 | Davis, C. | Oct. 1852 | 31 5 0 | South bank of river Selwyn, Ellesmere district |
| 53 | | | May 1853 | | |
| 42b | 8,000 | Ditto | Feb. 1862 | | |
| 54 | 10,000 | Bray, W. B. | Aug. 1853 | 62 10 0 | North bank of River Ashburton |
| 55 | 5,000 | Oridland, H. J. | Oct. 1852 | 31 5 0 | North bank of north branch of Ashburton |
| 57 | 5,000 | Phillips, H. | July 1852 | 31 6 0 | Malvern Hills |
| 57a | 7,000 | Ditto | Aug. 1855 | 43 15 0 | Backwood, Malvern Hills |

| No. | Arreage | Licenses | Date of Original License | Rent— 1st May, 1907. | Locality |
|------|----------|--|--------------------------|-------------------------|---|
| 58 | 14,500 | Aitken, J. C. | Oct. 1854 | £ s. d. 90 13 0 | Between Ashburton and Hinds |
| 59 | 19,400 | Reed, G. | Do | 121 0 0 | Ditto ditto |
| 60 | 5,000 | Bailey, J. and H. | May 1855 | 31 5 0 | Hororata branch of River Selwyn |
| 61 | 5,000 | | Aug. 1855 | 31 5 0 | North branch of River Rakai |
| 62 | 6,000 | | Do | 31 5 0 | Ditto ditto |
| 63 | 6,000 | | Do | 54 7 6 | Ditto ditto |
| 64 | 8,700 | Rhodes, R. H. | Do | 90 0 0 | Between Waimakariri and Hawkins |
| 65 | 14,400 | | Jan. 1853 | 43 15 0 | River Garry, North Ashley |
| 66 | 7,000 | Hart, G. | Do | 46 17 6 | North bank of Rakai |
| 67 | 7,500 | Cordy, J. | May 1856 | 05 10 0 | Lake Pukaki |
| 68 | 10,000 | Wilson and Browne | Dec. 1856 | 150 5 0 | Hunter's Hill, forks of the Waitoa |
| 69 | 25,000 | Stadhofme Bros | Jan. 1857 | 15 13 8 | Banks Peninsula |
| 70 | 5,000 | Magno, H. | Do | 38 15 0 | Ashley district, Mount Grey |
| 71 | 5,200 | Douglas, G. | Jan. 1855 | 50 0 0 | River Garry and Ashley |
| 72 | 6,000 | Brown, J. T. | Do | 34 7 5 | Lincoln district (rig. pole L 7 |
| 73 | 6,500 | Wilson, J. C. | Feb. 1853 | 40 0 0 | Branch of the Okuku |
| 74 | 5,400 | Brown, J. T. | Sept. 1851 | 86 5 0 | River Waipara, Ashley district |
| 75 | 13,800 | Trust and Agency Comp. | Mar. 1853 | 31 5 0 | South-east end of Banks Peninsula |
| 76 | 5,000 | Malmesche, E., and Le- Herre, F. | Do | | |
| 79 | 5,300 | Taylor, R. | May 1853 | 17 3 9 | Eltham district |
| 432 | | | Mar 1863 | | |
| 82 | (See 63) | Dixon, M. | Do | 46 17 6 | Between Waimakariri and Eyre |
| 83 | 7,500 | | Do | | |
| 85 | 20,000 | Trust and Agency Com- pany of Australasia | Do | 125 0 0 | Lake Coleridge and the north bank of the Rakai |
| 86 | | | Do | 104 1 3 | South bank of Rakai |
| 87 | 16,620 | Hankey and others | Do | 31 5 0 | Ditto |
| 88 | | | Do | 35 12 6 | Ditto |
| 89 | | | Do | 41 17 6 | Ditto |
| 90 | | | July 1853 | 61 17 0 | Between Waimakariri and Eyre |
| 91 | 5,700 | New Zealand Trust and Loan Company | Do | 60 0 0 | South bank of Selwyn |
| 92 | 5,000 | | Do | 62 10 0 | Hilvers Hills |
| 94 | 10,000 | Weslora, R. | Do | | |
| 95 | (See 40) | Wilson, J. O. | Do | | |
| 96 | 9,650 | Trust and Agency Com- pany of Australasia | Aug. 1853 | 61 11 3 | South bank of the Selwyn |
| 97 | 7,200 | Dickinson, Masuda, and Davis | Do | 26 0 0 | Forks of the River Ashburton |
| 98 | 8,000 | Allen, Rev. J. C. | Do | 50 0 0 | North bank of the River Ashburton |
| 99 | 15,500 | Tangred, Sir Thos. | Do | 116 13 0 | Ditto ditto |
| 101 | 7,300 | Gould, G. | Do | 45 12 0 | Ditto ditto |
| 104 | 15,500 | New Zealand Trust and Loan Company | Aug. 1853 | 96 0 0 | Lake Ellesmere |
| 105 | | | May 1862 | 62 10 0 | North-east bank of River Ashburton |
| 106 | 10,000 | Bray, W. B. | Aug. 1853 | 51 7 6 | Ashley district, south bank of Waipara |
| 107 | 6,700 | Trust and Agency Comp. | Do | 118 0 0 | North bank of Rakai |
| 108 | 15,400 | Trust and Agency Com- pany of Australasia | Do | | |
| 109 | 5,000 | Macpherson, J. D. | Do | 31 5 0 | North bank of Waimakariri |
| 112 | 10,000 | Brown and Allan | Oct. 1853 | 62 10 0 | South bank of Rakai |
| 113 | 8,000 | | Do | 50 0 0 | Ditto |
| 114 | (See 26) | Aynsley, E. P. M. | Aug. 1853 | 50 0 0 | Ditto |
| 115 | 8,000 | | Sept. 1853 | 116 17 6 | Ditto |
| 116 | 15,700 | Dunford, W. | Do | 118 15 0 | Ditto |
| 117 | 19,000 | Mackie and Beard | Do | 118 15 0 | Ditto |
| 118 | 19,000 | Kermode and Co. | Do | 90 0 0 | North bank of the Waimakariri |
| 119 | 14,400 | Curtis, T. J. | Aug. 1853 | 62 10 0 | Lake Coleridge |
| 121 | 10,000 | Oakden, J. J. | Oct. 1853 | 31 5 0 | Thirteen-mile Bush, near Lake Coleridge |
| 123 | 5,000 | Trust and Agency Com- pany of Australasia | Do | | |
| 124 | 15,500 | Hart, G. | Do | 121 17 6 | North bank of the River Ashburton |
| 125 | 20,000 | McLenn, J. | May 1855 | 123 0 0 | Main fork of the River Ashburton |
| 126 | 19,000 | Bank of New South Wales | July 1856 | 124 7 0 | Ditto ditto |
| 127 | 5,000 | Macfarlane, J. | Nov. 1853 | 31 5 0 | Under Mount Karetu, Ashley district |
| 128 | 10,000 | Chapman, E. | Do | 62 10 0 | On the beach between Rakai and Ashbur- ton |
| 129 | 20,000 | Hankey and others | Dec. 1853 | 125 0 0 | Ditto ditto |
| 130 | 15,300 | Longden and Deane | Oct. 1851 | 101 5 0 | South bank of the Waimakariri |
| 131 | 5,550 | Hankey and others | Jan. 1857 | 34 13 9 | An Island in the Rakai |
| 132 | 5,500 | Miles and Co. | Mar. 1854 | 39 7 8 | North bank of the Waimakariri |
| 133 | 9,500 | Moore, G. H. | May 1854 | 96 17 6 | Mouth of the River Ashburton |
| 139 | 13,900 | Kermode and Co. | Do | 118 15 0 | On the beach between Rakai and Ashburton |
| 140 | 19,000 | Birding, W. | Dec. 1854 | 31 5 0 | Beach between Lake Ellesmere and the sea |
| 143 | 5,000 | Ditto | Nov. 1856 | 31 5 0 | Ditto ditto |
| 143a | 5,000 | Knovlat, H. C. H. | Dec. 1854 | 31 5 0 | North of the Ashley, Oxford district |
| 145 | 5,000 | Trust and Agency Com- pany of Australasia | 7 Jan. 1856 | 31 5 0 | Malvern Hills, Waikopa |
| 146 | 5,000 | | | | |

| No. | Acres | Licensor. | Date of Original License | Area— 1st May, 1907 | Locality. |
|------|---------|---|--------------------------|------------------------|--|
| 149 | 9,800 | Aynsley, H. P. M. | May 1855 | 61 2 0 | South bank of the Rakia |
| 150 | 27,400 | Moore, G. H. | July 1855 | 171 2 0 | Beach between Rakia and Ashburton |
| 151 | 2,000 | Douglas, T. | Do | 31 5 0 | Malvern Hills, Kowai |
| 152 | 9,000 | Aynsley, H. P. M. | Aug. 1855 | 34 5 0 | Gorge of Rakia, near Mount Hutt |
| 153 | 22,000 | Barker, A. C. | Do | 200 0 0 | Near Lake Coleridge |
| 153a | 16,000 | Harper, C. J. | Do | 100 0 0 | Do do |
| 154 | 9,000 | Mitchin, E. C. | Do | 31 5 0 | North end of Malvern Hills |
| 155 | 10,000 | Osken, J. J. | Oct. 1855 | 62 10 0 | Near Lake Coleridge |
| 157 | 9,000 | Purnell, T. A. | Mar. 1857 | 31 5 0 | Upper forks of the Huru Opiti |
| 157a | 16,000 | Do | Do | 33 15 0 | Do do |
| 158 | 10,300 | Douglas, Alderson & Co. | Feb. 1857 | 150 12 0 | Hokateremoa, Waitangi |
| 160 | 40,000 | Trust and Agency Company of Australasia | Mar. 1857 | 250 0 0 | West of Hunter Hill, adjoining 23 |
| 161 | 21,400 | Allen, J. C. & J. H. R. | Do | 122 12 0 | River Waikato, Timaru district |
| 162 | 20,000 | Delzell, J. S. | Sept. 1857 | 125 6 0 | Do do |
| 164 | 20,000 | Mason, G. | Mar. 1857 | 150 2 0 | Gorge of the Pareora |
| 165 | 25,000 | Macfarlane, J. | Aug. 1857 | 150 2 0 | North of Mount Grey and Kareru |
| 166 | 25,000 | Macfarlane, J. | Aug. 1857 | 150 2 0 | South of the River Waipara |
| 169 | 3,000 | Lee, G. W. H. | April 1857 | 31 5 0 | Upper valley of the Ashley |
| 170 | 3,000 | Do | Do | 31 5 0 | Do do |
| 171 | 10,000 | Watson and Brown | Do | 62 10 0 | Lake Pukaki, Waitangi district |
| 172 | 15,000 | Hay, J. | Do | 63 15 0 | Lake Tekapo, Waitangi district |
| 173 | 10,000 | Hay, E., Reps. of late | Do | 63 10 0 | Do do |
| 174 | 29,000 | Bank of New South Wales | Do | 181 5 0 | Lake Heron, west of Mount Somers |
| 175 | 11,000 | Trust and Agency Company of Australasia | Do | 68 10 0 | Do do |
| 179 | 20,000 | Fraser, H. | Do | 170 0 0 | East of Lake Pukaki, Waitangi |
| 180 | 16,000 | Fraser, H. | Do | 62 10 0 | East of Lake Pukaki, north of Waitangi |
| 181 | 20,000 | Potts, T. H. | Do | 124 0 0 | West of Mount Somers range, south of Ashburton |
| 182 | 5,000 | Trust and Agency Company of Australasia | Do | 21 5 0 | Ashburton, adjoining run 44 |
| 184 | 25,000 | Maitland and Ender | May 1857 | 150 5 0 | Markenrie Pass |
| 185 | 20,000 | Patterson, A. | April 1857 | 125 0 0 | Waitangi district, north of run 43 |
| 186 | 18,000 | Clowes, T. A. | May 1857 | 62 15 0 | Do between 1st & 2nd branches |
| 187 | 3,000 | Do | Do | 31 5 0 | Do north of 186 |
| 189 | 7,000 | Potts, T. H. | Do | 43 15 0 | West of Mount Somers range, south of Ashburton |
| 190 | 9,000 | Deane, R. | Do | 32 5 0 | Malvern Hills, adjoining 190 |
| 191 | 7,000 | Macfarlane, J. | Do | 42 15 0 | Mount Kareru, Ashley district |
| 193 | 10,000 | New Zealand Trust and Loan Company | June 1857 | 62 10 0 | Waipara, south-west of 165, north-west of 161 |
| 194 | 3,000 | O'Connell, S. | Do | 31 5 0 | Mount Grey |
| 195 | 3,000 | Scars, F. D. S. | Do | 31 5 0 | Above Lake Coleridge |
| 197 | 85,000 | Douglas, Alderson & Co. | Oct. 1858 | 421 5 0 | Waitangi district, Hokateremoa |
| 198 | 10,000 | Do | June 1857 | 62 10 0 | Do adjoining run 185 |
| 199 | 9,000 | Brown and Allen | July 1857 | 36 2 0 | Between Rakia and Ashburton |
| 200 | 21,400 | Campbell, M. S. & R. H. | Do | 122 12 0 | Upper Waikato, Waimakariri |
| 201 | 3,000 | Coster, J. L. | Do | 31 5 0 | Above Rakia Gorge, south bank |
| 202 | 20,000 | Taylor, H. | Do | 125 0 0 | Above Hurunui Gorge |
| 204 | 11,800 | Stutholme, Brns. | Aug. 1858 | 72 12 0 | Timaru district, between Waimata & the sea |
| 205 | 15,000 | Trust and Agency Company of Australasia | Jan. 1858 | 89 12 0 | Forks of Waimakariri, north-west of Mount Torlesse |
| 205a | 10,000 | Do do | Do | 62 10 0 | Do do joining 205 |
| 207 | 5,000 | Taylor, H. | Aug. 1857 | 31 5 0 | South side of southern branch of Hurunui |
| 208 | 30,000 | Gibson, H. | Sept. 1857 | 157 10 0 | Waitangi Coal-Quarry |
| 210 | 6,500 | Langton, J. | Do | 40 15 0 | Malvern Hills, Mount Torlesse range |
| 211 | 3,000 | Deane, R. | Do | 31 5 0 | Do joining 194 and 190 |
| 212 | 12,000 | Wentres, J. E. | Do | 75 0 0 | Lake Sumner, upper valley of Hurunui |
| 213 | See 181 | Do | Do | Do | Do |
| 214 | 2,450 | Butler, S. | Oct. 1857 | 34 1 3 | Upper forks of the Rangitikei |
| 215 | 13,700 | Foster and Moore | Do | 84 12 6 | Upper valley of the Waimakariri |
| 216 | 14,300 | Hawdon, J. | Do | 29 7 6 | Do do |
| 216a | 5,000 | Campbell, M. S. & R. H. | Do | 31 5 0 | Do do |
| 217 | 10,800 | Do | Do | 68 2 6 | Do do |
| 218 | 10,000 | Do | Do | 62 10 0 | Do do |
| 218a | 9,000 | Mitchin, E. C. | Do | 50 0 0 | Do do |
| 221 | 5,000 | Campbell, B., jun. | April 1857 | 31 5 0 | Lake Obou |
| 222 | 28,000 | Trust and Agency Company of Australasia | Nov. 1857 | 150 2 0 | Gorge of Pareora and Markenrie Pass |
| 224 | 10,000 | Clowes, T. A. | Oct. 1857 | 62 10 0 | Waitangi, north of and adjoining run 187 |
| 225 | 20,000 | Teschmcker Brothers | Nov. 1857 | 125 0 0 | Tekapo stream, Waitangi |
| 229 | 5,000 | Hay, John | Dec. 1857 | 31 5 0 | Do Markenrie Country |
| 230 | 9,800 | Maxwell, R. C. | Do | 61 17 6 | Malvern Hills, Lake Lyndon |
| 232 | 20,000 | Milham, W. K. | May 1858 | 125 0 0 | Upper Valley of the Ashley |
| 237 | 20,000 | Milham, W. K. | Dec. 1857 | 125 0 0 | Upper Valley of the Ashley |

| No. | Amount. | Licensee. | Date of Original License | Rent— | Locality. | |
|------|---------|---|--------------------------|----------------|---|-----|
| | | | | 1st May, 1907. | | |
| | | | | £ s. d. | | |
| 233 | 15,000 | Russell, G. G. | Jan. 1859 | 93 15 0 | Mackenzie Country | 215 |
| 234 | 5,600 | Brown, J. T. | Do | 34 0 0 | Mount Thomas, Ohuku branch of the Ashley | 216 |
| 234a | 10,000 | Manning, T. S. | Do | 61 10 0 | Do do | 217 |
| 235 | 13,000 | Hart, G. | Aug. 1858 | 61 5 0 | Upper Valley of the Ashley | 218 |
| 236 | 20,000 | Fraser and Bodge | Jan. 1858 | 125 0 0 | Tekapo stream, Waitangi | 219 |
| 237 | 30,000 | Gould, G. | Feb. 1855 | 187 10 0 | Waitangi, north of Teesmaker's run | 220 |
| 238 | 6,400 | Kerr, P. | Do | 40 0 0 | On beach, Christchurch district | 221 |
| 240 | 49,900 | Walker, Choquetou & Walker | Do | 311 17 5 | Timaru district, adjoin. No. 30 N.E. Regla. | 222 |
| 255 | | | May 1858 | | | 223 |
| 241 | 8,000 | Foster and Moore | Feb. 1858 | 51 5 0 | Upper Valley of the Waimakariri | 224 |
| 243 | 10,450 | Butler, S. | Mar. 1859 | 55 6 2 | Upper valley of the Rangitata | 225 |
| 244 | 8,000 | Hay, R. Reps. of | April 1858 | 51 5 0 | Waitangi, Tekapo stream | 226 |
| 246 | 27,500 | Moore, G. H. | Feb. 1858 | 171 17 6 | Birch Hollow, late No. 9, N. Z. Regulations | 227 |
| 247 | 24,800 | Russell, T. | Do | 155 0 0 | Between Hinds and Ashburton, late 65, N. Z. Regulations | 228 |
| 248 | 8,000 | Campbell, M. E. & R. H. | April 1858 | 31 5 0 | Upper valley, Waimakariri | 229 |
| 249 | 10,000 | Olliver, A. | May 1858 | 92 10 0 | Upper Ashburton | 230 |
| 250 | 34,000 | Hargreaves, E. A. | Aug. 1858 | 215 15 0 | Lake Tekapo, Mackenzie Country | 231 |
| 251 | 40,000 | Hall, G. W. | Mar. 1858 | 250 0 0 | Pukaki stream, do | 232 |
| 252 | 20,000 | Russell, G. G. | Do | 125 0 0 | Tekapo stream, do | 233 |
| 253 | 20,000 | Hall, J. | Do | 125 0 0 | Lake Tekapo, do | 234 |
| 254 | 10,000 | Trust and Agency Company of Australasia | Do | 62 10 0 | Burke Pass, Opiti | 235 |
| 255 | | | | | | 236 |
| 256 | 8,000 | Potts, T. H. | Do | 31 5 0 | Rangitata | 237 |
| 257 | 7,000 | Douglas, G. | Do | 43 16 0 | Mount Grey, south of N. branch of riv. Kowai | 238 |
| 258 | | | | | | 239 |
| 260 | 8,000 | Macpherson, J. D. | Do | 31 5 0 | Waimakariri, south-west of Coast and Hak | 240 |
| 261 | 10,000 | Lutmore, P. B. | Do | 62 10 0 | Waitangi junction of Pukaki | 241 |
| 262 | 10,000 | Bank of New South Wales | Do | 62 10 0 | River Ashburton, west of Mount Somers | 242 |
| 263 | 6,000 | New Zealand Trust and Loan Company | Do | 37 10 0 | South side and branch of Hurunui | 243 |
| 264 | 5,000 | Coster, J. L. | June 1858 | 31 5 0 | above Gorge of the Rakais | 244 |
| 265 | 20,000 | Douglas, Alderson & Co. | Do | 125 0 0 | Waitangi, Hakuteramen, and Tekapo | 245 |
| 265a | 15,000 | Do | Do | 93 15 0 | Do do | 246 |
| 266 | 10,000 | Dark, Brothers | June 1858 | 62 10 0 | Lake Pukaki, north of No. 68 | 247 |
| 267 | 9,000 | Do | Do | 56 5 0 | Pukaki, west of, and east of Irishman's creek | 248 |
| 268 | 20,000 | Acland J. B. A. | Aug. 1858 | 125 0 0 | South of the Rangitata | 249 |
| 268 | 20,000 | Hall, G. W. | Do | 125 0 0 | Mackenzie Country | 250 |
| 270 | 7,000 | Foster, J. E. | Do | 43 15 0 | Three miles above Gorge, Waimakariri | 251 |
| 271 | 8,000 | Minchin, E. C. | Do | 50 0 0 | Upper valley, Waimakariri | 252 |
| 272 | 21,150 | Palmer, J. | Sept. 1858 | 129 5 9 | Cascade Creek, forks of the Rakais | 253 |
| 273 | 10,000 | Hall, T. W. | Do | 62 10 0 | Lake Tekapo, Mackenzie Country | 254 |
| 274 | 10,000 | Do | Do | 31 5 0 | East of a stream running into Pukaki | 255 |
| 275 | 30,000 | Do | Do | 187 16 0 | West of Lake Tekapo, Mackenzie Country | 256 |
| 277 | 5,000 | Trust and Agency Company of Australasia | Oct. 1858 | 31 5 0 | Mount Torlesse | 257 |
| 278 | 8,000 | Neave, F. D. S. | Do | 31 5 0 | Forks of the Rakais | 258 |
| 279 | 10,000 | Olliver, A. | Nov. 1858 | 62 10 0 | Between Rakais and Ashburton | 259 |
| 281 | 20,000 | Acland, J. B. A. | Do | 125 0 0 | Rangitata Country | 260 |
| 283 | 5,000 | Mallet, E. | Dec. 1858 | 31 5 0 | River Hak, upper valley of the river Courtney | 261 |
| 284 | 5,000 | Do | Do | 31 5 0 | Do do | 262 |
| 287 | 4,000 | Deane, R. | Jan. 1859 | 31 5 0 | Malvern Hills | 263 |
| 289 | 5,000 | Scott, H. A. | Do | 31 5 0 | Lake Coleridge | 264 |
| 290 | 8,000 | Hall, J. | Do | 50 0 0 | Mackenzie Plains | 265 |
| 291 | 5,000 | Palmer, J. | Feb. 1859 | 35 17 5 | Lake Heron, Branch of Rakais | 266 |
| 293 | 10,000 | Potts, T. H. | Do | 62 10 0 | Ashburton | 267 |
| 294 | 5,000 | Trust and Agency Company of Australasia | Do | 15 12 8 | Upper Waimakariri | 268 |
| 291 | 10,000 | Lutmore, P. B. | Mar. 1859 | 62 10 0 | Mackenzie Plains | 269 |
| 296 | 30,000 | Trust and Agency Company of Australasia | May 1859 | 187 10 0 | Do | 270 |
| 298 | 50,000 | Bank of New South Wales | Do | 31 5 0 | Mount Somers | 271 |
| 300 | 5,000 | Fraser, H. | Do | 31 5 0 | Lake Ohou | 272 |
| 301 | 60,000 | Messrs. Teesmaker, LeCren and Fisher | Do | 375 0 0 | Mackenzie Plains | 273 |
| 302 | 8,000 | Hill, T. | Do | 31 5 0 | Oxford district, west of No. 29 | 274 |
| 303 | 5,000 | Minchin, E. C. | Do | 31 5 0 | East bank of River Poulser, Waimakariri | 275 |
| 304 | 5,000 | Do | Do | 31 5 0 | West do do | 276 |
| 305 | 20,000 | Dampier, Atkinson, and Allen | May 1858 | 125 0 0 | South Bank of Hurunui | 277 |
| 307 | 10,000 | Rodgkinson, G. | Do | 62 10 0 | Lake Ohou | 278 |
| 308 | 20,000 | Acland, J. B. A. | June 1859 | 125 0 0 | Mount Peel | 279 |
| 309 | 10,000 | Mallet, E. | Do | 62 10 0 | Upper Valley, Waimakariri | 280 |
| 310 | 44,500 | Ditto | Do | 199 1 3 | Do do | 281 |
| 311 | 20,000 | Gibson, E. | July 1859 | 125 0 0 | Mackenzie Plains | 282 |
| 314 | 10,000 | Trust and Agency Company of Australasia | August 1859 | 62 10 0 | Gorge of the Rakais | 283 |

Becker

Hastings

Becker

215
216
217
218
219
220
221
222
223
224
225
226
227
228
229
230
231
232
233
234
235
236
237
238
239
240
241
242
243
244
245
246
247
248
249
250
251
252
253
254
255
256
257
258
259
260
261
262
263
264
265
266
267
268
269
270
271
272
273
274
275
276
277
278
279
280
281
282
283
284
285
286
287
288
289
290
291
292
293
294
295
296
297
298
299
300
301
302
303
304
305
306
307
308
309
310
311
312

| No. | Amount | Licence | Date of Original Licence | Sum - 1st May, 1957 | Locality |
|-----|--------|--|--------------------------|------------------------|---|
| 211 | 11,000 | Hodgkinson, G. | Sept. 1850 | 33 18 0 | Lake Okeu |
| 212 | 8,100 | Trust and Agency Company of Australasia | Do | 52 2 8 | New Durie's Pass |
| 219 | 15,000 | Fraser, H. | Oct. 1850 | 81 5 0 | Lake Pukaki |
| 220 | 10,000 | Russell, G. G. | Nov. 1850 | 62 10 0 | East of Lake Tekapo |
| 221 | 20,000 | Pitts, B. | Do | 125 0 0 | Waikati district, formerly 23 New Zealand Regulations |
| 222 | 22,000 | Parker, H. R. and G. B. | Do | 137 10 0 | Do do 24 do |
| 224 | 5,000 | Parkinson, T. H. | Do | 31 5 0 | Little River |
| 225 | 10,000 | Hall, T. W. | Dec. 1850 | 31 5 0 | Lake Pukaki |
| 226 | 15,000 | Fraser, J. | Do | 93 15 0 | East of Pukaki |
| 228 | 5,000 | Trust and Agency Company of Australasia | Do | 31 5 0 | Mount Somers Country, north-west of 175 |
| 229 | 5,000 | Cridland, H. J. | Do | 31 5 0 | Mount Hutt, north of No. 50 |
| 230 | 5,000 | Rhodes, W. R. and G. | June 1850 | 31 5 0 | Banks Peninsula, south of run 7 |
| 231 | 30,000 | Walker, Chapman, and Walker | Jan. 1850 | 187 10 0 | Joining Mr Ashford's runs |
| 232 | 10,000 | Trust and Agency Company of Australasia | Do | 62 10 0 | Do do |
| 233 | 20,000 | Gelding Brothers | Feb. 1850 | 125 0 0 | Upper Waimakareti |
| 234 | 5,000 | Douglas, Alderson and Co. | Do | 21 5 0 | Coal Creek, Waikati |
| 235 | 10,450 | Butler, B. | Do | 65 8 3 | Upper Rangitata |
| 240 | 10,000 | Do | Do | 62 10 0 | Do |
| 241 | 15,000 | Axtand, J. B. A. | May 1850 | 83 13 0 | South-west of Mount Peel range |
| 242 | | | | | |
| 243 | 5,000 | Scott, H. A. | Do | 50 5 0 | Upper Rakain |
| 244 | 5,000 | Butler, B. | March 1850 | 31 5 0 | Forks of the Rangitata |
| 245 | 7,000 | Trust and Agency Company of Australasia | Do | 43 15 0 | In the Malvern District |
| 250 | 5,000 | Potts, T. H. | Do | 31 5 0 | Rangitata |
| 251 | 14,000 | Palmer, J. | April 1850 | 93 15 0 | Upper Rakain |
| 252 | 20,000 | Bailey, R. | Do | 69 10 0 | South Bank of Rangitata |
| 253 | 1,750 | Neave, F. D. E. | Do | 35 10 0 | Upper Rakain |
| 256 | 5,000 | Do | Do | 60 0 0 | Do |
| 257 | 25,000 | Trust and Agency Company of Australasia | June 1850 | 137 10 0 | Mackenzie Country |
| 258 | 5,000 | Judge, R. | Do | 37 10 0 | Do |
| 260 | 25,000 | Gibson, R. | Do | 137 10 0 | Half a mile north of the River Waitangi |
| 264 | 7,000 | Fleming, R. | May 1850 | 43 15 0 | Pigeon Bay |
| 267 | 5,000 | Butler, B. | Do | 31 5 0 | Upper Rangitata |
| 269 | 13,000 | Axtand, J. B. A. | Feb. 1851 | 81 5 0 | Between the branches of the River Oreti |
| 270 | 8,500 | Walker, Chapman, and Walker | Do | 53 2 8 | Joining 231 |
| 272 | 5,000 | McFarlane, J. | Do | 31 5 0 | South Mount Grey |
| 274 | 10,000 | Bradley and Tyler | May 1850 | 62 10 0 | Upper Rangitata |
| 275 | 5,400 | Cator and Campbell | Do | 33 15 0 | Do |
| 276 | 5,000 | Butler, B. | Do | 31 5 0 | Do |
| 277 | 7,200 | Bank of New South Wales | Do | 45 0 0 | Mount Somers, adjoining No. 44 <i>Samoa</i> |
| 278 | 5,000 | Hall, T. W. | Jan. 1850 | 15 12 6 | Upper Pukaki valley |
| 279 | 5,000 | Do | Do | 15 12 6 | Do |
| 280 | 15,000 | Trust and Agency Company of Australasia | June 1850 | 93 15 0 | East of Lake Tekapo |
| 281 | 15,000 | Brown and Maude | Do | 40 17 6 | Do |
| 282 | 10,000 | Do Do | July 1850 | 31 5 0 | Opake, Timaru |
| 284 | 10,000 | Caton, J. H. | Do | 62 10 0 | Rangitata |
| 285 | 10,000 | Trust and Agency Company of Australasia | Aug. 1850 | 62 10 0 | Wear Swan, Ashburton |
| 289 | 5,000 | Scott, H. A. | Nov. 1850 | 31 5 0 | Lake Coleridge, joining 280 |
| 291 | 5,000 | Trust and Agency Company of Australasia | Dec. 1850 | 31 5 0 | Mount Somers |
| 295 | 5,000 | Morton, R. M. | Feb. 1851 | 31 5 0 | Upper Rangitata |
| 296 | 5,000 | Do | Do | 37 10 0 | Do |
| 297 | 5,000 | Do | Do | 31 5 0 | Do |
| 298 | 5,000 | Wachbourn, H. J. jun. | Do | 31 5 0 | Upper Rakain |
| 299 | 5,000 | Trust and Agency Company of Australasia | March 1851 | 15 12 6 | Near Mount Torlesse |
| 301 | 25,000 | Peter, W. S. | Oct. 1854 | 263 10 0 | Forks of the Hinds |
| 302 | 5,000 | Butler, B. | March 1851 | 31 5 0 | Upper Rangitata |
| 303 | 27,000 | New Zealand Trust and Loan Company (See 204) | Oct. 1854 | 169 15 0 | Waikati, Hurunui |
| 406 | | | | | Do |
| 410 | 5,000 | Axtand, J. B. A. | May 1851 | 37 10 0 | Mount Peel, South Rangitata |
| 411 | 25,700 | Judge, F. | Oct. 1854 | 166 17 6 | Peel Forest, South Rangitata |
| 412 | 20,000 | Parker, H. R. and G. B. | Do | 123 0 0 | North Bank, Waitangi |
| 413 | 20,600 | Hornbrook, A. | Do | 128 15 0 | Arcthesus |
| 414 | 20,000 | Graham, J. R. C. C. | July 1851 | 125 0 0 | Mount Somers Country |
| 415 | 29,500 | Trust and Agency Company of Australasia | August 1854 | 245 17 6 | Opiki and Opake |
| 416 | 15,000 | Huddleston, F. | Sept. 1851 | 93 15 0 | Lake Wanaka |