

## **Crown Pastoral Land Tenure Review**

**Lease name : GLENHOPE**

**Lease number : PC 083**

### **Due Diligence Report (including Status Report) - Part 3**

This report and attachments results from a pre-Tenure Review assessment of the pastoral lease for the purpose of confirming land available for Tenure Review and any issues, rights or obligations attaching to it. The information is gathered from files and other sources available to the LINZ contractor.

Part of the information relates to research on the status of the land, resulting in a Status Report that is signed off by a LINZ approving officer. The remainder of the information is not analysed for relevancy or possible action until required, and LINZ does not guarantee its accuracy or completeness as presented.

The report attached is released under the Official Information Act 1982.

**April 09**

LAND TRANSFER OFFICE  
 DIVISION: 11 PROV. No. \_\_\_\_\_  
 TITLE REF. \_\_\_\_\_  
 REFERRED TO DRAUGHTSMAN: 11  
 L.T. DRAUGHTSMAN \_\_\_\_\_  
 EXAMINED: \_\_\_\_\_  
 TRAY. REF. VOL. \_\_\_\_\_ FOL. \_\_\_\_\_  
 FIELD BOOK: No. 281 PAGE 57-58  
 COMP. No. \_\_\_\_\_ REPORT No. \_\_\_\_\_  
 REF. PLANS: \_\_\_\_\_  
 FILE: P.R. 313

FOR SURVEYS UNDER THE LAND TRANSFER ACT ONLY.

1945  
 DEPOSITED this \_\_\_\_\_ day  
 of \_\_\_\_\_ 19  
 Registrar

AMURI COUNTY  
 SKIDDAW S. D.

VII

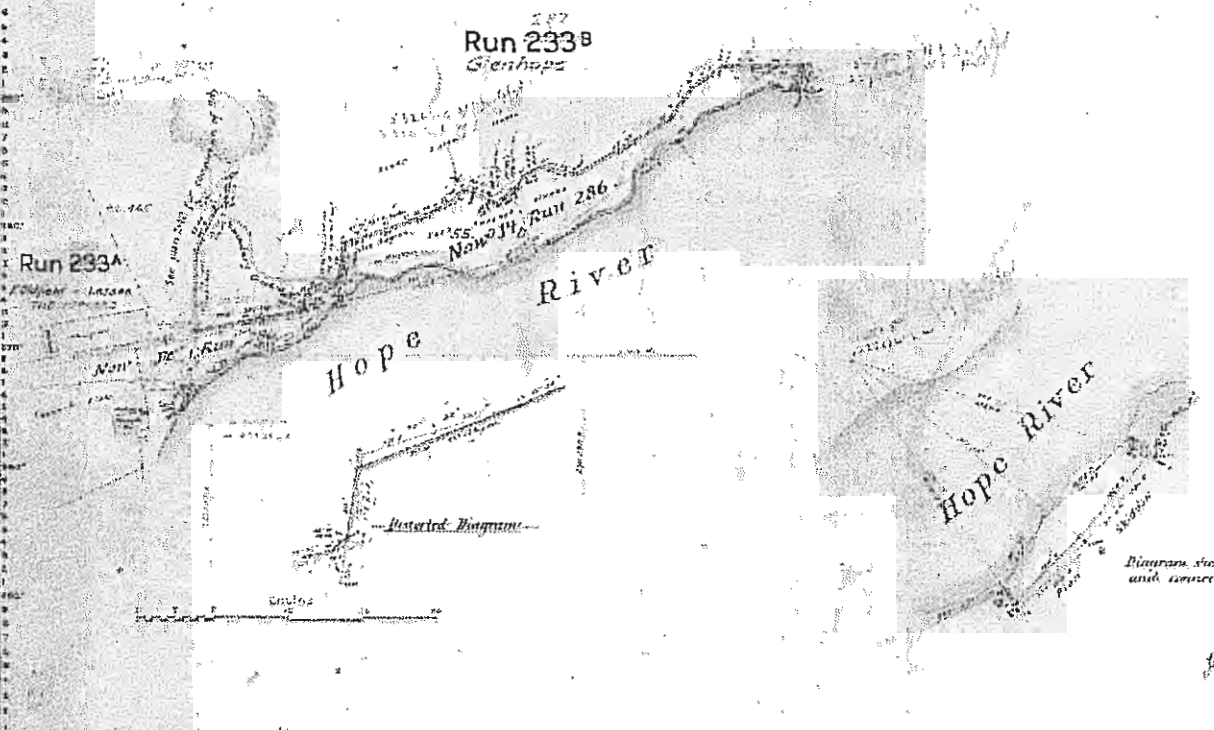

Please Deposit Stamp here

Approved us to Survey.  
 H.A. Adams  
 Licensed Surveyor  
 21/12/1925

Plan of Part of Run 233<sup>B</sup>  
 Amended boundary Runs 233<sup>A</sup>-B  
 Comprised in \_\_\_\_\_  
 Surveyed by H. A. Adams, Licensed Surveyor, November, 1925

Approved,

Applicant (or Registered Owner)

DECLARATION

I, the said Licensed Surveyor, do hereby declare that the above plan was prepared by me in accordance with the provisions of the Surveyors' Oath, dated the 31st day of March, 1925, and that the same is a true and correct copy of the original plan as shown to me by the Applicant, and that the same is a true and correct copy of the original plan as shown to me by the Applicant, and that the same is a true and correct copy of the original plan as shown to me by the Applicant, and that the same is a true and correct copy of the original plan as shown to me by the Applicant.

6024

RELEASED UNDER THE OFFICIAL INFORMATION ACT

State of Topographical Stations and right-of-way lines are omitted. Intersections with any survey peg or mark in a neighbourhood should be noted.

T.A. Darroett's Run (233A) edged green 106,750 acs

Area proposed to set aside for Scenic Res edged yellow 20,470 acs

Area proposed to be declared State Forest pale green wash, edged blue. 26,880 acs

Sutherland's Run (233B) 77,650 acs edged green

Area proposed to be decl'd. 21,180 acs. State Forest, pale green wash, edged purple.

- R. 4326, 7000 acs, Res under Scenery, Res. Act 1908, Gaz. 19 378 5322
- R. 4378, 13100 acs, Res under Scenery, Res. Act 1908, Gaz. 13 38 p. 96
- R. 4379, 7370 acs,
- R. 4380, 26880 acs, Permt State forest, Gaz. 19 38 p. 228
- R. 4381, 21800 acs,

This print (from file) was prepared when Gaz. descriptions were written in 1928

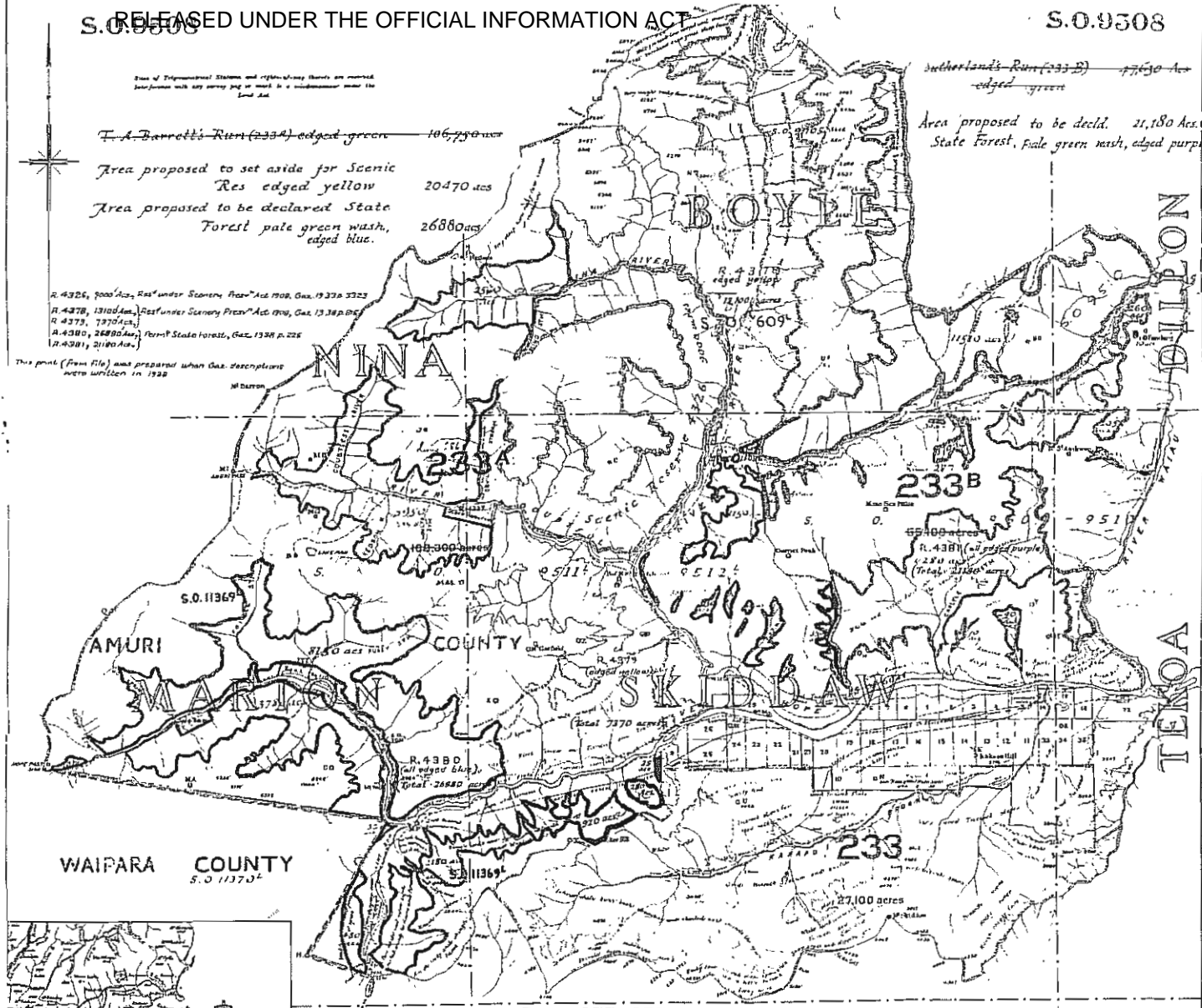

WAIPARA COUNTY S.O. 11370

Runs 233, 233a, and 233b, AMURI COUNTY,

# GLYNN WYE STATION.

Scale: 1 mile to an inch.

Res's. 4326, 4378, 4379 (Scenic) and Res's. 4380, 4381 (Permt. State Forest)

formerly Pt. Runs 233<sup>A</sup> and 233<sup>B</sup>

Note: This print was removed from Closed Volume of File. It is the only record found illustrating the above Reserves at the time of the Gazette actions, noted above. Abutments have not been brought up to date.

Approved as a Record

Chief Surveyor 28/7/1929

9508

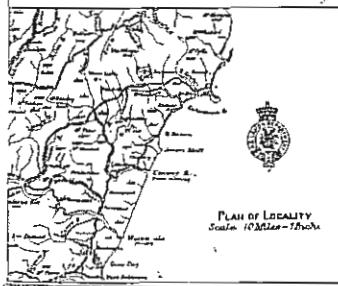

Res. 5001 - 6000 acres, State Forest Dec. 1959 p. 908  
Res. 5008 - 150 acres, State Forest Dec. 1959 p. 908  
Res. 5009, 640 acres, State Forest Dec. 1959 p. 908

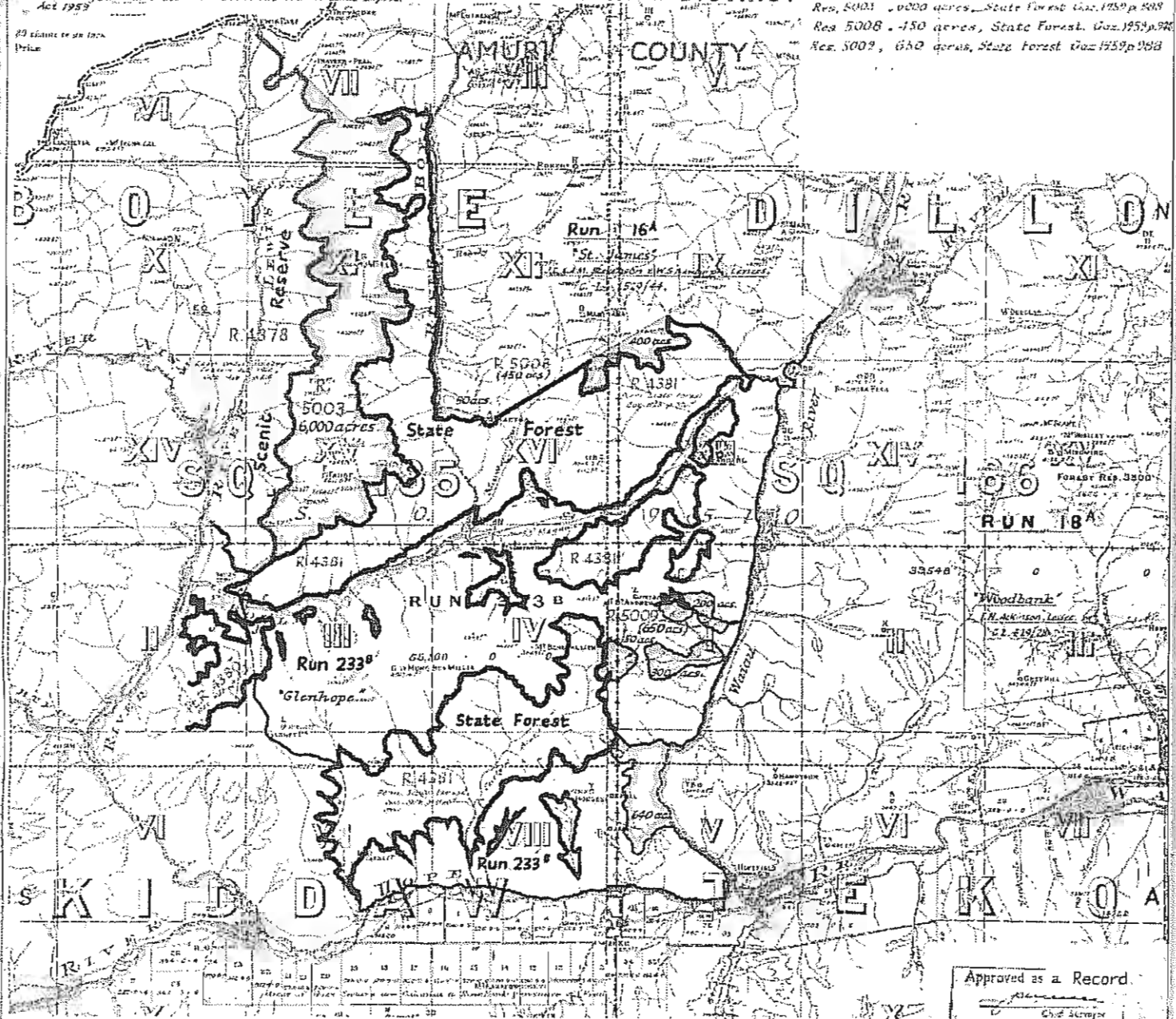

Approved as a Record  
Chas. J. [Signature]  
25/1/59

Plan of  
Pt. State Forest R. 4381 to be declared Crown Land  
and added to the 'Glenhope' Run, 640acs.   
also Rs. 5003, 5008 & 5009, formerly Parts of Run 233<sup>B</sup>, 'Glenhope',  
to be declared State Forest, 710acs.   
Scale: 1 mile to an inch.

9509

80 chains to an inch  
Price 1/-

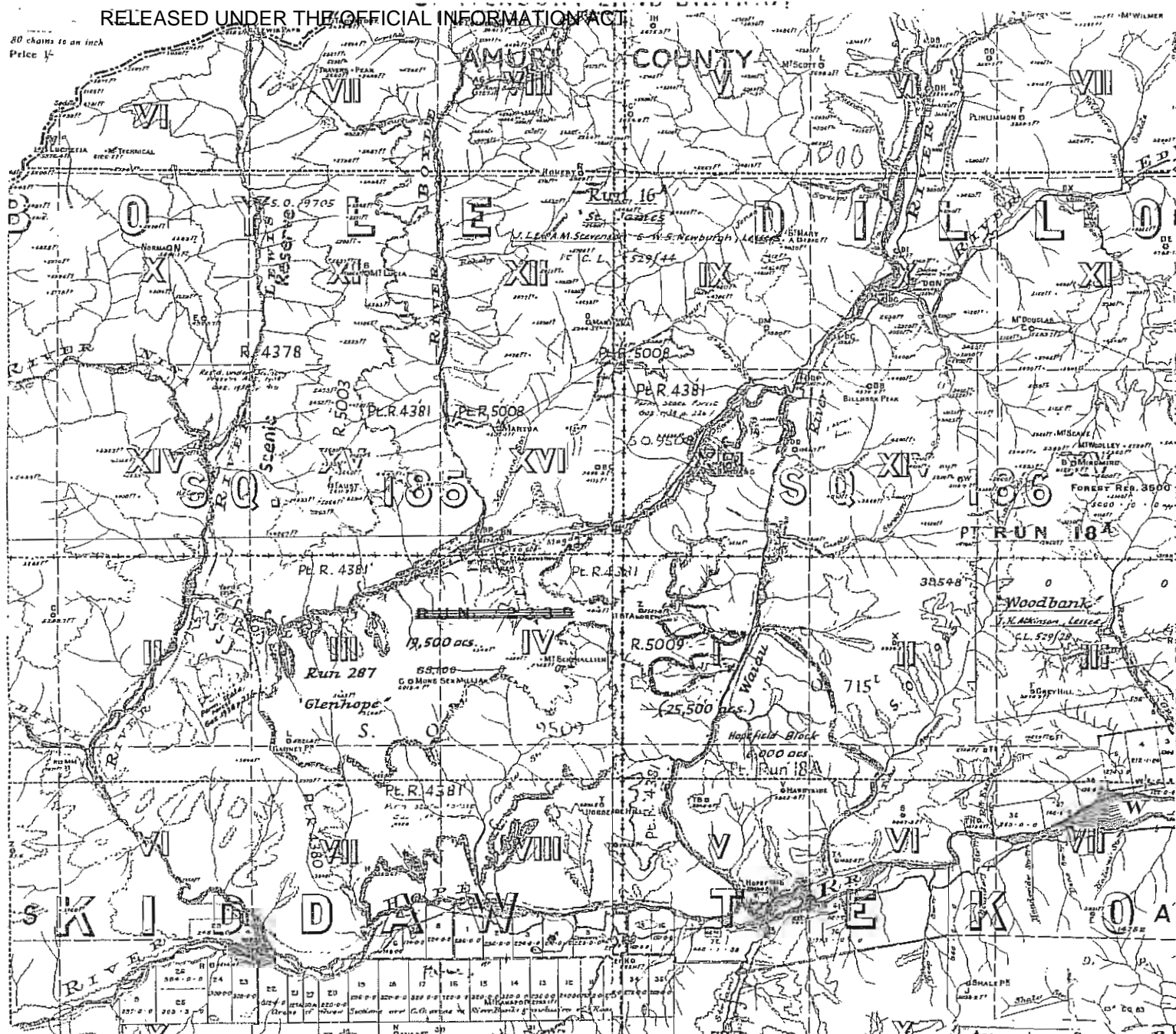

Plan of Run 287, Glenhope,  
formerly Pts. Run 233<sup>B</sup>, Pt. Run 18<sup>A</sup> & Pt. State Forest R. 4381,  
& Pt. Sec. 1, Block XVI Boyle S. D.  
also showing adjoining State Forest areas   
Total area of Run 287: 25,500 accs. Scale: 1 mile to an inch.

Approved as a Record

*[Signature]*  
Chief Surveyor  
25.3.59

9510

4.3.59  
24.3.59  
PR. 458  
S.O. 95081

RELEASED UNDER THE OFFICIAL INFORMATION ACT



LAKE SUMNER

29 10 1 M  
This plan conforms to the most recent administrative definition available as to the boundaries of the lands hereon shown.

*[Signature]*  
1952

Schedule

Appellation	Former Area	New Area	Area	Date	Particulars
P.R. 430	1000.00	1000.00	0.00	1952	See S.O. 11897
P.R. 431	1000.00	1000.00	0.00	1952	See S.O. 11897
P.R. 432	1000.00	1000.00	0.00	1952	See S.O. 11897
P.R. 433	1000.00	1000.00	0.00	1952	See S.O. 11897
P.R. 434	1000.00	1000.00	0.00	1952	See S.O. 11897
P.R. 435	1000.00	1000.00	0.00	1952	See S.O. 11897
P.R. 436	1000.00	1000.00	0.00	1952	See S.O. 11897
P.R. 437	1000.00	1000.00	0.00	1952	See S.O. 11897
P.R. 438	1000.00	1000.00	0.00	1952	See S.O. 11897
P.R. 439	1000.00	1000.00	0.00	1952	See S.O. 11897
P.R. 440	1000.00	1000.00	0.00	1952	See S.O. 11897

Run No.	Former Area	New Area	Area	Date	Particulars
Run 101	1000.00	1000.00	0.00	1952	See S.O. 11897
Run 102	1000.00	1000.00	0.00	1952	See S.O. 11897
Run 103	1000.00	1000.00	0.00	1952	See S.O. 11897
Run 104	1000.00	1000.00	0.00	1952	See S.O. 11897
Run 105	1000.00	1000.00	0.00	1952	See S.O. 11897
Run 106	1000.00	1000.00	0.00	1952	See S.O. 11897
Run 107	1000.00	1000.00	0.00	1952	See S.O. 11897
Run 108	1000.00	1000.00	0.00	1952	See S.O. 11897
Run 109	1000.00	1000.00	0.00	1952	See S.O. 11897
Run 110	1000.00	1000.00	0.00	1952	See S.O. 11897

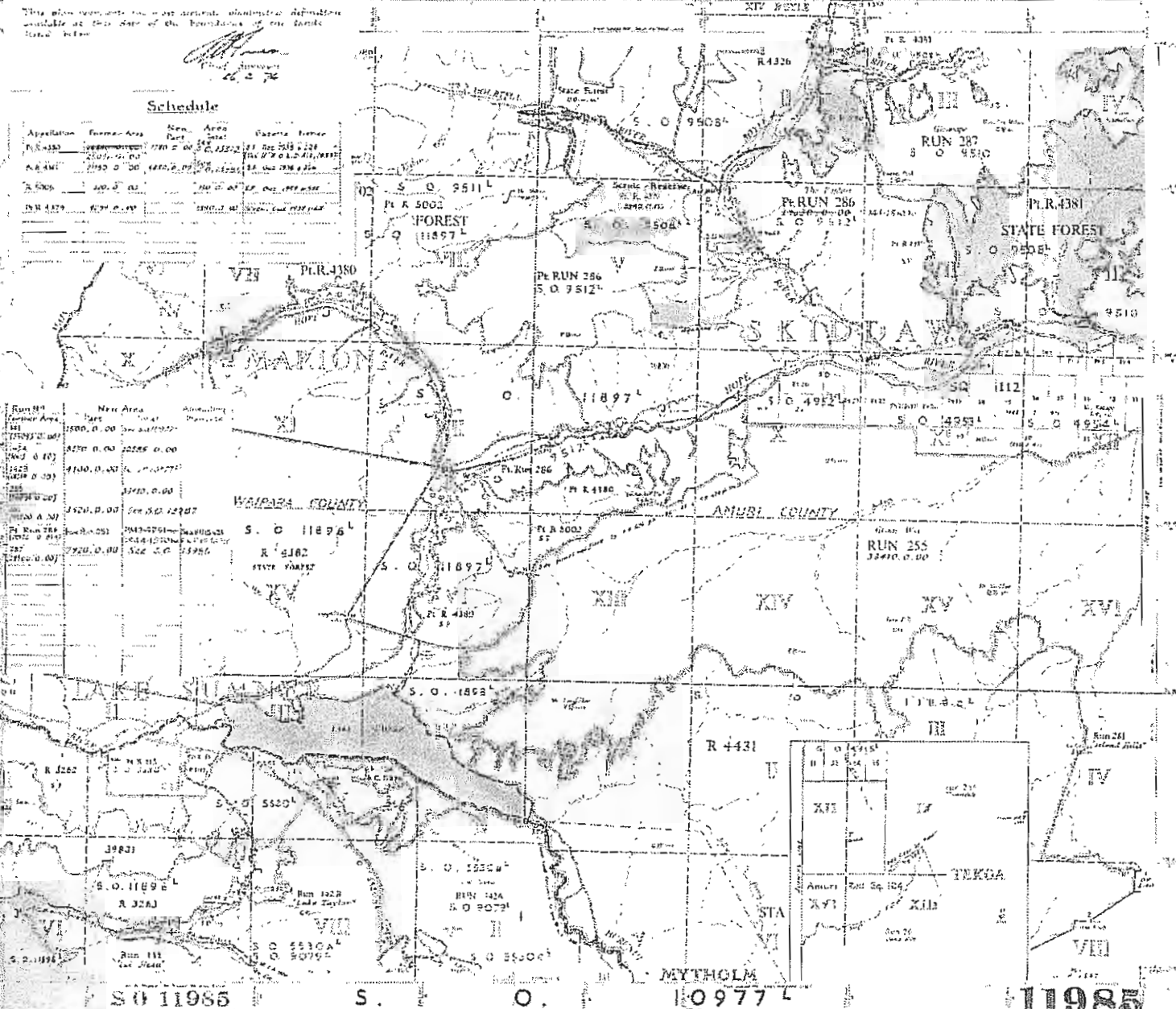

S O 11985      S. O. 10977 L      11985

Scale - 1:63360 (1 inch to 1 mile) Scale - 60 chns to an inch (approx.)

*[Detailed map scale and legend information]*

“RELEASED UNDER THE OFFICIAL INFORMATION ACT”

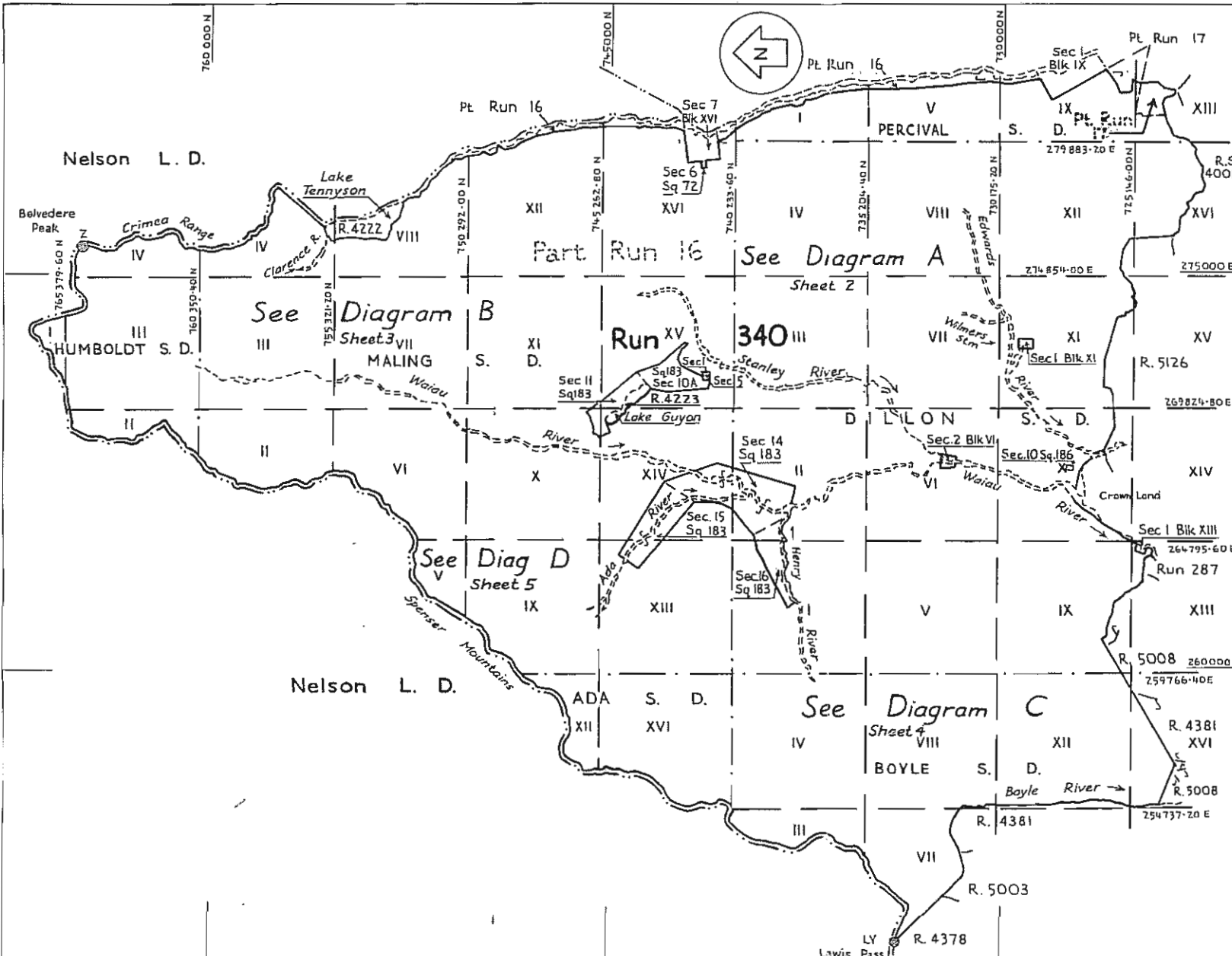

Schedule		
Appellation	Former Area (ha)	New Area (ha)
Run 340	80180.5685	76550.0

For boundary definition of roads and streams see sheets 2-5

Run 340 is subject to Sec 58 of the Land Act 1948 along rivers and streams over 3 metres wide.

Datum Old Cadastral Amuri Circuit Coordinates Origin Isolated Hill 700 000m N. 300 000 m E

Total Area 76550.0 ha

Comprised in C.L. 529/44.

This plan represents the most accurate planimetric definition available at this date of the boundaries of the land listed above.

Dated 28/6/1974

*[Signature]*  
Chief Surveyor

Field Book — p. — Traverse Book — p. —

Reference Plans See sheets 2-5

Examined G. Hindmarsh 26/7/74 Correct *[Signature]*

Approved as to Survey

See Above Chief Surveyor

Deposited this day of 19

District Land Registrar

File 3/452  
Received 12/2/74  
Instructions

**SO 13205**

LAND DISTRICT CANTERBURY  
SURVEY BLK. & DIST. See face  
NZMS 177 SHEET NO. S.40, 46 & 47

**Run 340  
"St James"**

LOCAL AUTHORITY AMURI COUNTY  
Compiled in Survey Office  
Scale 1:100 000 Date Feb 1974

REMICROFILMED 14 MAY 1984

SHEET 1 OF 5 SHEETS  
REMICROFILMED JUNE 1976

RELEASED UNDER THE OFFICIAL INFORMATION ACT

Printed by A.R. Shaver Government Printer, Wellington, New Zealand.

W.L.8499. Survey-General, Department of Lands and Survey, Wellington

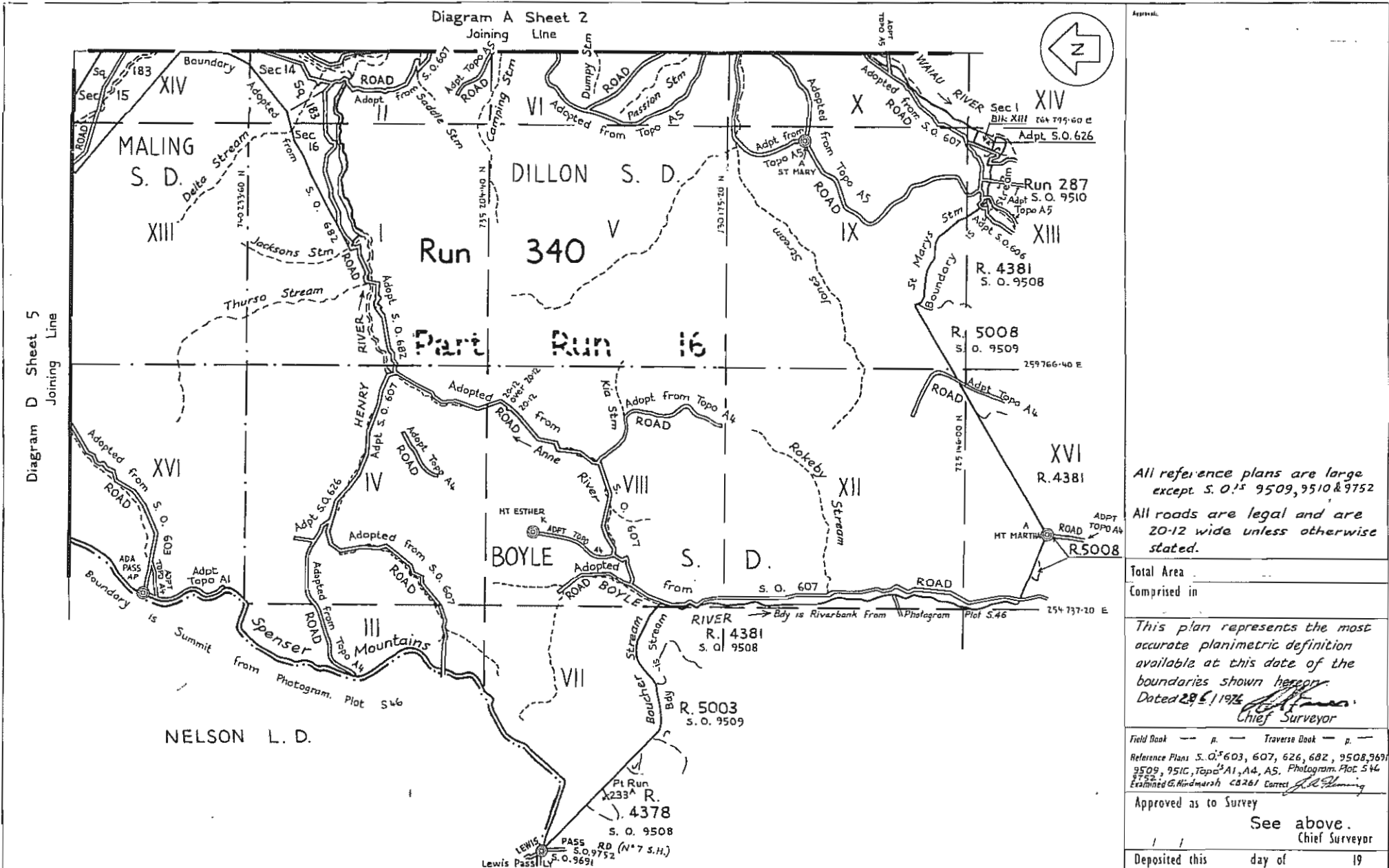

Approved

All reference plans are large except S.O.'s 9509, 9510 & 9752

All roads are legal and are 20-12 wide unless otherwise stated.

Total Area	...
Comprised in	...

This plan represents the most accurate planimetric definition available at this date of the boundaries shown hereon.

Dated 29<sup>th</sup> 11 1974

*[Signature]*  
Chief Surveyor

Field Book	p. ...	Traverse Book	p. ...
------------	--------	---------------	--------

Reference Plans S.O.'s 603, 607, 626, 682, 9508, 9691, 9509, 9510, Topo's A1, A4, AS. Photogram. Plot S.46

Examined G. Hindmarsh CB 261 Corrected J.R. Fleming

Approved as to Survey

See above.  
Chief Surveyor

Deposited this day of 19

LAND DISTRICT CANTERBURY  
 SURVEY BLK. & DIST. MALING, DILLON, BOYLE  
 NZMS 177 SHEET NO. S.46 & 47

Diagram C  
 Run 340

LOCAL AUTHORITY AMURI COUNTY  
 Compiled in Survey Office  
 Scale 1:50 000 Date Feb. 1974

District Land Registrar  
 File 3/952  
 Received 14/2 12/2/74  
 Instructions  
**SO 13205**

RELEASED UNDER THE OFFICIAL INFORMATION ACT



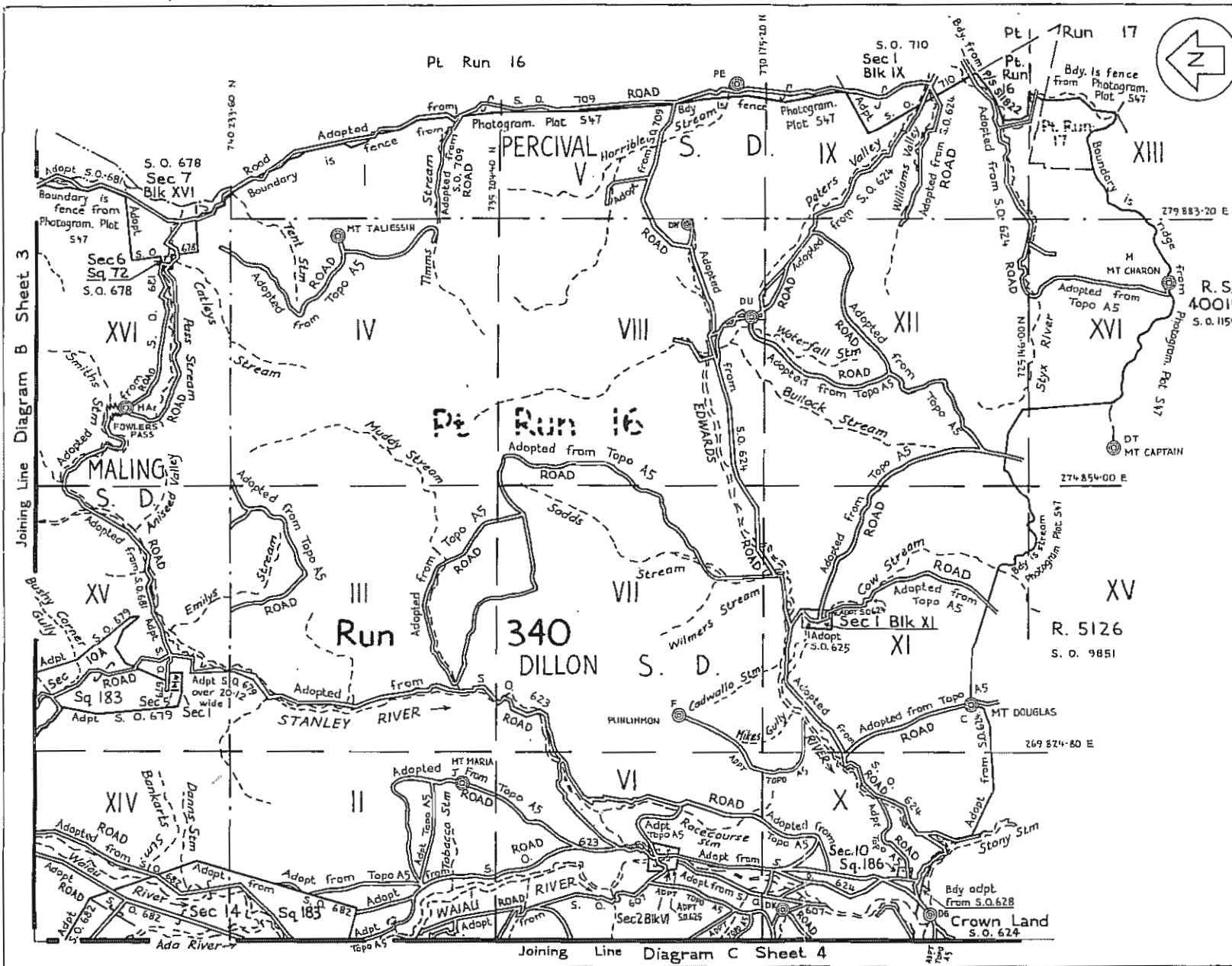

Approx.

All reference plans are large except S.O.s 9851 & 11590

All roads are legal and are 20'12" wide unless otherwise stated.

Total Area  
Comprised in

This plan represents the most accurate planimetric definition available at this date of the boundaries shown hereon.  
Dated 28/6/1974  
Chief Surveyor.

Field Book — p. — Traverse Book — p. —  
Reference Plans S.O.s 607, 623, 624, 625, 628, 678, 679, 681, 682, 9851 & 11590, Topo A5, Photogram. Plat. 547, 549 & 512  
Examined G. Hindmarsh, C.B. 261 Correct

Approved as to Survey  
See above.  
Chief Surveyor

Deposited this day of 19  
District Land Registrar

File 3/452  
Received S.O. 12/2/74  
Instructions  
**SO 13205**

LAND DISTRICT CANTERBURY  
SURVEY BLK. & DIST. XIV, XV, XVI MALING, V, VI, VII, VIII, IX, X, XI, XII, XIII, XIV, XV, XVI DILLON.  
NZMS 177 SHEET No. 547

Diagram A  
Run 340

LOCAL AUTHORITY AMURI COUNTY  
Compiled in Survey Office  
Scale 1:50,000 Date Feb. 1974

“RELEASED UNDER THE OFFICIAL INFORMATION ACT”

## **Extract of CLR**

10 FEB 1987

Description: Part Run 287 "Glenhope"

Situated in: Boyle, Dillon, Skiddaw and Tekoa Survey District.

S.O. Plan: Local Authority: Amuri County Council Area: 9265 m<sup>2</sup>/ha

DETAILS OF LEASE OR LICENCE								
Main File	Selector	File	Date of Selection	Term Years	From	R.V. Price	A/Rent Instalment	Det. Exp.
	GJ & H.J. Hewitt	P83	1.7.59	33	1.7.59	11450:00	580:00	16/92

DETAILS OF RESERVATIONS							
Purpose or Classification	Gazette		Administering Body	Vested		Control & Management	
	Year	Page		Year	Page	Year	Page

Valuation Ref: 21250 282.

C.L./C.T./Deeds Ref: 529/99

Name of Reserve/Locality:

Description:

Part Run 287 "Glenhope"

## Extracts of Allocation maps

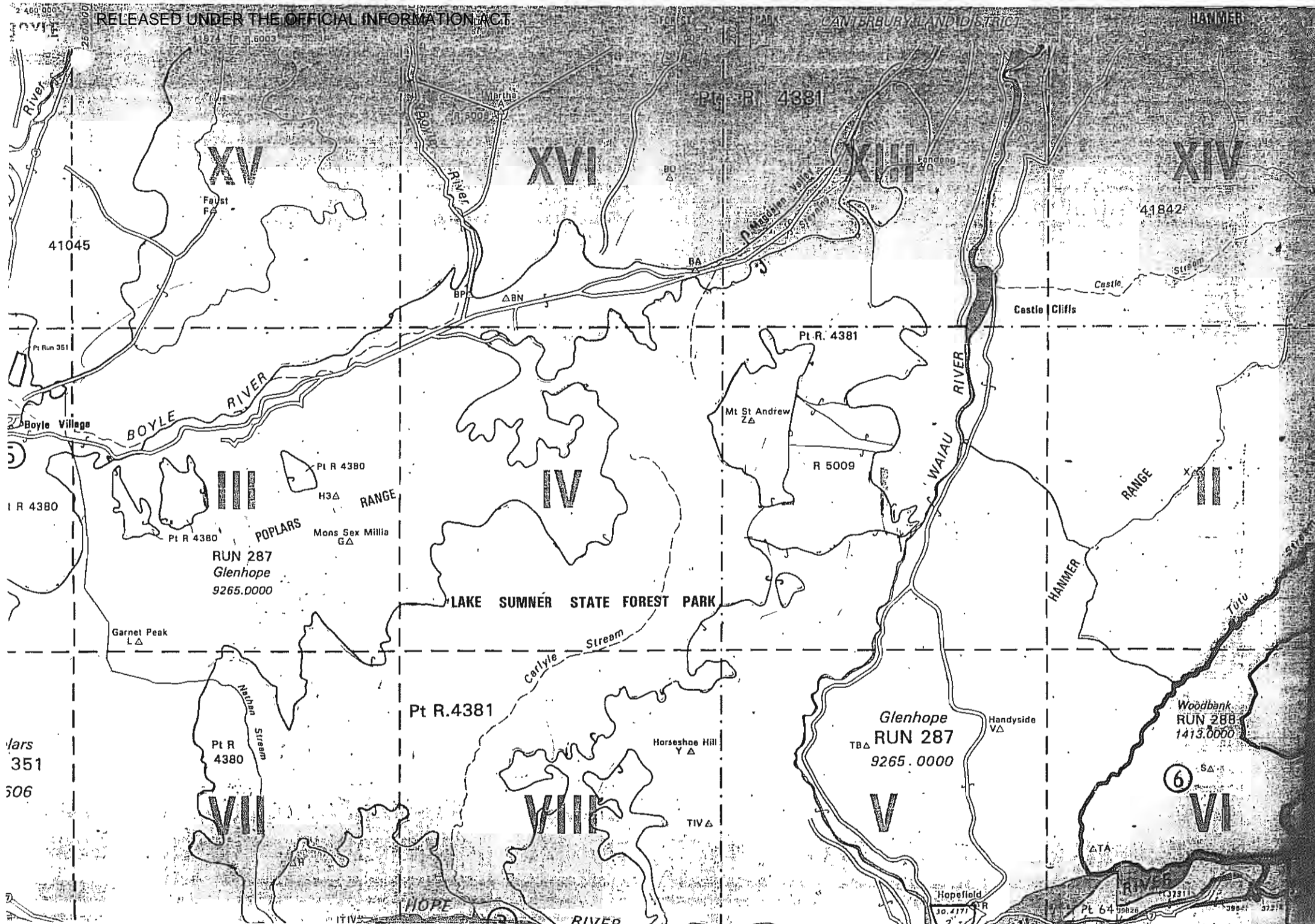

41045

Pt R 4381

41842

Pt Run 351

Pt R. 4381

I R 4380

Pt R 4380

R 5009

RUN 287  
Glenhope  
9265.0000

LAKE SUMNER STATE FOREST PARK

Woodbank  
RUN 288  
1413.0000

vars  
351

306

Pt R  
4380

Pt R.4381

Glenhope  
RUN 287  
9265.0000

Handyside  
VΔ

6  
SΔ

2

ITIV

HOPE

RIVER

Hopefield  
Pt. 4171

Pt 64  
99820

99821  
97214

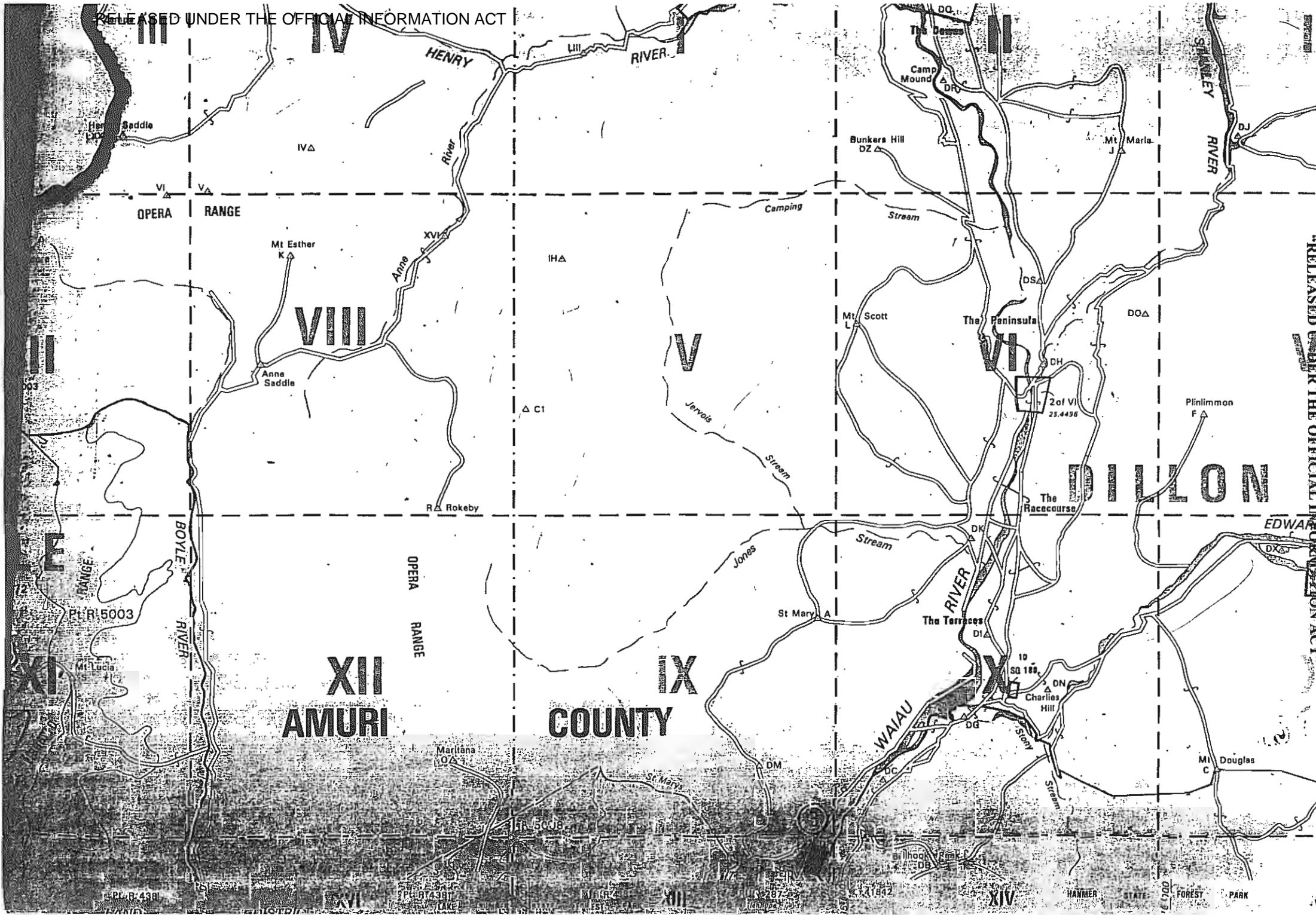

III  
IV  
II  
I  
E  
F  
G  
H  
I  
J  
K  
L  
M  
N  
O  
P  
Q  
R  
S  
T  
U  
V  
W  
X  
Y  
Z  
AA  
AB  
AC  
AD  
AE  
AF  
AG  
AH  
AI  
AJ  
AK  
AL  
AM  
AN  
AO  
AP  
AQ  
AR  
AS  
AT  
AU  
AV  
AW  
AX  
AY  
AZ  
BA  
BB  
BC  
BD  
BE  
BF  
BG  
BH  
BI  
BJ  
BK  
BL  
BM  
BN  
BO  
BP  
BQ  
BR  
BS  
BT  
BU  
BV  
BW  
BX  
BY  
BZ  
CA  
CB  
CC  
CD  
CE  
CF  
CG  
CH  
CI  
CJ  
CK  
CL  
CM  
CN  
CO  
CP  
CQ  
CR  
CS  
CT  
CU  
CV  
CW  
CX  
CY  
CZ  
DA  
DB  
DC  
DD  
DE  
DF  
DG  
DH  
DI  
DJ  
DK  
DL  
DM  
DN  
DO  
DP  
DQ  
DR  
DS  
DT  
DU  
DV  
DW  
DX  
DY  
DZ  
EA  
EB  
EC  
ED  
EE  
EF  
EG  
EH  
EI  
EJ  
EK  
EL  
EM  
EN  
EO  
EP  
EQ  
ER  
ES  
ET  
EU  
EV  
EW  
EX  
EY  
EZ  
FA  
FB  
FC  
FD  
FE  
FF  
FG  
FH  
FI  
FJ  
FK  
FL  
FM  
FN  
FO  
FP  
FQ  
FR  
FS  
FT  
FU  
FV  
FW  
FX  
FY  
FZ  
GA  
GB  
GC  
GD  
GE  
GF  
GG  
GH  
GI  
GJ  
GK  
GL  
GM  
GN  
GO  
GP  
GQ  
GR  
GS  
GT  
GU  
GV  
GW  
GX  
GY  
GZ  
HA  
HB  
HC  
HD  
HE  
HF  
HG  
HH  
HI  
HJ  
HK  
HL  
HM  
HN  
HO  
HP  
HQ  
HR  
HS  
HT  
HU  
HV  
HW  
HX  
HY  
HZ  
IA  
IB  
IC  
ID  
IE  
IF  
IG  
IH  
II  
IJ  
IK  
IL  
IM  
IN  
IO  
IP  
IQ  
IR  
IS  
IT  
IU  
IV  
IW  
IX  
IY  
IZ  
JA  
JB  
JC  
JD  
JE  
JF  
JG  
JH  
JI  
JJ  
JK  
JL  
JM  
JN  
JO  
JP  
JQ  
JR  
JS  
JT  
JU  
JV  
JW  
JX  
JY  
JZ  
KA  
KB  
KC  
KD  
KE  
KF  
KG  
KH  
KI  
KJ  
KK  
KL  
KM  
KN  
KO  
KP  
KQ  
KR  
KS  
KT  
KU  
KV  
KW  
KX  
KY  
KZ  
LA  
LB  
LC  
LD  
LE  
LF  
LG  
LH  
LI  
LJ  
LK  
LM  
LN  
LO  
LP  
LQ  
LR  
LS  
LT  
LU  
LV  
LW  
LX  
LY  
LZ  
MA  
MB  
MC  
MD  
ME  
MF  
MG  
MH  
MI  
MJ  
MK  
ML  
MN  
MO  
MP  
MQ  
MR  
MS  
MT  
MU  
MV  
MW  
MX  
MY  
MZ  
NA  
NB  
NC  
ND  
NE  
NF  
NG  
NH  
NI  
NJ  
NK  
NL  
NM  
NO  
NP  
NQ  
NR  
NS  
NT  
NU  
NV  
NW  
NX  
NY  
NZ  
OA  
OB  
OC  
OD  
OE  
OF  
OG  
OH  
OI  
OJ  
OK  
OL  
OM  
ON  
OO  
OP  
OQ  
OR  
OS  
OT  
OU  
OV  
OW  
OX  
OY  
OZ  
PA  
PB  
PC  
PD  
PE  
PF  
PG  
PH  
PI  
PJ  
PK  
PL  
PM  
PN  
PO  
PP  
PQ  
PR  
PS  
PT  
PU  
PV  
PW  
PX  
PY  
PZ  
QA  
QB  
QC  
QD  
QE  
QF  
QG  
QH  
QI  
QJ  
QK  
QL  
QM  
QN  
QO  
QP  
QQ  
QR  
QS  
QT  
QU  
QV  
QW  
QX  
QY  
QZ  
RA  
RB  
RC  
RD  
RE  
RF  
RG  
RH  
RI  
RJ  
RK  
RL  
RM  
RN  
RO  
RP  
RQ  
RR  
RS  
RT  
RU  
RV  
RW  
RX  
RY  
RZ  
SA  
SB  
SC  
SD  
SE  
SF  
SG  
SH  
SI  
SJ  
SK  
SL  
SM  
SN  
SO  
SP  
SQ  
SR  
SS  
ST  
SU  
SV  
SW  
SX  
SY  
SZ  
TA  
TB  
TC  
TD  
TE  
TF  
TG  
TH  
TI  
TJ  
TK  
TL  
TM  
TN  
TO  
TP  
TQ  
TR  
TS  
TT  
TU  
TV  
TW  
TX  
TY  
TZ  
UA  
UB  
UC  
UD  
UE  
UF  
UG  
UH  
UI  
UJ  
UK  
UL  
UM  
UN  
UO  
UP  
UQ  
UR  
US  
UT  
UU  
UV  
UW  
UX  
UY  
UZ  
VA  
VB  
VC  
VD  
VE  
VF  
VG  
VH  
VI  
VJ  
VK  
VL  
VM  
VN  
VO  
VP  
VQ  
VR  
VS  
VT  
VU  
VV  
VW  
VX  
VY  
VZ  
WA  
WB  
WC  
WD  
WE  
WF  
WG  
WH  
WI  
WJ  
WK  
WL  
WM  
WN  
WO  
WP  
WQ  
WR  
WS  
WT  
WU  
WV  
WW  
WX  
WY  
WZ  
XA  
XB  
XC  
XD  
XE  
XF  
XG  
XH  
XI  
XJ  
XK  
XL  
XM  
XN  
XO  
XP  
XQ  
XR  
XS  
XT  
XU  
XV  
XW  
XX  
XY  
XZ  
YA  
YB  
YC  
YD  
YE  
YF  
YG  
YH  
YI  
YJ  
YK  
YL  
YM  
YN  
YO  
YP  
YQ  
YR  
YS  
YT  
YU  
YV  
YW  
YX  
YY  
YZ  
ZA  
ZB  
ZC  
ZD  
ZE  
ZF  
ZG  
ZH  
ZI  
ZJ  
ZK  
ZL  
ZM  
ZN  
ZO  
ZP  
ZQ  
ZR  
ZS  
ZT  
ZU  
ZV  
ZW  
ZX  
ZY  
ZZ

XII  
AMURI

X  
COUNTY

DILLON

WAIAU

STANLEY RIVER

BOYLE RIVER

RIVER

HENRY RIVER

OPERA RANGE

OPERA RANGE

Saddle

Mt Esther K

Anna Saddle

R. Rokeby

Pt R 5003

Mt Lucia

Maritana OZ

Pt R 5008

St Mary

St Mary A

The Terraces

The Raccourse

The Peninsula

The Dunes

Camp Mound

Bunkera Hill

Mt Marla

Plinlimon F

Mt Douglas

Pt R 4381

Pt R 4381

Pt R 2875

Pt R 1484

Pt R 1000

HANMER STATE FOREST

PARK





## **DOC Consultation**

RELEASED UNDER THE OFFICIAL INFORMATION ACT



Department of Conservation  
*Te Papa Atawhai*

Our ref: PAR 019, PTR 083,

19 September 2001

Don McGregor  
McGregor Property Services  
6 Cumberland Place  
Kaiapoi

Dear Don

PASTORAL LEASE STATUS CHECK - GLENHOPE

I refer to your letter of 6 September 2001.

**GLENHOPE**

I have checked the Department of Conservation's land records. I can find no record of any conservation land within the Glenhope Pastoral Lease boundary, save for Marginal Strips pursuant to Part IVA of the Conservation Act 1987. Conservation Estate does adjoin the property and is listed below.

The following public conservation lands adjoin Glenhope PL:

L32/501 - The Glenhope PL is all but surrounded by the Lake Sumner Conservation Park, which is subject to the Conservation Act 1987, there are however two other land units involved.

M31/8 - This is an area of former Crown Land in the Waiau River, held pursuant to Section 62 of the Conservation Act 1987 (deemed to be stewardship land).

M32/12 - This shows up on our system as being "Woodbank Run". I presume this is land that has been surrendered from the Woodbank Pastoral Run, and subsequently allocated to the Department of Conservation (allocation number M32/6).

One other reference shows on the map, and that is M31/10. This is the St James Walkway, and isn't identified as being separate from the Lake Sumner Forest Park land, but is just a separate entity in our records.

Given the scale of the public conservation land adjoining the Glenhope PL, there is almost certainly concessions issued over them. As they are all outside the actual lease boundary I have not made any enquiries regarding these.

**MARGINAL STRIPS:**

Glenhope was renewed in 1992, and therefore the marginal strip provisions of the Conservation Act 1987 will apply to it, as far as any qualifying waterways are concerned. Interestingly the title actually notes that it is subject to Part IVA of the Conservation Act 1987, which is somewhat unusual. What is uncertain is which waterways qualify for marginal strips.

It is practically impossible to identify with any certainty whether a marginal strip is in place if it is not shown on a survey plan. Some marginal strips are shown on the DOC estate maps, and others are not. If there is no marginal strip shown on our allocation records, I have not identified them.

RELEASED UNDER THE OFFICIAL INFORMATION ACT

None of the marginal strips on Glenhope will have had concessions issued over them, save for some generic concessions covering the majority of the conservation estate in Canterbury.

I have attached maps of the relevant areas with public conservation land shown shaded.

At this time I am still waiting on plans for Lake Sumner, and as a result I will be unable to meet your deadline of 22 September. I am on annual leave from the 28<sup>th</sup> of September 2001, for 1 week (I return on the 8<sup>th</sup> of October). As such it is important that you get the plans for that property to me as soon as possible. If you could ring me when they are posted, I will do my best to get them into our system as quickly as I can.

Yours faithfully



**Robert Cant**  
Statutory Land Management Officer (Community Relations)  
For Conservator, Canterbury  
Email: [Rcant@doc.govt.nz](mailto:Rcant@doc.govt.nz)

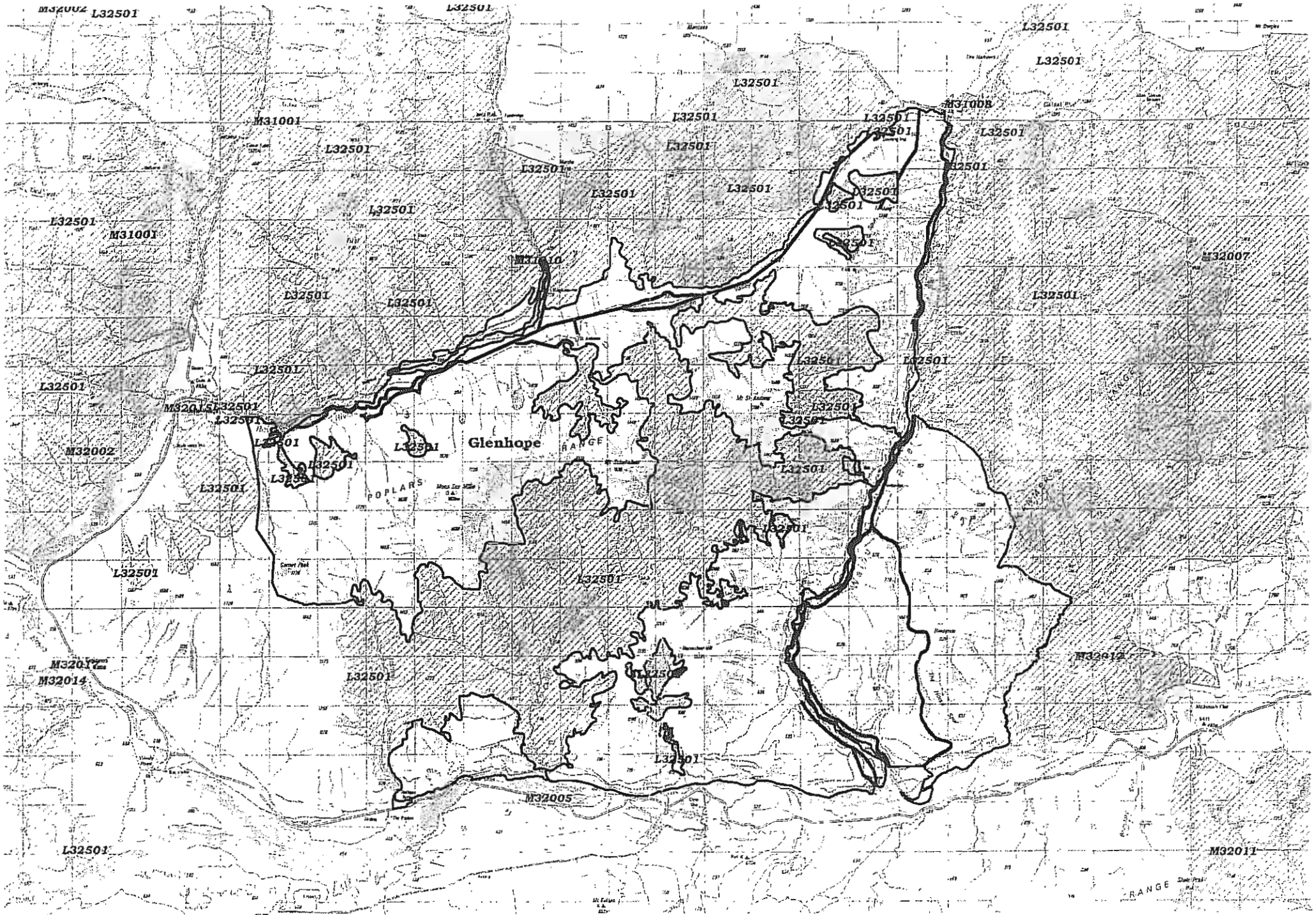

## **Information supporting Mineral investigation**



GLENHOPEPASTORAL RUN INDEX SEARCH1) Survey Plan Index (to 1987)

Run 287 - 50's 5675, 6023, 6024, 9510, 9509,  
9508, 9564, 715, 9512, 11985, 13986

2) Pastoral Run Register (to 1987)

Run 287 - - 25500 aces - R. Sutherland  
(formerly Run P.R. 458 (P83) - CT 529/99  
233B )

Remarks:

Run 233B reduced by 7100 aces - State Forest  
Run 233B increased by 640 aces - From Pt SF (ROLD Act 195  
Run 233B increased by 6000 aces - now Pt Run 18A.

3) P.R. Licence 458 (Run 233B)

To R Sutherland under LA 1924 for 35 yrs from 1 March 1926.  
Area 47550 aces.

Memorials on PRL:

- \* Increase in area by 80 aces (Section 1, Block XVI, Boyle SD) by ROLD Act (S.57) 1916.
- \* Reduction in area to 26450 aces by resumption of 21,180 aces of bush shown blue to be set apart partly as Scenic Reserve and partly State Forest to preserve the scenic attractions of the Lewis Pass Road.
- \* Change of Appellation 499061 whereupon parts within land changed to Res 5003, Res 5008, Res 5009 and Pt Run 287 "Glenhope".

13/9

GLENHOPE

PR 434 - Run 233B1 (10,000 acres) to F.L. Hickman  
Section 91 ROLD Act 1910.

12 yrs 1 March 1921 at AR of £ 125.

(Transfer bill Registrar of Supreme Court to HMK 20/2/1925).

PR 435 - Run 233B2 (14,000 acres) to C.S. Hickman  
Section 91 ROLD Act 1910.

12 yrs 1 March 1921 at AR of £ 135

(Transfer bill Registrar of Supreme Court to HMK 20/2/1925).

PR 436 - Run 233B3 (3,000 acres) to G.B. Hickman  
Section 91 ROLD Act 1910

12 yrs 1 March 1921 at AR of £ 120

[Add print PR 458]



PLAN OF RUN No.

No. 458.

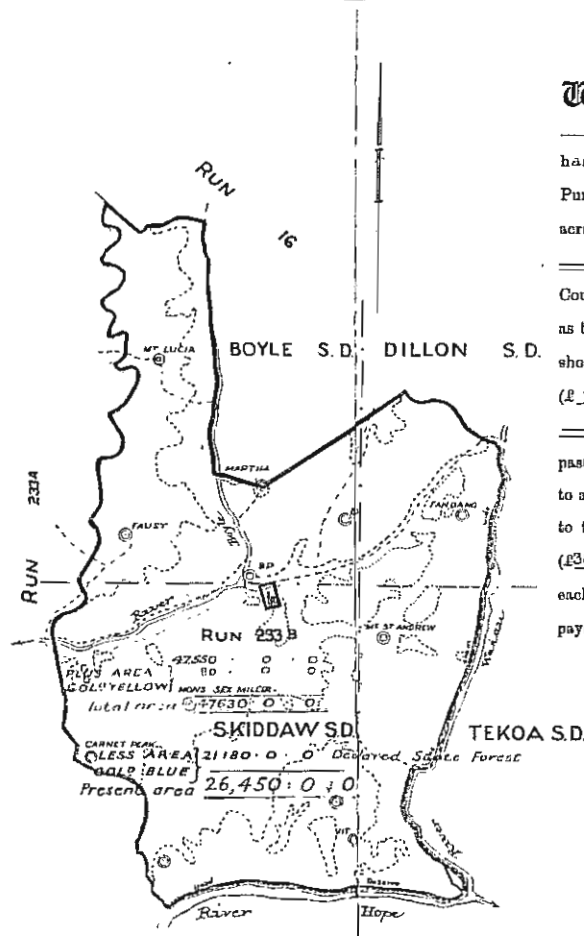

Scale: 2 Miles = 1 inch.

License to occupy Crown Lands for Pastoral Purposes.

~~Not Registered under Land Transfer~~

Act. Registered under Section 83,

Whereas ~~RONALD SUTHERLAND~~ Land Act. 1924

of ~~Sockburn~~, Farmer

has purchased at auction, under the provisions of the Land Act, 1908, and its amendments, a License to occupy for Pastoral Purposes all that area of Crown lands containing by estimation Forty-seven thousand five hundred and fifty (47,550) acres, more or less, and being Run number Two hundred and thirty three B (233B), classed as Pastoral land, in terms of section 22 of the Act, situate in the County of Amuri, in the Land District of Canterbury, New Zealand,

as the same is delineated on the plan in the District Lands and Survey Office, at Christchurch, as shown in the margin hereof, and has paid the sum of One hundred and ninety three pounds

(£ 193. 0. 0), being the first half-year's rent in advance for such Run: The said

RONALD SUTHERLAND hereby licensed to occupy the said land for pastoral purposes for the term of Thirty-five (35) years, to be computed from the first day of March 1926, subject to all the provisions and conditions of the Land Act, 1908, and its amendments, so far as applicable hereto, and subject also

to the payment of an annual rent of three hundred and eighty six pounds sterling (£386. 0. 0), in equal parts, half-yearly in advance, on the first day of March and the first day of September in each and every year, payment for the first half-year's rent having already been made, and the next of such half-yearly

payments to be made on the first day of September, 1926

Subject also to the conditions following, viz:—

- (1) That if the licensee or any person claiming an interest through or under him shall make or cause to be made any agreement or contract, or shall give or cause to be given or taken any negotiable security for the purpose of defeating or evading the provisions of, or shall in any way whatsoever directly or indirectly commit or be privy to a fraud upon, the Land Act, 1908, and its amendments, this license shall be liable to be forfeited and revoked;
- (2) That the licensee shall prevent the destruction or burning of timber or bush on the land comprised in this license, except as provided by section 243 of the Land Act, 1908; 1924
- (3) That the licensee shall prevent the growth or spread of gorse, broom, and sweetbrier, on the land comprised in this license, and shall with all reasonable speed remove or cause to be removed all gorse, sweetbrier, broom, or other noxious weeds or plants, as may be directed by the Commissioner of Crown Lands; and
- (4) That the licensee shall destroy all rabbits on the land comprised in this license, and shall prevent their increase or spread, to the satisfaction of the Commissioner or an officer appointed by him to inspect the ground.
- (5) That the Licensee shall within one year from the date of his license bring substantial improvements of a permanent character to a value equal to one year's rent. Within two years from the date of the license to a value equal to two year's rent. Within six years from the date of his license to a value equal to four year's rent.

And it is hereby declared that these presents are intended to take effect as a pasturage license only under the Land Act, 1908, and its amendments, and the provisions of those Acts applicable to such licenses shall apply hereto as fully and effectually as if the same had been set out herein at length.

In witness whereof the Commissioner of Crown Lands, on behalf of the Land Board of the Canterbury

1926

RELEASED UNDER THE OFFICIAL INFORMATION ACT

Mortgage No. *H.193* of the within License, Ronald Sutherland of Sockburn, Farmer to His Majesty the King  
registered this *twentieth* day of *March* 1937.

*[Signature]*  
Commissioner of Crown Lands.

The area of the within License is hereby increased from 47,550 acres to 47,630 acres by the inclusion of eighty (80) acres being Section 1, Block XVI, Boyle Survey District and Block IV, Skiddaw Survey District, under the Authority of Section 57 of the Reserves and Other Lands Disposal Act 1916. Recorded this Seventh day of August, 1935.

*[Signature]*  
Commissioner of Crown Lands.

Memorandum of Variation of Mortgage Number 413 RONALD SUTHERLAND to HIS MAJESTY THE KING (State Advances Corporation of New Zealand) approved by the Land Board this 12th day of October, 1937, and registered this 13th day of October, 1937.

*[Signature]*  
Commissioner of Crown Lands.

The area of the within License is hereby reduced to 26,450 acres by the resumption of 21,180 acres of bush lands shown coloured blue on plan hereon, to be set apart partly as Scenic Reserve and partly as State Forest to preserve the scenic attractions of the Lewis Pass Road. Approved by the Land Board this 11th day of August, 1937 (Memo of Partial Surrender duly executed with Consent of State Advances Corporation, as mortgagee)

*[Signature]*  
Commissioner of Crown Lands.

2 Transfer Ronald Sutherland  
to Jack Joseph Minehan of Amberley  
produced 5 July, 1956 at \_\_\_\_\_ Dated \_\_\_\_\_, 19\_\_\_\_  
p.m. *[Signature]*  
A.L.R.

3 Mortgage Jack Joseph Minehan  
to Leslie Sutherland  
produced 5 July, 1956 at 3 p.m. **COMMISSIONER OF CROWN LANDS**  
*[Signature]*  
A.L.R.

CHRISTCHURCH

261 Change of appellation whereby the description of parts  
of his land changed to Reg. 5003, Reg. 5004,  
5089 and Part Plan 227 "Eimohaka" to  
this 15 day of April 1959 at 11.15  
*[Signature]* Assistant Land Registrar **RONALD SUTHERLAND**

29/99 issued for the part  
287 "Eimohaka" herein  
11.1959 *[Signature]*  
**PASTURAGE LICENSE.**

Sections 2 and 4 of  
Ross Goldfields  
Electric Power  
Transmission Act,  
1908, amended.

56. The Ross Goldfields Electric Power Transmission Act, 1908, is hereby amended—

- (a.) By adding to the definition of "the company" in section two the words "and includes its assigns approved by the Minister of Mines"; and
- (b.) By adding to section four the words "and may, with the consent of the Minister of Mines, sell and dispose of such energy for mining purposes."

Authorizing the  
exchange of certain  
Crown land for  
certain private land,  
Canterbury Land  
District.

57. (1.) The Governor is hereby authorized to exchange the Crown land described in subsection two hereof for the lands described in subsections three and four hereof.

(2.) The Crown land to be given in exchange is more particularly described as follows:—

All that area in the Canterbury Land District, containing by admeasurement eight hundred and forty acres two roods, more or less, being Sections 30 and 31, Square 112, situated in Blocks XI and XII, Skiddaw Survey District, and bounded towards the north by Sections 12, 13, 14, 15, 16, 17, 18, Square 112, 24300.2 links; towards the south-east and south generally by the road reserve along Kakapo Brook, and by Run 233, 7333.6 links; and towards the west by Section 10, Square 112, 4000 links: be all the aforesaid linkages more or less: as the same is delineated on the plan marked L. and S. 8/8/45, deposited in the Head Office, Department of Lands and Survey, at Wellington, and thereon coloured yellow.

(3.) Portion of the land to be acquired by the Crown in exchange is more particularly described as follows:—

All that area in the Canterbury Land District, containing by admeasurement nineteen acres and twelve perches, more or less, being parts of Sections 5, Square 112, and 14, 15, and 16, Square 104, situated in Blocks VIII and XII, Skiddaw, and V and IX, Tekoa Survey Districts, bounded as follows: commencing at a point on the eastern boundary of Section 16, Square 104, 1897.8 links due south of the north-eastern corner of the said section; thence generally westerly for a distance of 19073.3 links; thence south-westerly, 100 links; thence easterly generally, 19081.7 links; thence due north, 100 links, to the commencing-point: be all the aforesaid linkages more or less: as the same is delineated on the plan marked L. and S. 8/8/45, deposited in the Head Office, Department of Lands and Survey, at Wellington, and thereon coloured pink.

Also all that area in the Canterbury Land District, containing by admeasurement thirty acres, more or less, being parts of Sections 4 and 5, Square 112, situated in Block VIII, Skiddaw Survey District, and bounded generally towards the east by other part of Section 5, 1608.4 links; towards the south generally by other parts of Sections 4 and 5, 5284.5 links; towards the north-west by other part of Section 4, 460 links; and towards the north by the River Hope: be all the aforesaid linkages more or less: as the same is delineated on the plan marked L. and S. 8/8/45, deposited in the Head Office, Department of Lands and Survey, at Wellington, and thereon coloured green.

Also all that area in the Canterbury Land District, containing by admeasurement nine acres and two perches, more or less, being parts

of Sections 2, 3, and 4, Square 112, situated in Block VIII, Skiddaw Survey District, bounded as follows: commencing at survey peg L in Section 4; thence generally westerly a distance of 9087.1 links; thence north-easterly, 100 links; thence generally easterly, 8947.3 links; thence south-easterly, 119.9 links, to the commencing-point: be all the aforesaid linkages more or less: as the same is delineated on the plan marked L. and S. 8/8/45, deposited in the Head Office, Department of Lands and Survey, at Wellington, and thereon coloured yellow.

Also all that area in the Canterbury Land District, containing by admeasurement eleven acres, more or less, being parts of Sections 1, 2, and 8, Square 112, situated in Block VIII, Skiddaw Survey District, bounded as follows: commencing at a point in Section 2, the same being 580 links north-west of survey peg LXI; thence generally westerly, 5615.6 links; thence north-easterly, 200 links, to the River Hope; thence easterly along the said River Hope a distance of about 5400 links; thence south-easterly, 110 links; thence south-westerly, 100 links, to the commencing-point: be all the aforesaid linkages more or less: as the same is delineated on the plan marked L. and S. 8/8/45, deposited in the Head Office, Department of Lands and Survey, at Wellington, and thereon coloured orange.

Also all that area in the Canterbury Land District, containing by admeasurement six acres three roods six perches, more or less, being parts of Sections 6, 7, and 8, Square 112, situated in Blocks VII and VIII, Skiddaw Survey District, bounded as follows: commencing at survey peg LXV in Section 6; thence north-easterly, 6781 links; thence north-westerly, 100.4 links; thence south-westerly, 6800.5 links; thence south-easterly, 101.6 links: be all the aforesaid linkages more or less: as the same is delineated on the plan marked L. and S. 8/8/45, deposited in the Head Office, Department of Lands and Survey, at Wellington, and thereon coloured violet.

Also all that area in the Canterbury Land District, containing by admeasurement 4 acres 2 roods, more or less, being part of Section 6, Square 112, situated in Block VII, Skiddaw Survey District, bounded as follows: commencing at survey peg LXV in the said Section 6; thence south-westerly, 1111.4 links; thence north-westerly, 451.5 links, to the River Hope; thence generally easterly along the south bank of that river for a distance of about 1300 links; thence south-easterly, about 200 links, to the commencing-point: be all the aforesaid linkages more or less: as the same is delineated on the plan marked L. and S. 8/8/45, deposited in the Head Office, Department of Lands and Survey, at Wellington, and thereon coloured red.

Also all that area in the Canterbury Land District, containing by admeasurement three acres and four perches, more or less, being part of Section 6, Square 112, situated in Blocks VII and XI, Skiddaw Survey District, bounded as follows: commencing at survey peg LXVII in the said Section 6; thence generally south-westerly, 3159.4 links; thence north-easterly, 106.8 links and 2896.4 links; thence south-easterly, 101.5 links, to the commencing-point: be all the aforesaid linkages more or less: as the same is delineated on the plan marked L. and S. 8/8/45, deposited in the Head Office, Department of Lands and Survey, at Wellington, and thereon coloured sepia.



Also all that area in the Canterbury Land District, containing by admeasurement seventy-five acres, more or less, being parts of Sections 9, 26, 24, 23, 22, 21, 27, 20, 19, and 6, Square 112, situated in Blocks X and XI, Skiddaw Survey District: commencing at survey peg LXX in Section 6; thence generally westerly, about 38850 links, to the western boundary of Section 9; thence northerly, 200 links, to the River Hope; thence easterly along the said river, about 39000 links; thence south-easterly, 150 links; thence south-westerly, 106.8 links, to the commencing-point: be all the aforesaid linkages more or less: as the same is delineated on the plan marked L. and S. 8/8/45, deposited in the Head Office, Department of Lands and Survey, at Wellington, and thereon coloured orange.

Also all that area in the Canterbury Land District, containing by admeasurement twelve acres, more or less, being part of Section 6, Square 112, situated in Blocks VII and XI, Skiddaw Survey District, and bounded towards the north-east, south-east, and south-west by other parts of Section 6, 350 links, 2680.2 links, and 366.2 links respectively; and towards the north-west by the River Hope: be all the aforesaid linkages more or less: as the same is delineated on the plan marked L. and S. 8/8/45, deposited in the Head Office, Department of Lands and Survey, at Wellington, and thereon bordered green.

(4.) The balance of the land to be acquired by the Crown in exchange is more particularly described as follows:—

All that area in the Canterbury Land District, containing by admeasurement two hundred and forty-eight acres, more or less, being Section 29, Square 112, situated in Blocks VI, X, and XI, Skiddaw Survey District, and bounded towards the north by Run 233A, 6300 links; towards the north-east by the River Boyle; towards the south by the River Hope; and towards the west by Run 233A, 2800 links: excepting a public road one chain in width which intersects the above-described area: be all the aforesaid linkages more or less: as the same is delineated on the plan marked L. and S. 8/8/45, deposited in the Head Office, Department of Lands and Survey, at Wellington, and thereon bordered pink.

Also all that area in the Canterbury Land District, containing by admeasurement eighty acres, more or less, being Section 1, situated in Block XVI, Boyle Survey District: bounded towards the east, south, and west by Run 233B, 4000 links, 2000 links, and 4000 links respectively; and towards the north by a public road, 2000 links: be all the aforesaid linkages more or less: as the same is delineated on the plan marked L. and S. 8/8/45, deposited in the Head Office, Department of Lands and Survey, at Wellington, and thereon bordered blue.

(5.) The land described in subsection four hereof shall from the date of the acquisition thereof by the Crown be deemed to be national-endowment land.

(6.) No exchange shall be effected under this section unless and until the owner of the private land to be exchanged indemnifies the Crown from all liability for claims in respect of fencing any portion of the land to be transferred to the Crown.

A MURI  
NEW ZEALAND.

RECORDS-1.



CANCELLED  
Register-Book,  
Vol 15 folio 157

References: Warrant No. 79  
P.B. folio 1736

CERTIFICATE OF TITLE UNDER LAND TRANSFER ACT.

This Certificate, dated the Twenty-fifth day of November, one thousand eight hundred and ninety-one, under the hand and seal of the District Land Registrar of the Land Registration District of Nelson, being a Certificate in lieu of Grant, under Warrant of His Excellency the Governor, in exercise of the powers enabling him in that behalf, Witnesseth that Andrew William Rutherford and Duncan Rutherford of Nimrod Sheepfarmers are

seized of an estate in fee-simple (subject to such reservations, restrictions, encumbrances, liens, and interests as are notified by memorial underwritten or indorsed hereon; subject also to any existing right of the Crown to take and lay off roads under any Act of the General Assembly of New Zealand) in the land hereinafter described, as the same is delineated by the plan hereon, bordered green, be the several admeasurements a little more or less, which said land is in the said Warrant expressed to have been originally acquired by David John William Rutherford and another as from the Seventh day of July, one thousand eight hundred and ninety-one, under The Land Act 1885, that is to say: All that parcel of land containing Eight acres more or less Block XVI (Section) on the plan of the above District deposited in the Office of the Chief Surveyor at Nelson

(233) Nelson Road  
District Land Registrar

Image Quality due to Condition of Original

Transfer 4353: produced 11 July 1892  
of 11.3 acres Andrew William Rutherford  
to Duncan Rutherford of his interest in the  
above land

I hereby certify the foregoing to be a true copy of a  
Certain Certificate of Title registered in this office as Vol 15  
fol 157 and of all memorials of dealings recorded thereon  
up to this date.

Given this 25th day of December 1891.  
Walter Lewis District Registrar

Transfer 1185/132 produced 30  
October 1915 at 11.51 am Duncan  
Rutherford to Ronald Ogilvie  
Duncan of Christchurch and Agent  
Walter Lewis D.L.R.

Transfer 1185/132 produced 4  
September 1917 at 10.10 am  
Ronald Ogilvie Duncan to  
Her Majesty The King  
Walter Lewis D.L.R.

Cancelled  
Produced this 15th day of July 1917  
at 11.30 am

49961 Change of specification whereby the description of part of the within land is changed to Block 227 Glenhope  
produced this 15th day of July 1917 at 10.10 am

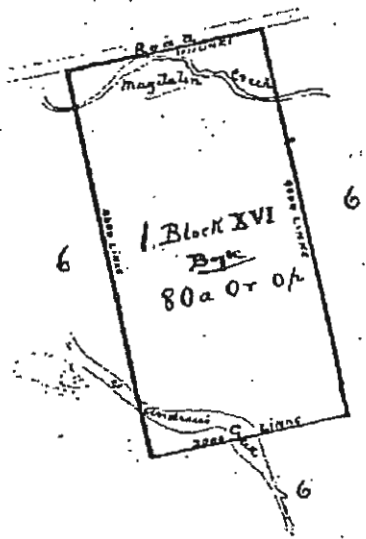

Scale 10 Chains to an inch  
Surveyed by F.A. Thompson  
District Chief Surveyor  
Drafter: Walter S. Curtis

15/157

15/157

# AMURI

*Sp. 529/99 issued for the post. Rev. 287/99  
Chania 26/1/1959*

*W. M. A. R.*

THIS REPRODUCTION (ON A REDUCED SCALE)  
CERTIFIED TO BE A TRUE COPY OF THE  
ORIGINAL REGISTER FOR THE PURPOSES OF  
SECTION 215A LAND TRANSFER ACT 1952.

*W. M. A. R.*

15/157

CERTIFICATE OF TITLE.

Vol. , folio

15/157



# ALTERATION TO BE NOTED

FILE: PR. 458

Lease/Licence No. PR. 458 C.T. Pt. 15/157 (Amuri) Pt. CL 529/28  
Lessee/Licensee: J. J. Minahan

Description of Land: Reserves 5003, 5008 + 5009 and Run 287  
"Glenhope"

Area: \_\_\_\_\_  
Rating Authorities: Amuri County Council

Full Details of Alteration

Reason and Authority for Alteration

✓ Reserve 5003 situated in Blks. VII, XI, XV  
Boyle S.D. and Blk. III Skiddaw S.D.  
Area: 6000 acres.  
Formerly part Run 233B.

6000  
2000

✓ Reserve 5008 situated in Blks. XII, XVI  
Boyle S.D. and Blks. IX-XIII Billon S.D.  
Area: 450 acres.  
Formerly part Run 233B.

Areas to be  
declared State  
Forest.

✓ Reserve 5009 situated in Blk. IV  
Skiddaw S.D. and Blk. I Tekoa S.D.  
Area: 650 acres.  
Formerly part Run 233B.

S.O. 9509  
CHECKED  
18 JUN 1959

Run 287, "Glenhope" situated in  
Boyle, Billon, Skiddaw + Tekoa S.D.'s  
Amuri County.  
Area: 25,500 acres.

New lease to be  
issued for balance  
of old Run plus  
Hopefield block.

Formerly parts Run 233B Pt. Run 18 (Amuri),  
Pt. L. 4381 + Pt. Sec. 1 Blk. XVI Boyle S.D.  
S.O. 9510

Prepared by: J.D. Inappert Checked by: J. Whitcombe  
Date: 24. 3. 59. Date: 24. 3. 59.

Details of Action

ACTION REQUIRED:

LEASES:	ACCOUNTS:	TITLES:	RECORDS:
G.13	Ledgers:	Documents:	File
C.L. Register	C/Register:	C/T:	Index
Expiry Book	Index:	Insurance:	

*(Handwritten marks and signatures in the table)*

29/16  
R1