

Crown Pastoral Land Tenure Review

Lease name : GLENHOPE

Lease number : PC 083

Due Diligence Report (including Status Report) - Part 6

This report and attachments results from a pre-Tenure Review assessment of the pastoral lease for the purpose of confirming land available for Tenure Review and any issues, rights or obligations attaching to it. The information is gathered from files and other sources available to the LINZ contractor.

Part of the information relates to research on the status of the land, resulting in a Status Report that is signed off by a LINZ approving officer. The remainder of the information is not analysed for relevancy or possible action until required, and LINZ does not guarantee its accuracy or completeness as presented.

The report attached is released under the Official Information Act 1982.

April 09

2422

THE NEW ZEALAND GAZETTE

No. 102

D.P. 85796; as shown on plan S.O. 51281, lodged in the office of the Chief Surveyor at Auckland, and thereon marked "A".

Given under the hand of His Excellency the Governor-General, and issued under the Seal of New Zealand, this 21st day of August 1981.

W. L. YOUNG, Minister of Works and Development.

[L.S.] GOD SAVE THE QUEEN!

(P.W. 33/2054; Ak. D.O. 50/15/11/0/51281)

State Forest Land Set Apart as State Forest Park for Addition to Lake Sumner State Forest Park

DAVID BEATTIE, Governor-General

A PROCLAMATION

PURSUANT to section 63B (1) of the Forests Act 1949 (as substituted by section 19 of the Forest Amendment Act 1976), I, The Honourable Sir David Stuart Beattie, the Governor-General of New Zealand, hereby set apart the State forest land described in the Schedule hereto as State forest park which shall hereby form part of the Lake Sumner State Forest Park.

SCHEDULE

CANTERBURY LAND DISTRICT—CANTERBURY CONSERVANCY—AMURI COUNTY

PART R. 4380, situated in Blocks XVI, Nina S.D.; IX, XIII, Boyle S.D.; III, IV, VIII, Marion S.D.; I, II, III, VI, VII, Skiddaw S.D. Area of 4270.3404 hectares.

Part R. 4381, situated in Blocks VII, VIII, XI, XII, XV, XVI, Boyle S.D.; IX, XIII, Dillon S.D.; II, III, IV, VII, VIII, Skiddaw S.D.; I, V, Tekoa S.D. Area of 9118.0000 hectares.

Part R. 5002, situated in Blocks V, VI, IX, X, XIII, XIV, Boyle S.D.; XII, XV, XVI, Nina S.D.; III, IV, VII, VIII, Marion S.D.; I, II, V, Skiddaw S.D. Area of 10 220.0000 hectares.

R. 5003, situated in Blocks VII, XI, XV, Boyle S.D.; III, Skiddaw S.D. Area of 2236.0000 hectares.

R. 5006, situated in Blocks IV, Marion S.D.; I, Skiddaw S.D. Area of 60.7028 hectares.

R. 5008, situated in Blocks XII, XVI, Boyle S.D.; IX, XIII, Dillon S.D. Area of 219.0000 hectares.

R. 5009, situated in Block I, Tekoa S.D. Area of 331.0000 hectares.

As shown on plan S. 46/1 and 2, deposited in the Head Office of the New Zealand Forest Service at Wellington.

Given under the hand of His Excellency the Governor-General, and issued under the Seal of New Zealand, this 25th day of August 1981.

VENN YOUNG, Minister of Forests.

[L.S.] GOD SAVE THE QUEEN!

(F.S. 6/6/7)

Vesting of Property in the Otorohanga Pest Destruction Board Amendment Order

(Notice No. 2658, Ag. 6/13/2/6A)

DAVID BEATTIE, Governor-General

ORDER IN COUNCIL

At the Government House at Wellington this 20th day of July 1981

Present:

HIS EXCELLENCY THE GOVERNOR-GENERAL IN COUNCIL

PURSUANT to section 27 (3) (c) of the Agricultural Pests Destruction Act 1967, His Excellency the Governor-General, acting by and with the advice and consent of the Executive Council, hereby makes the following order.

ORDER

1. (i) This order may be cited as the Otorohanga Pest Destruction Board Order 1981, Amendment No. 1, and shall be read together with and deemed part of the vesting of properties in the Waipa and Otorohanga Pest Destruction Board Order 1973.

(ii) This order shall come into force on the day after its notification in the *Gazette*.

2. The property described in the following Schedule is hereby vested in the Otorohanga Pest Destruction District (constituted on the 15th day of March 1971).

SCHEDULE

ALL that parcel of land vested in the Kawhia Rabbit Board, section 26, Block XI, Kawhia North Survey District Area: 3035 square metres.

P. G. MILLEN, Clerk of the Executive Council.

Directing the Sale of Land in Block XIII, Belmont Survey District, Borough of Petone

DAVID BEATTIE, Governor-General

ORDER IN COUNCIL

At the Government Buildings at Wellington this 24th day of August 1981

Present:

THE RT. HON. D. MACINTYRE PRESIDING IN COUNCIL

PURSUANT to the Public Works Act 1928, His Excellency the Governor-General, acting by and with the advice and consent of the Executive Council, hereby directs the sale of the land described in the Schedule hereto, such land being no longer required for the purposes for which it was acquired.

SCHEDULE

WELLINGTON LAND DISTRICT

ALL that piece of land containing 275 square metres, situated in Block XIII, Belmont Survey District, Borough of Petone, being Lot 2 on Land Transfer Plan 50869.

C. J. HILL, Acting for Clerk of the Executive Council.
(P.W. 51/3923; Wn. D.O. 19/2/37/0)

Extending the time within which the Commission to Inquire into the need to declare a new acclimatisation district in the Auckland region and, in particular, into the necessity or otherwise for altering the Auckland Acclimatisation District May Report

DAVID BEATTIE, Governor-General

To all whom these presents shall come, and to:

EDWIN IAN ROBERTSON, C.B.E., of Tawa, formerly Director-General of the Department of Scientific and Industrial Research; and

ROY WILLIAM STEPHAN CAVANAGH, of Tauherenikau, formerly Deputy Controller of the Wildlife Service, Department of Internal Affairs; and

ARTHUR ROGER WILSON, of Waimate, Farmer, a past president of the Waitaki Valley Acclimatisation Society:

GREETING:

WHEREAS, by an instrument signed on the 26th day of May 1981*, you, the said Edwin Ian Robertson, Roy William Stephan Cavanagh, and Arthur Roger Wilson, were appointed to be a Commission to inquire into the need to declare a new acclimatisation district in the Auckland region and, in particular, into the necessity or otherwise for altering the Auckland Acclimatisation District:

And whereas by the said instrument you were required to submit your report not later than the 31st day of August 1981:

And whereas it is expedient that the time for so reporting should be extended as hereinafter provided:

Now, therefore, pursuant to the Wildlife Act 1953 and the Commissions of Inquiry Act 1908, I, The Honourable Sir David Stuart Beattie, the Governor-General of New Zealand, hereby extend until the 30th day of September 1981 the time within which you, the said Edwin Ian Robertson, Roy William Stephan Cavanagh, and Arthur Roger Wilson, are so required to report, without prejudice to the continuation of the liberty conferred upon you by the said instrument signed on the 26th day of May 1981 to report your proceedings and findings from time to time if you should judge it expedient to do so, and hereby confirm the said instrument signed on the 26th day of May 1981 and the Commission thereby constituted, save as modified by these presents.

Given under the hand of His Excellency the Governor-General this 26th day of August 1981.

D. A. HIGHET, Minister of Internal Affairs.

**Gazette*, 1981, p. 1562

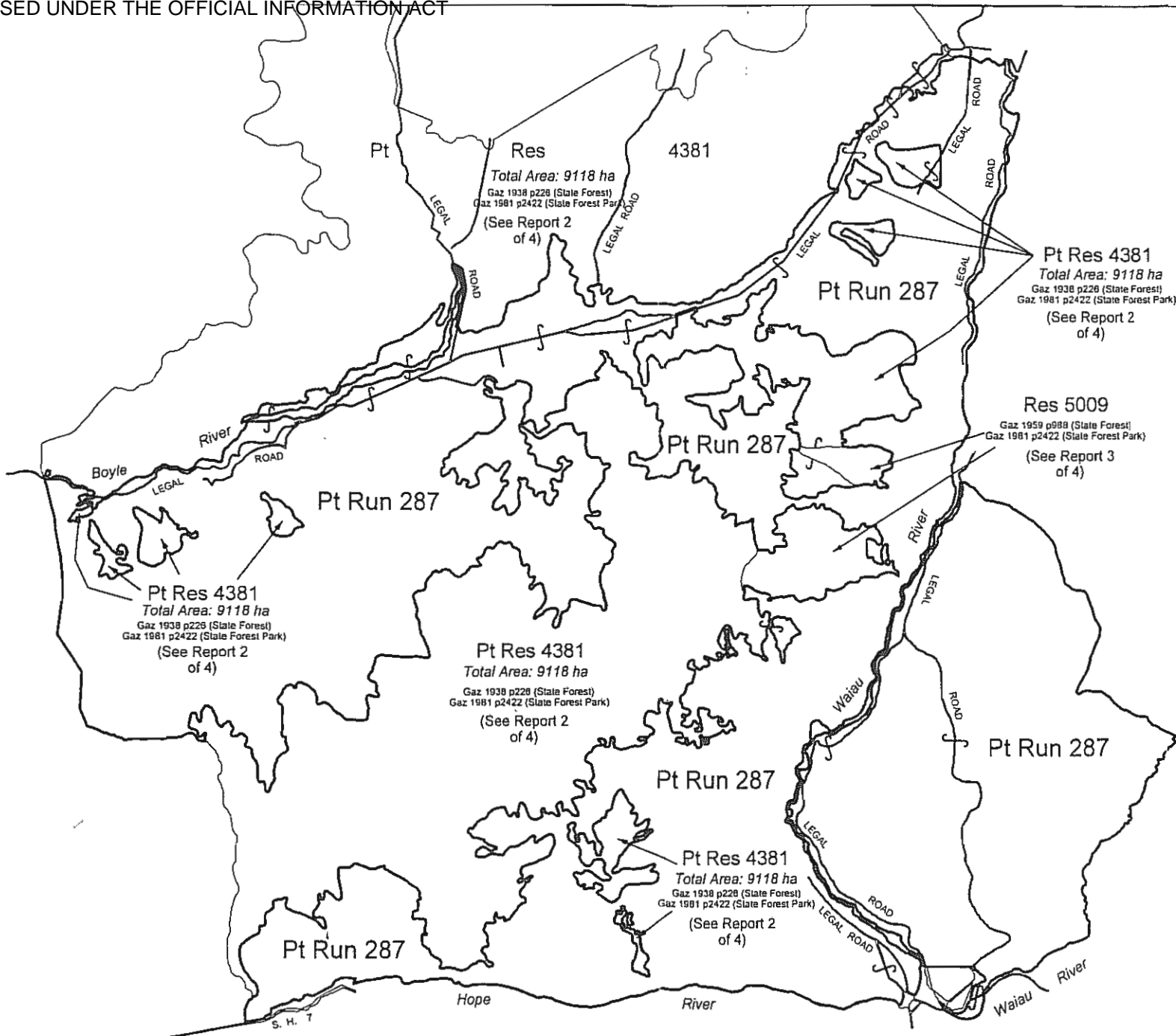

RELEASED UNDER THE OFFICIAL INFORMATION ACT



Marginal Strip Subject to Sec 24(9)
Conservation Act 1987 - - - - -

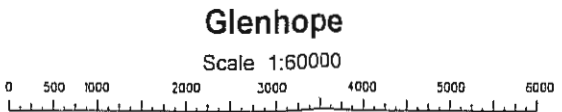

Version	1	2	3	4	5
Canterbury Land District					Sheet 4 of 5
Topographic Map 260 - M31, M32					Date 1/11/01

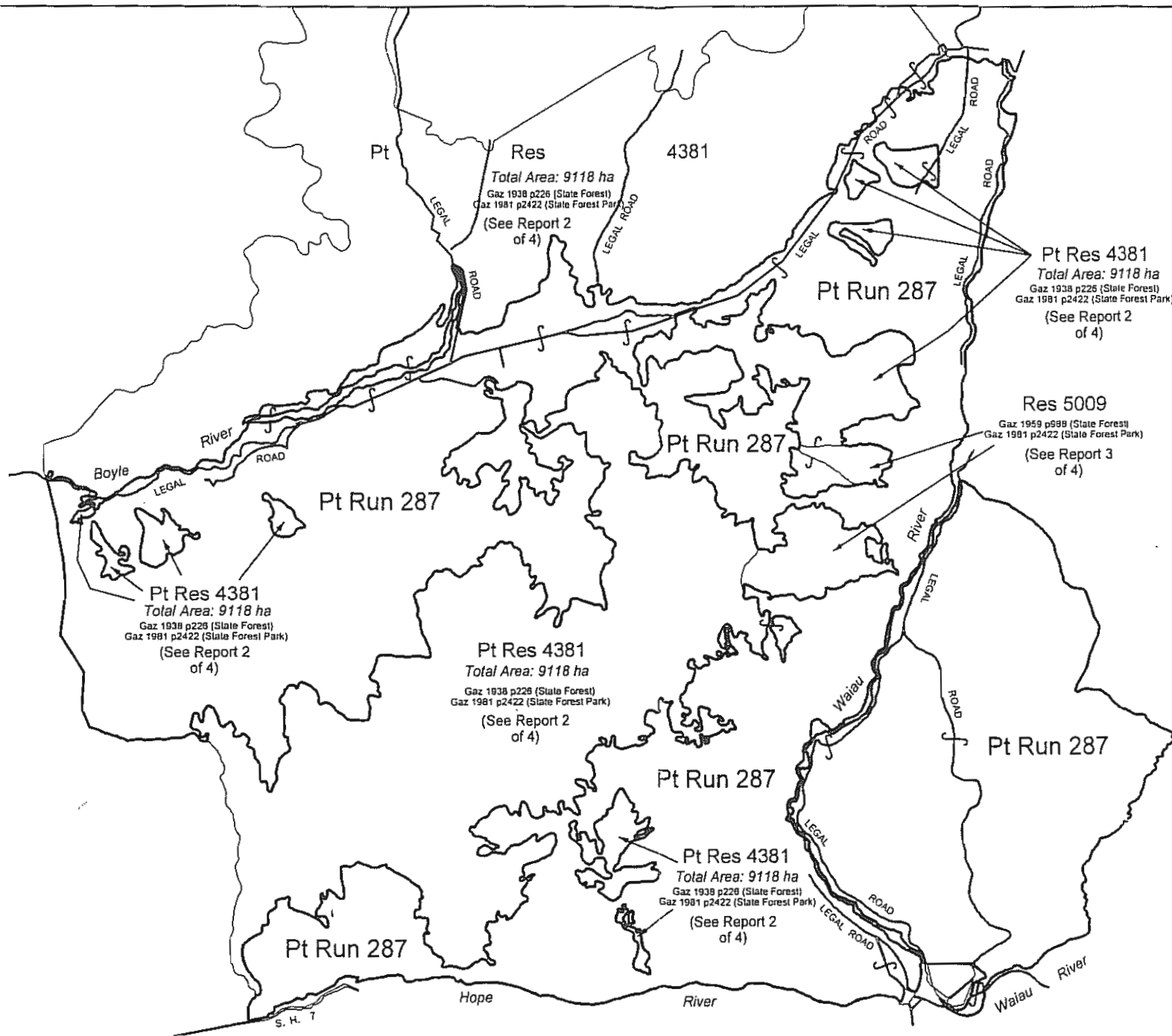

RELEASED UNDER THE OFFICIAL INFORMATION ACT

Glenhope

Scale 1:60000

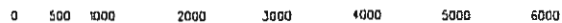

Marginal Strip Subject to Sec 24(9)
Conservation Act 1987

Version	1	2	3	4	5
Canterbury Land District					Sheet 4 of 5
Topographic Map 260 - M31, M32					Date 1/11/01



Site of Trigonometrical Stations and rights-of-way shown are reserved.
Interference with any survey peg or mark is a misdemeanour under the
Land Act.

F. A. Barrett's Run (233A) edged green. 106,750 acs

Area proposed to set aside for Scenic Res. edged yellow. 20,470 acs

Area proposed to be declared State Forest, pale green wash, edged blue. 26,880 acs

Sutherland's Run (233B) 47,450 acs edged green

Area proposed to be decl'd. 21,180 acs. State Forest, pale green wash, edged purple.

- R. 4326, 2000 acs, Res. under Scenery Pres. Act 1908, Gal. 19 37 & 3303
- R. 4378, 13190 acs, Res. under Scenery Pres. Act 1908, Gal. 19 36 & 3161
- R. 4379, 7370 acs,
- R. 4380, 26880 acs, Perm. State Forest, Gal. 19 28 & 228
- R. 4381, 2180 acs.

This print (from file) was prepared when Gaz. descriptions were written in 1932.

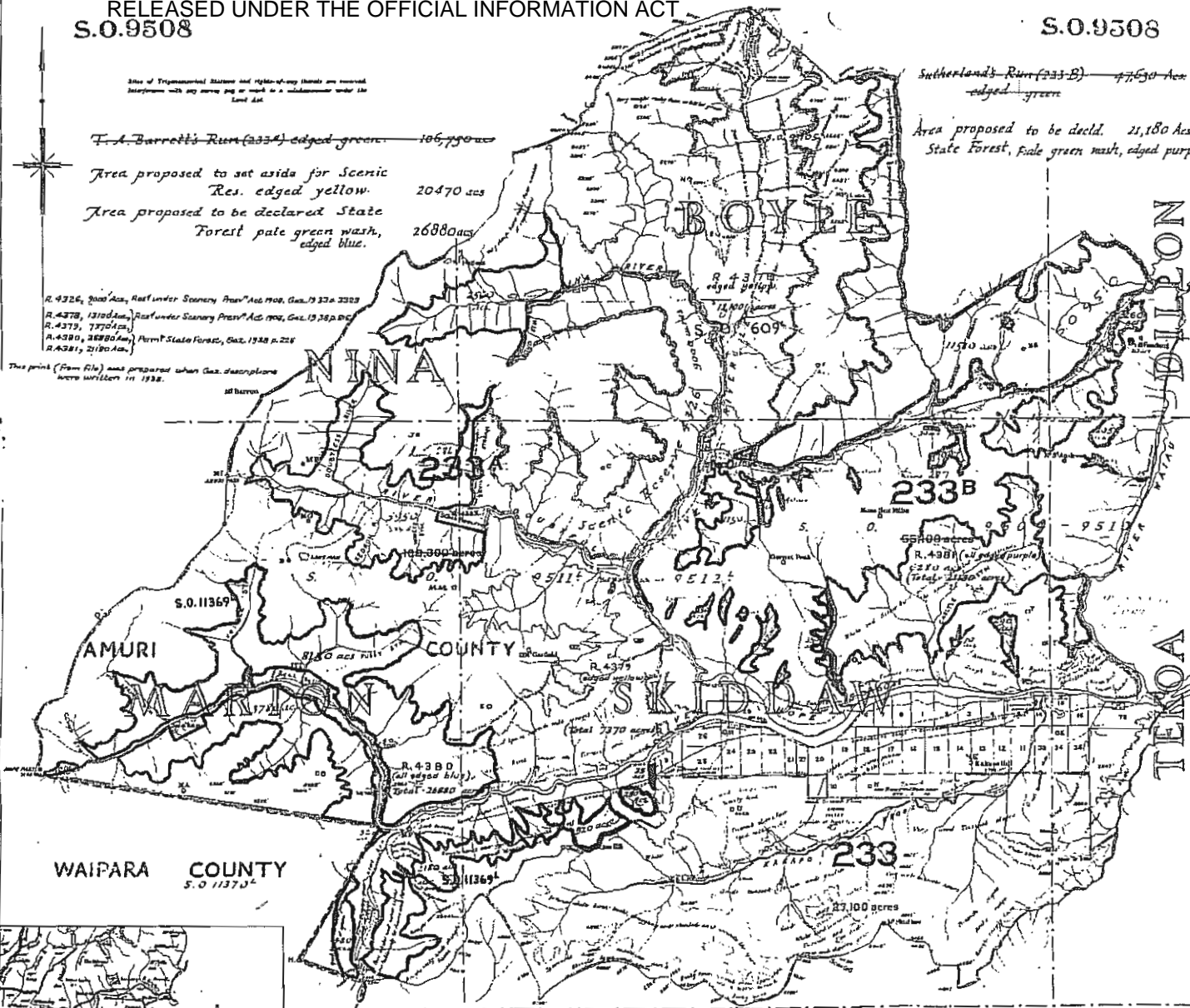

WAIPARA COUNTY
S.O. 11373

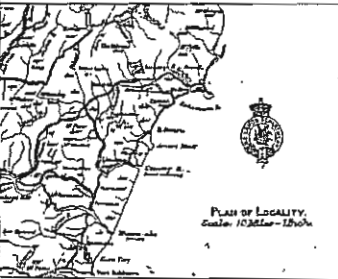

Runs 233, 233a, and 233b, AMURI COUNTY,

GLYNN WYE STATION.

Scale: 1 mile to an inch.

Res's. 4326, 4378, 4379 (Scenic) and Res's. 4380, 4381 (Permit, State Forest)

formerly Pt. Runs 233^A and 233^B

Note: This print was removed from Closed Volume of File. It is the only record found illustrating the above Reserves at the time of the Gazette actions, noted above. Abutments have not been brought up to date.

Approved as a Record

Chief Surveyor
25/1/32

9508

CANTERBURY LAND DISTRICT

Res. 5001 - 6000 acres, State Forest. Dec. 1952 p. 583
Res. 5008 - 450 acres, State Forest. Dec. 1952 p. 700
Res. 5009 - 650 acres, State Forest. Dec. 1952 p. 701

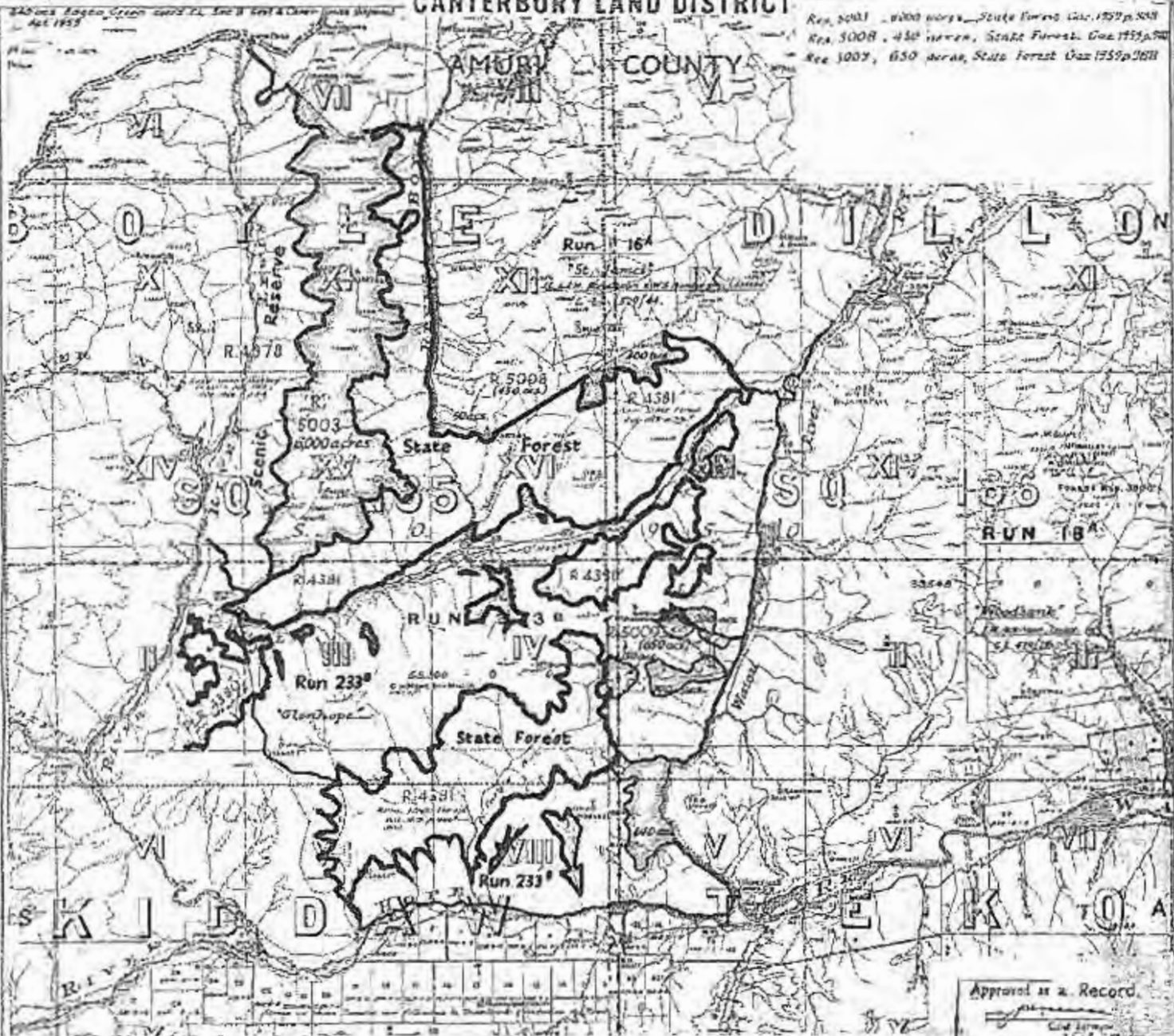

Approved as a Record
25/11/52

9509

Plan of
 Pt. State Forest R. 4391 to be declared Crown Land
 and added to the 'Glenhope' Run, 640 ac.
 also Rs 5003, 5008 & 5009, formerly Parts of Run 233, 'Glenhope';
 to be declared State Forest, 7100 ac.
 Scale: 1 mile to an inch.

S O 11985

S O 11985

LAKE SUMNER

This plan shows the most current descriptive information available as the result of the examination of the above named water.

Schedule

Applicant	Amount	Year	Interest	Remarks
PLR 400	100.00	1974	10.00	
PLR 400	100.00	1975	10.00	
PLR 400	100.00	1976	10.00	
PLR 400	100.00	1977	10.00	
PLR 400	100.00	1978	10.00	
PLR 400	100.00	1979	10.00	
PLR 400	100.00	1980	10.00	
PLR 400	100.00	1981	10.00	
PLR 400	100.00	1982	10.00	
PLR 400	100.00	1983	10.00	
PLR 400	100.00	1984	10.00	
PLR 400	100.00	1985	10.00	



S O 11985

S. O.

10977

11985

11985

Scale - 60' = 1" (1:720)

Legend

Water	Blue
Land	White
Forest	Green
Highway	Black
Railroad	Black
Power Line	Black
Telephone Line	Black
Boundary	Black
Parcel	Black

Notes

1. This plan shows the most current descriptive information available as the result of the examination of the above named water.

2. The plan shows the most current descriptive information available as the result of the examination of the above named water.

3. The plan shows the most current descriptive information available as the result of the examination of the above named water.

4. The plan shows the most current descriptive information available as the result of the examination of the above named water.

5. The plan shows the most current descriptive information available as the result of the examination of the above named water.

6. The plan shows the most current descriptive information available as the result of the examination of the above named water.

7. The plan shows the most current descriptive information available as the result of the examination of the above named water.

8. The plan shows the most current descriptive information available as the result of the examination of the above named water.

9. The plan shows the most current descriptive information available as the result of the examination of the above named water.

10. The plan shows the most current descriptive information available as the result of the examination of the above named water.

PROPERTY 3 of 4

**Appendix A - Land Status Report
(and supporting plans)**

**OPUS INTERNATIONAL CONSULTANTS LIMITED
CHRISTCHURCH OFFICE**

APPENDIX A3

Project Number 6NL.12770.TR.

This report has been prepared on the instruction of Land information New Zealand in terms of **Contract No. 50269 (as yet undated)** and is undertaken for the purposes of the Crown Pastoral Land Act 1998.

LAND STATUS REPORT for Glenhope Tenure Review (Conservation land)	LIPS Ref: Not Applicable
Property 3 of 4	

Land District	Canterbury.
Legal Description	Reserve 5009, situated in Block I, Tekoa Survey Districts.
Area	331.0000 hectares.
Status	Conservation Park held subject to Section 61 of the Conservation Act 1987.
Instrument	No registered instrument.
Encumbrances	Subject to Part 9 of the Ngai Tahu Claims Settlement Act 1998.
Mineral Ownership	The Mines and Minerals are owned by the Crown because the land has never been alienated from the Crown since its acquisition for settlement purposes from the former Maori owners under the 1859 Kaikoura Deed of Purchase.
Statute	Conservation Act 1987.

Data Correct as at	1 November 2001
---------------------------	-----------------



Prepared by Crown Accredited Supplier	Don McGregor, McGregor Property Services Limited, Christchurch for and on behalf of Opus International Consultants Limited
--	---

NOTES: This information does not affect the status of the land but was identified as possible requiring further investigation at the due diligence stage: See Crown Pastoral Standard 6	Not applicable.
--	-----------------

LAND STATUS REPORT for Glenhope Tenure Review (Conservation land)	LIPS Ref Not Applicable
Property 3 of 4	

Research Data: Some Items may not be applicable

SDI Print Obtained	Yes.
NZMS 261 Ref	M 32.
Local Authority	Hurunui District Council
Crown Acquisition Map	Kaikoura Deed of Purchase.
SO Plans	<p>SO 9509 - Plan of State Forest (Reserve 4381) to be declared Crown Land and added to Glenhope and Parts of Run 233B to be declared State Forest (Reserves 5003, 5008 and 5009). (Approved 25 March 1959).</p> <p>SO 9510 - Plan of Run 287 "Glenhope" (formerly Pts Run 233B, Pt Run 18, Pt State Forest Reserve 4381 and Section 1, Block XV, Boyle S.D.) and adjoining State Forest areas (Approved 25 March 1959).</p> <p>SO 13986 - Redefinition Plan of Run 287, Pts 4381 and Reserves 5003,5008 and 5009 (Approved 14 June 1976).</p> <p>SO 18910 - Redefinition Plan of Run 287, Reserve 5009 and Pts 4381 (Approved 6 January 1993).</p>
Relevant Gazette Notices etc	<p>N.Z Gazette 1938 p226 - declared Reserve 4381 (21180 acres) to be Permanent State Forest.</p> <p>Section 11 of the Reserves and Other Lands Act 1959 declared 640 acres of Reserve 4381 to be Crown Land for inclusion into the lease in exchange for 650 acres (Reserve 5009) of the lease to be set apart as State Forest.</p> <p>N.Z Gazette 1959 p988 - declared Reserve 5009 Permanent State Forest.</p> <p>N.Z Gazette 1981 p2422 - Set apart Part Reserve 4381 of State Forest Land as State Forest Park for addition to the Lake Sumner Forest Park.</p>
Instrument	No registrable instrument.
Legalisation Cards	Not applicable.
CLR	Not Crown land.
Allocation Maps (if applicable)	Not applicable.
VNZ Ref - if known	Not known.
Crown Grant Maps	Not applicable.

<p>If Subject Land Marginal Strip a) Type - [Sec 24(9) or Sec 58] b) Date Created c) Plan Reference</p>	<p>a) Not applicable. b) Not applicable. c) Not applicable.</p>
<p>If Crown land – Check Irrigation Maps</p>	<p>Not Applicable.</p>
<p>Mining Maps</p>	<p>Not Applicable.</p>
<p>If Road a) Is it created on a Block Plan – Section 43(1)(d) Transit NZ 1989 b) By Proc</p>	<p>a) Not applicable. b) Proc Plan Not applicable. c) Gazette Ref Not applicable.</p>
<p>Other relevant information a) Concessions – Advice from DOC or Knight Frank. b) Subject to any provisions of the Ngai Tahu Claims Settlement Act 1998 c) Mineral Ownership d) Other Info</p>	<p>a) Not applicable. b) Part 9 of the Ngai Tahu Claims Settlement Act 1998. c) The Mines and Minerals are owned by the Crown because the land has never been alienated from the Crown since its acquisition for settlement purposes from the former Maori owners under the 1859 Kaikoura Deed of Purchase. d) Not applicable.</p>

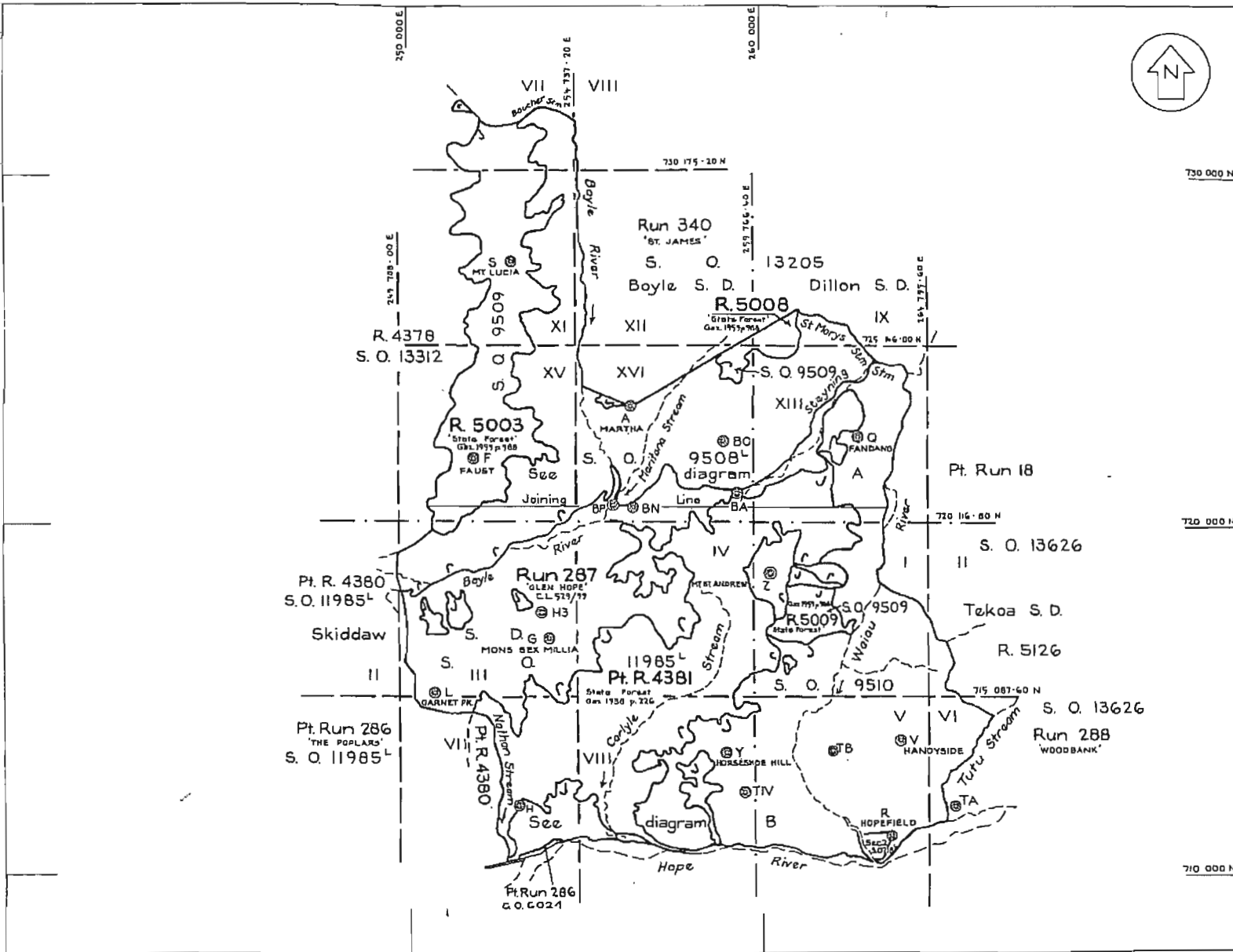

Approx

730 000 N

720 000 N

710 000 N

Area Schedule		
Appellation	Former Area (ha)	New Area (ha)
Run 287	10319.4839	9265.0
Pt. R. 4381	8312.2430	9118.0
R. 5003	2428.1138	2236.0
R. 5008	182.1085	219.0
R. 5009	263.0456	331.0

For boundary definition of roads and streams see sheets 2 & 3.

Run 287 is subject to Sec. 58 of the Land Act 1948 along rivers and streams over 3 metres wide.

Datum: Old Cadastral
Amuri Circuit Coordinates
Origin: Isolated Hill 700 000 mN
300 000 mE

Total Area 21254.0 ha.

Comprised in C.L. 529/99, Gaz. 1938 p. 226
Gaz. 1959 p. 988

This plan represents the most accurate planimetric definition available at this date of the lands listed above.
Dated 16/6/1976

[Signature]
Chief Surveyor

Field Book _____ p. _____ Traverse Book _____ p. _____
Reference Plans _____ SEE SHEETS 2 & 3
Examined L. Hay _____ Correct M. Fleming

Approved as to Survey
See above

Chief Surveyor

Deposited this _____ day of _____ 19____

District Land Registrar

LAND DISTRICT CANTERBURY
SURVEY BLK. & DIST. VII, VIII, IX, X, XI, XII, XIII, XIV, XV, XVI, BOYLE, DILLON, & 19 N
VIII, SKIDDAW, I, II, V, VI, TEKOA
NZMS 177 SHEET NO. S.46, S.47, S.53 & S.54

Run 287, Pts. R. 4381, R. 5003,
R. 5008 & R. 5009

LOCAL AUTHORITY AMURI COUNTY
Compiled in Survey Office
Scale 1:75,000 Date April, 1976

File 3/452
Received L. Hay 6.5.76
Instructions

SO 13986

RELEASED UNDER THE OFFICIAL INFORMATION ACT

vest in the Wainpu Hospital Board as from the date herein-after mentioned; and I do also declare that this Proclamation shall take effect on and after the twenty-first day of February, one thousand nine hundred and thirty-eight.

SCHEDULE.

APPROXIMATE areas of the pieces of land taken:

A.	R.	P.	} Being portion of Tawhiti le	} edged red.		
1	0	0			} 5B Block	} coloured red.
0	1	2.7				

Situated in Block XVI, Mata Survey District. (S.O. 1490, brown.)

In the Gisborne Land District; as the same are more particularly delineated on the plan marked P.W.D. 97923, deposited in the office of the Minister of Public Works at Wellington, and thereon coloured as above mentioned.

Given under the hand of His Excellency the Governor-General of the Dominion of New Zealand, and issued under the Seal of that Dominion, this 2nd day of February, 1938.

R. SEMPLE, Minister of Public Works.

GOD SAVE THE KING!

(P.W. 24/2452.)

Crown Land set apart as a Permanent State Forest.

[L.S.] GALWAY, Governor-General.

By his Deputy,
 MICHAEL MYERS,
 A PROCLAMATION.

BY virtue and in exercise of the powers and authorities conferred upon me by section eighteen of the Forests Act, 1921-22, I George Vere Arundell, Viscount Galway, Governor-General of the Dominion of New Zealand, do hereby set apart the Crown land described in the Schedule hereto as a permanent State forest.

SCHEDULE.

CANTERBURY LAND DISTRICT.—CANTERBURY FOREST-CONSERVATION REGION.

ALL that area in the Canterbury Land District, containing by admeasurement 1,400 acres, more or less, situated in Blocks LX, X, XIII, and XIV, Mount Thomas Survey District, and bounded generally as follows: Towards the north-east by Reserves 3114 and 3271 (State Forests, *Gazette*, 1881, p. 960, and *Gazette*, 1898, p. 1458); towards the south-east by Rural Section 37047; towards the south-west by Rural Section 36715 and Reserve 3272 (State Forest, *Gazette*, 1898, p. 1458); and towards the north-west by the said Reserve 3272. As the same is more particularly delineated on plan No. 135/1, deposited in the Head Office of the State Forest Service at Wellington, and thereon bordered red.

Given under the hand of His Excellency the Governor-General of the Dominion of New Zealand, and issued under the Seal of that Dominion, this 4th day of February, 1938.

FRANK LANGSTONE,
 Commissioner of State Forests.

GOD SAVE THE KING!

Altering the Boundaries of the Wairarapa Electric-power District.

[L.S.] GALWAY, Governor-General.

By his Deputy,
 MICHAEL MYERS,
 A PROCLAMATION.

IN pursuance and exercise of the powers conferred on me by section three of the Electric-power Boards Act, 1925, and of all other powers and authorities in anywise enabling me in that behalf, I, George Vere Arundell, Viscount Galway, Governor-General of the Dominion of New Zealand, do hereby alter the boundaries of the Wairarapa Electric-power District so as to include the area described in the Schedule hereto.

SCHEDULE.

ALL that area situated in the Wellington Land District, and being portion of the Masterton County, bounded by a line commencing at a point situated on the northern boundary of the Wairarapa Electric-power District as at present constituted at the north-west corner of Section 52, Block VI, Kopuaranga Survey District, which point is also on the northern boundary of the Masterton County as at present constituted; and thence following in a north-westerly and westerly direction generally the northern boundary of the said Masterton County to the north-west corner of Section 51, Block V, Kopuaranga Survey District; thence following in a southerly direction generally the western boundary of the Rangitumu Riding of the Masterton County, to where it meets the boundary of the said Wairarapa Electric-power District on the eastern bank of the Ruamahanga River at the north-west corner of Section 20, Block IX, Kopuaranga Survey District; thence following in a southerly direction the boundary of the said Wairarapa Electric-power District to the north-west corner of Section 19, Block IX, Kopuaranga Survey District; thence following in an easterly and north-easterly direction generally the boundary of the said Wairarapa Electric-power District, to the starting point; the same being more particularly shown on the plan marked P.W.D. 98324, deposited in the office of the Minister of Public Works at Wellington, and thereon coloured red.

Given under the hand of His Excellency the Governor-General of the Dominion of New Zealand, and issued under the Seal of that Dominion, this 2nd day of February, 1938.

R. SEMPLE, Minister of Public Works.

GOD SAVE THE KING!

(P.W. 20/988.)

Land set apart as a Permanent State Forest.

[L.S.] GALWAY, Governor-General.

By his Deputy,
 MICHAEL MYERS,
 A PROCLAMATION.

BY virtue and in exercise of the powers and authorities conferred upon me by section eighteen of the Forests Act, 1921-22, I, George Vere Arundell, Viscount Galway, Governor-General of the Dominion of New Zealand, do hereby set apart the land described in the Schedule hereto as a permanent State forest.

SCHEDULE.

CANTERBURY LAND DISTRICT.—CANTERBURY FOREST-CONSERVATION REGION.

ALL those areas in the Canterbury Land District, containing 48,060 acres and described as follows:—

All that area containing by admeasurement 26,880 acres, more or less, and being Reserve No. 4380, situated in Blocks IX and XIII, Boyle Survey District, Block XVI, Nina Survey District, Blocks III, IV, VI, VII, VIII, X, XI, XII, and XVI, Marion Survey District, and Blocks I, II, III, V, VI, VII, IX, X, and XIII, Skiddaw Survey District, and being all the bush clad areas contained within the boundaries of Run 233a, save and except thereout Reserves 4326, 4378, and 4379.

Also all that area containing by admeasurement 21,180 acres, more or less, and being Reserve No. 4381, situated in Blocks VII, XI, XII, XV, and XVI, Boyle Survey District, Blocks IX and XIII, Dillon Survey District, Blocks II, III, IV, VII, and VIII, Skiddaw Survey District, and Blocks I and V, Tekoa Survey District, and being all the bush clad areas contained within the boundaries of Run 233n.

As the same are more particularly delineated on the plan marked 127/4, deposited in Head Office of the State Forest Service, at Wellington, and thereon bordered blue.

Given under the hand of His Excellency the Governor-General of the Dominion of New Zealand, and issued under the Seal of that Dominion, this 1st day of February, 1938.

FRANK LANGSTONE,
 Commissioner of State Forests.

GOD SAVE THE KING!

Also all those areas in the Kowai County, containing 80 acres 3 roods, more or less, situated in Blocks X, XI, XIV, and XV, Grey Survey District, being all the road closed by Proclamation No. 22, of 16 April 1959, page 480, as shown on S.O. Plan No. 9077L.

As shown on plans Nos. 136/26, 136/27, and 136/28 respectively, deposited in the Head Office of the New Zealand Forest Service at Wellington, and thereon coloured green.

Given under the hand of His Excellency the Governor-General, and issued under the Seal of New Zealand, this 15th day of July 1959.

[L.S.] E. T. TIRIKATENE, Minister of Forests.

GOD SAVE THE QUEEN!

(P.S. 6/6/41)

Crown Land Set Apart as Permanent State Forest Land

COBHAM, Governor-General

A PROCLAMATION

PURSUANT to section 18 of the Forests Act 1949, I, Charles John, Viscount Cobham, the Governor-General of New Zealand, hereby set apart the Crown land described in the Schedule hereto as permanent State forest land.

SCHEDULE

CANTERBURY LAND DISTRICT—CANTERBURY CONSERVANCY

ALL that area in Amuri County containing 6,000 acres, more or less, being Reserve 5003 (formerly part Run 233a, "Glenhope"), situated in Blocks VII, XI, and XV, Boyle Survey District, and Block III, Skiddaw Survey District.

Also all those areas in Amuri County containing 450 acres, more or less, being Reserve 5008 (formerly part Run 233a, "Glenhope"), situated in Blocks XII and XVI, Boyle Survey District, and Blocks IX and XIII, Dillon Survey District.

Also all those areas in Amuri County containing 650 acres, being Reserve 5009 (formerly part Run 233a, "Glenhope"), situated in Block IV, Skiddaw Survey District, and Block I, Tekoa Survey District. Shown on plan No. 121/11 deposited in the Head Office of the New Zealand Forest Service at Wellington, and thereon bordered red. (S.O. Plan 9509.)

Also all that area in Amuri County containing 39,940 acres, more or less, being Reserve 5002 (formerly part Run 233a, "The Poplars"), situated in Blocks VI, IX, X, XIII, and XIV, Boyle Survey District, Blocks XII, XV, and XVI, Nina Survey District, Blocks III, IV, VI, VII, VIII, X, XI, XII, XV, and XVI, Marion Survey District, and Blocks I, II, V, IX, and XIII, Skiddaw Survey District. As shown on plan No. 127/10 deposited in the Head Office of the New Zealand Forest Service at Wellington, and thereon bordered red. (S.O. Plan 9511L.)

Also all that area in Amuri County containing 54 acres, more or less, being Reserve 5007 (formerly part Section 4, Block XI, Marion Survey District), situated in Block XI, Marion Survey District. Shown on plan No. 127/11 deposited in the Head Office of the New Zealand Forest Service at Wellington, and thereon bordered red. (S.O. Plan 700L.)

Also all that area in Amuri County containing 120 acres, more or less, being Reserve 5006 (formerly part Reserve 4337), situated in Block IV, Marion Survey District, and Block I, Skiddaw Survey District. Shown on plan No. 128/26 deposited in the Head Office of the New Zealand Forest Service at Wellington, and thereon bordered red. (S.O. Plan 715L.)

Given under the hand of His Excellency the Governor-General, and issued under the Seal of New Zealand, this 15th day of July 1959.

[L.S.] E. T. TIRIKATENE, Minister of Forests.

GOD SAVE THE QUEEN!

(F.S. 6/6/6)

Crown Land Set Apart as Permanent State Forest Land

COBHAM, Governor-General

A PROCLAMATION

PURSUANT to section 18 of the Forests Act 1949, I, Charles John, Viscount Cobham, the Governor-General of New Zealand, hereby set apart the Crown land described in the Schedule hereto as permanent State forest land.

SCHEDULE

SOUTHLAND LAND DISTRICT—SOUTHLAND CONSERVANCY

SECTION 297 (formerly part of Run 133), Block XIII, Wairio Survey District, situated in Wallace County: Area, 638 acres 2 roods 20 perches, more or less. Shown on plan 201/8 deposited in the Head Office of the New Zealand Forest Service at Wellington, and thereon bordered red. (S.O. Plan 6400.)

Given under the hand of His Excellency the Governor-General, and issued under the Seal of New Zealand, this 10th day of July 1959.

Provisional State Forest Land Set Apart as Permanent State Forest Land

COBHAM, Governor-General

A PROCLAMATION

PURSUANT to section 18 of the Forests Act 1949, I, Charles John, Viscount Cobham, the Governor-General of New Zealand, hereby set apart the provisional State forest land described in the Schedule hereto as permanent State forest land.

SCHEDULE

SOUTHLAND LAND DISTRICT—SOUTHLAND CONSERVANCY

ALL that area in Wallace County, containing by estimation 3,720 acres 2 roods 27 perches, more or less, situated in Blocks VII and XIII, Lillburn Survey District, and described generally as follows:

Commencing at a point on the right bank of the Waiau River, in line with the northern boundary of Section 19, Block II, Lillburn Survey District; thence westerly to and along the northern boundary of Section 19 aforesaid and Section 18, Block II aforesaid, to the eastern boundary of Section 6, Block VIII, Lillburn Survey District; thence north-westerly generally along the boundary of Section 6 aforesaid, to the eastern boundary of Section 1, Block IX, Lillburn Survey District; thence northerly generally along the eastern boundaries of the said Section 1 and Section 2, Block XII, Lillburn Survey District, to the southern side of a public road; thence easterly generally along the southern side of the aforesaid public road to the south-western boundary of Pre-emptive Right A; thence along the south-western boundary aforesaid to the north-western boundary of Section 8, Block XIII, Lillburn Survey District; thence westerly, southerly, and south-easterly generally along the western boundaries of the said Section 8, crossing the Waiharakeke Stream, to the western boundary of Section 9, Block XIII aforesaid; thence south-westerly, southerly, south-easterly, and north-easterly generally along the western and southern boundaries of the said Section 9 to the south-western boundary of Section 8 aforesaid; thence south-easterly and easterly generally along the southern boundaries of Section 8 aforesaid, and a river bank reserve to the right bank of the Waiau River; thence southerly generally along the right bank of the Waiau River to the point of commencement. Save and excepting from the above-described area, the public road taken by Proclamation published in the *Gazette*, No. 6, 23 January 1958, page 68. As shown on plan No. 200/36 deposited in the Head Office of the New Zealand Forest Service at Wellington, and thereon bordered green.

Given under the hand of His Excellency the Governor-General, and issued under the Seal of New Zealand, this 15th day of July 1959.

[L.S.] E. T. TIRIKATENE, Minister of Forests.

GOD SAVE THE QUEEN!

(F.S. 6/7/20)

Crown Land Set Apart for Railway Purposes at Feilding

COBHAM, Governor-General

By his Deputy,
J. D. HUTCHISON

A PROCLAMATION

PURSUANT to the Public Works Act 1928, I, Charles John, Viscount Cobham, the Governor-General of New Zealand, hereby proclaim and declare that the Crown land described in the Schedule hereto is hereby set apart for railway purposes; and I also declare that this Proclamation shall take effect on and after the 27th day of July 1959.

SCHEDULE

WELLINGTON LAND DISTRICT

ALL that piece of Crown land containing 2 roods 9-2 perches, situated in the Borough of Feilding, Wellington R.D., and being Lots 4, 10, and 11, D.P. 20573, being part Subdivision A, Manchester Block. Formerly part certificate of title, Volume 682, folio 65, Wellington Registry.

Given under the hand of His Excellency the Governor-General, and issued under the Seal of New Zealand, this 17th day of July 1959.

[L.S.] M. MOOHAN, Minister of Railways.

2422

THE NEW ZEALAND GAZETTE

No. 102

D.P. 85796; as shown on plan S.O. 51281, lodged in the office of the Chief Surveyor at Auckland, and thereon marked "A".

Given under the hand of His Excellency the Governor-General, and issued under the Seal of New Zealand, this 21st day of August 1981.

W. L. YOUNG, Minister of Works and Development.

[L.S.] GOD SAVE THE QUEEN!
(P.W. 33/2054; Ak. D.O. 50/15/11/0/51281)

State Forest Land Set Apart as State Forest Park for Addition to Lake Sumner State Forest Park

DAVID BEATTIE, Governor-General

A PROCLAMATION

PURSUANT to section 63B (1) of the Forests Act 1949 (as substituted by section 19 of the Forest Amendment Act 1976), I, The Honourable Sir David Stuart Beattie, the Governor-General of New Zealand, hereby set apart the State forest land described in the Schedule hereto as State forest park which shall hereby form part of the Lake Sumner State Forest Park.

SCHEDULE

CANTERBURY LAND DISTRICT—CANTERBURY CONSERVANCY—
AMURI COUNTY

PART R. 4380, situated in Blocks XVI, Nina S.D.; IX, XIII, Boyle S.D.; III, IV, VIII, Marion S.D.; I, II, III, VI, VII, Skiddaw S.D. Area of 4270.3404 hectares.

Part R. 4381, situated in Blocks VII, VIII, XI, XII, XV, XVI, Boyle S.D.; IX, XIII, Dillon S.D.; II, III, IV, VII, VIII, Skiddaw S.D.; I, V, Tekoa S.D. Area of 9118.0000 hectares.

Part R. 5002, situated in Blocks V, VI, IX, X, XIII, XIV, Boyle S.D.; XII, XV, XVI, Nina S.D.; III, IV, VII, VIII, Marion S.D.; I, II, V, Skiddaw S.D. Area of 10 220.0000 hectares.

R. 5003, situated in Blocks VII, XI, XV, Boyle S.D.; III, Skiddaw S.D. Area of 2236.0000 hectares.

R. 5006, situated in Blocks IV, Marion S.D.; I, Skiddaw S.D. Area of 60.7028 hectares.

R. 5008, situated in Blocks XII, XVI, Boyle S.D.; IX, XIII, Dillon S.D. Area of 219.0000 hectares.

R. 5009, situated in Block I, Tekoa S.D. Area of 331.0000 hectares.

As shown on plan S.46/1 and 2, deposited in the Head Office of the New Zealand Forest Service at Wellington.

Given under the hand of His Excellency the Governor-General, and issued under the Seal of New Zealand, this 25th day of August 1981.

VENN YOUNG, Minister of Forests.

[L.S.] GOD SAVE THE QUEEN!

(F.S. 6/6/7)

Vesting of Property in the Otorohanga Pest Destruction Board Amendment Order

(Notice No. 2658, Ag. 6/13/2/6A)

DAVID BEATTIE, Governor-General

ORDER IN COUNCIL

At the Government House at Wellington this 20th day of July 1981

Present:

HIS EXCELLENCY THE GOVERNOR-GENERAL IN COUNCIL

PURSUANT to section 27 (3) (c) of the Agricultural Pests Destruction Act 1967, His Excellency the Governor-General, acting by and with the advice and consent of the Executive Council, hereby makes the following order.

ORDER

1. (i) This order may be cited as the Otorohanga Pest Destruction Board Order 1981, Amendment No. 1, and shall be read together with and deemed part of the vesting of properties in the Waipa and Otorohanga Pest Destruction Board Order 1973.

(ii) This order shall come into force on the day after its notification in the *Gazette*.

2. The property described in the following Schedule is hereby vested in the Otorohanga Pest Destruction District (constituted on the 15th day of March 1971).

SCHEDULE

ALL that parcel of land vested in the Kawhia Rabbit Board, section 26, Block XI, Kawhia North Survey District Area: 3035 square metres.

P. G. MILLEN, Clerk of the Executive Council.

Directing the Sale of Land in Block XIII, Belmont Survey District, Borough of Petone

DAVID BEATTIE, Governor-General

ORDER IN COUNCIL

At the Government Buildings at Wellington this 24th day of August 1981

Present:

THE RT. HON. D. MACINTYRE PRESIDING IN COUNCIL

PURSUANT to the Public Works Act 1928, His Excellency the Governor-General, acting by and with the advice and consent of the Executive Council, hereby directs the sale of the land described in the Schedule hereto, such land being no longer required for the purposes for which it was acquired.

SCHEDULE

WELLINGTON LAND DISTRICT

ALL that piece of land containing 275 square metres, situated in Block XIII, Belmont Survey District, Borough of Petone, being Lot 2 on Land Transfer Plan 50869.

C. J. HILL, Acting for Clerk of the Executive Council.

(P.W. 51/3923; Wn. D.O. 19/2/37/0)

Extending the time within which the Commission to Inquire into the need to declare a new acclimatisation district in the Auckland region and, in particular, into the necessity or otherwise for altering the Auckland Acclimatisation District May Report

DAVID BEATTIE, Governor-General

To all whom these present shall come, and to:

EDWIN IAN ROBERTSON, C.B.E., of Tawa, formerly Director-General of the Department of Scientific and Industrial Research; and

ROY WILLIAM STEPHAN CAVANAGH, of Tauherenikau, formerly Deputy Controller of the Wildlife Service, Department of Internal Affairs; and

ARTHUR ROGER WILSON, of Waimate, Farmer, a past president of the Waitaki Valley Acclimatisation Society;

GREETING:

WHEREAS, by an instrument signed on the 26th day of May 1981*, you, the said Edwin Ian Robertson, Roy William Stephan Cavanagh, and Arthur Roger Wilson, were appointed to be a Commission to inquire into the need to declare a new acclimatisation district in the Auckland region and, in particular, into the necessity or otherwise for altering the Auckland Acclimatisation District:

And whereas by the said instrument you were required to submit your report not later than the 31st day of August 1981:

And whereas it is expedient that the time for so reporting should be extended as hereinafter provided:

Now, therefore, pursuant to the Wildlife Act 1953 and the Commissions of Inquiry Act 1908, I, The Honourable Sir David Stuart Beattie, the Governor-General of New Zealand, hereby extend until the 30th day of September 1981 the time within which you, the said Edwin Ian Robertson, Roy William Stephan Cavanagh, and Arthur Roger Wilson, are so required to report, without prejudice to the continuation of the liberty conferred upon you by the said instrument signed on the 26th day of May 1981 to report your proceedings and findings from time to time if you should judge it expedient to do so, and hereby confirm the said instrument signed on the 26th day of May 1981 and the Commission thereby constituted, save as modified by these presents.

Given under the hand of His Excellency the Governor-General this 26th day of August 1981.

D. A. HIGGET, Minister of Internal Affairs.

**Gazette*, 1981, p. 1562

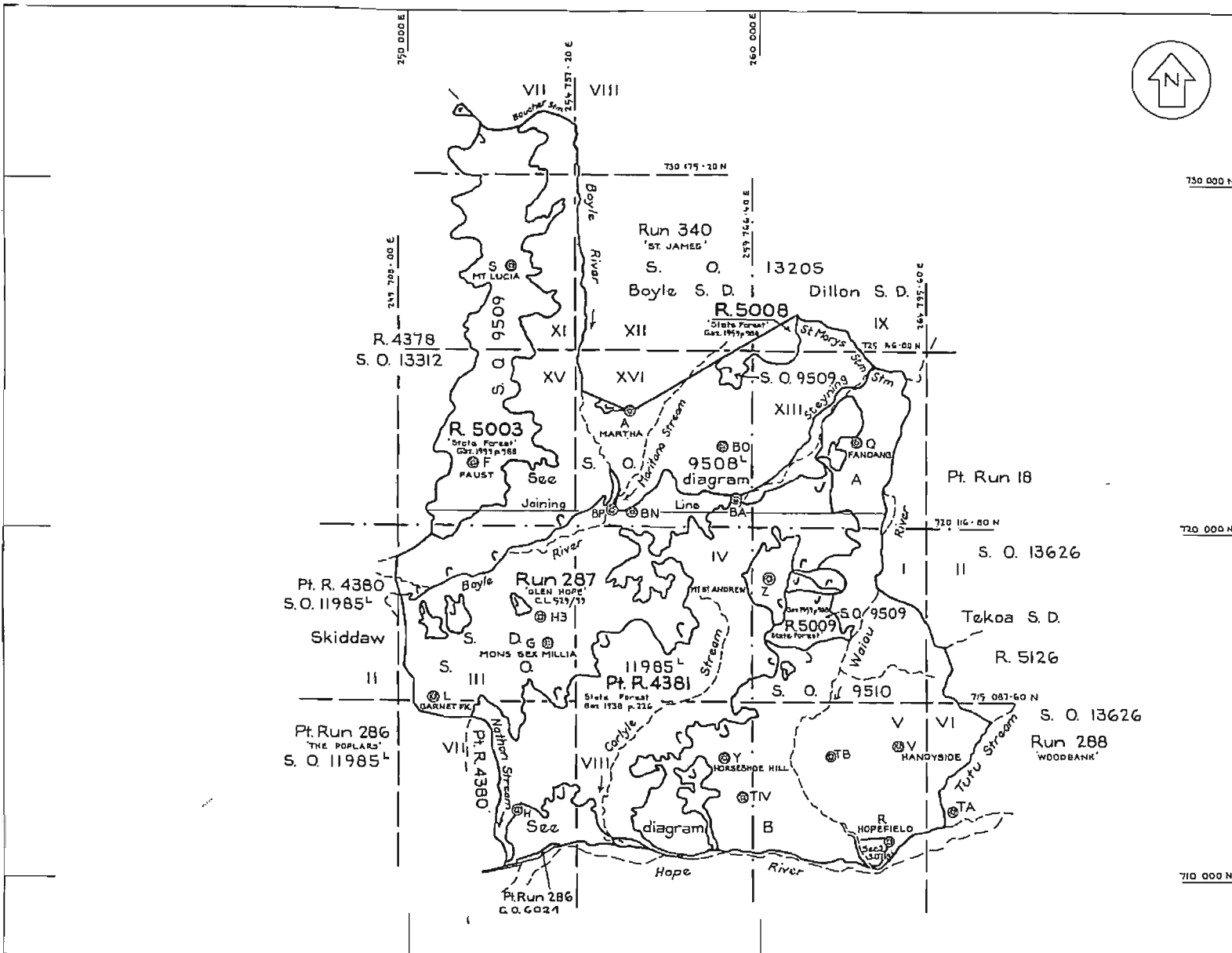

Area Schedule		
Appellation	Former Area (ha)	New Area (ha)
Run 287	10319.4639	9265.0
Pt. R. 4381	8312.2430	9118.0
R. 5003	2428.1138	2236.0
R. 5008	162.1085	219.0
R. 5009	263.0456	331.0

For boundary definition of roads and streams see sheets 2 & 3.

Run 287 is subject to Sec. 58 of the Land Act 1948 along rivers and streams over 3 metres wide.

Datum: Old Cadastral
Amuri Circuit Coordinates
Origin: Isolated Hill 700 000 mN
300 000 mE

Total Area... 21254.0 ha

Comprised in... C.L. 529/199, Gaz. 1938 p. 226
Gaz. 1959 p. 986

This plan represents the most accurate planimetric definition available at this date of the lands listed above.
Dated 14/10/1976

[Signature]
Chief Surveyor

Field Book... p. Traverse Book... p.
Reference Plans... SCL SHEETS 2, 3
Examined L. Hay... Correct *[Signature]*

Approved as to Survey
[Signature] Chief Surveyor

Deposited this... day of... 19...
District Land Registrar

LAND DISTRICT CANTERBURY
SURVEY BLK. & DIST. VII, VIII, IX, X, XI, XII, XIII, XIV, XV, XVI, BOYLE, DILLON, & 1/4 N
VII, VIII, SKIDDAW, LI, X, VI, TEKOA
NZMS 177 SHEET NO. S. 46, S. 47, S. 53 & S. 54

Run 287, Pts. R. 4381, R. 5003,
R. 5008 & R. 5009

LOCAL AUTHORITY AMURI COUNTY
Compiled in Survey Office
Scale 1:75,000 Date April, 1976

50 13986

RELEASED UNDER THE OFFICIAL INFORMATION ACT

S O 11985

S O 11985

LAKE SUMNER

Scale 1:25000

This plan represents the most accurate information available at this date of the boundaries of the lands shown herein.

[Signature]
Chief Surveyor
No. 376

Schedule

Application	Area	Area	Area	Area
D. 100	10000.00	10000.00	10000.00	10000.00
D. 100	10000.00	10000.00	10000.00	10000.00
D. 100	10000.00	10000.00	10000.00	10000.00



Section	Area	Area	Area	Area
Section 1	3600.00	3600.00	3600.00	3600.00
Section 2	3600.00	3600.00	3600.00	3600.00
Section 3	3600.00	3600.00	3600.00	3600.00
Section 4	3600.00	3600.00	3600.00	3600.00
Section 5	3600.00	3600.00	3600.00	3600.00
Section 6	3600.00	3600.00	3600.00	3600.00
Section 7	3600.00	3600.00	3600.00	3600.00
Section 8	3600.00	3600.00	3600.00	3600.00
Section 9	3600.00	3600.00	3600.00	3600.00
Section 10	3600.00	3600.00	3600.00	3600.00

S O 11985

S.

O.

11977

11985

Scale 1:25000 - 1 inch = 1 Mile Scale - 60 lines to an inch (approx.)

NOTE: This map was prepared from the original plan sheets of the Survey of the Lake Sumner area, and is not intended to be used as a basis for any other survey. It is not to be used as a basis for any other survey. It is not to be used as a basis for any other survey.

NOTE: This map was prepared from the original plan sheets of the Survey of the Lake Sumner area, and is not intended to be used as a basis for any other survey. It is not to be used as a basis for any other survey. It is not to be used as a basis for any other survey.

80 chains to an inch.
Price 4/-

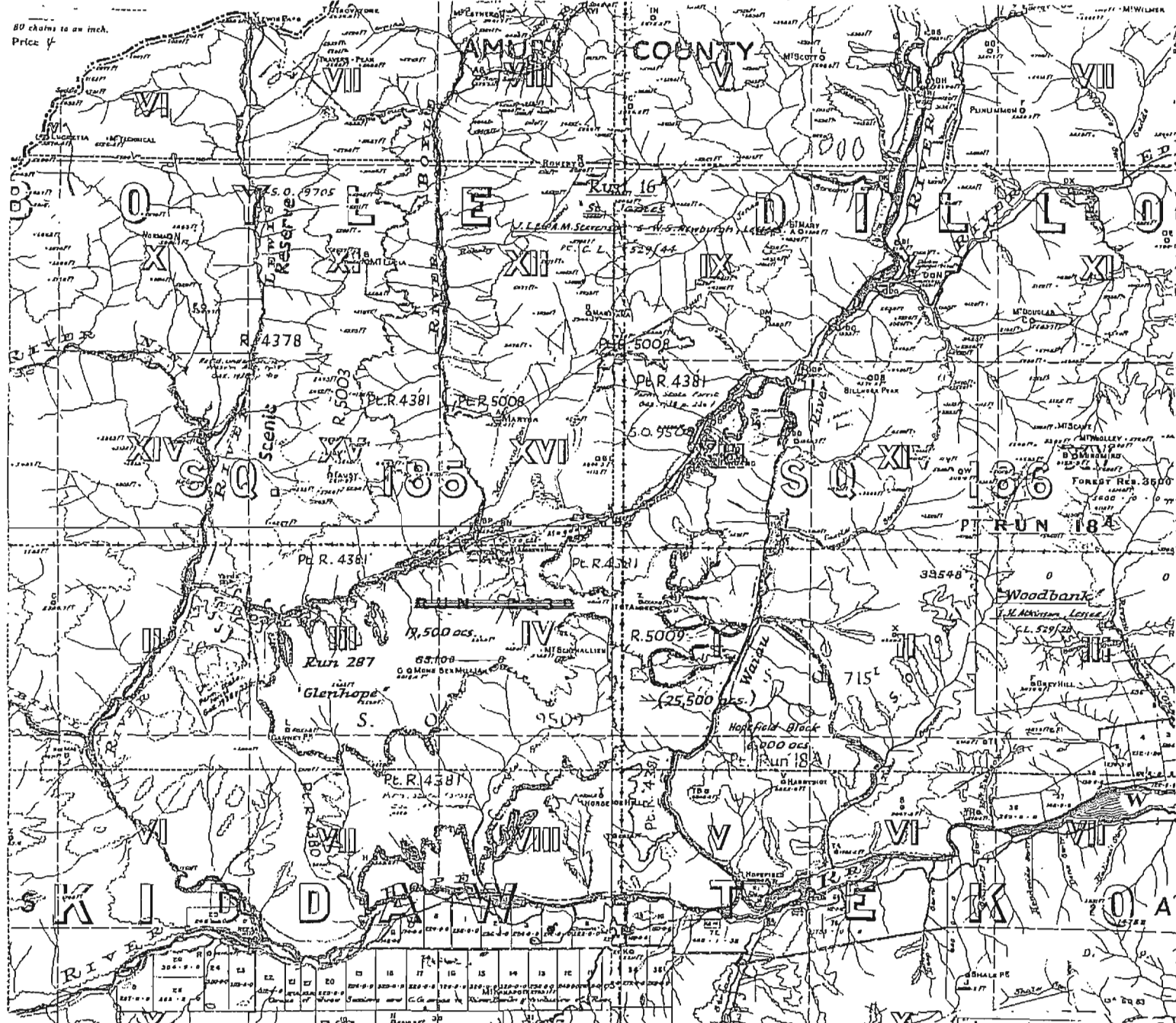

Plan of Run 287, Glenhope,
 formerly Pts. Run 233^B, Pt. Run 18^A & Pt. State Forest R. 4381,
 & Pt. Sec. 1, Block XVI Boyle S.D.
 also showing adjoining State Forest areas
 Total area of Run 287: 25,500 acs. Scale: 1 mile to an inch.

Approved as a Record
[Signature]
 Chief Surveyor
 25 13 52

9510

PLAN OF Run 287
 PREPARED BY *[Signature]*
 DATE 26.1.52
 P.R. 458
 S.O. 3508

"RELEASED UNDER THE OFFICIAL INFORMATION ACT"

CANTERBURY LAND DISTRICT

Res. 5003 - 6000 acres, State Forest Dec. 1959 p. 302
Res. 5008 - 430 acres, State Forest Dec. 1959 p. 302
Res. 5009 - 650 acres, State Forest Dec. 1959 p. 302



Approved as a Record
20/12/59

Plan of
Pt. State Forest R. 438/1 to be declared Crown Land
and added to the 'Glenhope' Run, 640 aas. []
also Rs 5003, 5008 & 5009, formerly Parts of Run 233^P, 'Glenhope';
to be declared State Forest, 7100 aas. []
Scale: 1 mile to an inch.

9509

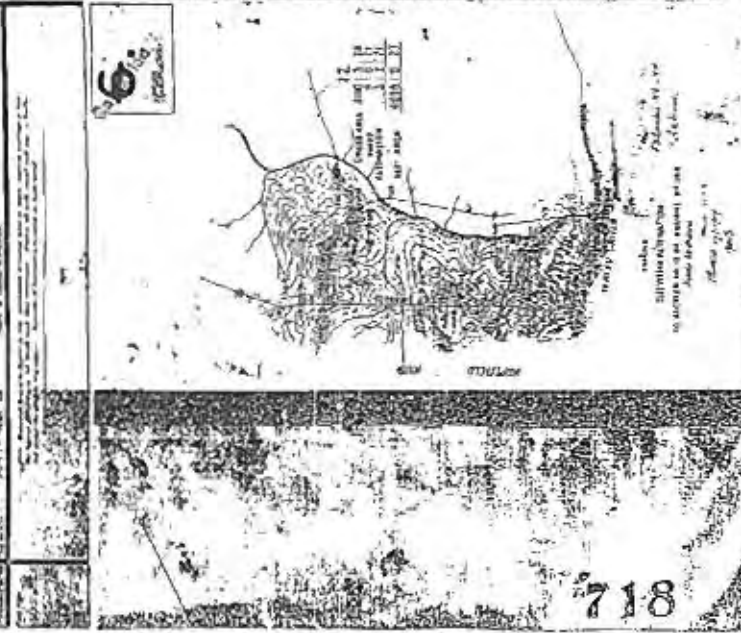
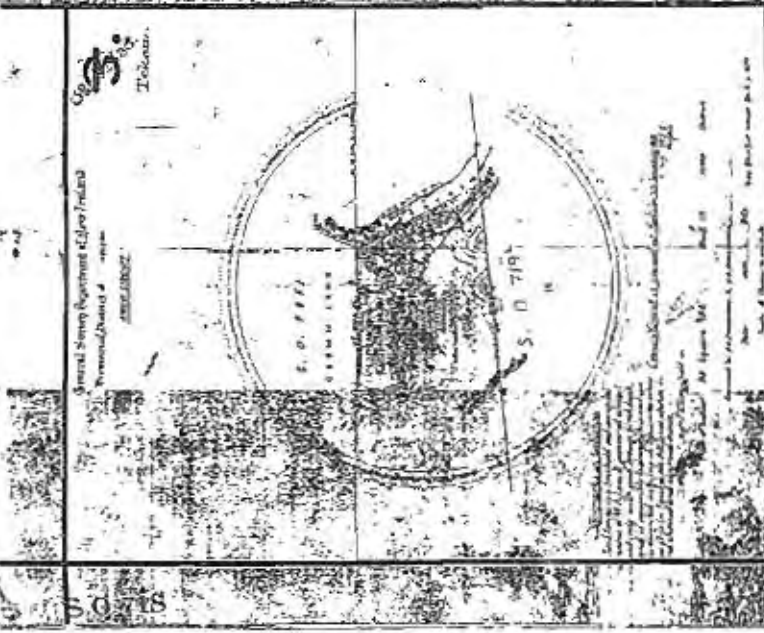
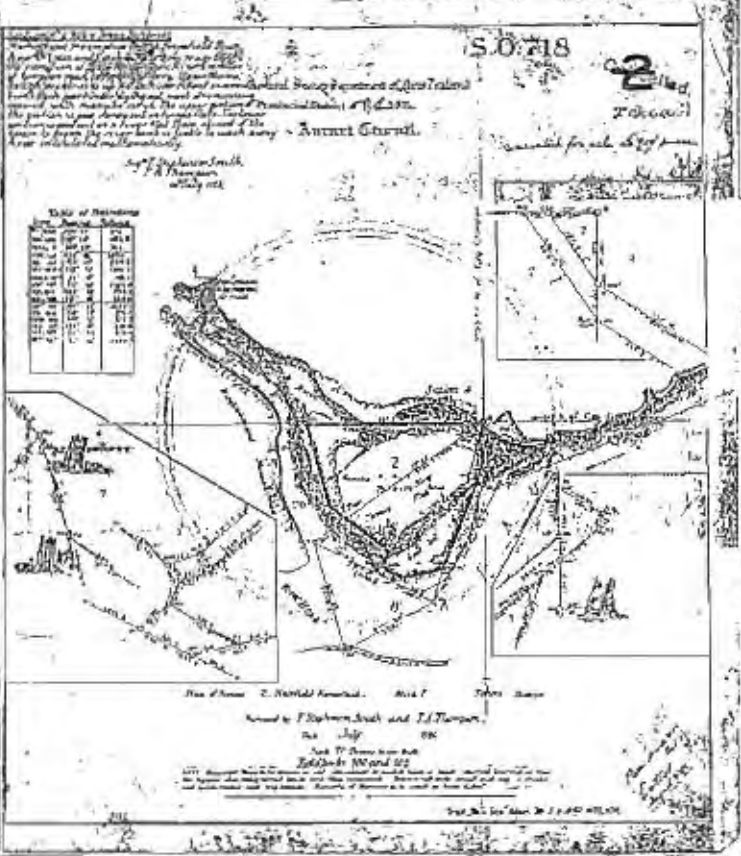
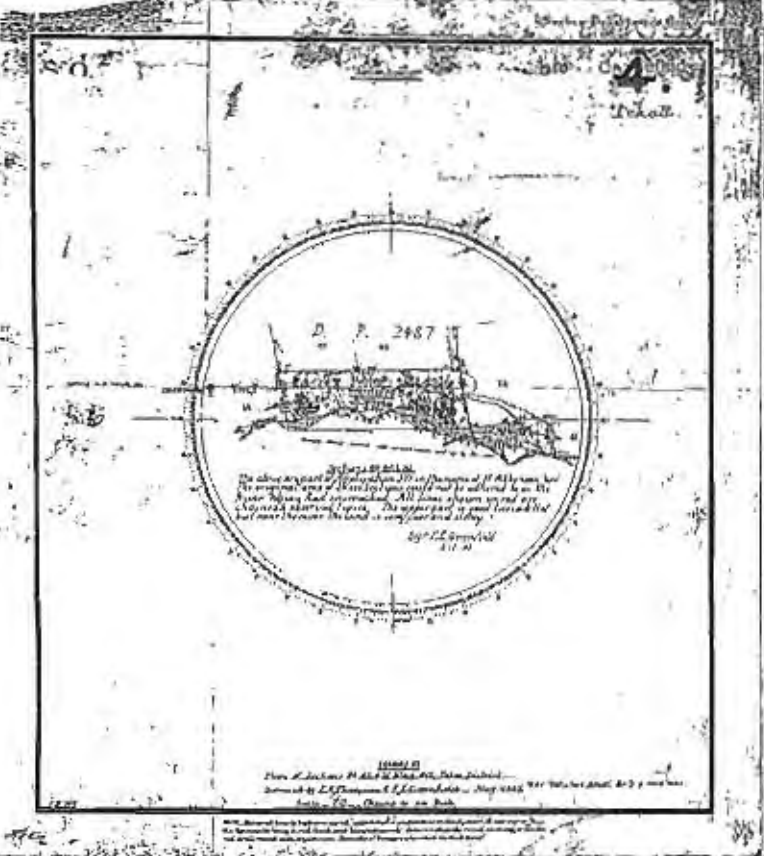

PROPERTY 4 of 4

**Appendix A - Land Status Report
(and supporting plans)**

**OPUS INTERNATIONAL CONSULTANTS LIMITED
 CHRISTCHURCH OFFICE**

APPENDIX A4

Project Number 6NL.12770.TR.

This report has been prepared on the instruction of Land information New Zealand in terms of **Contract No. 50269 (as yet undated)** and is undertaken for the purposes of the Crown Pastoral Land Act 1998.

LAND STATUS REPORT for Glenhope Tenure Review (Freehold)	LIPS Ref: Not Applicable
Property 4 of 4	

Land District	Canterbury.
Legal Description	Section 2, Block V, Tekoa Survey District.
Area	30.4171 hectares.
Status	Freehold land held by Twin Rivers Limited.
Instrument of title / lease	CT CB21F/1292.
Encumbrances	Subject to: 1) A circular area of 6.09 metres in diameter round Trig Station R together with a right of road thereto. 2) 842693 Agreement under Section 50 of the Electricity Act 1968 (vide Electricity Act 1992). 3) 481762/1 Land Improvement Agreement under Section 30(3) of the Soil Conservation and Rivers Control Act 1941.
Mineral Ownership	The Mines and Minerals are owned by the freehold owners.
Statute	Not applicable.

Data Correct as at	1 November 31 2001
---------------------------	--------------------

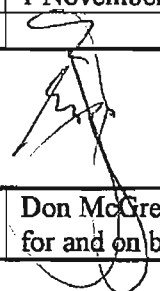

Prepared by Crown Accredited Supplier	Don McGregor, McGregor Property Services Limited, Christchurch for and on behalf of Opus International Consultants Limited
--	---

LAND STATUS REPORT for Glenhope Tenure Review (Freehold)	LIPS Ref Not Applicable
Property 4 of 4	

Research Data: Some Items may not be applicable

SDI Print Obtained	Yes.
NZMS 261 Ref	M 32.
Local Authority	Hurunui District Council
Crown Acquisition Map	SO 718 (No 2).
SO Plans	SO 718 (No 2) – Plan of Section 2, Hopefield Homestead Block V, Tekoa Survey District (1882).
Relevant Gazette Notices	Not applicable.
CT Ref / Lease Ref	CT CB21F/1292.
Legalisation Cards	Not applicable.
CLR	Not Crown land.
Allocation Maps (if applicable)	Not applicable.
VNZ Ref – if known	Not known.
Crown Grant Maps	Warrant 35 PR 1512 - SO 718 (No 2) Plan of Section 2, Hopefield Homestead Block V, Tekoa Survey District (1882).
If Subject Land Marginal Strip: a) Type [Sec 24(9) or Sec 58] b) Date Created c) Plan Reference	a) Not applicable. b) Not applicable. c) Not applicable.
If Crown land – Check Irrigation Maps	Not Applicable.
Mining Maps	Not Applicable.
If Road a) Is it created on a Block Plan – Section 43(1)(d) Transit NZ 1989 b) By Proc c) Gazette Ref	a) Not applicable. b) Proc Plan Not applicable. c) Gazette Ref Not applicable.
Other relevant information a) Concessions – Advice from DOC or Knight Frank.	a) Not applicable.

b) Subject to any provisions of the Ngai Tahu Claims Settlement Act 1998	b) Not applicable.
c) Mineral Ownership	c) Remains with CT CB21F/1292.
d) Other Info	d) Not applicable.

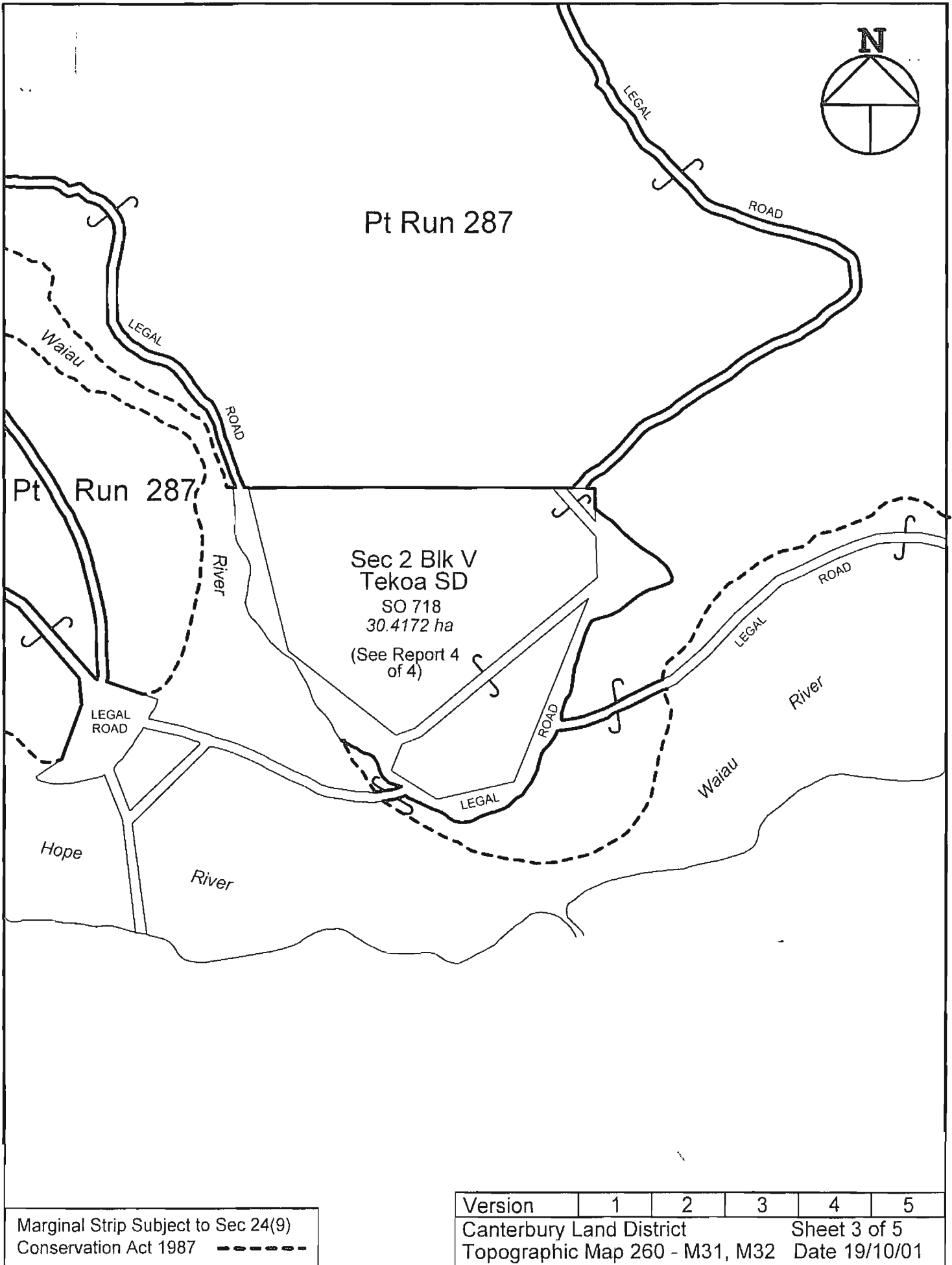

Marginal Strip Subject to Sec 24(9)
Conservation Act 1987 - - - - -

Version	1	2	3	4	5
Canterbury Land District					Sheet 3 of 5
Topographic Map 260 - M31, M32					Date 19/10/01

Glenhope

Scale 1:10000

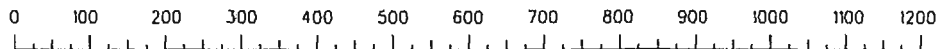

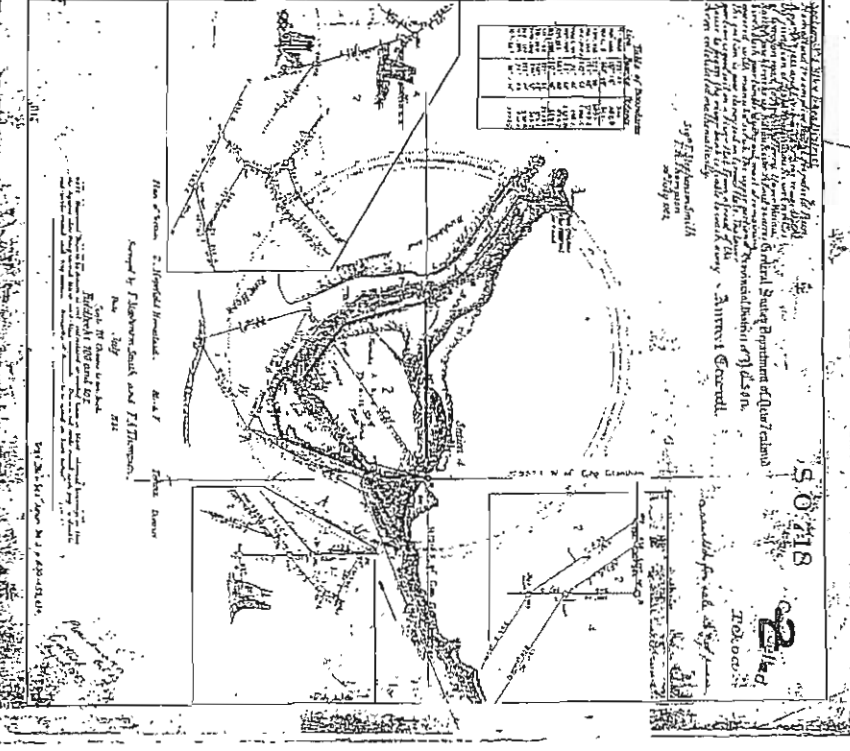
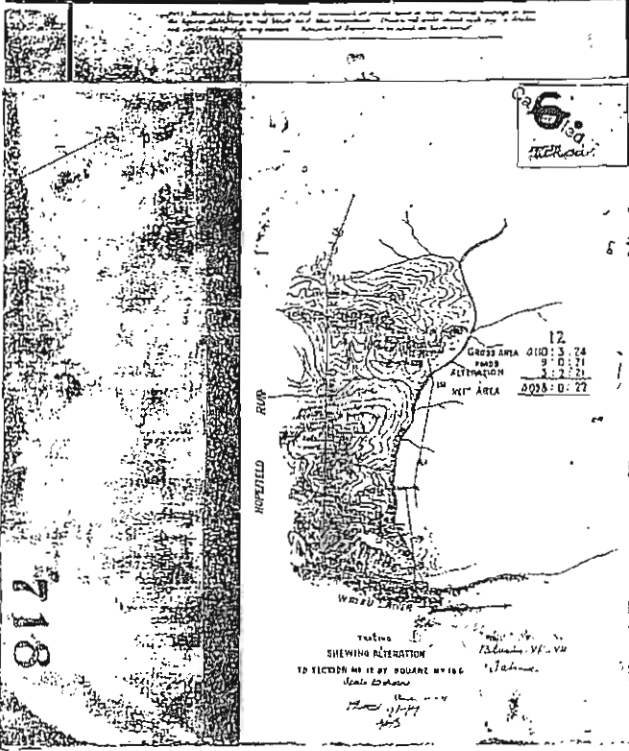
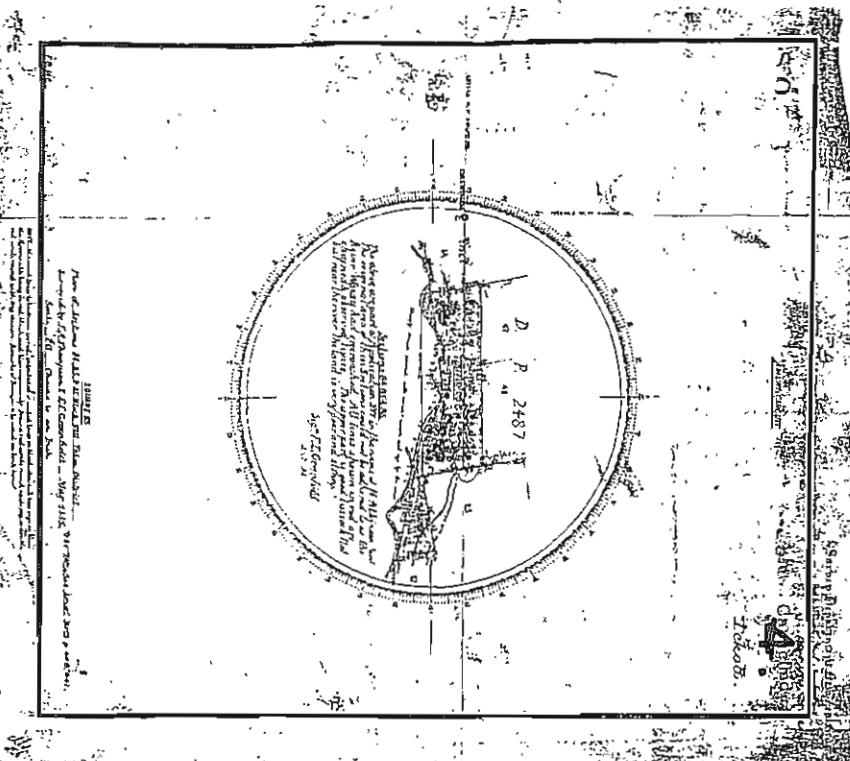
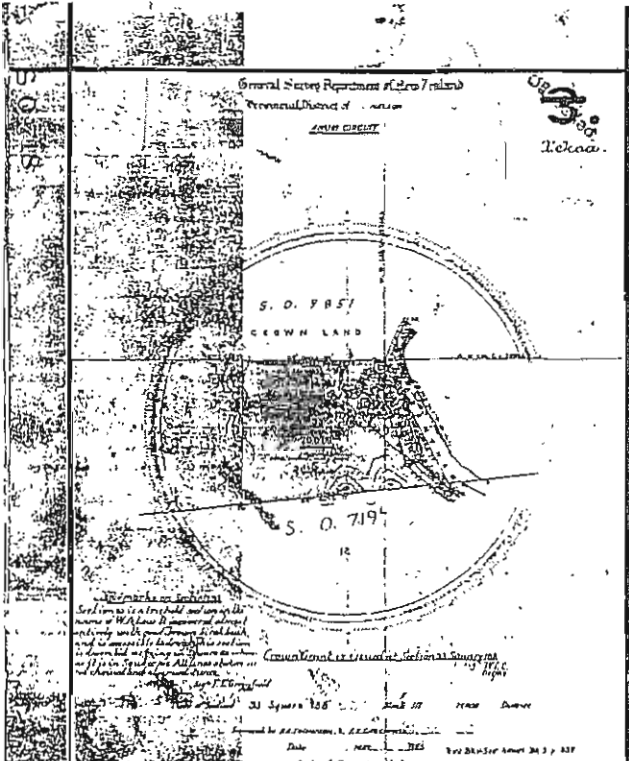



COMPUTER FREEHOLD REGISTER UNDER LAND TRANSFER ACT 1952



Historical Search Copy

R.W. Muir
Registrar-General
of Land

Identifier CB21F/1292
Land Registration District Canterbury
Date Issued 12 September 1980

Prior References

CBAM 11/245

Estate Fee Simple
Area 30.4171 hectares more or less
Legal Description Section 2 Block V Tekoa Survey District
Original Proprietors
Twin Rivers Limited

Interests

Subject however to a circular area of 6.09 metres in diameter round Trig.Station R together with a right of road thereto.
842693 Electricity Agreement pursuant to Section 50 Electricity Act 1968 - 10.9.1971 at 12.18 pm
481762.1 Land Improvement Agreement pursuant to Section 30(3) Soil Conservation and Rivers Control Act 1941 -
29.3.1984 at 11.10 am
A384767.4 Mortgage to Bank of New Zealand - 24.12.1998 at 12.47 pm

No. ZIF / 1292

References

Prior C/T 11/245 (Amuri)

Land and Deeds 69



REGISTER

Transfer No.

N/C. Order No. 290863/1-8.9.1980

CERTIFICATE OF TITLE UNDER LAND TRANSFER ACT

This Certificate dated the 12th day of September one thousand nine hundred and eighty under the seal of the District Land Registrar of the Land Registration District of CANTERBURY

WITNESSETH that GRAHAM JAMES HEWETT of Cheviot, Farmer and MARION JANET HEWETT his wife are

is seized of an estate in fee-simple (subject to such reservations, restrictions, encumbrances, liens, and interests as are notified by memorial underwritten or endorsed hereon) in the land hereinafter described, delineated with bold black lines on the plan hereon, be the several admeasurements a little more or less, that is to say: All that parcel of land containing 30.4171 hectares or thereabouts being Section 2 Block V Tekoa Survey District subject however to a circular area of 6.09 metres in diameter round Trig. Station R together with a right of road thereto

DISTRICT LAND REGISTRAR
[Signature]
for Assistant Land Registrar
CANTERBURY

Subject to:

(i) 842693 Agreement under Section 50 of the Electricity Act 1968 - 10.9.1971 at 12.18 pm.

Mortgage 292970/1 to *[illegible]* Limited - 22-9-1980 at 10.12 am

(ii) Mortgage 291790/3 to The National Bank of New Zealand Limited - 12.9.1980 at 9.46 am.

Mortgage 333699/1 to *[illegible]* Nominees Limited - 1981 at 9.19 a.m. 831016

DISCHARGED 27 OCT 1989
[Signature]
for A.L.R.

DISCHARGED 26 OCT 1989
[Signature]
for A.L.R.

No.333699/4 Memorandum of Priority making Mortgages 333699/1, 291790/3 and 292970/1 first, second and third mortgages respectively - 8.7.1981 at 9.20 a.m.

[Signature]
for A.L.R.

Mortgage 368222/1 to *[illegible]* Banking and Finance Corporation - 1982 at 11.12 am.

DISCHARGED 26 OCT 1989
[Signature]
for A.L.R.

Mortgage 368222/2 to *[illegible]* Banking and Finance Corporation - 1982 at 11.12 am. 834715

DISCHARGED 26 OCT 1989
[Signature]
for A.L.R.

No.368222/3 Memorandum of Priority making mortgages 333699/1, 292970/1, 368222/1, 368222/2 and 291790/3 as first, second, third and fourth and fifth mortgages respectively - 15.2.1982 at 11.12 am.

[Signature]
For A.L.R.

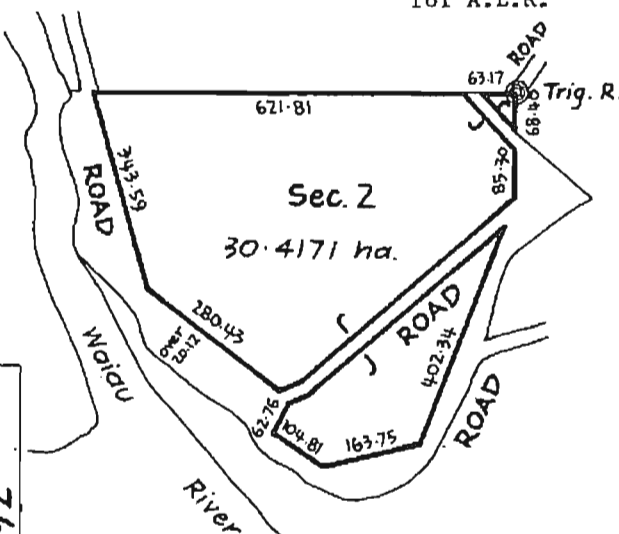

Measurements are Metric
S.O. 718

No. ZIF / 1292

[Handwritten initials]

CERTIFICATE OF TITLE No. 21F / 1292

Mortgage 368222/4 to The Rural Banking and Finance Corporation Limited - 13.10.1982 at 11.12 am.

DISCHARGED
14 DEC 1981
12.1.1983

Mortgage A53489/4 to Trust Bank Canterbury Limited - 27.5.1993 at 12.00pm

DISCHARGED
13.10.1993
Col-Judy
for A.L.R.

Variation of Mortgage 368222/1 - 21.1.1983 at 11.12 am.

DISCHARGED
for A.L.R.

A384767.3 Transfer to Twin Rivers Limited

A384767.4 Mortgage to Bank of New Zealand

all 24.12.1998 at 12.47

Variation of Mortgage 368222/1 - 9.2.1984 at 11.41 am.

DISCHARGED
Inouison
for A.L.R.

Christina
for DLR

No. 481762/1 Land Improvement Agreement under Section 30 (3) of the Soil Conservation and Rivers Control Act 1941 - 29.3.1984 at 11.10 a.m.

for A.L.R.

Variation of Mortgage 368222/2- 10.8.1984 at 11.52am.

DISCHARGED
for A.L.R.

Variation of Mortgage 333699/1- 10.8.1984 at 11.52am.

DISCHARGED
for A.L.R.

Variation of Mortgage 333699/1 - 16.9.1987 at 11.30am.

for A.L.R.

Mortgage 745272/1 to The Rural Banking and Finance Corporation of New Zealand - 9.6.1988 at 9.39am

DISCHARGED
26 OCT 1988
for A.L.R.

No. 745272/3 Memorandum of Priority making Mortgages 745272/1 and 291790/3 fifth and sixth mortgages respectively - 9.6.1988 at 9.39am

for A.L.R.

Transfer 840618/1 to Graham James Hewett of Cheviot, Farmer and Marion Janet Hewett his wife as tenants in common in equal shares - 29.11.1989 at 11.51am

for A.L.R.

Transfer A53489/3 to Roderick Hugh Hendry Milne and Charlotte Patricia Milne both of Kaikoura, Farmers - 27.5.1993 at 12.00pm

Col-Judy
for A.L.R.



