

Crown Pastoral Land Tenure Review

Lease name : Mt NICHOLAS STATION

Lease number : PS 046

Due Diligence Report (including Status Report) - Part 3

This report and attachments results from a pre-Tenure Review assessment of the pastoral lease for the purpose of confirming land available for Tenure Review and any issues, rights or obligations attaching to it. The information is gathered from files and other sources available to the LINZ contractor.

Part of the information relates to research on the status of the land, resulting in a Status Report that is signed off by a LINZ approving officer. The remainder of the information is not analysed for relevancy or possible action until required, and LINZ does not guarantee its accuracy or completeness as presented.

The report attached is released under the Official Information Act 1982.

June 09

"RELEASED UNDER THE OFFICIAL INFORMATION ACT"

RELEASED UNDER THE OFFICIAL INFORMATION ACT

Mortgage 158118 of Section 350A to The State Advances Corporation of New Zealand 5.8.1958 at 2.30 o'clock.

116270.1 Transfer of a one half share to Mary Metherell of Elfin Bay Married Woman 8.3.1985 at 9.10 a.m.

Mortgage 158306 of Section 350A to State Advances Corporation of New Zealand 14.8.1958 at 3 o'clock.

155236.2 Mortgage to Rural Banking and Finance Corporation of New Zealand - 12.9.1988 at 9.05 a.m.

Caveat 224412 against Run 567 by the State Advances Corporation of New Zealand 18.12.1967 at 2.20 o'clock.

234407 Certificate by Commissioner of Crown Lands incorporating part Run 568 Blks XII & XIII Von District and Blk IV Mavora Survey District shown on Plan 2 hereon in the within lease altering the annual rent to \$ 204.00 9.6.1969 at 11am.

174304.1 Mortgage to Rural Banking and Finance Corporation of New Zealand Limited 5.7.1990 at 9.05 a.m.

Variation of Mortgage 158118. 24.6.1969 at 11 a.m.

174304.2 Memorandum of Priority making Mortgages 174304.1 and 155236.2 fourth and fifth mortgages respectively - 7.5.1990 at 9.05 a.m.

Variation of Mortgage 158306. 24.6.1969 at 11 a.m.

234796 Mortgage to the State Advances Corporation of New Zealand 24.6.1969 at 11 a.m.

200400.1 Case for Majesty the Queen - 1.12.1988 at 9.17 a.m.

234797 Mortgage to the State Advances Corporation of New Zealand 24.6.1969 at 11 a.m.

249038 Certificate redefining the boundary of the within lease with Pastoral Lease 206/47. 10.2.1971 at 1.45pm.

201555.2 Certificate vesting mortgage 234796 in Rural Banking and Finance Corporation of New Zealand Limited - 4.9.1992 at 11.45 a.m.

The Part Run 568 herein is now known as Run 644 Mavora District See Appellation 253753 20.8.1971.

201555.4 Certificate vesting mortgage 158118 in Rural Banking and Finance Corporation of New Zealand Limited - 4.9.1992 at 11.45 a.m.

024869.1 Mortgage to Rural Banking and Finance Corporation of New Zealand 7.6.1977 at 2.29 p.m.

192820.1 Change of Name of the mortgagee in mortgages 234796, 158118, 024869.1, 155236.2 and 174304.1 to the Rural Bank Limited - 21.12.1990 at 11.29 a.m.

066000.1 Variation of Mortgage 024869.1 3.2.1981 at 9.42 a.m.

074262.1 Variation of mortgage 024869.1 16.9.1981 at 10.13 a.m.

077194.1 Variation of Mortgage 024869.1 30.11.1981 at 9.54 a.m.

201555.7 Transfer to Her Majesty the Queen - 4.9.1992 at 11.45 a.m.

083105.1 Mortgage to Rural Banking and Finance Corporation of New Zealand 1985.5.1982 at 9.12 a.m.

258221.1 Surrender of the within Lease - 9.6.1998 at 9.00

8

LAND & DEEDS	
Nature:	<i>Leasehold Lease</i>
Firm:	<i>CCL</i>
13 JUN 1966	
Time:	<i>10.48</i>
Fee: \$	<i>1</i>
Abstract No.	<i>17317</i>



CDE S15 - Request Manual Copy		X	
Document Type	Instrument	Request Id	45387
Reference Number	NA 134040.1	User Id	jkirkdu
Land District	Southland	Request Date	08/03/2002 14:59:10
Method of Delivery	Fax	Client Reference	GNLITR.02/526YD
Requested By	JOHN KIRK	Status	Pending
<input type="checkbox"/> Certified Copy			
Comments	MT NICHOLAS - NEW APPELATIONS		
Delivery Details			
Firm	Opus International Consultants Ltd (Dunedin)		
Primary Contact	Mr Robin Whelan		
Street	Private Bag 1913		
Town	Dunedin		
Country	New Zealand		
Postcode			
Fax Number	03 474 8995		
Fees...	OK	Cancel	

ALTERATION OF APPELLATION

Lessee/Licensee: _____

Description of Land: Section 1, BIK VII, Van Survey District, Section 1 & 2, BIK VIII, Van Survey District and Sections 4, 5, 6, 7, BIK XV, Mid-Wakatipu Survey District. Area: 54.7800 ha

Rating Authorities: Lake County

Valuation Department Assessment Reference: _____

(S.O. 10900)

Full Details of Alteration

Section 1, BIK VII, Van Survey District, formerly Pt Run 630 situated in BIK VII, Van Survey District. Area = 11.830 ha

Section 1, BIK VIII, Van Survey District, formerly Pt Run 630 situated in BIK VIII, Van Survey District. Area = 11.030 ha

Section 2, BIK VIII, Van Survey District, formerly Pt Run 630 situated in BIK VIII, Van Survey District. Area = 13.7800 ha

Section 4, BIK XV, Mid-Wakatipu Survey District, formerly Pt Run 630 situated in BIK XV, Mid-Wakatipu Survey District. Area = 6.1400

Section 5, BIK XV, Mid-Wakatipu Survey District, formerly Pt Run 630 situated in BIK XV, Mid-Wakatipu S.D. Area = 9.7600 ha

Reason and Authority for Alteration

Area to be surrendered from Mt Nicholas Run 630 (SO 2413)
RB 20/1/47

J 13 No. _____

Prepared by: AMC/req / 1/10/86 Checked by: KK/req / 11/10/86

ACTION REQUIRED:

LEASES SEC.:

- G. 13 / /
- C.L. Regr. / /
- Expiry Book / /
- Interest Review / /
- Register / /

ACCOUNTS DIV.:

- Ledgers: / /
- C./register: / /
- Land A/c. / /
- Index: / /
- A/c's. Check: / /

TITLES SEC.:

- Documents: / /
- Insurance: / /

RECORDS SEC.:

- File / /
- Index / /

ACTION CHECKED: / /

ALTERATION

Lessee/Licensee: _____

Description of Land: _____

Area: _____

Rating Authorities: _____

Valuation Department Assessment Reference: _____

Full Details of Alteration

Section 6, Blk XV, Mid-Wakatipu Survey District, formerly Pt Run 630 situated in Blk XV, Mid Wakatipu Survey Dist. Area = 740 m²

Section 7, Blk XV, Mid-Wakatipu Survey District, formerly Pt Run 630 situated in Blk XV, Mid Wakatipu SD. Area = 2.1660

D.L.R. Advised

5010900.

Reason and Authority for Alteration

J 13 No. _____

Prepared by: _____ / _____ / _____ Checked by: _____ / _____ / _____

ACTION REQUIRED:

LEASES SEC.:	ACCOUNTS DIV.:	TITLES SEC.:	RECORDS SEC.:
G. 13 / / .	Ledgers: / / .	Documents: / / .	File / / .
C.L. Regr. / / .	C./register: / / .	Insurance: / / .	Index / / .
Expiry Book: / / .	Land A/c. / / .		
Interest Review / / .	Index: / / .		
Register / / .	A/c's. Check: / / .		
	ACTION CHECKED: / / .		

ORDER FOR NEW CERTIFICATE
OF TITLE

REFERENCE:

Vol _____ Folio _____

Referred to Draughtsman. / 19

Returned from Draughtsman. / 19

MWP_0015860



11.36 01.OCT.86 134040.1
PARTICULARS ENTERED IN REGISTER
LAND REGISTRY SOUTH ISLAND
ASST. LAND REGISTRAR
206/47
W. S. H. [Signature]
SOUTH ISLAND

This pastoral Lease Sec 50 12218

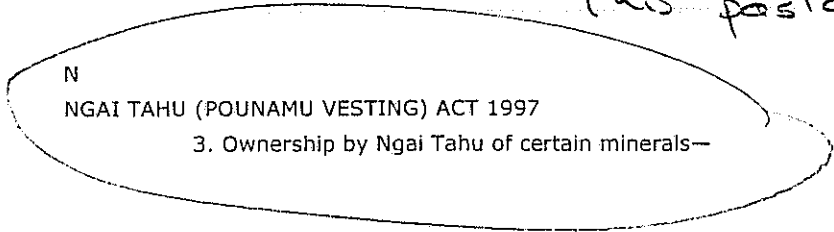

- PRINT
- EMAIL
- BOOKMARK

3. Ownership by Ngai Tahu of certain minerals—

Updater	Case Law	Analysis
---------	----------	----------

Notwithstanding any other enactment, all pounamu occurring in its natural condition in—

- (a) The Takiwa of Ngai Tahu Whanui; and
- (b) Those parts of the territorial sea of New Zealand (as defined by section 3 of the Territorial Sea, Contiguous Zone, and Exclusive Economic Zone Act 1977) that are adjacent to the Takiwa of Ngai Tahu Whanui and the seabed and subsoil beneath those parts of the territorial sea—

that, immediately before the commencement of this Act, is the property of the Crown, ceases, on the commencement of this Act, to be the property of the Crown and vests in and becomes the property of Te Runanga o Ngai Tahu.

4. Existing privileges for pounamu—

Updater	Case Law	Analysis
---------	----------	----------

- (1) Nothing in section 3 affects an existing privilege or the rights or obligations of any holder of an existing privilege and Part II of the Crown Minerals Act 1991 continues to apply in relation to that privilege as if this Act had not been passed.
- (2) Notwithstanding anything in the Crown Minerals Act 1991, all royalties paid to the Crown after the commencement of this Act by the holder of any existing privilege in respect of pounamu must be paid by the Crown to Te Runanga o Ngai Tahu.

5. Applications for mining privileges and permits for pounamu—

Updater	Case Law	Analysis
---------	----------	----------

Notwithstanding anything in the Crown Minerals Act 1991, the Minister of Energy must not grant any—

- (a) Permit pursuant to an application made under section 23 of that Act before the commencement of this Act; or
- (b) Mining privilege pursuant to an application to which section 112 of that Act applies—

in respect of any pounamu to which section 3 applies.

SCHEDULE

Updater	Analysis
---------	----------

Section 2

DESCRIPTION OF LAND IN WHICH SERPENTINE INCLUDED

The areas marked "A" and "B" respectively on Survey Office Plan 12458 lodged in the office of the Chief Surveyor of the Westland Land District which plan is also lodged in the office of the Chief Surveyor of the Otago Land District as Survey Office Plan 24619 and in the office of the Chief Surveyor of the Southland Land District as Survey Office Plan 12218.

The area marked "C" on Survey Office Plan 12457 lodged in the office of the Chief Surveyor of the Westland Land District.

This Act is administered in the Ministry of Commerce

NGAI TAHU (TUTAEPATU LAGOON VESTING) ACT 1998

Updater

1998 No 16

An Act to give effect to certain provisions of the Deed of 'On Account' Settlement, signed on 14 June 1996 by the Crown and by Te Runanga o Ngai Tahu as representative of Ngai Tahu,—

- (a) By vesting Tutaepatu Lagoon in Te Runanga o Ngai Tahu; and
- (b) By providing for the establishment of a recreation reserve at Woodend

[14 May 1998

ANALYSIS (List of Sections)

1. Short Title and commencement

2. Preliminary

3. Act to bind the Crown

Tutaepatu Lagoon

4. Reservation of Tutaepatu Lagoon as reserve revoked

5. Declaration of Tutaepatu Lagoon as wildlife refuge revoked

6. Vesting of Tutaepatu Lagoon in Te Runanga o Ngai Tahu

7. Management of Tutaepatu Lagoon

8. Tutaepatu Lagoon subject to walkway

9. Issue of certificate of title for Tutaepatu Lagoon

Establishment of Trust

10. Establishment of trust

New Reserve

11. Declaration of recreation reserve

"RELEASED UNDER THE OFFICIAL INFORMATION ACT"
RELEASED UNDER THE OFFICIAL INFORMATION ACT

Adjoining Land

ATTACHMENT 10.5

DEED OF COVENANT TO PROTECT BEECH FOREST REMNANTS

Clause 10.5.1(d)

Date:

BETWEEN

- (1) TE RUNANGA O NGAI TAHU (*the Landholder*)
- (2) THE MINISTER OF CONSERVATION (*the Minister*)

BACKGROUND

A The Landholder and the Crown are parties to a Deed of Settlement dated [] 1997.

B Pursuant to that Deed, the Crown agreed to transfer to the Landholder certain land including the Land, such transfer to be subject to the Landholder entering into a deed of covenant with the Minister providing for certain measures to protect the Beech Forest Remnants.

C Under section [] of the Ngai Tahu Claims Settlement Act 1997, this covenant is deemed to have been entered into by the Minister pursuant to section 77 of the Reserves Act 1977, and therefore binds future owners of the Land.

NOW THEREFORE the parties agree as follows:

1 DEFINITIONS AND INTERPRETATION

1.1 In this deed, unless the context otherwise requires:

Beech Forest Remnants means the areas of beech forest on any part of the Land which are 5 hectares or more in area at the date of this Deed which are identified as "Bush Remnant Areas" on the plans attached as an Appendix to this Deed;

Crown means Her Majesty the Queen in right of New Zealand;

Land means [legal description of Elfin Bay lake face, Greenstone lake face and Routeburn Dart faces to be inserted].

1.2 In the interpretation of this Deed, unless the context otherwise requires:

1.2.1 headings appear as a matter of convenience and are not to affect the interpretation of this Deed;

1.2.2 the singular includes the plural and vice versa, and words importing one gender include the other genders;

1.2.3 a reference to an enactment or any regulations is a reference to that enactment or those regulations as amended, or to any enactment or regulations substituted for that enactment or those regulations but this provision shall be read subject to *clause 1.3*;

1.2.4 a reference to a party to this Deed or any other document or agreement includes that party's successors, heirs, executors and assigns;

1.2.5 a reference to the Minister includes any officer or duly authorised agent of the Minister; and

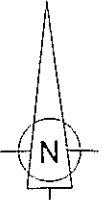

Lake Rere reserve

Elfin Bay

Lake Wakatipu

Black Gorge

Legend

 Bush Remnant Area

Scale of Original 1:50000

0 1 2 3 4 5 6 7 8 km

Southland & Otago Land Districts

Territorial Authority: Queenstown Lakes Dist.

Terralink NZ Ltd

Survey Services
Invercargill



Bush Remnants – Elfin Bay Station

Areas referred to in the Deed of Settlement for the
Ngai Tahu Claim

Approved as to boundaries:

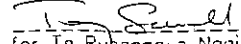
 21/11/97
for Te Rubangano Ngai Tahu

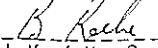
 21/11/97
on behalf of the Crown

HC 522

0.0000

0 links

[Redacted]

36219.3647800

.0000000 36219.3648 ha

[Redacted]

0.00 acres

Mt Nicholas Area Calc

To + and -
Areas.

36124.3090
40.2760
11.8300
11.0300
13.7800
6.1400
9.7600
0.0740
2.1660
-0.2273
36219.1377

Pt Run 630 SO 11859
 Sec 1 Blk XV Mavora SD
 Sec 1 Blk VII Von SD
 Sec 1 Blk VIII Von SD
 Sec 2 Blk VIII Von SD
 Sec 4 Blk XV Mid-Wakatipu SD
 Sec 5 Blk XV Mid-Wakatipu SD
 Sec 6 Blk XV Mid-Wakatipu SD
 Sec 7 Blk XV Mid-Wakatipu SD
 A on SO 12103

CDE_S15 - Request Manual Copy		X	
Document Type	Instrument	Request Id	45397
Reference Number	249038	User Id	jkirkdu
Land District	Southland	Request Date	08/03/2002 15:09:23
Method of Delivery	Fax	Client Reference	SNLITR.02/526YD
Requested By	JOHN KIRK	Status	Pending
	<input type="checkbox"/> Certified Copy		
Comments	MT NICHOLAS - CERTIFICATE REDEFINING THE BOUNDARY OF THE LEASE		
Delivery Details			
Firm	Opus International Consultants Ltd (Dunedin)		
Primary Contact	Mr Robin Whelan		
Street	Private Bag 1913		
Town	Dunedin		
Country	New Zealand		
Postcode			
Fax Number	03 474 8995		
Fees...	OK	Cancel	

PRODUCED by the
STATE ADVANCES CORPORATION
of **NEW ZEALAND**

(Invercargill Branch)
for the purpose of enabling registration of the undermentioned dealing :

For Lands & Survey
To register a line-alignment
of boundaries

PLEASE RETURN to Corporation after such registration or if documents not lodged by 7/3/1971

Industrious Ltd
For the STATE ADVANCES CORPORATION

C. S. W. Ltd 6424n 15m-10/69

7/1/1971

CERTIFICATE OF REDEFINITION

In the Matter of the Land Act 1948
and

In the Matter of a pastoral lease
from Her Majesty the Queen to
Mount Nicholas Station Limited
registered in Volume 206 folio 47
Southland Land Registry

and

In the Matter of a pastoral lease
from Her Majesty the Queen to
Robert James Metherell of Elfin Bay,
sheep farmer, registered as B3/614
Southland Land Registry

PLAN "A"

Redefinition survey of the Boundary Between
Mount Nicholas and Elfin Bay Stations

This is to certify that the boundary redefinition shown on Plan "A" endorsed hereon has been obtained from topographical surveys made by radial line plots during 1969 by the Department of Lands and Survey from aerial photographs taken in 1967.

This plan represents the most accurate planimetric definition available at this date of the boundary (bordered green and marked X - Y on the said plan) shown in Registers Volume 206 folio 47 and B3/614.

As witness my hand this 15th day of December 1970.

M. W. Armstrong
Chief Surveyor

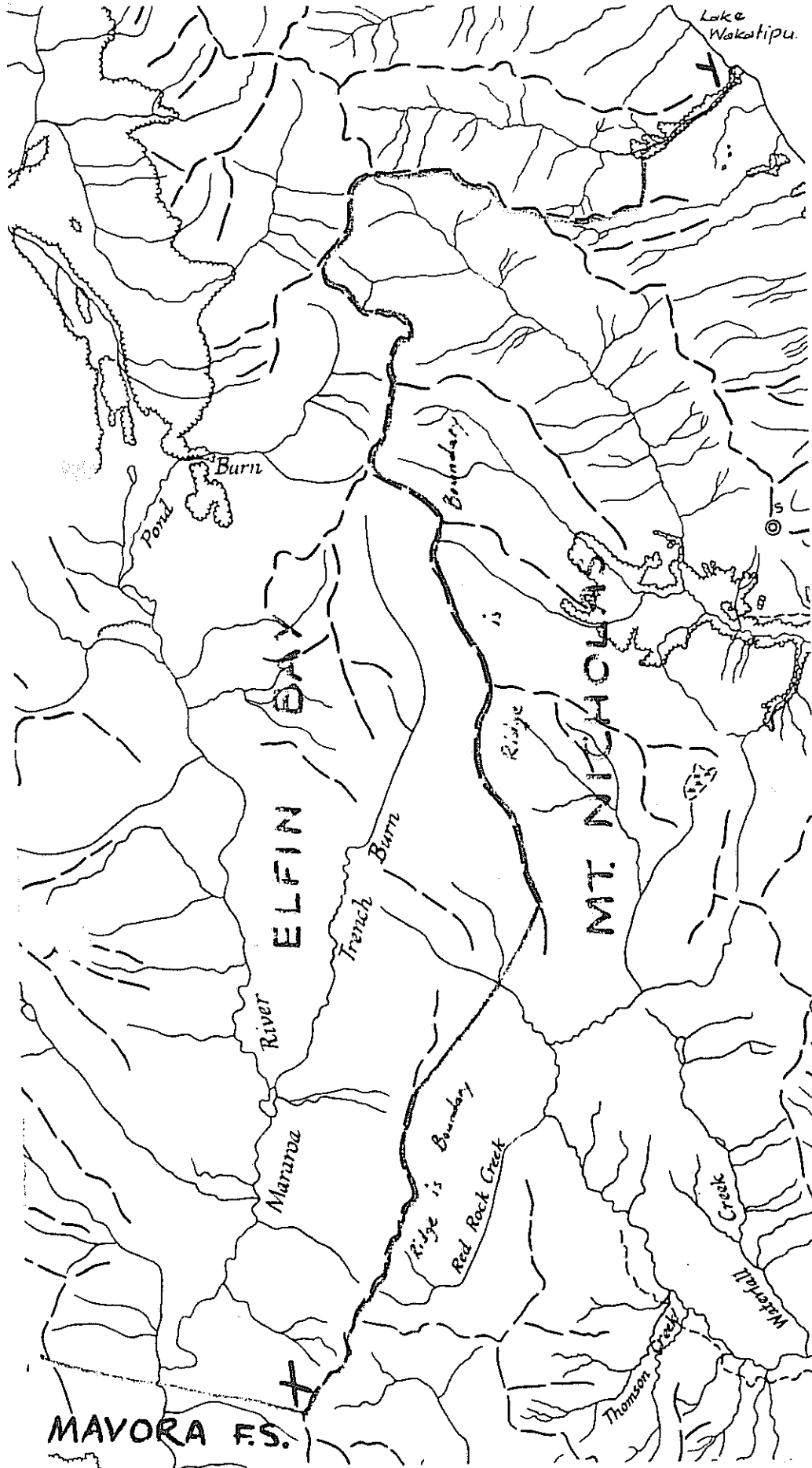

MAVORA F.S.

249000

CERTIFICATE OF REDEFINITION

Particulars entered in the Register-book

Vol. 206 folio 47,B3/614

the 10 day of February, 19 71
1.45 o'clock

District Land Registrar,
SOUTHLAND

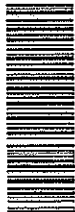

MWP_0015864



Not Registered under Land Transfer
Act, 1948
Registered under Section 83

LANE & WATTS
10 FEB 1971
Abstract No. 212

Department of Lands & Survey

TELEGRAPHIC ADDRESS: 'LANDS'

FOR VERBAL INQUIRIES
PLEASE ASK FOR MR

Freeman

TELEPHONE No. 87-334



OUR REFERENCE: 3/156/2

YOUR REFERENCE:

DISTRICT OFFICE,
P.O. BOX 826,
INVERCARGILL

15 December 1970

District Land Registrar,
Land Registry,
INVERCARGILL.

Redefinition of Boundaries
Mount Nicholas Station and Elfin Bay Station

I enclose herewith a Certificate of Redefinition signed by the Chief Surveyor.

The boundary line X - Y has been agreed and a copy of the plan initialled by both the lessees and in addition I have obtained the consent of Wright Stephenson Farmers Finance and Investment Company Limited as to C.T. 206/47 and the State Advances Corporation of New Zealand and James Gillespie as to C.T. B3/614 respectively.

Please register the Certificate of Redefinition.

J.A.S. Shaw
J.A.S. SHAW

Asst Commissioner of Crown Lands

Encl.

*Case: 3/156/2
to C.C.L. also 3/156/2*

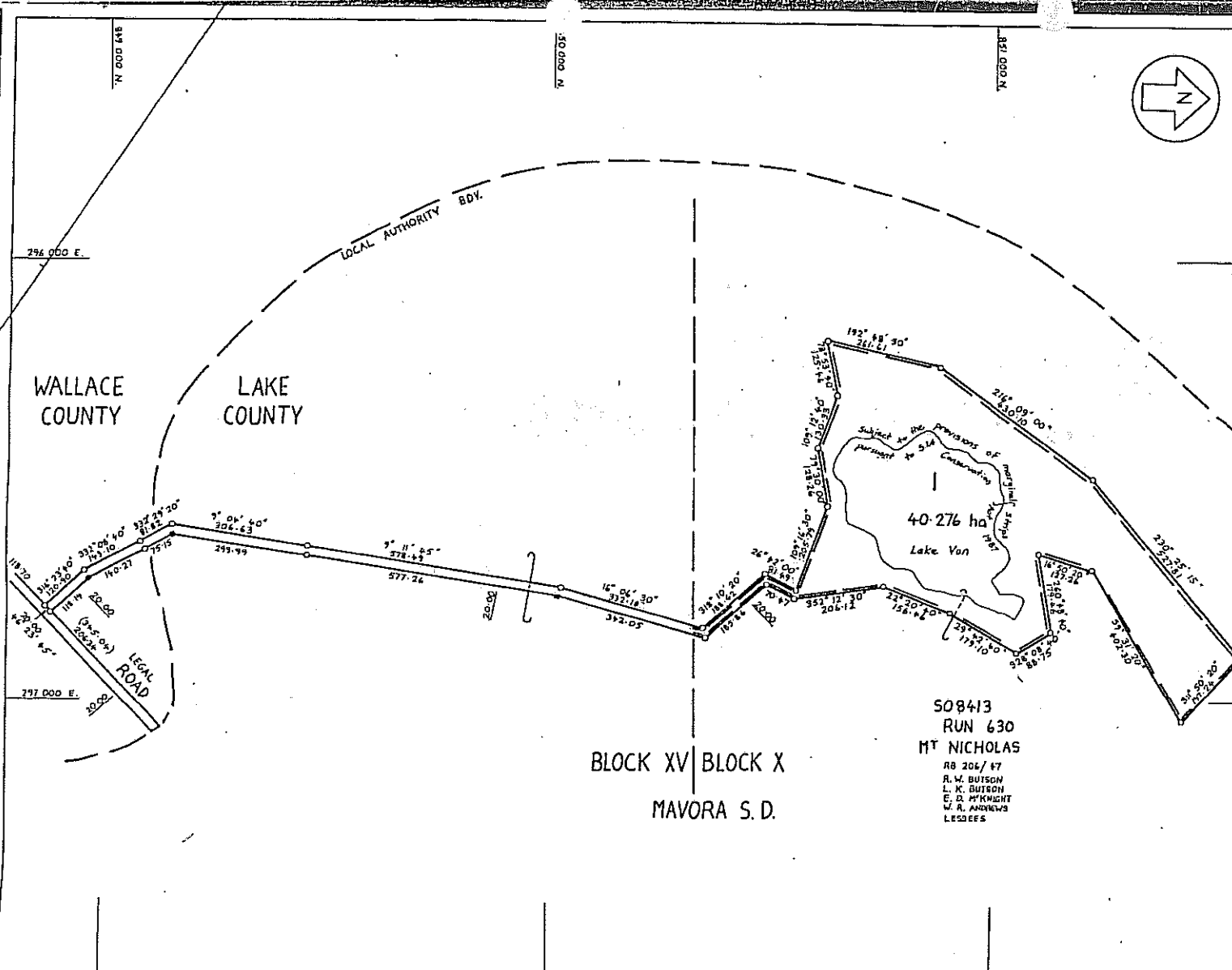

Approvals
 APPROVAL OF OWNER
 [Signature]
 COMMISSIONER OF CROWN LAND 23.5.86

Lake Van subject to the provisions of marginal strips pursuant to Section 24 Conservation Act 1987 on renewal of Pastoral Lease 206/47.

28/18/86 [Signature]
 Chief Surveyor

Total Area 40.276 ha.

Comprised in RB 206/47

I GEOFFREY GODDARD WELLS
 Registered Surveyor and holder of an annual practicing certificate for who may act as a registered surveyor pursuant to the proviso to section 13(2) of the Surveyors Act 1950 hereby certify that the plan has been made from surveys executed by me or under my direction, that both plan and survey are correct and have been made in accordance with the Survey Regulations 1972.

Dated at INVERCAROLL the 23RD day of MAY 1986 Signature *G. Weller*

Field Book 1933 p. 7-20 Traverse Book 126, 41-47 Reference Plans 80° 8113, 9137

Examined Correct *[Signature]*

Approved us to Survey

217/86 [Signature]
 Chief Surveyor

Deposited this day of 19

District Land Registrar

File 47/26
 Retained 20-5-86 R.L.L.
 Instructions 86/180 SQ 10833

LAND DISTRICT SOUTHLAND
 SURVEY BLK. & DIST. XV. MAVORA S.D.
 NZMS 261 SH1 E42 RECORD MAP No 721

SECTION 1

TERRITORIAL AUTHORITY WALLACE & LAKE COUNTY
 Surveyed by G. G. WELLER
 Scale 1 : 6000 Date MAY 1986

508413
 RUN 630
 MT NICHOLAS
 RB 206/47
 R. W. BUTSON
 L. K. BUTSON
 E. D. MCKNIGHT
 W. A. ANDREWS
 LESSEES

"RELEASED UNDER THE OFFICIAL INFORMATION ACT"

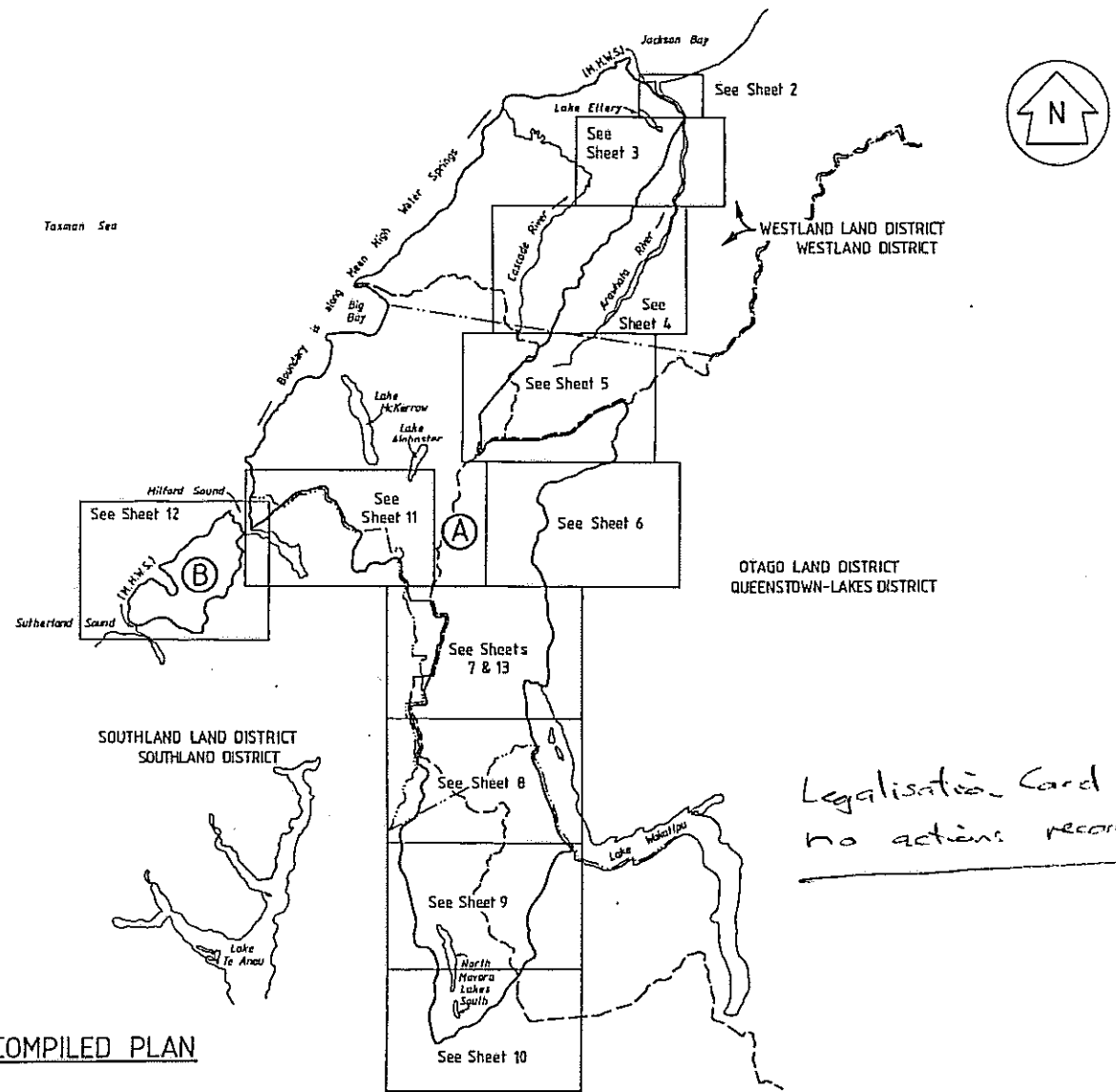

Notes -
 The coastal boundary is M.H.W.S. except where it crosses the mouths of rivers, streams, inlets and estuaries by right line.
 ----- indicates Territorial Authority
 indicates Land District Bdy.

SCHEDULE	
SHOWN	DESCRIPTION
(A)	SITUATED IN WESTLAND, OTAGO AND SOUTHLAND, LAND DISTRICTS.
(B)	SITUATED IN SOUTHLAND LAND DISTRICT.

Total Area _____

Comprised in _____

I, Registered Surveyor and holder of an assumed practicing certificate for whom may act as a registered surveyor pursuant to section 25 of the Survey Act 1980 hereby certify that the plan has been made from surveys executed by me or under my direction, that both plan and survey are correct and have been made in accordance with the Survey Regulations 1977 or any regulations made in substitution thereof.

Dated at _____ this _____ day of _____ 19 _____

Full Book _____ p. Traverse Book _____ p.

Reference Plans _____

Examined _____ Correct

Approved for Parliamentary Purposes

21.7.196 _____ CHIEF SURVEYOR Westland L.D.

21.7.196 _____ CHIEF SURVEYOR Otago L.D.

21.7.196 _____ CHIEF SURVEYOR Southland L.D.

Fm 4925/01 Westland L.D. S.O. 12406

Revised Otago L.D. S.O. 24429

Instructions 831424 Southland L.D. S.O. 12165

Legalisation Card
 no actions recorded.

LAND DISTRICT Westland, Otago, Southland...
 Survey Blk. & Dist. _____
 NZMS 261 Sheet _____ Record Map No. _____

Areas of Serpentine occurring in its natural condition
 in association with Nephrite and Bowenite.

TERRITORIAL AUTHORITY Westland District
 Southland District and
 Otago L.D. District
 Prepared by Department of Survey & Land Information
 Scale 1:500,000 Date October 1993

RELEASED UNDER THE OFFICIAL INFORMATION ACT

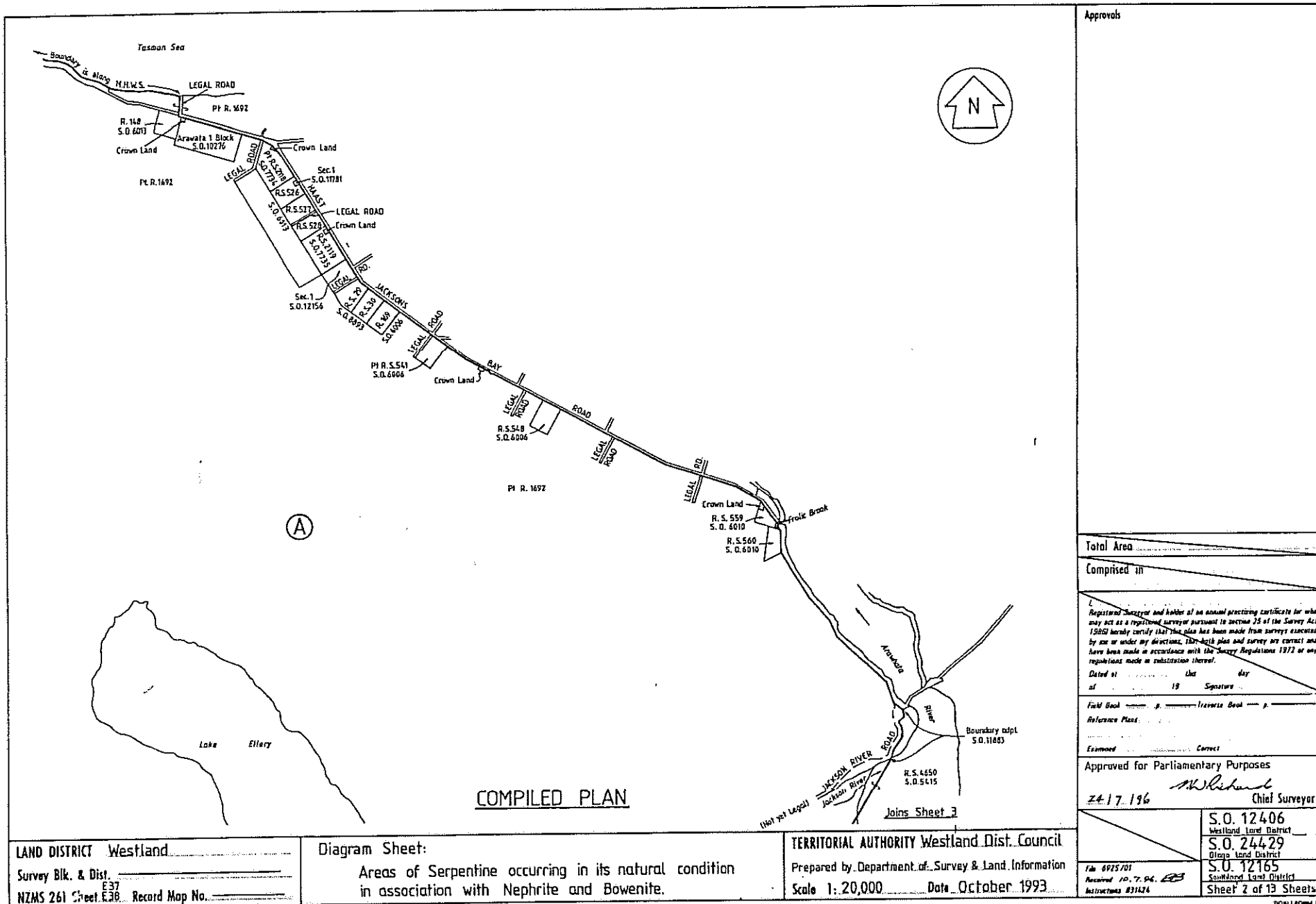

Approvals

Total Area _____
 Comprised in _____

I, Registered Surveyor and holder of an annual practicing certificate for who may act as a registered surveyor pursuant to section 25 of the Survey Act 1980 hereby certify that this plan has been made from surveys executed by me or under my directions, that both plan and survey are correct and have been made in accordance with the Survey Regulations 1972 or any regulations made in substitution thereof.

Dated at _____ the _____ day of _____ 19____ Signature _____

Field Book _____ p. _____ Traverse Book _____ p. _____

Reference Plans _____

Examined _____ Correct

Approved for Parliamentary Purposes
24 17 1996 *M. Williams* Chief Surveyor

S.O. 12406
 Westland Land District
 S.O. 24429
 Otago Land District
 S.O. 12165
 Southland Land District
 Sheet 2 of 13 Sheets

File 6925/01
 Received 10.7.96
 Instructions 8312/4

LAND DISTRICT Westland
 Survey Blk. & Dist. _____
 NZMS 261 Sheet E37 Record Map No. _____

Diagram Sheet:
 Areas of Serpentine occurring in its natural condition in association with Nephrite and Bowenite.

TERRITORIAL AUTHORITY Westland Dist. Council
 Prepared by Department of Survey & Land Information
 Scale 1:20,000 Date October 1993

"RELEASED UNDER THE OFFICIAL INFORMATION ACT"

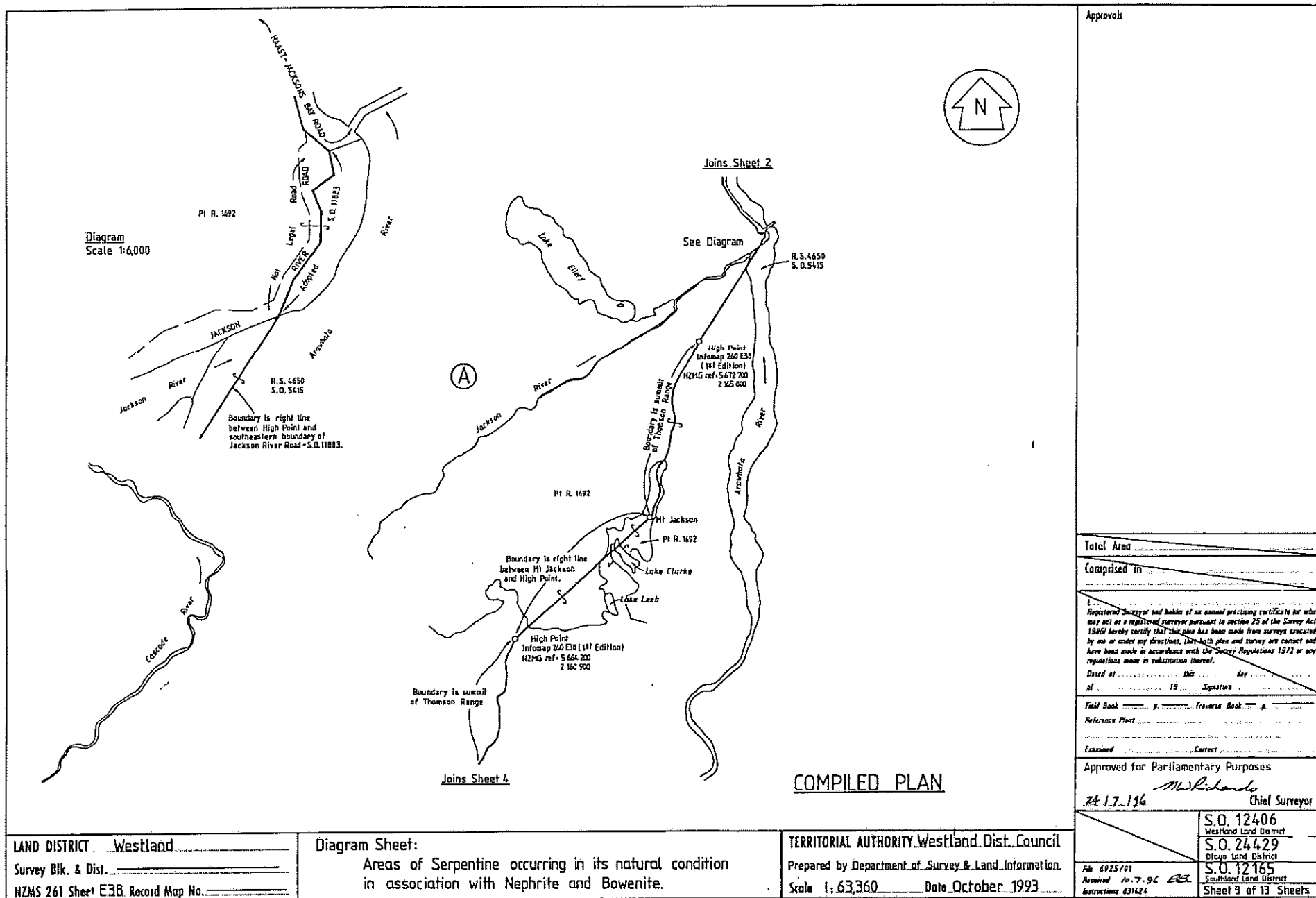

Approvals

Total Area _____
 Comprised in _____
 Registered Surveyor and holder of an annual practicing certificate for who may act as a registered surveyor pursuant to section 25 of the Survey Act 1986 hereby certify that this plan has been made from surveys executed by me or under my direction, that this plan and survey are correct and have been made in accordance with the Survey Regulations 1972 or any regulations made in substitution thereof.
 Dated at _____ this _____ day _____
 of _____ 19 _____
 Signature _____

Field Book _____ p. _____ Traverse Book _____ p. _____
 Reference Plans _____
 Examined _____ Correct _____

Approved for Parliamentary Purposes
 24.17.196 _____ Chief Surveyor

S.O. 12406
 Westland Land District
 S.O. 24429
 Otago Land District
 S.O. 12165
 Southland Land District
 Sheet 9 of 13 Sheets

LAND DISTRICT Westland
 Survey Blk. & Dist. _____
 NZMS 261 Sheet E36 Record Map No. _____

Diagram Sheet:
 Areas of Serpentine occurring in its natural condition
 in association with Nephrite and Bowenite.

TERRITORIAL AUTHORITY Westland Dist. Council
 Prepared by Department of Survey & Land Information
 Scale 1:63,360 Date October 1993

"RELEASED UNDER THE OFFICIAL INFORMATION ACT"

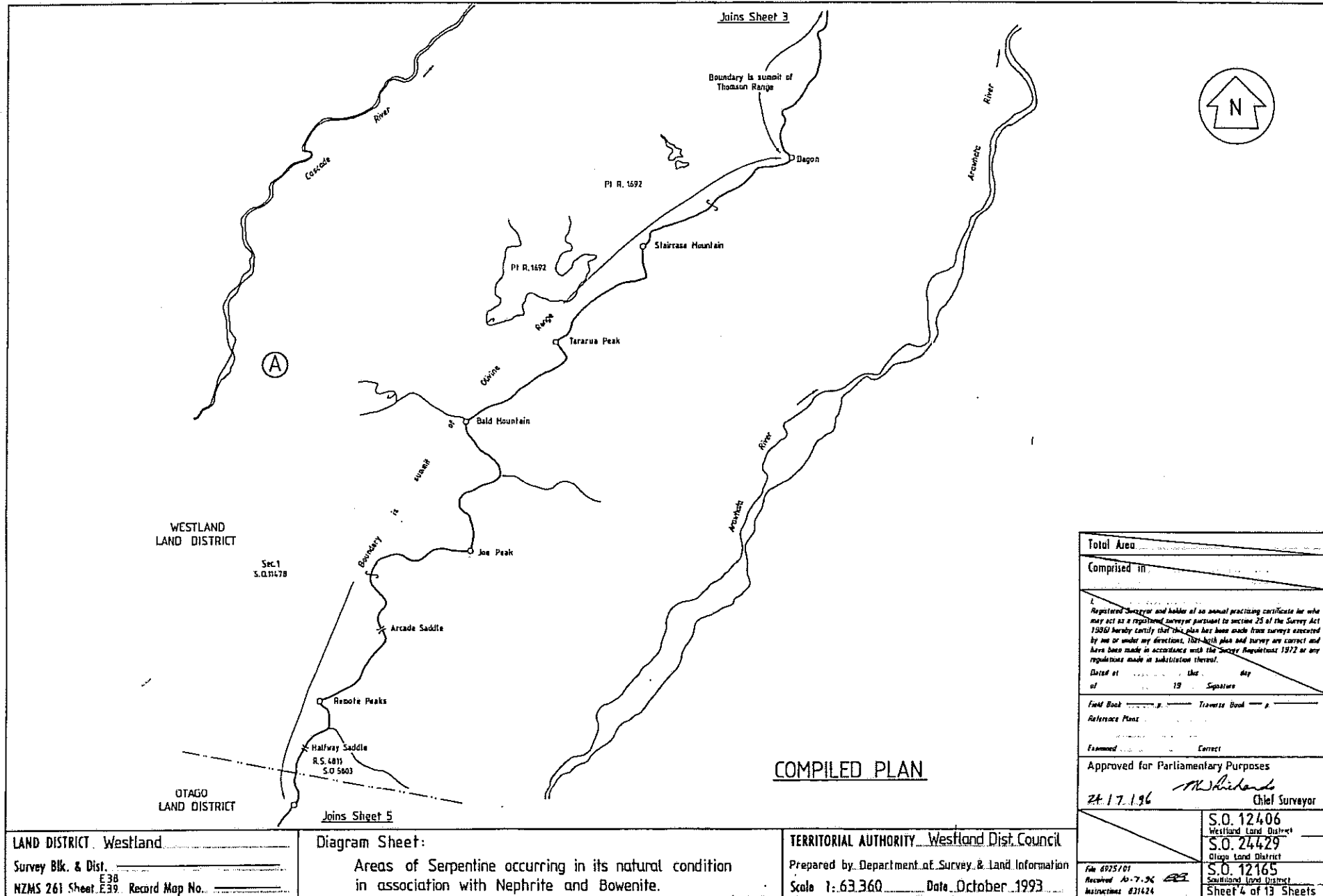

Total Area	
Comprised in	
<p><i>Registered Surveyor and holder of an annual practicing certificate for who may act as a registered surveyor pursuant to section 25 of the Survey Act 1980 hereby certify that this plan has been made from surveys executed by me or under my directions, that both plan and survey are correct and have been made in accordance with the Survey Regulations 1977 or any regulations made in substitution thereof.</i></p>	
Date of	Day
of	19
Field Book	Traverse Book
Reference Plans	
Examined	Correct
Approved for Parliamentary Purposes	
24/17/96	Chief Surveyor
S.O. 12406	Westland Land District
S.O. 24429	Otago Land District
S.O. 42165	Southern Land District
File 6925/01	Received 10-7-96
Instructions 831424	Sheet 4 of 13 Sheets

LAND DISTRICT Westland
 Survey Blk. & Dist. _____
 E38
 NZMS 261 Sheet E39 Record Map No. _____

Diagram Sheet:
 Areas of Serpentine occurring in its natural condition
 in association with Nephrite and Bowenite.

TERRITORIAL AUTHORITY Westland Dist Council
 Prepared by Department of Survey & Land Information
 Scale 1:63,360 Date October 1993

"RELEASED UNDER THE OFFICIAL INFORMATION ACT"

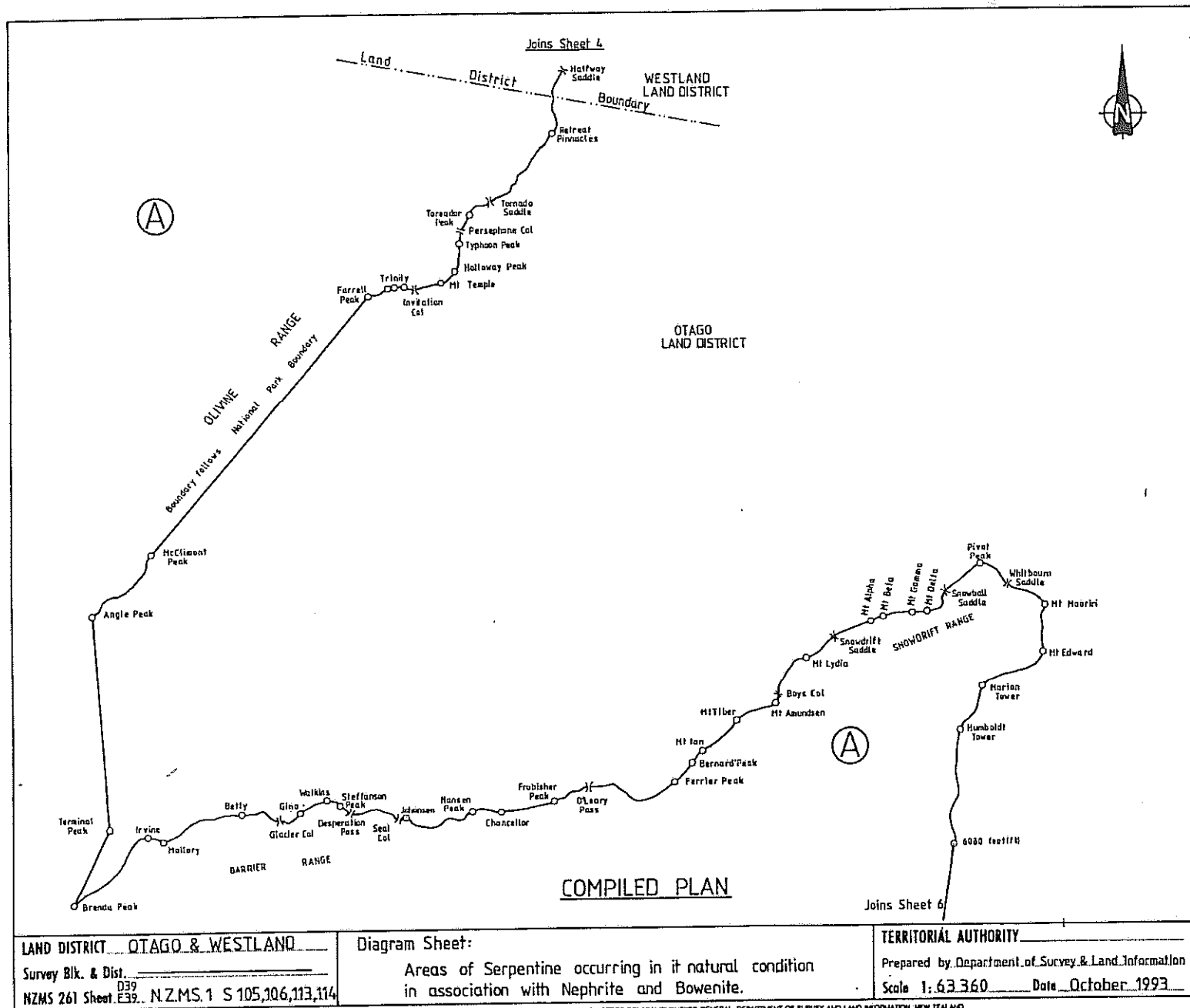

Approvals

BOUNDARY DETAILS.
 Unless otherwise stated, the boundary follows along the summit of:

- (a) the Olivine Range between Halfway Saddle and Farrell Peak, (then by right-line between Farrell Peak and McClimont Peak as described in Gaz 1964 p2305) between McClimont Peak and Angle Peak, all more particularly shown on SO 23070.
- (b) by a right line from Angle Peak to Terminal Peak and from Terminal Peak to Brenda Peak situated on the Barrier Range.
- (c) the Barrier and Snowdrift Ranges between Brenda Peak and the 6080 ft mark shown on NZMS 1 S122 (2nd edition) south of Humboldt Tower.
- (d) by a right line south from the 6080 ft mark to Mt Cunningham on the Forbes Mountains as shown on sheet 6.

BOUNDARY DETAILS SOURCED FROM

NZMS 1 sheets	S 105	2nd edition
	S 106	2nd edition
	S 113	1st edition
	S 114	2nd edition

unless otherwise shown.

Total Area.....

Comprised in.....

Registered Surveyor and holder of an annual practicing certificate for who may act as a registered surveyor pursuant to section 25 of the Survey Act 1966 hereby certify that this plan has been made from surveys conducted by me or under my direction, that this plan and survey are correct and have been made in accordance with the Survey Regulations 1972 or any regulations made in substitution thereof.

Dated at this day
 of 19..... Signature.....

Field Book p. Traverse Book p.

Reference Plans.....

Examined..... Correct

Approved for parliamentary purposes
 20.1.7.1966 *[Signature]*
 Chief Surveyor

LAND DISTRICT <u>OTAGO & WESTLAND</u>	Diagram Sheet:	TERRITORIAL AUTHORITY
Survey Blk. & Dist. <u>D39</u>	Areas of Serpentine occurring in it natural condition in association with Nephrite and Bowenite.	Prepared by Department of Survey & Land Information
NZMS 261 Sheet <u>E39. N.Z.M.S. 1 S105,106,113,114</u>		Scale <u>1:63,360</u> Date <u>October 1993</u>
		File <u>8975/01</u>
		Revised Instructions
		S.O. 12406 Westland Land District
		S.O. 24429 Otago Land District
		S.O. 12165 Southland Land District
		Sheet 5 of 13 Sheets

"RELEASED UNDER THE OFFICIAL INFORMATION ACT"

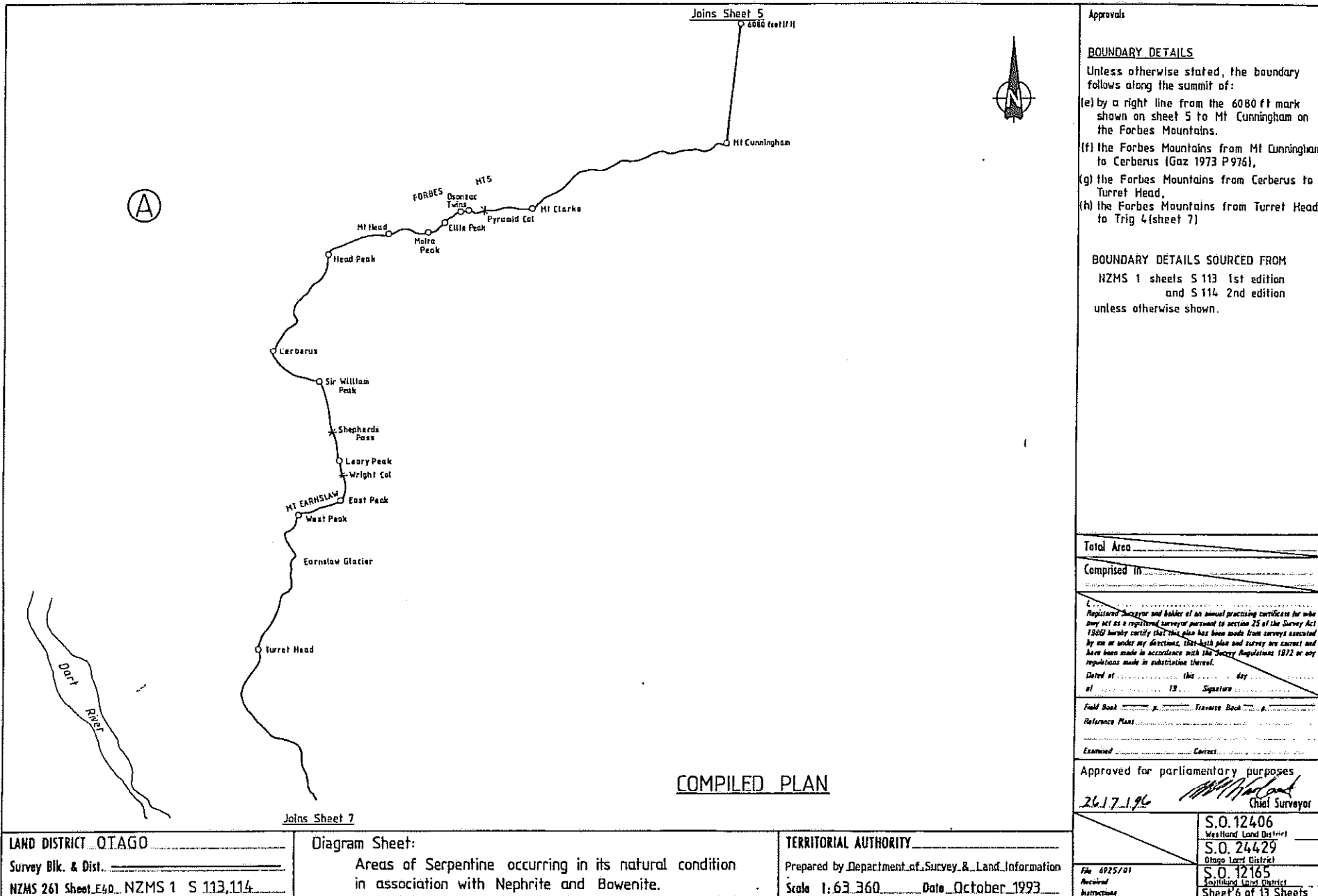

"RELEASED UNDER THE OFFICIAL INFORMATION ACT"

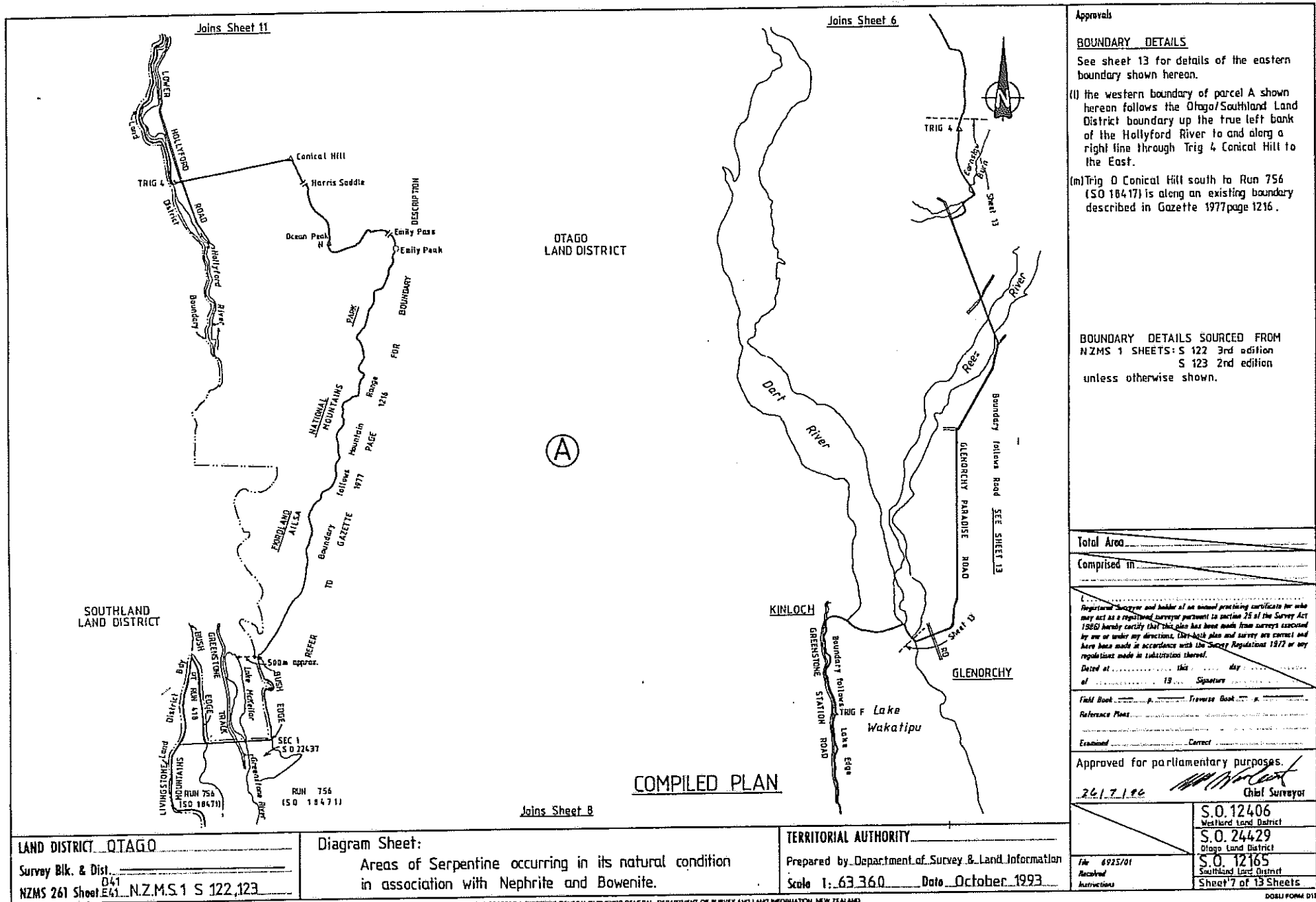

Approvals

BOUNDARY DETAILS
 See sheet 13 for details of the eastern boundary shown hereon.

(l) the western boundary of parcel A shown hereon follows the Otago/Southland Land District boundary up the true left bank of the Hollyford River to and along a right line through Trig 4 Conical Hill to the East.

(m) Trig D Conical Hill south to Run 756 (SO 18471) is along an existing boundary described in Gazette 1977 page 1216.

BOUNDARY DETAILS SOURCED FROM
 NZMS 1 SHEETS: S 122 3rd edition
 S 123 2nd edition
 unless otherwise shown.

Total Area _____
 Comprised in _____

I, _____
 District Surveyor and holder of an annual practicing certificate for who may act as a registered surveyor pursuant to section 25 of the Survey Act 1966 hereby certify that this plan has been made from surveys executed by me or under my direction, that this plan and survey are correct and have been made in accordance with the Survey Regulations 1972 or any regulations made in substitution thereof.

Dated at _____ this _____ day
 of _____ 19 _____

Field Book _____ Traverse Book _____
 Reference Plans _____
 Examined _____ Correct _____

Approved for parliamentary purposes.
 20.7.90 _____
 Chief Surveyor

S.O. 12406
 Westland Land District
 S.O. 24429
 Otago Land District
 S.O. 12165
 Southland Land District
 Sheet 7 of 13 Sheets

LAND DISTRICT OTAGO
 Survey Blk. & Dist. _____
 NZMS 261 Sheet E41 N.Z.M.S.1 S 122,123

Diagram Sheet:
 Areas of Serpentine occurring in its natural condition
 in association with Nephrite and Bowenite.

TERRITORIAL AUTHORITY _____
 Prepared by Department of Survey & Land Information
 Scale 1:63,360 Date October 1993

"RELEASED UNDER THE OFFICIAL INFORMATION ACT"

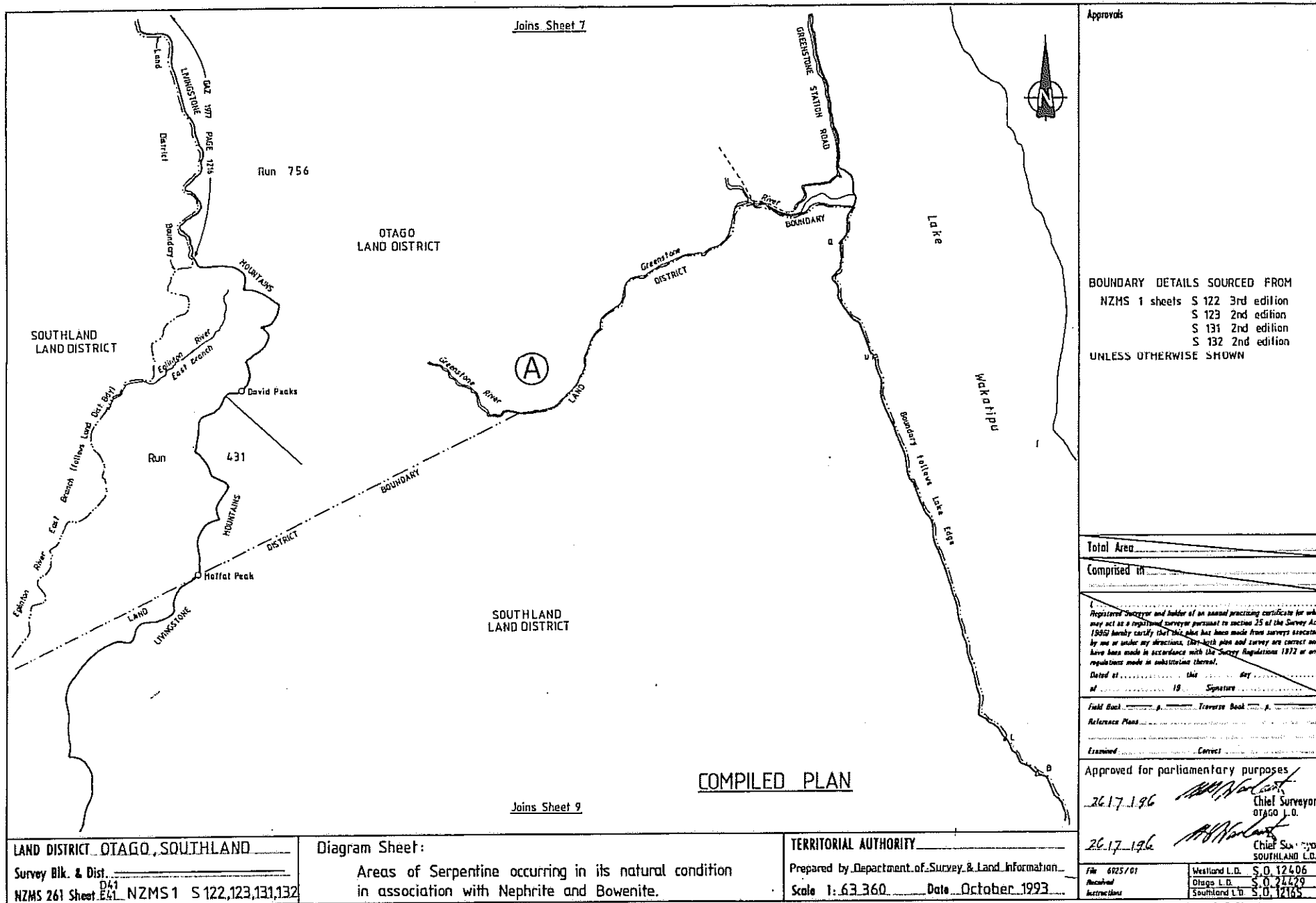

Approvals

BOUNDARY DETAILS SOURCED FROM
 NZMS 1 sheets S 122 3rd edition
 S 123 2nd edition
 S 131 2nd edition
 S 132 2nd edition
 UNLESS OTHERWISE SHOWN

Total Area _____
 Comprised in _____

I, _____
 Registered Surveyor and holder of an annual practicing certificate for who
 may act as a registered surveyor pursuant to section 25 of the Survey Act
 1958 hereby certify that this plan has been made from surveys executed
 by me or under my directions, that such plan and survey are correct and
 have been made in accordance with the Survey Regulations 1972 or any
 regulations made in substitution thereof.
 Dated at _____ this _____ day
 of _____ 19____ Signature _____

Field Book _____ p. _____ Traverse Book _____ p. _____
 Reference Plans _____
 Examined _____ Correct _____

Approved for parliamentary purposes
 26.17.196 _____
 Chief Surveyor
 OTAGO L.D.
 26.17.196 _____
 Chief Surveyor
 SOUTHLAND L.D.

File 6925/01
 Westland L.D. S.O. 12406
 Otago L.D. S.O. 24629
 Southland L.D. S.O. 12185

LAND DISTRICT OTAGO, SOUTHLAND
 Survey Blk. & Dist. _____
 NZMS 261 Sheet E41 NZMS 1 S 122, 123, 131, 132

Diagram Sheet:
 Areas of Serpentine occurring in its natural condition
 in association with Nephrite and Bowenite.

TERRITORIAL AUTHORITY _____
 Prepared by Department of Survey & Land Information
 Scale 1:63,360 Date October 1993

"RELEASED UNDER THE OFFICIAL INFORMATION ACT"

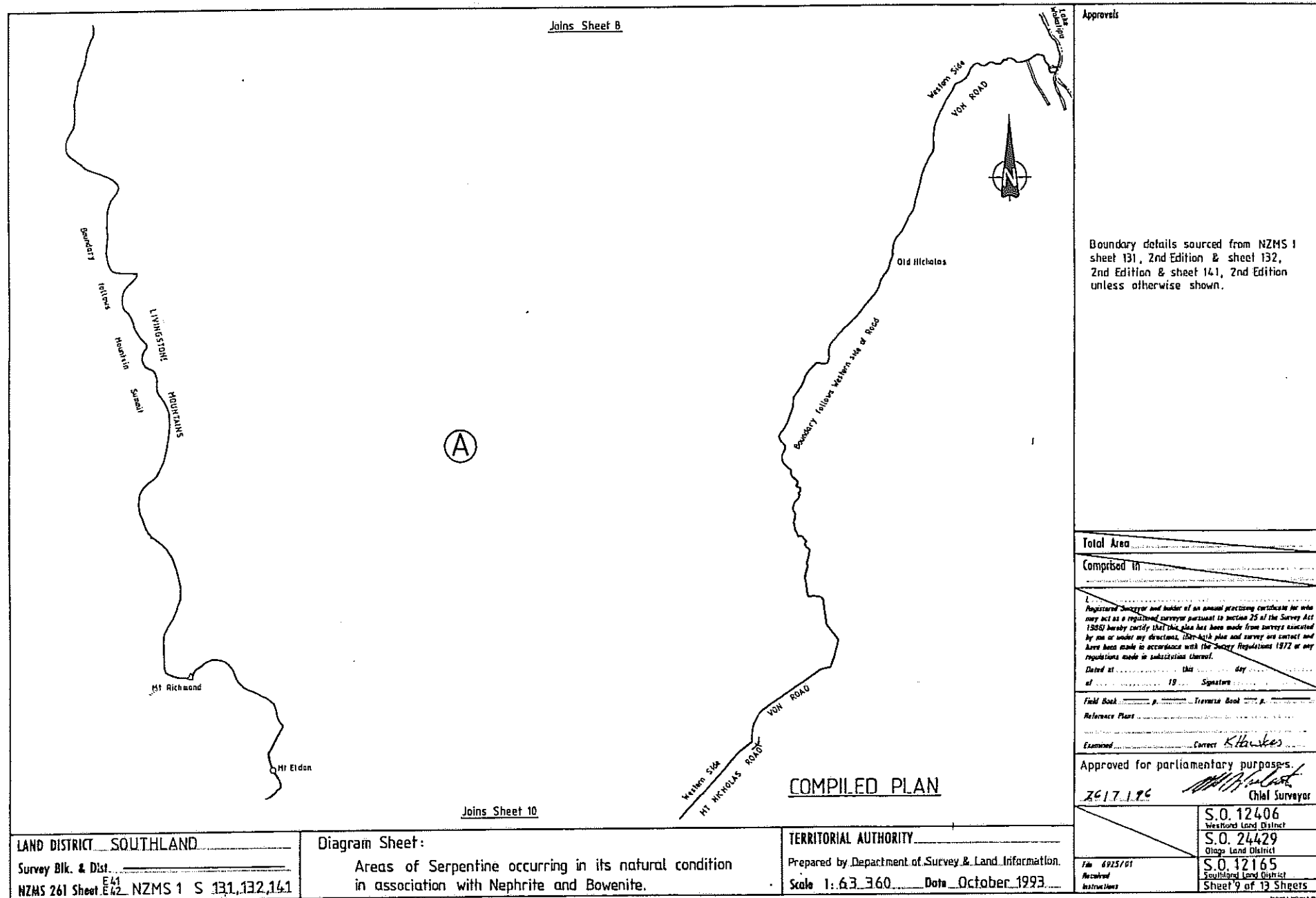

Approvals

Boundary details sourced from NZMS 1 sheet 131, 2nd Edition & sheet 132, 2nd Edition & sheet 141, 2nd Edition unless otherwise shown.

Total Area _____

Comprised in _____

Registered Surveyor and holder of an annual practicing certificate for who may act as a registered surveyor pursuant to section 25 of the Survey Act 1985 hereby certify that this plan has been made from surveys executed by me or under my direction, that this plan and survey are correct and have been made in accordance with the Survey Regulations 1972 or any regulations made in substitution thereof.

Dated at _____ this _____ day of _____ 19____ Signature _____

Field Book _____ p. Traverse Book _____ p.

Reference Plans _____

Examined _____ Correct *Klauskes*

Approved for parliamentary purposes.

ZC 17.1.96 *[Signature]*
Chief Surveyor

S.O. 12406 Westford Land District
S.O. 24429 Otago Land District
S.O. 12165 Southland Land District
Sheet 9 of 13 Sheets

File 6925/01
Received
Instructions

LAND DISTRICT SOUTHLAND

Survey Blk. & Dist. _____

NZMS 261 Sheet ^{E41} ~~E42~~ NZMS 1 S 131, 132, 141

Diagram Sheet:

Areas of Serpentine occurring in its natural condition in association with Nephrite and Bowenite.

TERRITORIAL AUTHORITY _____

Prepared by Department of Survey & Land Information.

Scale 1:63,360 Date October 1993

"RELEASED UNDER THE OFFICIAL INFORMATION ACT"

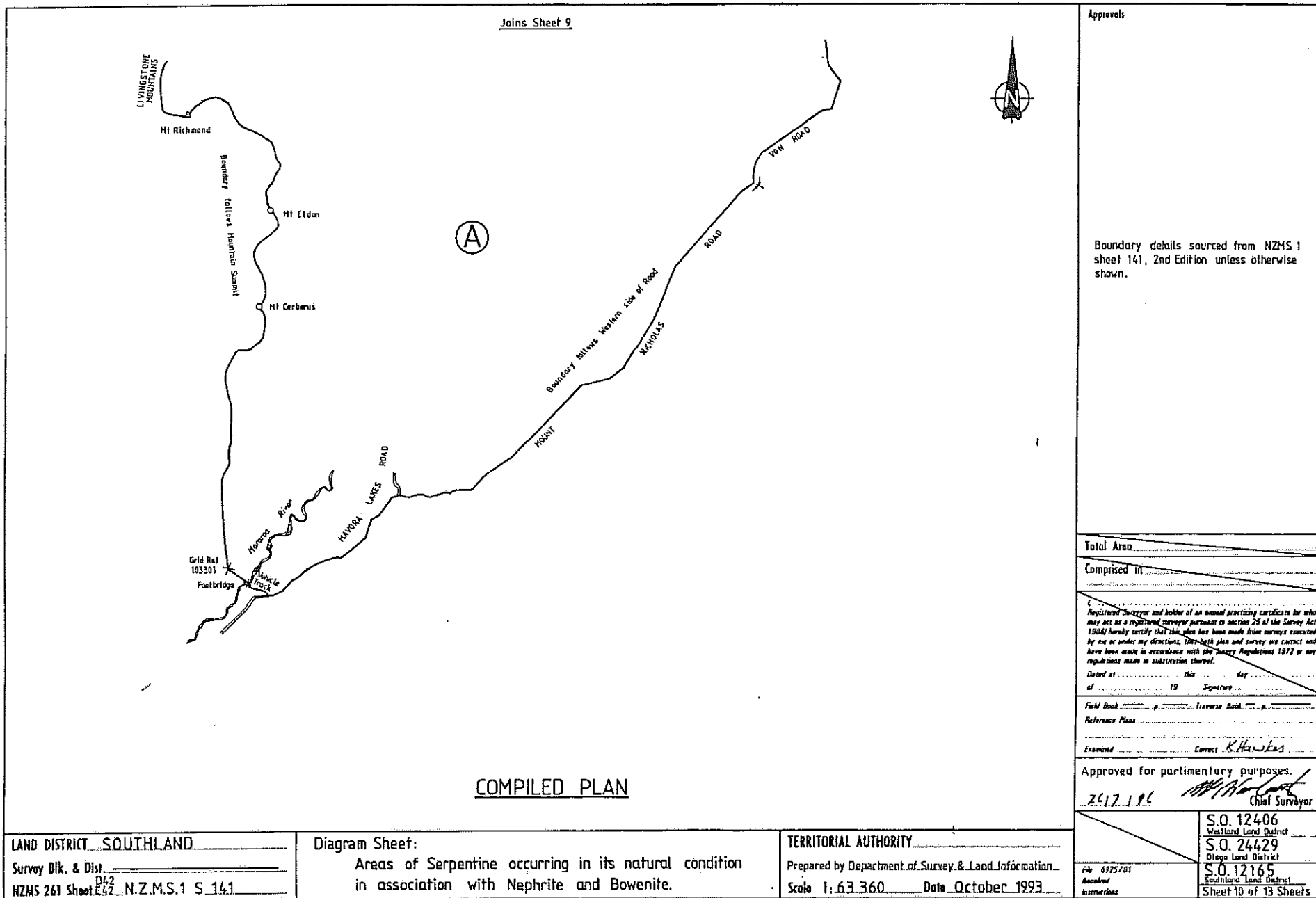

Approvals

Boundary details sourced from NZMS 1 sheet 141, 2nd Edition unless otherwise shown.

Total Area _____

Comprised in _____

I, Registered Surveyor and holder of an annual practicing certificate for who may act as a registered surveyor pursuant to section 25 of the Survey Act 1908/ hereby certify that the plan has been made from surveys executed by me or under my direction. The said plan and survey are correct and have been made in accordance with the Survey Regulations 1972 or any regulations made in substitution thereof.

Dated at _____ this _____ day of _____ 19 _____

Signature _____

Field Book _____ p. _____ Reverse Book _____ p. _____

Reference Plans _____

Examined _____ Correct *R. Hawkes*

Approved for parliamentary purposes.

24.10.93 _____
Chief Surveyor

LAND DISTRICT SOUTHLAND

Survey Blk. & Dist. _____

NZMS 261 Sheet D42 N.Z.M.S.1 S.141

Diagram Sheet:

Areas of Serpentine occurring in its natural condition in association with Nephrite and Bowenite.

TERRITORIAL AUTHORITY _____

Prepared by Department of Survey & Land Information

Scale 1:63,360 Date October 1993

S.O. 12406
Westland Land District

S.O. 24429
Otago Land District

S.O. 12165
Southland Land District

Sheet 10 of 13 Sheets

File 6925/01
Accredited
Instructions

"RELEASED UNDER THE OFFICIAL INFORMATION ACT"

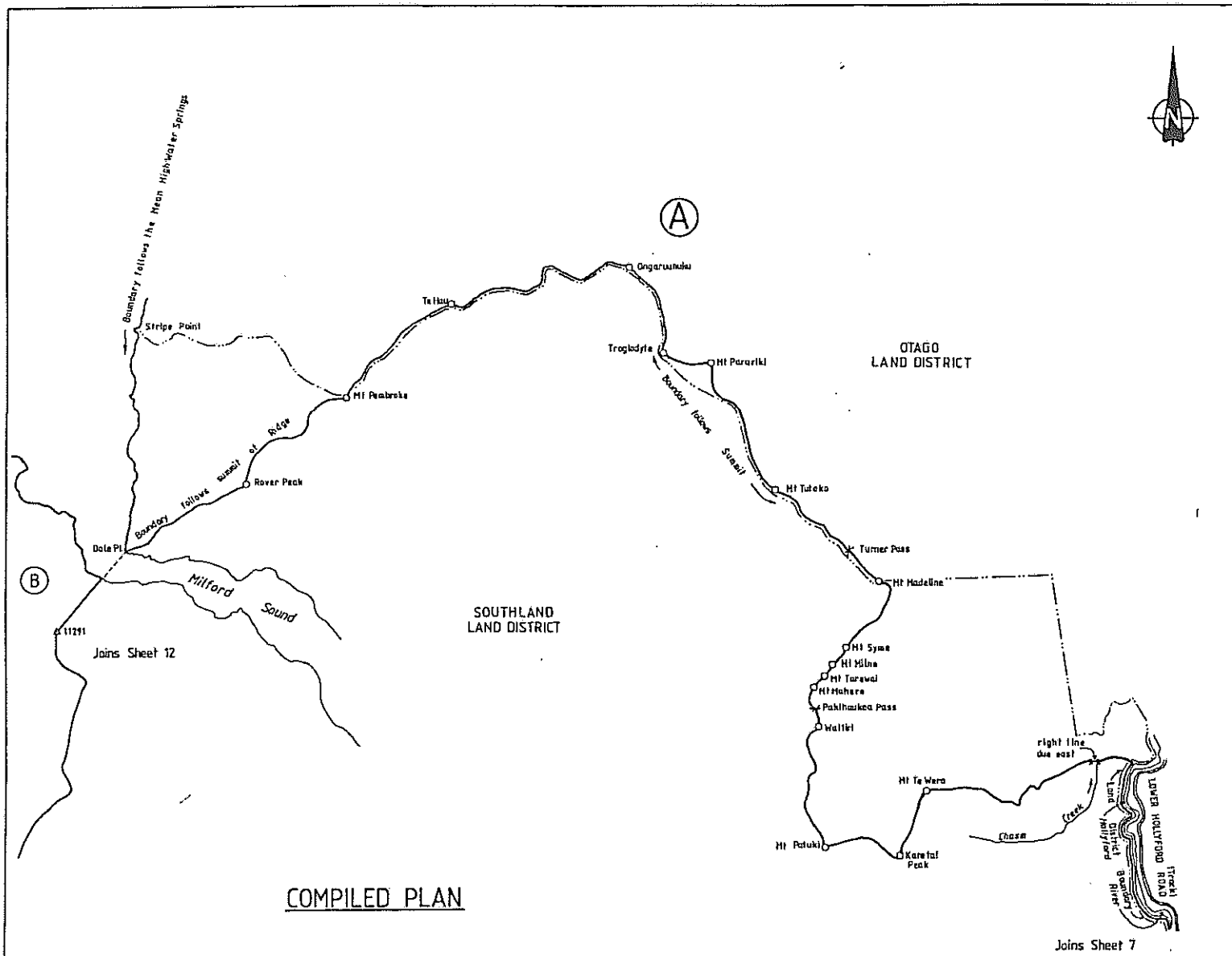

Approvals

BOUNDARY DETAILS
 Unless otherwise shown the boundary follows the summit of a mountain range or ridge:
 (k) generally easterly from Mt Te Wera to the end of a ridge and by a right-line due east to Chasm Creek, down Chasm Creek to the Otago / Southland Land District Boundary on the true left bank of the Hollyford River.

BOUNDARY DETAILS SOURCED FROM
 NZMS 1 SHEETS S 112 2nd edition
 S 113 1st edition
 S 122 3rd edition
 unless otherwise shown.

Total Area

Comprised in

I, *[Signature]* Registrar General and holder of an annual practicing certificate for who may act as a registered surveyor pursuant to section 25 of the Survey Act 1958 hereby certify that the plan has been made from surveys executed by me or under my direction. The said plan and survey are correct and have been made in accordance with the Survey Regulations 1972 or any regulations made in substitution thereof.
 Dated at this day of 1986
 of 18 Signature

Field Book p. _____ Traverse Book p. _____
 Reference Plans _____
 Examined _____ Correct _____

Approved for parliamentary purposes
 26.1.1986 *[Signature]* Chief Surveyor OTAGO L.D.
 26.1.1986 *[Signature]* Chief Surveyor SOUTHLAND L.D.

File 0925/01 Westland L.D. S.O. 12406
 Received Otago L.D. S.O. 24429
 Instructions Southland L.D. S.O. 12165

LAND DISTRICT SOUTHLAND, OTAGO
 Survey Blk. & Dist. _____
 NZMS 261 Sheet 040 N.Z.M.S. 1 S.112,113 & 122

Diagram Sheet:
 Areas of Serpentine occurring in its natural condition in association with Nephrite and Bowenite.

TERRITORIAL AUTHORITY _____
 Prepared by Department of Survey & Land Information
 Scale 1:63,360 Date October 1993

"RELEASED UNDER THE OFFICIAL INFORMATION ACT"

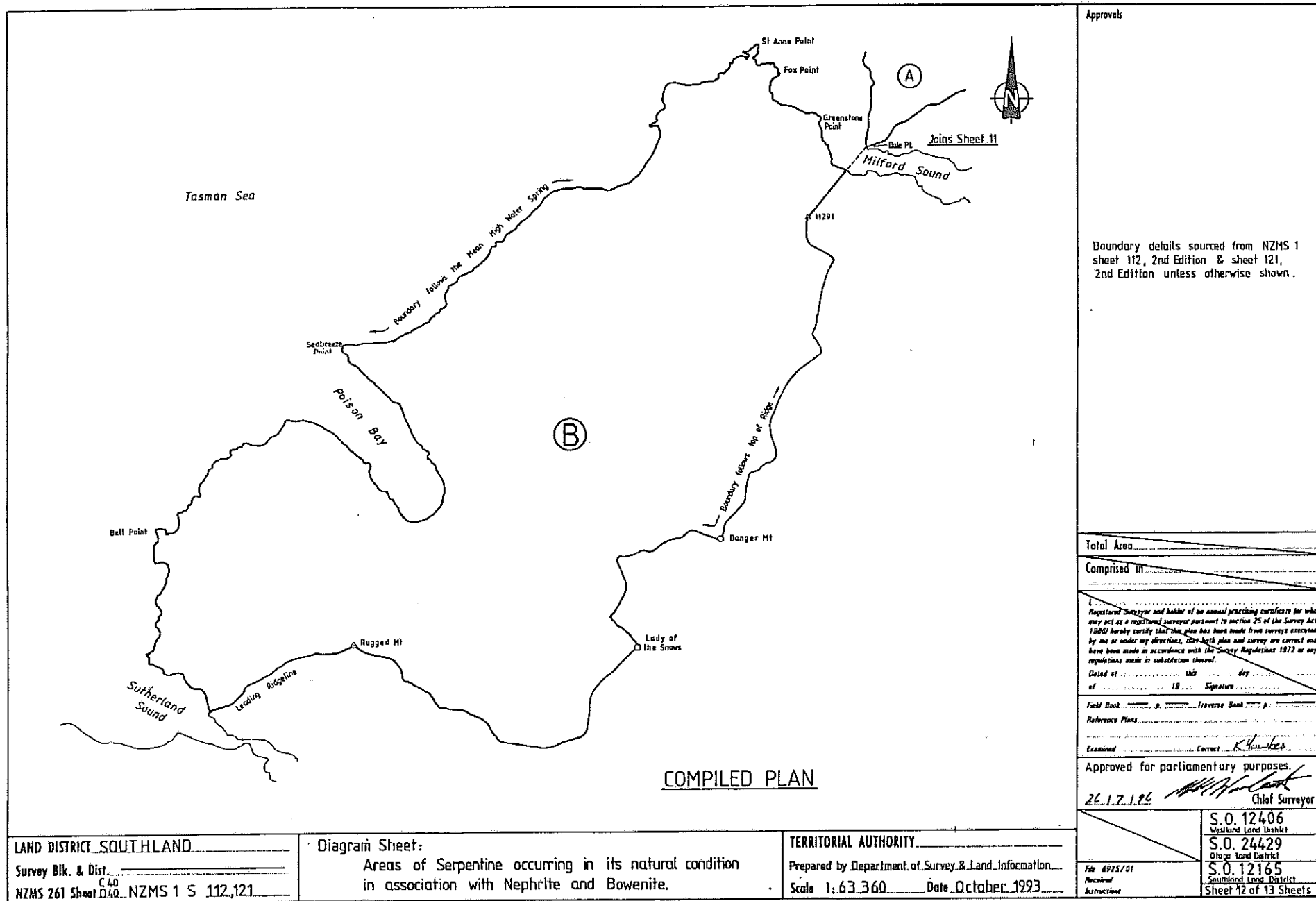

Approvals

Boundary details sourced from NZMS 1 sheet 112, 2nd Edition & sheet 121, 2nd Edition unless otherwise shown.

Total Area _____

Comprised in _____

I, Richard K. H. Lee, Registrar, Surveyor and holder of an annual practicing certificate for who may act as a registered Surveyor pursuant to section 25 of the Survey Act 1981 hereby certify that this plan has been made from surveys executed by me or under my direction, that both plan and survey are correct and have been made in accordance with the Survey Regulations 1972 or any regulations made in substitution thereof.

Dated at _____ this _____ day _____ of _____ 19... Signature _____

Field Book _____ p. _____ Traverse Book _____ p. _____

Reference Plans _____

Examined _____ Correct R. H. Lee

Approved for parliamentary purposes

26.1.7.93 _____ Chief Surveyor

S.O. 12406 Westland Land District
S.O. 24429 Otago Land District
S.O. 12165 Southland Land District
Sheet 12 of 13 Sheets

File 6925/01
Revised
Instructions

LAND DISTRICT SOUTH LAND	Diagram Sheet: Areas of Serpentine occurring in its natural condition in association with Nephrite and Bowenite.	TERRITORIAL AUTHORITY Prepared by Department of Survey & Land Information Scale 1:63,360 Date October 1993
--------------------------	---	--

Survey Blk. & Dist. _____
NZMS 261 Sheet C40 NZMS 1 S 112, 121

W.A. ROBERTSON, DIRECTOR GENERAL/SURVEYOR GENERAL, DEPARTMENT OF SURVEY AND LAND INFORMATION, NEW ZEALAND

DONALD FORM 018

"RELEASED UNDER THE OFFICIAL INFORMATION ACT"

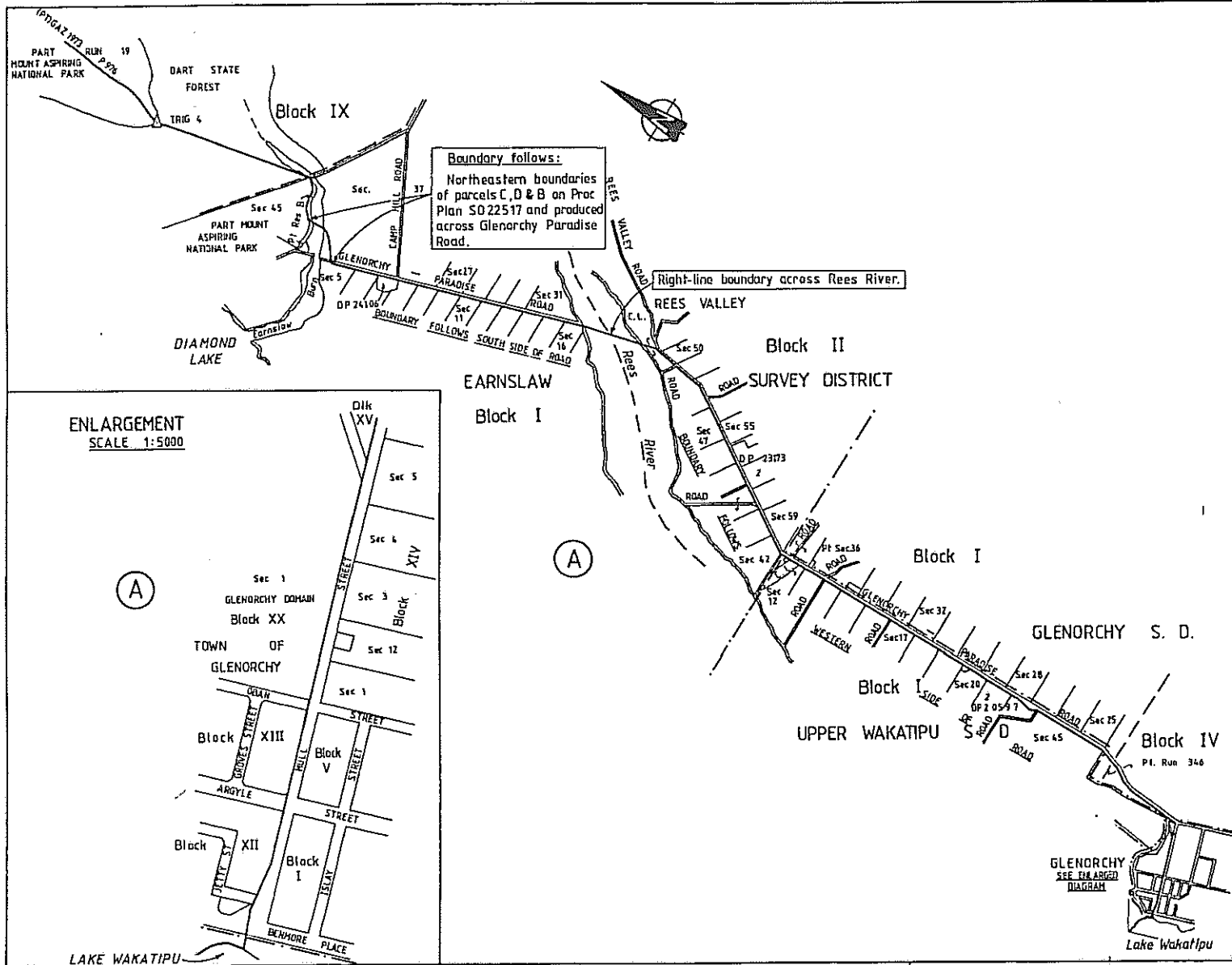

Approvals

BOUNDARY DETAILS

(i) along the summit of the Forbes Mountains from Turret Head on sheet 6 to Trig 4

(j) south by a right-line from Trig 4 to the intersection of the Section 45/PI Reserve B boundary on the true right bank of the Earnslaw Burn Block I Earnslaw S.D.

BOUNDARY DETAILS SOURCED FROM NZMS 1 SHEET 5 123 2nd edition, unless otherwise shown.

Total Area _____

Comprised in _____

I, _____ Registrar Surveyor and holder of an annual practicing certificate for who may act as a registered surveyor pursuant to section 25 of the Survey Act 1980 hereby certify that this plan has been made from surveys conducted by me or under my direction. That such plan and survey are correct and have been made in accordance with the Survey Regulations 1972 or any regulations made in substitution thereof.

Dated at _____ this _____ day of _____ 19 _____

Field Book _____ p. _____ Traverse Book _____ p. _____

Reference Plans _____

Examined _____ Correct _____

Approved for Parliamentary Purposes

26.7.126 _____ Chief Surveyor

LAND DISTRICT OTAGO

Survey Blk. & Dist. _____

NZMS 261 Sheet E60,4,1 NZMS 1 S.123

Diagram Sheet:

Areas of Serpentine occurring in its natural condition in association with Nephrite and Bowenite

TERRITORIAL AUTHORITY _____

Prepared by Department of Survey & Land Information

Scale 1:30,000 Date October 1993

SO 12406	Westland Land District
SO 24429	Otago Land District
SO 12165	Southland Land District
Sheet 13 of 13 Sheets	

"RELEASED UNDER THE OFFICIAL INFORMATION ACT"

LAND DESCRIPTION

EXPLORATION PERMIT APPLICATION 40287

Applicant: Southern Lakes Holdings Ltd

All that area of land situated in Blocks X and XV, Mid Wakatipu Survey District containing approximately 300 hectares being bounded by a line

commencing at Trig L, Block XV, Mid Wakatipu Survey District;

thence southerly for 1820 metres approximately on a bearing of $180^{\circ}00'$;

thence southeasterly for 1080 metres approximately on a bearing of $141^{\circ}30'$ to the northwest corner of part Section 3, Block XV, Mid Wakatipu Survey District;

thence southeasterly along the western boundary of the said part Section 3 to its southwest corner;

thence by right line to Trig A, Blocks X and XV, Mid Wakatipu Survey District;

thence by right line to Trig I, Block X, Mid Wakatipu Survey District;

thence easterly for 450 metres approximately on a bearing of $79^{\circ}28'$ to the shoreline of Lake Wakatipu;

thence northwesterly along the shoreline of Lake Wakatipu (crossing the mouth of the Von River) to its intersection with a line running north on a bearing of $0^{\circ}00'$ from Trig L aforesaid;

thence southerly for 30 metres approximately on a bearing of $180^{\circ}00'$ to Trig L aforesaid being the point of commencement;

and excluding part sections 1, 2 and 3, Block XV, Mid Wakatipu Survey District, Lot 1, DP 5055 and all Crown Land Reserved from Sale and Legal Road and the physical bed of the Von River.

and being more particularly shown marked by a bold black line on the plan attached hereto.

Bearings are in terms of Geodetic Datum 1949, Mt Nicholas Circuit.

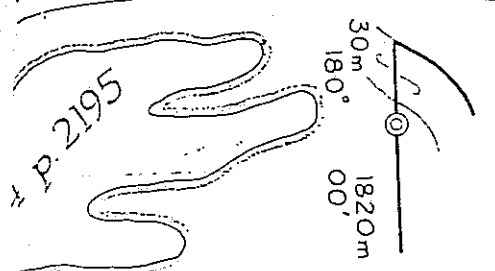

VIII DIAGRAM Not to Scale

SEE DIAGRAM
6.1400 331.01m

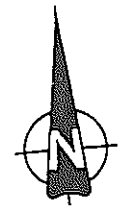

EXPLORATION PERMIT APPL. 40287
Applicant: Southern Lakes Holdings Ltd.

Scale 1:20,000 B.S. 786

Bearings are in terms of Geodetic Datum 1949
Mt Nicholas Circuit.

PREPARED BY ... Department of
Survey and Land Information

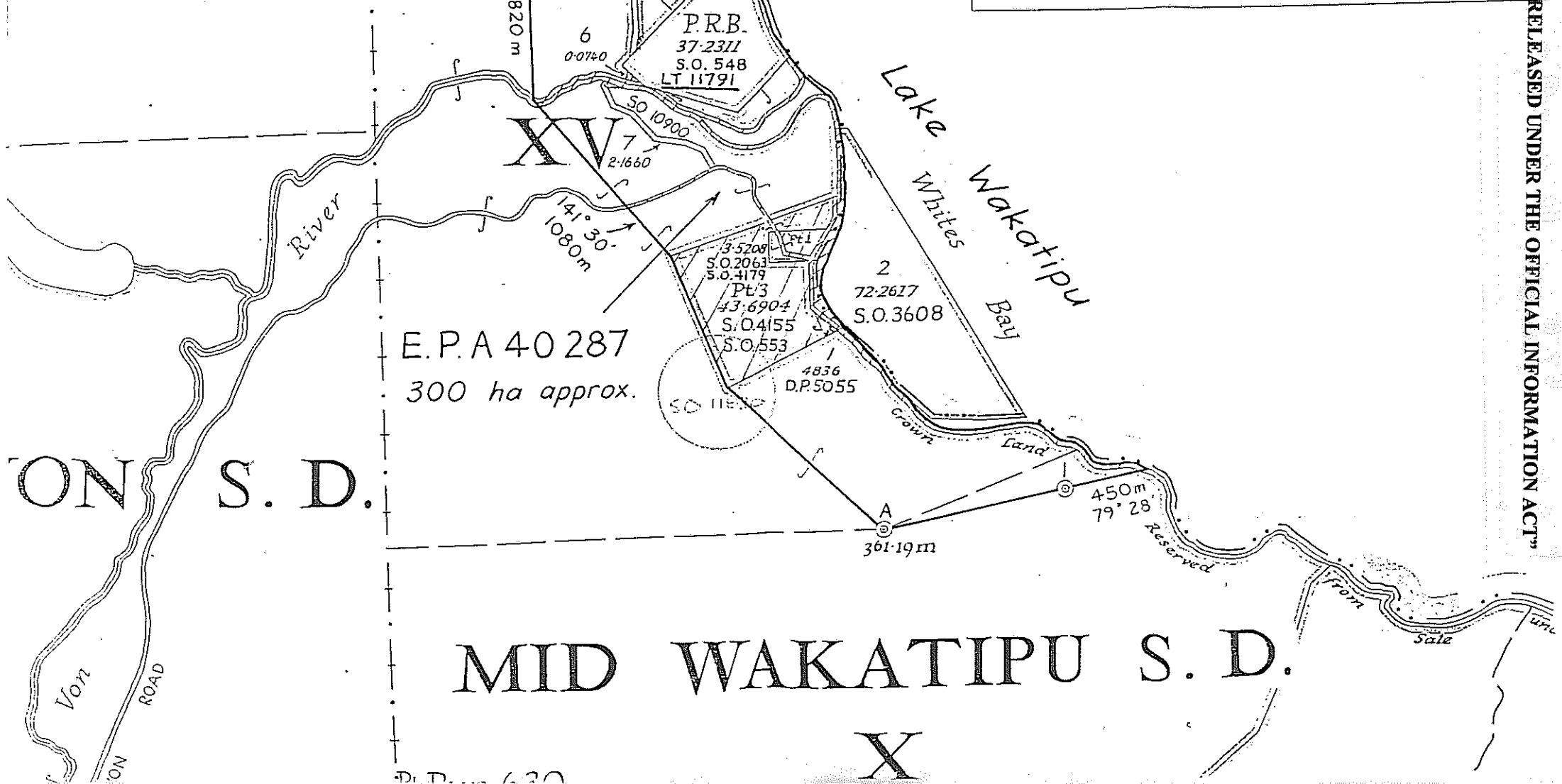

E.P.A 40287
300 ha approx.

ON S. D.

MID WAKATIPU S. D.

X

SECOND SCHEDULE
CONDITIONS OF EXPLORATION PERMIT 40 287
SOUTHERN LAKES HOLDINGS LIMITED

Work Programme

1 The permit holder shall make all reasonable efforts to systematically explore the permit's area in accordance with good exploration practice with the objective of identifying and delineating potential mineable reserves of gravel suitable for use as chip quality aggregate.

2 The permit holder shall carry out the following work programme:

- i Undertake a programme of geological mapping and hand sampling;
- ii Undertake a programme of pit bulk sample testing of approximately 6 sites or more. Pit and bulk sample size are not to exceed 20 cubic metres per site;
- iii Conduct resource and reserve calculations;
- iv Provide a plan showing the geology and the location of bulk sample sites and reserve blocks;
- v Undertake geotechnical and mining feasibility studies as appropriate.

Expenditure

3 The permit holder shall spend in

- Year 1 a minimum of \$5,000 (FIVE THOUSAND DOLLARS)
Year 2 a minimum of \$5,000 (FIVE THOUSAND DOLLARS)
Year 3 a minimum of \$5,000 (FIVE THOUSAND DOLLARS)

on exploration work unless otherwise approved in writing by the Secretary of Commerce.

Relevant Minerals Programme

4 The minerals programme in respect of the minerals to which this permit is granted which is first issued after the commencement date of this permit, shall apply to this permit ('the relevant minerals programme').

Royalties - One Year After Minerals Programme in Effect

5a The permit holder shall forward a royalty return and shall pay to the Crown, in respect of all gravel taken under this permit, a royalty calculated in accordance with the provisions of the relevant minerals programme.

- b The royalty return and any royalties payable shall be forwarded to the Secretary within 90 days of the completion of the relevant reporting period.
- c The reporting period for this permit shall be the financial reporting year of the permit holder.
- d Clauses 5(a) to 5(d) shall not come into force until one year after the minerals programme (referred to in clause 4) comes into effect.

Amendments to the Permit

- 6a The Minister may, at any time or times during the currency of the permit, on such conditions as he or she thinks fit, amend the conditions of the permit by giving the permit holder written notice pursuant to this clause that the permit conditions are to be amended.
- b The notice referred to in clause 6(a) shall specify the amendments that are to be made to the permit, and shall specify the date on which such amendments are to take effect.
- c The power to amend this permit in the manner provided in clause 6(a) shall be exercised only for the purpose of ensuring that the royalty provisions of this permit are in accordance with and give effect to the royalty regime outlined in the relevant minerals programme.
- d Amendments made to the permit pursuant to clause 6(a) shall take effect at least 20 working days after the service of the notice on the permit holder.

Reports

- 7a The permit holder shall provide such periodic reports and returns of production as may be required pursuant to the Crown Minerals Act 1991 and relevant regulations prescribed thereunder.
- b The permit holder shall within sixty days following the anniversary of the date of the granting of the permit, submit to the Secretary of Commerce, one copy of each technical report including map plans completed during the preceding twelve months.

Notifications Required

- 8a The permit holder will notify the Inspector of Mines and appropriate local authorities when operations are due to commence.
- b Prior to the commencement of any drilling or underground development the permit holder shall notify the Secretary, in writing, giving details of proposed activities and commencement date.

THE CROWN MINERALS ACT 1991

EXPLORATION PERMIT No. 40 287

Minister of Energy

TO

SOUTHERN LAKES HOLDINGS LIMITED

Area: 300 hectares

MEMORIALS

243971.1 Surrendered as to CT
A3/362 - 29.8.1996 at 9.50 a.m.

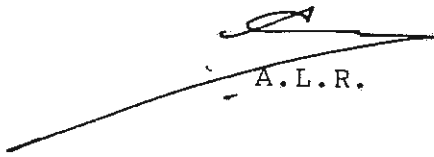
A.L.R.



Particulars entered in the Register shown in
the First Schedule herein on the date and at
the time stamped below.

.....
District/Asst Land Registra

Registry Office Use Only

9.05 30.OCT95 235722-1

ORIGINAL

PARTICULARS ENTERED IN REGISTER
LAND REGISTRY SOUTH AFRICA
ASST. LAND REGISTRAR
206/47
A3/362

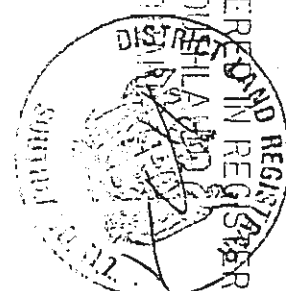

CDE_S15 - Request Manual Copy [X]

Document Type	Estimated	Request Id	45405
Reference Number	270215	User Id	jkirkdu
Land District	Southland	Request Date	08/03/2002 15:15:02
Method of Delivery	Fax	Client Reference	6NLITR.02/526YD
Requested By	JOHN KIRK	Status	Pending

Certified Copy

Comments
MT NICHOLAS - CHANGE OF DESCRIPTION ??? [NOT ABLE TO READ ON SL206/47]

Delivery Details

Firm	Opus International Consultants Ltd (Dunedin)
Primary Contact	Mr Robin Whelan
Street	Private Bag 1913
Town	Dunedin
Country	New Zealand
Postcode	
Fax Number	03 474 8995

Fees... [OK] [Cancel]

Department of Lands & Survey

TELEGRAPHIC ADDRESS: 'LANDS'

FOR VERBAL INQUIRIES
PLEASE ASK FOR MR

TELEPHONE No. 87-334



OUR REFERENCE: P. 46

YOUR REFERENCE:

DISTRICT OFFICE,

P.O. BOX 826,

INVERCARGILL.

31st May 1973.

The District Land Registrar,
Lands and Deeds Office,
Private Bag,
INVERCARGILL.

New Appellation
Subdivision of Crown Land

A copy of S.O. *8413^L*, showing new appellation is enclosed herewith.

Please quote references

on abstract.

M.W. ARMSTRONG
Chief Surveyor

Per: *M. W. Armstrong*

Encl. Photostat copy

FILE: P 46

ALTERATION New Applications

see/Licensee: 44 Nicholas Station Lt 1

R.M. 206/47

Description of Land: Run 620 situated in the
North Platte Range of the
Public Lands

Area: 79 Acres

Rating Authorities: Subsistence

Valuation Department Assessment Reference: ...

Full Details of Alteration

Run 620 situated in the
North Platte Range of the
Public Lands
Area 79 Acres

50. 8 1/2

Reason and Authority for Alteration

New application in the name of
the 44th North Station Run 620
situated in the North Platte Range
of the Public Lands

Prepared by: ... Checked by: ...

ACTION REQUIRED:

LEASES SEC.:	ACCOUNTS DIV.:	TITLES SEC.:	RECORDS SEC.:
G. 13 / /	Ledgers: / /	Documents: / /	File / /
C.L. Regr. / /	C./register: / /	Insurance: / /	Index / /
Expiry Book: / /	Land A/c. / /		
Interest Review	Index: / /		
Register / /	A/c's. Check: / /		

270215



MWP_0015865

New appellation

(1) Section 1 index

(2) 206/47.

SEARCHED	INDEXED
SERIALIZED	FILED
JUN 11 1975	
FBI - JAMES	
2333	

CDE_S15 - Request Manual Copy		X	
Document Type	Instrument	Request Id	45384
Reference Number	NA 130941.1	User Id	jkirkdu
Land District	Southland	Request Date	08/03/2002 14:56:49
Method of Delivery	Fax	Client Reference	6NLITR.02/526YD
Requested By	JOHN KIRK	Status	Pending
<input type="checkbox"/> Certified Copy			
Comments	MT NICNOLAS - NEW APPELATION SEC 1 BLK XV MAVORA SD		
Delivery Details			
Firm	Opus International Consultants Ltd (Dunedin)		
Primary Contact	Mr Robin Whelan		
Street	Private Bag 1913		
Town	Dunedin		
Country	New Zealand		
Postcode			
Fax Number	03 474 8995		
Fees...	OK	Cancel	

ALTERATION

New Appellation

Lessee/Licensee:

Description of Land:

Section 1, Block XV, Mavora S.D.

Area:

~~10833~~ 40.2769 ha.

Rating Authorities:

Wallace and Lake County

Valuation Department Assessment Reference:

Full Details of Alteration

Section 1, Block XV, Mavora Survey, District being formerly ~~State~~ Part Run 630 situated in Blocks X and XV, Mavora S.D.

Area 40 2760 ha

S.D. 10833

DLR Advised.

Reason and Authority for Alteration

Survey has been carried out to define a area to be gazetted wildlife management Reserve. Currently held in part RB 205/47

J 13 No.

Prepared by:

[Signature]

1/3/78

86

Checked by:

[Signature]

1/3/78

ACTION REQUIRED:

LEASES SEC.:

G. 13 / / .
C.L. Regr. / / .
Expiry Book: / / .
Interest Review
Register / / .

ACCOUNTS DIV.:

Ledgers: / / .
C./register: / / .
Land A/c. / / .
Index: / / .
A/c's. Check: / / .

TITLES SEC.:

Documents: / / .
Insurance: / / .

RECORDS SEC.:

File / / .
Index / / .

ACTION CHECKED: / / .

"RELEASED UNDER THE OFFICIAL INFORMATION ACT"
RELEASED UNDER THE OFFICIAL INFORMATION ACT
**ORDER FOR NEW CERTIFICATE
OF TITLE**

REFERENCE:

Vol _____ Folio _____

Referred to Draughtsman, / 19

Returned from Draughtsman, / 19

MWP_0015856



11.05 03 JUL 88 130243.4
M.P.C.U. 1001
LONDON
206/47
INDEXED
INDEXED
W. H. L. S. DIST.

CDE_S15 - Request Manual Copy			
Document Type	Retention	Request Id	45404
Reference Number	256343	User Id	jkirkdu
Land District	Southland	Request Date	08/03/2002 15:13:05
Method of Delivery	Fax	Client Reference	6NLITR.02/526YD
Requested By	JOHN KIRK	Status	Pending
<input type="checkbox"/> Certified Copy			
Comments	MT NICHOLAS - CERT OF INCORPORATION		
Delivery Details			
Firm	Opus International Consultants Ltd (Dunedin)		
Primary Contact	Mr Robin Whelan		
Street	Private Bag 1913		
Town	Dunedin		
Country	New Zealand		
Postcode			
Fax Number	03 474 8995		
Fees...	OK	Cancel	

L. & S.—B. 6

CERTIFICATE OF ALTERATION UNDER SECTION 113, LAND ACT 1948

IN THE MATTER of the Land Transfer Act 1952, and the Land Act 1948,

and

IN THE MATTER of lease (licence) from HER MAJESTY THE QUEEN to MOUNT NICHOLAS STATION LIMITED

registered in

Vol. 206 , folio 57 , Southland Land Registry.

This is to certify that on the first day of July 1971, the area of land included in the abovementioned lease was altered by the incorporation therein of the land described in the First Schedule and the exclusion therefrom of the land described in the Second Schedule hereto without alteration of the annual rental and stock limitation in the lease.

FIRST SCHEDULE
(Description and Plan of land incorporated)

Run 674, formerly part Run 568, situated in Blocks III, IV, V, VI, XI, XII, XIII and XIV, Mavora Survey District and Part Run 558, Von, Black Hill, Eyre North, Eyreside, Mavora, Lincoln and Mid Wakatipu Survey Districts and containing 14,028 acres more or less as shown edged red on Survey Office Plan number 8128 (L) a copy of which is filed on Appellation Document No. 251755 Southland Land Registry

SECOND SCHEDULE
(Description and Plan of land excluded)

Part Run 558, Blocks I, II, VII, and VIII, Black Hill Survey District and containing 1,340 acres more or less AND ALSO Part Run 558, Blocks II, III and VI, Black Hill Survey District and containing 690 acres more or less as shown respectively red in outline on the plan drawn hereon

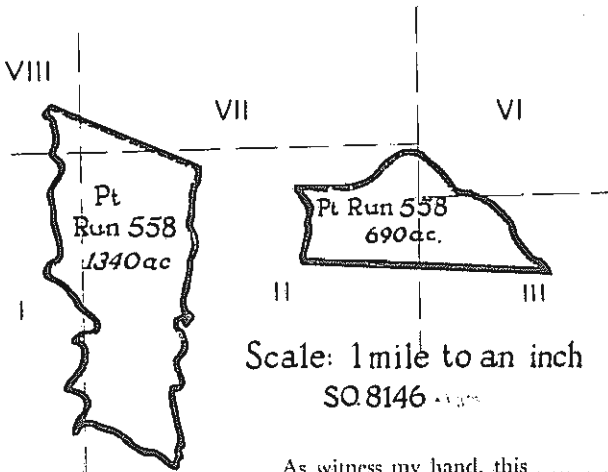

As witness my hand, this *13th* day of *October* 1971

[Signature]
Commissioner of Crown Lands.

256343

"RELEASED UNDER THE OFFICIAL INFORMATION ACT"

RELEASED UNDER THE OFFICIAL INFORMATION ACT

CERTIFICATE OF ALTERATION

Not Registered under Land Transfer Act. Registered under Land Transfer Act. 1940. Section 83;

HER MAJESTY THE QUEEN { Lessor. Licensor. }
WRIGHT STEPHENSON FARMERS' FINANCE AND INVESTMENT COMPANY LIMITED { Lessee. Licensee. }

PARTICULARS entered in the Register-book,

Volume 206, folio 47, and on mortgage 78470 the 29 day of November 1971 at 2.40 o'clock.



Assistant District Land Registrar of the District of Southland



WRIGHT STEPHENSON FARMERS' FINANCE AND INVESTMENT COMPANY LIMITED as Mortgagee under and by virtue of Memorandum of Mortgage No. 78470 over the land contained in P.R.L. 521 recorded at Register Book Volume 206 folio 47 (Southland Registry) DO TH HEREBY CONSENT to the within written Certificate of Alteration.

DATED at Wellington this 1st day of October 1971.

THE COMMON SEAL of WRIGHT STEPHENSON FARMERS' FINANCE AND INVESTMENT COMPANY LIMITED was hereunto affixed in the presence of.



Director Secretary

Handwritten notes: CA, CCL, 29 NOV 1971, 2.40, 4489

CDE S15 - Request Manual Copy			
Document Type	Undertaken	Request Id	45395
Reference Number	179507	User Id	kirkdo
Land District	Southland	Request Date	08/03/2002 15:06:57
Method of Delivery	Fax	Client Reference	6NUTR:02/5267D
Requested By	JOHN KIRK	Status	Being Processed
<input type="checkbox"/> Certified Copy			
Comments	MT NICHOLAS - SURRENDER DOCUMENT 17,700 acres		
Delivery Details			
Firm	Opus International Consultants Ltd (Dunedin)		
Firm Contact	Mr Robin Whelan		
Street	Private Bag 913		
Town	Dunedin		
Country	New Zealand		
Postcode			
Fax Number	03 474 8995		
Fees			
		OK	Cancel

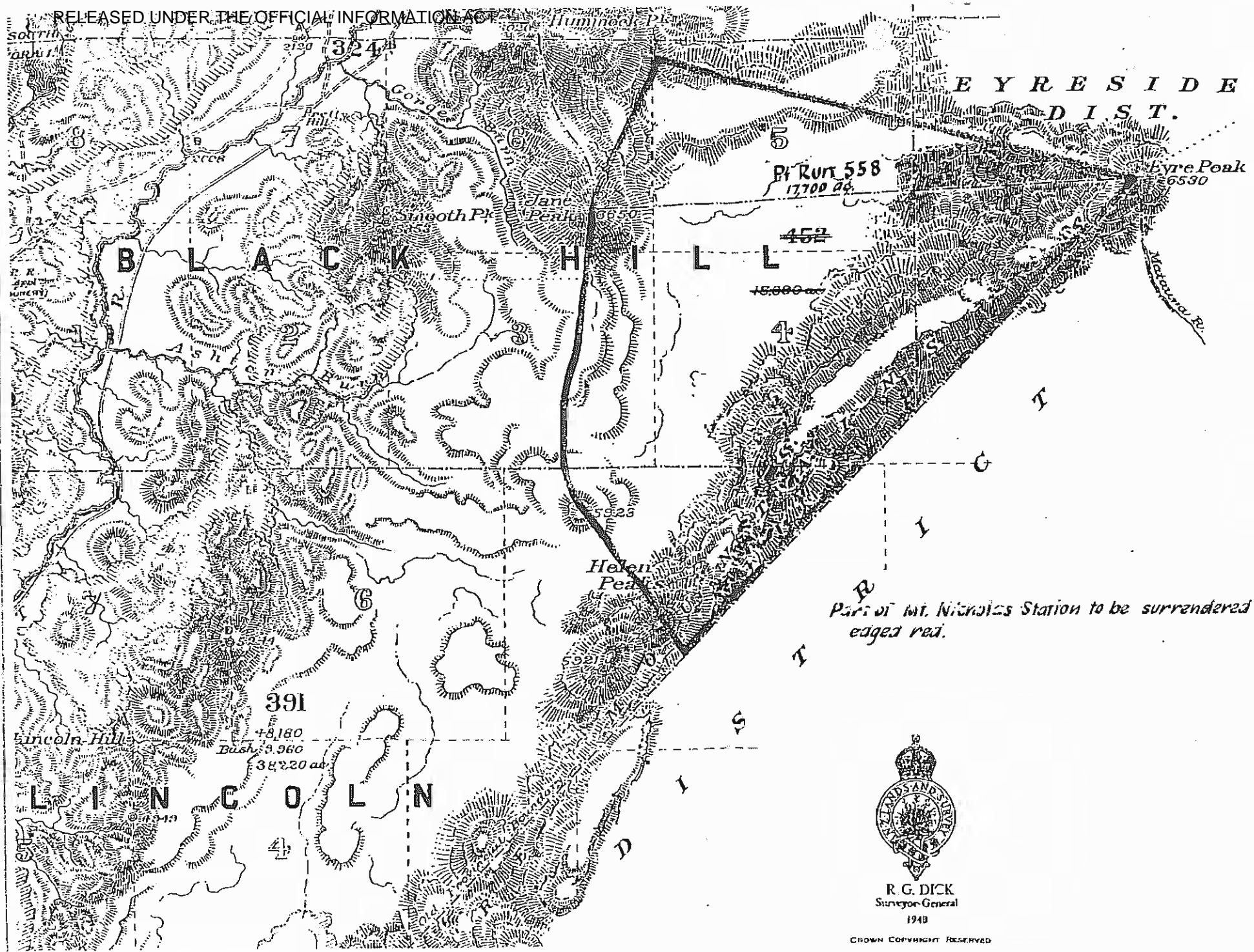

R. G. DICK
Surveyor-General
1940

CROWN COPYRIGHT RESERVED

From: LAND INFORMATION DEPARTMENT OFFICIAL INFORMATION #19-088-2099-12-10-#514 P.002/015