

Crown Pastoral Land Tenure Review

Lease name: MT NIMROD

Lease number: PT 094

Public Submissions - Part 3

These submissions were received as a result of the public advertising of the Preliminary Proposal for Tenure Review.

November

10

Submission 10



South Canterbury Tramping Club
PO Box 221
Timaru

Mike Todd
Opus International Consultants
PO Box 1482
Christchurch 8140

Dear Mike

Re: Tenure Review of Mt Nimrod Pastoral Lease

On behalf of the South Canterbury Tramping Club I would like to comment on the proposal for the tenure review of Mt Nimrod Pastoral Lease.

The South Canterbury Tramping Club, with a membership of approx 66, regularly visit this area, particularly the Scenic reserve. Mt Nimrod has superb views all around South Canterbury and beyond and we would value having permanent and year round access through this area. The proposed access a-b-c would be used by our members but we would like to also see a poled route across to the top of the Matata Reserve as this would allow a trip up the Nimrod Scenic reserve and down the Matata Reserve or vice versa. Access off the main track b-c to the high points along the ridge would be desirable as these would be good destinations for those not going as far. This proposed easement a-b-c says it is to provide access for public foot, horse and non-motorised vehicle access but as access to it is through the Nimrod Reserve it is only practical for foot access. Mountain bikes and horses need an alternative to get to point b. We are happy that motorized vehicles are not included in this access easement.

Using access a-b-c to get to the summit of Mt Nimrod is a fairly indirect and long route. We would like to also see a poled route for walking access from the top of the Nimrod Reserve largely following the ridge around to approximately point v. This would be a more direct route and would also allow for a circuit combined with a-b-c.

Indigenous vegetation

The area proposed to be disposed of by freehold disposal has a substantial amount of modified indigenous vegetation, especially in White Rock River up stream from the Reserve and in Nimrod Stream.(see photos).This level of indigenous vegetation is higher than other areas of the Hunter Hills. We feel there needs to be some sort of protective mechanism in place to prevent the best of this from being further degraded and to sustain the "special quality and integrity of the high country landscape". If either one of these areas had special protection it would provide a corridor from the bottom to the top of the range and link the forest and shrubland with the higher tussock grasslands and give some protection over the complete altitudinal range. Restricting grazing to the current level by either a covenant if freehold , or by retaining in Crown ownership with a controlled grazing lease should at least maintain the indigenous vegetation at its current level.

We understand there is a small patch of beech trees in the area above the Matata Reserve. This is unusual for this area and needs to have a protective covenant over it, preferably be fenced and have poled walking access to it.

Fencing

We are pleased that new fencing will be provided where required. We have some concerns about the current fencing around parts of the Nimrod Reserve in particular near the start of the proposed access a-b. According to the map provided the fence is inside the Nimrod Reserve and is certainly within the bush and is subject to damage. This fence line should be replaced following the actual boundary and all other fences made stock proof.

Yours sincerely

A handwritten signature in blue ink, appearing to read 'H Marshall', written in a cursive style.

Hazel Marshall
Secretary
SC Tramping Club



White
Rock
River

↑
SR2

Nimrod
Stream

View from top of Nimrod Reserve

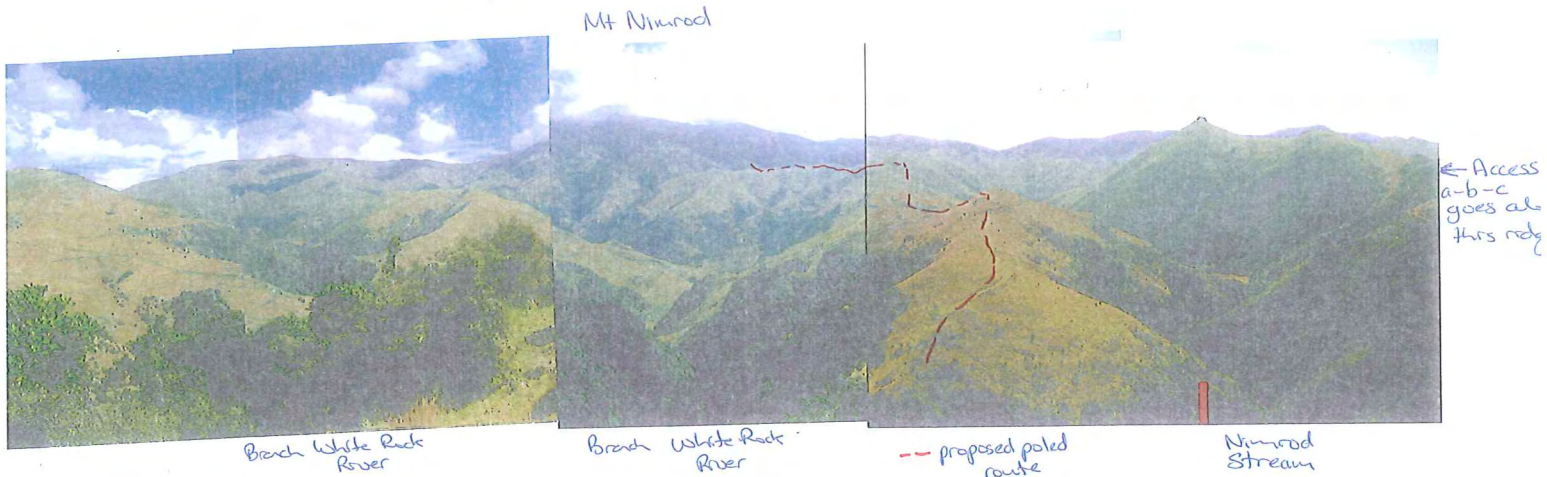

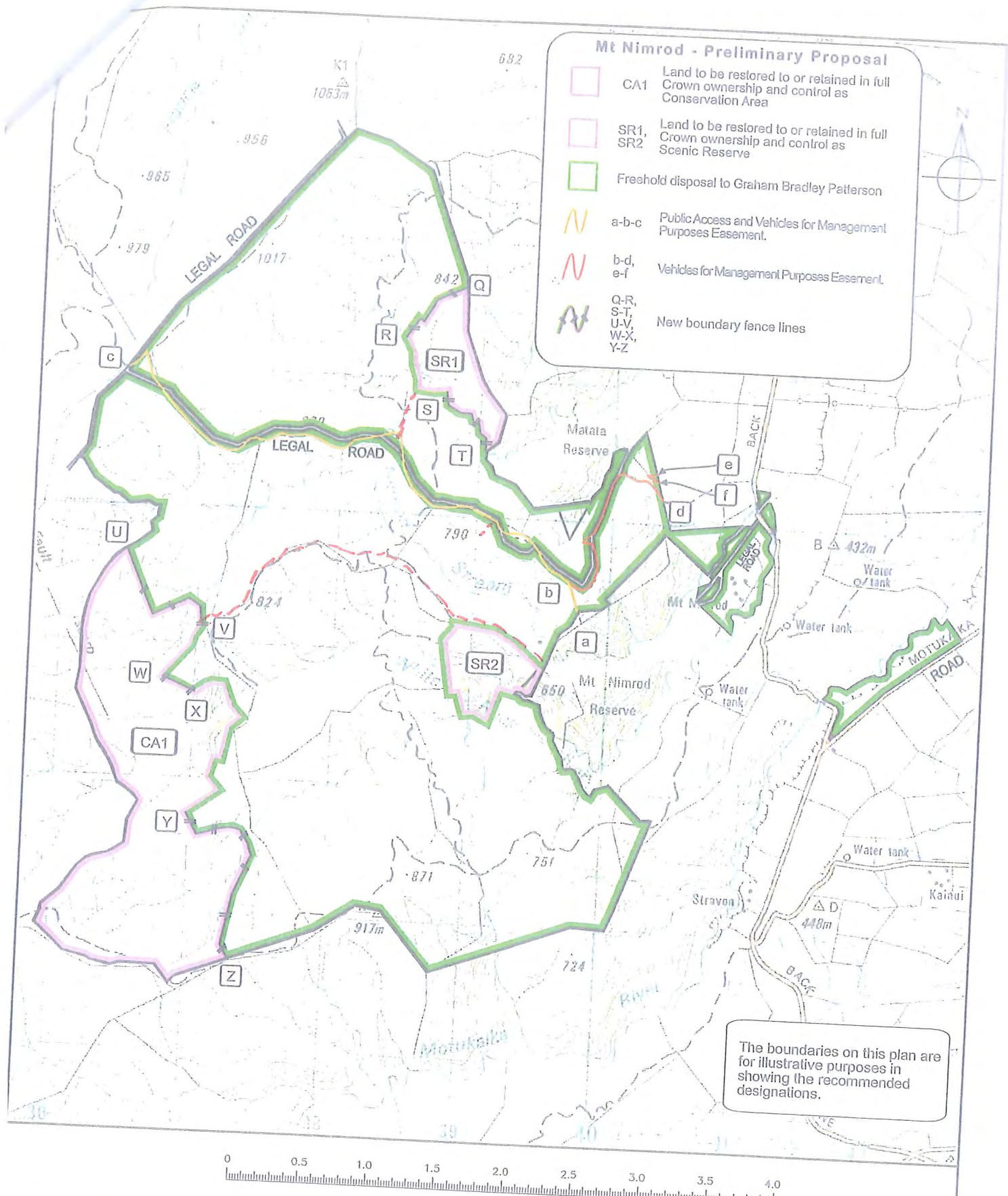

The boundaries on this plan are for illustrative purposes in showing the recommended designations.

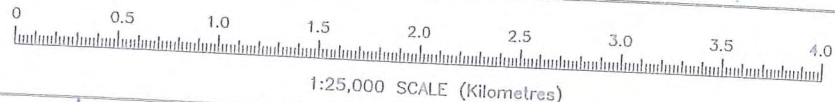

GP
GLASSON POTTS FOWLER
207, Armagh, 197 Armagh Street, Christchurch 8031, New Zealand
Ph (03) 374-8515 Fax (03) 374-8510 P.O.Box 13875 Email: cfb@gpf.co.nz

MT NIMROD
(R.S.41210 & R.S.41211, Pts.RESERVE 3346 & Pts RUN 305)
Excludes All Legal Roads and Marginal Strips (If Any)
Topographic Map 260 - J39

Canterbury Land District
Scale : 1:25,000@A3
Date : August 2002
Drawing No.: 7588-03A
Sheet No. of Sheets

--- suggested poled routes

Submission 11

Chris Pearson
5322 Whitetail Dr #9
Springfield IL 62703
USA
PH 217 585 6803

Monday, March 15, 2010

Commissioner of Crown Lands
C/- Mike Todd
Opus International Consultants Ltd
POBox 1482
Christchurch 8140

To Whom it may concern

I would like to make the following submission for Preliminary Proposal for the Mt Nimrod Pastoral Lease which is undergoing tenure review under the Crown Pastoral Land Act 1998. I strongly support the proposal I would like to express the wish that they be fully adopted. I am somewhat familiar with this area as a geodesist measuring earth deformation activity across the South Island while working for the University of Otago in the 1990s. From a public recreation point of view the area CA1 in the designations plan and the public access route a-b-c from the Mt Nimrod to the top of the range is likely to be the most valuable part of the lease for tramping and incorporating this with the adjacent conservation lands will significantly increase the scope for outdoor recreation in Hunter Hills. As I understand it, this will provide access to CA1 through from other DOC land acquired Mt Nimrod and other pastoral leases. The area CA1 will provide a nice addition to these DOC lands. It extends up to 1300 m elevation and is primarily natural tussock.

So for these reasons I can give my full support to the proposed tenure review.

Sincerely yours,

Christopher Pearson

Submission 12

From: mike Todd [mike.todd@opus.co.nz]
Sent: Thursday, 18 March 2010 08:12
To: 'Louise Mincher (Christchurch)'
Subject: FW: Tenure Review
image001.jpg

 *Mike J Todd*
Team Leader, Property Consultancy
Opus International Consultants Ltd
mike.todd@opus.co.nz
Tel +64 3 363 2742
Mobile +64 27 233 2307

From: ANNE & RICHARD PATTERSON [mailto:white-rock@farmside.co.nz]
Sent: Thursday, 15 October 2009 10:19 p.m.
To: mike.todd@opus.co.nz
Subject: Tenure Review

White-Rock,
Cannington,
14 R.D.,
CAVE.

12/03/2010,

Mike Todd,
Tenure Review Manager,
Private Bag 1913,
DUNEDIN.

Approximately 37.1367 hectares is to be added to Matata Reserve shown as SR1 on the plan.

This area needs its own access arrangements because Matata Reserve has no legal access at the present time. It is the good will of the present owners that the public get to go over the freehold land to get access to the Matata Reserve. This could be withdrawn at any time.

R.K. Patterson

From: mike Todd [mike.todd@opus.co.nz]
Sent: Thursday, 18 March 2010 08:13
To: 'Louise Mincher (Christchurch)'
Subject: FW: Tenure Review
Attachments: image001.jpg

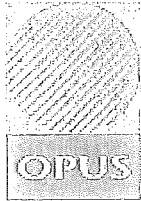

Mike J Todd
Team Leader, Property Consultancy
Opus International Consultants Ltd
Mike.Todd@opus.co.nz
Tel +64 3 363 2742
Mobile +64 27 233 2307

From: ANNE & RICHARD PATTERSON [mailto:white-rock@farmside.co.nz]
Sent: Thursday, 15 October 2009 10:21 p.m.
To: mike.todd@opus.co.nz
Subject: Tenure Review

White-Rock,
Cannington,
14 R.D.,
CAVE.

12/03/2010,

Mike Todd,
Tenure Review Manager,
Private Bag 1913,
DUNEDIN.

The present leasee of the Mt Nimrod Run Block 305 has been very generous in letting people use his four wheel drive tracks but a new owner with Freehold Title (maybe in a few years time) might not be so generous.

The opening up of a four wheel drive track for public use to go up to the Kaumira hunting block would be a good idea. This would give the older people and others that can not make it by any other means a chance to see this wonderful area. The opening of a track for say four months of a year (eg. from say February to May) would probably not interfere with the farming operation too much.

The Kaumira hunting block is very close to the city of Timaru (under 50km by road) so it is important that as many people as possible get to see it. After all, the area is approximately 4,000 ha and having Mt Nimrod in it being the highest point you can see in the Hunter Hills from Timaru.

R.K. Patterson

2010/03/18 08:14

From: mike Todd [mike.todd@opus.co.nz]
Sent: Thursday, 18 March 2010 08:14
To: 'Louise Milner (Christchurch)'
Subject: FW: Tenure Review 1
Attachments: image001.jpg



Mike J Todd
Team Leader, Property Consultancy
Opus International Consultants Ltd
mike.todd@opus.co.nz
Tel +64 3 363 2742
Mobile +64 27 233 2307

From: ANNE & RICHARD PATTERSON [mailto:white-rock@farmside.co.nz]
Sent: Thursday, 15 October 2009 10:23 p.m.
To: mike.todd@opus.co.nz
Subject: Tenure Review 1

White-Rock,
Cannington,
14 R.D.,
CAVE.

15/03/2010,

Mike Todd,
Tenure Review Manager,
Private Bag 1913,
DUNEDIN.

Re: Submission - Tenure Review Mt Nimrod

The horse and non motorized vehicle access easement starting from the Nimrod Reserve – This track is not a suitable access route for horse and rider or non motorized vehicle.

Alternative access routes to Mt Nimrod (Kaumira block) could be the old Bridle Track which goes up through Run 305 leaving from the Nimrod Road or the vehicle access for Management Purposes Easement.

The Bridle Track was built between 1865 & 1870 by the Holme Station run being the land between the Fareora and Otaio rivers. The Bridle Track started from small horse paddock near Mt Nimrod's present homestead. The Bridle Track went over to a point which became known as McVies Hut in the Upper Fareora Gorge area giving access to Dalzell area.

The Dalzell block of land is on the North West side of Mt Nimrod. A lot of this area is now in the Kaumira hunting block.

The Bridle Track was used until 1898 when Thomas Fringle brought Mount Nimrod Run. Then sold to Howells in 1922 and then to K. G. Patterson in 1957. Most of the Bridle Track was bulldozed when K. G. Patterson put in his first hill track in giving four wheel drive access for farm management purposes.

R.K. Patterson

White-Rock,
Cannington,
14 R.D.,
CAVE.

12/03/2010,

Mike Todd,
Tenure Review Manager,
Private Bag 1913,
DUNEDIN.

The Matata Reserve should be linked to the Mt Nimrod Reserve by a pole marked route Public Access Easement.

At present public go into the Matata Reserve heading for the top of Mount Nimrod or Kaumira hunting block, crossing run 305 block, mostly without getting the runholder's permission.

There could be two pole marked routes. One, a shorter one being where the proposed Public Access track passes within 300m of Matata Reserve south end. The second pole marked route could be out from the new area to be added to Matata Reserve (SR1 on map) up to the small patch of beech trees (silver) in the Matata creek water shed; then up to the ridge to legal road on top of the ridge and head south to point C linking it with Kaumira Block.

The small patch of beech trees in the Matata creek water shed should have a protective covenant on it and walking access from the Matata Reserve (pole route). There are very few beech trees in the Hunter Hills with none in the Matata or Nimrod Reserves. This patch of beech is probably the most south east patch in the Hunter Hills and the Canterbury Region. It would certainly be worth protecting and giving the public walking access to the beech trees.

R.K. Patterson

White-Rock,
Cannington,
14 R.D.,
CAVE.

12/03/2010,

Mike Todd,
Tenure Review Manager,
Private Bag 1913,
DUNEDIN.

The present leasee of the Mt Nimrod Run Block 305 has been very generous in letting people use his four wheel drive tracks but a new owner with Freehold Title (maybe in a few years time) might not be so generous.

The opening up of a four wheel drive track for public use to go up to the Kaumira hunting block would be a good idea. This would give the older people and others that can not make it by any other means a chance to see this wonderful area. The opening of a track for say four months of a year (eg. from say February to May) would probably not interfere with the farming operation too much.

The Kaumira hunting block is very close to the city of Timaru (under 50km by road) so it is important that as many people as possible get to see it. After all, the area is approximately 4,000 ha and having Mt Nimrod in it being the highest point you can see in the Hunter Hills from Timaru.

R.K. Patterson

Richard Patterson

White-Rock,
Cannington,
14 R.D.,
CAVE.

15/03/2010,

Mike Todd,
Tenure Review Manager,
Private Bag 1913,
DUNEDIN.

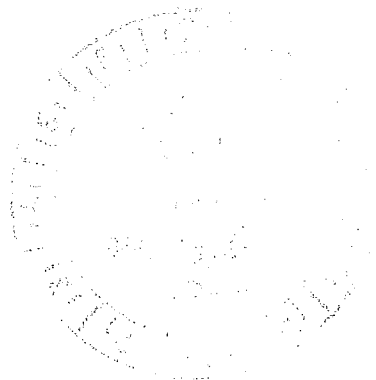

Re: Submission - Tenure Review Mt Nimrod

The horse and non motorized vehicle access easement starting from the Nimrod Reserve – This track is not a suitable access route for horse and rider or non motorized vehicle.

Alternative access routes to Mt Nimrod (Kaumira block) could be the old Bridle Track which goes up through Run 305 leaving from the Nimrod Road or the vehicle access for Management Purposes Easement.

The Bridle Track was built between 1865 & 1870 by the Holme Station run being the land between the Pareora and Otaio rivers. The Bridle Track started from small horse paddock near Mt Nimrod's present homestead. The Bridle Track went over to a point which became known as McVies Hut in the Upper Pareora Gorge area giving access to Dalzell area.

The Dalzell block of land is on the North West side of Mt Nimrod. A lot of this area is now in the Kaumira hunting block.

The Bridle Track was used until 1898 when Thomas Fringle brought Mount Nimrod Run. Then sold to Howells in 1922 and then to K.G. Patterson in 1957. Most of the Bridle Track was bulldozed when K.G. Patterson put in his first hill track in giving four wheel drive access for farm management purposes.

R.K. Patterson

White-Rock,
Cannington,
14 R.D.,
CAVE.

12/03/2010,

Mike Todd,
Tenure Review Manager,
Private Bag 1913,
DUNEDIN.



Approximately 37.1367 hectares is to be added to Matata Reserve shown as SR1 on the plan.

This area needs its own access arrangements because Matata Reserve has no legal access at the present time. It is the good will of the present owners that the public get to go over the freehold land to get access to the Matata Reserve. This could be withdrawn at any time.

R.K. Patterson

A handwritten signature in cursive script that reads "Richard Patterson".

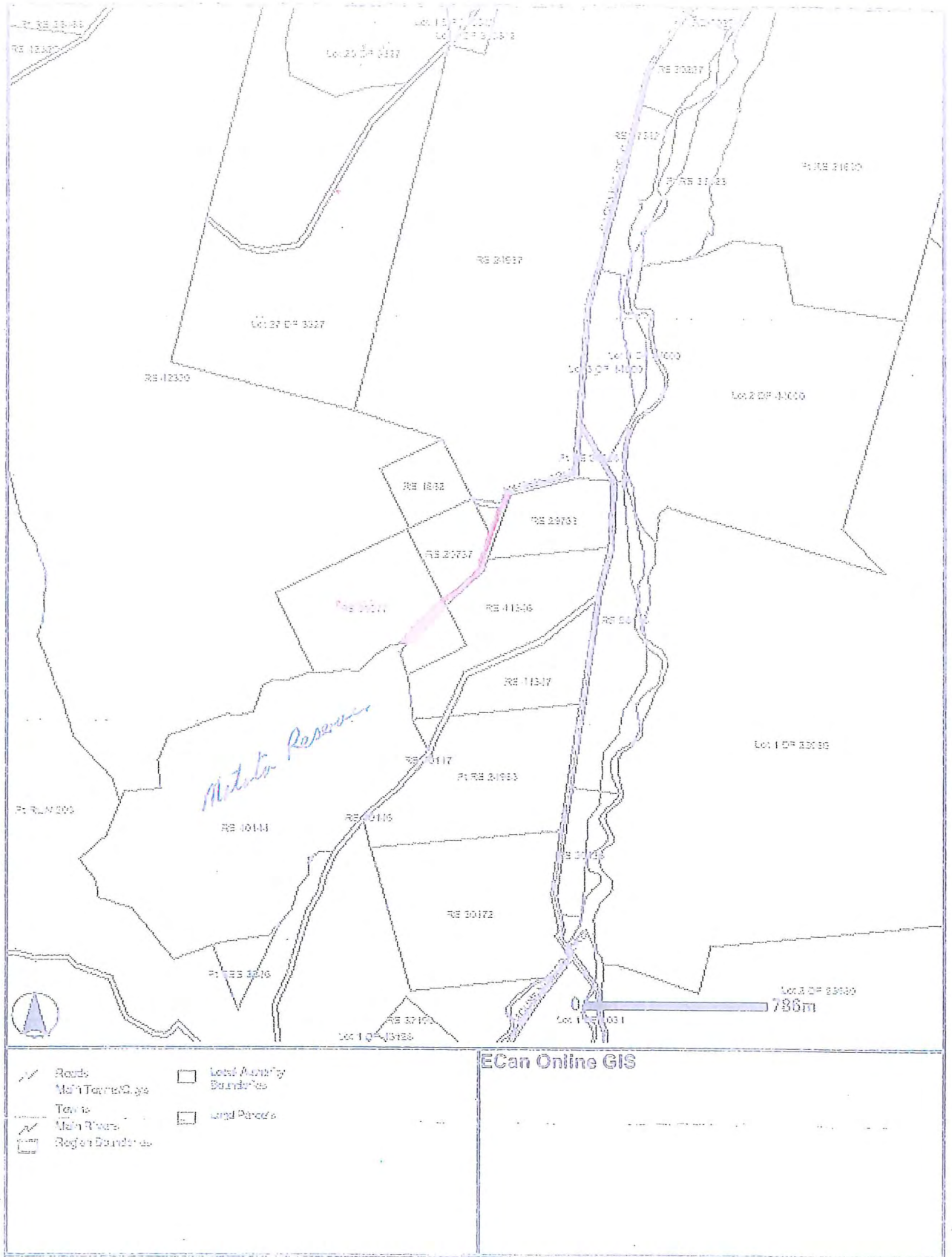

Freehold.
----- Pole market route to Mitata Reserve

White-Rock,
Cannington,
14 R.D.,
CAVE.

15/03/2010,

Mike Todd,
Tenure Review Manager,
Private Bag 1913,
DUNEDIN.

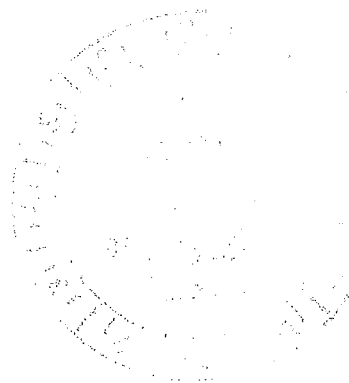

Re: Submission - Tenure Review Mt Nimrod

The horse and non motorized vehicle access easement starting from the Nimrod Reserve – This track is not a suitable access route for horse and rider or non motorized vehicle.

Alternative access routes to Mt Nimrod (Kaumira block) could be the old Bridle Track which goes up through Run 305 leaving from the Nimrod Road or the vehicle access for Management Purposes Easement.

The Bridle Track was built between 1865 & 1870 by the Holme Station run being the land between the Pareora and Otaio rivers. The Bridle Track started from small horse paddock near Mt Nimrod's present homestead. The Bridle Track went over to a point which became known as McVies Hut in the Upper Pareora Gorge area giving access to Dalzell area.

The Dalzell block of land is on the North West side of Mt Nimrod. A lot of this area is now in the Kaumira hunting block.

The Bridle Track was used until 1898 when Thomas Fringle brought Mount Nimrod Run. Then sold to Howells in 1922 and then to K.G. Patterson in 1957. Most of the Bridle Track was bulldozed when K.G. Patterson put in his first hill track in giving four wheel drive access for farm management purposes.

R.K. Patterson

Richard Patterson