

Crown Pastoral Land Tenure Review

Lease name : RAMSHEAD RUN

Lease number : PM 024

Due Diligence Report (including Status Report) - Part 3

This report and attachments results from a pre-Tenure Review assessment of the pastoral lease for the purpose of confirming land available for Tenure Review and any issues, rights or obligations attaching to it. The information is gathered from files and other sources available to the LINZ contractor.

Part of the information relates to research on the status of the land, resulting in a Status Report that is signed off by a LINZ approving officer. The remainder of the information is not analysed for relevancy or possible action until required, and LINZ does not guarantee its accuracy or completeness as presented.

The report attached is released under the Official Information Act 1982.

July 09

Los 5534

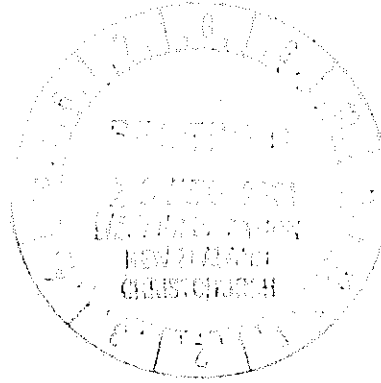

Bob

LAND STATUS REPORT

RAMSHEAD

**for
Tenure Review**

**Prepared by Don McGregor McGregor Property Services
for and on behalf of Q.V.Valuations**

February 2001

CONTENTS

1. APPENDIX A – LAND STATUS REPORT and supporting plans

- SO Plans (additional)
- Extract of CLR
- Extracts of Allocation Maps
- DOC Consultation
- Information Supporting Mineral Ownership Investigation
- Other Information
- Information Supporting Notes to Report

2. APPENDIX B – LAND STATUS REPORT (Certified Correct by Chief Surveyor)

APPENDIX A – LAND STATUS REPORTS and supporting plans

APPENDIX A

**Q V VALUATIONS
CHRISTCHURCH OFFICE**

Project Number QVV 64

This report has been prepared on the instruction of Land Information New Zealand in terms of Contract No. 50241 dated 6 November and is undertaken for the purposes of the Crown Pastoral Act 1998.

LAND STATUS REPORT for Ramshead Tenure Review	LIPS Ref : 12641
Property 1 of 1	

Land District	Marlborough.
Legal Description	Part Section 2, Block XXIV, Avon Survey District and Section 1, S.O. 6741.
Area	2346.1402 hectares.
Status	Crown land subject to the Land Act 1948.
Instrument of title / lease	Balance Pastoral Lease CL 1A/1033 pursuant to Section 66 and registered under Section 83 of the Land Act 1948 as varied by Memorandum of Renewal 184034.
Encumbrances	<p>Subject to:</p> <ol style="list-style-type: none"> 86262 Encumbrance to the Marlborough District Council (as successor to the Marlborough County Council) as varied by Partial Discharge of Encumbrance 142453 requiring the Council's prior consent to Transfer, lease or otherwise deal with certain lands except in conjunction with the Pastoral lease. 107938 Land Improvement Agreement under Section 30 of the Soil Conservation and Rivers Control Act 1941. Gazette Notice 154889 (N.Z. Gazette 1990 p3738) declaring part (651.7650 hectares) marked "A", "B" and "O" on DP 7395 to be protected private land for scenic purposes subject to the Reserves Act 1977. 194369 Transfer granting a Forestry Right under the Forestry Rights Registration Act 1983 to PGG Trust Limited for a term of 30 years from and inclusive of 7 May 1997 and expiring on 6 May 2027. Part IVA of the Conservation Act 1987, upon disposition.
Mineral Ownership	<p>The Mines and Minerals are owned by the Crown over a significant part of the land because it has never been alienated from the Crown since its acquisition for settlement purposes from the former Maori owners under the 1859 Kaikoura Deed of Purchase.</p> <p>Those parts Crown Granted in 1863 into private ownership were subsequently acquired by the HMK as Crown land subject to the Land Act in 1916 as part of an exchange proposal. The land was not acquired as a public work therefore the Crown is at liberty to invoke the standard</p>

	Mineral restrictions.
Statute	Land Act 1948 and Crown Pastoral Land Act 1998

Data Correct as at [Certification Attached]	18 February 2001 Yes
--	-------------------------



Prepared by Crown Accredited Supplier	Don McGregor, McGregor Property Services Limited for and on behalf of Q V Valuations
--	---

<p>NOTES: This information does not affect the status of the land but was identified as possible requiring further investigation at the due diligence stage: See Crown Pastoral Standard 6</p>	<p>1). As part of the Protected Private land area (registered as Gazette Notice 154889) the lessee agreed to the provision of a ROW to the Crown for practical access along the Dillon Creek to the Conservation land beyond (former Pastoral Occupation Licence area) as shown "C - N" on D.P. 7395. While some preliminary action has been undertaken this ROW has not been created.</p> <p>2). The original stock limitation is not recorded on the lease.</p> <p>3). Transfer 9586 dated 2 April 1928 created in favour of the Crown and its lessees an appurtenant Right of Way easement across the adjoining freehold (originally "Tynterfield"). This ROW is not registered against the lease and it is likely that the subject lands have been affected by further subdivision.</p> <p>4). An application for the operation of a tramping track with unguided walks was received from the lessee on 24 January 2000. There has been correspondence and it appears that the application is still being processed.</p>
---	--

LAND STATUS REPORT for Ramshead Tenure Review	LIPS Ref 12641
Property 1 of 1	

Research Data: *Some Items may not be applicable*

SDI Prints Obtained	Yes.
NZMS 261 Ref	O29, P28 and P29.
Local Authority	Marlborough District Council.
Crown Acquisition Map	Kaikoura Deed of Purchase.
SO Plans	<p>SO 4608 – Plan of Section 2, Block XXIV, Avon SD also Run 228, Blocks XXIV and XXV, Avon SD and Blocks VII and VIII Hodder SD. (Approved 18 March 1963).</p> <p>SO 6639 – Plan DOC Allocations (Approved 21 August 1987).</p> <p>SO 6640 – Plan DOC Allocations (Approved 21 August 1987).</p> <p>SO 6741T – Plan of Sections 1 and 2 (Approved 28 September 1988).</p> <p>SO 7182 – Plan of Waterways in P24 along which Section 24 Conservation Act 1987 applies.</p> <p><i>Other Plans</i></p> <p>DP's 740, 744 and 745 – Plans of Part Leefield Estate and Part Exchange of Blocks XVIII XXIII XIV and XXIV Avon SD. (Approved 24 March 1919).</p> <p>DP 7395 – Plan of Protected Private lands and Rights of Way over Part Section 2, Block XXIV Avon SD and Section 1, S.O.6741. (Approved 17 January 1989).</p>
Relevant Gazette Notices	NZ Gazette 1963 p1307 (Proclamation 40419) Closed parts of the Road (Crown Grant Road to Dillons Run).
CT Ref / Lease Ref	CL 1A/1033 pursuant to Section 66 and registered under Section 83 of the Land Act 1948 as varied by Memorandum of Renewal 184034.
Legalisation Cards	Searched. Not applicable.
CLR	Confirms Pastoral lease tenure.
Allocation Maps (if applicable)	SO's 6639 and 6640. No allocations to DOC or SOE's. Adjoining land allocated to DOC by Allocation O29-4 CO.
VNZ Ref – if known	VR 20311/22706.
Crown Grant Maps	Parts Crown Grant G1/29 (No 125) and 2/39 (394). Copies attached.

<p>If Land Marginal Strip:</p> <p>a) Type [Sec 24(9) or Sec 58]</p> <p>b) Date Created</p> <p>c) Plan Reference</p>	<p>a) Section 58 along Omaka River deemed to be Marginal strip. Specific appellations given to strips as shown on plan below. Section 24(9) along Dillon Creek.</p> <p>b) 6 December 1993 (SO 6741). 21 November 1995(SO 7182).</p> <p>c) SO 4608 (Sections 3 and 4). SO 7182.</p>
---	--

LAND STATUS REPORT for Ramshead Tenure Review		LIPS Ref 12641
Property 1 of 1		
<i>Search continued.</i>		
If Crown land – Check Irrigation Maps	Searched – Not applicable.	
Mining Maps	Searched – Not applicable.	
If Road a) Is it created on a Block Plan – Section 43(1)(d) Transit NZ 1989 b) By Proc	a) SO Plan 4608 – (along Dillon Creek and right bank of the Omaka River). b) Not applicable. c) Not applicable.	
Other relevant information a) Concessions – Advice from DOC or Knight Frank. b) Subject to any provisions of the Ngai Tahu Claims Settlement Act 1998 c) Mineral Ownership	<p>a) No current DOC interests apart from Marginal strips.</p> <p>Existence of concessions administered by Knight Frank not determined.</p> <p>b) Searched – Not applicable</p> <p><input checked="" type="checkbox"/> Mines and Minerals are owned by the Crown in respect of parts of the current lease because the land has never been alienated from the Crown since its acquisition for settlement purposes from the former Maori owners under the 1859 Kaikoura Deed of Purchase.</p> <p>However parts of the lease have previously been held in private ownership. Following the Crown's purchase occupation licences were granted over Dillons Run. In 1863 Crown Grants were issued over part of the Run to Dillon [Crown Grants G1/29 (125) and 2/39 (394)]. The Crown Grant sections were "gridironed" by Crown Grant roads.</p> <p>In 1916 some 2192 acres of Dillons freehold was acquired by His Majesty the King by Conveyance 23030 (Deeds Index 5/36 and Deeds Register 30/474 attached record the details) in exchange for 2428 acres of Crown land being granted to Dillon (refer C's T 21/83, 23/127 and 128 attached). Following the exchange the land was let on Pastoral tenures culminating in the current lease (CL 46/158, 46/185 and CL 1A/1033). Prior to the issue of the current Pastoral lease in 1963 the "gridironed road" was closed by NZ Gazette 1963 p1307.</p> <p>Since the affected Crown Grant lands were granted prior to the first Public Works Act legislation (1882) and the land was not acquired for a public work in 1916, but as Crown Land subject to the then Land Act to facilitate an exchange, the Crown is at liberty to invoke the standard mineral restrictions.</p>	
d) Other Info	d) Not applicable	

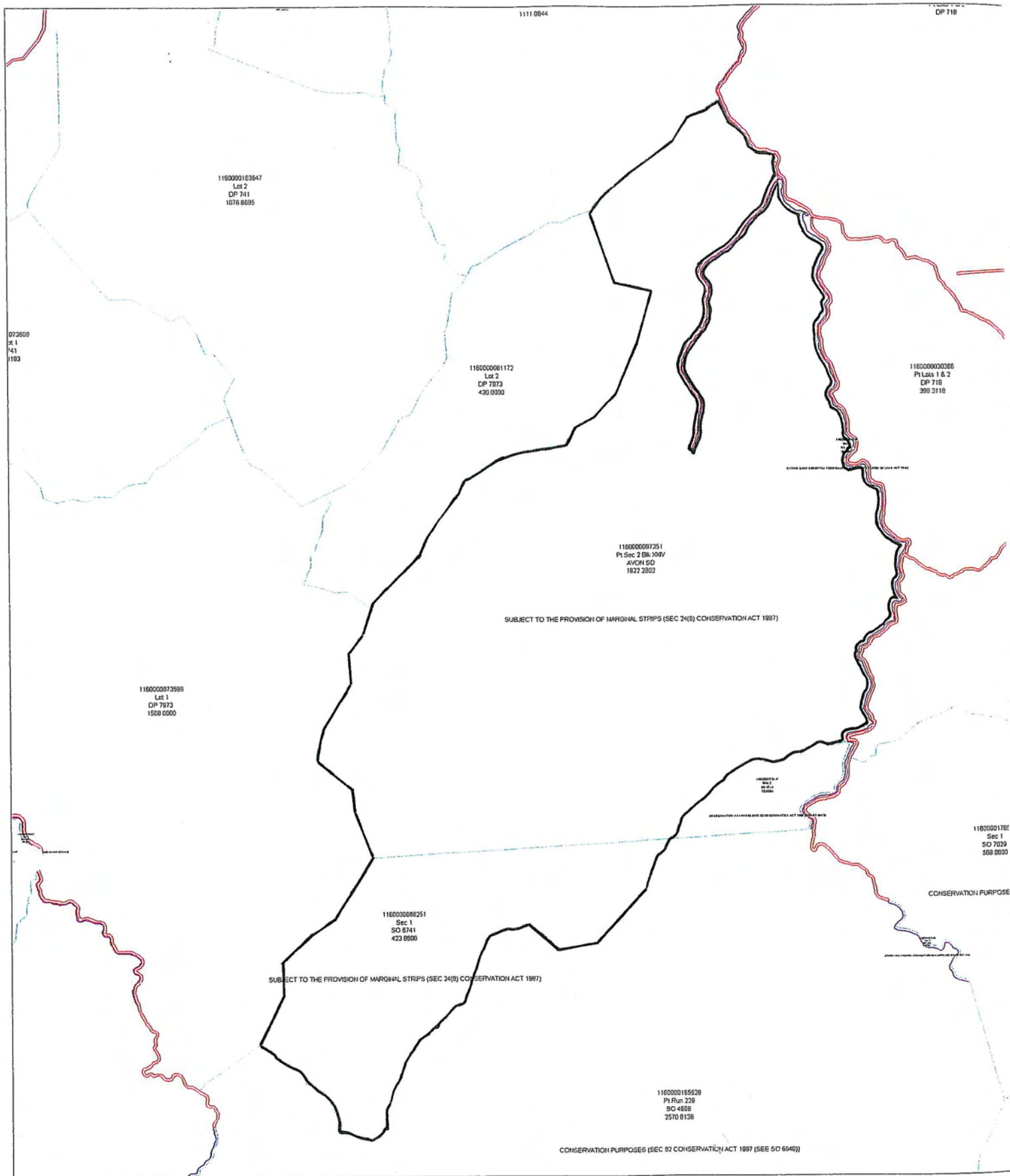

SEC 1 SO 6741

TERRALINK NZ LTD(Terraview)-DCDB Data as at 01.05.99>Title & VNZ data as at 01.05.99.Geodetic data as at 11.10.97.
Cadastral Information from LINZ Digital Cadastral Database (DCDB). CROWN COPYRIGHT RESERVED.

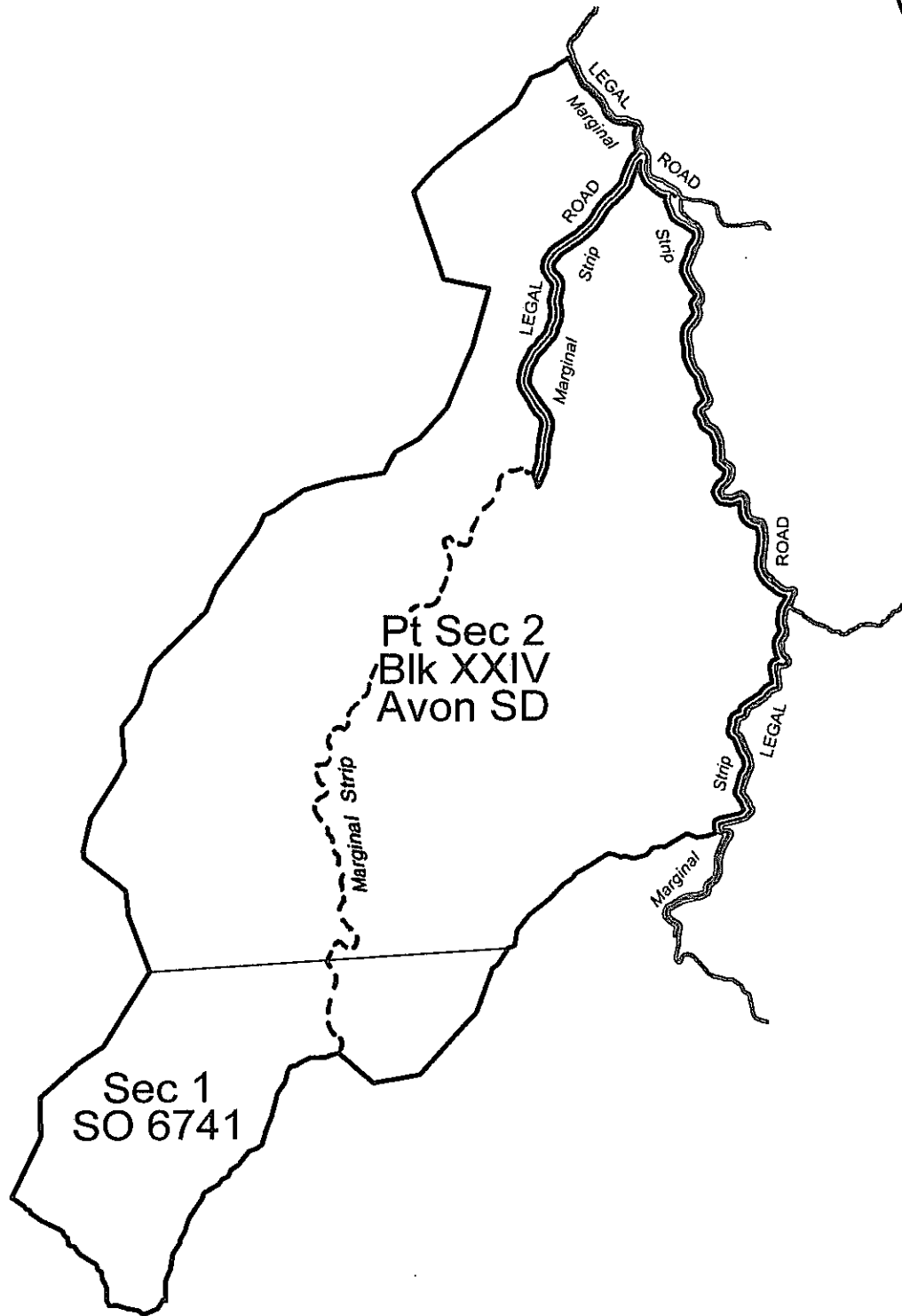
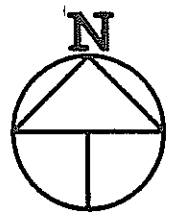

Marginal Strip Subject to Sec 24(9)
Conservation Act 1987 - - - - -

Version	1	2	3	4	5
Marlborough Land District					
Topographic Map 260 - O29,P28,P29					
Sheet 1 of 1					
Date 20/10/00					

Ramshead

Scale 1:50000

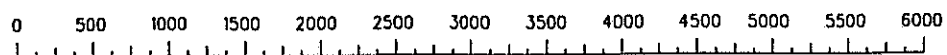



Pf Sec 2
Bik XXIV
Avon SD

Sec 1
SO 6741

Version	1	2	3	4	5
Marlborough Land District			Sheet 1 of 1		
Topographic Map 260 - O29,P28,P29			Date 20/10/00		

Marginal Strip Subject to Sec 24(9)
Conservation Act 1987 -----

Ramshead

Scale 1:50000

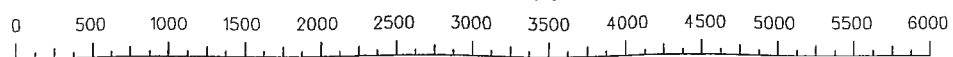

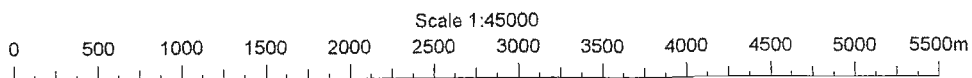

TERRALINK NZ LTD(Terraview)-DCDB Data as at 01.05.99Title & VNZ data as at 01.05.99.Geodetic data as at 11.10.97.
Cadastral Information from LINZ Digital Cadastral Database (DCDB). CROWN COPYRIGHT RESERVED.

SO Plans (additional)

740

AVONDALE
 (de Vroeg Technische School)
 D.P.E.E. (Africans)

Lot 1

Sheet 2	1482-0-00	Original Freehold & Closed Road
1	3248-0-00	
1	536-0-00	
6	1161-0-00	Leaschold Freehold
Total	6428-0-00	& Closed Road

XXIII

Pt. Lot 1
3248-0-00

Note
For diagram see
the OF 7434

1. Дружеское И. И. Д. И.

Fishes mark by us
A. tricolor
L. ...
L. ...

[illegible]

Received of Gloucester the sum of £10 on account of rent of the house at Gloucester the 1st day of January 1871

MALBOROUGH COUNTY

536-C-00
(Original Leasehold)

PT Sec 1, Bldg XIV
CT 21/183

Run 103

Pt Run 110

PLAN OF
SUBDIVISION PART LEEFIELD EST.

I Bik XXIII *Olion's Run* COMPRISING I-XXIV *Washburn & D.*
Secs. 45, 46, 47, 50, 51, 52, 53, 54, 55, 56, Pt Secs. 43, 44, 42, 48, 49, 57

AND PART EXCHANGE
BLOCKS XVIII, XXIII, XIV, XXIV.

AVON S.D.

SURVEYED BY
WELLS NEWTON.

740

Christchurch & Glenferry

Scale: 10 Chs. = 1 Inch.

HODDER 9.0

HODDER 89

DATE OF PHOTOGRAPHY
21 / 3 / 1973

“RELEASED UNDER THE OFFICIAL INFORMATION ACT”

744

Reported two red
 top of ...
 ...
 ...

Approved: 7-11-2010

 General

TYNTESFIELD
(E.F.J. Grigg Esq.)

[illegible][illegible]

Handwritten: At North New York
Second Survey
Luther and Joseph

Alfred

[illegible]

PLAN OF
SUBDIVISION PART LEEFIELD EST.

SECS 23, 24, 33, 34 PT SECS 26, 36 & PORTION OF BLK 8 LOTS 1 TO 10 BUXIX & CLOSED ROADS
COMPRISING
& PART EXCHANGE
BLOCKS XIV & XIX
AVON S.D.
SURVEYED BY

Handwritten notes:
- Dillingham Run, Matapan
- Matapan, Matapan
- 46 acres

A. WELLS NEWTON,
 Licensed Surveyor
 Christchurch & Bournemouth
 Scale: 10 Chains = 1 Inch.

744

"RELEASED UNDER THE OFFICIAL INFORMATION ACT"

DATE OF PHOTOGRAPHY
21/3/1973

DATE OF PHOTOGRAPHY
12/17/73

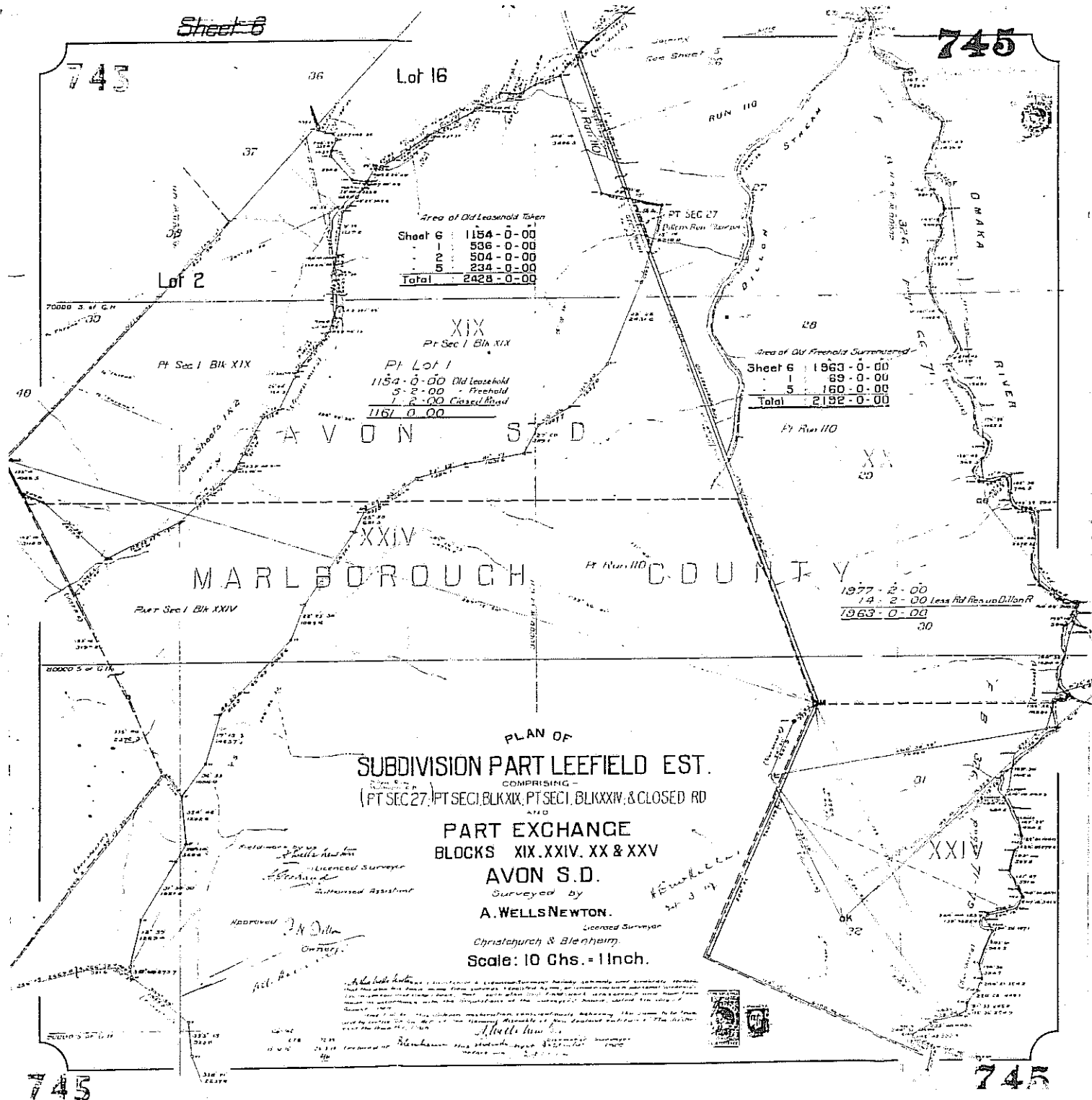
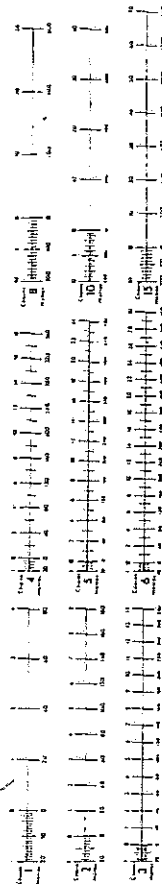

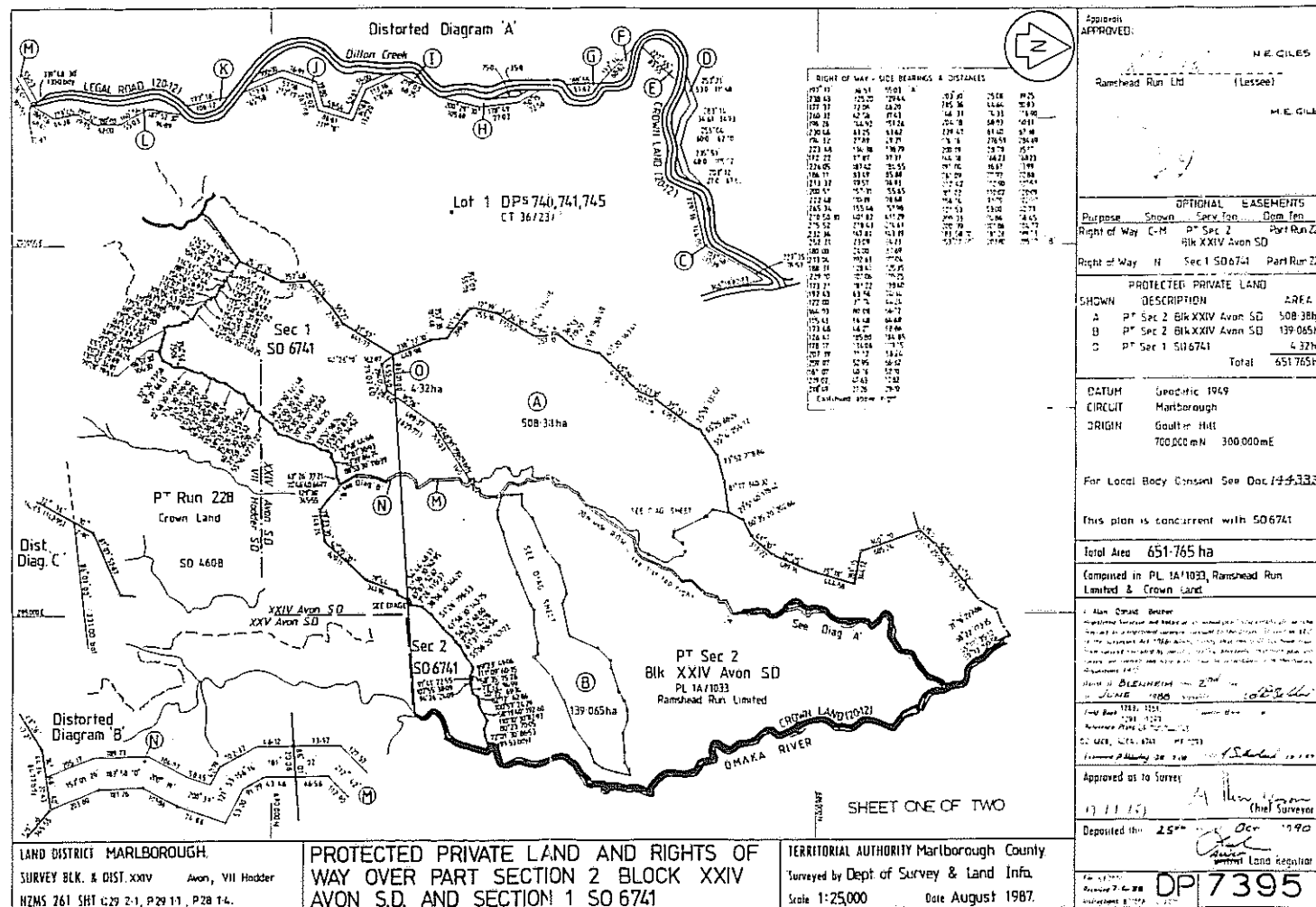

Approved: N.E. GILES

Ramshead Run Ltd (Lessee)

M.E. GILES

OPTIONAL EASEMENTS

Purpose	Shown	Sec 1	Sec 2	Part Sec 2
Right of Way	C-M	PT Sec 2	PT Sec 2	Part Run 228
Right of Way	H	Sec 1 SO 6741	Part Run 228	

PROTECTED PRIVATE LAND

Shown	Description	Area
A	PT Sec 2 Bk XXIV Avon SD	508.38ha
B	PT Sec 2 Bk XXIV Avon SD	139.065ha
C	PT Sec 1 SO 6741	4.32ha
Total		651.765ha

DATUM: Geodetic 1949
CIRCUIT: Marlborough
ORIGIN: Gaultier Hill
700,000 mN 300,000 mE

For Local Body Consent See Doc 14/333

This plan is concurrent with SO 6741

Total Area 651.765 ha

Composed in PL 1A/1033, Ramshead Run Limited & Crown Land

1. Alan O'Donnell, Engineer
Completed Survey and Plan of the Protected Private Land and Rights of Way over Part Section 2 Block XXIV Avon S.D. and Section 1 SO 6741 in accordance with the provisions of the Land Information Act 1984. The Survey and Plan were completed on 11/11/87. The Survey and Plan were submitted to the Department of Survey & Land Information for approval on 11/11/87. The Survey and Plan were approved by the Department of Survey & Land Information on 11/11/87.

Surveyed by: BLENHEIM on 27/11/87

11/11/87

Approved as to Survey: A. H. H. (Chief Surveyor)

Deposited this 25th Dec 1987

Land Registrar

DP 7395

Extract of CLR

[illegible]

Blocks: XXIII, XXIV, XXV Avon S. D.

28 NOV 1986

DESCRIPTION:

Section 2, Block XXIV, Avon S.D.

✓ S.O. PLAN: 11008				AREA: 1930		1995-1002 ha					
						AC 0 RL 00 PL					
OPENED FOR SELECTION		S. Plan or File	Class	Date of Disposal	Folio/R.Y.	Ann. Rent at Instalment	Term (Years from)	Tenure/ Lease No.	SELECTION		
Gazette Year	Page										
				1-1-83	-	\$180.00	20.2.1.1.1.1	10/24	Randhurst Real Ltd.		
<div style="text-align: right;"> R28/1-4 0.29/24 0.29/21 REC MAP Marl. City </div>											
FREEHOLD TITLE				RESERVATIONS							
160	No.	Vol.	Folio	Gazette		PURPOSE	Vested		Control Vested		IN WHOM VESTED
				Year	Page		Year	Page	Year	Page	
C.O.P.	-										
Warrant	-										
C.C.L's Cert.	-										
C/Grant	-										

DESCRIPTION: Section 2, Block XXIV, Avon S.D.

L.A.S.-U.																												
DESCRIPTION: Crown Land (Sec 58 Land Act 1948) adjoining Section 2, Block XXIV, Avon Survey District																												
S.D. PLAN: 4508						AREA: Ha/m ²																						
OPENED FOR SELECTION																												
Gazette		S. Plan or File	Class	Date of Disposal	Price/B.Y.	Ann. Rent or Instalment	Term (Years from)	Term's/ Lease No.	SELECTOR																			
Year	Page																											
FREEHOLD TITLE						RESERVATIONS																						
<table border="1" style="width: 100%; border-collapse: collapse;"> <tr> <th rowspan="2">No.</th> <th rowspan="2">Vol</th> <th rowspan="2">Folio</th> <th colspan="2">Gazette</th> <th rowspan="2">PURPOSE</th> <th colspan="2">Vested</th> <th colspan="2">Control Vested</th> <th rowspan="2">IN WHOM VESTED</th> </tr> <tr> <th>Year</th> <th>Page</th> <th>Year</th> <th>Page</th> <th>Year</th> <th>Page</th> </tr> </table>						No.	Vol	Folio	Gazette		PURPOSE	Vested		Control Vested		IN WHOM VESTED	Year	Page	Year	Page	Year	Page	MARLB. CTY					
									No.	Vol		Folio	Gazette		PURPOSE		Vested		Control Vested		IN WHOM VESTED							
Year	Page	Year	Page	Year	Page																							
C.O.P. - -																												
Warrant - -																												
C.C.L.'s Cert.																												
C/Grant																												
DESCRIPTION: C.L. (Sec 58 Land Act) adj Sec 2 Blk XXIV Avon S.D.																												

10 DEC 1986

SEC No.	REFERENCE TO			SEC No.	REFERENCE TO			SEC No.	REFERENCE TO		
	ACQUISITION	DISPOSAL			ACQUISITION	DISPOSAL			ACQUISITION	DISPOSAL	
		CERT	TITLE			CERT	TITLE			CERT	TITLE
1-22		Not used		27	B/K XIX	Avon S.D.		31	B/K XXV	Avon S.D.	
						CG - CG 2/39				CG - CG 2/39	
23	B/K XIV	Avon S.D.		P427	C. 23030	Now in Run 110			C. 23030	Now in Run 110	
		CG - CG 1856/29									
24	B/K XIX	Avon S.D.		28	B/K XIX	Avon S.D.		32	B/K XXV	Avon S.D.	
		CG - CG 1856/29				CG - CG 2/39				CG - CG 2/39	
					C. 23030	Now in Run 110			C. 23030	Now in Run 110	
25	B/K XIX	Avon S.D.		29	B/K XIX	Avon S.D.		33-37	B/K XIX	Avon S.D.	
		CG - CG 1856/29				CG - CG 2/39				CG - CG 3/361	
P425	C. 23030	Now in Run 110			C. 23030	Now in Run 110					
26	B/K XIX	Avon S.D.		30	B/K XIX	Avon S.D.		38-40	B/K XVII	Avon S.D.	
		CG - CG 1856/29				CG - CG 2/39				CG - CG 3/361	
P426	C. 23030	Now in Run 110			C. 23030	Now in Run 110		41-43	B/K XVII	Avon S.D.	
										CG - CG 3/362	

Dillon's Run, Waihopai R.D.

1 Secs 1 - 43

SEC	REFERENCE TO			SEC	REFERENCE TO			SEC	REFERENCE TO		
	No.	ACQUISITION	DISPOSAL		No.	ACQUISITION	DISPOSAL		No.	ACQUISITION	DISPOSAL
		CERT	TITLE			CERT	TITLE			CERT	TITLE
44-49	B/K XXIII	Avon S.D.									
		CG-CG	3/362								
50-56	B/K XXIII	Avon S.D.									
		CG-CG	3/360								
57	B/K XXIII	Avon S.D.									
		CG-CG	3/360								
457	C 23030	Nowin	Rup 110								

Dillon's Run, Waihopai R. D. - Secs 44-'57

[illegible]

Blocks XXIII, XXIV, XXV Avon S. D.

Sheet.....2 of.....2.....

Sheet 029

SCHEDULE PURSUANT TO SEC 62

CONSERVATION ACT 1987

CLOSED FOR
AMENDMENTS AS
A T.1.3.90 HOW SE
LAKES HILTON

2025 RELEASE UNDER THE OFFICIAL INFORMATION ACT

CERTIFIED CORRECT

CHIEF SURVEYOR

- | NOT USED | | CHIEF SURVEYOR | |
|----------|--|----------------|---|
| 2 | State Forest land allocation approved by Special Ministerial Coordinating Committee on 16 November 1986; | 4 | Crown land and State Forest land allocation approved by the Special Ministerial Coordinating Committee on 21 January 1987; |
| 3 | Crown land allocation approved by the Special Ministerial Coordinating Committee on 3 December 1986; | 5 | NOT USED |
| | | 6 | State Forest land allocations approved by Cabinet following the Blakeley report on West Coast Forests. |
| | | 7 | Crown land and State Forest land allocation approved by the Special Ministerial Coordinating Committee on 11 March 1987. |
| | | 8 | Crown land subject to sections 66A, 67, 68 and 165 Land Act 1948 and unalienated crown land not previously accounted for, approved in accordance with the Special Ministerial Coordinating Committee's decision of 25 March 1987. |

"RELEASED UNDER THE OFFICIAL INFORMATION ACT"

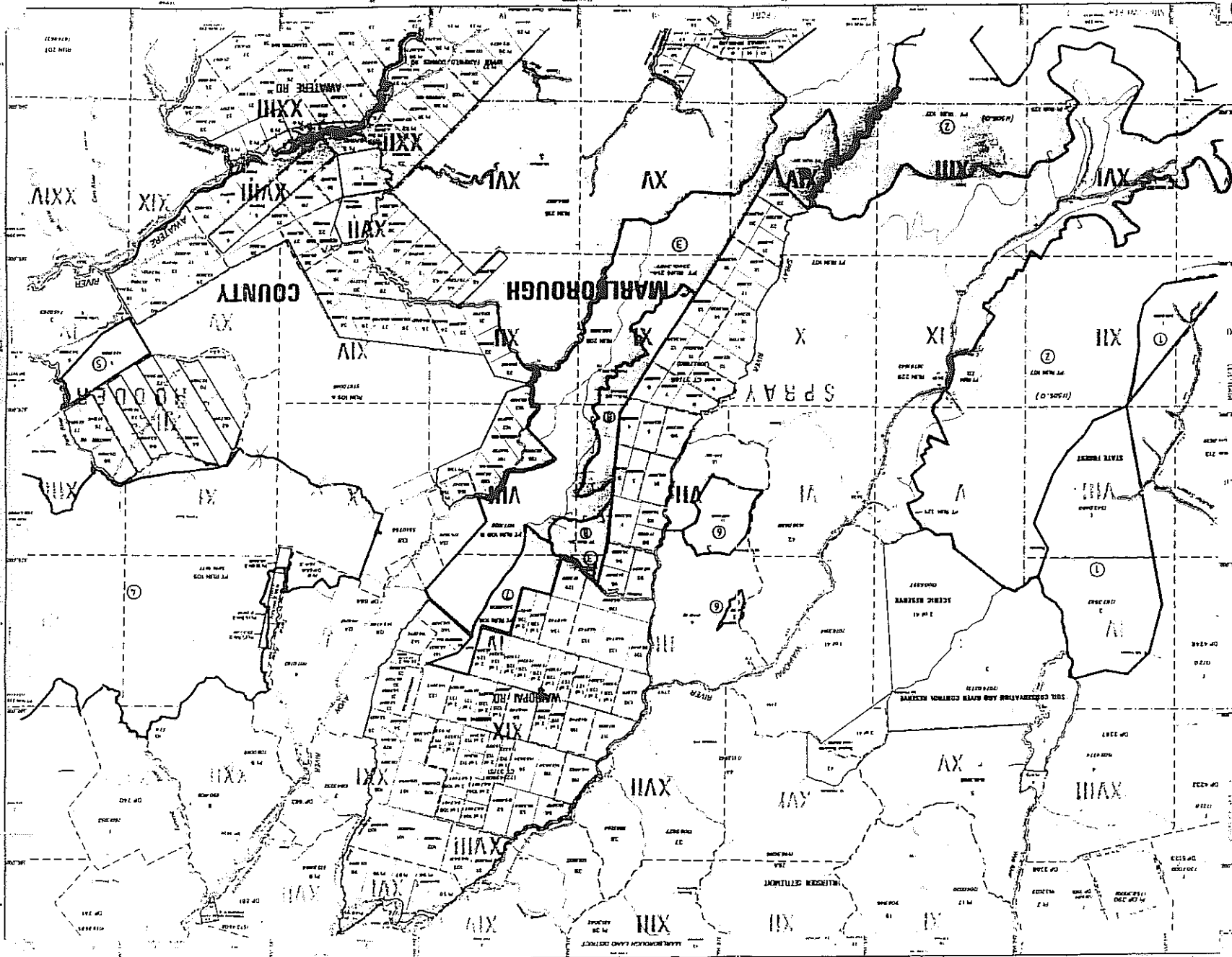
[illegible]

SO 6640

SO 6640

NZMS 261 SHEET P29 & Q29 GR

CONTINUED INFORMATION
NEW ZEALAND MAPS
This map is a reproduction of the original map on which it is based. It is not a substitute for the original map. The original map is the only authoritative source of information. The map is subject to change without notice. The map is not to be used for navigation. The map is not to be used for any other purpose. The map is not to be used for any other purpose.

RELEASED UNDER THE OFFICIAL INFORMATION ACT

NEW ZEALAND MAPS
1:50,000
This map is a reproduction of the original map on which it is based. It is not a substitute for the original map. The original map is the only authoritative source of information. The map is subject to change without notice. The map is not to be used for navigation. The map is not to be used for any other purpose. The map is not to be used for any other purpose.

NZMS 261
SHEET P29 & Q29
GRASSMERE

P+Q29 SO6640 Sht1 of 2

SO 6640

SO 6640
Sheet 1 of 2

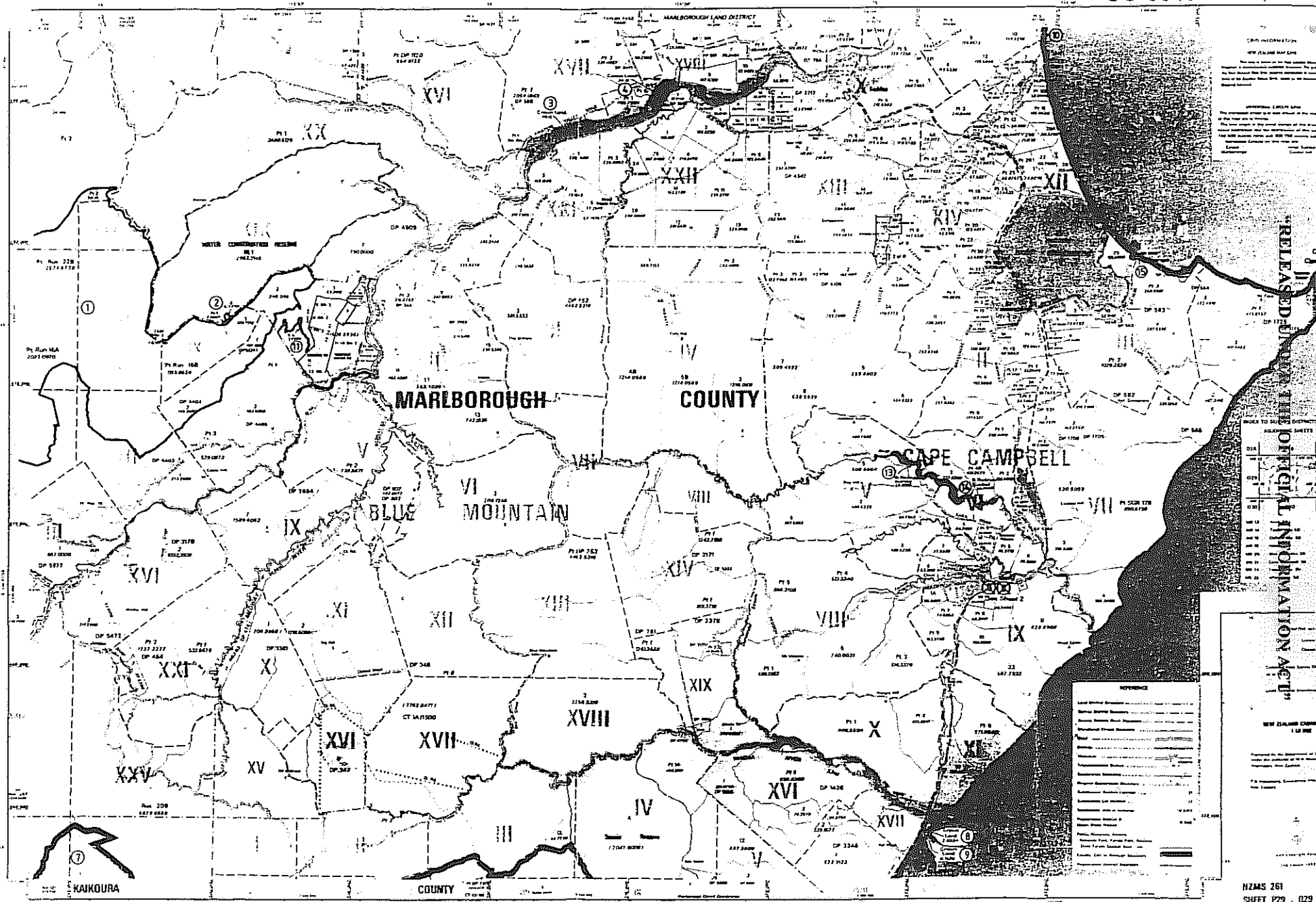

Certified as correct for the purpose of
Section 62 Conservation Act 1953.
Chief Surveyor

DOC Consultation

From: Ratcliffe, Colin NELSON/MARLBOROUGH CO <cratcliffe@doc.govt.nz>
To: 'donmcg@ihug.co.nz' <donmcg@ihug.co.nz>
Date: Monday, 27 November 2000 13:27
Subject: Pastoral Leases

I have finally had a chance to have a look at Camden and Ramshead for you and I can confirm that there is no DOC land within these apart from the Marginal strips,

28/11/00

"RELEASED UNDER THE OFFICIAL INFORMATION ACT"

Information Supporting Mineral Ownership Investigation

1/3/1932
1/3/1934
1/3/1934



No. 299

License to occupy Crown Lands for Pastoral Purposes.

Whereas OLIVE WATSON, wife of William Alexander Watson, LAURIE WATSON, and COLIN WATSON, all of Blenheim, Farmers, have acquired at auction, under the provisions of the Land Act, 1908, and its amendments, a License to occupy for Pastoral Purposes all that area of Crown lands containing by estimation Fourteen thousand (14,000) acres, more or less, and being Run number One hundred and ten (110), classed as Pastoral land, in terms of section 225 thereof, situate in the County of Marlborough, in the Land District of Marlborough, New Zealand, as the same is delineated on the plan in the District Lands and Survey Office, Blenheim, as shown in the margin hereof, and have paid the sum of Seventeen pounds ten shillings (£17: 10: 0), being the first half-year's rent in advance for such Run: The said OLIVE WATSON, LAURIE WATSON and COLIN WATSON are hereby licensed to occupy the said land for pastoral purposes for the term of twenty-one (21) years, to be computed from the first day of March 1933, subject to all the provisions and conditions of the Land Act, 1908, and its amendments, so far as applicable hereto, and subject also to the payment of an annual rent of (£260) for the first five (5) years and Eighty-five pounds (£85) for the remainder of the term of the License, in equal parts, half-yearly in advance, on the first day of March and the first day of September in each and every year, payment for the first half-year's rent having already been made, and the next of such half-yearly payments to be made on the first day of September, 1933.

Subject also to the conditions following, viz:—

- (1) That if the licensee or any person claiming an interest through or under him shall make or cause to be made any agreement or contract, or shall give or cause to be given or taken any negotiable security for the purpose of defeating or evading the provisions of, or shall in any way whatsoever directly or indirectly commit or be privy to a fraud upon, the Land Act, 1908, and its amendments, this license shall be liable to be forfeited and revoked;
- (2) That the licensee shall prevent the destruction or burning of timber or bush on the land comprised in this license, except as provided by section 237 of the Land Act, 1908; 260 of the Land Act, 1924.
- (3) That the licensee shall prevent the growth or spread of gorse, broom, and sweetbrier, on the land comprised in this license, and shall with all reasonable speed remove or cause to be removed all gorse, sweetbrier, broom, or other noxious weeds or plants, as may be directed by the Commissioner of Crown Lands; and
- (4) That the licensee shall destroy all rabbits on the land comprised in this license, and shall prevent their increase or spread, to the satisfaction of the Commissioner or an officer appointed by him to inspect the ground.
- (5) That the Licensees shall put on the land comprised in this License, and thereafter maintain, substantial improvements of a permanent character as follows:—
 - (a) Within one year from the date of this License, to a value equal to one year's rent payable under this License.
 - (b) Within two years from the date of this License, to a value equal to two year's rent payable under this License.
 - (c) Within six years from the date of this License, to a value equal to four year's rent payable under this License.

And it is hereby declared that these presents are intended to take effect as a pasturage license only under the Land Act, 1908, and its amendments, and the provisions of those Acts applicable to such licenses shall apply hereto as fully and effectually as if the same had been set out herein at length.

In witness whereof the Commissioner of Crown Lands, on behalf of the Land Board of the Marlborough Land District, hath hereunto set his hand, this 9th day of December, 1932.

WATSON

THE OLIVE WATSON, LAURIE WATSON and COLIN WATSON, the above-named Licensees, hereby accept this license on the terms and conditions specified therein.

Witness to
Colin Watson
Laurie Watson
Olive Watson

Witness to
Colin Watson
Laurie Watson
Olive Watson

Witness to
Colin Watson
Laurie Watson
Olive Watson

Olive Watson.

Commissioner of Crown Lands.

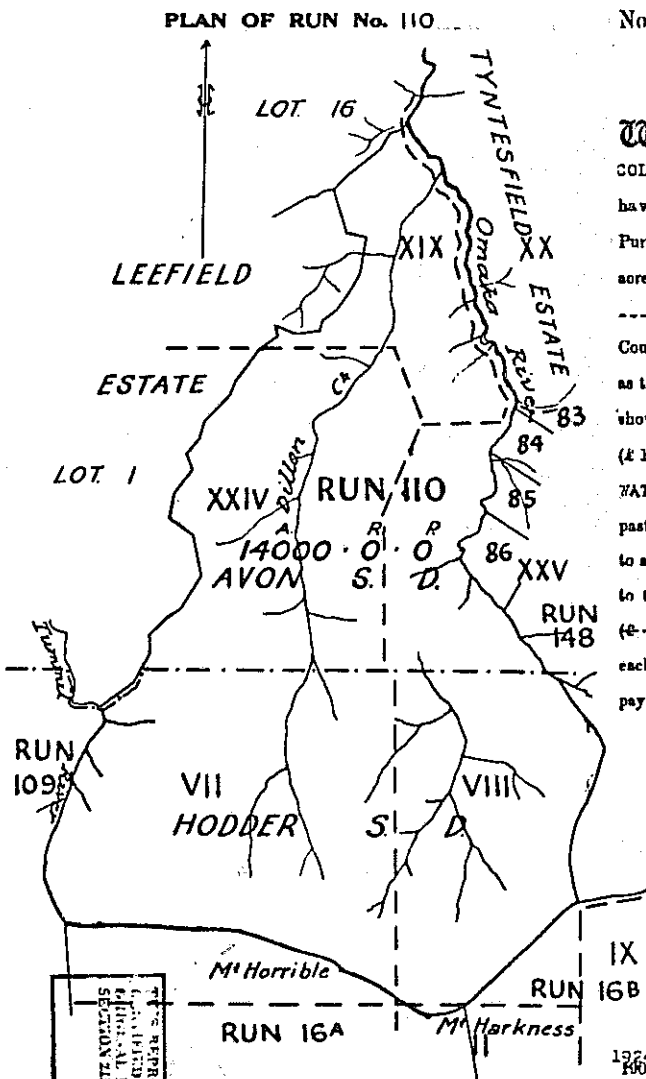

Scale: 1 Mile = 1 inch.

THIS REPRODUCTION ON A REDUCED SCALE IS INTENDED TO BE A TRUE COPY OF THE ORIGINAL REGISTER FOR THE PURPOSES OF SECTION 214 LAND TRANSFER ACT 1952.

(OVER)

CANCELLED
CANCELLED
CANCELLED

"RELEASED UNDER THE OFFICIAL INFORMATION ACT"
20 JAN 2018
REGISTER

4/6/1938