

## **Crown Pastoral Land Tenure Review**

**Lease name : RUGGED RIDGES**

**Lease number : PO 145**

### **Due Diligence Report - Plans**

These plans attach to and support the Due Diligence Report.

They are released under the Official Information Act 1982.

**October**

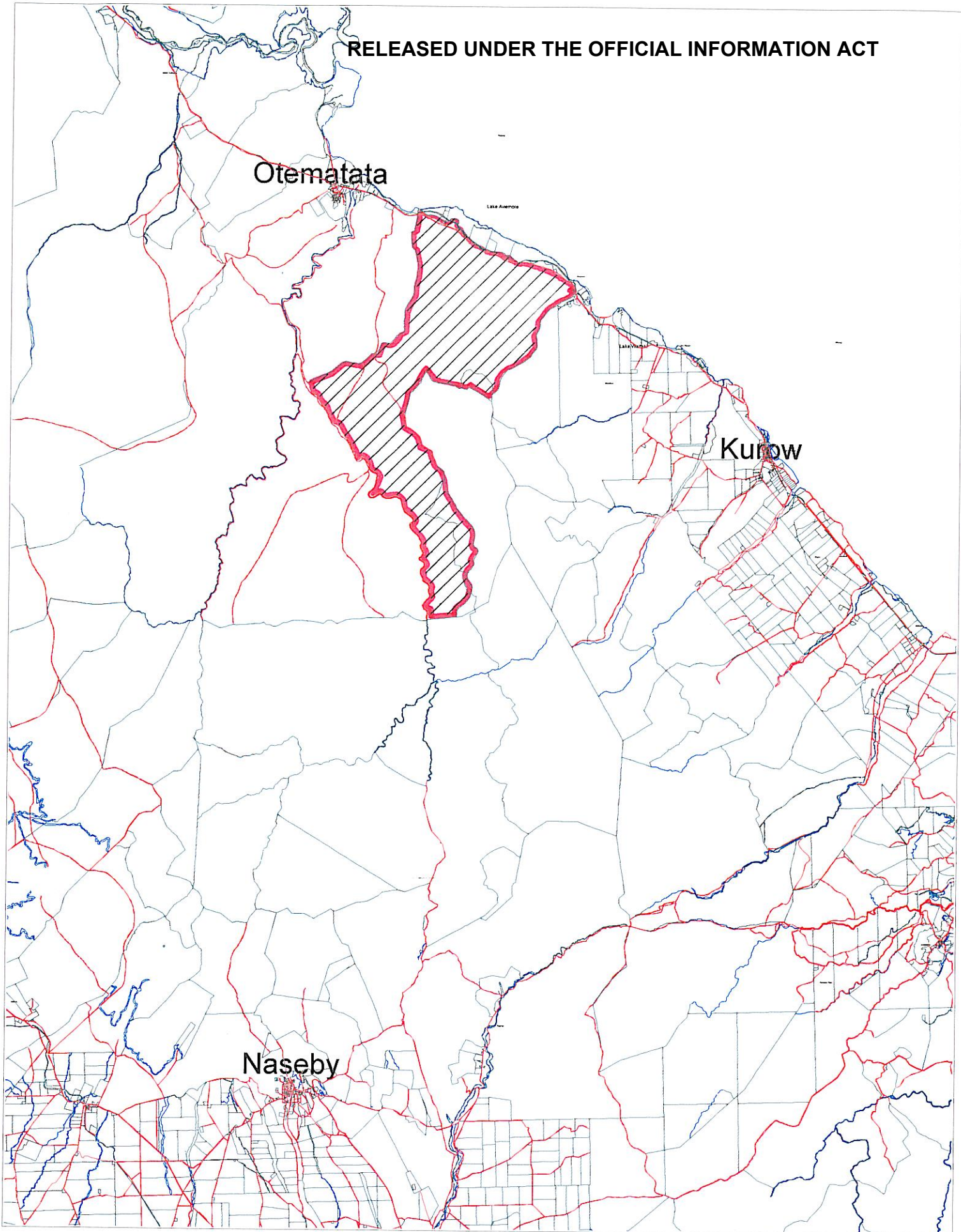

**05**

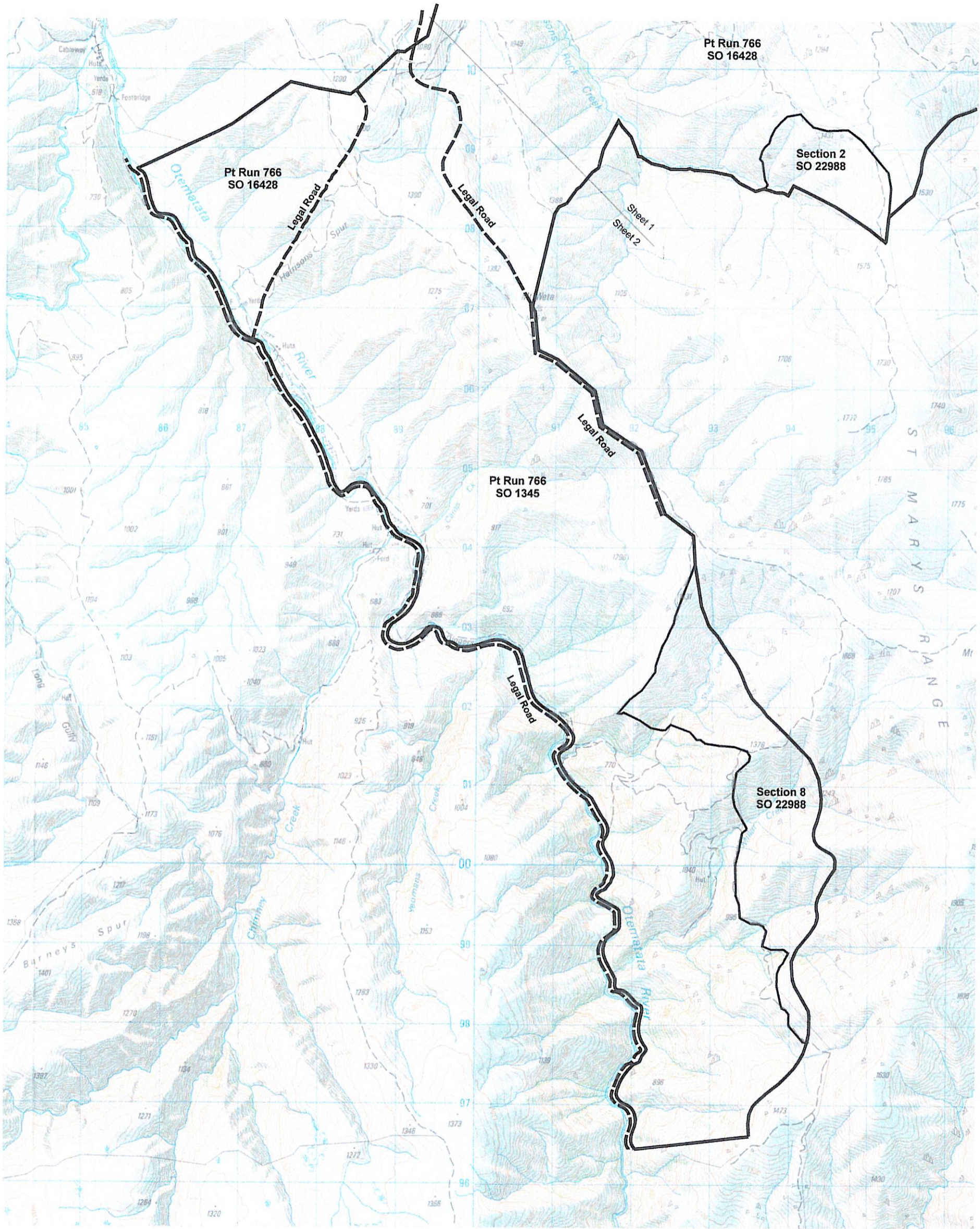
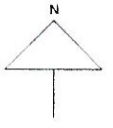

RUGGED RIDGES - Sheet 2  
STATE HIGHWAY No. 83  
OTEMATATA



Part Sheet NZMS 260 Sheet H40 Otematata

-  PASTORAL LEASE BOUNDARY
-  LEGAL ROAD
-  SECTION BOUNDARY



Mapping by:  
John McMecking Mapping  
Dunedin - 03 479 2233  
Abercrombie and Associates Ltd  
20.12.2000

RUGGED RIDGES - sheet 1  
STATE HIGHWAY No. 83  
OTEMATATA

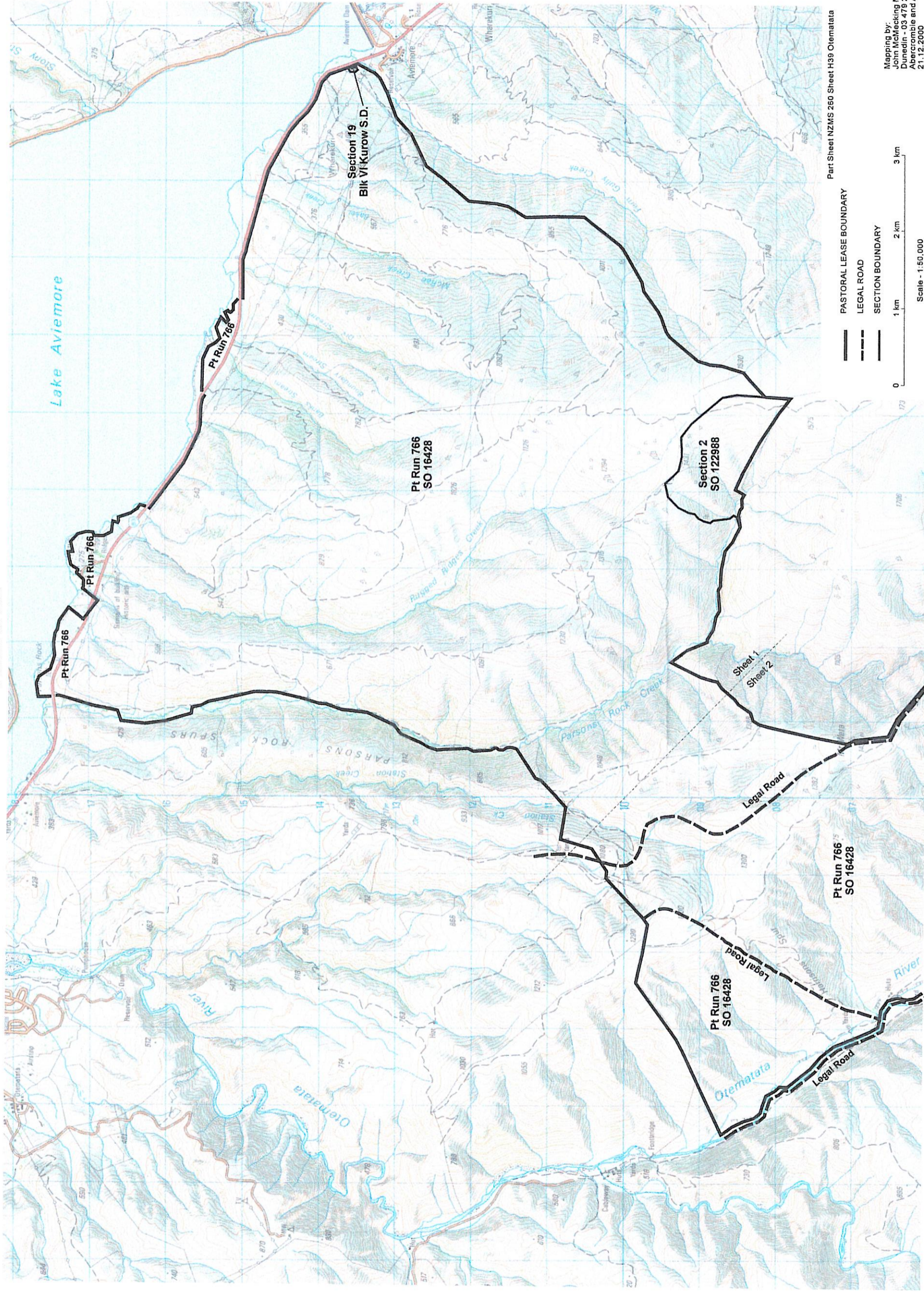
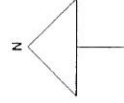

Part Sheet NZMS 260 Sheet H39 Otematata

PASTORAL LEASE BOUNDARY  
 LEGAL ROAD  
 SECTION BOUNDARY

0 1 km 2 km 3 km  
 Scale - 1:50,000

Mapping by:  
 John McMeeking Mapping  
 Dunedin - 03 478 2233  
 Abercrombie and Associates Ltd  
 21.12.2000