

## **Crown Pastoral Land Tenure Review**

**Lease name : STEW POINT**

**Lease number : PT 113**

### **Due Diligence Report (including Status Report) - Part 3**

This report and attachments results from a pre-Tenure Review assessment of the pastoral lease for the purpose of confirming land available for Tenure Review and any issues, rights or obligations attaching to it. The information is gathered from files and other sources available to the LINZ contractor.

Part of the information relates to research on the status of the land, resulting in a Status Report that is signed off by a LINZ approving officer. The remainder of the information is not analysed for relevancy or possible action until required, and LINZ does not guarantee its accuracy or completeness as presented.

The report attached is released under the Official Information Act 1982.

**July 09**



**COMPUTER INTEREST REGISTER  
UNDER LAND TRANSFER ACT 1952**



**Historical Search Copy**

**Identifier** CB1D/1466  
**Land Registration District** Canterbury  
**Date Registered** 02 December 1964 02:42 pm

**Prior References**  
CB529/76 CB529/78

<b>Type</b>	Lease under s83 Land Act 1948		
<b>Area</b>	3255.6960 hectares more or less	<b>Term</b>	33 years commencing on the 1st day of July 1964 and extended to 1.7.2030

**Legal Description** Run 297 and Part Run 303

**Original Proprietors**  
Gary James Herbert Rooney

**Interests**

- ✓ 692011 Variation of the within Lease reserving a Water Easement over part of the within land appurtenant to Rural Section 39047 (CT CB3D/1031) - 30.8.1966 at 9.20 am
- ✓ A258065.1 Variation and Extension of the term of the within Lease to 1.7.2030 - 12.9.1996 at 9.00 am
- A344365.5 Mortgage to Bank of New Zealand - 24.3.1998 at 3.01 pm

L. & S.—B. 4

Former Ref. Vol. 529 fol. 76 78

NEW ZEALAND

Entered in the Register-book, the

2nd day of December

L. & S. Ref. No. P 113

1964 at 2.42 o'clock p.m.

NOT REGISTERED UNDER LAND TRANSFER ACT  
REGISTERED UNDER SECTION 83 LAND ACT 1948

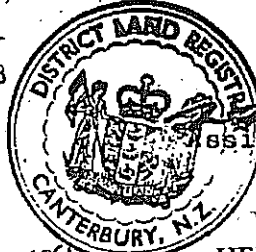

REGISTER

Assistant Land Registrar

Pastoral Lease under the Land Act 1948

This Deed, made the 1st day of July 1964 between HER MAJESTY THE QUEEN (hereinafter referred to as "the Lessor") of the one part, and JOHN CHALMERS KELLAND of Mount Peel, farmer

(hereinafter referred to as "the Lessee"), of the other part: WITNESSETH that, in consideration of the rent hereinafter reserved, and of the covenants, conditions, and agreements herein contained and implied, and on the part of the Lessee to be paid, observed, and performed, the Lessor doth hereby demise and lease unto the lessee, all that parcel of land containing by estimation 8,045 acres more or less, situated in the Land District of Canterbury, and being Run 297 "Stew Point" and part Run 303 "Coal Hill" situated in Blocks III, VI, VII, X and XI Mount Peel Survey District Geraldine County

as the same is more particularly delineated with bold black lines on the plan hereon; together with the rights,

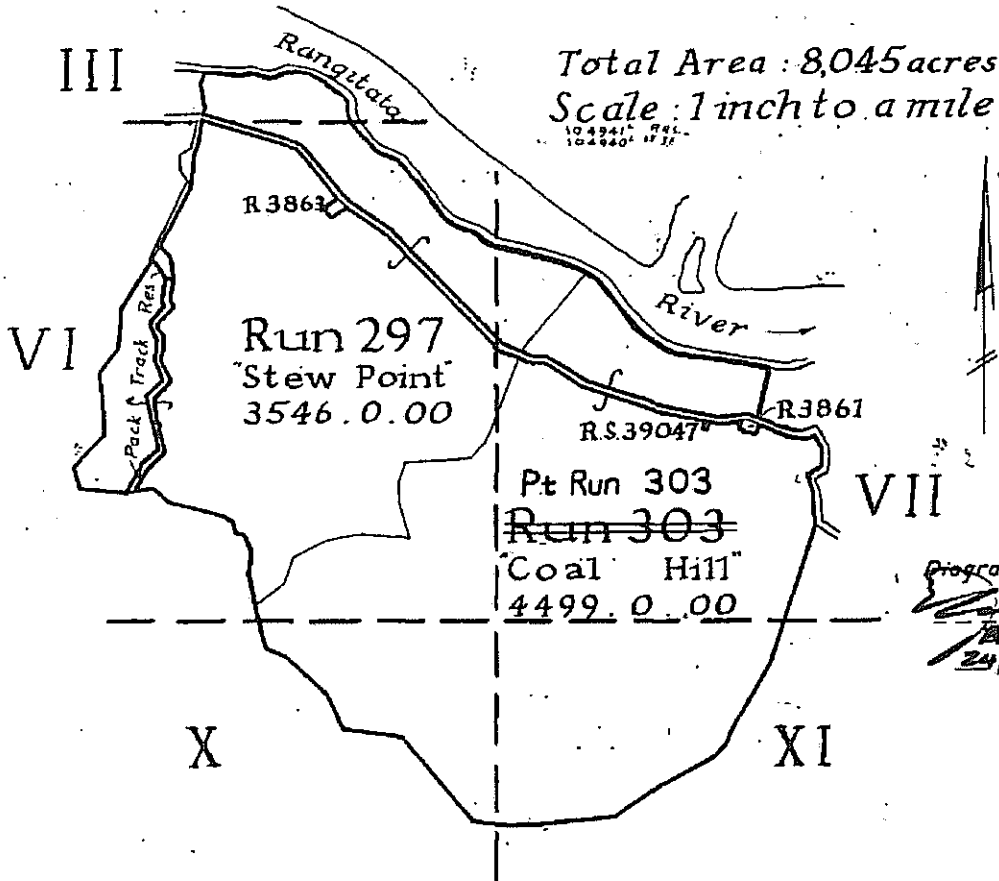

ID/1466

No.

ID/1466

1D/1466

Mortgage 626201 to The State Advances Corporation of New Zealand - 29.5.1964 at 11.38a.m.

DISCHARGED  
2/3/1980  
A.L.R.

Mortgage 626202 to Andrew Aitken Taylor - 29.5.1964 at 11.38a.m.

DISCHARGED  
2/3/1980  
A.L.R.

No. 692011

Variation of the within Lease reserving a Water Easement over part of the within land appurtenant to R.S. 39047 (C.T. 3D/1031) - 30.8.1966 at 9.20a.m. (with consent of Mortgagee under Mortgage 626201)

*[Signature]*  
A.L.R.

Variation of Mortgage 626201 - 23/1/1970 at 9.40 a.m. (with the consent of the mortgagee under Mortgage 626202)

*[Signature]*  
A.L.R.

No. 814841 Land Improvement Agreement under Section 30(3) and 30A of the Soil Conservation and River Control Act 1941 - 18/11/1970 at 2.59 p.m.

*[Signature]*  
A.L.R.

Transmission 165561/1 of Mortgage 626202 to Andrew Innes Taylor and Richard Aitken Taylor, as Executors - 14-2-1978 at 1.38p.m.

*[Signature]*  
A.L.R.

Transmission 165561/2 to Dorothy Olwyn Kelland, now of Geraldine, Widow, as Executor - 14-2-1978 at 1.38p.m.

*[Signature]*  
A.L.R.

Mortgage 165561/4 The Rural Banking and Finance Corporation of New Zealand - 20.12.1982 at 1.38p.m.

DISCHARGED  
2/3/1980  
A.L.R.

*[Signature]*  
A.L.R.

No. 165561/5 Memorandum of Priority making Mortgage 165561/4 a second Mortgage and Land Improvement Agreement 814841 a third charge - 14-2-1978 at 1.39p.m.

*[Signature]*  
A.L.R.

LAND & LEASES	
Nature:	Pastoral Lic
Firm:	L.L.R.
Date:	2 DEC 1964
Time:	2.42
Fee:	1-5-70
Abstract No.	7462

Transfer 207762/1 to the abovenamed Dorothy Olwyn Kelland - 18.12.1978 at 11.47 am.

*[Signature]*  
for A.L.R.

Mortgage 271115/1 to The Rural Banking and Finance Corporation - 22.9.1981 at 10.49 a.m.

DISCHARGED  
2/3/1980  
A.L.R.

*[Signature]*  
for A.L.R.

No. 273674/1 Statutory Charge under the Rural Housing Act 1941 - 21/3/1980 at 9.03a.m.

DISCHARGED  
2/3/1980  
A.L.R.

*[Signature]*  
for A.L.R.

No 299188/1 Statutory Charge under the Rural Housing Act 1941 - 21/3/1980 at 9.03 am.

DISCHARGED  
2/3/1980  
A.L.R.

*[Signature]*  
for A.L.R.

Variation of Mortgage 271115/1 - 22.9.1981 at 10.49 a.m.

*[Signature]*  
for A.L.R.

Mortgage 366815/1 The Rural Banking and Finance Corporation - 4.7.1982 at 10.52 am.

DISCHARGED  
18/6/82  
652625/1

*[Signature]*  
for A.L.R.

Variation of Mortgage 165561/4 - 24.2.1983 at 9.45 a.m.

*[Signature]*

for A.L.R.

Certificate No. 112856/4 that the within Mortgage No. 626201 is vested in the Rural Banking and Finance Corporation of New Zealand 12/11/84 1984-29.

ALR

Variation of Mortgage 271115/1 - 29.6.1984 at 11.10am

*[Signature]*  
for A.L.R.

No. 523613/1 Land Improvement Agreement under Section 30A Soil Conservation and River Control Act 1941 (with Land Improvement Agreement 814841) - 20.12.1984 at 9.45 a.m.

*[Signature]*  
for A.L.R.

No. 917710/1 Change of Name of the mortgagee under Mortgages 626201, 165561/4 & 271115/1 to The Rural Bank Limited - produced 28.1.1991 and entered 2.9.1992 at 9.40am

*[Signature]*  
A.L.R.

Variation of Mortgage 271115/1 - 2.9.1992 at 9.40am

*[Signature]*  
A.L.R.

No. A258065/1 Variation and Extension of the term of the within lease to 1.7.2030 - 12.9.1996 at 9.00am

*[Signature]*  
A.L.R.

SEE WITHIN...



easements, and appurtenances thereto belonging. TO HOLD the said premises intended to be hereby demised unto the Lessee for the term of 33 years, commencing on the 1st day of July 19 64, together with the period between the date of this lease and the aforesaid 1st day of July 19 64, YIELDING and paying therefor unto the Department of Lands and Survey at Christchurch the annual rent of £ 425.0.0. payable without demand by equal half-yearly payments in advance on the 1st day of January and the 1st day of July in each and every year during the said term. AND also paying in respect of the improvements specified in the Schedule hereto the sum of £ by a deposit of £ (which has already been paid) and thereafter by half yearly instalments of £ on the 1st day of January and the 1st day of July in each and every year.

AND the Lessee doth hereby covenant with the Lessor as follows:

1. THAT without derogating from or restricting the covenants contained and implied in this lease and on the part of the Lessee to be performed or complied with the Lessee will not at any time during the said term depasture on the land hereby demised more than 3850 sheep which number shall not include more than 2250 breeding ewes nor more than 20 cattle which number shall not include more than breeding cows PROVIDED HOWEVER that the Lessee may with the prior written consent of the Land Settlement Board carry such additional stock on such terms and conditions as may therein be specified subject nevertheless to the right of the Land Settlement Board to revoke or vary such consent at any time.

2. That the Lessee will at all times farm the land hereby demised in a manner to promote soil conservation and prevent erosion and will comply with the provisions of the Soil Conservation and Rivers Control Act 1941.

3. AND it is hereby agreed and declared by and between the Lessor and Lessee:

THAT pursuant to the provisions of the Noxious Animals Act 1956 officers and employees of the New Zealand Forest Service and other authorised persons shall at all times have a right of ingress, egress and regress over the land comprised in this lease for the purpose of determining whether such land or any adjoining land is infested with deer, wild goats, wild pigs, opossums or other animals which the said Service is charged with the duty of exterminating or controlling, or for the purpose of destroying any such animals: Provided that such officers, employees and other authorised persons in the performance of the said duties shall at all times avoid undue disturbance of the Lessee's stock.

AND it is hereby declared and agreed that these presents are intended to take effect as a Pastoral Lease of pastoral land under section 66 of the Land Act 1948, and the provisions of the said Act and of the regulations made thereunder applicable to such leases shall be binding in all respects upon the parties hereto in the same manner as if such provisions had been fully set out herein.

3. That pursuant to Section 58 of the Land Act 1948 a strip of land one chain in width along the banks of all rivers and streams which have an average width of not less than ten feet is excluded from the within lease.

SCHEDULE OF IMPROVEMENTS BELONGING TO THE CROWN

In witness whereof the Commissioner of Crown Lands for the said Land District, on behalf of the Lessor, has hereunto set his hand, and these presents have also been signed by the said Lessee.

Signed by the said Commissioner on behalf of the Lessor, in the presence of—

Witness: J.R. Evans  
Occupation: Clerk, Lands + Survey Dept  
Address: Christchurch

A.S. R. Hampton  
Commissioner of Crown Lands

Signed by the above-named Lessee, in the presence of—

Witness: David Marshall  
Occupation: Railway  
Address: Rangitoto

J. Kelland  
Lessee

A344365.4 Transfer to Gary James Herbert. ~~+~~ Not obtained.  
Rooney

A344365.5 Mortgage to Bank of New Zealand

all 24.3.1998 at 3.01



for DLR



PaATA

692011

13

oration of New Zealand )  
by authority of the )  
Corporation under its )  
Common Seal pursuant )  
to section 13 of the State )  
Advances Corporation )  
Act 1965 by )

For and on behalf of  
STATE ADVANCES CORPORATION OF  
NEW ZEALAND,

*[Handwritten signature]*

— Macdonald Boyd )  
an officer of the Corpor- )  
ation in the presence of )

*[Large handwritten signature]*

*[Handwritten signature]*  
*[Handwritten signature]*

<b>LAND &amp; DEEDS</b>	
Nature:	<i>V/Am lease</i>
Firm:	<i>CEL</i>
<b>30 AUG 1966</b>	
<i>9:20</i>	
<i>5508</i>	



P 71

692011 VL

MEMORANDUM OF VARIATION OF LEASE

IN THE MATTER of the Land Act 1948

AND

IN THE MATTER of Lease registered as  
Volume 1D folio 1466 Canterbury Land  
Registry from HER MAJESTY THE QUEEN to  
JOHN CHALMERS KELLAND

THE COVENANTS CONDITIONS AND RESTRICTIONS contained or implied in the said  
Lease are hereby varied by the addition of clause 4 hereafter.

1. "CLAUSE 4. THAT pursuant to Section 60 of the Land Act 1948 the Lessor hereby reserves unto herself the right to take water from the spring situated on the land comprised in this lease and to conduct the same by the means of a line of covered pipes already laid for this purpose across that part of the land comprised in the said lease as is shown on Survey Office Plan No. 10224 and thereon coloured blue and marked as "Water Supply Easement", "10.4" perches in area for the purposes of a domestic water supply for the benefit of all that parcel of land situated in Block VII, Mount Peel Survey District containing one (1) rood nineteen and seven-tenth (19.7) perches being Rural Section 39047 and being all the land owned by Her Majesty the Queen for a teachers residence and comprised and described in Certificate of Title Volume 3D folio 1031 (Canterbury Registry) and this reservation shall be deemed to include in favour of the Lessor all the rights and powers implied in terms of Section 90D of the Land Transfer Act 1952 in favour of grantees having the "Right to Convey Water" save as the same are hereby varied added or modified.
  - (i) THAT references in the said statutory implied powers to "grantee" shall be construed where the same appears as referring to the Lessor hereunder and references therein to "grantor" shall be construed as referring to the registered Lessee under this lease
  - (ii) THAT the registered Lessee hereunder shall be entitled to draw water in common with the Lessor hereunder from the source of supply.
  - (iii) THAT the Lessor shall maintain and operate the said easement and all ancillary equipment solely at her own expense."
2. THAT save as expressly provided hereinbefore the covenants conditions and restrictions contained or implied in the said lease shall remain unaltered and otherwise unaffected.

DATED the 7<sup>th</sup> day of June 1966.

SIGNED by the said JOHN CHALMERS )  
KELLAND as Lessee in the presence of: )

John Kelland

Witness: [Signature]

Occupation: 1st Master

Address: Peel Forest

SIGNED for and on behalf of HER )  
MAJESTY THE QUEEN by the Commissioner )  
of Crown Lands for the Land District )  
of Canterbury in the presence of: )

[Signature]  
Assistant Commissioner of Crown Lands

Witness: [Signature]

Occupation: Christchurch Survey Dept

Address: Christchurch



MEMORANDUM OF RENEWAL

BETWEEN HER MAJESTY THE QUEEN

Lessor

AND DOROTHY OLWYN KELLAND

Lessee

Particulars entered in the Register  
on date and at the time recorded  
below

District/Assistant Land Registrar

Particulars entered in Register  
Land Registry Canterbury  
Asst. Land Registrar  
[Signature]  
District/Assistant Land Registrar

KNIGHT FRANK (NZ) LIMITED  
TIMARU

9.00 12 SEP 96 A 258065 / 1

REGISTER



A 258065.1 VL

IN THE MATTER of the Land Transfer Act  
1952 and the Land Act 1948

AND

IN THE MATTER of Pastoral Lease No. P113  
registered in Volume 1D,  
Folio 1466, Canterbury  
Land Registry, from HER  
MAJESTY THE QUEEN to  
DOROTHY OLWYN  
KELLAND of Geraldine

Pursuant to Section 170 of the Land Act 1948 the term of the abovementioned lease registered in Volume 1D, Folio 1466, Canterbury Land Registry, is renewed for a term of 33 years commencing on the 1st day of July 1997. The Covenant to pay rent and the Rental Value contained in the lease is hereby varied by deleting the said covenant and substituting the following.

Yielding and paying therefore for the first 11 years of the said term unto the Commissioner of Crown Lands at Wellington the annual rent of \$6,000.00 calculated on a Rental Value of \$400,000 payable without demand by equal half-yearly payments in advance on the 1st day of January and the 1st day of July in each and every year during the said period of 11 years, and for the next two successive periods of 11 years of the said term a rent determined in respect of each of those periods in the manner provided in Section 132A of the Land Act 1948.

Save as hereby expressly varied all the covenants conditions and restrictions contained or implied in the said Memorandum of Lease shall remain in full force.

IN WITNESS WHEREOF the parties have hereunto subscribed their names this 16<sup>th</sup>  
day of July 1996.

SIGNED by the Commissioner of Crown )  
Lands for and on behalf of HER MAJESTY )  
THE QUEEN in the presence of: )

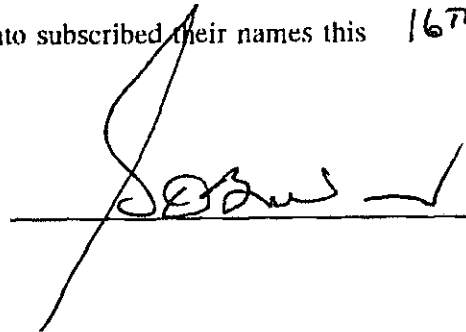

Witness: Lynette Porter

Occupation: LYNETTE PORTER  
TEAM MEMBER  
Address: NATIONAL OFFICE  
LAND INFORMATION N.Z.  
WELLINGTON

OK.

SIGNED by the said DOROTHY OLWYN )  
KELLAND as lessee in the presence of: )

D.O. Kelland.  
Lessee

Witness: 

Occupation: A. D. ARGYLE  
SOLICITOR  
ASHBURTON

Address: \_\_\_\_\_

Correct for Purposes of Land Transfer Act

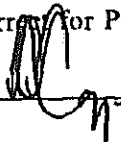
 Solicitor for Lessee

To order

So 3789 ✓

So 11388 ✓

So 3788 ✓

So 3792 ✓

Star Point Paddock Run.

Rural Sections.

CT Issued

x	• 28808 ✓ → CT 227/202	✓	80/293
x	RS's • 24512 ✓ → CT 227/202/203. RS 24511 (N/A)	✓	108/272
x	• 25017 ✓ → CT 227/202 RS 24512	✓	80/240
x	• 25018 ✓ → CT 227/202	✓	88/46
x	• 25019 ✓ → CT 227/202	✓	80/241
x	• 25020 ✓ → CT 227/202	✓	80/241
x	• 25113 ✓ → CT 227/202	✓	88/46
x	• 25114 ✓ → CT 227/202	✓	80/240
x	• 28809 ✓ → CT 227/202	✓	80/242
x	• 29286 ✓ → CT 227/202	✓	84/74
x	• 29287 ✓ → CT 227/202	✓	80/244
x	• 29288 ✓ → CT 227/202	✓	80/244
x	• 29399 ✓ → CT 227/202	✓	84/77
x	• 29400 ✓	✓	84/260
x	• 30934 ✓ → 30935 84/76 ✓ → CT 227/202	✓	84/78
x	• 31155 ✓ } → CT 227/202	✓	84/260
x	• 31156 ✓ }	✓	84/260
x	• 33083 ✓ → CT 227/202	✓	84/261
✓	• 36723 → ✓ 27/93 (lease)	✓	
✓	• 36724 → ✓ 27/108 (lease)	✓	

21 appellations.



279 130

279/130

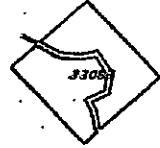
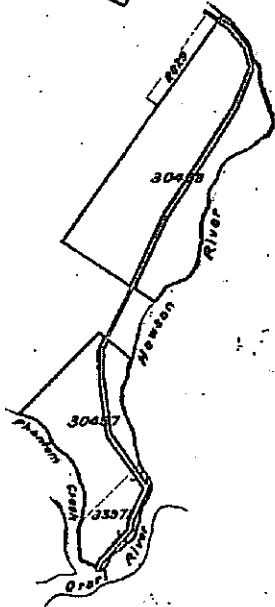
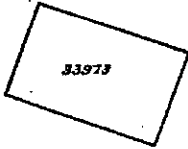
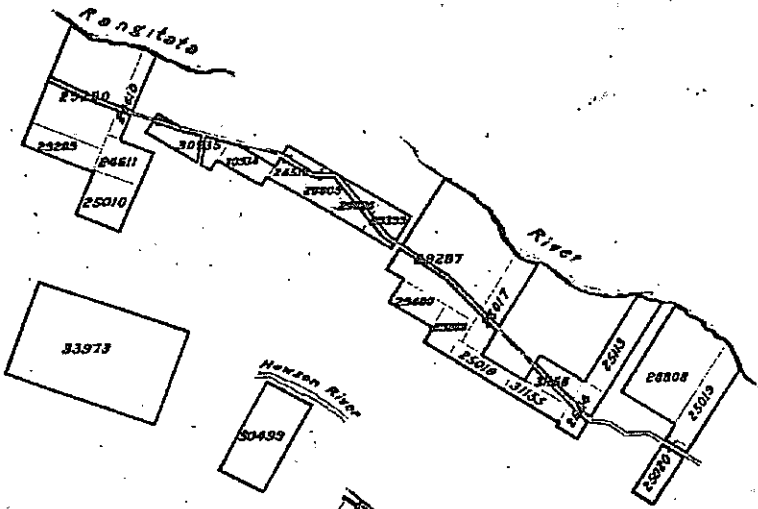

Total Area	2488.	2.	16.	
Less	2	0	8	Col'd Yellow
	2486	2	8	
Less	4	1	35	Col'd Red.
	2482	0	3	

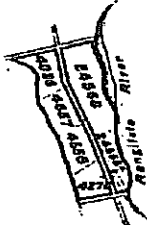
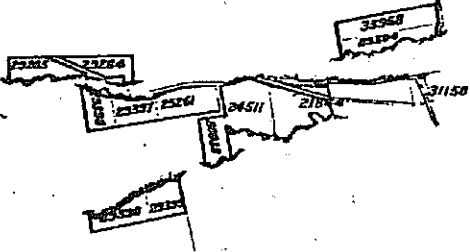

Scale 40 Chains to an Inch.

279 130

W.C.G.



# Proclamation

## H.H. 1

Received for deposit in  
the Lands Registry Office  
this 29<sup>th</sup> day of November  
1913 at 10 am.

Particulars entered  
Register Books 279/130  
and 286/139.03.

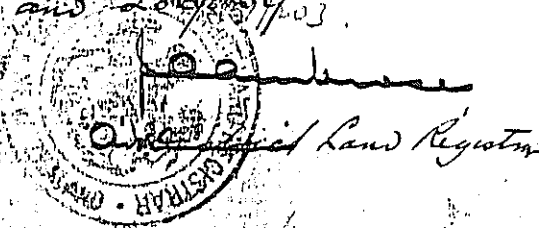

Plan  
Plan P<sup>n</sup> 441.(M)  
to 2/12/13

286/139 notes: 279/130 notes: 20/1/13  
8/2/13  
Memo. to  
Chief Surveyor  
19.12.13  
Letter for 652.79/30 sent  
16/1/13

146749/1 Change of appellation whereby the description  
of the within land is changed to  
Rural Section 40837  
produced this 20<sup>th</sup> day of September 19 22 at  
Assistant Land Registrar

2/19/30 letter for letter  
sent 16/1/13

Additional  
notes

Handwritten signature or initials.

[Extract from New Zealand Gazette, 20th Nov., 1913.]

Lands proclaimed as a Road, and Roads closed, in the Canterbury Land District.

(L.S.) - LIVERPOOL, Governor.  
A PROCLAMATION.

IN pursuance and exercise of the powers conferred by section eleven of the Land Act, 1908, I, Arthur William de Brio Savile, Earl of Liverpool, the Governor of the Dominion of New Zealand, do hereby, with the consent of the owners and lessees of the lands described in the First Schedule hereto, and of the Mount Peel Road Board, being the local authority in whose district the said lands are situated, proclaim as a road the lands described in the First Schedule hereto; and also do hereby, with the like consents as aforesaid, proclaim as closed the roads described in the Second Schedule hereto, which are not required by reason of the road described in the First Schedule hereto.

FIRST SCHEDULE.  
LANDS PROCLAIMED AS A ROAD.

Approximate Area of Land proclaimed as a Road.	Being Portions of Rural Sections.	Situated in Block.	Situated in Survey District of.	Shown on Plan.	Coloured on Plan.
0 1 0	21100	II	Acland	L. and E. 1011/1217	Red.
0 1 0	21844	"	"	"	"
0 1 0	21844	"	"	"	"
0 0 0	24811	"	"	"	"
1 4 24	21841	"	"	"	"

SECOND SCHEDULE.  
ROADS CLOSED.

Approximate Area of Road closed.	adjoining or passing through.	Situated in Block.	Situated in Survey District of.	Shown on Plan.	Coloured on Plan.
0 0 0	R.S. 21120	II	Acland	L. and E. 1011/1217	Green.
0 0 4	R.S. 21844	"	"	"	"
0 1 21	R.S. R. 103	"	"	"	"
1 0 0	R.S. 21840	"	"	"	"
0 1 11	R.S. R. 103	"	"	"	"

All in the Canterbury Land District; as the same are more particularly delineated on the plans marked and coloured as above mentioned, and deposited in the Head Office, Department of Lands and Survey, at Wellington.

Given under the hand of His Excellency the Right Honourable Arthur William de Brio Savile, Earl of Liverpool, Knight Commander of the Most Distinguished Order of Saint Michael and Saint George, Member of the Royal Victorian Order, Governor and Commander-in-Chief in and over His Majesty's Dominion of New Zealand and its Dependencies; and issued under the Seal of the said Dominion, at the Government House, at Wellington, this thirteenth day of November, in the year of our Lord one thousand nine hundred and thirteen.

H. D. HILL,  
For Minister of Lands.

God Save the King.

*Plan 279/130.*

*N. Co. Bal 227/203*

*2/1/13*

*3. 10. 13.*

*Plan & papers of 286/139 endorsed*

*H. D. Hill*

*13/12/13*



1139

Particulars Entered  
in Register Books  
271/108 M163745, 168869  
271/110 M168606.  
279/130 and 286/139  
the 25 Sept 1930 at  
10 am  
A. B. Ross  
D.L.R.



C.T. 286/139 noted  
7-11-30

C/T. 271/108, M. 163745 }  
M. 168869 } 5/11/30

C/T 271/110 + m168606  
noted 7-11-30

C. T. 279/130 noted 19-11-30

Particulars Entered  
in Register Books  
279/130  
10 am

1139

[Extract from N.Z. Gazette No. 65, 18th September, 1930.]  
Page 2780.

Land proclaimed as a road in Block VII, Mount Peel Survey District, and Block II, Auckland Survey District, Geraldine County.

[L.S.] BLEDISLOE, Governor-General.  
A PROCLAMATION.

IN pursuance and exercise of the powers conferred by section twelve of the Land Act, 1924, I, Charles, Baron Bledisloe, Governor-General of the Dominion of New Zealand, do hereby proclaim as a road the land in Mount Peel and Auckland Survey Districts described in the Schedule hereto.

*Auckland*

SCHEDULE.

APPROXIMATE areas of the pieces of land proclaimed as a road:—

A. R. P.	Being	
PT 271/108 >0 3 33	Portion of S.G.R. 100, being part Rural Section 33683, Block VII, Mount Peel Survey District; coloured pink.	<i>Auckland</i>
PT 273/130 (3-1-30) >4 3 31	Portion of Run 1, being part Rural Sections 25201, 29307, and 20308, Block II, Auckland Survey District; coloured pink.	<i>Auckland</i>
PT 271/110 >1 0 0	Portion of S.G.R. 102, being part Rural Section 30729, Block II, Auckland Survey District; coloured pink.	<i>Auckland</i>
PT 273/136 (0-9-10) 0-20	Portion of Rural Section 31153, Block II, Auckland Survey District; coloured green.	<i>Auckland</i>
PT 280/140 (1-0-10) 0 0 8-0	Crown land adjoining Rural Section 31153, Block II, Auckland Survey District; coloured blue. (Canterbury R.D.) (S.O. 2151.)	<i>Auckland</i>

In the Canterbury Land District; as the same are more particularly delineated on the plan marked P.W.D. 79377, deposited in the office of the Minister of Public Works at Wellington, and thereon coloured as above mentioned.

Given under the hand of His Excellency the Governor-General of the Dominion of New Zealand, and issued under the Seal of that Dominion, this 12th day of September, 1930.

W. B. TAVERNER, Minister of Public Works.

(P.W. 46/722.) GOD SAVE THE KING!

*Register Copies endorsed.*

*N.R.S.  
23/9/30*

*Original copy 271/108 Endorsed  
N.R.S.  
15/11/30*

*Original copy 273/130 Endorsed  
N.R.S.  
14/11/30*



96671

No.

Correct for the purposes of the Land Transfer Act.

Transfer of

*W. K. Pollen*

Situated in

*279/130*

*Commissioner Crown Lands*

H. D. ACLAND & cros. Vendor

HIS MAJESTY THE KING Purchaser

Particulars entered in the Register-book

Vol. *227* Folio *201.202.203*  
*and 230/4*

the *10* day of *December* 19*12*

at *12.26* o'clock *pm*

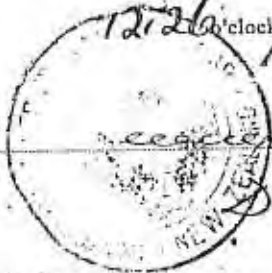

District Land Registrar

*11.12.12*

*12.26*

*[Large handwritten signature]*



WILDING & ACLAND,  
SOLICITORS,  
CHRISTCHURCH

T.96671

*Leomin Brown Land*  
10/12/12  
12-200



MEMORANDUM OF TRANSFER.

HENRY DYKE ACLAND, Solicitor, HUGH THOMAS DYKE ACLAND, Medical Practitioner both of Christchurch and WALTER EMPSON, of Holnicote, Mount Peel, Gentleman

- 1. Here state nature of the estate or interest.
- 2. District, county, hundred or township.
- 3. Here state area, exclusive of roads intersecting the same, if any.
- 4. Here state rights-of-way, privileges or easements, if any, intended to be conveyed; and if the land to be dealt with contains all that is included in an existing grant or certificate, refer thereto for description of parcels and diagrams; otherwise set forth the boundaries in chains, links, or feet, and refer to the plan, if attached to the instrument or annexed to the instrument or deposited in the Registry Office.

being registered as the proprietor<sup>s</sup> of an estate<sup>1</sup> in fee simple

subject however to such encumbrances, liens, and interests as are notified by memoranda underwritten or endorsed hereon, in all those piece<sup>s</sup> of land situated in the<sup>2</sup> Acland, Orari and Mount Peel Survey Districts

containing<sup>3</sup> together Two thousand four hundred and eighty eight acres Two Roods and Sixteen perches (2488 Acres 2 Roods 16 Perches)

be the same a little more or less<sup>4</sup> being the whole of the land comprised in Certificate of Title Volume 227 Folio 202 AND BEING Rural Sections 29284, 29285, 33968, 29394, 29398, 29399, 25261, 30938, 24611, 29395, 29396 and those parts of Rural Sections 21844 and 31158 shown on the Plan annexed hereto and coloured red in outline thereon being part of the land comprised in Certificate of Title Volume 227 Folio 203 AND BEING Rural Sections 4036, 4557 and parts of Rural Sections 4276 and 4556 being part of the land comprised in Certificate of Title Volume 230 Folio 4 AND BEING Rural Sections 24568 and 24568 being part of the land comprised in Certificate of Title Volume 227 Folio 201

*Please issue one copy for the whole of the land herein.*

*10/12/12*

*all 227/201*  
*Part 227/201, 227/203 & 230/4*  
*R.S. 4036, 4557, 24511, 24512, 24568, 24568, 24610, 24611, 25010, 25017, 25018, 25019, 25020, 25113, 25114, 25261, 25808, 28809, 29284, 29285, 29286, 29287, 29288, 29289, 29290, 29394, 29396, 29397, 29398, 29399, 29400, 29943, 29944, 29945, 30497, 30498, 30499, 30934, 30935, 30938, 31155, 31156, 33083, 33968, 33971, 33973. And Pt. 4276, 4556, 21844, 31158*

*(By check 2488-3-3) " 17-11 Acland & 11 Orari S 2*  
*accept 2488-2-16.*

*16.1.13.*

*CC. 2/12/12*

*CC. 2/12/12*

in consideration of the sum of . . . transfer or conveyance to us of certain lands and hereditaments containing together Three thousand five hundred and eighty six acres 0 Roods and Twenty perches (3686 Acres 0 Roods 20 Perches) by HIS MAJESTY

THE KING, no sum being paid by way of equality of exchange

*CC. 2/12/12*

Do hereby transfer to the said His Majesty The King -----

6. Or a lesser estate or interest, describing such lesser estate.

all our estate and interest in the said piece of land

signs

1912

IN WITNESS whereof we have hereto signed our names this *multi*  
day of *December* one thousand nine hundred and *twelve*.

Signed on the above-named date by the said  
*Henry Byrre Ireland*  
*and Hugh Thomas Byrre Ireland*  
in the presence of

*Hugh L. Ireland*  
*Henry D Ireland*

WITNESS— Name

*Walter Thompson Esq*

Occupation

*Lawyer*

Address

*Geraldine*

Signed on the above-named date by the said

WALTER EMPSON

*Walter Empson*

WITNESS— Name

*Alfred George Haynes*

Occupation

*Archdeacon*

Address

*St Peter's Vicarage  
Wellington*

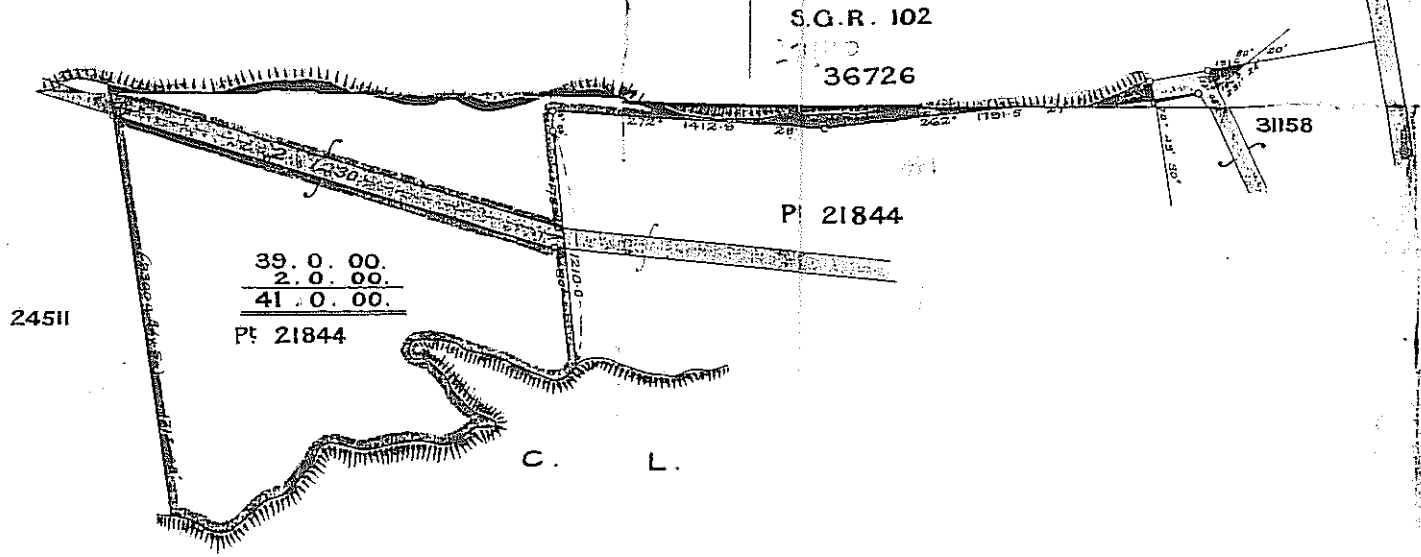

Part R.S. 21844 & 31158

Compiled by the L. & S. Office from Official Records

# Acland S. D. Block II

Scale 5 Chains = 1. Inch

*Henry D. Acland*  
*Walter Simpson*

*Walter Simpson*  
*Henry D. Acland*  
*Walter Simpson*

Approved  
*J. H. [Signature]*  
Chief Surveyor  
Date 30. 8. 12

*200*

NEW ZEALAND.

Form B.

227/202

Vol. 227, folio 202  
Substituted  
Dunedin



Register-book,  
Vol. 227, folio 202

Reference:

CERTIFICATE OF TITLE UNDER LAND TRANSFER ACT. **CANCELLED**

This Certificate, dated the Seventh day of January, one thousand nine hundred and Six, under the hand and seal of the District Land Registrar of the Land Registration District of Canterbury, Witnesseth that John Barton Arundel O'Connell of Mount Peel Sheepfarmer

is seized of an estate in fee-simple (subject to such reservations, restrictions, encumbrances, liens, and interests as are notified by memorial underwritten or indorsed hereon; subject also to any existing right of the Crown to take and lay off roads under the provisions of any Act of the General Assembly of New Zealand) in the land hereinafter described, as the same is delineated by the plan hereon, bordered green, in the several admeasurements a little more or less, that is to say: All that parcel of land containing together Two Acres and fifty Seven Cents in the about situated in Block I, II, VI, VII of the Mount Peel and Block I of the O'Connell Survey District comprising Rural Sections 24512, 24610, 24611 25010, 25017, 25018, 25019, 25020, 25113, 25114, 28808, 28809, 29286, 29287, 29288, 29289, 29290, 29399, 29400, 29443, 29444, 29445, 30497, 30498 30499, 30434, 30435, 31155, 31156, 33083, 33971 and 33972



H. H. H. H.  
District Land Registrar

Mortgage 10029 produced 15th Dec 1896 at 5.30 pm John Barton Arundel O'Connell to Arthur Mills

Mortgage 31613 produced 5 September 1896 at 2.30 pm John Barton Arundel O'Connell to The Union Bank of Australia Limited

Transfer of Mortgage 31613 produced 8 June 1896 at 2.30 pm The Union Bank of Australia Limited to Arthur Mills

Mortgage 36269 produced 20 July 1896 at 12.15 pm John Barton Arundel O'Connell to Arthur Mills

Transfer of Mortgage 3570 of Mortgage 10029, 31613 and 36269 to Reginald Rowdie Dyer O'Connell, Shepherds Bay, O'Connell, Barton, Reginald, Vaughan, Mills and Dudley O'Connell Wells entered 26 July 1899 at 12.20 pm

See over

Transfer of Mortgage 10029, 31613 and 36269 produced 28 July 1899 at 11.45 am Reginald Rowdie Dyer, O'Connell, Shepherds Bay, O'Connell, Barton, Reginald, Vaughan, Mills and Dudley O'Connell Wells to Arthur Edgier Mavor, Rhodes

Transfer Transmission 576 to George Harper and Henry Dyer, O'Connell Solicitors and Hugh Thomas Dyer, O'Connell medical practitioner, all of Christchurch entered 26 July 1906 at 2.30 pm

227/202

over





CANCELLED

108/272

NEW ZEALAND.

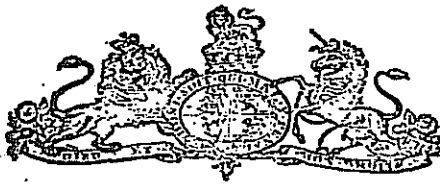

[CERTIFICATE OF TITLE.]

Register Book,

Vol. 108 Folio 272

John Donald Arundel Acland, of Mount Peel Sheepfarm, is now seized of an Estate in fee simple subject to such encumbrances and interests as are notified by memorial underwritten and endorsed hereon in those pieces of land situated in Blocks II and VI of the Acland District respectively containing together 55 1/2 acres and about colored green in the plan hereon and being the undivided Rural Sections 24511 and 24512 excepting a strip from the said Section 24512 a road one chain in width intersecting the said section colored brown on the said plan the area of which said excepted road is not included in the area hereinbefore described which said Rural Sections marked 24511 and 24512 are delineated in the Subdivision Map of the said District deposited in the office of the Chief Surveyor and was originally purchased from the Crown on the thirteenth day of April 1876 by Arthur Mills and John Donald Arundel Acland respectively.

In witness whereof I have hereunto signed my name and affixed my Seal this eighth day of September One thousand eight hundred and eighty three Signed in the presence of

James Bottomley the 8th day of September 1883.



Arthur Mills District Land Registrar of the District of Canterbury



Mortgage No 10029 produced 23rd July 1880 at 1.30pm John Barton Arundel Acland to Arthur Mills

BLOCK II AGLAND DIST

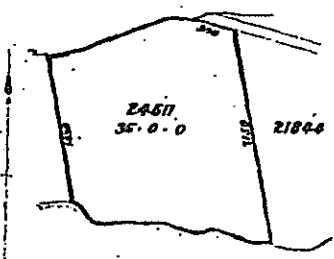

Scale 40 chains to an inch. Surveyed by H. J. Lewis Chief Surveyor: J. H. Baker Draughtsman: J. R. Russell

2445

Image Quality due to Condition of Original

BLOCK VI MT PEEL DIST

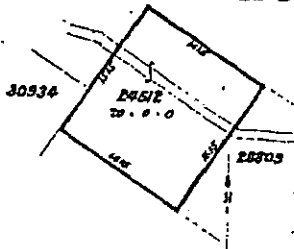

Mortgage 30736 produced 9 February 1881 at 2.25pm John Donald Arundel Acland to Arthur Mills

Mortgage 31613 produced 5 September 1893 at 2.30pm John Barton Arundel Acland to The Union Bank of Australia Limited

Transfer of Mortgage 31613 produced 7 June 1896 at 2.30pm The Union Bank of Australia Limited to Arthur Mills

108/272

108/272

Mortgages 36260 produced 20 July 1926  
at 12.15 pm John Carter, Auctioneer, Island  
to Arthur Mills. *Arthur Mills*

In commission 35.70 of Mortgages 10029, 31613,  
36269 to Reginald Brodie, Dyke, Acland, Theodore  
Dyke, Acland, Martin, Reginald, Vaughan, Mills  
and Dudley Acland, Mills entered  
26 July 1899 at 12.20 pm

*Arthur Mills* 26  
Transfer of Mortgages 10029, 31613, 36269  
produced 28 July 1899 at 11.15 am Reginald  
Brodie, Dyke, Acland, Theodore Dyke,  
Acland, Martin, Reginald, Vaughan, Mills  
and Dudley Acland, Mills to Arthur Edgar  
Gravenor Rhodes.

*Arthur Mills* 26

Cancelled n/c 227/202/203

108/272

CANCELLED

108/272



NEW ZEALAND

CANCELLED

CERTIFICATE OF TITLE

(C)  
M.H.C.



Register Book,

Vol. 88 Folio 46

John Dalton Round Island of Mount Peel, the former, is now owner of an Estate in fee simple subject matter to such encumbrances then and interest as are notified by memorial under writhe or indented letters in those pieces of land situated in Blocks VI and VII of the Mount Peel Survey District containing all the Crown land and enclosures on the said blocks or the parts thereof and pieces of land as set out in the plan hereon and comprise the several sections numbered 25016, 25018 and 25019 situated in the District of the said District deposited in the office of the Chief Surveyor originally purchased from the Crown on the sections 25016 and 25018 on the twenty sixth day of May 1895 and as to section 25019 on the fifth day of June 1895 by the said John Dalton Round Island.

In witness whereof I have hereunto signed my name and affixed my Seal this nineteenth day of December 1895 in the presence of  
J. A. Ambrose  
the 19th day of December 1895



W. M. Hutchison  
District Land Registrar  
of the District of Canterbury.

Mortgage 10024 produced 25th May 1895 at 100 for John Dalton Round Island to Hutchison.

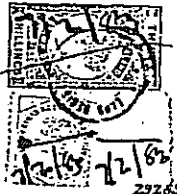

Mount Peel Block VI

Dist. Block VII

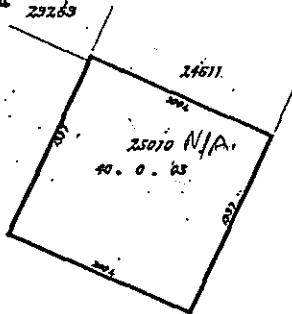

Mortgage 30736 produced 9th February 1895 as **DISCHARGED** John Dalton Round Island to Hutchison.



largely and Company Limited  
William H. Lee

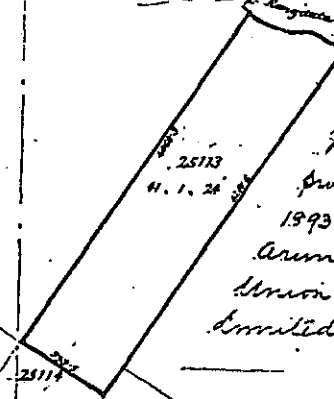

Mortgage 31613 produced 5 September 1893 at 2.50 for John Dalton Round Island to The Union Bank of Australia Limited.  
William H. Lee

Transfer of Mortgage 31613 produced 8 June 1895 at 2.35 from The Union Bank of Australia Limited to Arthur Mills  
William H. Lee

over

Scale, 1/4 chains to an inch.  
Surveyed by P. M. G. O.  
Chief Surveyor J. F. B. G.  
Draughtsman J. H. G.  
1895.

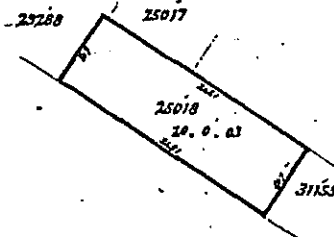

88 / 46

88/46

Mortgage 36269 produced 20 July  
1896 at 12.15 pm. 30 min. Barton, Rhodes, Hills  
to Arthur Hills *Arthur T. Hill*

Transmission 3570 of mortgages 309, 3113, 36269  
to Reginald Brodie Dyke, Acland, Meadows Dyke  
Acland, Barton Reginald, Vaughan Mills and  
Dudley Acland, Hills entered 16 July 1899 at 12.15 pm  
*Arthur T. Hill*

Transfer of Mortgage 10029, 31613, 36269 produced  
28 July 1897 at 11.45 am Reginald Brodie Dyke,  
Acland, Meadows Dyke Acland, Barton Reginald,  
Vaughan Mills and Dudley Acland, Hills  
to Arthur Edgar Gravins Rhodes.  
*Arthur T. Hill*

Cancelled 1/1-22/1202

88/46

CANCELLED

88/46



# NEW ZEALAND

# CANCELLED

115. C

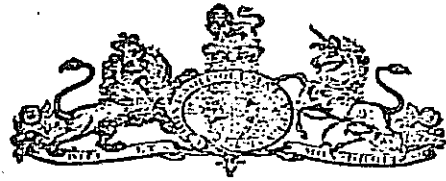

(CERTIFICATE OF TITLE.)

Register Book,  
Vol. 84 Folia 261.

84/261

John Barton Arundel Acland, of New Zealand, Esquire, is now seized of an Estate in fee simple subject to the usual covenants, conditions and incumbrances as are notified by memorial under written or endorsed in these pieces of land situated in Block VII of the Auckland Survey District containing together One hundred and sixty acres, more or less, of freehold or hereditaments which said pieces of land are colored green in the plan thereon and comprise the Rural Section number 33083 delineated in the Public Map of the said District deposited in the office of the Chief Surveyor originally purchased from the Crown on the nineteenth day of August 1882 by the said John Barton Arundel Acland.

Mortgage of the above named Estate signed in my name and appearing that this fourth day of December One thousand eight hundred and eighty two Signed in the presence of

*W. A. C. M. S.*  
the 4<sup>th</sup> day of December 1882



*W. A. C. M. S.*  
District Land Registrar  
of the District of Canterbury

Mortgage of 10000 produced 20<sup>th</sup> May 1882 at 1.30 pm John Barton Arundel Acland to Arthur Mills  
*W. A. C. M. S.*

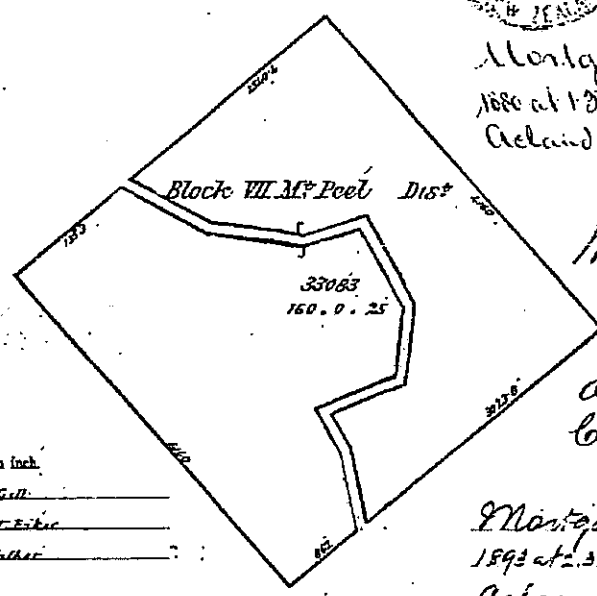

Scale, 47 chains to an inch.  
Surveyed by J. T. G. H.  
Chief Surveyor: J. T. G. H.  
Draftsman: J. T. G. H.  
1705

Mortgage 30736 produced 9 February 1896  
John Barton Arundel Acland to W. A. G. & Co. Company Limited.  
**DISCHARGED**  
*W. A. C. M. S.*

Mortgage 31613 produced 5 September 1893 at 2.30 pm John Barton Arundel Acland to The Union Bank of Australia Limited.  
*W. A. C. M. S.*

Transfer of Mortgage 31613 produced 8 June 1896 at 7.30 pm The Union Bank of Australia Limited to Arthur Mills  
*W. A. C. M. S.*

Image Quality due to Condition of Original

84/261

84/261

84/261

Mortgage 36269, recorded 28 July 1896 at 12.15 pm John Barton Granger  
Deland to Arthur Mills *William E. Edgar*

Transmission 3570 of Mortgage 29, 3113, 31269 to Reginald Brodie Dyke, Deland, Theodore Dyke Deland, Barton Reginald Vaughan Mills and Dudley Deland. Mills entered 26 July 1899 at 12.15 pm *William E. Edgar*

Transfer of Mortgage 29, 3113, 31269 recorded 28 July 1899 at 12.15 pm Reginald Brodie Dyke, Deland, Theodore Dyke, Deland, Barton Reginald Vaughan Mills and Dudley Deland Mills to Arthur Edgar Granger Rhode. *William E. Edgar*

Cancelled N/C 227/202

84/261

CANCELLED



NEW ZEALAND

CANCELLED

(CERTIFICATE OF TITLE)

(C)  
M5 C

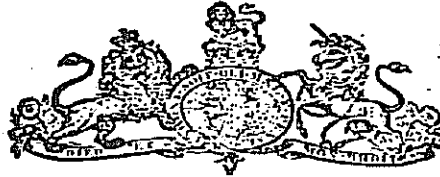

Register Book,

Vol. 84 Folio 260

84/260

John Barton Arnold Acland of Auckland being  
finder, is now seized of an estate in fee simple subject to such  
incumbrances liens and interests as are notified by memorial under written  
indeed herein in those pieces of land situated in Block VI of the  
Peel Survey District containing all together 153 acres 2 roods 3  
woods 1/4 of an acre or thereabouts which said pieces of land are  
colored green in the plan herein and comprise the 12th 13th 14th 15th 16th 17th 18th 19th 20th 21st 22nd 23rd 24th 25th 26th 27th 28th 29th 30th 31st 32nd 33rd 34th 35th 36th 37th 38th 39th 40th 41st 42nd 43rd 44th 45th 46th 47th 48th 49th 50th 51st 52nd 53rd 54th 55th 56th 57th 58th 59th 60th 61st 62nd 63rd 64th 65th 66th 67th 68th 69th 70th 71st 72nd 73rd 74th 75th 76th 77th 78th 79th 80th 81st 82nd 83rd 84th 85th 86th 87th 88th 89th 90th 91st 92nd 93rd 94th 95th 96th 97th 98th 99th 100th 101st 102nd 103rd 104th 105th 106th 107th 108th 109th 110th 111th 112th 113th 114th 115th 116th 117th 118th 119th 120th 121st 122nd 123rd 124th 125th 126th 127th 128th 129th 130th 131st 132nd 133rd 134th 135th 136th 137th 138th 139th 140th 141st 142nd 143rd 144th 145th 146th 147th 148th 149th 150th 151st 152nd 153rd 154th 155th 156th 157th 158th 159th 160th 161st 162nd 163rd 164th 165th 166th 167th 168th 169th 170th 171st 172nd 173rd 174th 175th 176th 177th 178th 179th 180th 181st 182nd 183rd 184th 185th 186th 187th 188th 189th 190th 191st 192nd 193rd 194th 195th 196th 197th 198th 199th 200th 201st 202nd 203rd 204th 205th 206th 207th 208th 209th 210th 211th 212th 213th 214th 215th 216th 217th 218th 219th 220th 221st 222nd 223rd 224th 225th 226th 227th 228th 229th 230th 231st 232nd 233rd 234th 235th 236th 237th 238th 239th 240th 241st 242nd 243rd 244th 245th 246th 247th 248th 249th 250th 251st 252nd 253rd 254th 255th 256th 257th 258th 259th 260th 261st 262nd 263rd 264th 265th 266th 267th 268th 269th 270th 271st 272nd 273rd 274th 275th 276th 277th 278th 279th 280th 281st 282nd 283rd 284th 285th 286th 287th 288th 289th 290th 291st 292nd 293rd 294th 295th 296th 297th 298th 299th 300th 301st 302nd 303rd 304th 305th 306th 307th 308th 309th 310th 311th 312th 313th 314th 315th 316th 317th 318th 319th 320th 321st 322nd 323rd 324th 325th 326th 327th 328th 329th 330th 331st 332nd 333rd 334th 335th 336th 337th 338th 339th 340th 341st 342nd 343rd 344th 345th 346th 347th 348th 349th 350th 351st 352nd 353rd 354th 355th 356th 357th 358th 359th 360th 361st 362nd 363rd 364th 365th 366th 367th 368th 369th 370th 371st 372nd 373rd 374th 375th 376th 377th 378th 379th 380th 381st 382nd 383rd 384th 385th 386th 387th 388th 389th 390th 391st 392nd 393rd 394th 395th 396th 397th 398th 399th 400th 401st 402nd 403rd 404th 405th 406th 407th 408th 409th 410th 411th 412th 413th 414th 415th 416th 417th 418th 419th 420th 421st 422nd 423rd 424th 425th 426th 427th 428th 429th 430th 431st 432nd 433rd 434th 435th 436th 437th 438th 439th 440th 441st 442nd 443rd 444th 445th 446th 447th 448th 449th 450th 451st 452nd 453rd 454th 455th 456th 457th 458th 459th 460th 461st 462nd 463rd 464th 465th 466th 467th 468th 469th 470th 471st 472nd 473rd 474th 475th 476th 477th 478th 479th 480th 481st 482nd 483rd 484th 485th 486th 487th 488th 489th 490th 491st 492nd 493rd 494th 495th 496th 497th 498th 499th 500th 501st 502nd 503rd 504th 505th 506th 507th 508th 509th 510th 511th 512th 513th 514th 515th 516th 517th 518th 519th 520th 521st 522nd 523rd 524th 525th 526th 527th 528th 529th 530th 531st 532nd 533rd 534th 535th 536th 537th 538th 539th 540th 541st 542nd 543rd 544th 545th 546th 547th 548th 549th 550th 551st 552nd 553rd 554th 555th 556th 557th 558th 559th 560th 561st 562nd 563rd 564th 565th 566th 567th 568th 569th 570th 571st 572nd 573rd 574th 575th 576th 577th 578th 579th 580th 581st 582nd 583rd 584th 585th 586th 587th 588th 589th 590th 591st 592nd 593rd 594th 595th 596th 597th 598th 599th 600th 601st 602nd 603rd 604th 605th 606th 607th 608th 609th 610th 611th 612th 613th 614th 615th 616th 617th 618th 619th 620th 621st 622nd 623rd 624th 625th 626th 627th 628th 629th 630th 631st 632nd 633rd 634th 635th 636th 637th 638th 639th 640th 641st 642nd 643rd 644th 645th 646th 647th 648th 649th 650th 651st 652nd 653rd 654th 655th 656th 657th 658th 659th 660th 661st 662nd 663rd 664th 665th 666th 667th 668th 669th 670th 671st 672nd 673rd 674th 675th 676th 677th 678th 679th 680th 681st 682nd 683rd 684th 685th 686th 687th 688th 689th 690th 691st 692nd 693rd 694th 695th 696th 697th 698th 699th 700th 701st 702nd 703rd 704th 705th 706th 707th 708th 709th 710th 711th 712th 713th 714th 715th 716th 717th 718th 719th 720th 721st 722nd 723rd 724th 725th 726th 727th 728th 729th 730th 731st 732nd 733rd 734th 735th 736th 737th 738th 739th 740th 741st 742nd 743rd 744th 745th 746th 747th 748th 749th 750th 751st 752nd 753rd 754th 755th 756th 757th 758th 759th 760th 761st 762nd 763rd 764th 765th 766th 767th 768th 769th 770th 771st 772nd 773rd 774th 775th 776th 777th 778th 779th 780th 781st 782nd 783rd 784th 785th 786th 787th 788th 789th 790th 791st 792nd 793rd 794th 795th 796th 797th 798th 799th 800th 801st 802nd 803rd 804th 805th 806th 807th 808th 809th 810th 811th 812th 813th 814th 815th 816th 817th 818th 819th 820th 821st 822nd 823rd 824th 825th 826th 827th 828th 829th 830th 831st 832nd 833rd 834th 835th 836th 837th 838th 839th 840th 841st 842nd 843rd 844th 845th 846th 847th 848th 849th 850th 851st 852nd 853rd 854th 855th 856th 857th 858th 859th 860th 861st 862nd 863rd 864th 865th 866th 867th 868th 869th 870th 871st 872nd 873rd 874th 875th 876th 877th 878th 879th 880th 881st 882nd 883rd 884th 885th 886th 887th 888th 889th 890th 891st 892nd 893rd 894th 895th 896th 897th 898th 899th 900th 901st 902nd 903rd 904th 905th 906th 907th 908th 909th 910th 911th 912th 913th 914th 915th 916th 917th 918th 919th 920th 921st 922nd 923rd 924th 925th 926th 927th 928th 929th 930th 931st 932nd 933rd 934th 935th 936th 937th 938th 939th 940th 941st 942nd 943rd 944th 945th 946th 947th 948th 949th 950th 951st 952nd 953rd 954th 955th 956th 957th 958th 959th 960th 961st 962nd 963rd 964th 965th 966th 967th 968th 969th 970th 971st 972nd 973rd 974th 975th 976th 977th 978th 979th 980th 981st 982nd 983rd 984th 985th 986th 987th 988th 989th 990th 991st 992nd 993rd 994th 995th 996th 997th 998th 999th 1000th 1001st 1002nd 1003rd 1004th 1005th 1006th 1007th 1008th 1009th 1010th 1011th 1012th 1013th 1014th 1015th 1016th 1017th 1018th 1019th 1020th 1021st 1022nd 1023rd 1024th 1025th 1026th 1027th 1028th 1029th 1030th 1031st 1032nd 1033rd 1034th 1035th 1036th 1037th 1038th 1039th 1040th 1041st 1042nd 1043rd 1044th 1045th 1046th 1047th 1048th 1049th 1050th 1051st 1052nd 1053rd 1054th 1055th 1056th 1057th 1058th 1059th 1060th 1061st 1062nd 1063rd 1064th 1065th 1066th 1067th 1068th 1069th 1070th 1071st 1072nd 1073rd 1074th 1075th 1076th 1077th 1078th 1079th 1080th 1081st 1082nd 1083rd 1084th 1085th 1086th 1087th 1088th 1089th 1090th 1091st 1092nd 1093rd 1094th 1095th 1096th 1097th 1098th 1099th 1100th 1101st 1102nd 1103rd 1104th 1105th 1106th 1107th 1108th 1109th 1110th 1111th 1112th 1113th 1114th 1115th 1116th 1117th 1118th 1119th 1120th 1121st 1122nd 1123rd 1124th 1125th 1126th 1127th 1128th 1129th 1130th 1131st 1132nd 1133rd 1134th 1135th 1136th 1137th 1138th 1139th 1140th 1141st 1142nd 1143rd 1144th 1145th 1146th 1147th 1148th 1149th 1150th 1151st 1152nd 1153rd 1154th 1155th 1156th 1157th 1158th 1159th 1160th 1161st 1162nd 1163rd 1164th 1165th 1166th 1167th 1168th 1169th 1170th 1171st 1172nd 1173rd 1174th 1175th 1176th 1177th 1178th 1179th 1180th 1181st 1182nd 1183rd 1184th 1185th 1186th 1187th 1188th 1189th 1190th 1191st 1192nd 1193rd 1194th 1195th 1196th 1197th 1198th 1199th 1200th 1201st 1202nd 1203rd 1204th 1205th 1206th 1207th 1208th 1209th 1210th 1211th 1212th 1213th 1214th 1215th 1216th 1217th 1218th 1219th 1220th 1221st 1222nd 1223rd 1224th 1225th 1226th 1227th 1228th 1229th 1230th 1231st 1232nd 1233rd 1234th 1235th 1236th 1237th 1238th 1239th 1240th 1241st 1242nd 1243rd 1244th 1245th 1246th 1247th 1248th 1249th 1250th 1251st 1252nd 1253rd 1254th 1255th 1256th 1257th 1258th 1259th 1260th 1261st 1262nd 1263rd 1264th 1265th 1266th 1267th 1268th 1269th 1270th 1271st 1272nd 1273rd 1274th 1275th 1276th 1277th 1278th 1279th 1280th 1281st 1282nd 1283rd 1284th 1285th 1286th 1287th 1288th 1289th 1290th 1291st 1292nd 1293rd 1294th 1295th 1296th 1297th 1298th 1299th 1300th 1301st 1302nd 1303rd 1304th 1305th 1306th 1307th 1308th 1309th 1310th 1311th 1312th 1313th 1314th 1315th 1316th 1317th 1318th 1319th 1320th 1321st 1322nd 1323rd 1324th 1325th 1326th 1327th 1328th 1329th 1330th 1331st 1332nd 1333rd 1334th 1335th 1336th 1337th 1338th 1339th 1340th 1341st 1342nd 1343rd 1344th 1345th 1346th 1347th 1348th 1349th 1350th 1351st 1352nd 1353rd 1354th 1355th 1356th 1357th 1358th 1359th 1360th 1361st 1362nd 1363rd 1364th 1365th 1366th 1367th 1368th 1369th 1370th 1371st 1372nd 1373rd 1374th 1375th 1376th 1377th 1378th 1379th 1380th 1381st 1382nd 1383rd 1384th 1385th 1386th 1387th 1388th 1389th 1390th 1391st 1392nd 1393rd 1394th 1395th 1396th 1397th 1398th 1399th 1400th 1401st 1402nd 1403rd 1404th 1405th 1406th 1407th 1408th 1409th 1410th 1411th 1412th 1413th 1414th 1415th 1416th 1417th 1418th 1419th 1420th 1421st 1422nd 1423rd 1424th 1425th 1426th 1427th 1428th 1429th 1430th 1431st 1432nd 1433rd 1434th 1435th 1436th 1437th 1438th 1439th 1440th 1441st 1442nd 1443rd 1444th 1445th 1446th 1447th 1448th 1449th 1450th 1451st 1452nd 1453rd 1454th 1455th 1456th 1457th 1458th 1459th 1460th 1461st 1462nd 1463rd 1464th 1465th 1466th 1467th 1468th 1469th 1470th 1471st 1472nd 1473rd 1474th 1475th 1476th 1477th 1478th 1479th 1480th 1481st 1482nd 1483rd 1484th 1485th 1486th 1487th 1488th 1489th 1490th 1491st 1492nd 1493rd 1494th 1495th 1496th 1497th 1498th 1499th 1500th 1501st 1502nd 1503rd 1504th 1505th 1506th 1507th 1508th 1509th 1510th 1511th 1512th 1513th 1514th 1515th 1516th 1517th 1518th 1519th 1520th 1521st 1522nd 1523rd 1524th 1525th 1526th 1527th 1528th 1529th 1530th 1531st 1532nd 1533rd 1534th 1535th 1536th 1537th 1538th 1539th 1540th 1541st 1542nd 1543rd 1544th 1545th 1546th 1547th 1548th 1549th 1550th 1551st 1552nd 1553rd 1554th 1555th 1556th 1557th 1558th 1559th 1560th 1561st 1562nd 1563rd 1564th 1565th 1566th 1567th 1568th 1569th 1570th 1571st 1572nd 1573rd 1574th 1575th 1576th 1577th 1578th 1579th 1580th 1581st 1582nd 1583rd 1584th 1585th 1586th 1587th 1588th 1589th 1590th 1591st 1592nd 1593rd 1594th 1595th 1596th 1597th 1598th 1599th 1600th 1601st 1602nd 1603rd 1604th 1605th 1606th 1607th 1608th 1609th 1610th 1611th 1612th 1613th 1614th 1615th 1616th 1617th 1618th 1619th 1620th 1621st 1622nd 1623rd 1624th 1625th 1626th 1627th 1628th 1629th 1630th 1631st 1632nd 1633rd 1634th 1635th 1636th 1637th 1638th 1639th 1640th 1641st 1642nd 1643rd 1644th 1645th 1646th 1647th 1648th 1649th 1650th 1651st 1652nd 1653rd 1654th 1655th 1656th 1657th 1658th 1659th 1660th 1661st 1662nd 1663rd 1664th 1665th 1666th 1667th 1668th 1669th 1670th 1671st 1672nd 1673rd 1674th 1675th 1676th 1677th 1678th 1679th 1680th 1681st 1682nd 1683rd 1684th 1685th 1686th 1687th 1688th 1689th 1690th 1691st 1692nd 1693rd 1694th 1695th 1696th 1697th 1698th 1699th 1700th 1701st 1702nd 1703rd 1704th 1705th 1706th 1707th 1708th 1709th 1710th 1711th 1712th 1713th 1714th 1715th 1716th 1717th 1718th 1719th 1720th 1721st 1722nd 1723rd 1724th 1725th 1726th 1727th 1728th 1729th 1730th 1731st 1732nd 1733rd 1734th 1735th 1736th 1737th 1738th 1739th 1740th 1741st 1742nd 1743rd 1744th 1745th 1746th 1747th 1748th 1749th 1750th 1751st 1752nd 1753rd 1754th 1755th 1756th 1757th 1758th 1759th 1760th 1761st 1762nd 1763rd 1764th 1765th 1766th 1767th 1768th 1769th 1770th 1771st 1772nd 1773rd 1774th 1775th 1776th 1777th 1778th 1779th 1780th 1781st 1782nd 1783rd 1784th 1785th 1786th 1787th 1788th 1789th 1790th 1791st 1792nd 1793rd 1794th 1795th 1796th 1797th 1798th 1799th 1800th 1801st 1802nd 1803rd 1804th 1805th 1806th 1807th 1808th 1809th 1810th 1811th 1812th 1813th 1814th 1815th 1816th 1817th 1818th 1819th 1820th 1821st 1822nd 1823rd 1824th 1825th 1826th 1827th 1828th 1829th 1830th 1831st 1832nd 1833rd 1834th 1835th 1836th 1837th 1838th 1839th 1840th 1841st 1842nd 1843rd 1844th 1845th 1846th 1847th 1848th 1849th 1850th 1851st 1852nd 1853rd 1854th 1855th 1856th 1857th 1858th 1859th 1860th 1861st 1862nd 1863rd 1864th 1865th 1866th 1867th 1868th 1869th 1870th 1871st 1872nd 1873rd 1874th 1875th 1876th 1877th 1878th 1879th 1880th 1881st 1882nd 1883rd 1884th 1885th 1886th 1887th 1888th 1889th 1890th 1891st 1892nd 1893rd 1894th 1895th 1896th 1897th 1898th 1899th 1900th 1901st 1902nd 1903rd 1904th 1905th 1906th 1907th 1908th 1909th 1910th 1911th 1912th 1913th 1914th 1915th 1916th 1917th 1918th 1919th 1920th 1921st 1922nd 1923rd 1924th 1925th 1926th 1927th 1928th 1929th 1930th 1931st 1932nd 1933rd 1934th 1935th 1936th 1937th 1938th 1939th 1940th 1941st 1942nd 1943rd 1944th 1945th 1946th 1947th 1948th 1949th 1950th 1951st 1952nd 1953rd 1954th 1955th 1956th 1957th 1958th 1959th 1960th 1961st 1962nd 1963rd 1964th 1965th 1966th 1967th 1968th 1969th 1970th 1971st 1972nd 1973rd 1974th 1975th 1976th 1977th 1978th 1979th 1980th 1981st 1982nd 1983rd 1984th 1985th 1986th 1987th 1988th 1989th 1990th 1991st 1992nd 1993rd 1994th 1995th 1996th 1997th 1998th 1999th 2000th 2001st 2002nd 2003rd 2004th 2005th 2006th 2007th 2008th 2009th 2010th 2011th 2012th 2013th 2014th 2015th 2016th 2017th 2018th 2019th 2020th 2021st 2022nd 2023rd 2024th 2025th 2026th 2027th 2028th 2029th 2030th 2031st 2032nd 2033rd 2034th 2035th 2036th 2037th 2038th 2039th 2040th 2041st 2042nd 2043rd 2044th 2045th 2046th 2047th 2048th 2049th 2050th 2051st 2052nd 2053rd 2054th 2055th 2056th 2057th 2058th 2059th 2060th 2061st 2062nd 2063rd 2064th 2065th 2066th 2067th 2068th 2069th 2070th 2071st 2072nd 2073rd 2074th 2075th 2076th 2077th 2078th 2079th 2080th 2081st 2082nd 2083rd 2084th 2085th 2086th 2087th 2088th 2089th 2090th 2091st 2092nd 2093rd 2094th 2095th 2096th 2097th 2098th 2099th 2100th 2101st 2102nd 2103rd 2104th 2105th 2106th 2107th 2108th 2109th 2110th 2111th 2112th 2113th 2114th 2115th 2116th 2117th 2118th 2119th 2120th 2121st 2122nd 2123rd 2124th 2125th 2126th 2127th 2128th 2129th 2130th 2131st 2132nd 2133rd 2134th 2135th 2136th 2137th 2138th 2139th 2140th 2141st 2142nd 2143rd 2144th 2145th 2146th 2147th 2148th 2149th 2150th 2151st 2152nd 2153rd 2154th 2155th 2156th 2157th 2158th 2159th 2160th 2161st 2162nd 2163rd 2164th 2165th 2166th 2167th 2168th 2169th 2170th 2171st 2172nd



Mortgages 36269 produced. 20 July 1946.  
at 12.15 pm from Barton, Ronald, Acland  
to John Hills. *W. H. H. C. P.*

84/260

84/260

Transmission of Mortgages 1029, 3173, 36269  
to Reginald Bruce Dyke Acland, Theodore Dyke  
Acland, Barton, Reginald Vaughan Mills  
and Dudley Acland Hills entered 26 July 1949  
at 12.20 pm

*W. H. H. C. P.* DLA

Transfer of Mortgages 1029, 3173, 36269 pro-  
duced 28 July 1949 at 11.15 am Reginald Bruce  
Dyke Acland, Theodore Dyke Acland, Barton  
Reginald Vaughan Mills and Dudley Acland  
Hills to Arthur Edgar Craven Rhodes  
*W. H. H. C. P.* DLA

Cancelled N/C 227/202

84/260

CANCELLED



NEW ZEALAND

CANCELLED

84/78

(C)  
No. 8

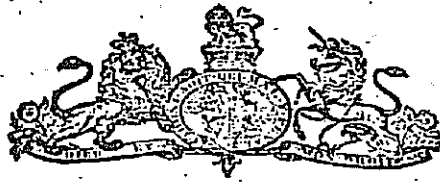

[CERTIFICATE OF TITLE]

Register Book,  
Vol. 811 Folio 18

John Barton Arundel Acland, of Mount Peel, Shropshire, now seized of an Estate in fee simple, subject nevertheless to such encumbrances, liens and interests as are notified by memorial underwritten or entered thereon in those pieces of Land situated in Blocks III and VI of the Mount Peel Survey District containing altogether Forty five acres more or less twenty five parcels or thereabouts, which said pieces of Land, are, colored green in the Plan heron and comprises the several Sections marked 30934 and 30935 delineated in the Plan heron, the said District deposited in the office of the Chief Surveyor originally purchased from the Crown on the twenty first day of March 1852 by the said John Barton Arundel Acland, M.C. who has hereunto signed my name and affixed my Seal this thirty first day of August. One thousand eight hundred and eighty two.

Signed in the presence of  
*W. M. Allan*  
the 31<sup>st</sup> day of August 1882



*W. M. Allan*  
District Land Registrar  
of the District of Canterbury

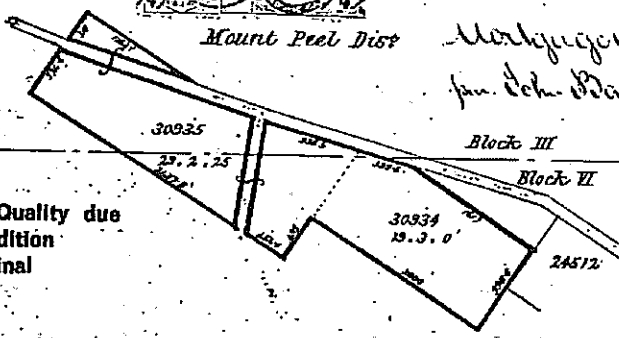

Image Quality due to Condition of Original

Scale, 10 chains to an inch.  
Surveyed by D. M. G. G.  
Chief Surveyor: T. F. Baker  
Draftsman: J. Foster  
11409

Mortgage 1020 produced 20<sup>th</sup> July 1880 at £20 for John Barton Arundel Acland to Arthur Mills.  
*W. M. Allan* D.L.R.

Mortgage 3016 produced 9 February 1896 from John Barton Arundel Acland to Dalgety and Company Limited.  
**DISCHARGED**  
*W. M. Allan* D.L.R.

Mortgage 31613 produced 5 September 1893 at £20 for John Barton Arundel Acland to The Union Bank of Australia Limited.  
*W. M. Allan*

Transfer of mortgage 31613 produced 8 June 1896 at £20 for The Union Bank of Australia Limited to Arthur Mills  
over *W. M. Allan*

84/78

84/78

84/78

Mortgage 36269 produced 20 July 1896 at  
12.15 pm from Arthur Mills Arthur Mills to  
Arthur Mills Arthur Mills

Transmission 3570 of Mortgages 10029, 31613, 36269  
to Reginald Brodie Dyke Cleland, Theodore Dyke  
Cleland, Barm. Reginald Vaughan Mills and  
Dudley Cleland Mills, entered 26 July 1899 at 12.20 pm  
Richard Richard

Transfer of Mortgages 10029, 31613, 36269  
produced 28 July 1899 at 11.15 am in Reginald Brodie  
Dyke Cleland, Theodore Dyke Cleland, Barm.  
Reginald Vaughan Mills and Dudley Cleland  
Mills to William Edgar Graham Richard

Cancelled N/C 227/202

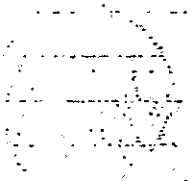

84/78

CANCELLED



NEW ZEALAND

CANCELLED

(CERTIFICATE OF TITLE.)

(C)  
No. 2



Register Book,

Vol. 814 Folio 77-

84/77

John Barton Arundel Acland of Mount Peel, District of Otago, is notified of an Estate in fee simple, subject unto the covenants, conditions and interests as are notified by memorial underwritten and indorsed hereon in those pieces of land situated in Block No. 11 of the Mount Peel Survey District containing together twenty acres or thereabouts which said pieces of land are colored green in the plan heron and comprise the Section marked 29399 delineated in the District Map of the said District deposited in the office of the Chief Surveyor originally purchased from the Crown on the thirtieth day of September 1877 by the said John Barton Arundel Acland.

Witness my hand and official seal this thirty first day of August One thousand eight hundred and eighty two.

Signed in the presence of  
*Connaught*

The 31<sup>st</sup> day of August 1882



*W. Matthews*

District Land Registrar  
of the District of Canterbury

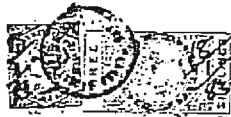

Block II Mount Peel Dist

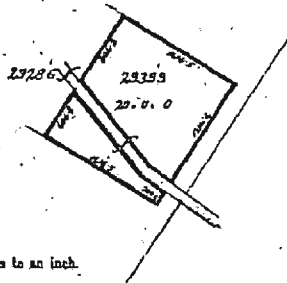

Scale, 70 chains to an inch.

Surveyed by *D. A. G. Z.*

Chief Surveyor: *J. H. Baker*

Draughtsman: *J. Walker*

1410

Mortgage No 10079 produced 20<sup>th</sup> July 1880  
at 1.30 pm John Barton Arundel Acland to  
Arthur Mills.

*W. Matthews*

Mortgage 30736 produced 9 February  
1893 at 2.25 pm John Barton Arundel  
Acland to Dalgety & Co. Limited.  
**DISCHARGED**  
14.12.1891  
*William A. D.*

Mortgage 31613 produced 5 September 1893  
at 2.32 pm John Barton Arundel Acland to The  
Union Bank of Australia Limited.

*W. Matthews*

Transfer of mortgage 31613 produced 8 June 1894  
at 2.30 pm The Union Bank of Australia Limited to Arthur  
Mills.  
*W. Matthews*

Image Quality due  
to Condition  
of Original

84/77

84/77

84/77

Mortgage 310269 produced 20 July 1996  
at 12.15 pm John Barton Surinder Selwade  
to Arthur Mills *(Witness) SA*

Transmission 3570 of mortgages 10029, 31613, 36269  
to Reginald Brodie Dyke Acland, Theodora Dyke  
Acland, Barrow, Reginald Vaughan Mills and  
Audrey Acland Mills entered 26 July 1999 at 12.30 pm  
*(Witness) SA*

Transfer of mortgages 10029, 31613, 36269 produced  
28 July 1999 at 11.15 am Reginald Brodie Dyke  
Acland, Theodora Dyke Acland, Barrow Reginald  
Vaughan Mills and Audrey Acland Mills to  
Arthur Edgar Gavenor Rhodes  
*(Witness) SA*

Cancelled N/C 227/202

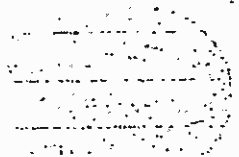

84/77

CANCELLED



CANCELLED

NEW ZEALAND.

(C)

No. C



(CERTIFICATE OF TITLE.)

Register Book,

Vol. 811 Folio 111

84/74

John Barton Grindel Acland, of Mount Peel, Sheepfarmer, is now seized of an Estate in fee simple subject nevertheless to such encumbrances, liens and interests as are notified by memorial underwritten or intimated herein in those pieces of land situated in Block VI of the Mount Peel Survey District containing together 200 Acres 2 Roods and 10 Perches which said pieces of land are colored green in the plan hereon and comprise the several Sections numbered 29250 situated in the District of the said District deposited in the office of the Chief Surveyor originally produced from the Crown on the sixth day of September 1891 by the said John Barton Grindel Acland.

In witness whereof I have hereunto signed my name and affixed my Seal this thirty first day of August One thousand eight hundred and ninety two.

Signed in the presence of  
Matthew  
the 31<sup>st</sup> day of August 1892



Matthew  
District Land Registrar  
of the District of Canterbury.



Block VI Mount Peel Dist

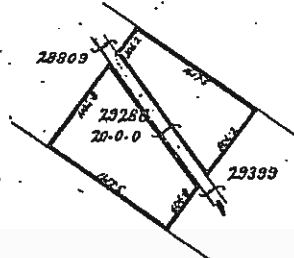

Image Quality due to Condition of Original

Scale, 70 chains to an inch.  
Surveyed by D. M. G. M.  
Chief Surveyor: J. F. H. Acland  
Draftsman: J. Walker  
11113

Mortgage 10029 produced 13<sup>th</sup> May 1880 at 1.30 pm John Barton Grindel Acland to Arthur Mills. Matthew

Mortgage 30736 produced 23<sup>rd</sup> February 1893 at 2.25 pm John Barton Grindel Acland to Dalgety and Company Limited. Matthew

Mortgage 31613 produced 5 September 1893 at 2.30 pm John Barton Grindel Acland to The Union Bank of Australia Limited. Matthew

Transfer of mortgage 31613 produced 8 June 1896 at 2.30 pm The Union Bank of Australia Limited to Arthur Mills. Matthew

over

84/74

84/74

84/74

Mortgages 30269 produced 30 July 1966  
at 11.15 pm. from Barton, Sussex, Road  
to Arthur Mills. *William D. D. R.*

Transfer of 3570 of Mortgage No. 31613, 31614  
to Reginald Brodie, Ireland, Meuron, Dyke  
Arlund, Burton Reginald, Vaughan Mills and  
Dudley, Ireland, Mills entered 26 July 1964, at 12.45 pm  
*William D. D. R.*

Transfer of mortgages 16624, 31613, 31614 produced  
20 July 1964 at 11.15 am Reginald Brodie, Dyke,  
Arlund, Meuron, Dyke, Ireland, Burton, Reginald,  
Vaughan, Mills and Dudley, Ireland, Mills to  
Arthur Edgar Craven, Rhodes.

*William D. D. R.*

Cancelled N/C 227/202

84/74

CANCELLED



# NEW ZEALAND

## CANCELLED

(C)  
Cat 89

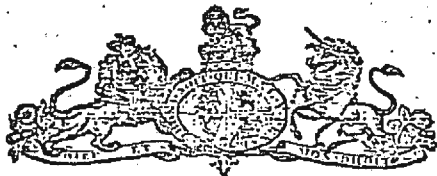

(CERTIFICATE OF TITLE.)

Register Book,

Vol 80 Folio 244

80/244

John Barton Arnold Acland of Auckland, New Zealand, is now seized of an Estate in fee simple subject to the rights hereinafter mentioned lands and interests as are notified by memorial and a vesting instrument known as those pieces of land situated in Block VI of the Auckland City District containing together a referenced and registered plan and conditions, which said pieces of land are colored green in the plan hereto annexed and comprise the Aerial Sections marked 29207 and 29208 delineated in the Public Map of the said District deposited in the office of the Chief Surveyor, originally purchased from the Government on the 26th day of September 1882 by the said John Barton Arnold Acland.

That I, the undersigned, John Barton Arnold Acland, do hereby certify that the above is a true and correct copy of the original as signed in the presence of the undersigned on the 21st day of July 1882.



*John Barton Arnold Acland*  
District Land Registrar  
of the District of Auckland

Block VI. M\* Peel Dist.

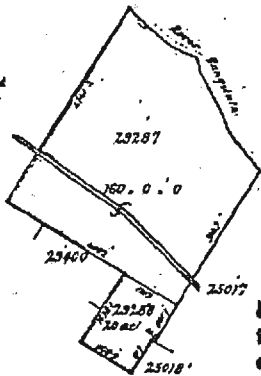

Image Quality due to Condition of Original

Scale, 20 chains to an inch.  
Surveyed by D. M. G. G.  
Chief Surveyor: J. E. R. G.  
Draftsman: J. K. G.

1254

Mortgage 11009 produced 20th July 1880 at 1.30 pm John Barton Arnold Acland to Arthur Mills

*Arthur Mills*

Mortgage 30736 produced 1st February 1893 at 2.25 pm John Barton Arnold Acland to Dalgety and Co. Limited.



*Arthur Mills*

Mortgage 31612 produced 5 September 1893 at 2.30 pm John Barton Arnold Acland to The Union Bank of Australia Limited

*Arthur Mills*

Mortgage 31613 produced 8 June 1894 at 2.30 pm The Union Bank of Australia Limited to Arthur Mills

*Arthur Mills*

Mortgage 36269 produced 20 July 1896 at 12.15 pm John Barton Arnold Acland to Arthur Mills

*Arthur Mills*

80/244



80/244

80/244

In and with 2870 of Mortgages 10029, 3163, 3626  
- to Reginald Brodie Dyke Acland, Theodore Dyke  
- Acland, Barton, Reginald Vaughan Mills and Dudley  
- Acland Mills. entered 26 July 1899 at 12.20 pm

*Cancelled* 218  
Transfer of Mortgages 10029, 3163, 3626  
produced 22 July 1899 at 11.15 am Reginald Brodie  
Dyke Acland, Theodore Dyke Acland, Barton  
Reginald Vaughan Mills and Dudley Acland  
Mills to Arthur Edgar Gravener Sholtoz

*Cancelled* 218  
Cancelled N/C 227/202

**CANCELLED**

80/244



NEW ZEALAND

CANCELLED

(C)

E. 4. 33

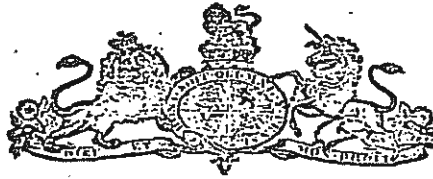

(CERTIFICATE OF TITLE.)

Register Book,

Fol. 80 Folia 243.

80/243

John Barton Arundel Acland, of Mount Peck, Shropshire, is now and of law estate in fee simple subject nevertheless to such encumbrances here and hereinafter as are notified by memorial instruments referred to hereon in that piece of land situated in Block VII of the Mt Peck District containing 28808 acres and 100 square rods, which said piece of land is colored green in the plan hereon and is the Acland Section under the 25505, situated in the Public Map of the said District passed in the office of the Chief Surveyor originally purchased from the Crown on the 13th day of August 1857 by the said John Barton Arundel Acland.

And I, the said John Barton Arundel Acland, signed my name and affixed my Seal this twenty first day of July 1862 in the presence of

*John Barton Arundel Acland*  
The 21<sup>st</sup> day of July 1862



*John Barton Arundel Acland*  
District Land Registrar  
of the District of Canterbury

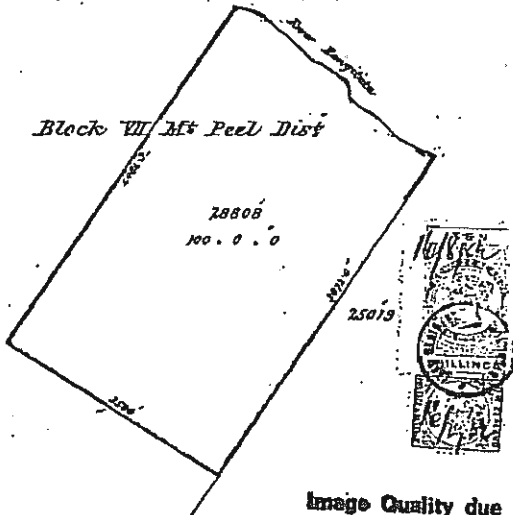

Image Quality due to Condition of Original

Scale, 10 chains to an inch.

Surveyed by *P. W. G. T.*

Chief Surveyor: *T. K. Acland*

Draughtsman: *T. K. Acland*

1255

a. 107-2015

Mortgage 147009 produced 25<sup>th</sup> July 1862 at 12.00 pm. John Barton Arundel Acland to his three Wills.

Mortgage 30736 produced 9<sup>th</sup> February 1893 **DISCHARGED** John Barton Arundel Acland to Dalgety and Company Limited *Arthur Mills*

Mortgage 31613 produced 5 September 1893 at 2.30 pm. John Barton Arundel Acland to The Union Bank of Australia Limited *Arthur Mills*

Transfer of Mortgage 31613 produced 9 June 1896 at 2.30 pm. The Union Bank of Australia Limited to Arthur Mills *Arthur Mills*

Mortgage 36262 produced 20 July 1876 at 12.15 pm. John Barton Arundel Acland to Arthur Mills *Arthur Mills*

80/243

80/243

Transmission 3570 of Mortgage 10029, 3113, 3164  
 to Reginald Brock by the Island, The Crown by the  
 Island, Barton Hospital, Vaughan Mills and Lady  
 Island Mills and on 25 July 1999 at 11:15 AM  
 Transfer of Mortgage 10029, 3113, 3164 produced  
 28 July 1999 at 11:15 AM Reginald Brock by the  
 Island, The Crown, by the Island, Barton Hospital  
 Vaughan Mills and Lady Island Mills to  
 Arthur Edgar (prevailing) Rhodes

80/243

Cancelled N/C 227/212

CANCELLED

80/243





80/242

80/242

Transmission 3570 of Mortgage 10029, 31615, 31616  
to Reginald Brodie Bylle Acland, Maurice Bylle  
Acland, Barton Reginald Vaughan Mills and  
Budley Acland Mills entered 26 July 1899 at 7.25 pm

*William B. B.*

Transfer of Mortgage 10029, 31615, 31616 by deed  
28 July 1899 at 11.15 am Reginald Brodie Bylle Acland  
Maurice Bylle Acland, Barton Reginald  
Vaughan Mills and Budley Acland Mills  
Arthur Edgar Graham Miles

*William B. B.*

Cancelled N/C 227/202

**CANCELLED**

80/242



NEW ZEALAND

CANCELLED

(C)  
C. 1199



(CERTIFICATE OF TITLE.)

Register Book,  
Vol. 80 Folio 241.

80/241

John Barton Arundel Acland, of Mount Peel, Waikato  
is now seized of an Estate in fee simple subject nevertheless to such encumbrances  
liens and interests as are notified by memorial under writ law or otherwise hereon in  
those pieces of land situated in Block VII of the Mt Peel District Survey District  
containing together Sixty five acres three roods thirty six perches or there-  
abouts which said pieces of land were and are in the joint name and comprise  
the several Sections numbered 25019 and 25020 situated in the District of  
the said District situated in the office of the Chief Surveyor originally ac-  
quired from the Crown on the twenty ninth day of May 1882 by the said  
John Barton Arundel Acland.

Made this whenof I have hereunto signed my name and affixed my Seal  
this twenty first day of July 1882

Signed in the presence of  
*W. R. G. G. G.*  
The 21<sup>st</sup> day of July, 1882  
Block VII Mt Peel Dist



*W. R. G. G.*  
District Land Registrar  
of the District of Canterbury

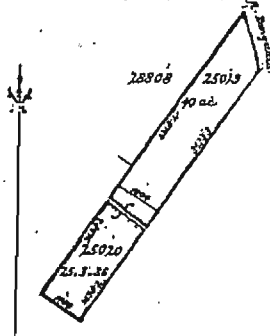

Image Quality due  
to Condition  
of Original

Scale, 20 chains to an inch.  
Surveyed by W. G. G.  
Chief Surveyor: J. F. Baker  
Draftsman: J. Walker

1257

1257-2118

Mortgage 170224 produced 23<sup>rd</sup> July 1880 at  
100 pm John Barton Arundel Acland to Arthur  
Mills.  
*Arthur Mills*

Mortgage 30736 produced 23<sup>rd</sup> February  
1893 at 2.25 pm ~~John Barton Arundel Acland~~  
Acland to Dalrymple & Company  
Limited.  
*Arthur Mills*

Mortgage 31613 produced 5 September  
1893 at 2.36 pm John Barton Arundel Acland  
to The Union Bank of Australia Limited.  
*Arthur Mills*

Correction of mortgage 31613 produced 3 June 1896  
2.30 pm The Union Bank of Australia Limited to  
Arthur Mills  
*Arthur Mills*

Mortgage 36264 produced 20 July 1896 at  
12.15 pm John Barton Arundel Acland to Arthur  
Mills.  
*Arthur Mills*

80/241

80/241

80/241

Transfer of Mortgages 10029, 31613, 36269  
to Reginald Brodie Byke Orland Theodore Byke Orland  
Barth Reginald Vaughan Mills and Ludwig Orland  
Mills entered 26 July 1949 at 12:20 pm

*W. Orland* 248

Transfer of Mortgages 10029, 31613, 36269 recorded  
28 July 1949 at 11:15 am Reginald Brodie Byke Orland  
Theodore Byke Orland Barth Reginald Vaughan  
Mills and Ludwig Orland Mills to Arthur  
Edgar Gravener Moore

*W. Orland* 248

Cancelled MC 227/202

80/241

