

Crown Pastoral Land Tenure Review

Lease name : THE JOLLIES

Lease number : PS 051

Due Diligence Report (including Status Report) - Part 2

This report and attachments results from a pre-Tenure Review assessment of the pastoral lease for the purpose of confirming land available for Tenure Review and any issues, rights or obligations attaching to it. The information is gathered from files and other sources available to the LINZ contractor.

Part of the information relates to research on the status of the land, resulting in a Status Report that is signed off by a LINZ approving officer. The remainder of the information is not analysed for relevancy or possible action until required, and LINZ does not guarantee its accuracy or completeness as presented.

The report attached is released under the Official Information Act 1982.

July 09

Sec E26
EYRE SD
123 13276
SD 2811

Pi Sec 155
EYRE SD
543-3785
SD 6867

Sec 1
SD 12005
1608.0000
Subject to the provision of Marginal Strips
Sec 24 Conservation Act 1987

Gar 1998 p 980

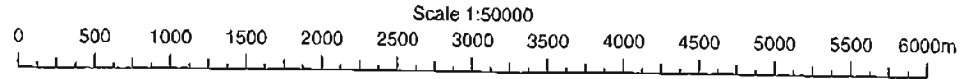
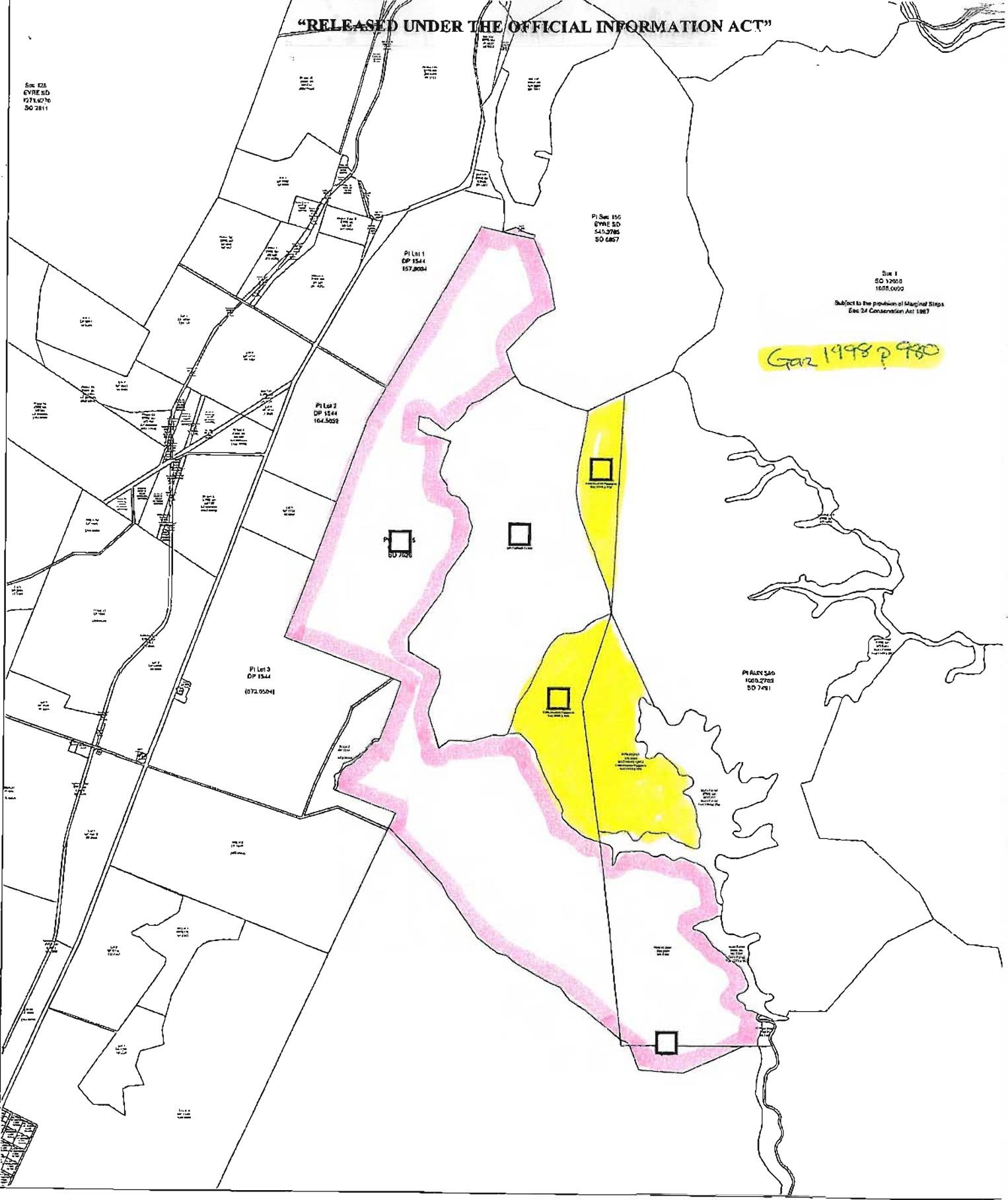

The Jollies
TERRALINK NZ LTD (Terraview)-DCDB Data as at 2.11.2000 Title & Valuation data as at 2.11.2000 Geodetic data as at 11.10.97.
Cadastral Information from LINZ Digital Cadastral Database (DCDB). CROWN COPYRIGHT RESERVED.

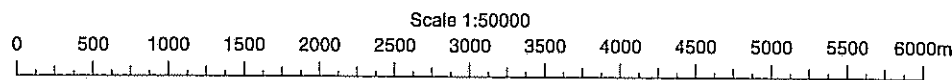
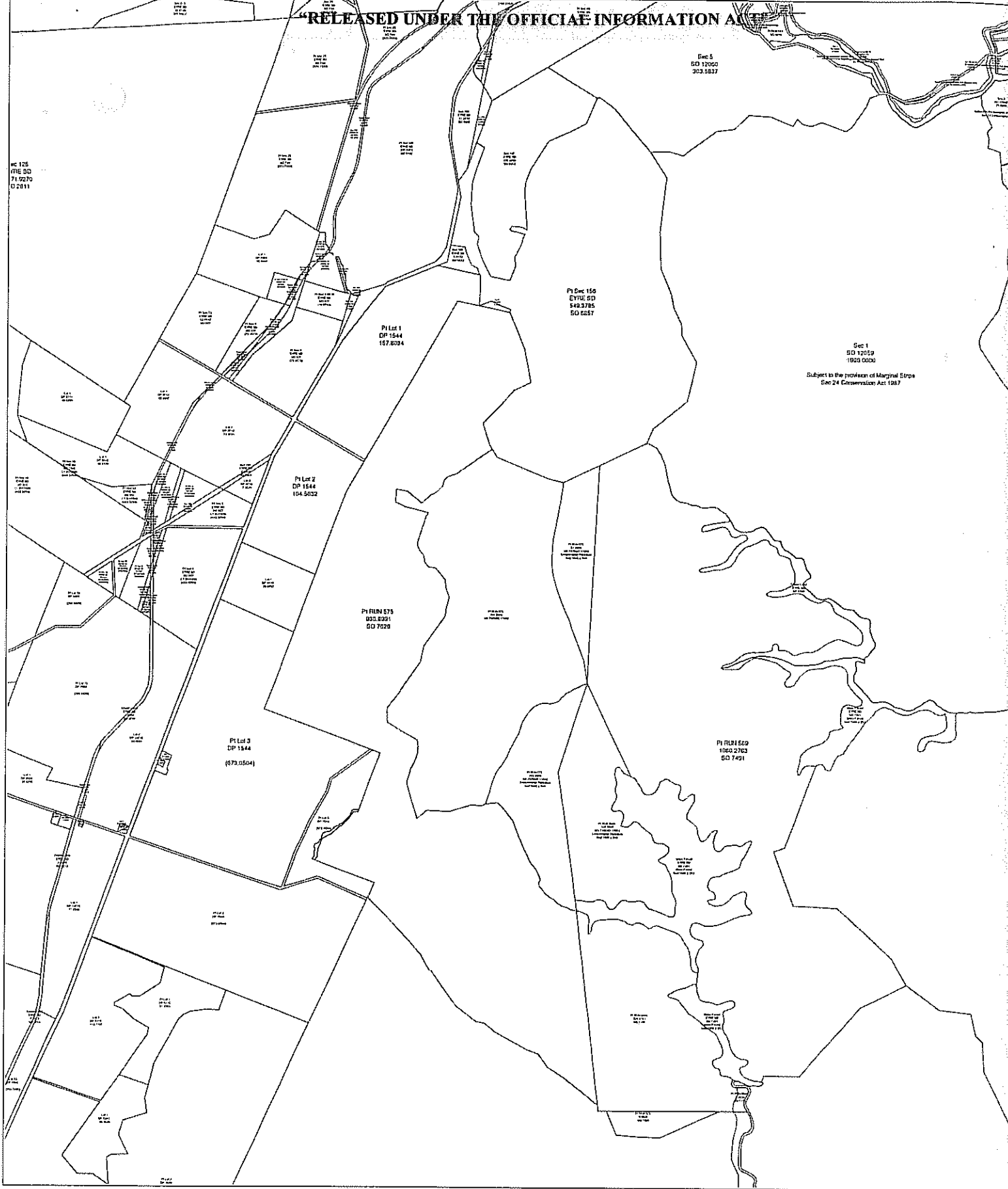

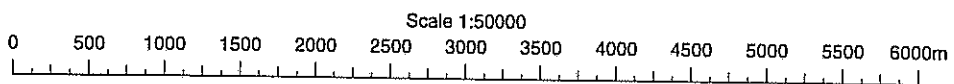

The Jollies

TERRALINK NZ LTD(Terraviva)-DCDB Data as at 2.11.2000 Title & Valuation data as at 2.11.2000 Geodetic data as at 11.10.97.
Cadastral Information from LINZ Digital Cadastral Database (DCDB). CROWN COPYRIGHT RESERVED.

SO 11860



View Statutory Action

Parcel Part Run 575
Current Purpose Conservation Purposes

Parcel Status Current

Statutory Action	Type	Recorded	Action	Status
New Zealand Gazette 1998 p 980	Gazette Notice	30/10/2000	Create	Current

Statute
Purpose Conservation Purposes
Name
Comments

*** End of Report ***

SO 7491



View Statutory Action

Parcel Crown Land Eyre Survey District
Current Purpose Crown Land Reserved from Sale (Marginal Strip)

Parcel Status Current

Statutory Action	Type	Recorded	Action	Status
Sec 58 Land Act 1948	Other Statutory actions	30/10/2000	Create	Current

Statute
Purpose Crown Land Reserved from Sale (Marginal Strip)
Name
Comments

*** End of Report ***

SO 7491



View Statutory Action

Parcel State Forest Eyre Survey District
Current Purpose State Forest

Parcel Status Current

Statutory Action	Type	Recorded	Action	Status
New Zealand Gazette 1886 p 253	Gazette Notice	30/10/2000	Create	Current

Statute

Purpose State Forest

Name

Comments

*** End of Report ***

SO 7626



View Statutory Action

Parcel Part Run 394A
Current Purpose Conservation Purposes

Parcel Status Current

Statutory Action	Type	Recorded	Action	Status
New Zealand Gazette 1998 p 980	Gazette Notice	30/10/2000	Create	Current

Statute
Purpose Conservation Purposes
Name
Comments

*** End of Report ***

So 7626



View Statutory Action

Parcel Part Run 575
Current Purpose Conservation Purposes

Parcel Status Current

Statutory Action	Type	Recorded	Action	Status
New Zealand Gazette 1998 p 980	Gazette Notice	30/10/2000	Create	Current

Statute
Purpose Conservation Purposes
Name
Comments

*** End of Report ***

SO 7195



View Statutory Action

Parcel Part Run 394A
Current Purpose Conservation Purposes

Parcel Status Current

Statutory Action	Type	Recorded	Action	Status
New Zealand Gazette 1998 p 980	Gazette Notice	30/10/2000	Create	Current
Statute				
Purpose	Conservation Purposes			
Name				
Comments				

*** End of Report ***

CDE_S15 - Request Manual Copy		X	
Document Type	Instrument	Request Id	16310
Reference Number	VL 216153.1	User Id	kirkdu
Land District	Southland	Request Date	29/08/2001
Method of Delivery	Post BOX	Client Reference	SNLITR.02/096YD THE JOLL
<input type="checkbox"/> Certified Copy		Status	Pending
Delivery Details			
Firm	Opus International Consultants Ltd - Dunedin		
Street	Private Bag 1913		
Town	Dunedin		
Country	New Zealand		
Postcode			
Fax Number	03 474 8995		
Eees...	OK		Cancel

John if not found
phone John + ask for CT number

**MEMORANDUM OF RENEWAL AND VARIATION
OF PASTORAL LEASE**

IN THE MATTER of the Land Transfer Act 1952
and the Land Act 1948

AND

IN THE MATTER of Pastoral Lease No Ps51
registered in Volume 229
Folio 98 Southland District Land
Registry from HER MAJESTY THE
QUEEN to JOLLIES INVESTMENTS
LIMITED AT DUNEDIN

- (1) Pursuant to Section 170 of the Land Act 1948 the term of the abovementioned lease registered in Volume 229 Folio 98 Southland Land Registry is renewed for a term of 33 years commencing on the 1st day of July 1992. The covenant to pay rent and the rental value contained in the lease is hereby varied by deleting the said covenant and substituting the following:

Yielding and paying therefore for the first 11 years of the said term unto the Landcorp Property Limited at Alexandra the annual rent of \$1,350.00 plus GST calculated on a rental value of \$90,000.00 payable without demand by equal half yearly payments in advance on the first day of January and the first day of July in each and every year during the said period of 11 years and for the next two successive periods of 11 years of the said term a rent determined in respect of each of those periods in the manner provided in Section 132A of the Land Act 1948.

Save as hereby expressly varied all the covenants conditions and restrictions contained or implied in the said Memorandum of Lease shall remain in full force.

IN WITNESS WHEREOF the parties have hereunto subscribed their names this
1st day of June 1973

SIGNED for and on behalf of HER MAJESTY
THE QUEEN by the Commissioner of Crown
Lands ~~in the presence of~~ Johnny Edmonds
in the presence of:

Witness: Bullen
Occupation: Postal Administration Officer
Department of Survey and Land Information
Address: Wellington

[Signature]
Commissioner of Crown Lands

The Common Seal of
JOLLIES INVESTMENTS LIMITED
as lessee was hereto-affixed
in the presence of:

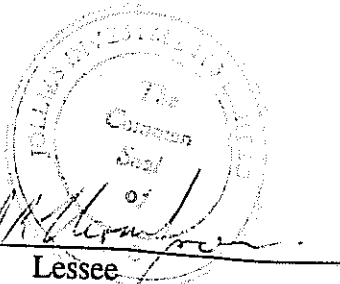

Witness: [Signature]
Occupation: Charlie Gearhart
Address: Dunedin

[Signature]
Lessee
R.J. Seltzer



DRAFT

Sec 1
SO 1266
10A5 0000
Subject to the provision of Marginal Strips
Sec 24 Conservation Act 1957

Sec 125
FYRE 70
1274234
SO 2811

Lot 1
DP 6761

Pt Sec LSC
FYRE 5D
540 3785
SO 6367

Pt Lot 1
DP 1544
157 8054

Pt Lot 2
DP 1544
104 3632

Pt Run 575

Pt Run 575
600 8991
SO 7870

To be reserved for
Soil Conservation
Purposes

DOC allocations
Sec 62 Land Act
1987

Pt Run 585
1060 2742
SO 7451

Pt Lot 3
DP 1544
1573 0504

26

27

Pt Run 394A

~~Marginal
Strip~~

The Jollies

Scale 1:50000

E43 E44

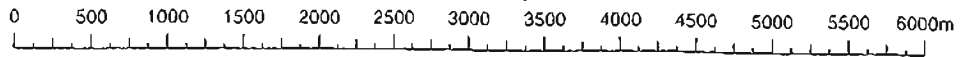

The Jollies

TERRALINK NZ LTD(Terraviva)-DCDB Data as at 2.11.2000 Title & Valuation data as at 2.11.2000 Geodetic data as at 11.10.97.
Cadastral Information from LINZ Digital Cadastral Database (DCDB). CROWN COPYRIGHT RESERVED.

DRAFT

CDE S15 - Request Manual Copy		X	
Document Type	Instrument	Request Id	16307
Reference Number	INCORP CERT 232715	User Id	jkirkdu
Land District	Southland	Request Date	29/08/2001
Method of Delivery	Post BOX	Client Reference	SNLITR.02/09BYD THE JOLL
<input type="checkbox"/> Certified Copy		Status	Pending
Delivery Details			
Firm	Opus International Consultants Ltd - Dunedin		
Street	Private Bag 1913		
Town	Dunedin		
Country	New Zealand		
Postcode			
Fax Number	03 474 8995		
Fees...	OK		Cancel

L. & S.—B. 5

CERTIFICATE OF ALTERATION UNDER SECTION 113, LAND ACT 1948

IN THE MATTER of the ~~Land Transfer Act 1952~~, and the Land Act 1948,

and

IN THE MATTER of lease (licence) from HER MAJESTY THE QUEEN to ROBERT GEORGE SELBIE of Eyre Creek Former of Part Run 575 situated in Block IV & VII, Eyre Survey District and Parts of Run 590A, Eyre Survey District,

registered in

Vol. 229 , folio 98 , Southland Land Registry.

This is to certify that on the 12th day of February 1969, the area of land included in the above mentioned lease was altered by the incorporation therein of the land described in the Schedule hereto ~~and shown in outline in the plan drawn hereon.~~

Schedule: Lot 2 DP 5761, being also part Section 42, Block XXXIX, Eyre Survey District. Area: 3 acres 2 roods 25.5 perches.

As witness my hand, this 11th day of March 1969

Assistant Commissioner of Crown Lands

Handwritten notes at the bottom left of the page.

CERTIFICATE OF ALTERATION

Not Registered under Land Transfer Act. — Registered under Land Act, 1948.

under Section 83,
 HERESTY THE QUEEN } Lessor,
 Licensor.
 GEORGE BELBIE } Lessee,
 Licensee.

PARTICULARS entered in the Register-book,

Volume 229, folio 98,

the 21 day of March 1969

at 11 o'clock.



[Signature]
 Assistant Land Registrar of the District
 District of Leventhal

MWP_0011995

LAND & DEEDS
Notes: <u>Good act</u>
Fees: <u>C C C</u>
<u>21 MAR 1969</u>
Time: <u>11 am</u>
Folio: <u>B2</u>
Abstract No: <u>745</u>

L. & S.—B. 5

CERTIFICATE OF ALTERATION UNDER SECTION 113, LAND ACT 1948

IN THE MATTER of the ~~Land Transfer Act 1952~~, and the Land Act 1948,

and

IN THE MATTER of lease (licence) from HER MAJESTY THE QUEEN to ROBERT GEORGE SELBIE of Eyre Creek Farmer of Part Run 575 situated in Block IV & VII, Eyre Survey District and Parts of Run 594A, Eyre Survey District,

registered in

Vol. 229, folio 98, Southland Land Registry.

This is to certify that on the 12th day of February 1969, the area of land included in the above mentioned lease was altered by the incorporation therein of the land described in the Schedule hereto ~~and shown on the plan~~ ~~to the plan shown heron.~~

Schedule: Lot 2 DP 6761, being also part Section 82, Block XXXIX, Eyre Survey District. Area: 5 acres 2 roods 25.5 perch.

(10/10/1969)

As witness my hand, this

11th

day of

March

1969

ASSISTANT Commissioner of Crown Lands

[Faint handwritten notes at the bottom left]

CERTIFICATE OF ALTERATION

Not Registered under Land Transfer Act. — Registered under Section 83, Land Act, 1948

ESTY THE QUEEN } Lessor, Licensor.
GEORGE SEIRIE } Lessee, Licensee.

PARTICULARS entered in the Register-book,

Volume 229, folio 98,

the 21 day of March 1969
at 11 o'clock.



[Signature]
Assistant Land Registrar of the District
District of *Southland*

MWP_0011995

LAND & DEEDS
Nature: *Gen Act*
File: *CCL*
21 MAR 1969
Time: *11*
Page: *82*
Abstract No. *745*

CDE S15 - Request Manual Copy		X	
Document Type	Instrument	Request Id	16306
Reference Number	CERT 232714	User Id	jkirkdu
Land District	Southland	Request Date	29/08/2001
Method of Delivery	Post <i>PKY</i>	Client Reference	6NLITR.02/096YD THE JOLL
<input type="checkbox"/> Certified Copy		Status	Pending
Delivery Details			
Firm	Opus International Consultants Ltd - Dunedin		
Street	Private Bag 1913		
Town	Dunedin		
Country	New Zealand		
Postcode			
Fax Number	03 474 8995		
Fees...	OK	Cancel	

L. & S.—B. 5

OF AREA
CERTIFICATE OF ALTERATION/UNDER SECTION 113, LAND ACT 1948

IN THE MATTER of the ~~Land Transfer Act 1952~~ and the Land Act 1948,

and

IN THE MATTER of lease (licence) from HER MAJESTY THE QUEEN to ROBERT GEORGE GELBIE of Eyre Creek Farmer of Part Run 575 situated in Block VII & VII, Eyre Survey District and Parts of Run 594A, Eyre Survey District, registered in Volume 225, folio 98, Southland Land Registry.
registered in

Vol. _____, folio _____, Land Registry.

This is to certify that the area of the land included in the above-mentioned lease has altered on re-survey. The correct area is now 4740 acres.

As witness my hand, this 11th day of March 1969

J. Shaw
ASSISTANT Commissioner of Crown Lands.

1/10/69

CERTIFICATE OF ALTERATION

Not Registered under Land Transfer Act, 1948
 Not Registered under Land Act, 1948

BY THE QUEEN } Lessor.
 } Licensor.
 _____ } Lessee.
 _____ } Licensee.

PARTICULARS entered in the Register-book,

Volume 229, folio 98.

the 21 day of March 1949
 at 11 o'clock.



Davis
 Assistant Land Registrar of the
 District of Southland

MWP_0011996



LAND & DEEDS
Case <u>Canogaed</u>
Type <u>CCL</u>
21 MAR 1969
Name _____
Vol. <u>20-3</u>
Page No. <u>745</u>

CDE S15 - Request Manual Copy		X	
Document Type	Instrument	Request Id	16304
Reference Number	SURR CERT 231855	User Id	kirkdu
Land District	Southland	Request Date	29/08/2001
Method of Delivery	Post BOX	Client Reference	SNLITR.02/096YD THE JOLL
<input type="checkbox"/> Certified Copy		Status	Pending
Delivery Details			
Firm	Opus International Consultants Ltd - Dunedin		
Street	Private Bag 1913		
Town	Dunedin		
Country	New Zealand		
Postcode			
Fax Number	03 474 8995		
Fees..	OK		Cancel

MEMORANDUM OF PARTIAL SURRENDER

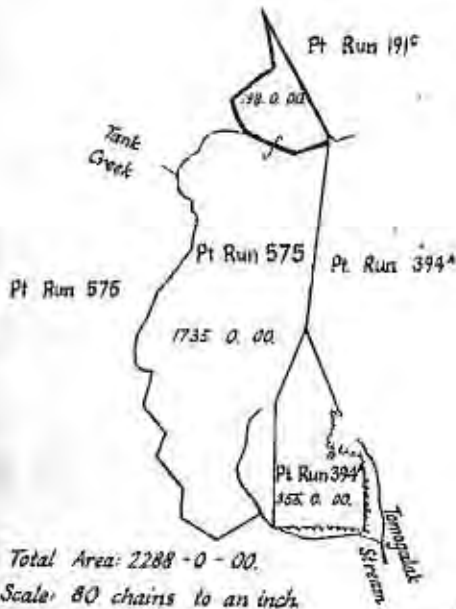

IN THE MATTER of the Land Transfer Act 1952

AND

IN THE MATTER of the Land Act 1948 and its amendments

AND

IN THE MATTER of Pastoral Lease No. P.51 under the Land Act 1948 of all that piece of land situated in the Southland Land District containing 4508 acres more or less being Run 575 Blocks IV and VII and Part Run 394A Eyre Survey District and being the whole of the land comprised and described in the aforesaid pastoral lease recorded in Register Book, Vol. 229 folio 98 Southland Registry.

Total Area: 2288 - 0 - 00.
Scale: 80 chains to an inch.

20.697 M.P.M.

R.G.S.
I, Robert George Selbie of Eyre Creek, farmer the Lessee under the abovementioned lease DO HEREBY SURRENDER in terms of Section 145 of the Land Act 1948 all my estate and interest as such Lessee in all that piece of land containing ~~4508~~ ¹⁷³⁵ acres more or less, being Part Run 575 and ~~394A~~ Eyre Survey District as the same is more particularly delineated on the plan hereon and therein coloured red in outline, with no alteration in the annual rental or stock limitation AND I AGREE AND DECLARE THAT all and singular the covenants conditions and agreements of the said recited lease expressed and/or implied shall continue in force in respect of the residus of the land henceforth comprised therein as fully and effectually as if such residus of the said land above had originally been comprised therein.

AND I HEREBY FURTHER AGREE AND DECLARE that the said surrender shall take effect from the 30th day of June 1964.

As witness my hand this 16 day of August 1964

Signed by the said Robert George Selbie in the presence of:

R.G. Selbie
Lessee

Witness: Phillips
Occupation: Lands Office Clerk
Address: Imvercargill

Surrender Accepted for and on behalf of Her Majesty the Queen as Lessor.

Signed by the Assistant Commissioner of Crown Lands for the Southland Land District in the presence of:

C. Oshea
Assistant Commissioner of Crown Lands

Witness: Phillips
Occupation: Lands Office Clerk
Address: Imvercargill

The Southland Catchment Board as encumbrancee under and by virtue of Notice of Charge No. 192767 under the Statutory Land Charges Registration Act 1928 heraby consents to the aforesaid surrender but without prejudice to its rights powers and remedies otherwise under or in respect of the said Notice of Charge No. 192767 or the remainder of the land therein described.

The common seal of The Southland Catchment Board was hereunto affixed in the presence of:

W. J. ... Chairman
... Secretary



11 FEB 1969

231855

Act Land Registrar, SOUTHLAND

WE, Lucy Agnes Selbie, James Scott Marshall and Horace James Macalister as mortgagees under and by virtue of Memorandum of Mortgage No. 77749 do hereby consent to the aforesaid surrender but without prejudice to our rights powers and remedies otherwise under or in respect of the said mortgage or the remainder of the land therein described.

Signed by the said

J. Marshall *H. Macalister*

Lucy Agnes Selbie as mortgagee in the presence of:

James Scott Marshall as mortgagee in the presence of:

Horace James Macalister as mortgagee in the presence of:

Witness: _____

Witness: *Mumie*

Witness: *Mumie*

Occupation: _____

Occupation: *Solutor*

Occupation: *Solutor*

Address: _____

Address: *Murray*

Address: *Murray*

I, Janet McKay Selbie, as encumbrances under and by virtue of Memorandum of Encumbrance No. 195024 do hereby consent to the aforesaid surrender but without prejudice to my rights powers and remedies otherwise under or in respect of the said encumbrance or the remainder of the land therein described:

Signed by the said Janet McKay Selbie as mortgagee in the presence of:

J. M. Selbie
Mortgagee

Witness: *[Signature]*

Occupation: *Land Agent*

Address: *[Address]*

Correct for the purposes of the Land Transfer Act

Part Surrender of Land PARTICULARS ENTERED IN THE REGISTER-BOOK VOLUME 229 FOLIO 98

[Signature]
Assistant Commissioner of Crown Lands

THE 11 DAY OF February 1969 AT 2.16 O'CLOCK.



[Signature]
Assistant Land Registrar Southland



*Pt. Surrender
CC2
2.16
Feb
295*

Not Registered under Land Transfer Act.—Registered under Section 83, Land Act, 1948

CDE_S15 - Request Manual Copy		X	
Document Type	Instrument	Request Id	16303
Reference Number	INCOR CERT 193755	User Id	kikdu
Land District	Southland	Request Date	29/08/2001
Method of Delivery	Post Box	Client Reference	GNLITR.02/096YD THE JOLL
<input type="checkbox"/> Certified Copy		Status	Pending
Delivery Details			
Firm	Opus International Consultants Ltd - Dunedin		
Street	Private Bag 1913		
Town	Dunedin		
Country	New Zealand		
Postcode			
Fax Number	03 474 8995		
Fees...	OK		Cancel

L. & S.—B. O.

Certificate of Alteration under Section 113, Land Act, 1948

IN THE MATTER of the Land Transfer Act, ¹⁹⁵² ~~1925~~, and the Land Act, 1948,

and

IN THE MATTER of lease [licence] from His Majesty the King to Janet Lasky Colbie of Tyre Creek, Widow, James Brighton Peake of Invercargill, Solicitor and Colin Edward Peake of Invercargill, Public Accountant, of all that ~~area~~ of land containing 3000 acres being ~~Map 975~~ situated in District 12, ~~of 711~~, Tyre Survey District and

registered in Vol. 220, folio 21, Southland Land Registry.

THIS is to certify that on the First day of March, 1963, the area of land included in the above-mentioned lease [licence] was altered by the incorporation therein of the land described in the First Schedule hereto and shown red in outline on the plan drawn hereon [and the exclusion therefrom of the land described in the Second Schedule hereto and shown green in outline on the plan drawn hereon].

Consequent on the alteration in area aforesaid, the rental value and annual rent were altered on the same date to the following amounts:—

Rental value: £ _____ Annual rent: £ _____

FIRST SCHEDULE

(Description and plan of land incorporated)

Part 344, Tyre Survey District
Area: 300 acres



Scale = 40 chains to an inch.
S.O. 7195.

As witness my hand, this 10 day of October, 1963

[Signature]
Commissioner of Crown Lands.

193755

4.

Not registered under the Land Transfer Act

Not registered under the Land Act, 1948

Certificate of Alteration

HIS MAJESTY THE KING, } Lessor.
Grantor.

} Lessee.
Licensee.

PARTICULARS entered in the Register-book, Vol. 229

folio 98, the 29 OCT 1963 day of

19, at 11:40 o'clock.



[Signature]
District (Asst.) Land Registrar of the

District of SOUTHLAND

1963/10/29

193755

10
10
10
10

LAND & DEEDS
Historic
To Mr C. C. Rowland
29 OCT 1963



MWP_0011983

[Handwritten mark]

CDE S15 - Request Manual Copy		X	
Document Type	Instrument	Request Id	16311
Reference Number	SURRENDER 230352.3	User Id	jkikdu
Land District	Southland	Request Date	29/08/2001
Method of Delivery	Post <i>BOX</i>	Client Reference	6NLITR.02/096YD THE JOLL
<input type="checkbox"/> Certified Copy		Status	Pending
Delivery Details			
Firm	Opus International Consultants Ltd - Dunedin		
Street	Private Bag 1913		
Town	Dunedin		
Country	New Zealand		
Postcode			
Fax Number	03 474 8995		
Fees...	OK		Cancel

Department of Conservation
Te Atawhai

31 March 1995

District Land Registrar
Land and Deeds Registry Office
Henderson House
93 Kelvin Street
INVERCARGILL

PARTIAL SURRENDER - 229/98

The fee charged for registration of this partial surrender would be payable directly or indirectly from the Crown Bank Account (formerly the Consolidated Revenue Account).

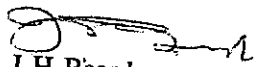

J H Beard
Regional Solicitor
for Regional Conservator

MEMORANDUM OF PARTIAL SURRENDER

IN THE MATTER of the Land Act 1948

AND

IN THE MATTER of Pastoral Lease No. P51 under the Land Act 1948 of ALL those pieces of land situated in the Southland Land District containing 1919.6908 hectares more or less being Part Run 394A situated in Block IV Parts Run 575 situated in Blocks IV and VII and Lot 2 DP 6761 situated in Block XXXIX Eyre Survey District and being the balance of the land comprised and described in the aforesaid Pastoral Lease recorded as Register Volume 229 folio 98 (Southland Registry)

JOLLIES INVESTMENTS LIMITED at Dunedin the Lessee under the abovementioned lease DOES HEREBY SURRENDER in terms of section 145 of the Land Act 1948 all its estate and interest as such Lessee in all those pieces of land containing altogether ⁷⁵⁵~~1356~~ hectares more or less being those parts of Run 575 shown "A" "B" and "C" on SO 11860 and that part of Run 394A shown "A" on SO 12054 the said parcels of land being more particularly shown on the attached copies of SO 11860 and 12054.

AND IT AGREES AND DECLARES THAT all and singular the covenants conditions and agreements of the said recited Lease expressed and/or implied shall continue in force in respect of the residue of the land henceforth comprised therein as fully and effectually as if such residue of the said land above had originally been comprised therein

AND IT HEREBY FURTHER AGREES AND DECLARES that the said surrender shall take effect on the 2nd day of February 1995

THE COMMON SEAL of)
JOLLIES INVESTMENTS LIMITED)
was hereunto affixed)
in the presence of:)

R. F. Selbie

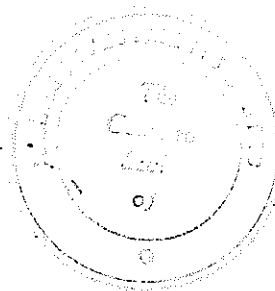
Dunedin



SURRENDER ACCEPTED for and on behalf of Her Majesty the Queen as Lessor

DATED the 2nd day of FEBRUARY 1995

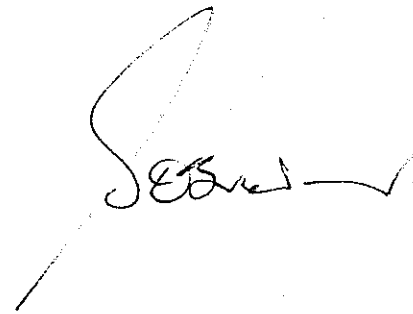
SIGNED by the Commissioner of Crown)
Lands for and on behalf of **HER MAJESTY**)
THE QUEEN as Lessor in the presence of:)



*Mr. P. G. ...
Senior Land Information Officer
Department of Survey and Land Information
Wellington*

CERTIFICATE OF NON-REVOCATION OF POWER OF ATTORNEY

We, Gerard Joseph Callaghan of Christchurch and Donald Vernon Tyree of Christchurch, New Zealand,

Bank Officers, severally certify that:

- 1. By deed dated 25 May 1994 (the "Deed") we were, by virtue of being respectively a SECOND Authorised Officer and a SECOND Authorised Officer, appointed jointly as attorneys of Bank of New Zealand (the "Bank") on the terms and subject to the conditions set out in the Deed.
2. Copies of the Deed are deposited in the Land Transfer Offices at: Auckland as No. C622693.1F, Christchurch as No. A124795.1, Gisborne as No. G198246.1, Hokitika as No. 098538, Napier as No. 609666.1, New Plymouth as No. 412259, Blenheim as No. 174983, Dunedin as No. 859913, Hamilton as No. B214884, Invercargill as No. 221983.1, Nelson as No. 339830.1, Wellington as No. B363693.1
3. We have executed the instrument(s) to which this certificate relates under the powers conferred by the Deed.
4. At the date of this certificate we have not received any notice or information of the revocation of that appointment by the dissolution of the Bank or otherwise.

SIGNED at Christchurch

this 20 day of Feb 1995

Signature of Gerard Joseph Callaghan

SIGNED at Christchurch

this 20 day of Feb 1995

Signature of Donald Vernon Tyree



BANK OF NEW ZEALAND as Mortgagee under and by virtue of Memorandum of Mortgage 185601.2 **DOES HEREBY CONSENT** to the aforesaid surrender **BUT WITHOUT PREJUDICE** to its rights powers and remedies otherwise under or in respect of the Mortgage

Dated on 20th day of February 1995

SIGNED for and on behalf of BANK OF NEW ZEALAND by its Attorneys	BANK OF NEW ZEALAND by its Attorneys:-
Gerard Joseph Callaghan	
Donald Vernon Tyree	

In the presence of:

.....
STEPHEN JAMES MACKLE
Bank Officer
Christchurch

595 0002

Correct for the purposes of the Land Transfer Act

Solicitor for the Lessor

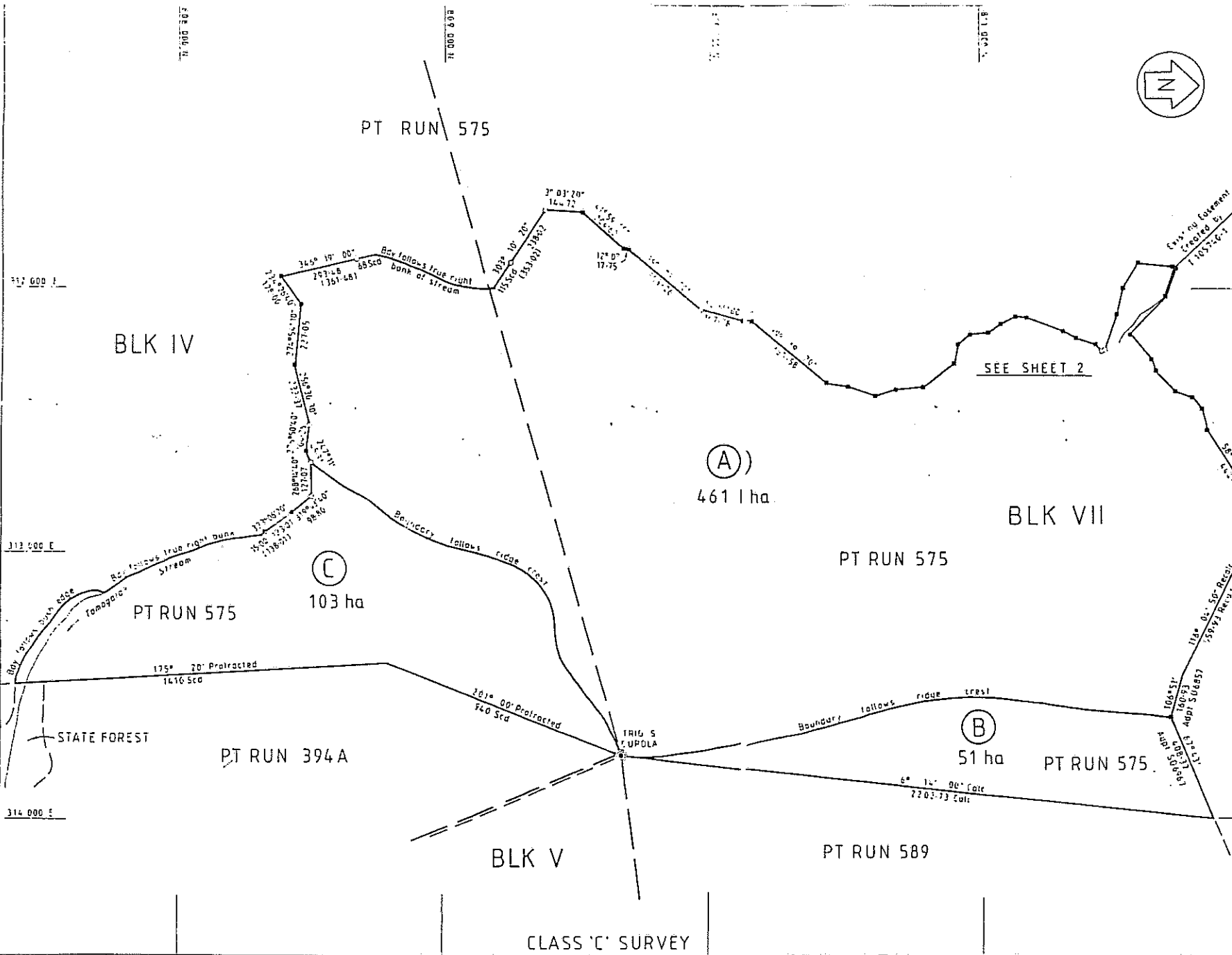

Approvals

APPROVED AS TO LAYOUT

K.R Taylor, Managing Consultant for LANDCO

APPROVED AS TO LAYOUT

K. Mawhinney, Regional Conservator for DEPT OF CONSERVATION.

LAND TO BE SET APART

Shown	Area	Description	Purpose
A	461 ha	PT Run 575	Soil Conserv. Reserve
B	51 ha	PT Run 575	Scenic Reserve
C	103 ha	PT Run 575	Scenic Reserve

PT RUN 575

PT RUN 575

PT RUN 575

PT RUN 575

PT SEC 156

Total Area 615 ha

Comprised in R.B. 229/98 (Part)

I, RONALD JAMES KEEN
Registered Surveyor and holder of an annual practicing certificate for 1992
may act as a registered surveyor pursuant to section 25 of the Survey Act 1986
I hereby certify that this plan has been made from correct data by me or under my directions, that both plan and survey are correct and have been made in accordance with the Survey Regulations or regulations made in substitution thereof

Dated at DUNEDIN this 26th day of JUNE 1992

Signature: *R. J. Keen*

Examined *B. J. Harty* Chief Registrar

Approved as to Survey for Gazetted Purposes only

Signature: *R. J. Keen* Chief Surveyor

Deposited this day of 1992

District Land Registrar

LAND DISTRICT SOUTHLAND

Survey Blk. & Dist. IV & VII EYRE S.D.

NZMS 261 Sheet E 43 Record Map No. E 44

LAND TO BE SET APART

TERRITORIAL AUTHORITY SOUTHLAND DISTRICT

Surveyed by R. J. KEEN

Scale 1: 10 000 Date MARCH 1992

File 513
Received 3 7 92 SRA
Instructions Job 913

SO 11860

RELEASED UNDER THE OFFICIAL INFORMATION ACT

“RELEASED UNDER THE OFFICIAL INFORMATION ACT”

BLK VII

PT RUN 575
SO 11860

PT RUN 575
SO 11860

TRIG S. CUPOLA

PT RUN 589

PT RUN 575
SO 11860

BLK IV

BLK V

(A)

140 ha

PT RUN 575

PT RUN 394 A

STATE FOREST

BOUNDARY FOLLOWS

BUSH EDGE

Tomagalak Stream
(left branch)

Tomagalak Stream
(right branch)

SO 7195

COMPILED PLAN

NOTE
The bush edge and creeks on this plan have been defined from NZMS 270, Sheet E 43/D and Sheet E 44/B



Approved
For and on behalf of
by Milton D. Smith
Manager, DCSI, Invercargill
M.D. Smith
M. D. Smith
Registered Proprietor

Approved as to Layout
[Signature]
Regional Conservator
Department of Conservation

LAND TO BE SET APART
Shown Area Description Purpose
A 140 ha Pt Run 394 A Scenic Reserve

DATUM: GEODETIC 1949
CIRCUIT: BLUFF
ORIGIN OF COORDINATES: OBSERVATION
SPOT, 700 000 mN & 300 000 mE

Total Area 140 ha.
Comprised in R.B. 229/98 (Part)

I, RONALD JAMES KEEN,
Registered Surveyor and holder of an annual practicing certificate for who may act as a registered surveyor pursuant to section 25 of the Survey Act 1956) hereby certify that this plan has been made from surveys executed by me or under my direction, that both plan and survey are correct and have been made in accordance with the Survey Regulations 1972 or any regulations made in substitution thereof.
Dated at DUNEDIN this 17th day
of NOVEMBER 1994 Signature *R. James Keen*

Field Book — p Traverse Book — p
Reference Plans SOs 7195, 7491, 7626, 11860

Examined *[Signature]* Correct *K. Hawkes*

Approved for Gazetted Purposes only
13/12/94 *[Signature]*
Acting Chief Surveyor

Deposited this day of 19
District Land Registrar

LAND DISTRICT SOUTHLAND
Survey Blk. & Dist. BLK IV, EYRE S.D.
E 43 E 43/7-4
NZMS 261 Sheet E 44 Record Map No. E 44/7-1

LAND TO BE SET APART

TERRITORIAL AUTHORITY SOUTHLAND DIST.
Surveyed by R. J. KEEN
Scale 1:10,000 Date NOV. 1994

File 5/3
Received 23 November 1994
Instructions Job 9213 SO 12054

9.15 26.APR95

230352 - 3

PARTICULARS ENTERED IN THE
 LAND REGISTRY SOUTH ISLAND
 # 229/98
 ASST. LAND REGISTRAR
 SOUTHLAND N.Z.



MWP_0011989

"RELEASED UNDER THE OFFICIAL INFORMATION ACT"

MEMORANDUM OF PARTIAL SURRENDER

Regional Solicitor
 Department of Conservation
 DUNEDIN