

Crown Pastoral Land Tenure Review

Lease name : WATERLOO STATION

Lease number : PS 016

Due Diligence Report (including Status Report) - Part 2

This report and attachments results from a pre-Tenure Review assessment of the pastoral lease for the purpose of confirming land available for Tenure Review and any issues, rights or obligations attaching to it. The information is gathered from files and other sources available to the LINZ contractor.

Part of the information relates to research on the status of the land, resulting in a Status Report that is signed off by a LINZ approving officer. The remainder of the information is not analysed for relevancy or possible action until required, and LINZ does not guarantee its accuracy or completeness as presented.

The report attached is released under the Official Information Act 1982.

July 09

Dated the 4th day of September, 1923.

AS Gairdner
Commissioner of Crown Lands.

Land Board,

10/2/23.

The terms of written license is hereby renewed
to the 5th July 1925 & such license is
hereby approved & confirmed.

Transfer No 94375 of a lot 3000 share William
Charles G. William Murray Charles and John
Charles both of Murray Creek
Farmers as tenants in common in equal
shares Entered 21/4/30 at 222 - *James*

W.L.
W.M.G.
G.O.R.

See Pastoral License issued for land
herein for and to be 1923. This 3
Ampleman
D.R.

CANCELLED

THIS REPRODUCTION (ON A REDUCED SCALE)
CERTIFIED TO BE A TRUE COPY OF THE
ORIGINAL REGISTER FOR THE PURPOSES OF
SECTION 215A LAND TRANSFER ACT 1952.

James

D.L.R.

169/29

Dated 1st March 1920

THE
COMMISSIONER OF CROWN LANDS

Quercargill

to
*William Charles the
Younger*
PASTURAGE LICENSE.
Central Bus. 175th Street

33

11
MN

Hington, this twenty-fourth day of February, in the year of our Lord one thousand eight hundred and eighty-six.

P. A. BUCKLEY,
(For the Minister of Lands.)

Approved in Council.
FORSTER GORING,
Clerk of the Executive Council.

GOD SAVE THE QUEEN!

Land set apart for a Village Settlement in Block VII., Invercargill Hundred, Southland Land District.

(L.S.) Wm. F. DRUMMOND JERVOIS,
Gov. Gen.

A PROCLAMATION.

IN pursuance and exercise of the powers and authorities conferred upon me by the one hundred and sixty-sixth section of "The Land Act, 1885," I, William Francis Drummond Jervois, the Governor of the Colony of New Zealand, do hereby set apart the land described in the Schedule hereto for sale as a village settlement, upon such terms and conditions as are to be set forth in an Order in Council to be made under the one hundred and sixty-seventh section of the said Act.

SCHEDULE.

VILLAGE SETTLEMENT, BLOCK VII., INVERCARGILL HUNDRED.

Small-farm Allotments.

| Section. | Acres. | Section. | Acres. |
|---|---------|----------|---------|
| A. R. P. | | A. R. P. | |
| 95 | 6 3 50 | 105 | 12 2 1 |
| 96 | 8 1 10 | 106 | 6 0 0 |
| 100 | 7 3 22 | 110 | 8 0 0 |
| 101* | 9 0 38 | 111 | 2 0 24 |
| 102 | 6 2 33 | 112 | 2 2 22 |
| 104 | 10 1 28 | 113 | 2 2 14 |
| Subject to £150 valuation for saw-mill and plant on the land. | | | |
| 90 | 0 0 13 | 97 | 10 0 19 |
| 91 | 10 2 25 | 99 | 10 1 30 |
| 92 | 9 0 4 | 103 | 8 0 12 |
| 93 | 5 3 6 | 107 | 11 3 30 |
| 94 | 11 2 9 | 108 | 14 2 20 |
| 95 | 10 1 21 | | |

Given under the hand of His Excellency Sir William Francis Drummond Jervois, Lieutenant-General in Her Majesty's Army, Knight Grand Cross of the Most Distinguished Order of Saint Michael and Saint George, Companion of the Most Honourable Order of the Bath, Governor and Commander-in-Chief in and over Her Majesty's Colony of New Zealand and its Dependencies, and Vice-Admiral of the same; and issued under the Seal of the said Colony, at the Government House, at Wellington, this twenty-fourth day of February, in the year of our Lord one thousand eight hundred and eighty-six.

P. A. BUCKLEY,
(For the Minister of Lands.)

GOD SAVE THE QUEEN!

Declaring State Forests in the Land District of Southland.

(L.S.) Wm. F. DRUMMOND JERVOIS,
Governor.

A PROCLAMATION.

BY virtue and in exercise of the powers and authorities vested in me by "The New Zealand State Forests Act, 1885," and of every other power and authority enabling me in that behalf, I, William Francis Drummond Jervois, the Governor of the Colony of New Zealand, by and with the advice and consent of the Executive Council of the said Colony, do hereby set apart the forests lands described in the Schedule hereto, forming part of the Crown lands in New Zealand, as and for State forests within the provisions of the said Act.

SCHEDULE.

1. All that area containing 11,400 acres or thereby, and comprising Blocks XXII., XXIII., and XXIV., Invercargill Hundred; excepting out of the said area all those sections in Block XXII. aforesaid which have been already surveyed.

2. All that area containing 722 acres 1 rood 21 perches or thereby, comprising Sections 43 to 49 inclusive of Block X., Invercargill Hundred, and the bush reserves lying south of said Sections Nos. 46 to 49.

3. All that area containing 345 acres 3 roods 8 perches or thereby, comprising bush reserves lying west of Sections Nos. 1, 2, and 3, Block XVIII., Invercargill Hundred.

4. All that area containing 6,700 acres or thereby, comprising all the bush land situate in Blocks VIII. and IX., Campbelltown Hundred; excepting all those sections in Block VIII. aforesaid which have been already surveyed.

5. All those areas containing 12,420 acres or thereby, and comprising all the bush land situate in Blocks II., III., IV., V., VII., IX., X., and XI., Otaramika Hundred; excepting from the above all sections that have been either sold or surveyed with a view to sale.

6. All that area containing 1,500 acres or thereby, and comprising all the bush land situate in Block XXI., New River Hundred; excepting from the above all sections that have either been sold or surveyed with a view to sale.

7. All that area containing 24,200 acres or thereby, and comprising all the bush land situate in Blocks VIII., XIII., XVII., XVIII., XIX., XX., XXI., and XXII., Jacob's River Hundred; excepting from the above all mining-lease areas and all sections that have either been sold or surveyed with a view to sale.

8. All that area containing 15,500 acres or thereby, and comprising all the bush land situate in Blocks I., III., IV., V., VI., and VII., Apanui Hundred; excepting from the above all sections that have been either sold or surveyed with a view to sale.

9. All that area containing 6,200 acres or thereby, and comprising all the bush land situate in Blocks II., III., and VIII., Winton Hundred; excepting from the above all sections that have either been sold or surveyed with a view to sale.

10. All that area containing 330 acres or thereby, and comprising all the unsold portion of Spar Bush, situate in the Oreti Survey District.

11. All that area containing 51,600 acres or thereby, and comprising all the bush land situate in the Longwood Survey District; excepting from the above all Native reserves, mining areas, and all sections that have been either sold or surveyed with a view to sale.

12. All that area containing 11,400 acres or thereby, and comprising all that portion of the Dunsdale and other forests situate in the Waimumu Survey District; excepting from the above all sections that have been either sold or surveyed with a view to sale, and also all that part of the said forest which has been reserved for the Invercargill Waterworks.

13. All that area containing 2,250 acres or thereby, and comprising all that portion of the Dunsdale Forest situate in the Lindhurst Survey District; excepting from the above all sections that have either been sold or surveyed with a view to sale.

14. All that area containing 16,900 acres or thereby, and comprising all the bush land situate in the Forest Hill Hundred; excepting from the above all sections that have either been sold or surveyed with a view to sale, and also all that part of the said forest which has been reserved for the Invercargill Waterworks.

15. All that area containing 1,000 acres or thereby, and comprising the whole of Hillel's Forest, situate in the Tairāwhiti Survey District; except such portions along the margin of same as have been surveyed and sold.

16. All that area containing 2,500 acres or thereby, and comprising the whole of the Letham Bush, situate in Wairaki Survey District; excepting from the said bush such portions along the margin of same as have been surveyed and sold.

17. All that area containing 1,200 acres or thereby, and comprising all the bush land in Blocks II. and V., Mabel Hundred; excepting from the above all sections that have either been sold or surveyed with a view to sale.

18. All that area containing 3,200 acres or thereby, and comprising all that portion of the Woodlaw Forest situate in the Wairai Survey District; excepting from the above all sections which have either been sold or surveyed with a view to sale.

19. All those areas containing 16,573 acres or thereby, and comprising all those portions of Longwood, Raymond's, Woodlaw, Woodlands, and Lonsdale's Forests which are situate in the Wairai Survey District; excepting from the above all mining claims and all sections which have been either sold or surveyed with a view to sale.

20. All those areas containing 37,448 acres or thereby, and being all the bush land situate in Takitimu Survey District, and comprising Holmeist, Taylor's, Blackmount, Frochester, and Takitimu Forests; excepting from the above all mining claims and all sections which have been either sold or surveyed with a view to sale.

21. All those areas containing 5,360 acres or thereby, and comprising all those portions of the Takitimu and other forests which are situate in the Centra Hill Survey District.

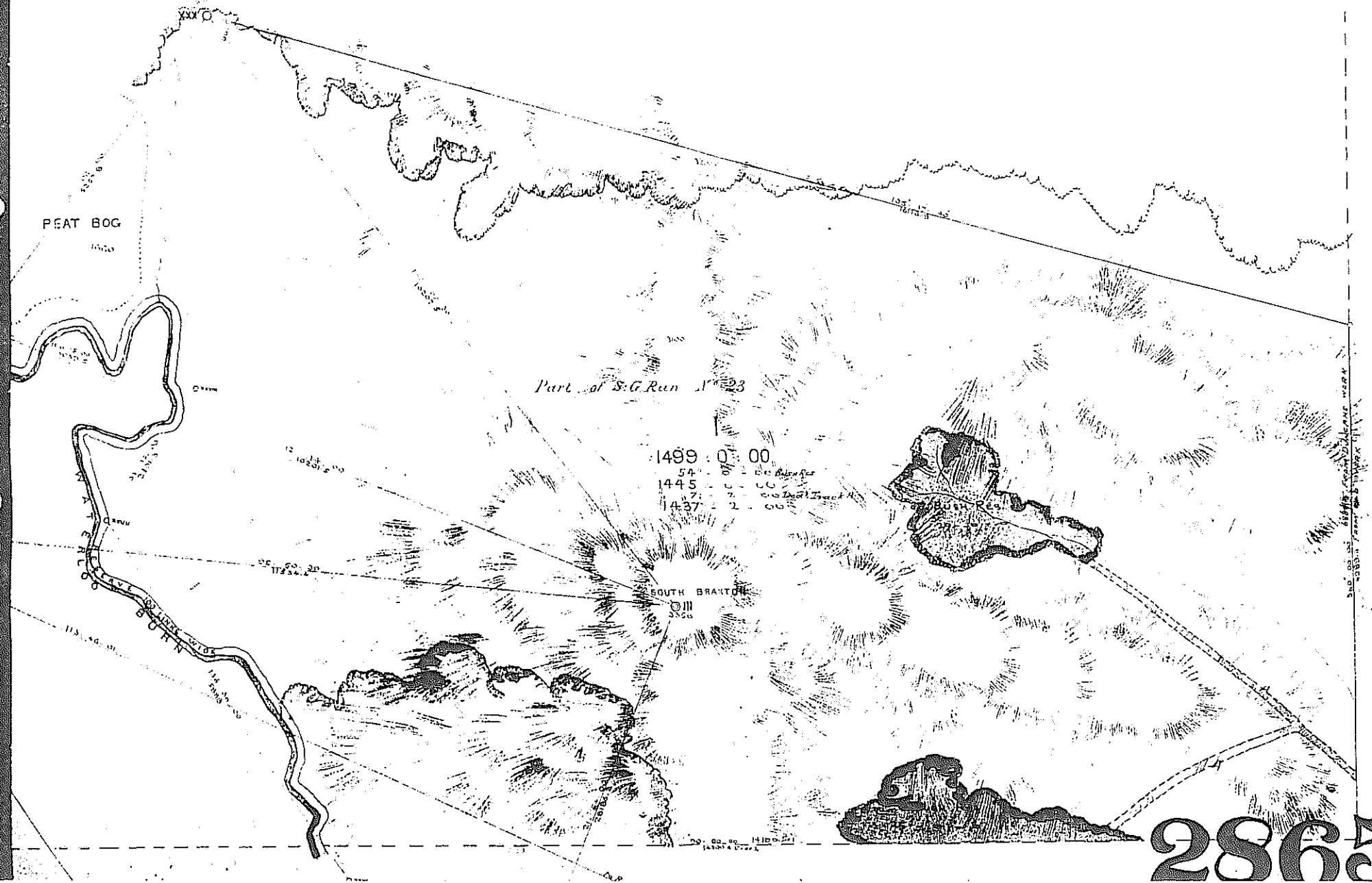

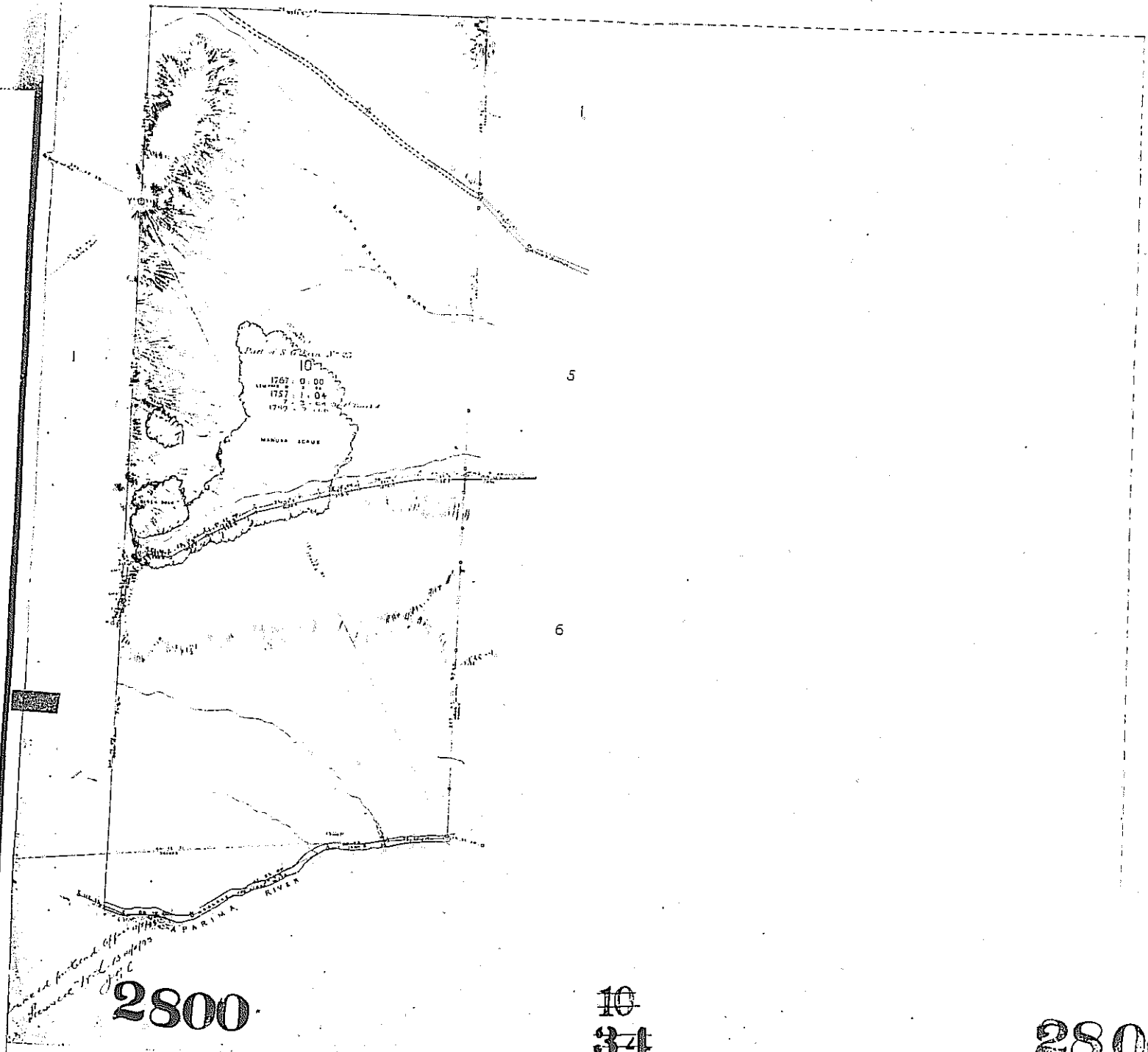
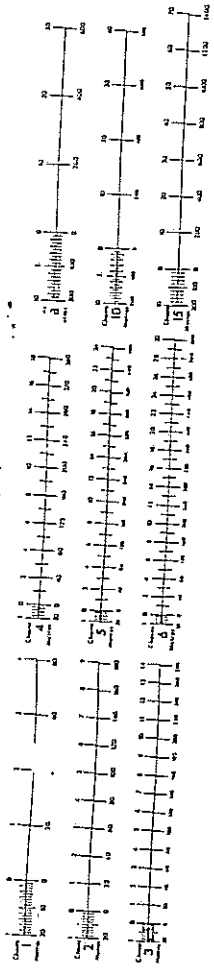

Handwritten notes: "Handwritten notes: 2800, 10, 34, 2800" and "Handwritten notes: 2800, 10, 34, 2800"

2800

10
34

2800
let IX pages 118 & 122

CENTRE HILL DISTRICT

BLOCK XV

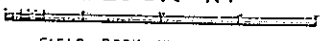

FIELD BOOK NO 206

*Approved
for the Survey 1975*

2801

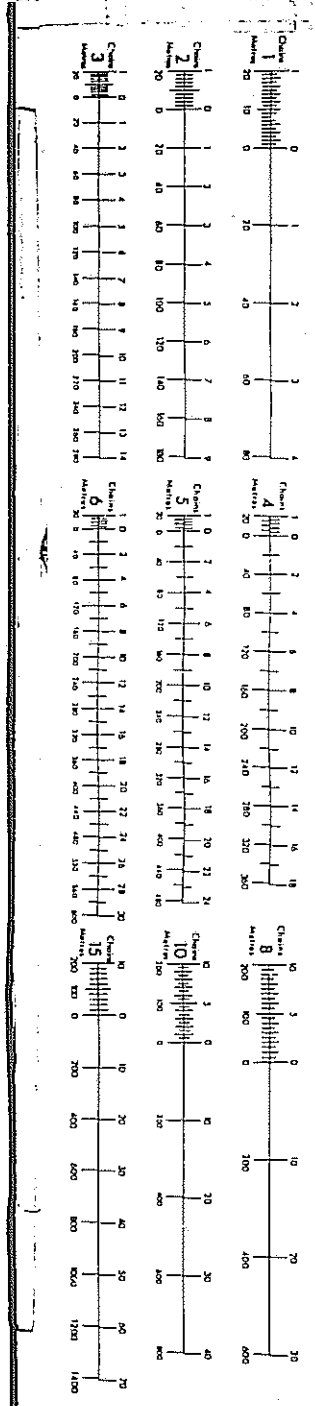
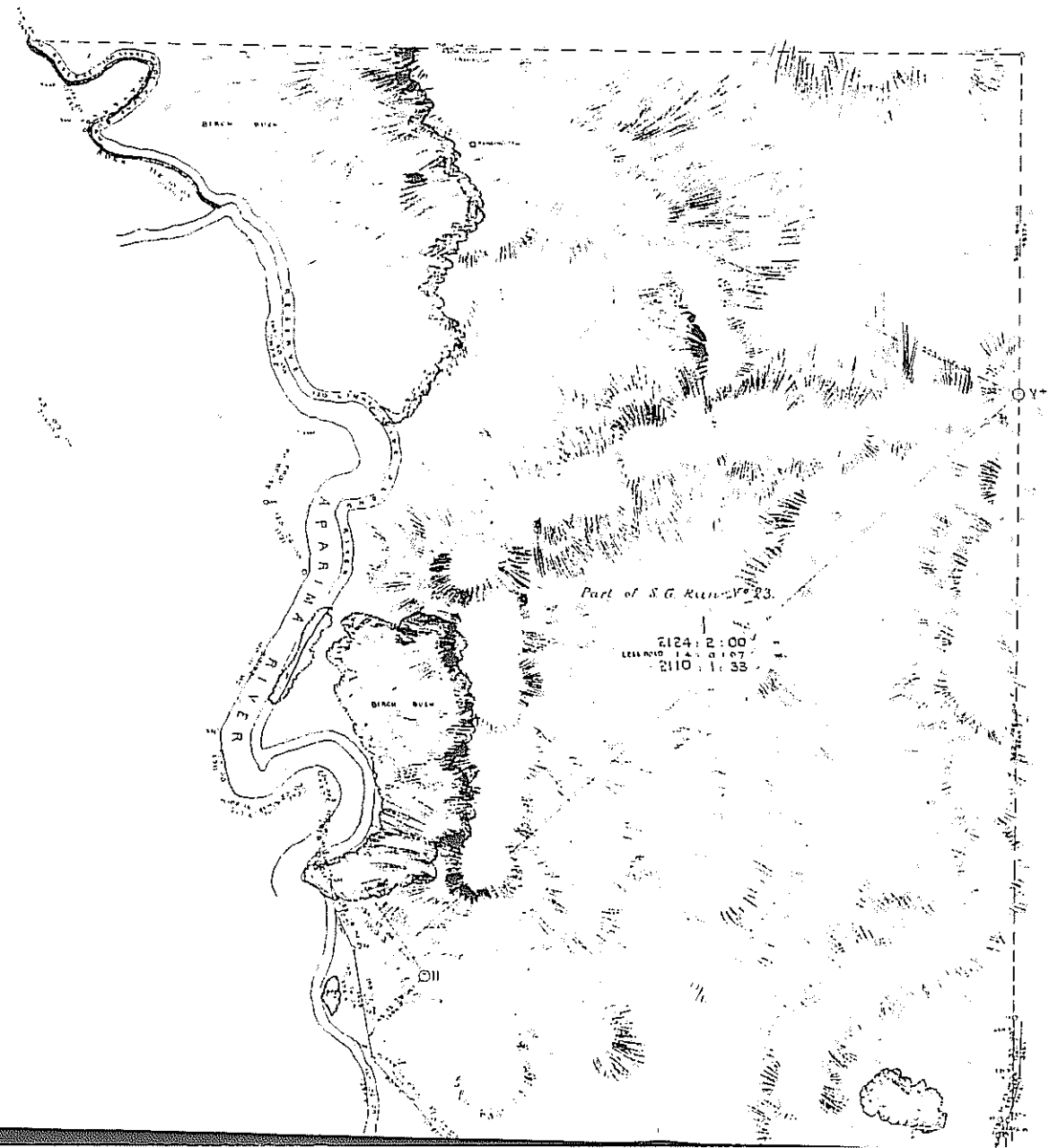

DATE OF PHOTOGRAPHY
15/5/74

“RELEASED UNDER THE OFFICIAL INFORMATION ACT”

CENTRE HILL DISTRICT

BLOCK XIII

FIELD BOOK No 206

July 1894

Handwritten notes:
17/11/94
Surrey
17/11/94

DATE OF PHOTOGRAPHY

3/10/73

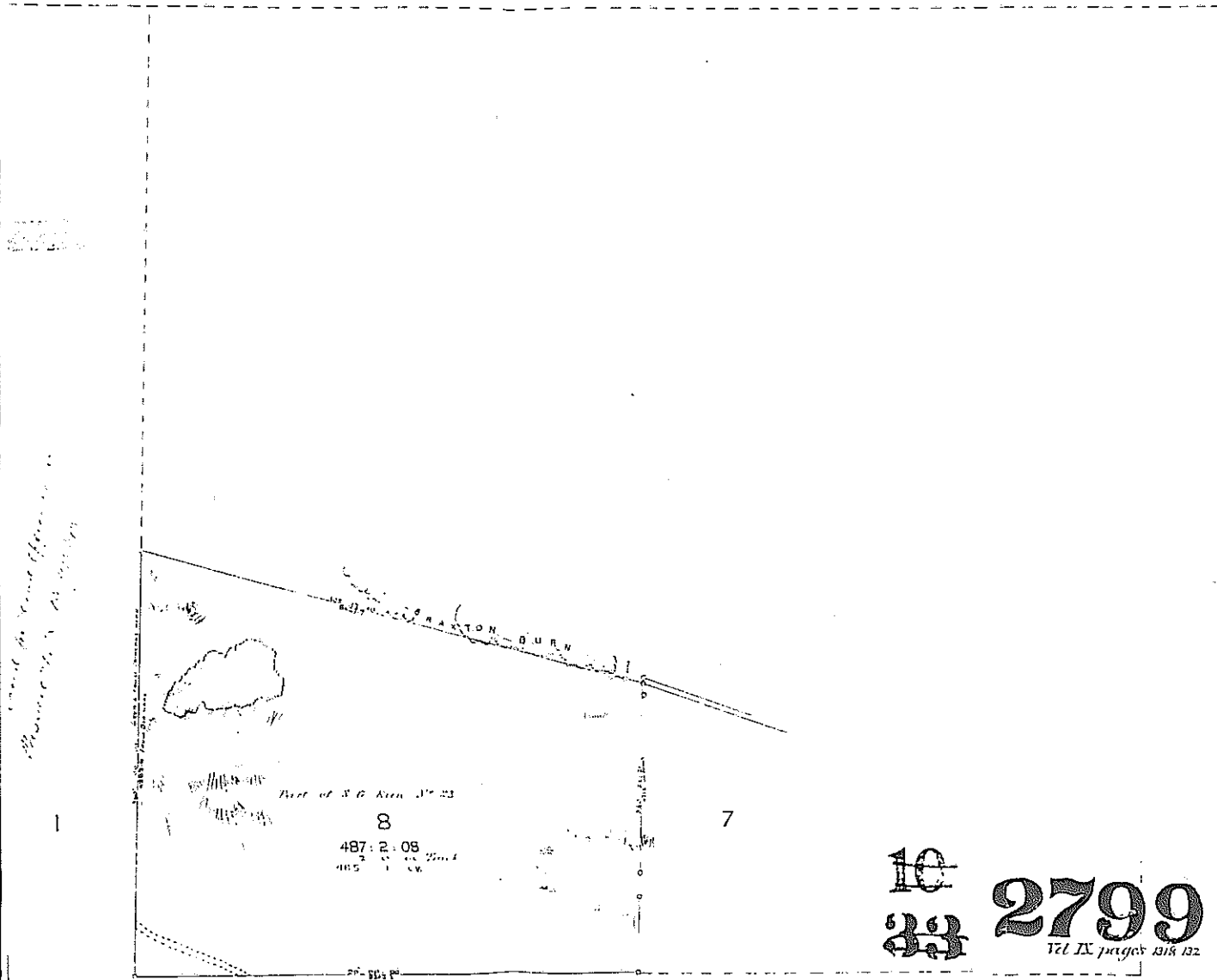
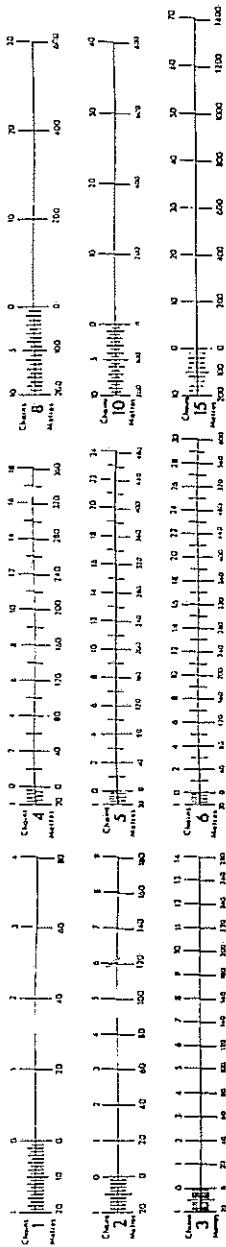

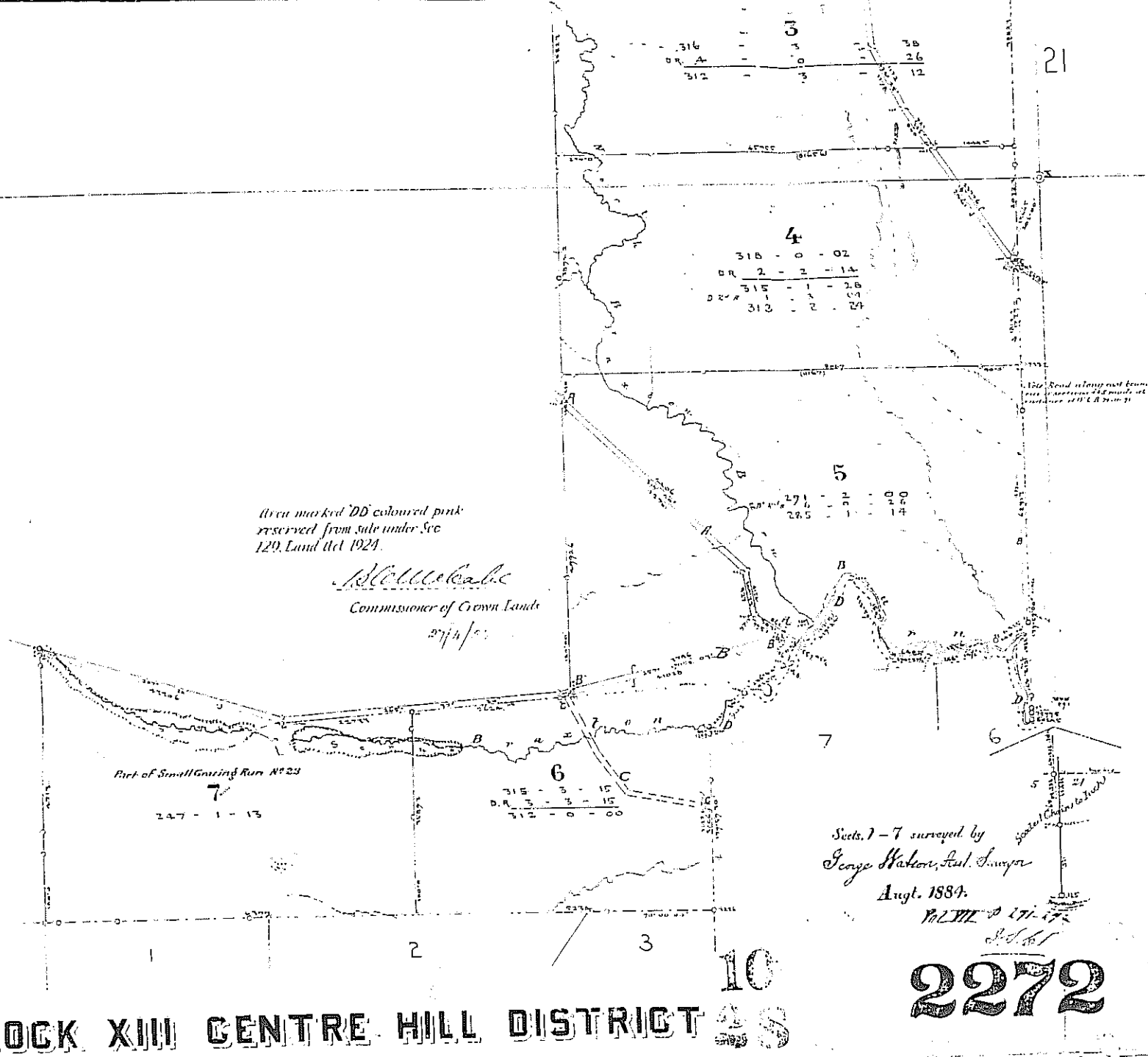

Area marked 'DD' coloured pink reserved from sale under Sec 129, Land Act 1924.

W. McClellan
 Commissioner of Crown Lands
 27/4/01

Sects. 7-7 surveyed by
 George Watson, Sur. Geny
 Aug. 1884.

2272

LOCK XIII CENTRE HILL DISTRICT

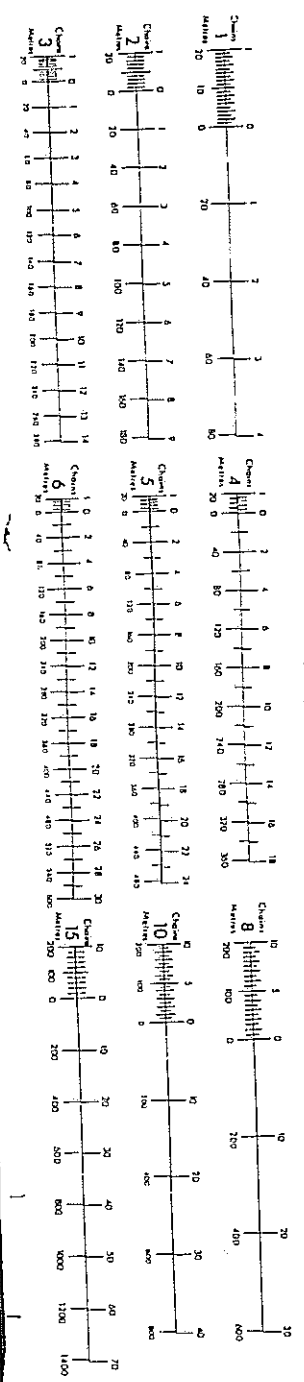

DATE OF PHOTOGRAPHY
 13/5/24

2270

B L O C K XIII

2270

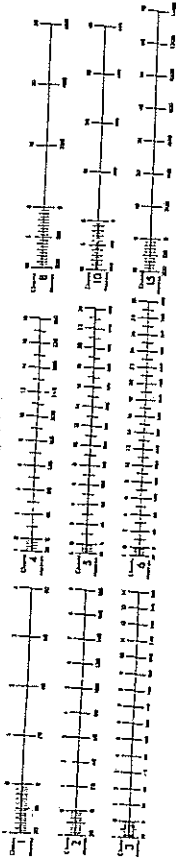

SOUTH-LAND
 DATE OF PHOTOGRAPHY
 12/2/23

2270

BLOCK XIV CENTRE HILL DISTRICT

2270

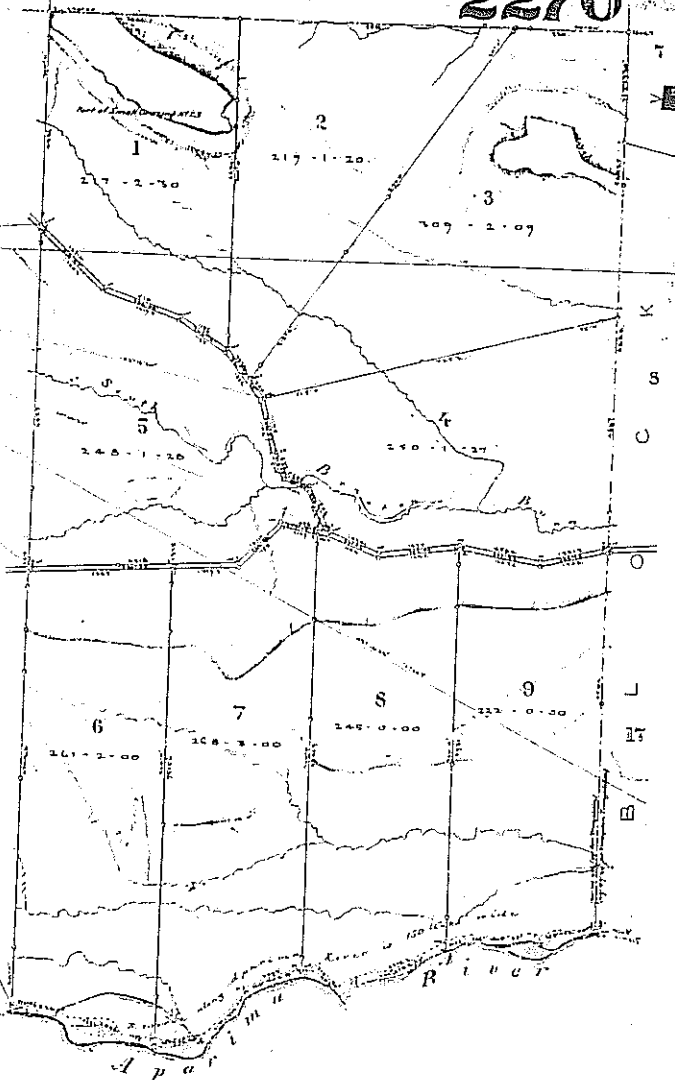

Area marked AS coloured pink
 reserved from sale under Act 123
 Land Act 1924

A. B. C. C. C. C. C. C. C.
 Commissioner of Crown Lands
 27/4/23

Sections 1-9 surveyed by
 George Skelton, Public Surveyor
 July, 1882
 T. E. M. 1882

10
27

RELEASED UNDER THE OFFICIAL INFORMATION ACT

11.12 06.DEC90

182150-1

[PARTICULARS ENTERED IN REGISTER]
LAND REGISTRY SOUTHLAND
ASST. LAND REGISTRAR



APPLICATION FOR REGISTRATION OF A LAND IMPROVEMENT
AGREEMENT UNDER THE SOIL CONSERVATION AND RIVERS
CONTROL AMENDMENT ACT 1959

TO: The District Land Registrar,
Invercargill.

PURSUANT to the provisions of the Soil Conservation and Rivers Control Amendment Act 1959, I, BRIAN STEWART HALL of Invercargill, Secretary, an authorised officer in relation to a Land Improvement Agreement made with the Southland Regional Council DEPOSIT HEREWITH a duplicate of a Land Improvement Agreement duly certified by me AND I CERTIFY that the Agreement is one that may be registered against the land hereinafter described AND I HEREBY APPLY for the registration of the Agreement against the land.

LAND AFFECTED BY REGISTRATION

Name: JOHN GORDON MINTY (Junior)
Situation: Waterloo, Upper Aparima Valley
Area: 3,499.7214 hectares
Description of land: Run 198C Centre Hill and Takitimu Survey Districts and being the land contained in Certificate of Title 193/3 Southland Registry

DATED at Invercargill this 19 day of November 1990

Southland Regional Council

Secretary

SOUTHLAND
REGIONAL
COUNCIL

WINDBREAK
TREE PLANTING

PLAN NO. TP. 753

J. G. MINTY
Waterloo Station

February 1990.



to promote wise
long term management
of the land

LAND IMPROVEMENT AGREEMENT

This AGREEMENT is made between the Southland Regional Council being the catchment authority for the area constituted under the Soil Conservation and Rivers Control Act 1941 of the one part
AND John Gordon Minty (Junior)

being the owner or occupier of the other part.

WHEREAS the owner or occupier is the registered proprietor or occupier of the land described in the first schedule.

AND WHEREAS pursuant to sub section (2A) and (3) of section 30 of the Soil Conservation and Rivers Control Act 1941 the catchment authority is authorised to make payment as grantor to the owner or occupier for the purposes specified in this agreement.

NOW THIS AGREEMENT WITNESSETH that it is hereby agreed and declared by and between the parties hereto as follows:-

1. IN consideration of the payment of a grant at the rates set out in the second schedule hereto paid or credited to him by the catchment authority the owner or occupier within or throughout (as the case may be) the periods specified in the second schedule will carry out to the satisfaction of the catchment authority the works and requirements set out in the second schedule.
2. UPON completion of the works or upon compliance with the requirements to the satisfaction of the catchment authority within the period specified in Part I of the second schedule the catchment authority shall pay or credit to the owner or occupier a grant at the rates set forth in Parts I and IV of the second schedule.
3. THE OWNER or occupier throughout the currency of this agreement shall permit the catchment authority by its officers, servants and agents at all reasonable times to enter upon the land for the purpose of inspecting the same and to ascertain whether the owner or occupier has complied with his obligations hereunder.
4. IF the owner or occupier fails to carry out to the satisfaction of the catchment authority the works and requirements set out in the second schedule or shall otherwise default in complying with his obligations under this agreement the catchment authority by notice in writing delivered to or posted by registered post to the owner or occupier specifying the default may either at the sole option of the catchment authority require him to repay to the catchment authority all grants paid or credited to him hereunder, in accordance with the provisions set out in subsection 2(a) and 3 of section 30 of the Soil Conservation and Rivers Control Act 1941 or within one calendar month after receipt of such notice to remedy such defaults in such manners as the catchment authority may herein require; and if following receipt of such notice the owner or occupier fails within one calendar month thereafter to comply with the requirements thereof it shall be lawful for the catchment authority by its servants, agents or contractors to enter upon the land described in the first schedule hereto and carry out all works necessary to secure compliance with the requirements of such notice and recover from the owner or occupier the cost of so doing by action at law or otherwise.

[Handwritten signatures and initials]

5. ALL the provisions of section 30A of the Soil Conservation and Rivers Control Act 1941 shall apply to this agreement and in particular the owner or occupier acknowledges that he is aware that the agreement shall run at law with the land against the title to which it is registered so as to confer and impose on present and future owners or occupiers of the land an obligation to observe and perform the agreement during their occupancy of the land.

6. MAINTENANCE of all works and requirements set out in Parts II and V of the second schedule shall be the sole responsibility of the owner to do and provide the cost thereof with the exception of any specified items in Part IV of the second schedule which may attract a maintenance grant.

7. This agreement shall enure until 2020 or until such sooner time as may be agreed between the parties.

IN WITNESS WHEREOF this agreement has been executed this

2nd day of April 1990

SIGNED:.....

J. S. Mandy
Owner / Occupier

IN THE PRESENCE OF:

Witness: Gary Manger

Address: Retreat Road

Occupation: Soil Conservator

Pursuant to a resolution of the catchment authority the common seal of the catchment authority is affixed hereto in the presence of:

Chairman: [Signature]

Secretary: [Signature]

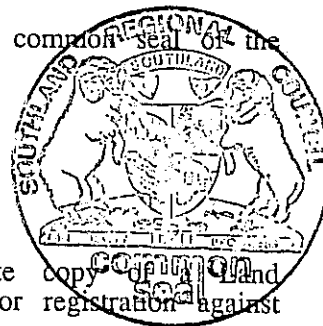

I hereby certify that this agreement is the duplicate copy of the Land Improvement Agreement referred to in an application for registration against the land described in the 1st schedule hereto.

[Signature] Secretary

[Handwritten initials/signature]

THE FIRST SCHEDULE

DESCRIPTION OF LAND:
RUN 198C Centre Hill and Takitimu Survey Districts

THE SECOND SCHEDULE

Part I - Rates of Grant:

It is agreed that the works as set out in Part V of this agreement and described in the plans and specifications dated February 1990 which have been initialled by the owner for the purposes of identification and which are deemed to be included in this schedule, will be carried through to completion before 31 March 1990 and that the requirements under this agreement will be complied with, subject to such amendments as may be mutually agreed upon in writing by the owner or occupier and the catchment authority and subject also to the availability of grant finance in any one year.

The rates of grant applicable to such works and requirements are:

| <u>Job No.</u> | <u>% Grant</u> | <u>% Owner</u> |
|----------------|----------------|----------------|
| 1 | 60 | 40 |

Part II - Conditions:

| <u>Works and Requirements</u> | <u>Period during which Works and Requirements Apply</u> | <u>Conditions</u> |
|-------------------------------|---|--|
| Fencing | For 30 years | To be maintained in a stock proof condition except that renewal should be done as set out as in part III of this agreement. |
| Trees | For 30 years | To apply such silvicultural practices as the Regional Council deems necessary for the maintenance of an effective windbreak. Mature trees may be utilised with the approval of the Council, but shall be replaced as required by the Council with such costs to be the first charge against the revenue received by the owner from such sales of wood. |
| Stocking | For 30 years | No stock to be grazed within the wind break. |
| Cultivation practices | For 30 years | Cultivation practices which aim to minimise the risk of soil erosion by wind to be carried out as specified in plans attached. |

[Handwritten signatures and initials]

Part III - Maintenance

Maintenance is defined as the activities to maintain soil conservation works, existing or established under this agreement, being the care of trees, plantations, protection forest areas, vegetation established or protected directly for the mitigation of specific erosion and any additional work carrying capital subsidy as detailed above, including water supply reticulation, firebreaking and bridges.

In addition it includes subsequent replanting or willow layering, the spraying or clearing of undesirable vegetation in channels, gullies, waterways and contour works, planted strong points being kept in good order, together with repairs as necessary to flumes, conduits, structures, culverts, floodgates, fences and access tracks.

When fences are due for renewal and providing proper maintenance has been done as and when required such fence renewal will be subsidised at the rates then applicable.

Part IV

Items attracting a maintenance grant

The following items attract a maintenance grant at the rates shown:

| <u>Job No.</u> | <u>% Grant</u> | <u>% Owner</u> |
|----------------|----------------|----------------|
|----------------|----------------|----------------|

NOT APPLICABLE

Part V

Summary of Works and Requirements

| <u>Job No.</u> | <u>Work</u> | <u>Requirements</u> |
|----------------|------------------------------|-----------------------------------|
| 1 | 4.5km windbreak treeplanting | to be maintained for thirty years |

[Handwritten signatures and initials]

SOUTHLAND REGIONAL COUNCIL

Telephone (021) 56197
 Facsimile (021) 58081

Corner Price St & North Rd
 Private Bag, Invercargill

9 February 1990

Mr J G Minty,
 Waterloo Station,
 No 2 R.D.,
LUMSDEN

Dear Sir,

WIND EROSION CONTROL PROGRAMME - TP 753

Location of Property : Waterloo, Upper Aparima Valley
Topography and Soils : Terraceland with Braxton and Glenelg soils.
Problem : Wind erosion due to high intensity north westerly winds.
Control : Windbreak treeplanting and conservation cultivation techniques.
Orientation : Across the eroding wind approximately east-west.
Specifications :

Fence : 5 x 127 mm posts per 20 metres]
 or equivalent
 8 x 12.5 gauge Hi-tensile wires]

Trees : Refer windbreak specifications attached.

Costs : Estimated maximum costs eligible for grant assistance:

| | per 20 m | per km |
|---|----------|------------|
| <u>Fence:</u> Materials | 50.00 | 2,250.00 |
| Ripping and Cartage | 5.00 | 250.00 |
| Erection and laying out | 30.00 | 1,500.00 |
| <u>Trees:</u> Tree stocks @ \$80/100 | 12.00 | 600.00 |
| Spot Spraying @ \$30/100 (includes release spray) | 4.00 | 200.00 |
| Planting @ \$30/100 | 4.00 | 200.00 |
| Blanking | 1.00 | 50.00 |
| Total : | \$106.00 | \$5,300.00 |
| Plus 5% Contingencies | 5.00 | 250.00 |
| | \$111.00 | \$5,550.00 |

J G Minty

Grant Assistance : 60% Gross 48% Nett

Programme :

| Year | Length (km) | Estimated Cost \$ | % Service Charge (\$) | Total Cost (\$) | Est Grant @ 60% (\$) | Est Net Grant | Est Farmer's Share | |
|-------|-------------|-------------------|-----------------------|-----------------|----------------------|---------------|--------------------|--------|
| 1990 | 4.5 | 24,975 | 7,492 | 32,467 | 19,480 | 11,988 | 12,987 | |
| TOTAL | | 4.5 | 24,975 | 7,492 | 32,467 | 19,480 | 11,988 | 12,987 |

This treeplanting programme was approved by the Council at its meeting on 14 March 1990.

Yours faithfully,



W J Tuckey
DIRECTOR OF PLANNING.

GRA:AK

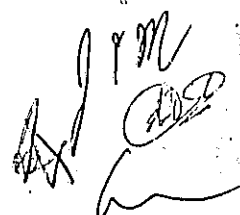

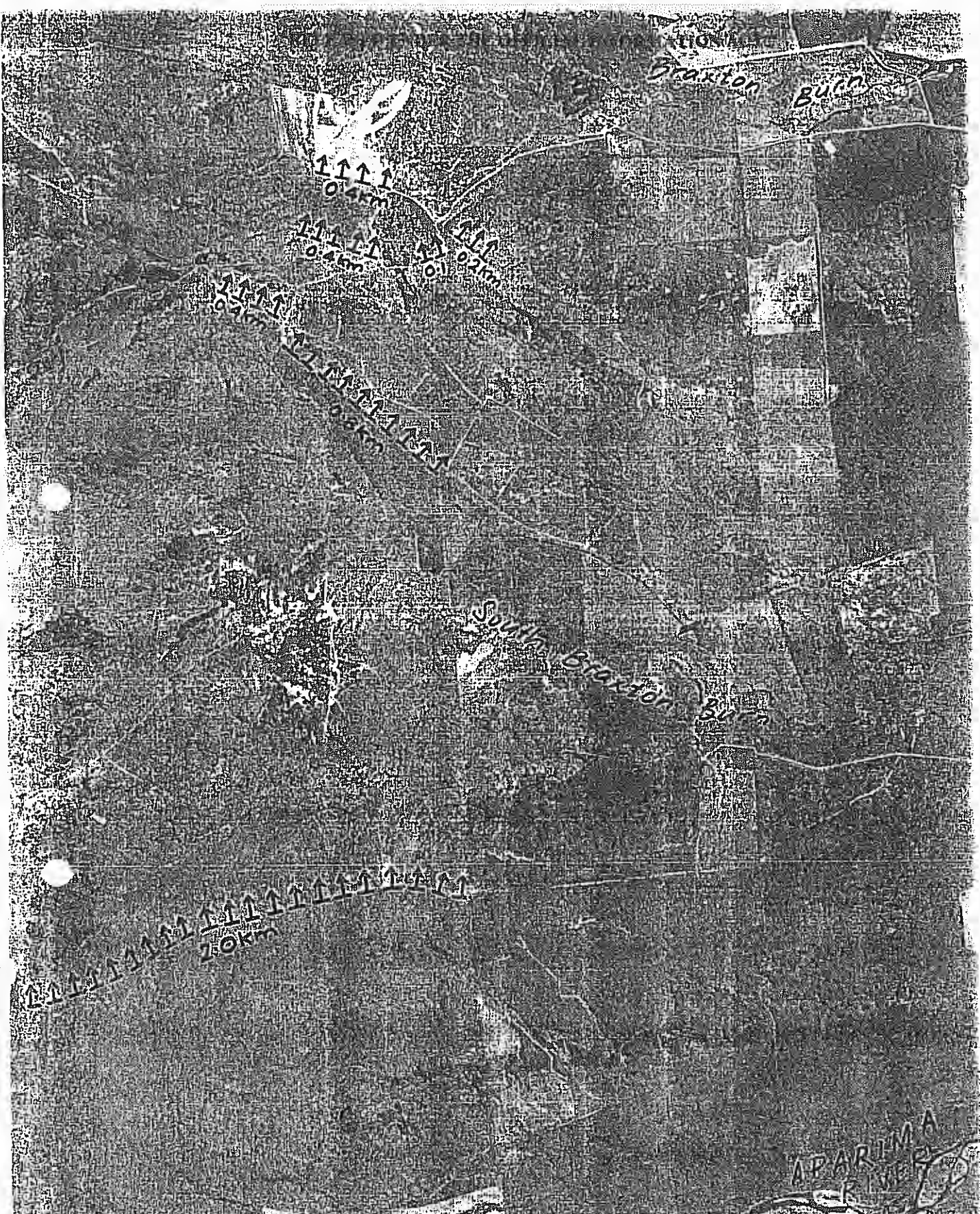

| | | | |
|----------|----|--------|-------|
| PHOTO NO | SN | 8038 | 812 |
| SURVEYED | | 6WM | 11/89 |
| DRAWN | | 6WM | 11/89 |
| TRACED | | S.A.M. | 11/89 |
| CHECKED | | 6WM. | 11/89 |
| APPROVED | | | |

SOUTHLAND REGIONAL COUNCIL
 WINDBREAK TREEPLANTING - NOV. 1989
WATERLOO STATION

MAP REF: 6159: 080 870 SCALE: 1: 20,000

| |
|-------------|
| PLANNING IV |
| WBTP: 753 |
| REVISION |
| JOB NO. |
| SHEET No. |
| OF SHEETS |

WINDBREAK SPECIFICATION : JOB TP 753.

Windbreak type:

1) FRONT VIEW

2) SIDE VIEW

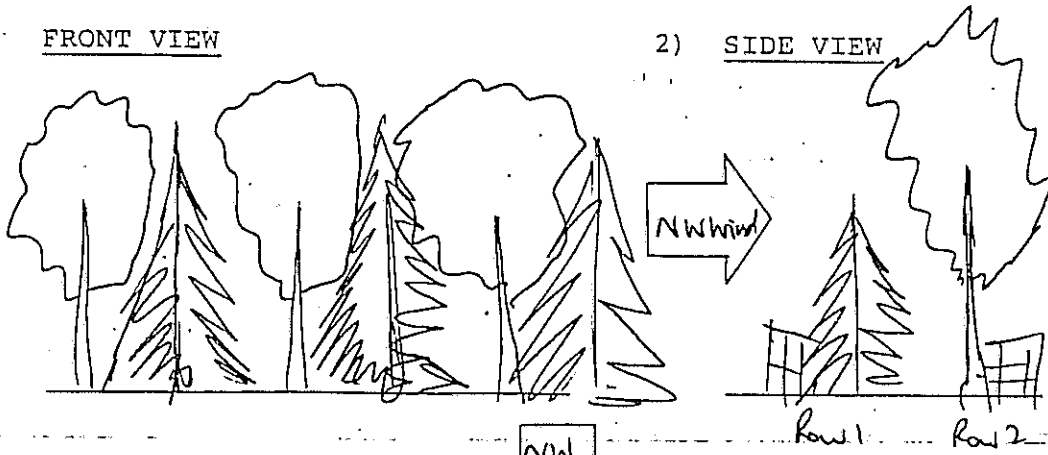

3) SPACINGS

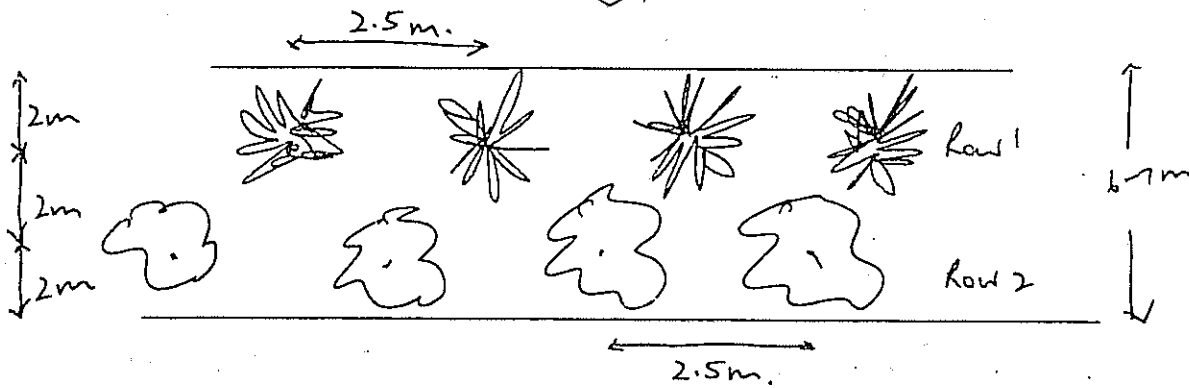

4) RECOMMENDED SPECIES

Row (1)

Row (2)

Western Red Cedar
(*Thuja plicata*)

Eucalyptus nitens

WINDBREAK MANAGEMENT : JOB

Row 1 - No maintenance required

Row 2 - Occasional side trimming of persistent heavy branches may be necessary.

Keep all young trees weed free during establishment years

SOUTHLAND CATCHMENT BOARD DISTRICT WIND EROSION CONTROL SCHEME

WINDBREAK MANAGEMENT

| | | | | | | | | | | | | | | | | | | |
|--------------------------------------|-------|-------|-----|-----------|------|--------|-------|------|------|------|---------------------|------|-------|-------|-----|------|------|------|
| NAME: <i>J. G. Minty, Waterloo</i> | | | | | | | | | | | T.P. NO. <i>753</i> | | | | | | | |
| DISTRICT NO: <i>3</i> | | | | REVISION: | | | | | | | DATE: <i>3/90</i> | | | | | | | |
| | MARCH | APRIL | MAY | JUNE | JULY | AUGUST | SEPT. | OCT. | NOV. | DEC. | JAN. | FEB. | MARCH | APRIL | MAY | JUNE | JULY | AUG. |
| ORDER TREE STOCKS (+ REPLACEMENT) | ✓ | | | | | | | | | | | | | | | | | |
| GROUND PREPARATION | ✓ | | | | | | | | | | | | | | | | | |
| SPOT SPRAYING | ✓ | | | | | | | | | | | | | | | | | |
| FENCING | ✓ | | | | | | | | | | | | | | | | | |
| PLANTING | | | | | | | ✓ | ✓ | | | | | | | | | | |
| BLANKING | | | | | | | | | | | | | | | | | | |
| S.C.B. INSPECTION | ✓ | | | | | | | | ✓ | | | | | | | | | |
| SEND IN CLAIM | ✓ | | | | | | | | | | | | | | | | | |
| RELEASE SPRAYING | | | | | | | | | | | ✓ | | | | | | | |
| SIDE TRIMMING | | | | | | | | | | | | | | | | | | |
| SIDE PRUNING | | | | | | | | | | | | | | | | | | |
| PRUNING | | | | | | | | | | | | | | | | | | |

FURTHER RECOMMENDATIONS:

SIGNED FOR AND ON BEHALF OF HER MAJESTY
THE QUEEN PURSUANT TO A DEED LODGED WITH
THE DISTRICT LAND REGISTRAR AS NO 7-50040
BY LAND CORPORATION LIMITED BY ITS 171747.1
ATTORNEY SUSAN JANE BUNTING
IN THE PRESENCE OF:

LAND CORPORATION LIMITED
BY ITS ATTORNEY
REGISTER



WITNESS: 
OCCUPATION: Property Officer, Landcorp
ADDRESS: Dunedin

SIGNED BY THE LESSEE
JOHN GORDON MINTY
IN THE PRESENCE OF:

_____ LESSEE

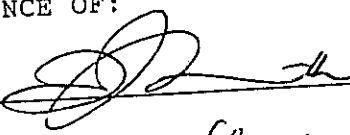
WITNESS: 
OCCUPATION: Solicitor
ADDRESS: Invercargill

CERTIFICATE OF NON-REVOCATION OF POWER OF ATTORNEY

Susan Jane Bunting of Dunedin, Property Officer

HEREBY CERTIFY -

1. THAT by Deed dated the 12th day of June 1987 copies of which are deposited in the Land Registry Offices at -

- AUCKLAND (North Auckland Registry) and there numbered B678573
- BLLENHEIM (Marlborough Registry) and there numbered 136439
- CHRISTCHURCH (Canterbury Registry) and there numbered 686366/2
- DUNEDIN (Otago Registry) and there numbered 681189/1
- GISBORNE (Poverty Bay Registry) and there numbered 167089.2
- HAMILTON (South Auckland Registry) and there numbered H734777
- HOKITIKA (Westland Registry) and there numbered 076748
- INVERCARGILL (Southland Registry) and there numbered 141782
- NAPIER (Hawkes Bay Registry) and there numbered 478751.2
- NELSON (Nelson Registry) and there numbered 269962.1
- NEW PLYMOUTH (Taranaki Registry) and there numbered 341775
- WELLINGTON (Wellington Registry) and there numbered 860782.2

LAND CORPORATION LIMITED at Wellington carrying on the business of land management appointed me its Attorney on the terms and subject to the conditions set out in the said Deed.

2. THAT at the date hereof I was Property Officer of the said Corporation.

3. THAT at the date hereof I have not received any notice or information of the revocation of that appointment by the winding up or dissolution of the said LAND CORPORATION LIMITED or otherwise.

SIGNED at Dunedin
this 20th day of April
1990

)
)
)

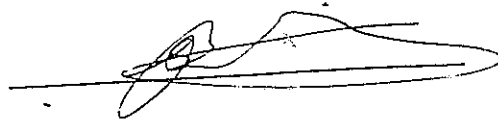

REGISTER

MEMORANDUM OF RENEWAL OF PASTORAL LEASE

PARTICULARS ENTERED IN THE REGISTER AS SHOWN HEREIN ON THE DATE AND AT THE TIME STAMPED BELOW.

HER MAJESTY THE QUEEN

LESSOR

J G MINTY

LESSEE

DISTRICT/ASSISTANT LAND REGISTRAR OF OTAGO

LAND CORPORATION LIMITED
DUNEDIN

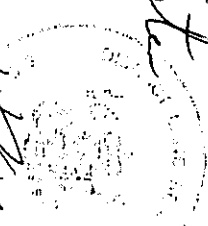
9:02 22 May 1993 174868.1
Particulars entered in Register
1933
ASST. LAND REGISTRAR

MEMORANDUM OF RENEWAL AND VARIATION REGISTER
OF PASTORAL LEASE

IN THE MATTER OF THE LAND ACT 1948

AND

IN THE MATTER OF PASTORAL LEASE NO Ps 16
REGISTERED AS REGISTER VOLUME
193 FOLIO 3 SOUTHLAND DISTRICT
LAND REGISTRY FROM HER MAJESTY
THE QUEEN TO JOHN GORDON MINTY
(JUNIOR) OF MOSSBURN FARMER

SOUTHLAND
PURSUANT TO SECTION 170 OF THE LAND ACT 1948 THE TERM OF THE ABOVEMENTIONED
LEASE REGISTERED IN VOLUME 193 FOLIO 3 ~~OF THE~~ LAND REGISTRY IS RENEWED FOR A
TERM OF 33 YEARS COMMENCING ON THE 1ST DAY OF JULY 1988. THE COVENANT TO
PAY RENT AND THE RENTAL VALUE CONTAINED IN THE LEASE IS HEREBY VARIED BY
DELETING THE SAID COVENANT AND SUBSTITUTING THE FOLLOWING:

YIELDING AND PAYING THEREFOR FOR THE FIRST 11 YEARS OF THE SAID TERM
UNTO THE LAND CORPORATION LIMITED AT DUNEDIN THE ANNUAL RENT OF
\$1,755.00 CALCULATED ON A RENTAL VALUE OF \$117,000.00 PAYABLE WITHOUT
DEMAND BY EQUAL HALF YEARLY PAYMENTS IN ADVANCE ON THE FIRST DAY OF
JANUARY AND THE FIRST DAY OF JULY IN EACH AND EVERY YEAR DURING THE
SAID PERIOD OF 11 YEARS AND FOR THE NEXT TWO SUCCESSIVE PERIODS OF 11
YEARS OF THE SAID TERM A RENT DETERMINED IN RESPECT OF EACH OF THOSE
PERIODS IN THE MANNER PROVIDED IN SECTION 132A OF THE LAND ACT 1948.

SAVE AS HEREBY EXPRESSLY VARIED ALL THE COVENANTS CONDITIONS AND
RESTRICTIONS CONTAINED OR IMPLIED IN THE SAID MEMORANDUM OF LEASE SHALL
REMAIN IN FULL FORCE.

IN WITNESS WHEREOF THE PARTIES HAVE HEREUNTO SUBSCRIBED THEIR NAMES THIS
20th DAY OF April 1988 .

"RELEASED UNDER THE OFFICIAL INFORMATION ACT"

District and Remarks.

| Sec. &c. Run No. | Plans. | | | | | | | Block, Survey District and Remarks. |
|---------------------|---------------------------|----------|-------|-------|---------|----------|----------------|--|
| 194 | | | | | | | | Wendon, Wendonside |
| 195 | Now 195 | a, b | | | | | | Hokonui |
| 195 ^a | | | | | | | | Hokonui |
| 195 ^b | | | | | | | | Hokonui |
| 196 | | | | | | | | Te Anau |
| 197 | | | | | | | | Te Anau |
| 198 | Now 198 | a-c | 10077 | | | | | Centre Hill (Pt State Forest) |
| 198 ^a | 10077 | | | | | | | Centre Hill " " " |
| 198 ^b | Subdivided For Settlement | | | | | | | Centre Hill |
| 198 ^c | | | | | | | | Centre Hill <i>Blocks 13, 14, 15, 16, 17</i> |
| 207 | Now Sec 815 | | 8897 | | | | | Hokonui |
| 207 ^a | Pt Ardlussa Settlement | | | | | | | Hokonui |
| 207 ^b | Subdivided For Settlement | | | | | | | Hokonui |
| Pt 208 | 7593 L | | | | | | | Wairaki |
| Pt 208 | Now 563 | 7445 L | | | | | | Wairaki |
| 214 ^{a-e} | 6884 | 8103 | | | | | | Eyre |
| 214 ^a | Now | | | | | | | Nokomai |
| 214 ^b | 8329 | 10324 | | | | | | Nokomai, Kingston |
| 251 | 7800 | 8012 (R) | 8199L | 8205L | | | Mokoreta | Wyndham, Slopedown, Tukurau, |
| Pt 254 ^b | Now 579 | 7014 | | | | | | Wendon |
| Pt 254 ^b | Now 561 | | | | | | | Wendon |
| Pt 254 ^b | Now 599 | 7035L | 4492 | | | | | Wendon |
| 257 | | | | | | | | Mokoreta |
| 300 ^b | Now 568 | | | | | | | Burwood, Takitimu, Mararoa |
| 301 ^b | Now Lynwood F.S. | | 4685L | 7420L | 7431(R) | 7520L(R) | 7628(R) | Te Anau, Mararoa |
| | 7629(R) | 7630 | 8001 | 8045L | 8262 | 8407 | 8424 | |
| | 8457 | 8460 | 9255 | 9906 | 10308 | 10307 | 0308 | |
| | 10366 | 10369 | 10370 | 10800 | 10799 | 10943(R) | 10952-10957(R) | |