

394



(C) Approved by the D.L.R. of Nelson. No. 132

NEW ZEALAND

# MEMORANDUM OF TRANSFER

I, THEO MELVIN DUNCAN of Riwaka, Farmer, \_\_\_\_\_  
\_\_\_\_\_, being the registered proprietor  
of an estate in fee simple \_\_\_\_\_ subject,  
however, to such encumbrances, liens and interests as are notified by memoranda underwritten or  
endorsed hereon, in that piece of land situate in the Land District of Nelson \_\_\_\_\_

containing Four acres three rood six perches (4a. 3r. 06p.) \_\_\_\_\_  
be the same a little more or less being that part of section 61 Square 9 - -  
District of Motueka more particularly shown on the diagram - - -  
endorsed hereon edged green and being part of the land in Certifi-  
cate of Title Volume 62 Folio 298 (limited as to parcels) - - -

SUBJECT to K 2689  
IN CONSIDERATION of the sum of THIRTY FIVE POUNDS (£35) paid to  
me by MATTHEW SLATER of Riwaka, Labourer, the receipt whereof is  
hereby acknowledged, DO HEREBY TRANSFER to the said Matthew Slater  
all my estate and interest in the said piece of land. This - - -  
transfer is not preceded by an instrument of agreement of sale.

IN WITNESS whereof I have hereunto set my hand this 7<sup>th</sup>  
day of August 1952.



SIGNED by the said THEO MELVIN )  
DUNCAN in the presence of :

*Charles W. King  
Duncanson  
Molick*

*J M Duncan*

**T 48082 Transfer**  
Cpy - 01/01, Pgs - 003, 23/12/13, 13:26  
  
DocID: 213596448

88084

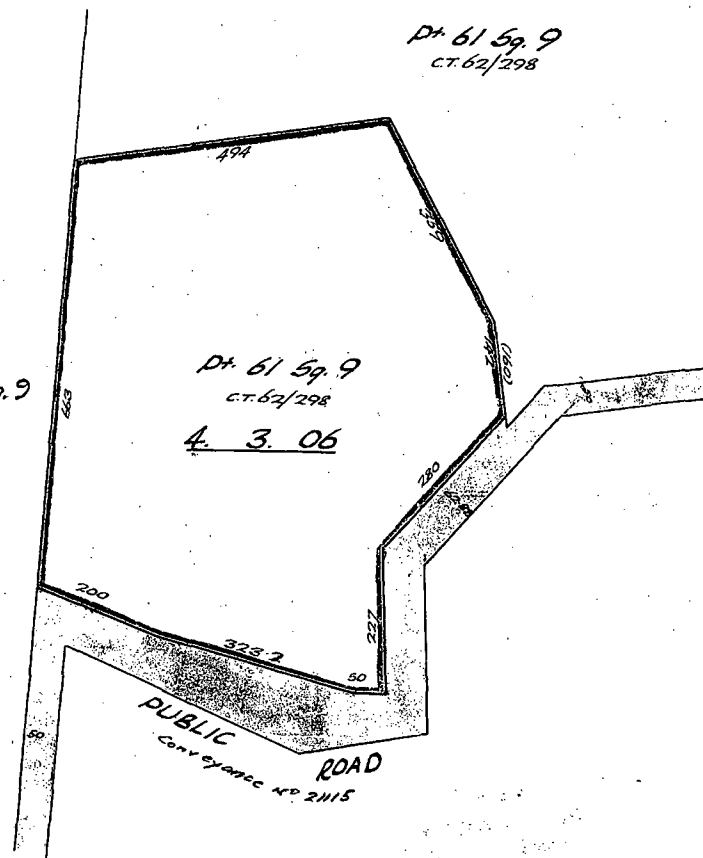
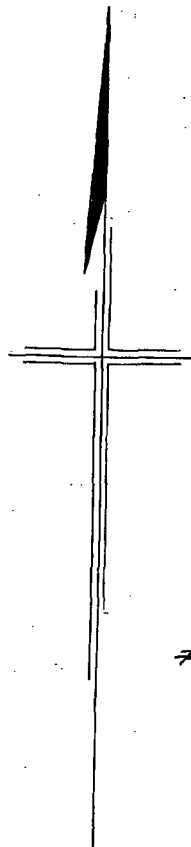

Pt. 61 Sq. 9  
C.T. 62/298

#63 Sq. 9

Pt. 61 Sq. 9  
C.T. 62/298  
4. 3. 06

PUBLIC ROAD  
CONVEYANCE NO 2115

This subdivision has been exempted from the provision of a Scheme Plan. See Exemption Tracing No. 173.

*J. W. McIntyre*  
Chief Surveyor  
17. 11. 52

Diagram examined.  
correct for issue of C.T. limited as to Permits only.

*J. Hoffman*  
L.S.S.  
17. 11. 52

Plan of Pt. Sec. 61 Square 9

Blk. 111 Motueka S.D.

Scale: 2 Chains to an inch

Exemption Tracing No. 173  
Plans 55 95 & 96 C.  
44

STAIG and SMITH  
per *Sgt. Smith*  
*Reg. Surveyor*  
25. 6. 1952

No. **48082** **TRANSFER** of Freehold

at Riwaka

Correct for the purposes of the Land Transfer Act.

*Charles W. Thorp & Vautier*

Solicitor for the Transferee  
Motueka.

*BS62*

THEO MELVIN DUNCAN, Vendor.

MATTHEW SLATER, Purchaser.

Particulars entered in the Register-book, Vol. *62*

the *24th* day of *September* 19*52*  
at *2.37* o'clock.



*Matthew Slater*  
District Land Registrar,  
of the District of Nelson.

*NO*  
*116/134*

RECALL FILE LABEL



F500002673399

*Plan of 28/1-2/2*  
*24-9-52*  
*3.37*  
*Parroll*

**CHARLES W. THORP & VAUTIER**

Solicitors

Motueka