

**RECORD OF TITLE
UNDER LAND TRANSFER ACT 2017
FREEHOLD
Limited as to Parcels
Historical Record**



R. W. Muir
Registrar-General
of Land

Constituted as a Record of Title pursuant to Sections 7 and 12 of the Land Transfer Act 2017 - 12 November 2018

| | | |
|-----------------------------------|-------------------|------------------|
| Identifier | WN337/177 | Cancelled |
| Land Registration District | Wellington | |
| Date Issued | 07 July 1926 | |

Prior References

DI 25/275

| | |
|--------------------------|--|
| Estate | Fee Simple |
| Area | 20.2343 hectares more or less |
| Legal Description | Part Section 35-36 Rangitikei District |

Original Registered Owners

Craig Peter Wigglesworth and Maureen Anne Wigglesworth

Interests

- 937919 Gazette Notice declaring portion of State Highway 3 to be a limited access road - 8.9.1972 at 2.03 pm
- B306042.3 Mortgage to Trust Bank Central Limited - 23.8.1993 at 2.17 pm
- B685976.4 Mortgage to Peter Neville Wigglesworth and to Hoani Victor Hansen and to Colin Field and to Peter Neville Wigglesworth in shares - 24.9.1998 at 9.15 am
- 6540798.1 Transfer to Craig Peter Wigglesworth and Maureen Anne Wigglesworth - 19.8.2005 at 9:00 am
- 6540798.5 Variation of Mortgage B306042.3 - 19.8.2005 at 9:00 am
- 7095691.1 Application pursuant to Section 99A Land Transfer Act 1952 vesting Mortgage B306042.3 in Westpac New Zealand Limited - 2.11.2006 at 9:00 am
- 8188694.1 Discharge of Mortgage B685976.4 - 12.6.2009 at 3:38 pm
- 11465817.1 Transmission to Craig Peter Wigglesworth as survivor(s) - 25.3.2020 at 10:38 am
- 11465817.2 Transfer to Craig Peter Wigglesworth and Murray Frederick Knox - 25.3.2020 at 10:38 am
- 11842059.1 Cancelled as to Part Section 35-36 Rangitikei District, Part Section 36 Rangitikei Agricultural District remains - 18.9.2020 at 2:25 pm
- 11842059.1 CTs issued - produced 18.9.2020 at 2:25 pm and entered 2.12.2020 at 7:01 am

| Legal Description | Title |
|-----------------------------|--------------|
| Lot 1 Deposited Plan 539808 | 903441 |
| Lot 2 Deposited Plan 539808 | 903442 |

CANCELLED

NEW ZEALAND.



Land Transfer (Compulsory Registration of Titles) Act, 1924.
 Reference: Deeds Index. Vol. 25 Folio 275
 Application No. C.2954



Register-book,
 Vol. 337, folio 177

CERTIFICATE OF TITLE UNDER LAND TRANSFER ACT.
 LIMITED AS TO PARCELS AND EXTENT.

This Certificate, dated the seventh day of July one thousand nine hundred and twenty-six under the hand and seal of the District Land Registrar of the Land Registration District of WELLINGTON Witnesseth that JOHN HART McDONALD of Makirikiri South near Larton Farmer

is seized of an estate in fee-simple (subject to such reservations, restrictions, encumbrances, liens, and interests as are notified by memorial under written or endorsed hereon, subject also to any existing rights of the Crown to take and lay off roads under the provisions of any Act of the General Assembly of New Zealand) in the land hereinafter described, as the same is delineated by the plan hereon bordered green, be the several admeasurements a little more or less, that is to say: All that parcel of land containing FIFTY ACRES more or less situate in Block VI of the Rangitoto Survey District and being part of Sections 35 and 36 on the plan of the Agricultural Reserve in the Rangitikei District



District Land Registrar.

Outstanding Mortgage No. 137623 (249/517) John Hart

DISCHARGED Elizabeth Ann Temperley PRODUCED *ms. hall* *all correct* D.L.R.

Outstanding Mortgage No. 137624 (249/520) John Hart

DISCHARGED Walter James Farmer PRODUCED *ms. hall* *all correct* D.L.R.

Outstanding Sub-Mortgage No. 139554 (256/594) of

Mortgage No. 137624 Walter James Farmer to William DISCHARGED PRODUCED *ms. hall* *all correct* D.L.R.

Outstanding Sub-Mortgage No. 142645 (263/433) of

Mortgage No. 137624 Walter James Farmer to William DISCHARGED PRODUCED *ms. hall* *all correct* D.L.R.

This Certificate is no longer limited as to title. Entered 26th July 1926

Transmission of outstanding Sub-Mortgage No. 142645 to John Hamilton DISCHARGED

Hamilton as Grantor. Entered 26th October 1926 at 2/3/26

Mortgage No. 174009 of Outstanding Mortgage 137624 produced 18th November 1926 and transferred from Walter James Farmer to John Hamilton DISCHARGED

PRODUCED *ms. hall* *all correct* CONTINGENT

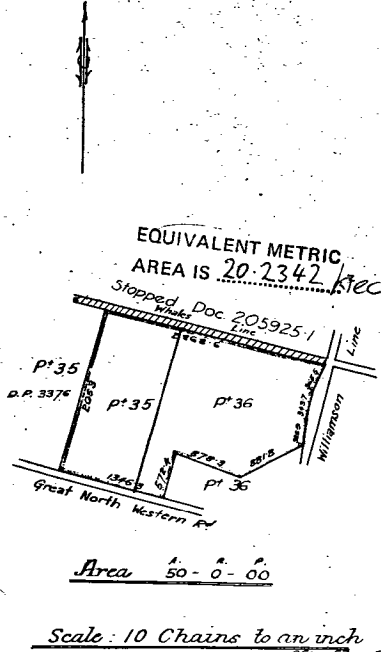

337/177

DISCHARGED Mortgage 18922 of Outstanding Mortgage
18922 to Walter James Farmer to James Robert
McNeill produced 22.8.1938 at 2.25 p.m.

Transfer 417498 to registered proprietor to Peter
Neville Sigglesworth and Marjorie Long
Sigglesworth, both of Marston farmers as tenants
in common in equal shares produced
2.4.1958 at 2.24 p.m.

DISCHARGED Mortgage 18922 of Outstanding Mortgage
18922 to James Robert McNeill and Aline Grace
Saddler produced 17.11.1938 at 2.25 p.m.

Mortgage 372522 to registered proprietor to
Robert W. S. Aldfield produced 7.7.1952
at 11.30 a.m.

DISCHARGED Mortgage 18922 of Outstanding Mortgage
18922 to James Robert McNeill and Aline Grace
Saddler produced 17.11.1938 at 2.25 p.m.

Variation of Mortgage 372522 produced 8.8.1960
at 2.25 p.m.

DISCHARGED Mortgage 18922 of Outstanding Mortgage
18922 to William McNeill produced 21.12.1938
at 2.25 p.m.

Variation of Mortgage 372522 produced 8.2.1961
at 11.30 a.m.

Transfer 195217 of Mortgage 18922
Walter James Farmer to Harry Dentiffe
produced with Receipt 195217 of 12.10.1952
at 2.25 p.m.
K18889 Order of the Court of Review
Review Mortgage 18922 and 18921
produced 21.10.1938 at 3 p.m.

Variation of Mortgage 372522 produced
5.9.1961 at 12.12 noon

Transmission 35269 of Mortgage
18922 to Cyril Dentiffe as Executor
produced 6.11.1941 at 2.25 p.m.
and entered 23.11.1941 at 2.25 p.m.

Transmission 546018 of Mortgage 372522
to Peter Neville Sigglesworth by parent
-13/11/1963 at 11.18 a.m.

Transmission 40411 of the interest in Mortgage
18922 of Elizabeth Anne Tempsey deceased
to William Percy Chadwick and Harry
Glenne Norman Hadley as Executors
entered 1.2.1945 at 1.31 p.m.

Transfer 592926 to Peter Neville Sigglesworth
and Marjorie Long produced 15.5.1961 at 2.25 p.m.

Transmission 40707 of the interest of
Aline Grace Saddler in Mortgage 18922
to Harry Clement Norman Hadley and
Cyril Grace Hadley as Executors entered
20.8.1946 at 2.28 p.m.

Variation of Mortgage 592927
27.8.1972 at 9.12 a.m.

DISCHARGED Mortgage 282991 of Outstanding Mortgage
to Robert A. S. Aldfield produced 17.11.1952
at 11.30 a.m.

No. 937919: Gazette Notice declaring
portion of State Highway 3
to be a limited access road.
8.9.1972 at 2.03 p.m.

DISCHARGED Extension of Mortgage 282991 produced 2nd
March 1953 at 10.28 a.m.

Transmission 62046 to Kenneth Carmichael
of Whenuakura, farmer and Rupert
Mackay of Bulls, solicitor as executors
entered 13.6.1958 at 10.15 a.m.

THIS REPRODUCTION (ON A REDUCED SCALE)
CERTIFIED TO BE A TRUE COPY OF THE
ORIGINAL REGISTER FOR THE PURPOSES OF
SECTION 115A LAND TRANSFER ACT 1952
Stanton D.L.R.

(OVER)

337/177

No. 205925.1 Notice that a portion of Whales Line adjoining hereto has been stopped and New Appellation, section 117 Rangitikei Agricultural Reserve situated in Block II Rangitoto Survey District, has been allotted thereto - 1.9.1976 at 11.25 a.m.

[Signature]
A.L.R.

~~DISCHARGED~~
No. 213680 Variation of the terms of Mortgage 592927 - 2.12.1976 at 11.15 a.m.

[Signature]
A.L.R.

~~DISCHARGED~~
508690.1 Variation of the terms of Mortgage 592927 - 6.8.1982 at 10.00 a.m.

[Signature]
A.L.R.

785388.1 Transfer to John Sydney Wigglesworth of Marton, Farmer - 19.6.1986 at 11.23 a.m.

[Signature]
A.L.R.

~~DISCHARGED~~
887 B.306042.1 785388.2 Mortgage to Peter Neville Wigglesworth - 19.6.1986 at 11.23 a.m.

[Signature]
A.L.R.

B.306042.2 Transfer to Craig Peter Wigglesworth, Contractor and Maureen Anne Wigglesworth, Bank Officer, both of Marton - 23.8.1993 at 2.17 pm.

[Signature]
A.L.R.

B.306042.3 Mortgage to Trust Bank Central Limited - 23.8.1993 at 2.17 pm.

[Signature]
A.L.R.

B685976.4 Mortgage to Peter Neville Wigglesworth, Hoani Victor Hansen and Colin Field ~~and to Peter Neville Wigglesworth~~ *and to Peter Neville Wigglesworth*, in shares - 24.9.1998 at 9.15.

[Signature]
for DLR